

NOS.	RADIUS	Δ	ARC	TAN	CHORD	BEARING
4-5	640.00	15°22'42"	171.76	86.41	171.26	N 88°00'57"W
8-9	755.34	27°42'55"	365.8	186.57	362.25	N 01°24'48"E
10-11	830.00	18°15'31"	278.98	140.8	277.67	N 05°39'30"E
11-12	25.00	86°38'51"	37.8	23.56	34.31	N 39°2'10"E
13-1	325.00	08°48'53"	50.00	25.05	49.95	N 78°6'08"E

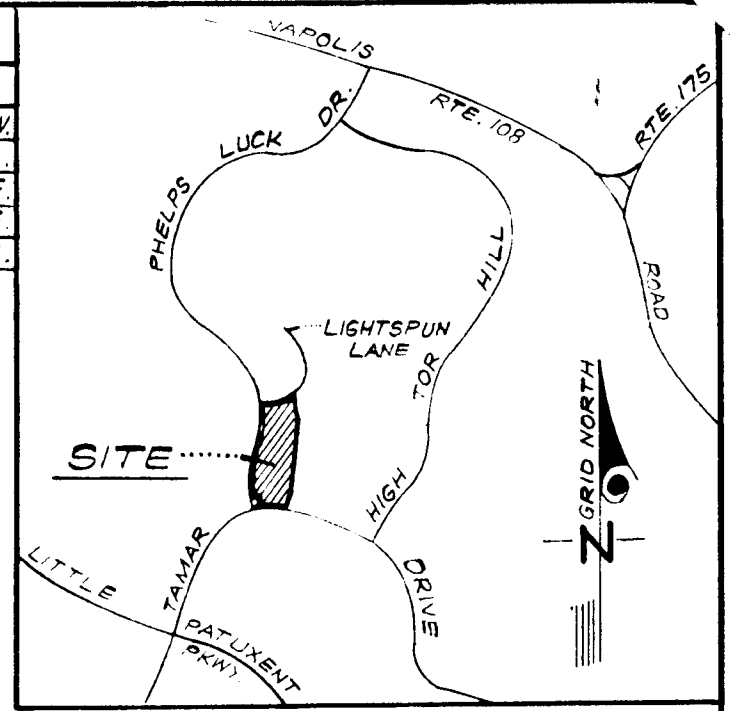

VICINITY MAP  
SCALE - 1" = 2000'

**RECEIVED**  
APR 15 1975  
BUREAU OF ENGINEERING  
SECTION SECTION

COORDINATE SCHEDULE		
NO.	NORTH	EAST
1	503 681 .59	850 774 .95
2	503 484 .06	850 806 .30
3	502 704 .07	850 707 .31
4	502 641 .26	850 673 .30
5	502 647 .19	850 502 .15
6	502 686 .99	850 498 .17
7	502 678 .36	850 459 .11
8	502 720 .57	850 449 .79
9	503 082 .70	850 458 .72
10	503 349 .93	850 531 .77
11	503 626 .25	850 559 .14
12	503 652 .78	850 580 .90
13	503 671 .44	850 726 .04

Storm Drain Easements shown thus are for the construction and maintenance of a private storm Drain system.

**GRANT OF EASEMENT**

We, "Columbia Park and Recreation Association do hereby grant unto Long Reach-P&S Associates, its successors and/or assigns, an easement for the construction and maintenance of a storm system through Open Space Lot 567 Village of Longreach, recorded in Plat Book 21, Folio 47.

TABULATIONS		
TOTALS		ACREAGE
Residential Lots (50)	=	2.082
R.O.W.	=	
Community Owned Lots (1)	=	4.151
Total	=	6.233
Lots this plat (Including Community Owned Lots)	=	51

Authorized Agent

**OWNER'S DEDICATION**

We, Long Reach - P&S Associates, a Limited Maryland Partnership, by Poretzky & Starr, Inc., General Partner, Martin H. Poretzky, President and Jack Starr, Secretary, owners of the property shown and described hereon, hereby adopt this plan of subdivision, and in consideration of the approval of this Final Plat by the Office of Planning and Zoning, establish the minimum building restriction lines, and dedicate where applicable the water, sewer, and Floodplain easements to public use. Storm drain easements shown on Lots J-9 and J-32 thru 38 are for maintenance of a private storm drain system. Witness our hands this 30<sup>th</sup> day of October, 1974.

LONG-REACH - P&S ASSOCIATES, A LIMITED MD. PARTNERSHIP  
By: Martin H. Poretzky  
MARTIN H. PORETSKY, President  
Poretzky & Starr, Inc., General Partner  
Attest: Jack Starr  
JACK STARR, Secretary  
Poretzky & Starr, Inc., General Partner

**SURVEYOR'S CERTIFICATE**

I hereby certify that the Final Plat shown hereon is correct, that it is a subdivision of all of the lands conveyed by Artery Communities, Inc. to Long Reach - P&S Associates, a Limited Maryland Partnership, by deed dated July 1, 1974, and recorded in the Land Records of Howard County, Maryland, in Liber 689 of Folio 81; that it is also a resubdivision of Parcel J, Village of Longreach, Section 1, Area 1, recorded in the aforesaid Land Records in Plat Book 21 Folio 47 and that all monuments are in place as shown in accordance with the Annotated Code of Maryland, as amended.

10/30/74 Date  
Donald B. Sackett  
DONALD B. SACKETT  
Registered Land Surveyor  
Md. No. 6059  
CLARK, FINEFROCK & SACKETT,  
ENGINEERS-PLANNERS-SURVEYORS  
11315 LOCKWOOD DRIVE  
SILVER SPRING, MD. 20904

RECORDED IN PLAT BOOK 30 FOLIO 36  
ON April 15, 1975, ETA among The  
Land Records of Howard County, Maryland

COLUMBIA  
VILLAGE OF LONGREACH  
Section 1, Area 1, Lots J-1 thru J-51, Inclusive  
A Resubdivision of Parcel J  
SECTION 1  
AREA 1  
Sheet 1 of 1  
6<sup>th</sup> Election District of Howard County, Md.  
Scale: 1" = 50' Date: October, 1974

#100