

# COLUMBIA

ALL COORDINATES ARE BASED ON THE MARYLAND STATE GRID SYSTEM

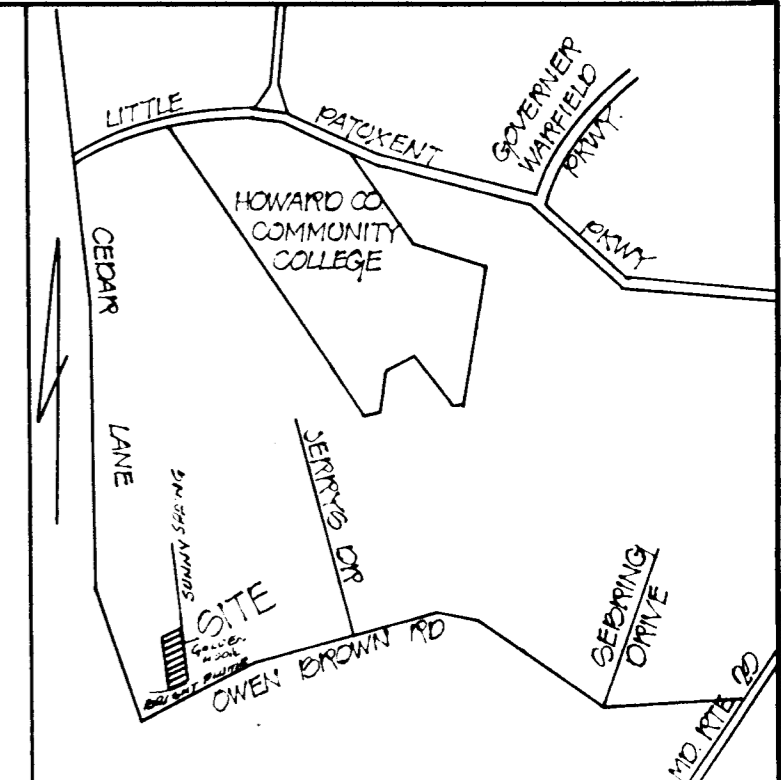
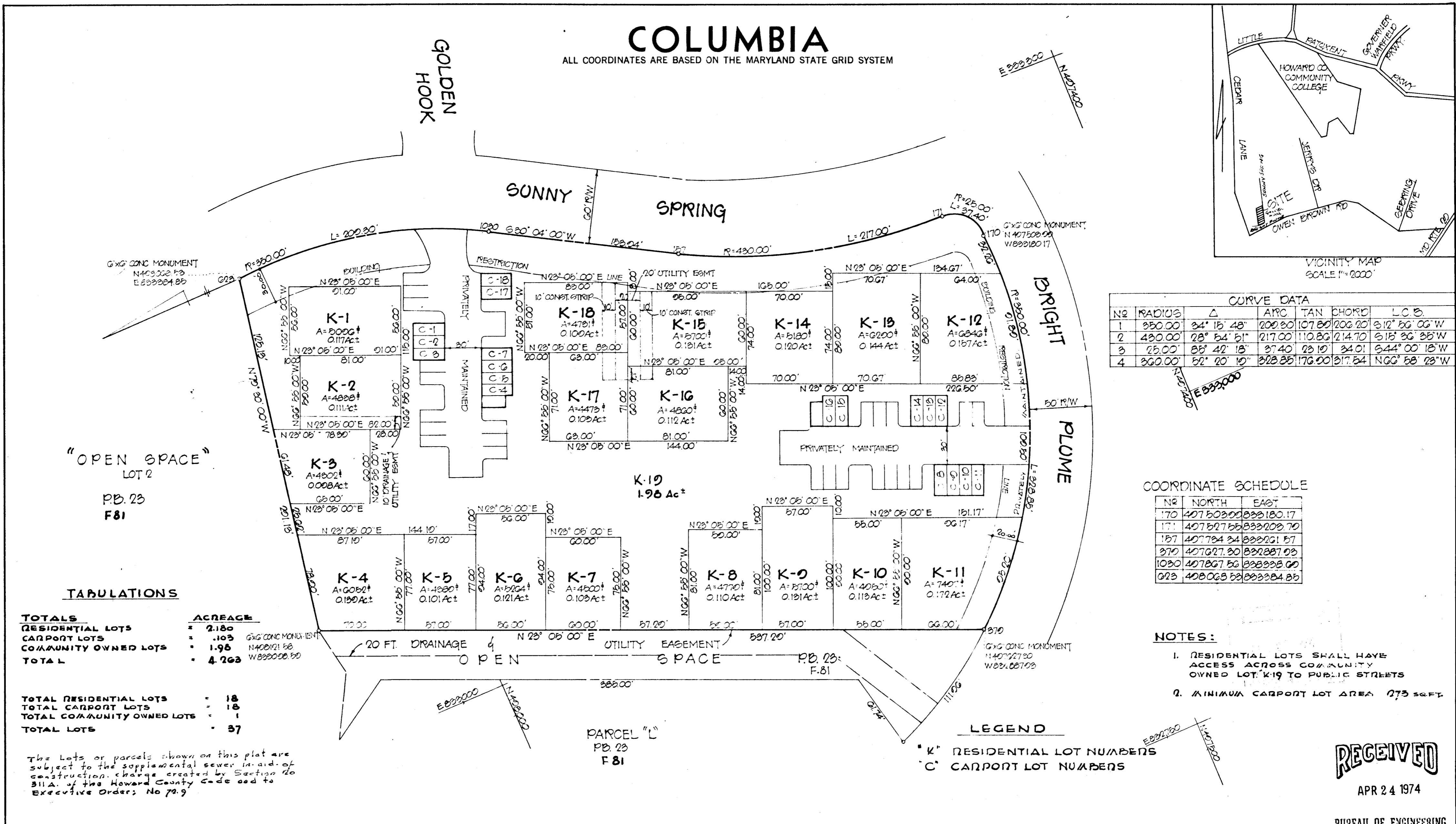

"OPEN SPACE"  
LOT 2  
P.B. 23  
F.81

**TABULATIONS**

TOTALS	ACREAGE
RESIDENTIAL LOTS	2.180
CARPORT LOTS	.103
COMMUNITY OWNED LOTS	1.96
TOTAL	4.243

TOTAL RESIDENTIAL LOTS	18
TOTAL CARPORT LOTS	18
TOTAL COMMUNITY OWNED LOTS	1
TOTAL LOTS	37

The Lots or parcels shown on this plat are subject to the supplemental sewer in aid of construction charge created by Section 20 311A of the Howard County Code and to Executive Orders No 79.9

APPROVED: FOR PUBLIC WATER AND PUBLIC SEWERAGE SYSTEMS, HOWARD COUNTY HEALTH DEPARTMENT.

COUNTY HEALTH OFFICER \_\_\_\_\_ DATE \_\_\_\_\_

APPROVED: HOWARD COUNTY OFFICE OF PLANNING AND ZONING.

DIRECTOR \_\_\_\_\_ DATE \_\_\_\_\_

APPROVED: FOR PUBLIC WATER AND PUBLIC SEWERAGE, STORM DRAINAGE SYSTEMS AND PUBLIC ROADS. HOWARD COUNTY DEPARTMENT OF PUBLIC WORKS.

DIRECTOR \_\_\_\_\_ DATE \_\_\_\_\_

SURVEYOR'S, ENGINEER'S and OWNER'S CERTIFICATES

The undersigned, owner of the property shown on this Plat, grants unto, (1) Howard County, Maryland, its successors and assigns, the right to lay, construct and maintain water and sewer mains and laterals therefor in and under all road and street rights-of-way as shown hereon; (2) further it adopts this plan of subdivision and reserves the fee simple title to the beds of the streets and/or roads hereon, except however, for one dollar consideration, it herewith grants the right and option to Howard County, Maryland to acquire (within a period of five years commencing with the date of recording of this plat among the Land Records of Howard County) the fee simple title to the beds of the streets and/or roads shown hereon, together with such adjacent land, if any, as may be shown on this plat as areas designated for the installation of street lighting facilities.

The undersigned certify that the subdivision plan shown hereon is correct as complying with the requirements of Final Development Plan Phase 100 recorded in Plat Book 20 Folios 75 to 83, each inclusive, with all Open Space shown thereon to be used for drainage easements, if necessary, and the requirements of Article 21 Section 7-108 of the annotated code of Maryland concerning the making of this Plat and setting of markers have been complied with. The land shown hereon is a part of the land which by deed dated May 31, 1972 and recorded among the Land Records of Howard County, Maryland in Liber 610 Folio 81, was granted and conveyed by The Howard Research and Development Corporation, to John N. Bowers, Inc.

PROFESSIONAL LAND SURVEYOR: WALTER PARK, HUDKINS ASSOCIATES INC, 221 JOSEPH SQUARE-COLUMBIA, MD 21043

PROFESSIONAL ENGINEER: HOWARD KOLESCHER, HUDKINS ASSOCIATES INC, 220 EAST JOPPA RD. TOWSON, MD 21284

OWNER: JOHN N. BOWERS, INC, AUTH. AGENT, COLUMBIA, MARYLAND, 21044

RECORDED IN PLAT BOOK 26 FOLIO 81

on APRIL 17, 1974 among The Land Records of Howard County, Maryland.

**COLUMBIA VILLAGE OF HICKORY RIDGE SECTION-1 AREA-1 LOTS K-1 TO K-19 A RESUBDIVISION OF PARCEL "K"**

SECTION \_\_\_\_\_

AREA \_\_\_\_\_

Sheet \_\_\_\_\_ of \_\_\_\_\_

5<sup>th</sup> Election District of Howard County, Md.

Scale: 1" = 50' Date: AUGUST 17, 1973

RECEIVED  
APR 24 1974  
BUREAU OF ENGINEERING

Inspections