

# COLUMBIA

ALL COORDINATES ARE BASED ON THE MARYLAND STATE GRID SYSTEM

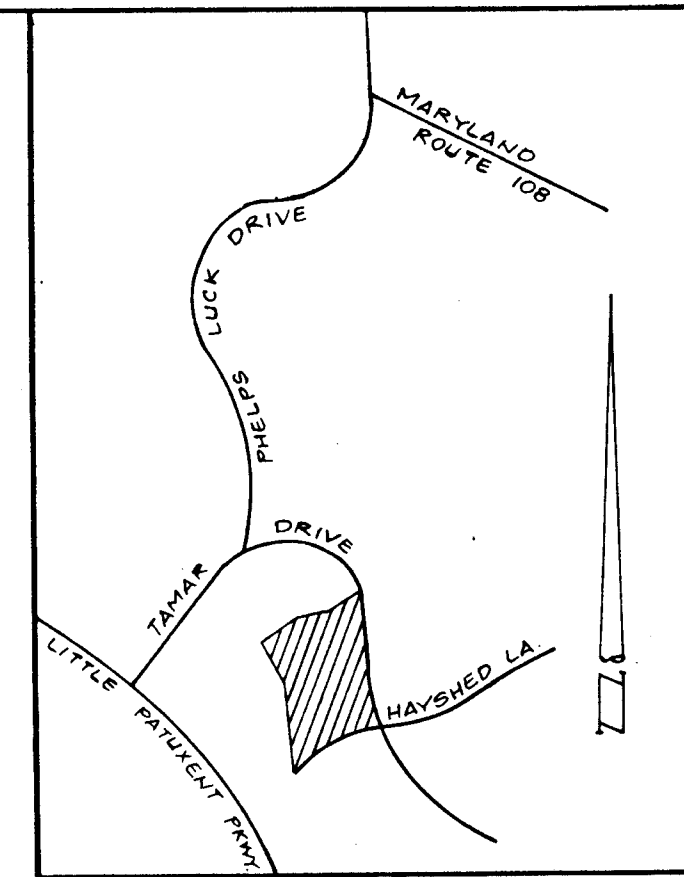

VICINITY MAP  
1" = 2000'

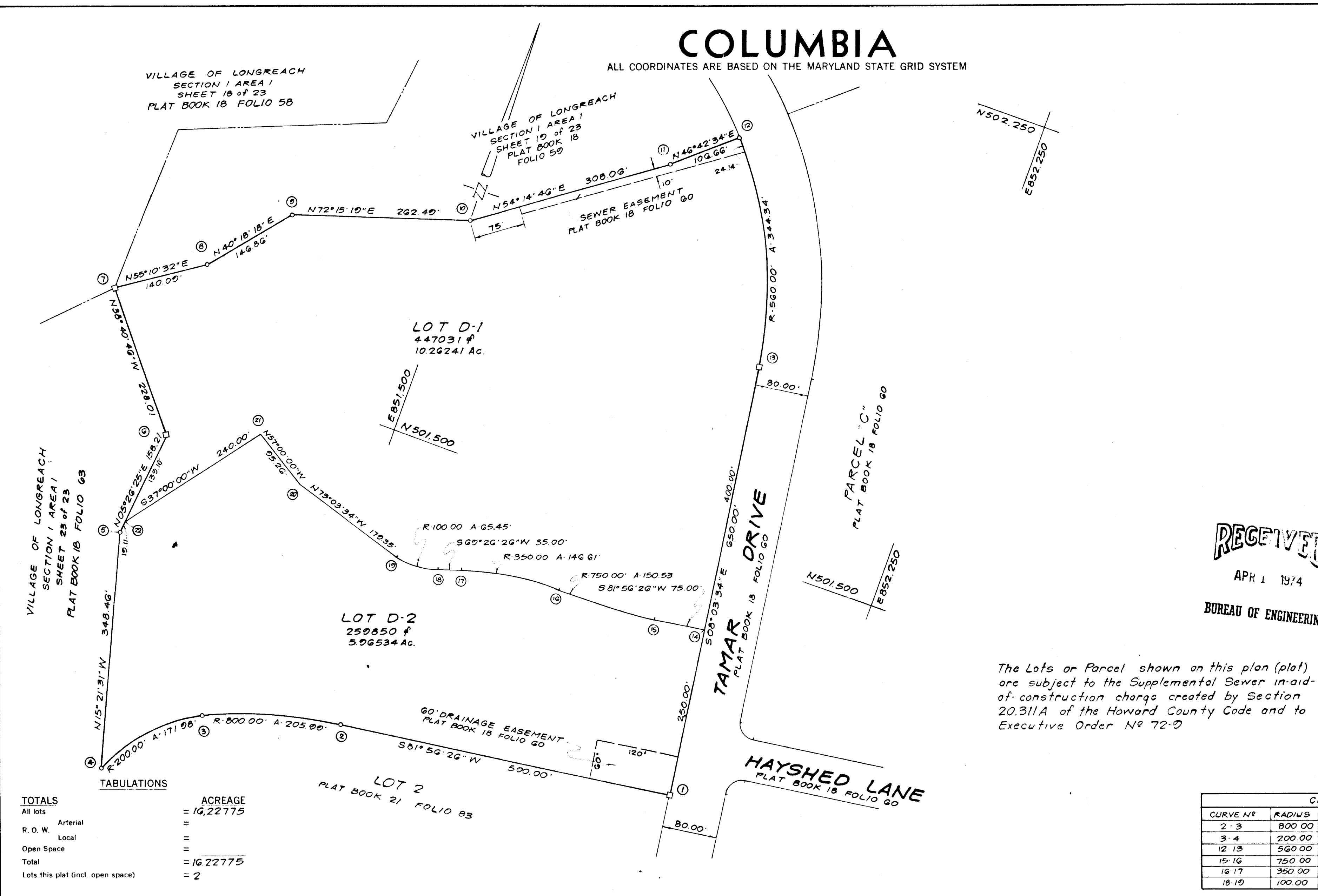

COORDINATES		
Nº	NORTH	EAST
1	501,134.08	805,065.63
2	501,063.98	804,570.57
3	501,009.31	804,372.56
4	500,886.48	804,259.80
5	501,222.50	804,167.51
6	501,380.00	804,182.51
7	501,557.99	804,040.01
8	501,637.99	804,155.01
9	501,749.99	804,250.01
10	501,829.99	804,500.01
11	502,009.99	804,750.01
12	502,083.13	804,827.65
13	501,777.65	804,974.50
14	501,381.60	805,030.58
15	501,371.09	804,956.32
16	501,364.98	804,806.16
17	501,349.37	804,662.26
18	501,331.08	804,629.19
19	501,329.05	804,565.22
20	501,381.31	804,393.65
21	501,433.19	804,313.76
22	501,241.52	804,169.32

**RECEIVED**  
APR 1 1974  
BUREAU OF ENGINEERING

The Lots or Parcel shown on this plan (plot) are subject to the Supplemental Sewer in-aid-of-construction charge created by Section 20.311A of the Howard County Code and to Executive Order Nº 72-D

CURVE DATA						
CURVE Nº	RADIUS	Δ	ARC	TAN.	CHORD	L.C.B.
2-3	800.00	14°45'10"	205.99	103.57	205.42	S74°33'51"W
3-4	200.00	49°16'06"	171.98	91.71	166.73	S42°33'12"W
12-13	560.00	35°13'52"	344.34	177.61	388.94	S25°40'30"E
15-16	750.00	11°30'00"	150.53	75.52	150.28	S81°41'26"W
16-17	350.00	24°00'00"	146.61	74.39	145.54	S81°26'26"W
18-19	100.00	37°30'00"	65.45	33.95	64.29	S88°11'26"W

TOTALS	
All lots	ACREAGE = 16.22775
R. O. W. Arterial	=
Local	=
Open Space	=
Total	= 16.22775
Lots this plat (incl. open space)	= 2

APPROVED: FOR PUBLIC WATER AND PUBLIC SEWERAGE SYSTEMS. HOWARD COUNTY HEALTH DEPARTMENT.

*[Signature]* 3-28-74  
COUNTY HEALTH OFFICER DATE

APPROVED: HOWARD COUNTY OFFICE OF PLANNING AND ZONING.

*[Signature]* 3-29-74  
DIRECTOR DATE

APPROVED: FOR PUBLIC WATER AND PUBLIC SEWERAGE, STORM DRAINAGE SYSTEMS AND PUBLIC ROADS. HOWARD COUNTY DEPARTMENT OF PUBLIC WORKS.

*[Signature]* 3-29-74  
DIRECTOR DATE

SURVEYOR'S, ENGINEER'S and OWNER'S CERTIFICATES

The undersigned, owner of the property shown on this Plat, grants unto, (1) Howard County, Maryland, its successors and assigns, the right to lay, construct and maintain water and sewer mains and laterals therefor in and under all road and street rights-of-way as shown hereon; (2) further it adopts this plan of subdivision and reserves the fee simple title to the beds of the streets and/or roads hereon, except however, for one dollar consideration, it herewith grants the right and option to Howard County, Maryland to acquire (within a period of five years commencing with the date of recording of this plat among the Land Records of Howard County) the fee simple title to the beds of the streets and/or roads shown hereon, together with such adjacent land, if any, as may be shown on this plat as areas designated for the installation of street lighting facilities.

The undersigned certify that the subdivision plan shown hereon is correct as complying with the requirements of Final Development Plan Phase 77 recorded in Plat Book 10 Folios 50 to 72, each inclusive, with all Open Space shown thereon to be used for drainage easements, if necessary, and the requirements of Article 21, Section 3-108 of the annotated code of Maryland concerning the making of this Plat and setting of markers have been complied with. The land shown hereon is a part of the land which by deed dated December 13, 1966 and recorded among the Land Records of Howard County, Maryland in Liber 463 Folio 196, was granted and conveyed by C. Aileen Ames to The Howard Research and Development Corporation, then conveyed by the Howard Research & Development Corp. to The National Housing Partnership a limited partnership of the District of Columbia, by deed dated April 20 1971 and recorded among said Land Records in Liber 557 of Folio 312 that this plat is a subdivision of Parcel 'D', as shown on a plat recorded among said Land Records in Plat Book 18 at Folio 60.

(By) *[Signature]* 3014LS Reg. No. SEYBOLT, GORE, NEWQUIST & BERLINSKY  
1111 BONIFANT STREET, SILVER SPRING, MD. 20910

(By) *[Signature]* 0420 PE. Reg. No. SEYBOLT, GORE, NEWQUIST & BERLINSKY  
1111 BONIFANT STREET, SILVER SPRING MD. 20910

(By) *[Signature]* THE NATIONAL HOUSING PARTNERSHIP Auth. Agent  
1133 15TH ST. NW. WASHINGTON D.C. 20005

RECORDED IN PLAT BOOK 18 FOLIO 60  
on MARCH 29, 1974 among The Land Records of Howard County, Maryland.

**COLUMBIA**  
LOTS D-1 & D-2  
A RESUBDIVISION OF PARCEL 'D'  
VILLAGE OF LONGREACH

SECTION 1  
AREA 1  
Sheet 1 of 1  
G<sup>TH</sup> Election District of Howard County, Md.

Scale: 1" = 100' Date: DECEMBER, 1973

#100

*Inspections*