

GENERAL NOTES

1. THE EXISTING UTILITIES AND OBSTRUCTIONS SHOWN ON THE PLANS ARE FROM THE BEST AVAILABLE RECORDS AND SHALL BE VERIFIED BY THE CONTRACTOR TO HIS OWN SATISFACTION BEFORE STARTING CONSTRUCTION. NEITHER THE ENGINEER NOR THE HOWARD COUNTY DEPARTMENT OF PUBLIC WORKS WARRANT OR GUARANTEE THE COMPLETENESS OR CORRECTNESS OF THE INFORMATION SHOWN.
2. THE CONTRACTOR SHALL TAKE ALL NECESSARY PRECAUTIONS TO PROTECT EXISTING UTILITIES. ANY DAMAGE INCURRED SHALL BE REPAIRED IMMEDIATELY TO THE SATISFACTION OF THE ENGINEER BY THE CONTRACTOR AT THE CONTRACTOR'S EXPENSE.
3. THE CONTRACTOR SHALL BE RESPONSIBLE FOR THE RESTORATION OF ALL DRIVEWAYS DAMAGED AS A RESULT OF HIS CONSTRUCTION ACTIVITIES.
4. TREES, SHRUBS AND BUSHES ARE TO BE PROTECTED TO THE MAXIMUM EXTENT POSSIBLE. TREES, SHRUBS, BUSHES, MAILBOXES, FENCES, AND ROADWAY SIGNS WHICH INTERFERE WITH ROADWAY INSTALLATION AND RELATED GRADING ACTIVITIES SHALL BE RELOCATED AS DIRECTED BY THE ENGINEER. NO SEPARATE MEASUREMENT OR PAYMENT WILL BE MADE FOR THIS WORK.
5. PLACE REGULATION "MEN WORKING" AND WARNING SIGNS AS REQUIRED TO COMPLY WITH MARYLAND STATE HIGHWAY ADMINISTRATION MANUAL OF TRAFFIC CONTROL FOR HIGHWAY CONSTRUCTION AND MAINTENANCE OPERATIONS.
6. PERFORMANCE OF WORK SHALL CONFORM TO THE HOWARD COUNTY DESIGN MANUAL, VOLUME IV, STANDARD SPECIFICATIONS AND DETAILS FOR CONSTRUCTION. WHERE SPECIFIED ON THE PLANS OR STIPULATED IN THE SPECIFICATIONS THE WORK SHALL CONFORM TO THE STATE HIGHWAY ADMINISTRATION BOOK TITLED "SPECIFICATIONS FOR MATERIALS, HIGHWAYS AND INCIDENTAL STRUCTURES."
7. REFERENCE MADE TO STANDARD DRAWINGS REFER TO THE STANDARDS BOUND IN THE HOWARD COUNTY DESIGN MANUAL, VOLUME IV, STANDARD SPECIFICATIONS AND DETAILS FOR CONSTRUCTION. UNLESS OTHERWISE SPECIFIED, IT WILL BE THE CONTRACTOR'S RESPONSIBILITY THAT THE STANDARD DETAILS IN HIS POSSESSION ARE LATEST REVISED STANDARDS UP TO THE DATE OF THE ADVERTISEMENT OF THIS CONTRACT.
8. ALL HORIZONTAL CONTROLS AND COORDINATES SHOWN ARE BASED ON THE MARYLAND STATE COORDINATE SYSTEM.
9. ONLY THOSE BENCH MARKS SHOWN ON THE PLAN INDICATED BY THE SYMBOL SHALL BE USED FOR CONSTRUCTION.
10. STOPPING SIGHT DISTANCE FOR VERTICAL CURVES SHOWN AS (SSD=400) ON PLANS IS BASED ON HEIGHT OF EYE BEING 5.00 FEET ABOVE THE ROAD SURFACE SIGHTING AN OBJECT 6 INCHES HIGH.
11. ALL LAWNS DISTURBED BY CONSTRUCTION SHALL BE SODDED. ALL OTHER SHALL BE REPAIRED BY TOPSOIL, SEEDING, AND MULCHING.
12. THE CONTRACTOR SHALL TAKE ALL PRECAUTIONS SO AS NOT TO DISTURB THE EXISTING VEGETATION OUTSIDE THE LIMITS OF CONSTRUCTION. SOIL STABILIZATION WILL CONFORM TO U.S.D.A. SOIL CONSERVATION SERVICE "STANDARDS AND SPECIFICATIONS FOR SOIL EROSION AND SEDIMENT CONTROL IN DEVELOPING AREAS."
13. THE CONTRACTOR SHALL SUBMIT HIS SCHEDULE OF CONSTRUCTION AND PLAN FOR MAINTENANCE OF TRAFFIC TO HOWARD COUNTY BEFORE GRADING OR EXCAVATING OPERATIONS ARE INITIATED. THESE CONSTRUCTION AND TRAFFIC MAINTENANCE SCHEDULES SHALL BE DEVELOPED SO AS TO MAINTAIN TWO (2) LANES OF TRAFFIC AT ALL TIMES. THE CONTRACTOR SHALL BE RESPONSIBLE FOR ESTABLISHING AND MAINTAINING ALL TRAFFIC CONTROL DEVICES AND SIGNS.
14. THE CONTRACTOR SHALL NOTIFY THE FOLLOWING AGENCIES AT LEAST THREE (3) DAYS PRIOR TO BEGINNING CONSTRUCTION OF THIS PROJECT.
 HOWARD COUNTY FIRE DEPARTMENT 992-2311
 HOWARD COUNTY POLICE DEPARTMENT 992-2222
 MISS UTILITY 559-0100
 STATE HIGHWAY ADMINISTRATION 531-5533
 CHESAPEAKE & POTOMAC TELEPHONE COMPANY 795-1390
15. THE CONTRACTOR SHALL NOTIFY THE HOWARD COUNTY DIVISION OF TRAFFIC FORTY-EIGHT (48) HOURS PRIOR TO BEGINNING THE ACTUAL INSTALLATION OF PAVEMENT MARKINGS AND/OR STRIPING.

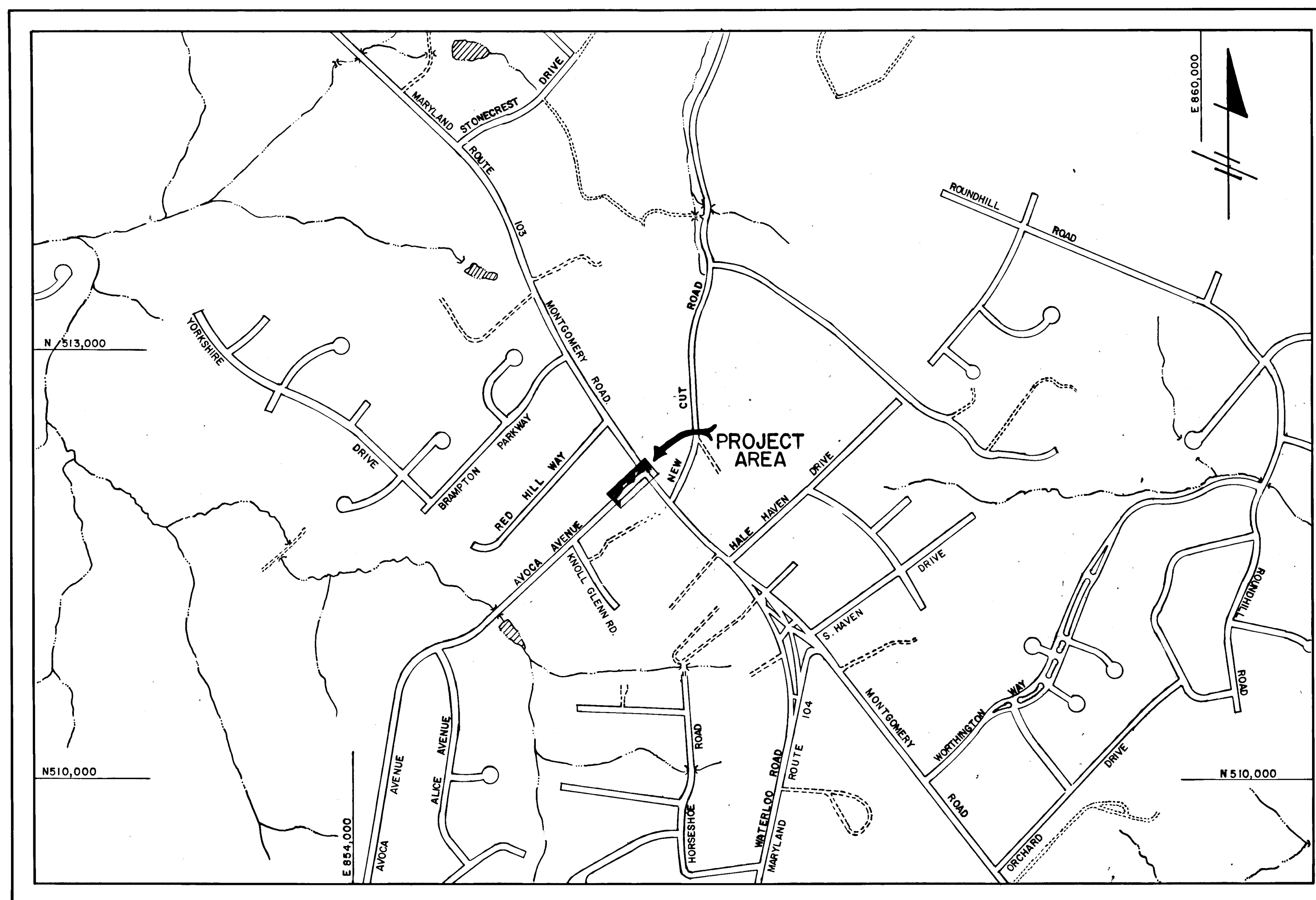

VICINITY MAP
SCALE 1"=600'

ENGINEER'S CERTIFICATE

I HEREBY CERTIFY THAT THIS PLAN FOR EROSION AND SEDIMENT CONTROL REPRESENTS A PRACTICAL AND WORKABLE PLAN BASED ON MY PERSONAL KNOWLEDGE OF THE SITE CONDITIONS AND THAT IT WAS PREPARED IN ACCORDANCE WITH THE REQUIREMENTS OF THE HOWARD SOIL CONSERVATION DISTRICT.

[Signature]
SIGNATURE OF ENGINEER

7-2-85
DATE

DEVELOPER'S CERTIFICATE

"I/WE CERTIFY THAT ALL DEVELOPMENT AND CONSTRUCTION WILL BE DONE ACCORDING TO THIS PLAN OF DEVELOPMENT AND PLAN FOR EROSION AND SEDIMENT CONTROL AND THAT ALL RESPONSIBLE PERSONNEL INVOLVED IN THE CONSTRUCTION PROJECT WILL HAVE A CERTIFICATE OF ATTENDANCE AT A DEPARTMENT OF NATURAL RESOURCES APPROVED TRAINING PROGRAM FOR THE CONTROL OF SEDIMENT AND EROSION BEFORE BEGINNING THE PROJECT. I ALSO AUTHORIZE PERIODIC ONSITE INSPECTION BY THE HOWARD SOIL CONSERVATION DISTRICT OR THEIR AUTHORIZED AGENTS, AS ARE DEEMED NECESSARY."

[Signature]
SIGNATURE OF DEVELOPER

6-25-85
DATE

ROADWAY IMPROVEMENTS

AVOCA AVENUE AT MARYLAND ROUTE 103

CAPITAL PROJECT T-7032

HOWARD COUNTY, MARYLAND

DEPARTMENT OF PUBLIC WORKS

SEDIMENT CONTROL MEASURES FOR THIS CONTRACT WILL BE IMPLEMENTED IN ACCORDANCE WITH DIVISION III OF VOLUME IV OF THE HOWARD COUNTY DESIGN MANUAL AND THE STANDARDS AND SPECIFICATIONS FOR SOIL EROSION AND SEDIMENT CONTROL. THIS PLAN IS APPROVED FOR EROSION AND SEDIMENT CONTROL BY THE HOWARD SOIL CONSERVATION DISTRICT.

[Signature] 7-2-85
HOWARD SOIL CONSERVATION DISTRICT DATE

REVIEWED FOR HOWARD COUNTY SOIL CONSERVATION DISTRICT AND MEETS TECHNICAL REQUIREMENTS

[Signature] 7-2-85
U.S. SOIL CONSERVATION SERVICE DATE

DEPARTMENT OF PUBLIC WORKS
HOWARD COUNTY, MARYLAND

[Signature] 6-25-85
DIRECTOR OF PUBLIC WORKS DATE

[Signature] 6-25-85
CHIEF, BUREAU OF ENGINEERING DATE

FISHER, COLLINS & CARTER

CONSULTING ENGINEERS AND LAND SURVEYORS
8388 COURT AVENUE
ELLCOTT CITY, MARYLAND 21043

DES-P.W.K.

DRN-D.B.S.

CHK-T.A.F.

DATE:

BY NO. REVISION DATE

TITLE SHEET

600' SCALE MAP NO. 31 BLOCK NO.

ROADWAY IMPROVEMENTS
AVOCA AVENUE AT MARYLAND ROUTE 103
CAPITAL PROJECT NO. T-7032
SECOND ELECTION DISTRICT
HOWARD COUNTY, MARYLAND

SCALE AS SHOWN

SHEET 1 OF 3

#1154

BENCH MARK

B.M. #1 ELEV 470.00
 22 SPIKE SET IN G#E
 POLE 513240, NORTH SIDE
 MONTGOMERY ROAD OPPOSITE
 AVOCA AVENUE

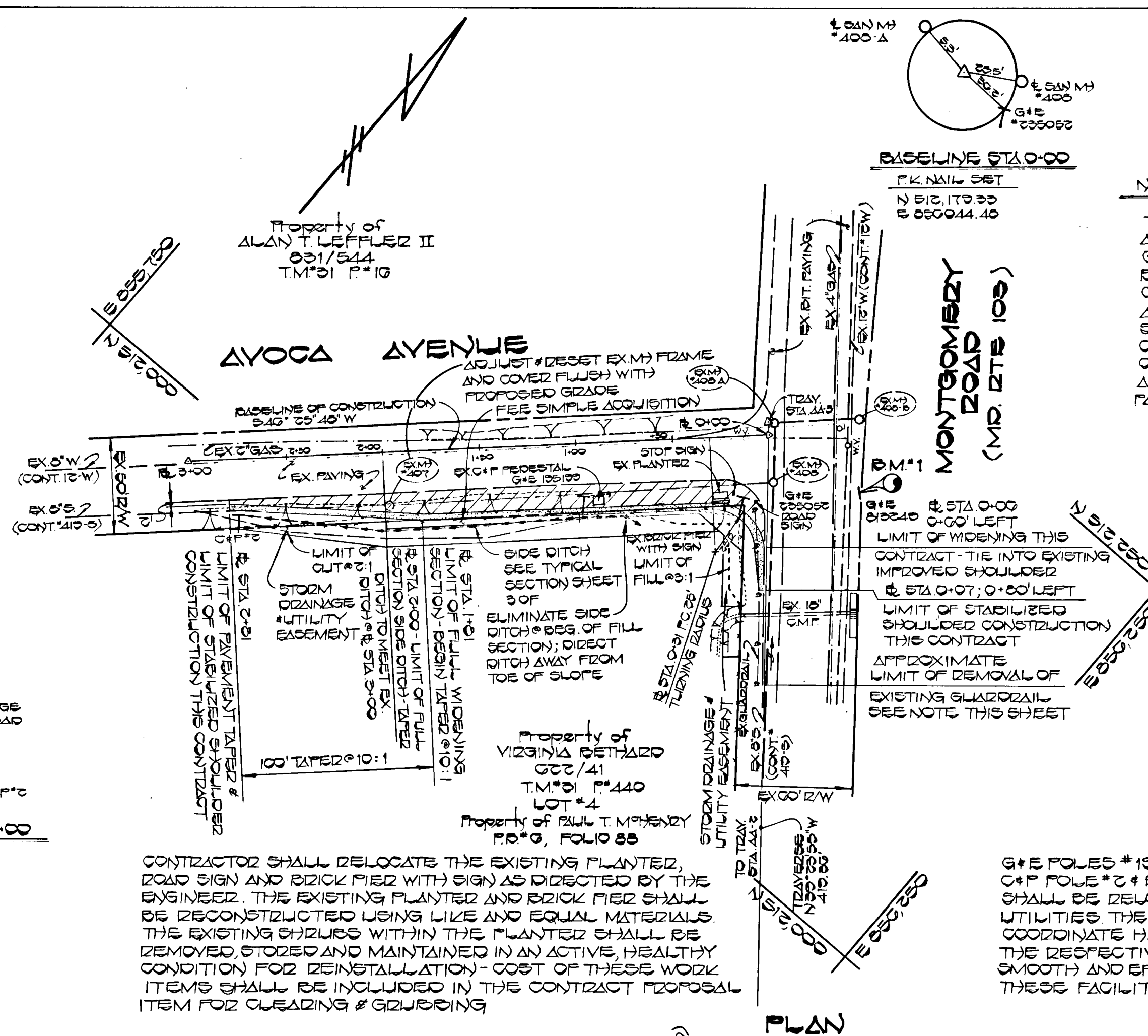

NOTE: GUARDRAIL RELOCATION

THE CONTRACTOR SHALL REMOVE APPROXIMATELY 30 FEET OF EXISTING GUARDRAIL ALONG MONTGOMERY ROAD BEGINNING AT THE LIMIT OF REMOVAL, THE CONTRACTOR SHALL REINSTALL APPROXIMATELY 75' OF GUARDRAIL AS SHOWN IN THE PLAN ON SHEET 3 OF 3. COSTS OF REMOVAL AND REINSTALLATION OF THE GUARDRAIL SHALL BE INCIDENTAL TO AND INCLUDED IN THE PRICE BID FOR THE ANY ITEMS OF THE PROPOSAL.

G#E POLES # 105100 # # 230552 AND G#E POLE # 2 # EXISTING G#E PEDESTAL SHALL BE RELOCATED BY THE RESPECTIVE UTILITIES THE CONTRACTOR SHALL COORDINATE HIS ACTIVITIES WITH THE RESPECTIVE UTILITIES TO ASSURE THE SMOOTH AND EFFICIENT RELOCATION OF THESE FACILITIES

SEE SHEET 3 OF 3 FOR:

1. TYPICAL ROADWAY WIDENING SECTION
2. TYPICAL PAVING SECTION
3. MAINTENANCE OF TRAFFIC PLAN, NOTES AND DETAILS
4. SEDIMENT AND EROSION CONTROL PLAN, NOTES AND DETAILS

CONTRACTOR SHALL RELOCATE THE EXISTING PLANTED ROAD SIGN AND BRICK PIERS WITH SIGN AS DIRECTED BY THE ENGINEER. THE EXISTING PLANTED AND BRICK PIERS SHALL BE RECONSTRUCTED USING LIKE AND EQUAL MATERIALS. THE EXISTING BRICKS WITHIN THE PLANTED SHALL BE REMOVED STORED AND MAINTAINED IN AN ACTIVE HEALTHY CONDITION FOR REINSTALLATION. COST OF THESE WORK ITEMS SHALL BE INCLUDED IN THE CONTRACT PROPOSAL ITEM FOR CLEARING & GRUBBING

PLAN
1" = 50'

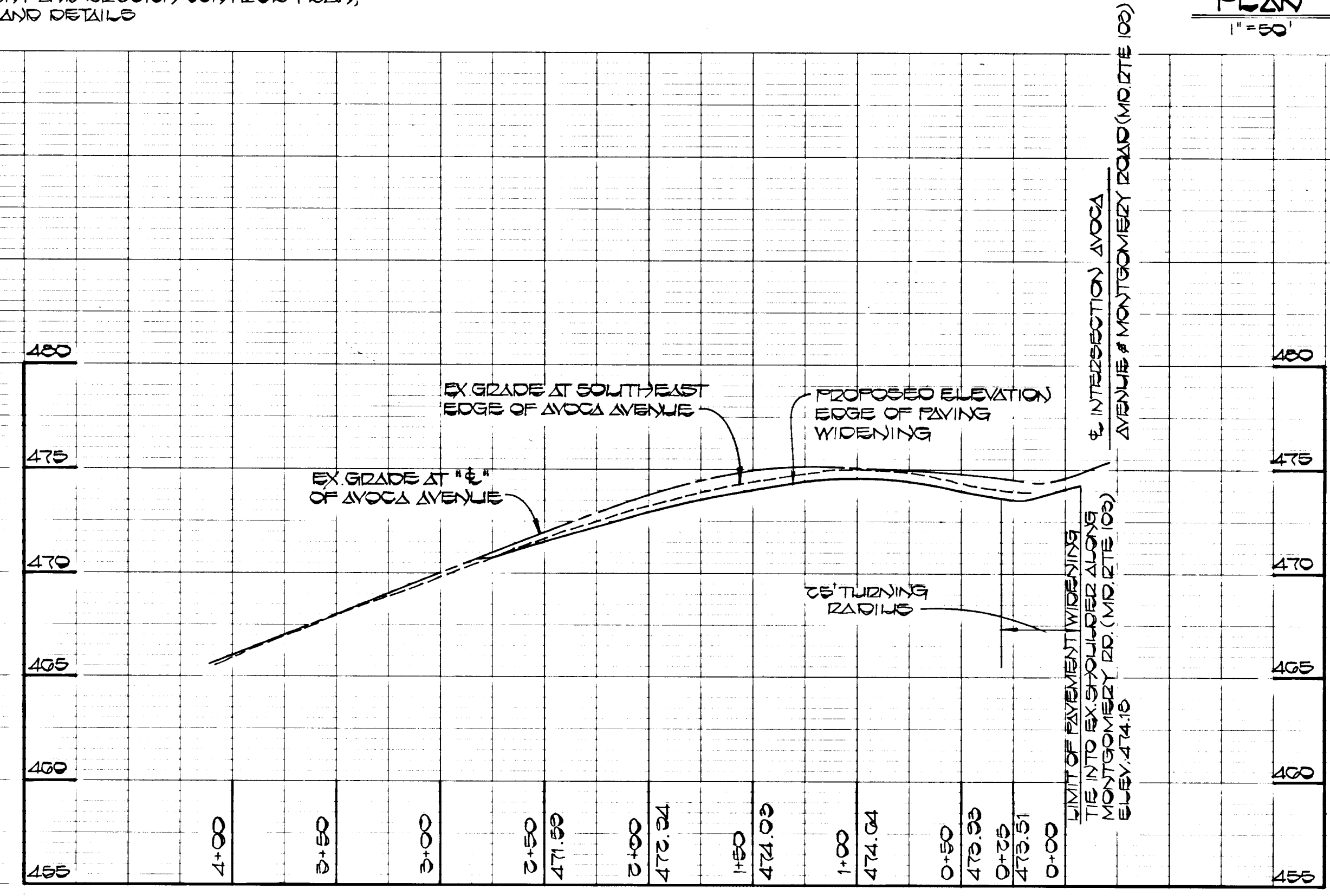

PROFILE
SCALE: HORIZ. 1" = 50'
VERT. 1" = 5'

DEPARTMENT OF PUBLIC WORKS
 HOWARD COUNTY, MARYLAND

Director of Public Works
 Date: 6-25-85

Chief, Bureau of Engineering
 Date: 6-25-85

Chief, Roads, Bridges, & Storm Drainage Division
 Date: 6-25-85

FISHER, COLLINS & CARTER, INC.
 CONSULTING ENGINEERS AND LAND SURVEYORS

8388 COURT AVENUE
 ELLICOTT CITY, MARYLAND 21043

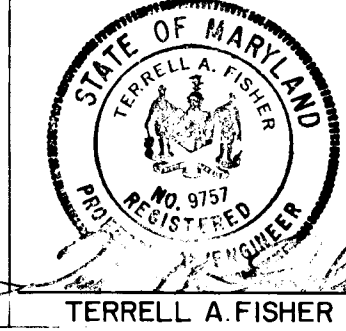

DES: P.W.K.	
DRN: D.B.S.	
CHK: T.A.F.	
DATE:	
BY: NO	
REVISION	
DATE	

PLAN AND PROFILE

600' SCALE MAP NO. 31 BLOCK NO.

ROADWAY IMPROVEMENTS
 AVOCA AVENUE AT MARYLAND ROUTE 103
 CAPITAL PROJECT NO. T-7032

SECOND ELECTION DISTRICT
 HOWARD COUNTY, MARYLAND

SCALE AS SHOWN
 SHEET 2 OF 3

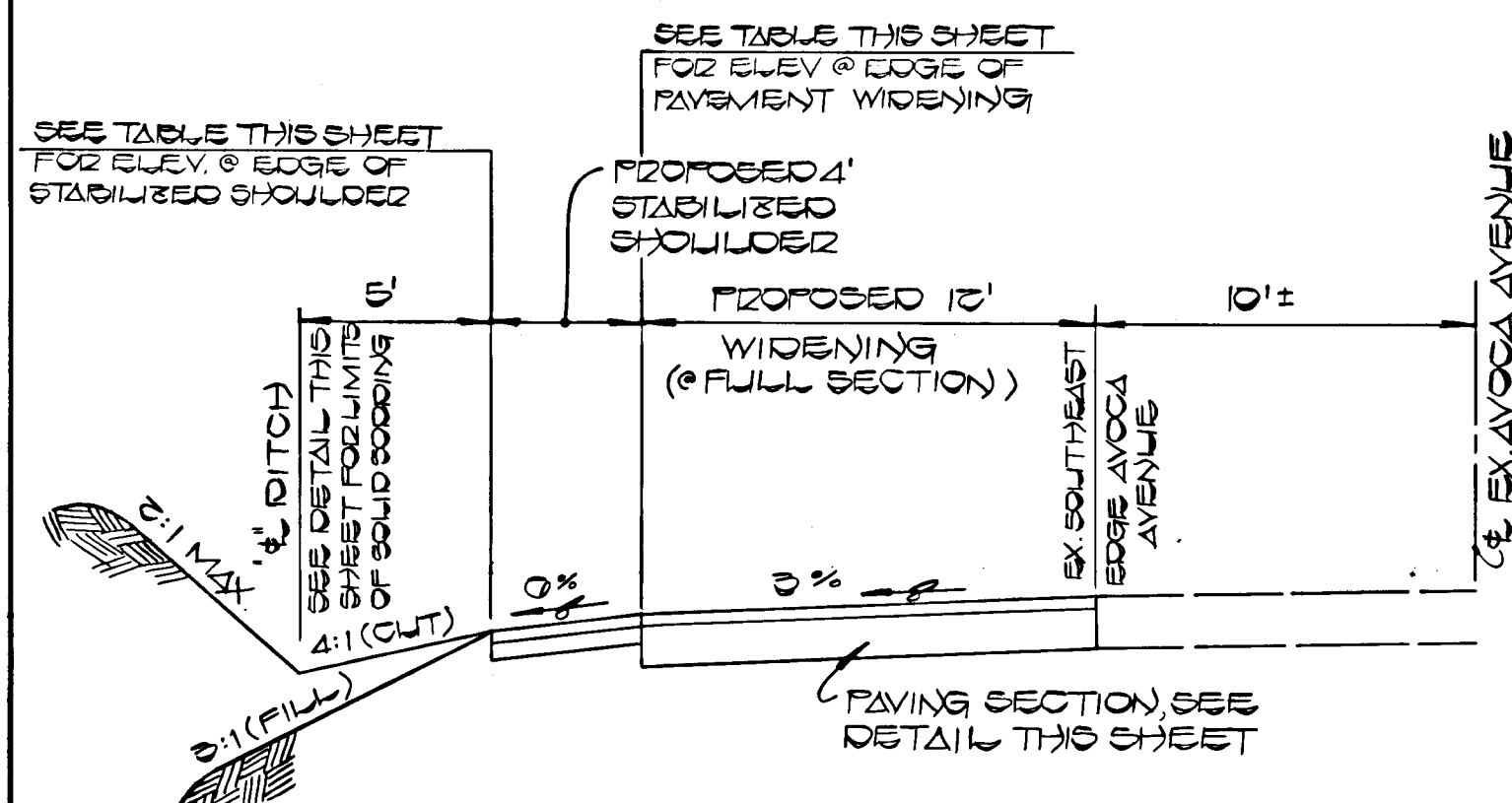

TYPICAL SECTION
NO SCALE

BASLINE STATION	WIDTH OF PAVING	ELEVATION @ EDGE OF PAVING	ELEVATION @ EDGE OF STABILIZED SHOULDER
0+35	15'	473.51	473.07
0+50	15'	473.93	473.09
0+75	15'	474.33	474.06
1+00	15'	474.64	474.40
1+25	15'	474.34	474.60
1+50	15'	474.00	473.79
1+75	15'	473.43	473.22
2+00	10' IN TAPER	473.34	472.70
2+25	7.5' IN TAPER	473.33	472.02
2+50	5' IN TAPER	471.33	471.36
2+75	2.5' IN TAPER	470.70	470.46
3+01	0'	470.43	470.25

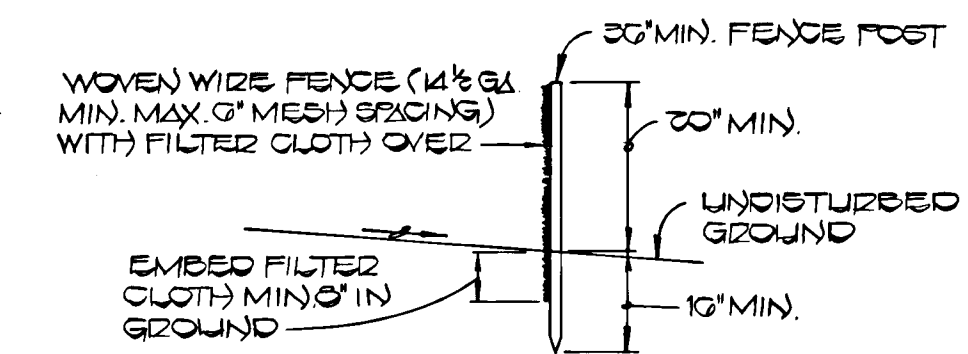
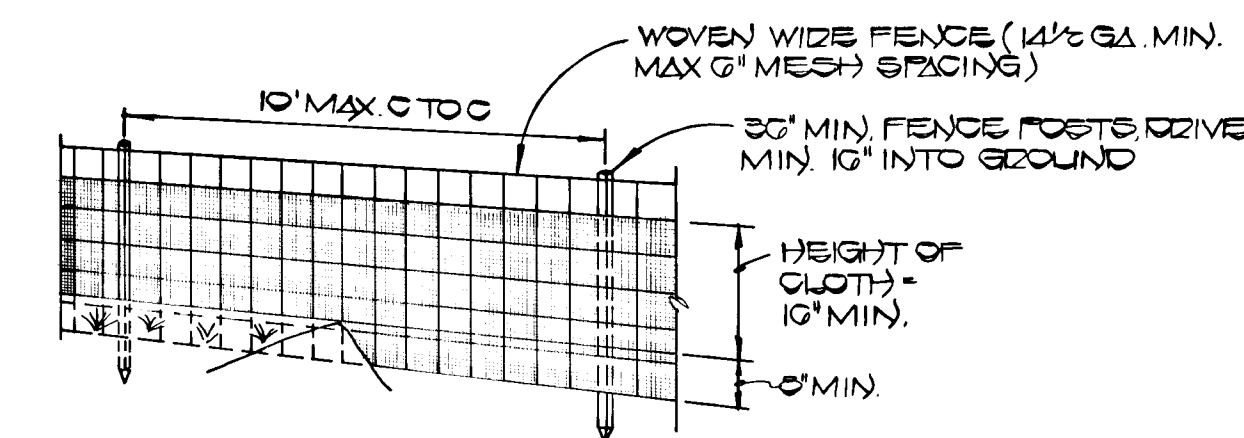

SILT FENCE
NO SCALE

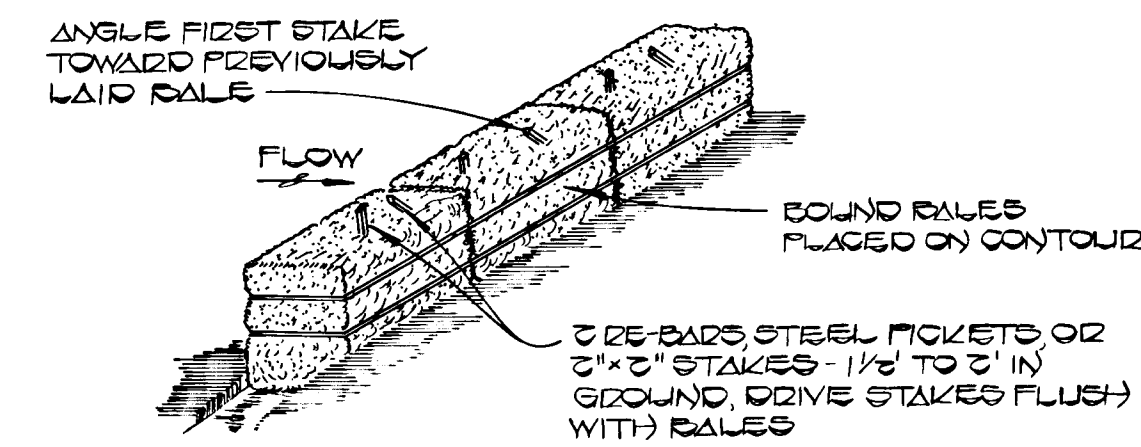

STRAW BALE DIKE
NO SCALE

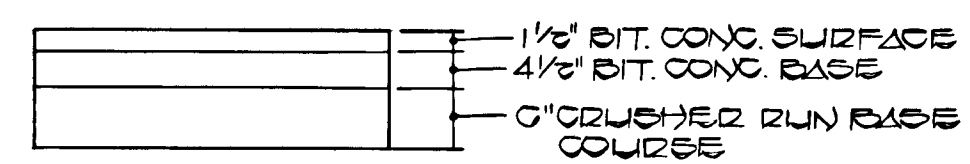

TYPICAL PAVING SECTION
NO SCALE

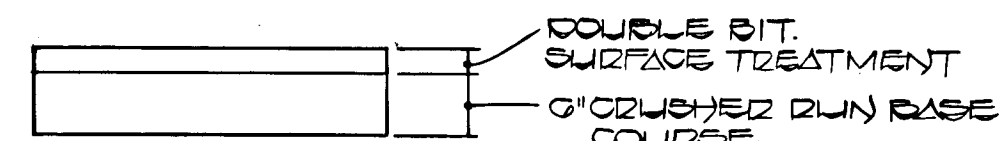

STABILIZED SHOULDER SECTION
NO SCALE

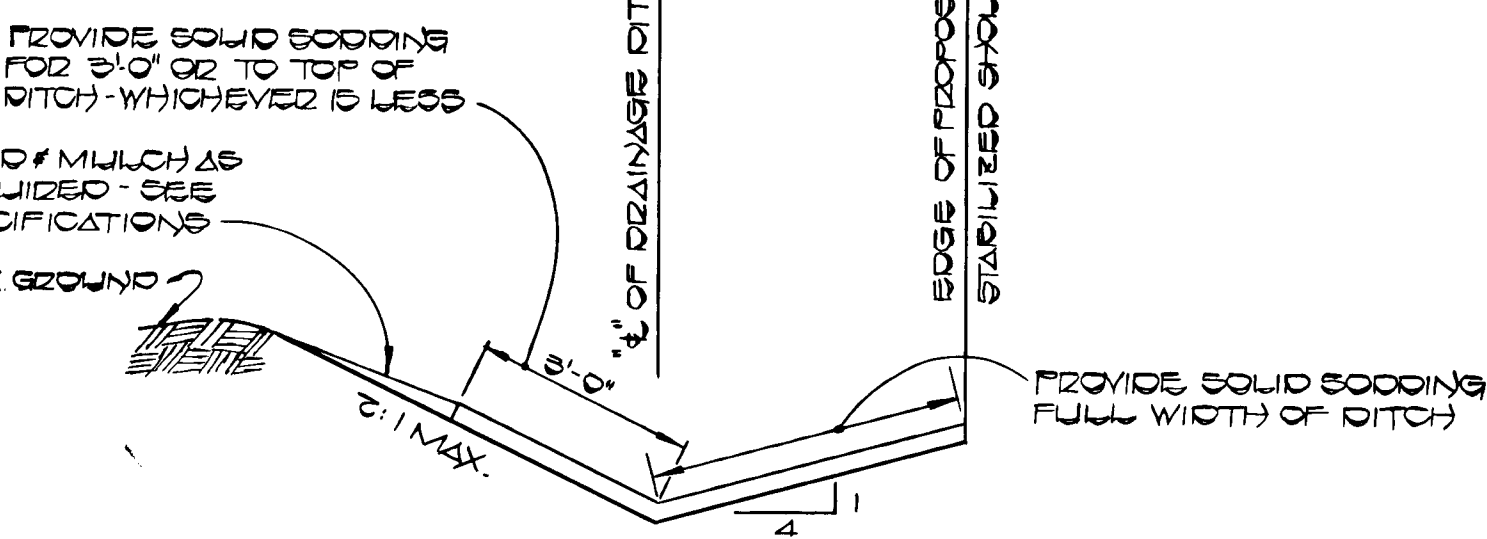

DETAIL
SOLID SOODING @ DRAINAGE DITCH
NO SCALE

NOTE: SEE SECTION 3.31 OF THE SPECIAL PROVISIONS FOR SPECIFICATIONS REGARDING SOLID SOODING

BASLINE STATION	DISTANCE - EDGE OF STABILIZED SHOULDER TO 1/2\"/>		
1+00	0.0'	474.40 *	* ELEV. @ EDGE OF SHOULDER; DATE 31 MAX TO EX. SECTION FIRST FULL SECTION DITCH
1+25	0.0'	473.33	
1+50	0.0'	472.54	FULL SECTION DITCH
1+75	0.0'	471.97	
2+00	0.0'	471.45	LAST FULL SECTION DITCH
2+25	4.0'	471.02	
2+50	0.0'	470.00	TAPER DRAINAGE DITCH INTO EX SWALE @ EDGE OF AVOCA AVENUE
2+75	1.2'	470.17	
3+01	0.0'	470.00	
3+00	0.0'	469.74	

TABLE OF SIDE DRAINAGE DITCH ELEVATIONS

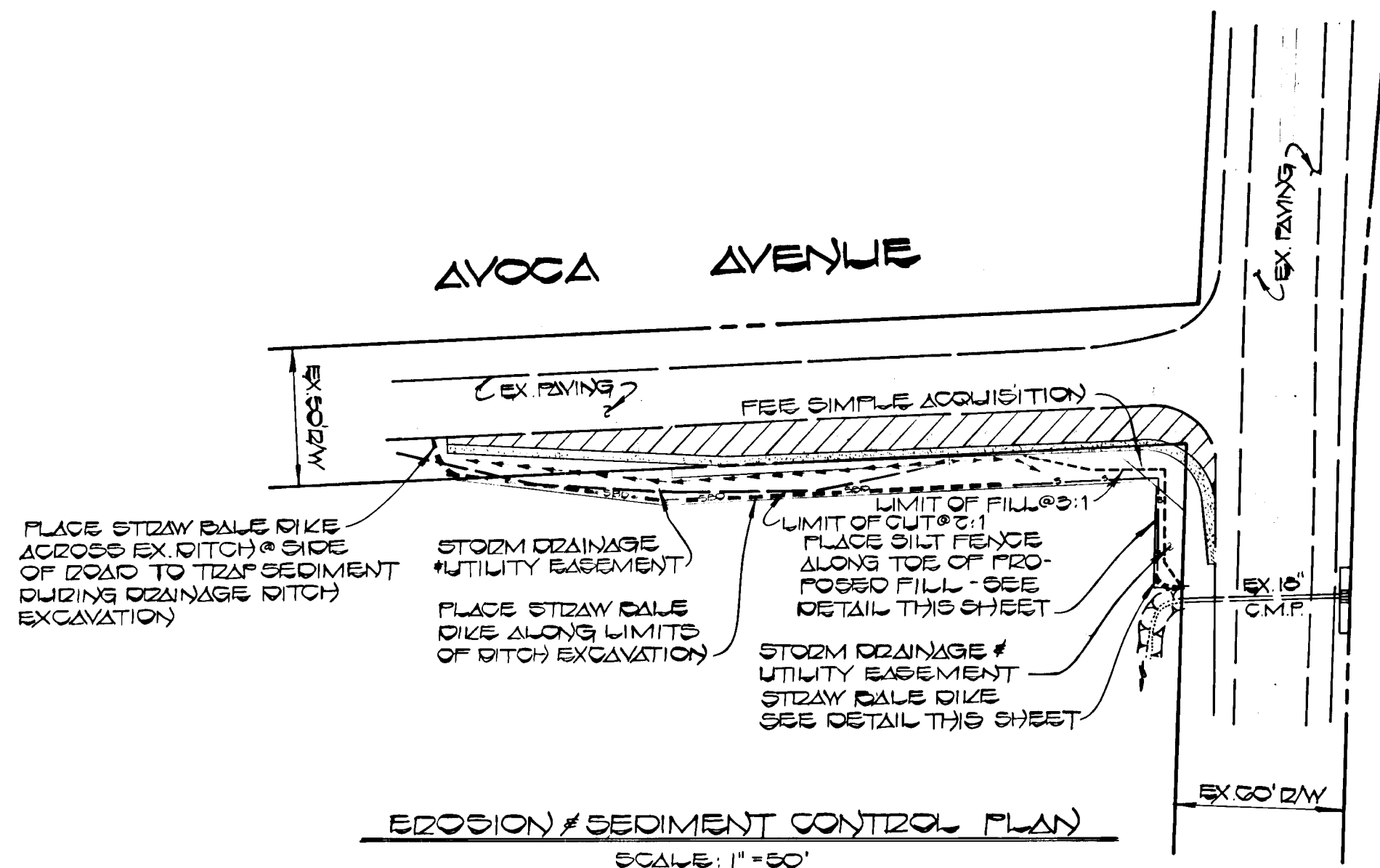

EROSION & SEDIMENT CONTROL PLAN
SCALE: 1" = 50'

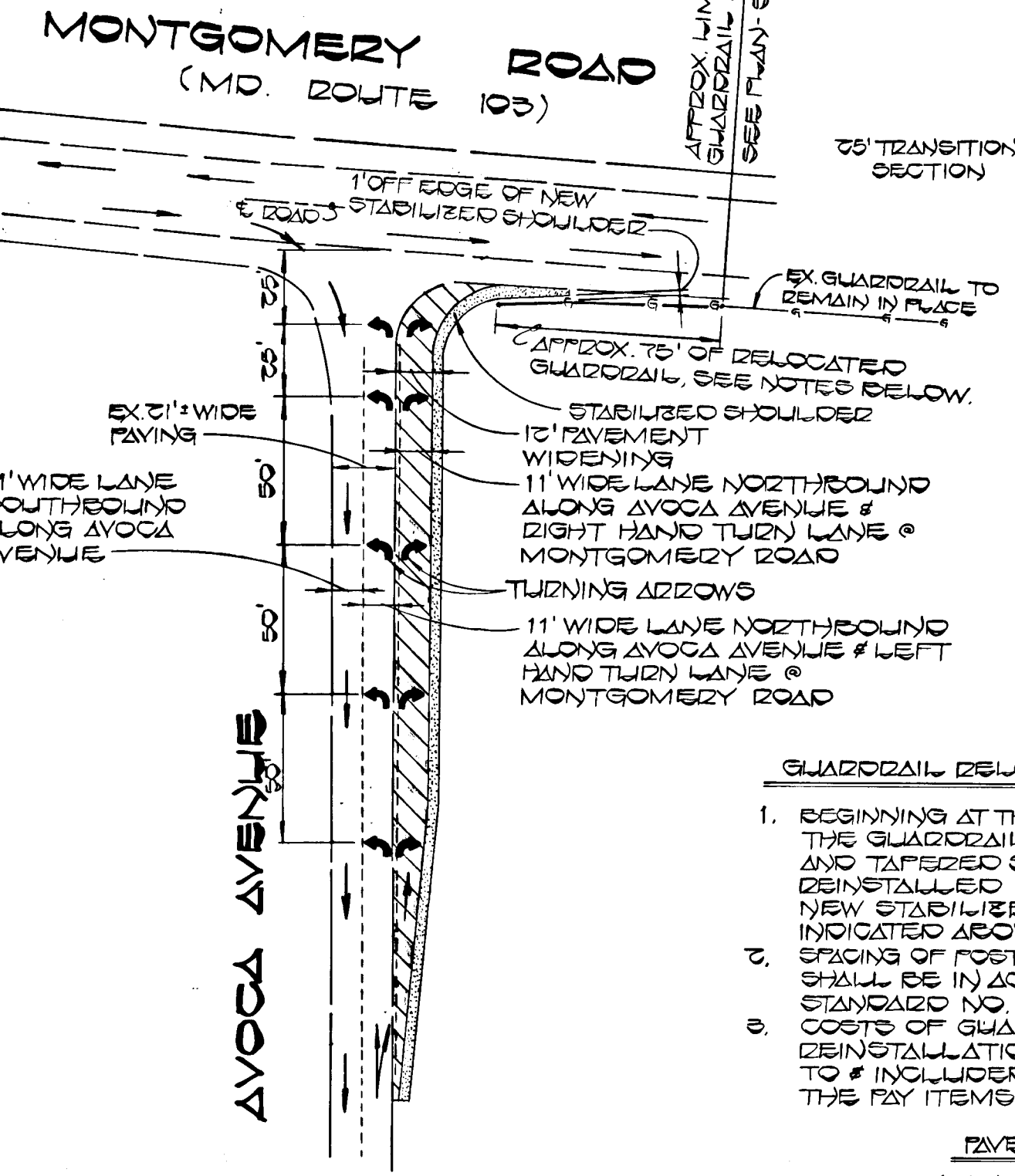
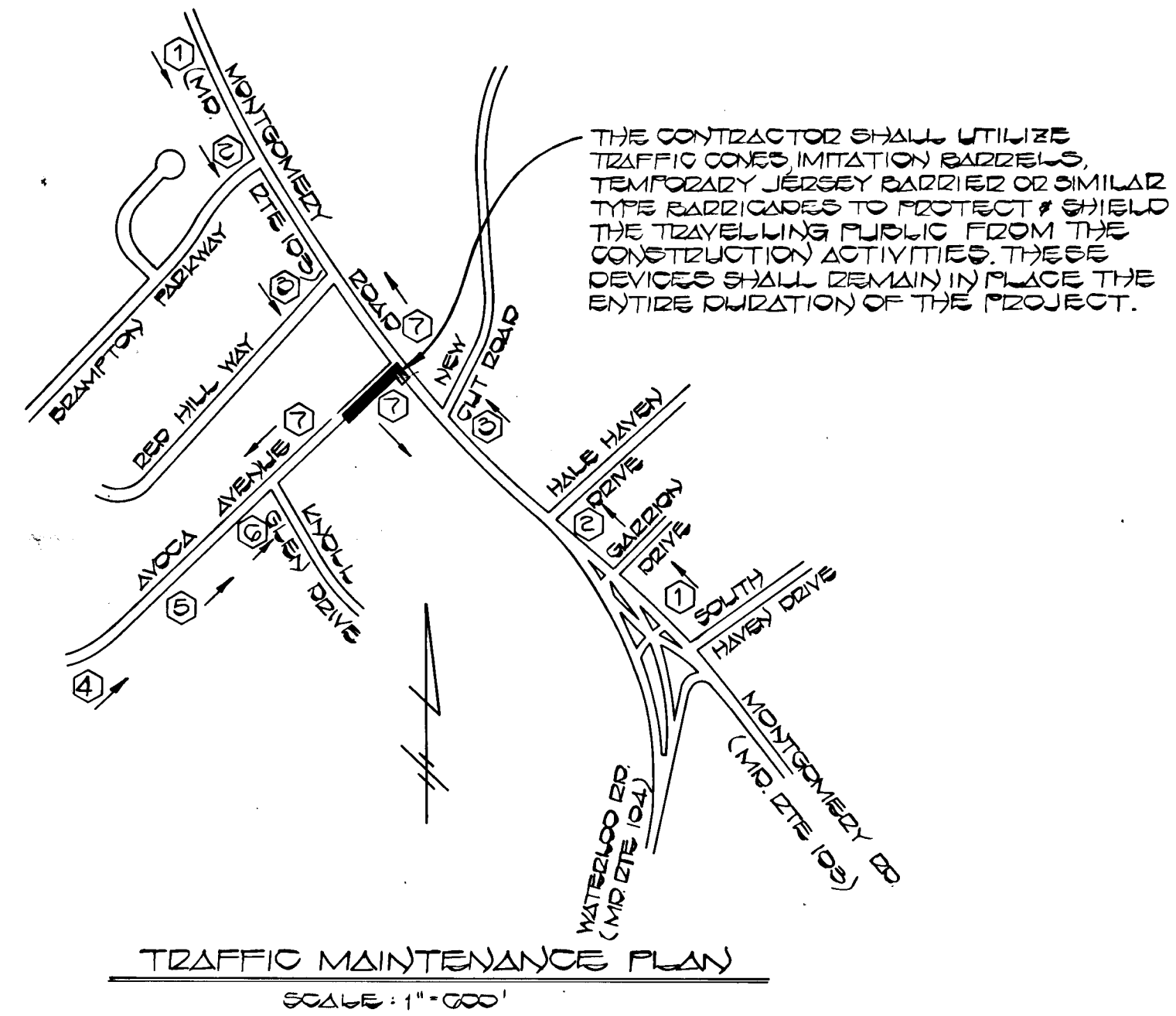
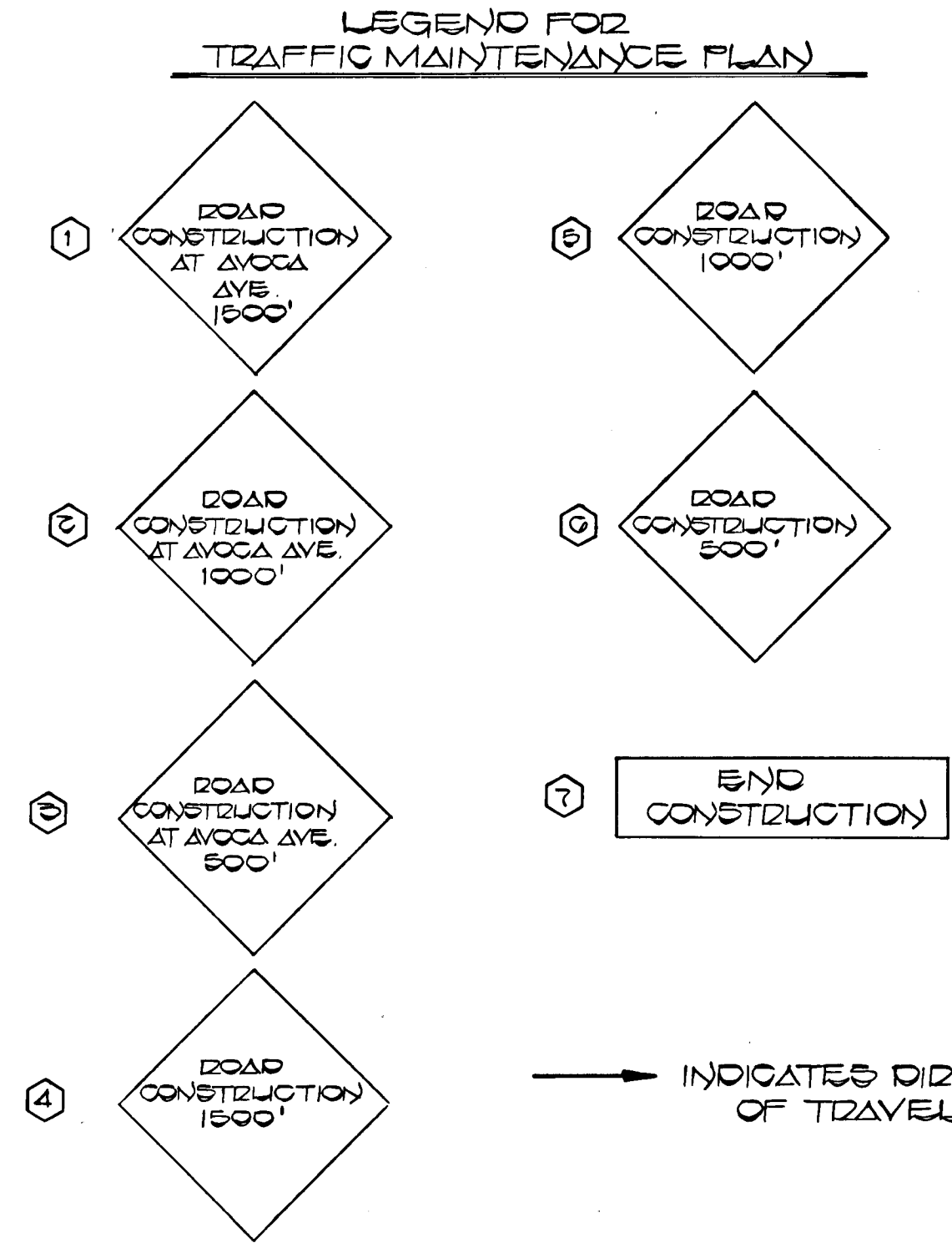

STRIPING AND PAVEMENT MARKING PLAN
GUARDRAIL RELOCATION PLAN

PAVEMENT MARKINGS & STRIPING NOTES

1. THE CONTRACTOR SHALL NOTIFY THE HOWARD COUNTY DIVISION OF TRAFFIC FORTY-EIGHT (48) HOURS PRIOR TO BEGINNING THE ACTUAL INSTALLATION OF PAVEMENT MARKINGS AND/OR STRIPING.
2. THE PROVISION OF PAVEMENT MARKINGS & STRIPING WILL NOT BE MEASURED OR PAID FOR SEPARATELY, BUT SHALL BE CONSIDERED INCIDENTAL TO THE CONTRACT WORK. ALL ASSOCIATED COSTS SHALL BE INCLUDED IN THE VARIOUS PAY ITEMS OF THE PROPOSAL.

DEPARTMENT OF PUBLIC WORKS HOWARD COUNTY, MARYLAND Director of Public Works: <i>Steve Nemy</i> DATE: 6/21/11 Chief, Bureau of Engineering: <i>Aracelis G. Carr</i> DATE: 6/25/11 Chief, Roads, Bridges & Storm Drainage Division: <i>Edward Anderson</i> DATE: 6/25/11	FISHER, COLLINS & CARTER CONSULTING ENGINEERS AND LAND SURVEYORS 8388 COURT AVENUE ELLICOTT CITY, MARYLAND 21043	DES:				ROADWAY IMPROVEMENTS AVOCA AVENUE AT MARYLAND ROUTE 103 CAPITAL PROJECT NO. T-7032 SECOND ELECTION DISTRICT HOWARD COUNTY, MARYLAND	SCALE AS SHOWN
		DRN:					SHEET 3 OF 3
		CHK:					
		DATE:					
		BY:					
		NO.:					
		REVISION:					
		DATE:					
		600' SCALE MAP NO. 31					
		BLOCK NO.:					

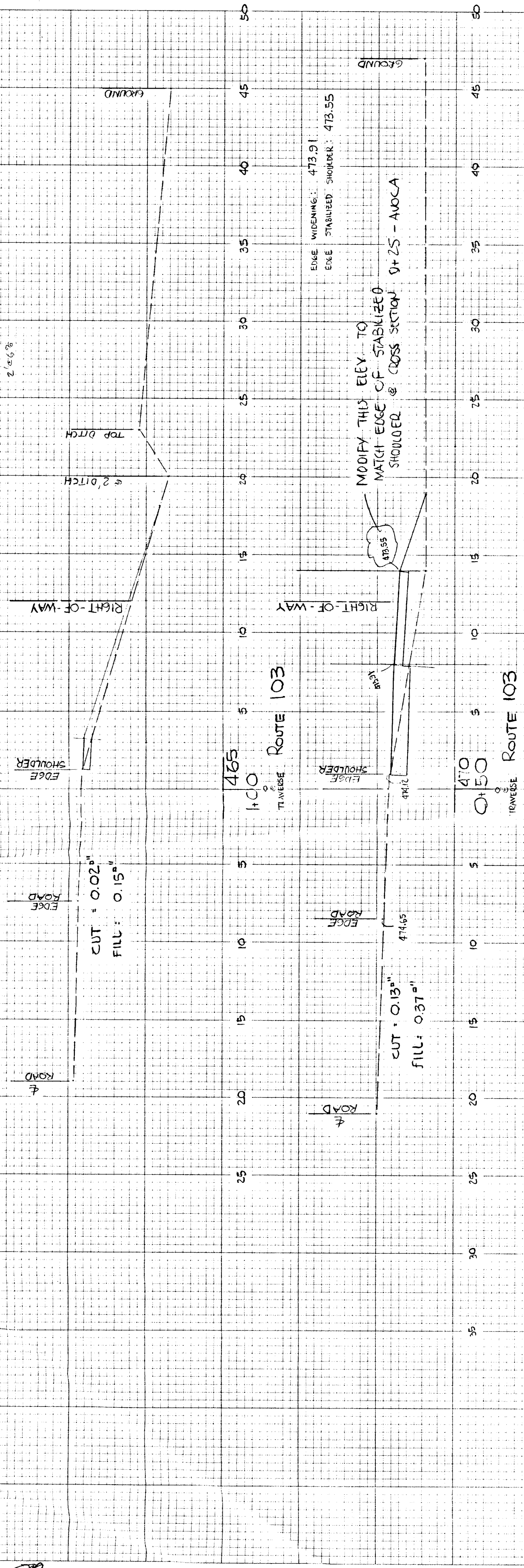

CROSS-SECTIONS: MONTGOMERY ROAD - MD ROUTE 103 FROM TRAVERSE

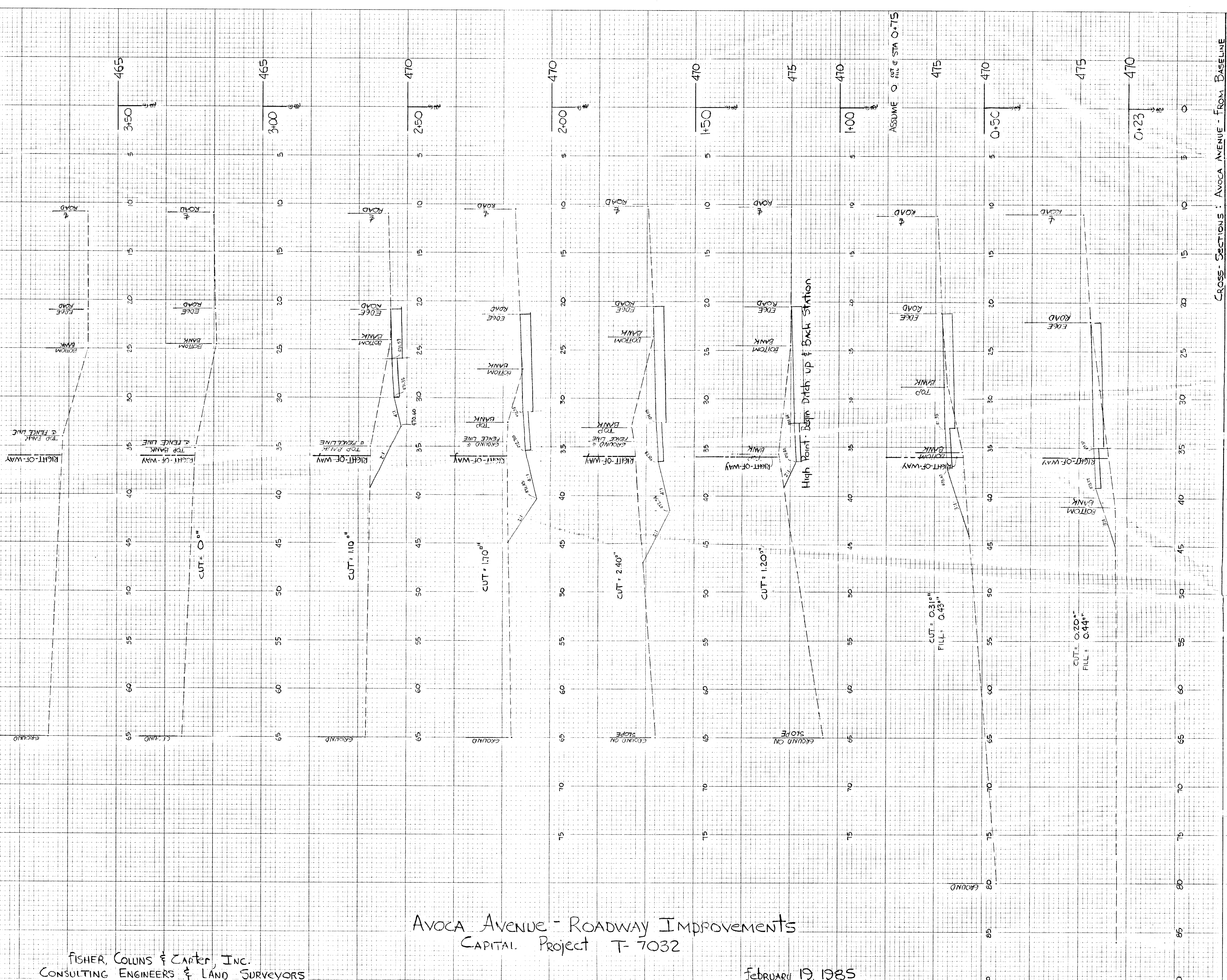

#1154

FISHER, COLLINS & ZAPFER, INC.
CONSULTING ENGINEERS & LAND SURVEYORS

AVOCA AVENUE - ROADWAY IMPROVEMENTS
CAPITAL PROJECT T-7032

FEBRUARY 19, 1985

XXAV-85-004