

ROAD PROFILE
 OF
 A. H. YOUNG DEVELOPMENT
 FIFTH ELECTORAL DISTRICT OF HOWARD COUNTY
 CHARLESVILLE, MARYLAND
 A. H. YOUNG, JR., DEVELOPER
 ROUTE 2
 MABLEAN, VIRGINIA
 C. M. SKINNER, JR., ENGINEER
 ELLICOTT CITY, MARYLAND
 JULY 24, 1988

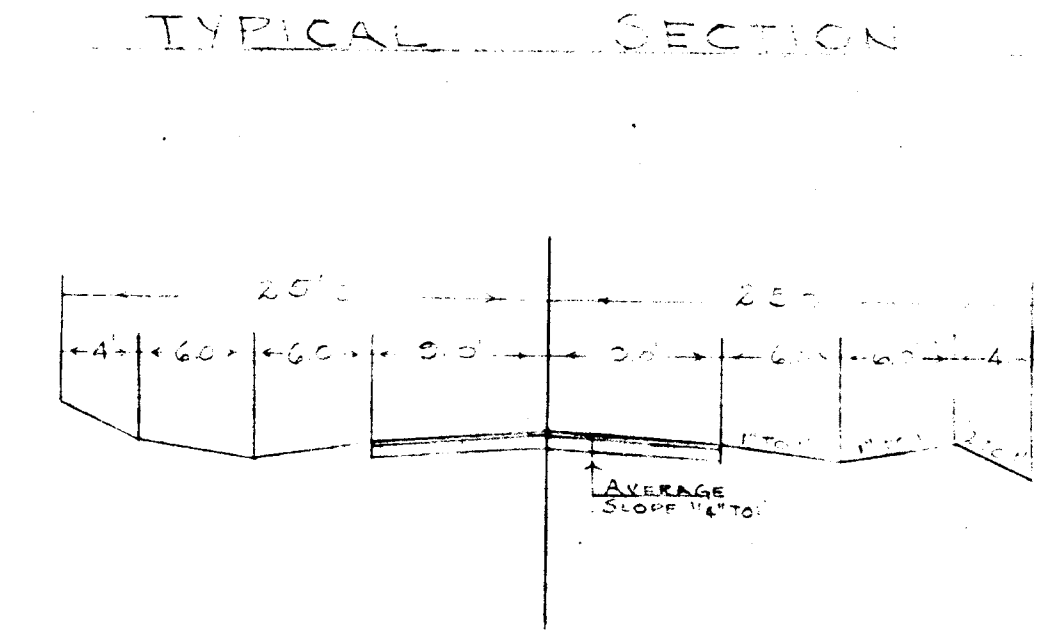
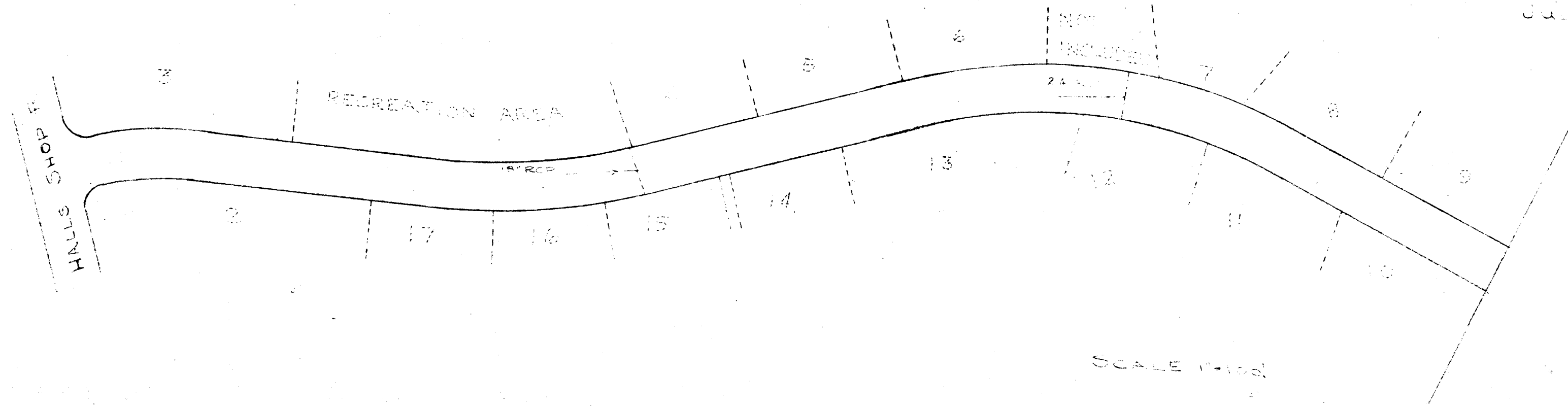

SCALE 1"=10'

NOTE -
 ROAD TO BE CONSTRUCTED
 TO HOWARD COUNTY ROAD DEPARTMENT
 ROAD SPECIFICATIONS

PROFILE SUBMITTED BY DATE
 PLOTTED BY
 CHECKED BY
 NOTE BOOK NO.
 STRUCTURE NOTATIONS (if any)

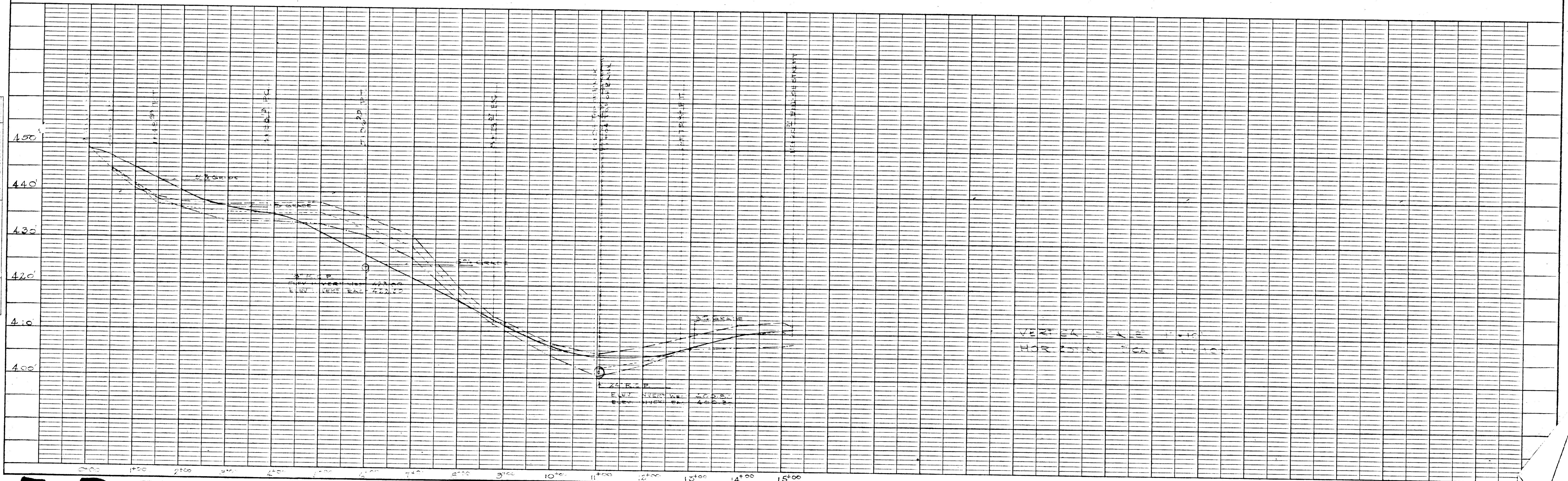

R-P-33-239

CROSS SECTIONS A. H. YOUNG SUBDIVISION

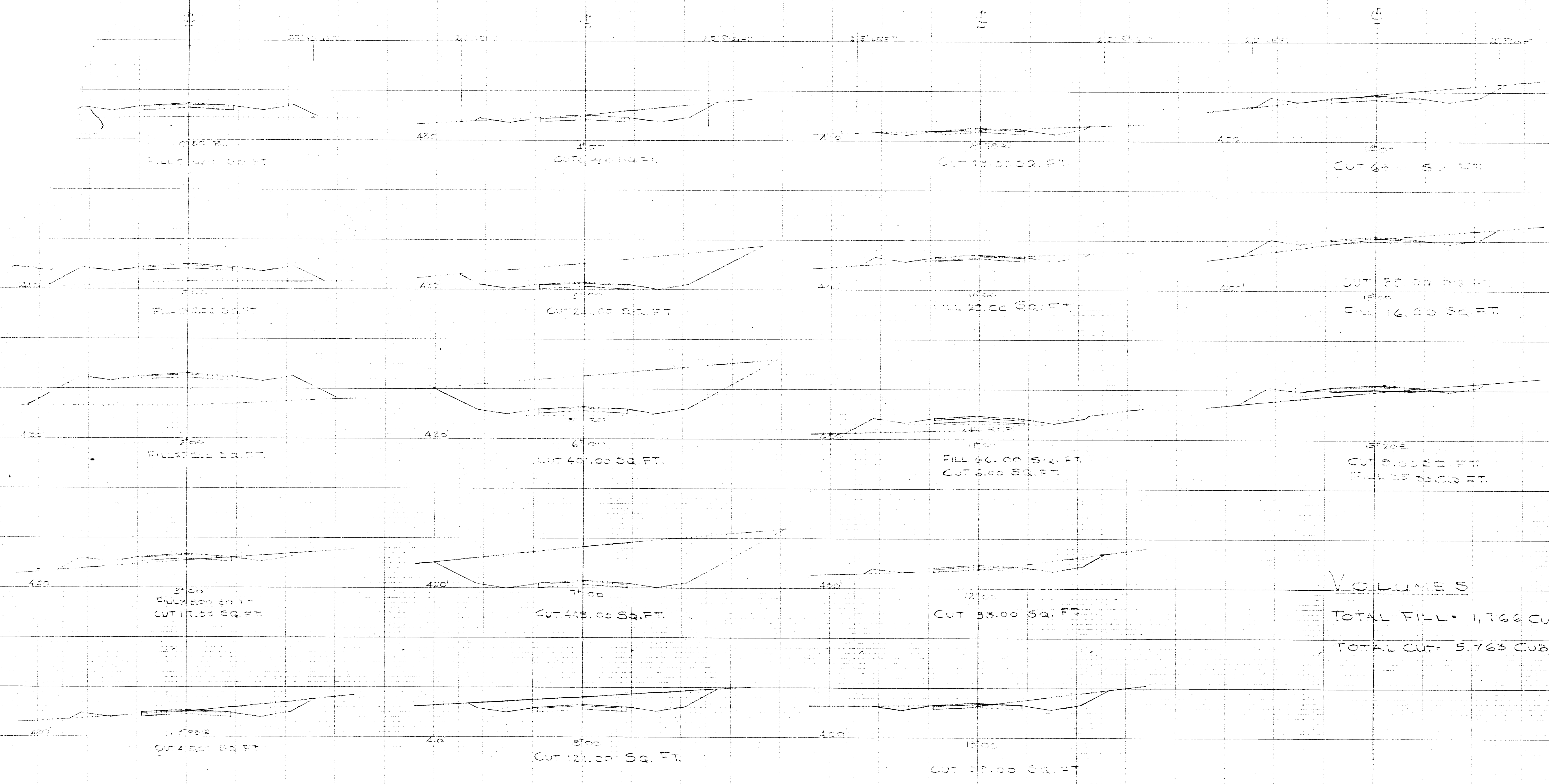

VOLUMES
 TOTAL FILL = 1,766 CUBIC YARDS
 TOTAL CUT = 5,765 CUBIC YARDS

SCALE = 1" = 10'