

Schatz House  
HO-871  
3935 Hunter Street, Ellicott City  
Howard County  
Ca. 1915  
Private

The Schatz House is a ca. 1915 1 1/2-story, 3-bay, wood frame, end gable cottage with a rectangular footprint that is in good, unaltered condition, which is located in the Patapsco View development off Old Columbia Pike southwest of the Ellicott City Historic District in Howard County, Maryland. The house is set on a small suburban lot that backs up to a wooded valley. While the development was platted in 1915, the houses were built over a long period of time and the neighborhood includes ca. 1915-ca. 2000 houses. The Schatz House appears to be first constructed in the neighborhood. The house is set on a CMU cellar. It retains its original wood German siding, original wood one-over-one double hung sash on the 1st and 2nd stories and three-light wood windows in the cellar. The house has wood doors (some original), and an asphalt roof.

The Schatz House, an intact ca. 1915 cottage, embodies the distinctive characteristics of early 20th c. suburban workers houses in Howard County, Maryland. Similar to modest cottages sold by Sears, Roebuck and Co., the house may have been ordered from a Sears competitor, such as Montgomery Ward or Aladdin. Likely constructed as rental housing, the house is a rare typology for the Ellicott City area. Few small early 20th century workers' houses remain in the area, where most of the worker's houses date from the 19th century and mid-20th century. The house, which is located in the Patapsco View development, platted in 1915, also attests to the lack of suburban development in the Ellicott City area in the early 20th century. Few houses were built in the subdivision until after World War II and remaining lots have been infilled in recent years.

# Maryland Historical Trust Maryland Inventory of Historic Properties Form

Inventory No. HO-871

## 1. Name of Property (indicate preferred name)

historic      Schatz House (preferred)  
 other      "Patapsco View" Development

## 2. Location

street and number   3935 Hunter Street          not for publication  
 city, town      Ellicott City          vicinity  
 county      Howard

## 3. Owner of Property (give names and mailing addresses of all owners)

name      Arlene Baublitz  
 street and number   3935 Hunter Street      telephone      410-361-8622  
 city, town      Ellicott City      state      MD      zip code      21043

## 4. Location of Legal Description

courthouse, registry of deeds, etc.      Howard County Land Record      liber   2312   folio   749  
 city, town      Columbia      tax map   25      tax parcel   89      tax ID number      02-281538

## 5. Primary Location of Additional Data

     Contributing Resource in National Register District  
     Contributing Resource in Local Historic District  
     Determined Eligible for the National Register/Maryland Register  
     Determined Ineligible for the National Register/Maryland Register  
     Recorded by HABS/HAER  
     Historic Structure Report or Research Report at MHT  
     Other: \_\_\_\_\_

## 6. Classification

Category	Ownership	Current Function	Resource Count	
<u>    </u> district	<u>    </u> public	<u>    </u> agriculture	Contributing	Noncontributing
<input checked="" type="checkbox"/> building(s)	<input checked="" type="checkbox"/> private	<u>    </u> landscape	<u> 1</u>	<u> 0</u> buildings
<u>    </u> structure	<u>    </u> both	<u>    </u> commerce/trade	<u> 0</u>	<u> 0</u> sites
<u>    </u> site		<u>    </u> defense	<u> 0</u>	<u> 0</u> structures
<u>    </u> object		<input checked="" type="checkbox"/> domestic	<u> 0</u>	<u> 0</u> objects
		<u>    </u> education	<u> 1</u>	<u> 0</u> Total
		<u>    </u> funerary		
		<u>    </u> government		
		<u>    </u> health care		
		<u>    </u> industry		
		<u>    </u> recreation/culture		
		<u>    </u> religion		
		<u>    </u> social		
		<u>    </u> transportation		
		<u>    </u> work in progress		
		<u>    </u> unknown		
		<u>    </u> vacant/not in use		
		<u>    </u> other:		
			<b>Number of Contributing Resources previously listed in the Inventory</b>	
			<u> 0</u>	

---

## 7. Description

Inventory No. HO-871

---

### Condition

excellent       deteriorated  
 good             ruins  
 fair               altered

---

Prepare both a one paragraph summary and a comprehensive description of the resource and its various elements as it exists today.

The Schatz House is a ca. 1915 wood-frame cottage located in the Patapsco View development off Old Columbia Pike southwest of the Ellicott City Historic District in Howard County, Maryland. The house is set on a small suburban lot that backs up to a wooded valley. While the development was platted in 1915, the houses were built over a long period of time and the neighborhood includes ca. 1915-ca. 2000 houses. The Schatz House appears to be first constructed in the neighborhood.

### House

#### *Exterior*

The Schatz House is a ca. 1915 1 1/2-story, 3-bay, wood frame, end gable cottage with a rectangular footprint that is in good, unaltered condition. The house is set on a CMU cellar. It retains its original wood German siding, original wood one-over-one double hung sash on the 1st and 2nd stories and three-light wood windows in the cellar. The house has wood doors (some original), and an asphalt roof.

The primary facade of the Schatz House faces northwest and fronts the side yard. The front porch is inset. The porch has a concrete deck and retains original square wood posts. The front door, a ca. 1940s paneled wood door with a fanlight, is centered in the front facade and is located under the porch. A double window opening, which lights the living room, is located west of the front door. A single window opening is located east of the front door, which lights a bedroom. The CMU cellar has a cellar door vertically aligned with the front door and cellar windows vertically aligned with the 1st story windows.

The southwest (side) 1st story elevation has a one-light over two-panel side (kitchen) door and a window opening that lights the living room. The 2nd story has one window opening that is centered in the gable end. A wood vent is set in the peak of the gable.

A square bay projects from the center of the southeast (rear) facade. A double 1st story window opening is located west of the bay, a window opening is centered in the bay, and a 1st story window opening is located east of the bay. Two cellar window openings are vertically aligned with eastern and western 1st story window openings.

The northeast (side) 1st story elevation has three window openings. The centered 1st story window, which lights the bathroom, has been partially infilled for a smaller window. The 2nd story has one window opening that is centered in the gable end. A wood vent is set in the peak of the gable. The cellar has a centered cellar door opening, which holds a four-light over two-panel wood door that is vertically aligned with bathroom and 2nd story window openings. The cellar door is flanked by two cellar window openings. The northern cellar window opening is vertically aligned with the 1st story window opening. The southern cellar window opening is offset to the north from the 1st story window opening.

#### *Interior*

The interior of the Schatz House is remarkably intact. The 1st floor plan has six rooms and a passage, including living room, kitchen, breakfast nook, dining room, bathroom, and bedroom. The front door opens into the living room. The salvaged stair, which has a ca. 1860s Italianate newel post, handrail, and balusters, is located in the living room.<sup>1</sup> A fireplace is located in the living room and a massive fireplace/ stove chimney is located between the living room and kitchen.<sup>2</sup> A bedroom opens off the living room and is the other front room. The kitchen, breakfast nook, and dining room are arrayed across the back of the house. The breakfast nook is located in the square bay and the cellar stair opens off the dining nook. A short passage is located behind the stair and leads to the dining room and bathroom, which is located between the dining room and bedroom. The 2nd floor has two bedrooms and a passage. The interior retains its original wood floors, plaster walls, four panel wood doors, wood trim, and kitchen cabinets and sink. The current owner recently rehabbed the bathroom and installed new fixtures and finishes and decreased the size of the window to install a shower.

---

<sup>1</sup> The current owner heard that the stair was taken from a family home in Port Deposit Maryland. The original owner, Frederick Schatz did not have family in Cecil County. The second owners were the Houses, and they may have rented the house from early days. There were Houses in Cecil County, who were carpenters and cabinet makers.

<sup>2</sup> The fireplace mantel does not appear to be original.

## 8. Significance

Inventory No. *HO-871*

Period	Areas of Significance	Check and justify below		
<input type="checkbox"/> 1600-1699	<input type="checkbox"/> agriculture	<input type="checkbox"/> economics	<input type="checkbox"/> health/medicine	<input type="checkbox"/> performing arts
<input type="checkbox"/> 1700-1799	<input type="checkbox"/> archeology	<input type="checkbox"/> education	<input type="checkbox"/> industry	<input type="checkbox"/> philosophy
<input type="checkbox"/> 1800-1899	<input checked="" type="checkbox"/> architecture	<input type="checkbox"/> engineering	<input type="checkbox"/> invention	<input type="checkbox"/> politics/government
<input checked="" type="checkbox"/> 1900-1999	<input type="checkbox"/> art	<input type="checkbox"/> entertainment/ recreation	<input type="checkbox"/> landscape architecture	<input type="checkbox"/> religion
<input type="checkbox"/> 2000-	<input type="checkbox"/> commerce	<input type="checkbox"/> ethnic heritage	<input type="checkbox"/> law	<input type="checkbox"/> science
	<input type="checkbox"/> communications	<input type="checkbox"/> exploration/ settlement	<input type="checkbox"/> literature	<input checked="" type="checkbox"/> social history
	<input type="checkbox"/> community planning		<input type="checkbox"/> maritime history	<input type="checkbox"/> transportation
	<input type="checkbox"/> conservation		<input type="checkbox"/> military	<input type="checkbox"/> other: _____

**Specific dates** ca. 1915 **Architect/Builder** unknown

**Construction dates** ca. 1915

Evaluation for:

National Register  Maryland Register  not evaluated

Prepare a one-paragraph summary statement of significance addressing applicable criteria, followed by a narrative discussion of the history of the resource and its context. (For compliance projects, complete evaluation on a DOE Form – see manual.)

The Schatz House, an intact ca. 1915 cottage, embodies the distinctive characteristics of early 20th c. suburban workers houses in Howard County, Maryland. Similar to modest cottages sold by Sears, Roebuck and Co., the house may have been ordered from a Sears competitor, such as Montgomery Ward or Aladdin. Likely constructed as rental housing, the house is a rare typology for the Ellicott City area. Few small early 20th century worker's houses remain in the area, where most of the worker's houses date from the 19th century and mid-20th century. The house, which is located in the Patapsco View development, platted in 1915, also attests to the lack of suburban development in the Ellicott City area in the early 20th century. Few houses were built in the subdivision until after World War II and remaining lots have been infilled in recent years.

### Owners and occupants

Only three families owned the house prior to the current owner and one family may have been long-standing tenants prior to purchasing the house. In 1915, the Thrift Land Co, Inc, sold lots 16, 18, 20, 24, 26, 28, and 30 of the newly platted Patapsco View subdivision to Frederick Schatz. These lots comprised the land on the north side of Hunter Street, except for lots 1, 2, and 3, which front Old Columbia Pike. Frederick Schatz moved to Howard County from Baltimore City between 1900 and 1910. In 1900, he and his family lived in Baltimore City, where he worked as a plasterer.<sup>3</sup> By 1910, they owned a house on Columbia Road in Clarksville and were farming.<sup>4</sup> In 1920 and 1930, they remained at that location.<sup>5</sup> Since the Frederick Schatz did not live at 3935 Hunter Street, he probably built it as an investment property.

In 1931, Frederick Schatz lost the property in a court case between him and William R. Dorsey (the William R. Dorsey House is located at 3920 College Avenue, HO-582). The property sold for \$120 at auction to Andrew, John, and Anna Kraft, who were partners in the Kraft Brothers meat market in Ellicott City. The Krafts were wealthy butchers who invested in real estate throughout the county. They lived next door to the Schatz House on Old Columbia Pike (3871 Old Columbia Pike, now Slack Funeral Home) and did their butchering in the back section of that property right behind 3935 Hunter Street.

The descendents of Andrew, John, and Anna Kraft sold the property to Henry B. House in 1948 after the last of the siblings died in 1946. Henry House, Sr., a well-digger, moved to Columbia Road (now Old Columbia Pike) from Laurel, Maryland between 1900 and 1910.<sup>6</sup> In 1910, Henry House lived with his second wife Ida, his four children from his first marriage, Ellsworth (aged 16) - who helped his father, Harry (aged 15) - who helped his father, Norman (aged 13), Carroll (aged 11), three children from her first marriage, Elizabeth Delosier (aged 10), Charles Delosier (aged 8), and Olga Delosier (aged 5), their son Henry, Jr. (aged 3 months), his mother

<sup>3</sup> Department of Commerce – Bureau of the Census, **Twelfth Census of United States: 1900, Population Schedule**, E. D. 22, Sheet 17A

<sup>4</sup> Department of Commerce – Bureau of the Census, **Thirteenth Census of United States: 1910, Population Schedule**, E. D. 57, Sheet 10B

<sup>5</sup> Department of Commerce – Bureau of the Census, **Fourteenth Census of United States: 1920, Population Schedule**, E.D. 64, Sheet 2B.

<sup>6</sup> Department of Commerce – Bureau of the Census, **Twelfth Census of United States: 1900, Population Schedule**, E. D. 102, Sheet 4B.

# Maryland Historical Trust Maryland Inventory of Historic Properties Form

Inventory No. HO-871

Name  
**Continuation Sheet**

Number 8 Page 1

---

Sarah (aged 64) - who was a private nurse, and his brother Lemuel (aged 20) - who was an odd jobs laborer.<sup>7</sup> By 1930, the household was a more manageable Henry Sr. (aged 65) - who was by then working as a building contractor, Ida (aged 53), son Henry, Jr. (aged 20) - a machinist in a mill, and daughter Sarah (aged 18), a stenographer in an office. They rented a house for \$18 a month.<sup>8</sup>

After purchasing the house in 1948, Henry B. House, unmarried, immediately executed a deed transfer that made him joint tenant with Carroll House. This would likely be Henry House, Jr. and his brother. In 1976, Carroll House deeded the house to Isabelle Spioch, Trustee for the use of and benefit of her daughter Sandy Spioch. The nature of that deed leads me to believe that Isabelle Spioch was somehow related to the Houses. In 1991 Isabelle Spioch and Sandy J. Rockenbaugh (nee Spioch) sold the house to the current owner, Arlene Baublitz.

---

<sup>7</sup> Department of Commerce – Bureau of the Census, **Thirteenth Census of United States: 1910, Population Schedule**, E.D. 51, Sheet 4A.

<sup>8</sup> Department of Commerce – Bureau of the Census, **Fifteenth Census of United States: 1930, Population Schedule**, E.D. 14-3, Sheet 2A.

---

## 9. Major Bibliographical References

Inventory No. HO-871

Department of Commerce – Bureau of the Census. **Census of United States: Population Schedule, 1900, 1910, 1920, 1930.**

Howard County Land Records, Dorsey Building, Columbia. See attached chain of title for specific libers and folios.

Sears, Roebuck and Company. **Small Houses of the Twenties: The Sears, Roebuck 1926 House Catalog.** Mineola, New York: Dover Publications, 1991.

Stevenson, Katherine Cole and H. Ward Jandl. **Houses by Mail: A Guide to Houses from Sears, Roebuck and Company.** New York: John Wiley & Sons, 1995.

---

## 10. Geographical Data

Acreege of surveyed property 8,450 square feet

Acreege of historical setting 8,450 square feet

Quadrangle name Ellicott City

Quadrangle scale: 1:24,000

---

### Verbal boundary description and justification

The boundary of the Schatz House corresponds to Howard County Map 25, Grid 13, Parcel 89, which is the building's current legal lot.

---

## 11. Form Prepared by

name/title	Jennifer Goold, Historic Sites Surveyor		
organization	Howard County Department of Planning & Zoning	date	February 3, 2005
street & number	3430 Courthouse Drive	telephone	410-313-4335
city or town	Ellicott City	state	MD

The Maryland Inventory of Historic Properties was officially created by an Act of the Maryland Legislature to be found in the Annotated Code of Maryland, Article 41, Section 181 KA, 1974 supplement.

The survey and inventory are being prepared for information and record purposes only and do not constitute any infringement of individual property rights.

return to: Maryland Historical Trust  
DHCD/DHCP  
100 Community Place  
Crownsville, MD 21032-2023  
410-514-7600

HO-871  
 Schatz House  
 3935 Hunter Street, Ellicott City  
 Howard County

CHAIN OF TITLE

GRANTOR	GRANTEE	DATE	LIBER	FOLIO	TRANS.	PRICE	ACREAGE	COMMENTS
Isabelle J. Spioch and Sandy J. Rockenbaugh (Howard County)	Arlene Baublitz	03-28-1991	2312	749	Deed	135,000	8450 Square Feet	Lots 28 and 30 of Patapsco View (June 7, 1915), Liber 99, folio 424
Isabelle J. Spioch	Isabelle J. Spioch and Sandy J. Rockenbaugh	04-08-1982	1099	190	Deed	0.00	"	"; 1. Deed dated March 9, 1982 from Paul B. Lohinski, Substitute Gaurdian of Noretta A. House, and Sarah H. Graber, Substitute Trustee for Noretta A. House and Sarah H. Graber, Personal Representative of the Estate of Carroll M. House, to Isabelle J. Spioch, and 2. Quit-Claim Deed dated April 7th, 1982, from Sandy J. Rockenbaugh (formerly known as Sandy Spioch) Beneficiary, to Isabelle J. Spioch
Sandy J. Rockenbaugh, previously known as Sandy Spioch, beneficiary under Trust Deed	Isabelle J. Spioch	04-07-1982	1099	188	Deed	0.00	"	Lots 28 and 30 of Patapsco View (June 7, 1915), Liber 99, folio 424
Carroll M. House	Isabelle J. Spioch, Trustee, for the use and benefit of her daughter Sandy Spioch	03-17-1976	760	82	Deed of Trust		8450 Square Feet	Lots 28 and 30 of Patapsco View (June 7, 1915), Liber 99, folio 424; the purpose of the trust being to provide the beneficiary a home during her mother's lifetime.
Noretta A. House, (formerly of Ellicott City)	Carroll M. House (Ellicott City)	03-04-1974	681	657	Power of Attorney			
Shirley Schaefer (Ellicott City)	Carroll M. House and his sister Noretta A. House	03-02-1974	674	146	Deed			Lots 1, 2, 3, 10, 11, 12, 16, 18, 20, 22, 24, 26, 28, 30 of Patapsco View and three additional parcels.

HO-871  
 Schatz House  
 3935 Hunter Street, Ellicott City  
 Howard County

CHAIN OF TITLE

Carroll M. House	Shirley Schaefer	03-02&04-1974	674	148	Deed			In trust and confidence to reconvey to Carroll M. House and his sister Noretta A. House; Lots 1, 2, 3, 10, 11, 12, 16, 18, 20, 22, 24, 26, 28, 30 of Patapsco View and three additional parcels.
Guinevere M. Warfield, unmarried	Henry B. House, Trustee	11-19-1948	210	145	Deed	5.00		1/3 interest in Lots 16, 18, 20, 22, 24, 26, 28, 30 of Patapsco View
Guinevere M Warfield, unmarried	Henry B. House and Carroll M. House	11-19-1948	210	144	Deed	5.00		2/3 interest in Lots 16, 18, 20, 22, 24, 26, 28, 30 of Patapsco View
Henry B. House, unmarried	Guinevere M. Warfield	11-19-1948	210	143	Deed	5.00		Lots 16, 18, 20, 22, 24, 26, 28, 30 of Patapsco View
Clara K Kraft, widow	Henry B. House	08-10-1948	210	140	Deed	1.00		Lots 16, 18, 20, 22, 24, 26, 28, 30 of Patapsco View; Clara K. Kraft is the owner of the adjoining property known as the "Kraft Home Property" that she acquired a one-half interest from through the will of Andrew H. Kraft, and a one-half interest from John F. Kraft and others Henry B. House committed not to construct or maintain more than four houses on the property



HO-871  
 Schatz House  
 3935 Hunter Street, Ellicott City  
 Howard County

CHAIN OF TITLE

<p>Clara K. Kraft and William E. Kraft, administrators, d.b.n.c.t.a., et al.</p>	<p>Henry B. House</p>	<p>08-10-1948</p>	<p>210</p>	<p>137</p>	<p>Deed</p>	<p>800.00</p>		<p>1) Grantors were Clara K. Kraft and William E. Kraft administrators of the estate of Andrew H. Kraft party of the 1st part and John F. Kraft and Ida B. Kraft, his wife, Mary Louise Boone and Lewis W. T. Boone, her husband parties of the 2nd part.          2) Andrew Kraft died on or about January 8th, 1946, seised of a 1/3 interest in the property.          3) Andrew Kraft gave his Executors the right to sell his estate.          4) \$266.66 went to Clara and William Kraft, \$266.66 went to John Kraft, and \$266.66 went to Mary Louise Boone          5) Anna Kraft died September 13, 1932 and left her 1/3 interest to her husband Andrew H. Kraft for the term of his natural life and after his death to her brother-in-law, John H. Kraft.          6) John H. Kraft died on May 22, 1943 and left his own 1/3 interest and the 1/3 interest he was to gain from Anna L. Kraft to his son John F. Kraft and Mary Louise Boone.</p>
<p>George D. Day, Jr., Sheriff</p>	<p>Andrew H. Kraft, John H. Kraft, and Anna L. Kraft, Partners, trading a Kraft Brothers</p>	<p>12-29-1931</p>	<p>142</p>	<p>501</p>	<p>Deed</p>	<p>120.00</p>		<p>Lots 16, 18, 20, 22, 24, 26, 28, 30 of Patapsco View; sold in case William R. Dorsey against Frederick Schatz</p>

HO-871  
Schatz House  
3935 Hunter Street, Ellicott City  
Howard County

CHAIN OF TITLE

Thrift Land Co. Inc, and Trustees	Frederick Schatz	11-23- 1915	100	351	Deed	600.00	Lots 16, 18, 20, 22, 24, 26, 28, 30, 40 of Patapsco View Fifty years covenant: "Negroes and Chinese shall not be permitted to own or reside on the property hereby conveyed, except in the capacity of family servants; No manufacturing plant of any kind, no slaughtering of animals, no public laundries or saloons shall be permitted; no improvements shall be constructed on this property to cost less than \$1500.00, exclusive of foundations and outbuildings, and foundations shall not be built closer than twenty feet to the line of the street, on lot no. forty the improvements exclusive of foundations and outbuildings shall not cost less than \$2000.
--------------------------------------	------------------	----------------	-----	-----	------	--------	---



HD-871  
 SCHATZ House CA 1915  
 1" = 3/16" J. GOULD 01/05





Schatz House (HO-871)  
3935 Hunter Street, Ellicott City  
Howard County  
*Site Plan/Aerial Photo*

Schatz House (HO-871)  
3935 Hunter Street, Ellicott City  
Howard County  
Plat

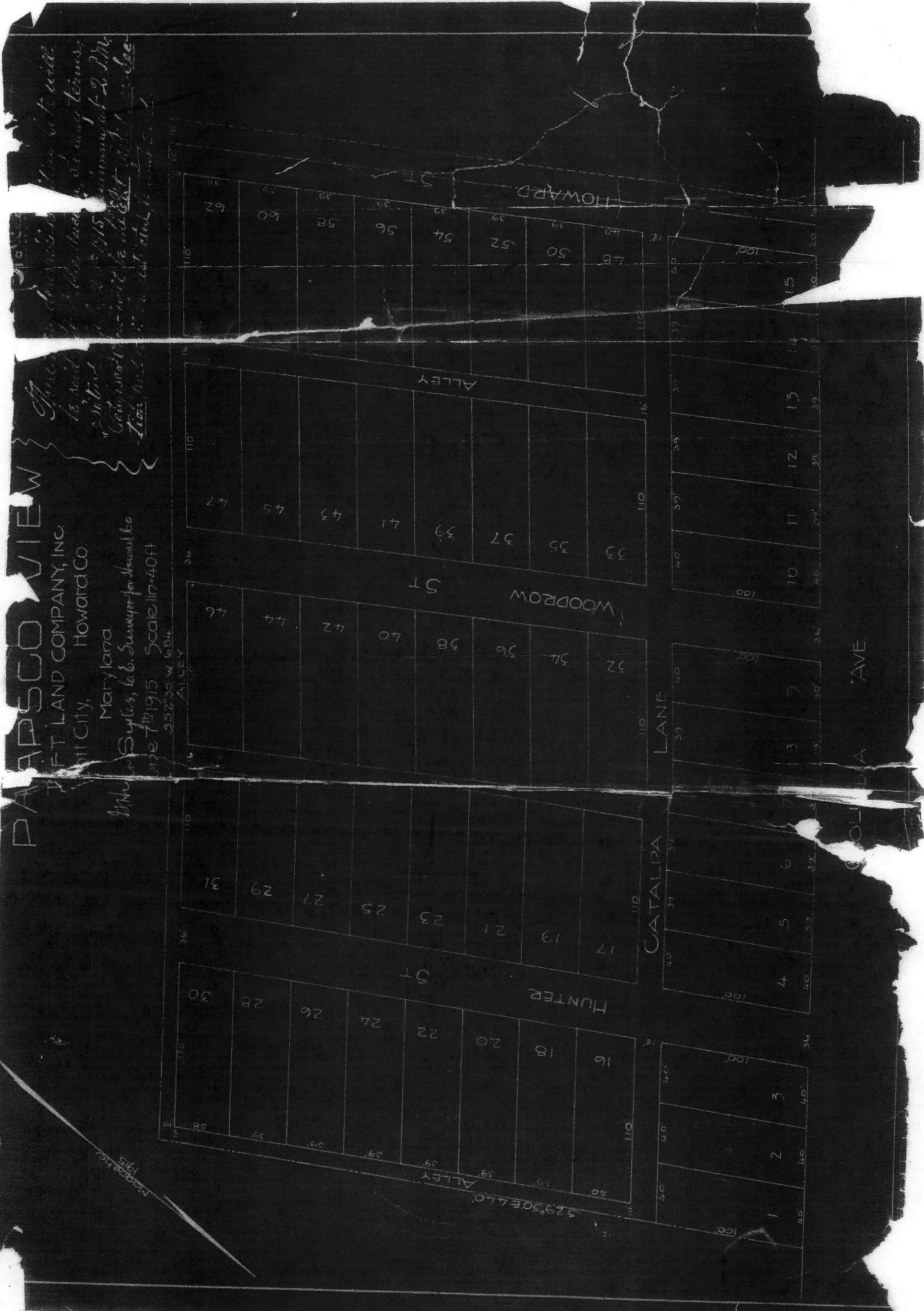

# PAPSCO VIEW

FT LAND COMPANY, INC.  
Ellicott City, Howard Co.  
Maryland  
Sylvia, G.C. Surveyor for Howard Co.  
Date 7/17/1915 Scale 1/16" = 40ft  
35235 W 684

*Handwritten notes:*  
"Submitted to the Board of Commissioners on 7/17/1915..."  
"City will be in charge of the plat..."  
"See..."

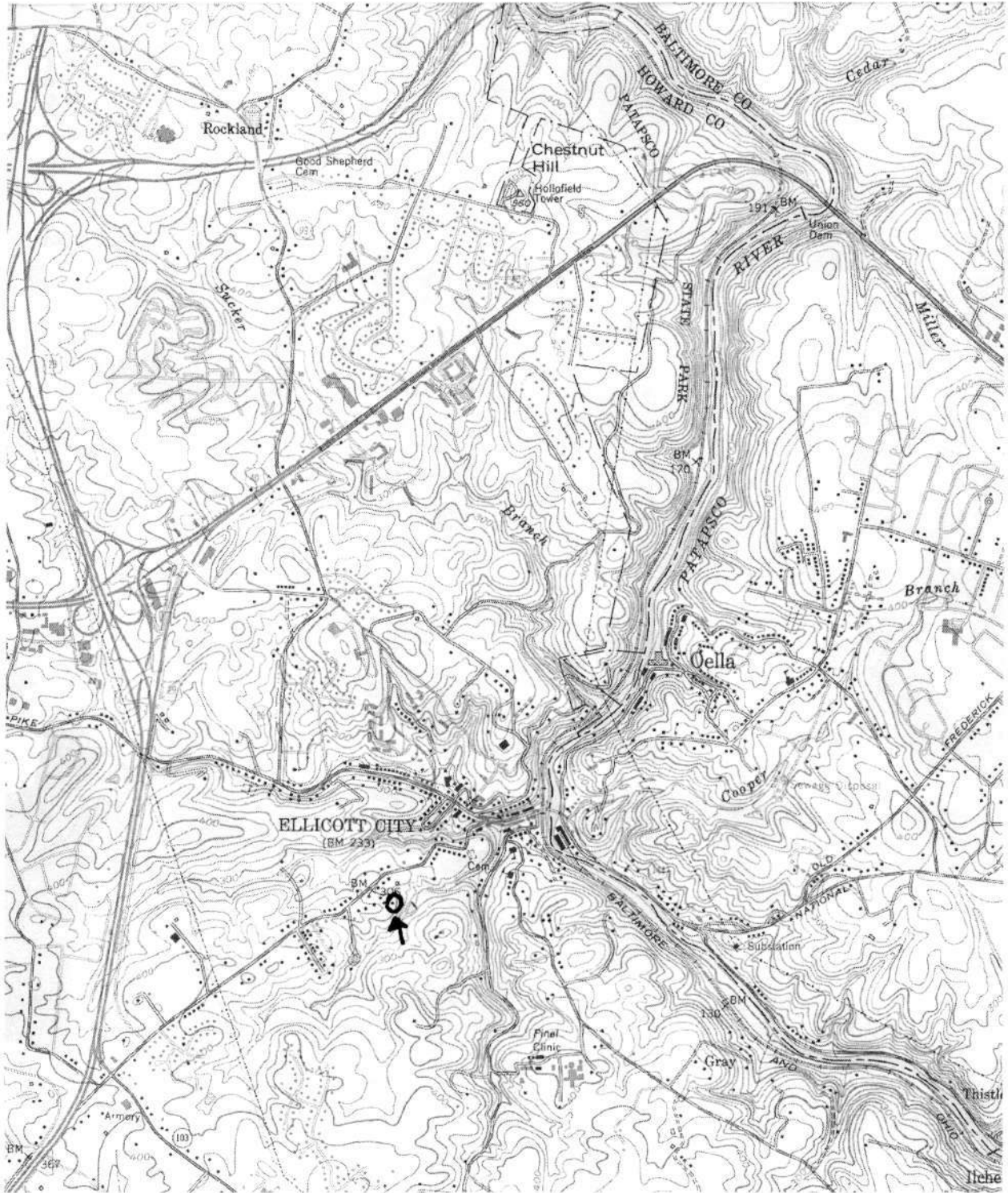

Schatz House (HO-871)  
3935 Hunter Street  
Ellicott City, Howard County  
USGS Ellicott City Quad



HO-871

Schatz House

Howard County, MD

Jennifer Goold

01/05

MDSHPD

View E. Shows front & side elevations.

1063

ART-2611 <NO. 35 >014  
969 1212 -1 N N 1- 32 (044)©





HO-871

Schatz House

Howard County, MD

Jennifer Gould

01/05

MD SAPO

ART-2611 <NO. 36 >815  
969 1212 -1 N N-5 22 <044>@

View NE. Shows reused Italianate stair,

2 of 3

Kodak



HO-871

Schatz House

Howard County, MD

Jennifer Gould

1/05

MD SHPO

View SE shows original kitchen.

3063

FRT-2611 <NO. 1 >001  
883 1212 - 1 N N-5 32 (044) ©