

HO-844
Charles and Margaret Kirn House
10114 Frederick Road
Ellicott City vicinity
Howard County, Maryland
Private
c. 1911

Description:

The Charles and Margaret Kirn House is located on the north side of the road, just west of Centennial Lane. The property contains a frame foursquare house with a small frame outbuilding behind it, and the house faces southwest toward the road. The house is a 2 1/2-story, two-bay by three-bay frame structure with a rubble stone foundation, vinyl siding over weatherboards on the first story and over wood shingles on the second story, and a hipped roof with asphalt shingles. The interior has a four-room plan with the entrance stair hall in the south corner and rooms in the west, north, and east corners. The south room has a stair on the southeast wall that has three runs. The second story has the same plan as the first story. There is a shed located about 5 feet northeast of the addition to the house. It is a one-story, one-bay structure with German siding and a gable roof with flat metal and a southwest-northeast ridge. The interior of the building has exposed 2 by 4 studs.

Significance:

Charles A. Gerwig owned and operated a general merchandise store and post office at Pine Orchard, on the south side of Frederick Road, for over 40 years in the late-nineteenth and early-twentieth centuries. His daughter, Margaret, married Charles R. Kirn, probably in the early twentieth century. In 1911 Gerwig sold a small parcel of land on the north side of Frederick Road to his daughter and son-in-law, and the following year Kirn was assessed for a new house valued at \$1,350. This is the house that stands on the lot, and must have been built by Kirn and his laborers himself, since he was a "prominent builder and contractor." He had worked for his father's firm, Jacob Kirn & Sons, who had started out in Catonsville and later moved to Howard County. Charles Kirn died in 1925, at age 41. Margaret Gerwig Kirn continued to own the house, and presumably lived here, until her death in 1960.

Maryland Historical Trust

Maryland Inventory of Historic Properties Form

Inventory No. HO-844

1. Name of Property (indicate preferred name)

historic Charles & Margaret Kirn House

other _____

2. Location

street and number 10114 Frederick Road _____ not for publication

city, town Ellicott City X vicinity

county Howard

3. Owner of Property (give names and mailing addresses of all owners)

name JDB/TSC Route 40 LLC

street and number 7120 Minstrel Way Ste 208 telephone 443-535-9200

city, town Columbia state MD zip code 21048-0630

4. Location of Legal Description

courthouse, registry of deeds, etc. Howard County Courthouse tax map and parcel: 24-61

city, town Ellicott City liber 9275 folio 348

5. Primary Location of Additional Data

- Contributing Resource in National Register District
- Contributing Resource in Local Historic District
- Determined Eligible for the National Register/Maryland Register
- Determined Ineligible for the National Register/Maryland Register
- Recorded by HABS/HAER
- Historic Structure Report or Research Report
- Other _____

6. Classification

Category	Ownership	Current Function	Resource Count	
			Contributing	Noncontributing
<input type="checkbox"/> district	<input type="checkbox"/> public	<input type="checkbox"/> agriculture		
<input checked="" type="checkbox"/> building(s)	<input checked="" type="checkbox"/> private	<input type="checkbox"/> commerce/trade	<u>2</u>	<u>0</u> buildings
<input type="checkbox"/> structure	<input type="checkbox"/> both	<input type="checkbox"/> defense	<u>0</u>	<u>0</u> sites
<input type="checkbox"/> site		<input type="checkbox"/> domestic	<u>0</u>	<u>0</u> structures
<input type="checkbox"/> object		<input type="checkbox"/> education	<u>0</u>	<u>0</u> objects
		<input type="checkbox"/> funerary	<u>2</u>	<u>0</u> Total
		<input type="checkbox"/> government		
		<input type="checkbox"/> health care		
		<input type="checkbox"/> industry		
		<input type="checkbox"/> landscape		
		<input type="checkbox"/> recreation/culture		
		<input type="checkbox"/> religion		
		<input type="checkbox"/> social		
		<input type="checkbox"/> transportation		
		<input type="checkbox"/> work in progress		
		<input type="checkbox"/> unknown		
		<input checked="" type="checkbox"/> vacant/not in use		
		<input type="checkbox"/> other:		
			Number of Contributing Resources previously listed in the Inventory	
			<u>2</u>	

7. Description

Inventory No. HO-844

Condition

<input type="checkbox"/> excellent	<input type="checkbox"/> deteriorated
<input type="checkbox"/> good	<input type="checkbox"/> ruins
<input checked="" type="checkbox"/> fair	<input type="checkbox"/> altered

Prepare both a one paragraph summary and a comprehensive description of the resource and its various elements as it exists today.

The Charles and Margaret Kim House is located at 10114 Frederick Road, on the north side of the road, just west of Centennial Lane and about 1.5 miles west of Ellicott City in northeastern Howard County, Maryland. The property contains a frame foursquare house with a small frame outbuilding behind it, and the house faces southwest toward the road.

The house is a 2 1/2-story, two-bay by three-bay frame structure with a rubble stone foundation, vinyl siding over weatherboards on the first story and over wood shingles on the second story, and a hipped roof with asphalt shingles. The window sash are either replaced or missing. On the southwest elevation, the first story has a window to the west and a door to the south. The doorway has sidelights with one light over one panel, and a one-light transom. Both the transom bar and the doorposts are paneled. There is a one-story porch with a tongue-and-grooved wood deck, three Doric columns with railings and square balusters between them, and the soffit of the porch is now covered. The porch has a half-hip roof. The second story has two windows, and the eaves have an overhang with a bead-board soffit. There are half-round gutters. On the roof is a dormer with a hip roof and two small casements that are now missing the sash. The dormer sides are covered with wood shingles.

The southeast elevation foundation has raised-bead pointing, with a window opening over the center and east bays. The first story has a small window in the south bay and a new one-over-one sash in the center and east bays. The second story has no opening in the south bay, a medium-sized window in the center, and a new one-over-one sash in the east bay. There is a dormer that matches that on the southwest elevation. There is a wing and addition attached to the northeast in two sections. The wing has a shed roof that slopes down to the northeast, is set on brick piers with terra cotta tile infill between them, and has a small window on the southeast elevation. The addition is on brick piers and has a roof that slopes down to the northeast on the northeast part and slopes down to the southeast on the southeast part. The addition has no opening on the southeast elevation. The northeast elevation has a boarded-up door to the east and a window to the north. There is a brick chimney in this addition, and it has been heightened. The northwest elevation of the addition has a window in the center. The northeast elevation of the main block has a cellar bulkhead in the north bay of the foundation. The first story has a window in the north bay, and the second story has two window openings. The wood shingles of the story have a kick where they meet the first story, with an ogee moulding below this kick. There is a brick chimney in the center. The northwest elevation has a three-sided bay to the north on the first story, with a foundation beneath the bay and one window in this foundation. There is a window in each side of the bay on the first story, and there is a window in the center and the west bays. The foundation has a window in the center bay, and the west bay is covered with corrugated metal. The second story has three windows, and there is a typical dormer on the roof.

The interior has a four-room plan with the entrance stair hall in the south corner and rooms in the west, north, and east corners. The south room has a stair on the southeast wall that has three runs. It ascends along the southwest wall to the southeast, then along the southeast wall, and finally along the northeast wall. The stair has a paneled, closed stringer, with a sunken, flat panel and a bolection mould with a torus and a cavetto and bead. The stair has square balusters of oak, and a moulded handrail that also appears to be pine. There is a square paneled newel post of oak that has dentils at the top. All of this woodwork has a dark stained finish. The floor is carpeted, and the baseboard has a quirked ogee and bevel. The front door has one light over a pair of lying panels, above one lying panel, with a pair of lying panels at the bottom. The door has been broken apart. The architrave has an ogee backband and a beaded interior edge. The interior doors are missing, and the architrave has a broken double field and a cavetto at the break and a small ogee on the inner edge.

The west room has carpeting, typical baseboard and architrave, and a doorway on the northeast, set to the north. The east room has linoleum, plain baseboard, and typical architrave. There is a door to the cellar stairs on the southwest, set to the south, and the opening is boarded up because the stairs are gone. There is a doorway on the northwest, set to the north, and another on the northeast, set to the north. The wall on the northeast was studded out with drywall and covers an original doorway set to the east that was closed off on the other side as well. This opening has typical architrave. The walls in the house are plaster, though some have drywall added over top. The north room has carpeting and typical baseboard, and the architrave has an ogee and bevel

Maryland Historical Trust

Maryland Inventory of Historic Properties Form

Inventory No. HO-844

Name Charles & Margaret Kirn House
Continuation Sheet

Number 7 Page 1

backband and an interior beaded edge. There is a fireplace on the southeast that has been bricked in and the mantel has been removed. The mantel was fastened with wires, and these wires are held into the masonry with wire nails. The northwest elevation of this room has a bay window.

The northeast addition has carpeting, and the walls have Masonite with applied rails and stiles and panel moulds to create the effect of paneling. The panel moulds have a quirked ogee and bevel. The architrave is in part plain with bull's-eye corner blocks, and in part pulvinated with a torus on each side and the same bull's-eye corner blocks. The ceiling is treated like the walls with an ovolo and cavetto cornice mould. There is a chimney on the east with a stovepipe hole. On the southwest wall is a cupboard with two doors that have three lights each on the top. The south side has two drawers below the door while the west side is open below the door, though it was possibly altered. There are two doors at the bottom of the cupboard, each door having two panels with sunken fields and panel moulds. The doors have butt hinges with pins and spring catches. The south elevation has two doors. The east door has one light over two lying panels, with butt hinges that have ball finials. The south door has four panels with sunken fields and ogee panel moulds. The center of the wall, beneath the Masonite, has weatherboard siding to the south with a seam, and it is painted dark green. To the east there is patched wood sheathing. The south door leads to a powder room, while the east door leads to a closed-off vestibule. This vestibule has beaded-edge, vertical-board half wainscot and two four-light casement windows on the southeast. There is a window opening on the southwest, and a door on the northeast that has one light over two panels. The ceiling has narrow beaded-edge-and-center boards.

The second story has the same plan as the first story and has carpet or linoleum throughout, typical architrave and baseboard, and most of the doors are missing. The south chamber has an open stair railing along the southeast and enclosed attic stairs on the southeast. The attic stairs have a dogleg, and ascend along the southeast to a landing, then turn to the northwest. The edges of the stair landing along the south chamber are paneled to match the stringer. The stairs have a four-panel door with sunken fields, ogee panel moulds, and butt hinges with pins. The west chamber has a closet on the southeast, set to the south, with five lying panels on the door. An identical door is from the stair hall to this chamber, and it has a natural finish beneath later paint. There is a bathroom on the southeast, in the center, with a claw-foot tub and a new sink and toilet. The north chamber has a five-lying-panel door, and a closet on the southeast, set to the east, that also has a five-lying-panel door. The east chamber has a flush door. There is a closet on the northwest with a five-lying-panel door, and plain architrave. The room has paneling and a drop ceiling.

The attic is floored and constructed with 2 by 6 dimensional circular-sawn rafters. There is board sheathing with cut nails coming through it, and the wall framing also has cut nails. A brick chimney comes up just north of center.

There is a shed located about 5 feet northeast of the addition to the house. It is a one-story, one-bay structure with German siding and a gable roof with flat metal and a southwest-northeast ridge. The building has a wood box cornice with returns. The southeast elevation has a door with louvered blinds though this has been broken. The northwest elevation has a six-over-six sash with head-cut trim. There are no openings on the northwest and southeast elevations. The interior of the building has exposed 2 by 4 studs.

8. Significance

Inventory No. HO-844

Period	Areas of Significance	Check and justify below		
<input type="checkbox"/> 1600-1699	<input type="checkbox"/> agriculture	<input type="checkbox"/> economics	<input type="checkbox"/> health/medicine	<input type="checkbox"/> performing arts
<input type="checkbox"/> 1700-1799	<input type="checkbox"/> archeology	<input type="checkbox"/> education	<input type="checkbox"/> industry	<input type="checkbox"/> philospohy
<input type="checkbox"/> 1800-1899	<input checked="" type="checkbox"/> architecture	<input type="checkbox"/> engineering	<input type="checkbox"/> invention	<input type="checkbox"/> politics/government
<input checked="" type="checkbox"/> 1900-1999	<input type="checkbox"/> art	<input type="checkbox"/> entertainment/ recreation	<input type="checkbox"/> landscape architecture	<input type="checkbox"/> religion
<input type="checkbox"/> 2000-	<input type="checkbox"/> commerce	<input type="checkbox"/> ethnic heritage	<input type="checkbox"/> law	<input type="checkbox"/> science
	<input type="checkbox"/> communications	<input type="checkbox"/> exploration/ settlement	<input type="checkbox"/> literature	<input type="checkbox"/> social history
	<input type="checkbox"/> community planning		<input type="checkbox"/> maritime industry	<input type="checkbox"/> transportation
	<input type="checkbox"/> conservation		<input type="checkbox"/> military	<input type="checkbox"/> other:

Specific dates	N/A	Architect/Builder	N/A
Construction dates	c. 1911-12		

Evaluation for:

National Register Maryland Register not evaluated

Prepare a one-paragraph summary statement of significance addressing applicable criteria, followed by a narrative discussion of the history of the resource and its context. (For compliance reports, complete evaluation on a DOE Form - see manual.)

Charles A. Gerwig owned and operated a general merchandise store and post office at Pine Orchard, on the south side of Frederick Road, for over 40 years in the late-nineteenth and early-twentieth centuries. His daughter, Margaret, married Charles R. Kirn, probably in the early twentieth century. The Gerwig and Kirn families were both originally from Germany, were members of the Lutheran Church, and were especially prominent in building in Ellicott City and Catonsville, so it is no surprise that they would have intermarried. In 1911 Gerwig sold a small parcel of land on the north side of Frederick Road to his daughter and son-in-law, and the following year Kirn was assessed for a new house valued at \$1,350. This is the house that stands on the lot, and must have been built by Kirn and his laborers himself, since he was a "prominent builder and contractor." He had worked for his father's firm, Jacob Kirn & Sons, who had started out in Catonsville and later moved to Howard County. Charles Kirn succeeded his father, though may have still been working for him in 1911. (1)

The house Kirn built for himself was an early foursquare that still retained some Queen Anne influence, especially in the kick and cornice between the first and second stories, where the materials changed from shingles above to weatherboards below. The closed stringer stair is also characteristic of the c. 1890-1915 period and was not used in later foursquares. The plan of the house is typical for foursquares, with the entrance hall in one front corner, parlor next to it, kitchen behind the entrance hall, and dining room next to the kitchen, behind the parlor. The dining room also has a bay window, which was fairly common for this space in foursquares. A porch on the rear was later enclosed for additional space, and added onto.

Charles Kirn died in 1925, at age 41. Margaret Gerwig Kirn continued to own the house, and presumably lived here, until her death in 1960. She left the property to Ida M. Garrick, who may have been her daughter. (2)

Notes:

(1). Ellicott City (Maryland) Times, 11 January 1913, p. c, col. 2. Howard County Genealogical Society, comp., Howard County Maryland Records, vol. 7 (Columbia, MD: Author, 1991), pp. 22, 24. Ellicott City (Maryland) Times, 12 March 1925, p. 5, col. 2. Kenneth M. Short, "Old Catonsville National Register Historic District" nomination, 200?. Howard County Commissioners of the Tax, Assessment, District 2, 1910-17, Maryland State Archives.

(2). Ellicott City (Maryland) Times, 12 March 1925, p. 5, col. 2.

9. Major Bibliographical References

Inventory No. HO-844

Footnotes.
See ~~continuation sheet.~~

10. Geographical Data

Acreage of surveyed property 1.191 acres
Acreage of historical setting 1.191 acres
Quadrangle name Ellicott City Quadrangle scale 1:24000

Verbal boundary description and justification

The boundaries consist of all of the property on map 24, p. 61, which encompasses all of the historic structures.

11. Form Prepared By

name/title	Ken Short		
organization	Howard County Dept. of Planning & Zoning	date	2/19/2008
street and number	3430 Courthouse Drive	telephone	410-313-4335
city or town	Ellicott City	state	MD zip code 21043

The Maryland Inventory of Historic Properties was officially created by an Act of the Maryland Legislature to be found in the Annotated Code of Maryland, Article 41, Section 181 KA, 1974 supplement.

The survey and inventory are being prepared for information and record purposes only and do not constitute any infringement of individual property rights.

return to: Maryland Historical Trust
DHCD/DHCP
100 Community Place
Crownsville MD 21032
410-514-7600

1/2 10114 Frederick Rd HO-844
1/2 Moulding Profiles

KMS
11 June '07

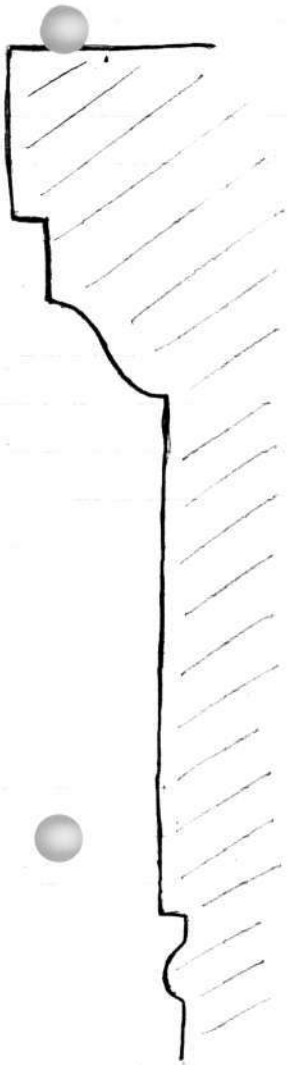

Front
Door
Architrave

Interior
Door
Architrave

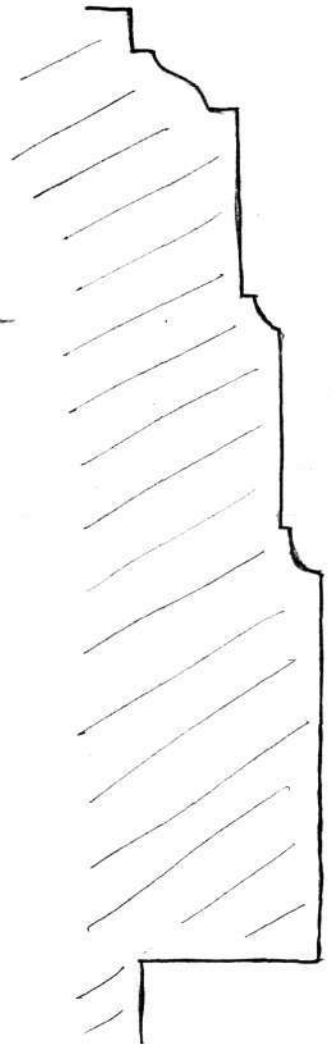

Baseboard

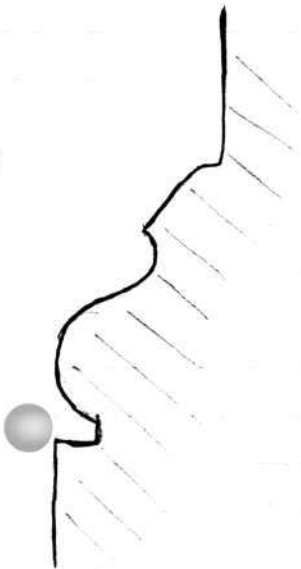

Stair Stringer Panel Mould

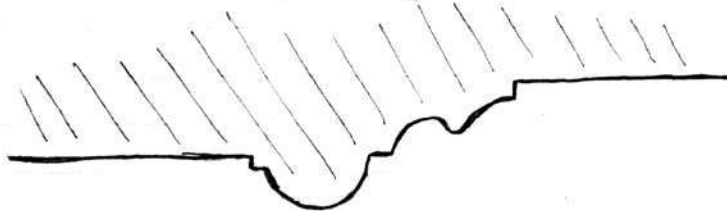

2/2 10114 Frederick Rd
Moulding Profiles

HO-844

KMS
11 June '07

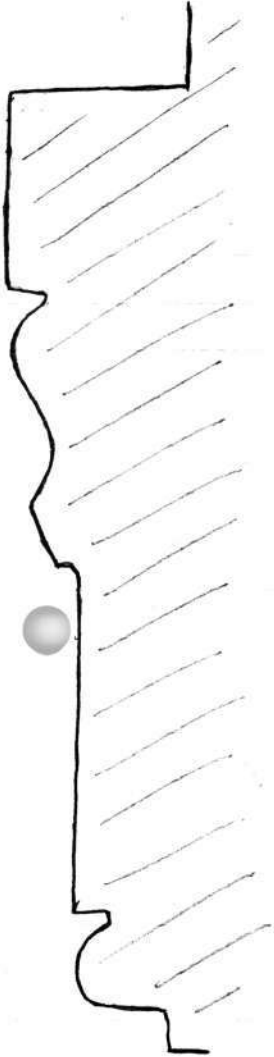

North
Room
Architrave

NE Addition Architrave

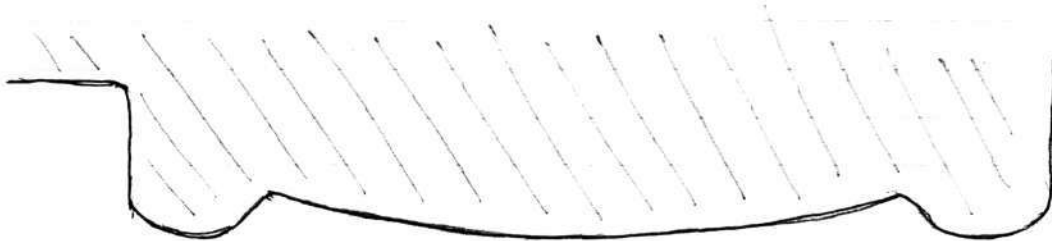

Charles & Margaret Kirn House (HO-844)
 10114 Frederick Road
 CHAIN OF TITLE

GRANTOR/HOME	GRANTEE/HOME	DATE	LIBER/ FOLIO	INSTRU- MENT	CONSIDER- -ATION	ACREAGE	NOTES
Wachovia Bank	JDB/TSC Route 40 LLC/MD	6.24.2005	MDR 9275-348	Deed - fee simple	\$2,300,000	1) .383 A 2) .8583 A	1) 10114 Frederick Rd. 2) 10163 Baltimore Natl. Pike
W. William Cookson J. Richard Fowler Mary Elizabeth Seidel/?	Wachovia Bank	4.29.2003	MDR 7409-661	Deed - fee simple	\$450,000	1) .383 A	
Mary Elizabeth Siedel, pers. rep./?	Mary Elizabeth Seidel/?	4.29.2003	MDR 7409-657	Deed - fee simple	\$0	1) .383 A.	Jerome Seidel d. 1996
Richard Dipasquale pers. rep. Of Myrtle M. Hutchinson guardian of Frances L. Grossnickle/Howard	W. William Cookson J. Richard Fowler Jerome M. Siedel/?	10.1.1984	CMP 1289-98	Deed - fee simple	\$42,500	1) .383 A.	MMH deceased FLG senile
John L. Clark, exec. Of John M. Garrick/Howard	Frances L. Grossnickle Myrtle M. Hutchinson	12.20.1972	CMP 619-152	Deed - fee simple	\$5.00	?	2 parcels Will of JMG 1.24.1964
Ida M. Garrick	John M. Garrick	Written 7.11.1963	<u>Wills</u> RLP 13-378	Bequest			
Margaret L. Kirn	Ida M. Garrick	3.30.1960	<u>Wills</u> RLP 12-77	Bequest			
Ida Gerwig Dugan, exec. Of Barbara C. Gerwig/Howard	Margaret L. Kirn/w/o Charles E. Kirn/Howard	8.15.1922	HBN 115-466	Deed - fee simple	\$5.00	4 A.	BCG will RD 6-211 Left east portion of land to MLK Adjoins land where Kirn lives (1)
Margaret L. Kirn/Howard	Charles E. Kirn/Howard	9.17.1918	HBN 106-126	Deed - fee simple	\$5.00	?	"Whereon I now reside" (2)
Charles A. & Barbara C. Gerwig/Howard	Margaret L. Kirn w/o Charles Kirn/Howard	5.16.1911	WWLC 91-123	Deed - fee simple	0-2-3/4 ARP		(2)

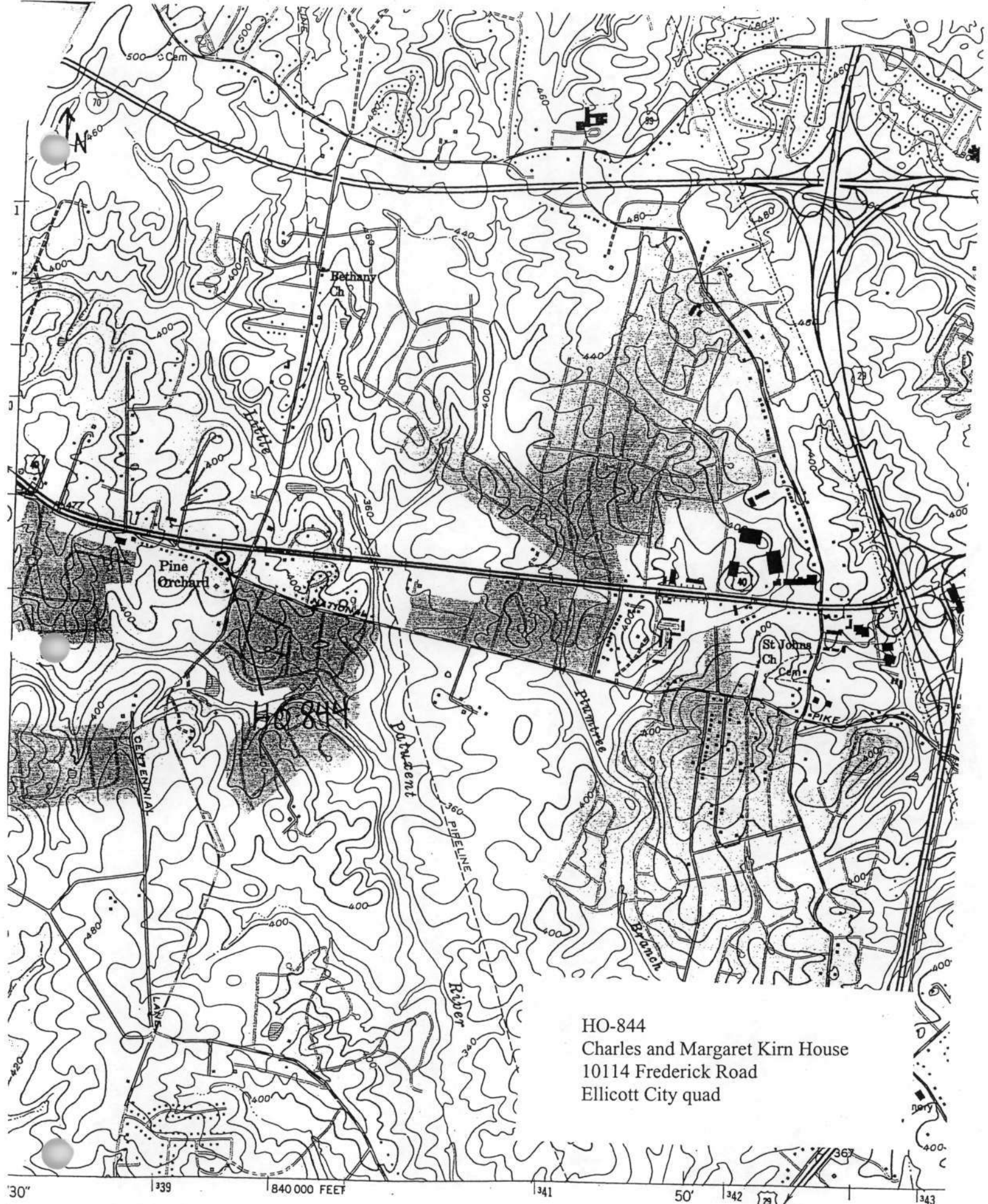

HO-844
 Charles and Margaret Kirm House
 10114 Frederick Road
 Ellicott City quad

30" 1339 184000 FEET 1341 50' 1342 1343

Map prepared by the Army Map Service
 Digitized and published by the Geological Survey
 Control by USGS and USC&GS

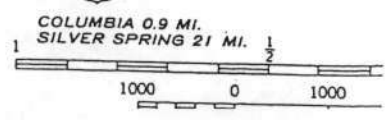

HO-844
Charles and Margaret Kirn House
10114 Frederick Road
Howard County, Maryland
Ken Short, photographer

Photo Log

Nikon D-70 camera
HP Premium Plus paper
HP Gray Photo print cartridge

HO-0844_20070611_01
Southwest and southeast elevations

HO-0844_20070611_02
Northeast and northwest elevations

HO-0844_20070611_03
South room, stairway, view southeast

HO-0844_20070611_04
Northeast addition, cabinet

HO-0844_20070611_05
Outbuilding, southeast elevation



HO-844

Charles and Margaret Kirn House

10114 Frederick Rd.

Howard County, MD

Ken Short

June 2007

MD SHPO

Southwest and Southeast Elevations

1/5



HO-844

Charles and Margaret Kirn House

10114 Frederick Rd

Howard County, MD

Ken Short

June 2007

MD SHPO

Northeast and Northwest Elevations

2/5



Young Welcome to Blessie Old P...

LE

Why?

Watch your SHIT
FUCK THAT SHIT

HO-844

Charles and Margaret Kirn House

10114 Frederick Rd

Howard County, MD

Ken Short

June 2007

MD SHPO

South room, Stairway, view Southeast

3/5



HO-844

Charles and Margaret Kirn House

10114 Frederick Rd.

Howard County, MD

Ken Short

June 2007

MD SHPO

Northeast Addition, Cabinet

4/5



HO-844

Charles and Margaret Kirn House

10114 Frederick Rd.

Howard County, MD

Ken Short

June 2007

MD SHPO

Outbuilding, Southeast Elevation

HO-844, House
10114 Frederick Road, Ellicott City vicinity
Howard County
Ca. 1910
Private

CAPSULE SUMMARY

This two-story, frame four-square faces south on the north side of Frederick Road just west of Centennial Lane. The house has been vacant for over a year and all of the windows were recently removed and the openings boarded up. The construction of the house predated the construction of Route 40 so it was located along the old National Road when it was still the main east-west route through Howard County. The area has seen major changes in the last 25 years, and the house is now located on a small triangle of land between Route 40, Centennial Lane, and Route 144 and is surrounded by a shopping center on the east, a High's store and gas station on the west, and backs to commercial development along Route 40. This four-square was probably constructed ca. 1910. It rests on a stone foundation with applied, raised mortar joints and most of the building is covered with vinyl siding. The hipped roof has a wide eave overhang and is covered with asphalt shingles, and one interior brick chimney is located on the rear slope of the roof just behind the peak.

This four-square is significant under criteria C in the area of architecture. It is a representative example of the four-square style and is also significant for its location along the former National Road.

Maryland Historical Trust

Maryland Inventory of Historic Properties Form

Inventory No. HO-844

1. Name of Property (indicate preferred name)

historic House
other

2. Location

street and number 10114 Frederick Road not for publication
city, town Ellicott City vicinity
county Howard

3. Owner of Property (give names and mailing addresses of all owners)

name Wachovia Bank National Association
street and number 3015 S. College Street telephone
city, town Charlotte state NC zip code 28288

4. Location of Legal Description

courthouse, registry of deeds, etc. Howard County Courthouse tax map and parcel: Map 24, P671
city, town Ellicott City liber 7409 folio 661

5. Primary Location of Additional Data

- Contributing Resource in National Register District
- Contributing Resource in Local Historic District
- Determined Eligible for the National Register/Maryland Register
- Determined Ineligible for the National Register/Maryland Register
- Recorded by HABS/HAER
- Historic Structure Report or Research Report
- Other

6. Classification

Category		Ownership	Current Function		Resource Count	
<input type="checkbox"/>	district	<input type="checkbox"/> public	<input type="checkbox"/> agriculture	<input type="checkbox"/> landscape	Contributing	Noncontributing
<input checked="" type="checkbox"/>	building(s)	<input checked="" type="checkbox"/> private	<input type="checkbox"/> commerce/trade	<input type="checkbox"/> recreation/culture	2	buildings
<input type="checkbox"/>	structure	<input type="checkbox"/> both	<input type="checkbox"/> defense	<input type="checkbox"/> religion		sites
<input type="checkbox"/>	site		<input type="checkbox"/> domestic	<input type="checkbox"/> social		structures
<input type="checkbox"/>	object		<input type="checkbox"/> education	<input type="checkbox"/> transportation		objects
			<input type="checkbox"/> funerary	<input type="checkbox"/> work in progress	2	0
			<input type="checkbox"/> government	<input type="checkbox"/> unknown		Total
			<input type="checkbox"/> health care	<input checked="" type="checkbox"/> vacant/not in use		
			<input type="checkbox"/> industry	<input type="checkbox"/> other:		
					Number of Contributing Resources previously listed in the Inventory	
					0	

7. Description

Inventory No. HO-844

Condition

<input type="checkbox"/> excellent	<input type="checkbox"/> deteriorated
<input type="checkbox"/> good	<input type="checkbox"/> ruins
<input checked="" type="checkbox"/> fair	<input type="checkbox"/> altered

Prepare both a one paragraph summary and a comprehensive description of the resource and its various elements as it exists today.

This two-story, frame four-square faces south on the north side of Frederick Road just west of Centennial Lane. The house has been vacant for over a year and all of the windows were recently removed and the openings boarded up. The construction of the house predated the construction of Route 40 so it was located along the old National Road when it was still the main east-west route through Howard County. The area has seen major changes in the last 25 years, and the house is now located on a small triangle of land between Route 40, Centennial Lane, and Route 144 and is surrounded by a shopping center on the east, a High's store and gas station on the west, and backs to commercial development along Route 40. On the south side of Route 144, one old house was recently demolished and all of the trees were removed leading to speculation that another shopping center is planned for the property.

This four-square was probably constructed ca. 1910. It rests on a stone foundation with applied, raised mortar joints and most of the building is covered with vinyl siding. The hipped roof has a wide eave overhang and is covered with asphalt shingles, and one interior brick chimney is located on the rear slope of the roof just behind the peak.

The front (south) façade is two bays wide. The entrance is located in the right bay and the glazed and paneled door is capped by a narrow transom and flanked by sidelights. The second story windows are vertically aligned above the first story openings. All of the windows on this façade have been removed and the openings boarded up. There is a hipped dormer on the front slope of the roof that originally held two casement windows which have been removed. The sidewalls of the dormer are covered with unpainted wood shingles. A single story porch spans the full width of the front façade. Doric columns support the hipped roof and square balusters ring the wood floor.

The east side façade has three windows across the first story and two windows on the second story. Three of the five openings hold vinyl windows while the other two openings are boarded up. There are two boarded up window openings in the foundation and another hipped dormer that is also boarded up.

On the west side façade, the second story is shingled with unpainted wood shakes while the first story is covered with vinyl siding. There are three windows located across the second story and two regular windows and a three-sided bay window on the first story. There are two boarded up window openings in the foundation and a hipped dormer on the roof. Like the front dormer, this one originally held two casement windows that have since been removed.

There is an early one story, shed roofed addition centered on the rear (north) façade. This addition rests on a brick foundation and has a tall interior brick chimney. Like the west façade, the second story of the original rear façade is shingled while the first story, including the addition, is covered with vinyl siding. There are two windows located on the second story, both removed, and one window located to the right of the addition on the first story. There is also bulkhead access to the basement to the right of the addition. There is an enclosed porch on the east side of the addition that conceals the rest of the first story of the original structure.

The only outbuilding on the property is a small frame shed located directly behind the addition. This shed has wooden German siding, a metal roof, one 6/6 double hung wood window on the west façade, and a door on the east façade.

8. Significance

Inventory No. HO-844

Period	Areas of Significance	Check and justify below		
<input type="checkbox"/> 1600-1699	<input type="checkbox"/> agriculture	<input type="checkbox"/> economics	<input type="checkbox"/> health/medicine	<input type="checkbox"/> performing arts
<input type="checkbox"/> 1700-1799	<input type="checkbox"/> archeology	<input type="checkbox"/> education	<input type="checkbox"/> industry	<input type="checkbox"/> philosophy
<input type="checkbox"/> 1800-1899	<input checked="" type="checkbox"/> architecture	<input type="checkbox"/> engineering	<input type="checkbox"/> invention	<input type="checkbox"/> politics/government
<input checked="" type="checkbox"/> 1900-1999	<input type="checkbox"/> art	<input type="checkbox"/> entertainment/ recreation	<input type="checkbox"/> landscape architecture	<input type="checkbox"/> religion
<input type="checkbox"/> 2000-	<input type="checkbox"/> commerce	<input type="checkbox"/> ethnic heritage	<input type="checkbox"/> law	<input type="checkbox"/> science
	<input type="checkbox"/> communications	<input type="checkbox"/> exploration/ settlement	<input type="checkbox"/> literature	<input type="checkbox"/> social history
	<input type="checkbox"/> community planning		<input type="checkbox"/> maritime industry	<input type="checkbox"/> transportation
	<input type="checkbox"/> conservation		<input type="checkbox"/> military	<input type="checkbox"/> other:

Specific dates ca. 1910

Architect/Builder unknown

Construction dates ca. 1910

Evaluation for:

National Register

Maryland Register

not evaluated

Prepare a one-paragraph summary statement of significance addressing applicable criteria, followed by a narrative discussion of the history of the resource and its context. (For compliance reports, complete evaluation on a DOE Form - see manual.)

This four-square is significant under criteria C in the area of architecture. It is a representative example of the four-square style and is also significant for its location along the former National Road.

Four-square houses were popular throughout the Mid-Atlantic region from the 1890's through the 1920's. Two stories in height, commonly two bays wide, the four-square was square in shape, capped with a pyramidal or hipped roof, and usually contained four rooms on each floor. Hipped dormers were a common feature, as were full width front porches with either Classically inspired or Prairie-style supports. Bay windows on the side facades are also a common embellishment.

This particular four-square is representative of the style with its two bay front façade, hipped roof with hipped dormers, full width porch, and bay window on the west façade, and is therefore typical of the type of domestic architecture constructed across Howard County in the first decades of the 20th century.

The house also gains some significance from its location on the National Road. The National Road was laid out in the early 19th century and was the east-west route through Howard County and the country at that time. Over the past 200 years a variety of structures have been built and demolished along the road. Small businesses, including mills, blacksmiths, and general stores, tended to spring up at major crossroads while the long stretches in between were dotted with houses and farms. By 1900, the National Road was seeing increasingly heavy traffic and the age of the automobile was fast approaching. Route 40 was constructed parallel to the National Road in 1925. When completed, Route 40 stretched from coast to coast and, by the 1950's, was referred to as the Golden Highway. As the country's interstate system expanded during the 1970's, Route 40 became obsolete as the main east-west route across the country. In Howard County, Route 40 closely parallels the old National Road and Interstate 70 was later constructed partially on the alignment of Route 40. Today, Route 40 remains a separate road only in the eastern portion of the county around Ellicott City. Increased traffic and development pressure have had a negative impact on the old National Road all through Howard County, but this particular area near Centennial Lane has seen the greatest impact since the alignments of the National Road and Route 40 are virtually on top of each other. This portion of the National Road seems sure to change from mostly residential to largely commercial in the next 5 to 10 years, but in the meantime it is worth noting the interesting structures that remain.

9. Major Bibliographical References

Inventory No. HO-844

See continuation sheet.

10. Geographical Data

Acreage of surveyed property 0.3Acreage of historical setting 0.3Quadrangle name Ellicott CityQuadrangle scale 1:24000

Verbal boundary description and justification

Tax map 24, parcel 671.

11. Form Prepared By

name/title Kristin Hill, Historic Sites Surveyororganization Howard County Department of Planning and Zoningdate 3/23/04street and number 3430 Court House Drivetelephone 410-313-4335city or town Ellicott Citystate MD zip code 21043

The Maryland Inventory of Historic Properties was officially created by an Act of the Maryland Legislature to be found in the Annotated Code of Maryland, Article 41, Section 181 KA, 1974 supplement.

The survey and inventory are being prepared for information and record purposes only and do not constitute any infringement of individual property rights.

return to: Maryland Historical Trust
DHCD/DHCP
100 Community Place
Crownsville MD 21032
410-514-7600

Maryland Historical Trust
Maryland Inventory of
Historic Properties Form

Inventory No. HO-844

Name House

Continuation Sheet

Number 9 Page 1

Lanier, Gabrielle M. and Bernard L. Herman. EVERYDAY ARCHITECTURE OF THE MID-ATLANTIC. Baltimore: Johns Hopkins University Press, 1997.

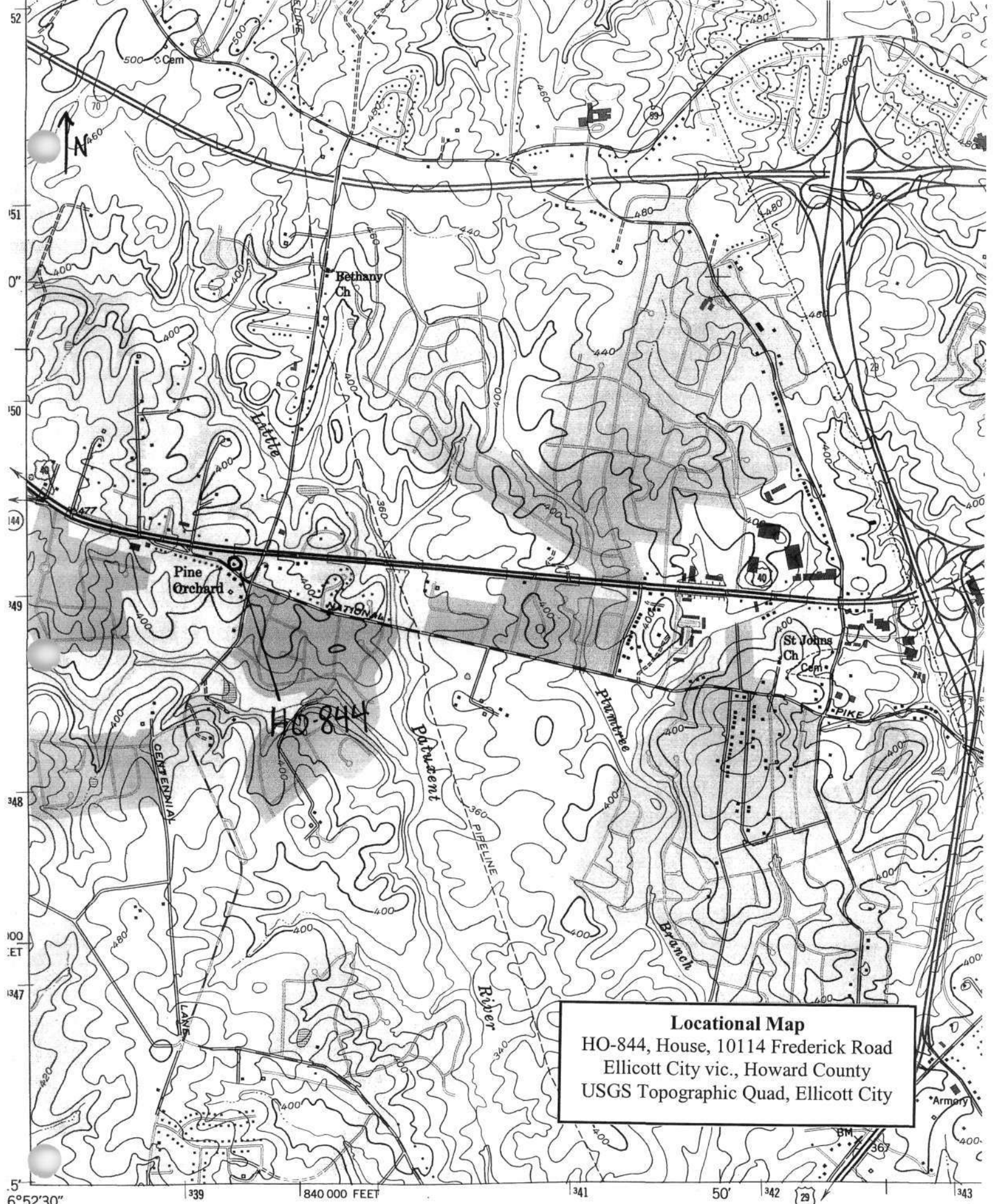

Locational Map
 HO-844, House, 10114 Frederick Road
 Ellicott City vic., Howard County
 USGS Topographic Quad, Ellicott City

Mapped by the Army Map Service
 Edited and published by the Geological Survey
 Control by USGS and USC&GS
 Topography from aerial photographs by photogrammetric

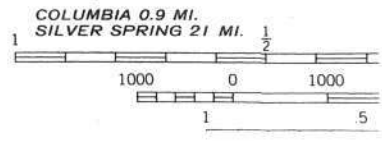



AD-844, House

10114 Frederick Rd

Howard County, Maryland

Kinstle Hill, 3/04

Negative at MDSTPO 32 21+01 NNNNN 158

SE elevation

119



HO-844, House

10114 Frederick Rd.

Howard County, Maryland

Kristin Hill, 3/04

Negative at MD SHPO

31 21+01 NNNNN 158

Front (south) elevation

2/9



HO-844, House

10114 Frederick Rd.

Howard County, Maryland

Kniskern Hill, 3/04

30 21+00 NNNNN 150

Negative at MDS#PO

Front entrance

3/9



No 844, House
10114 Frederick Rd.
Howard County, Maryland

29 21+00 NNNNN 158

Kristin Hill, 3/04
Negative at MDSTPO
SW elevation

4/9



HO-844, House
10114 Frederick Rd.
Howard County, Maryland
Krestin Hill, 3/04
Negative at MD5HPO
NW elevation

28 21+01 NNNNN 158

5/9



HO-844, House

10114 Frederick Rd.

Howard County, Maryland

27 21+01 NNNNN 158

Kristin Hill, 3/04

Negative at MDSHPO

Rear (north) elevation, shed in foreground

6/9



HO-844, House
10114 Frederick Rd.

Howard County, Maryland

Kristin Hill, 3/04

Negative at MDSHPO

NE elevation

7/9

20 21+01 NNNNN 158



HO-844, House
10114 Frederick Rd.
Howard County, Maryland
Kinstm Hill, 3/04

21 21+00 NNNNN 158

Negative at MDSHPD

East elevation

8/9



HO-844, House

10114 Frederick Rd.

Howard County, Maryland

Kinstin Hill, 3/04

19 21+00 NNNNN 150

Negative at MDSHPo

shed, northeast elevation

9/9