

**INDIVIDUAL PROPERTY/DISTRICT  
MARYLAND HISTORICAL TRUST  
INTERNAL NR-ELIGIBILITY REVIEW FORM**

Property/District Name: Whetzel Farm Survey Number: HO-720

Tax Parcel#: 337

Project: Maryland 216/29 Project Planning Study Agency: MDOT-SHA

Site visit by MHT Staff:  no  yes Name \_\_\_\_\_ Date \_\_\_\_\_

Eligibility recommended \_\_\_\_\_ Eligibility **not** recommended  \_\_\_\_\_

Criteria:  A  B  C  D Considerations:  A  B  C  D  E  F  G  None

Justification for decision: (Use continuation sheet if necessary and attach map)

The Whetzel Farm at 11425 Scaggsville Road is not eligible due to the fact that it does not meet National Register Criteria A, B, C, or D. Preliminary research has not revealed any association between the dwelling and events that have made a significant contribution to the broad patterns of our history (Criterion A) or the lives of persons significant in our past (Criterion B). Although the building provides an example of the vernacular Gothic Revival style, it is neither unusual nor distinguished; it does not represent the work of a master or display high artistic merit (Criterion C). There is no evidence that the property is likely to yield information important in history or prehistory (Criterion D). Thus, the property is not National Register-eligible.

Documentation on the property/district is presented in: Maryland Historical Trust Inventory Form

and Maryland 29/216 Project Planning Report

Prepared by: Tracerics, 5420 Western Ave., Chevy Chase, MD 20815 November 1997

Connor - Allen Smider 2/10/98  
Reviewer, Office of Preservation Services Date

NR program concurrence:  yes  no  not applicable

B. Kuntz 3/31/99  
Reviewer, NR Program Date

*gms*

**CAPSULE SUMMARY**  
Whetzel Farm  
11425 Scaggsville Road  
(HO-720)

T-shaped in plan, the original dwelling at 11425 Scaggsville Road dates from circa 1875-1890. The wood frame, two-and-a-half-story, four-bay house is designed as a vernacular Gothic Revival-style dwelling. The wood frame walls, originally clad in German siding, have since been clad in asbestos shingles. A standing seam metal side gable roof with cornice returns covers the main body of the I-house with a cross gable roof marking the central bay, typical of the Gothic Revival style. Interior end brick chimneys with corbelled caps flank the composition. A two-story rear ell with an interior brick chimney at its ridge extends at the rear of the house. A one-story, four-bay porch with Tuscan columns and a hipped roof extends across the full width of the facade.

Whetzel Farm is the result of the merging of several properties, many of which were associated with families who held large tracts of land in the late 19th century, including the Renns, the Scaggs, the Iagers, and the Warfields. In the 1910s, Joseph Frank Harrison began to amass land in this area. According to oral tradition, the Harrisons operated a large chicken farm in this location. In 1951, the Harrisons sold the farm to Charles and Caroline Soper. On October 24, 1976, Charles Soper died, leaving his 99.537-acre property to his heirs. He willed the northwestern third of the farm, including farm buildings, to his daughter, Betty L. Whetzel. Since the Whetzels obtained the property, they have continued to farm this land. For many years, the family rented out the 19th century house, and in 1979 they constructed a dwelling for their own use at the northwest edge of the property.

MARYLAND HISTORICAL TRUST  
MD INVENTORY OF HISTORIC PROPERTIES

Inventory No. HO-720

=====

1. Name of Property

=====

historic name \_\_\_\_\_  
common/other name Whetzel Farm

=====

2. Location

=====

street & number 11425 Scaggsville Road not for publication \_\_\_\_\_  
city or town Fulton vicinity \_\_\_\_\_ state Maryland code MD  
county Howard County code 027 zip code 20759

=====

3. State/Federal Agency Certification N/A

=====

4. National Park Service Certification N/A

=====

5. Classification

=====

Ownership of Property (Check all that apply)

- private
- public-local
- public-State
- public-Federal

Category of Property (Check only one box)

- building(s)
- district
- site
- structure
- object

Number of Resources within Property

Contributing		Noncontributing	
<u>6</u>	<u>7</u>		buildings
<u>0</u>	<u>0</u>		sites
<u>0</u>	<u>0</u>		structures
<u>0</u>	<u>0</u>		objects
<u>6</u>	<u>7</u>		Total

Is this property listed in the National Register?

Yes \_\_\_\_\_ Name of Listing \_\_\_\_\_  
No



=====  
8. Statement of Significance  
=====

Applicable National Register Criteria (Mark "x" in one or more boxes for the criteria qualifying the property for National Register listing)

- A Property is associated with events that have made a significant contribution to the broad patterns of our history.
- B Property is associated with the lives of persons significant in our past.
- C Property embodies the distinctive characteristics of a type, period, or method of construction or represents the work of a master, or possesses high artistic values, or represents a significant and distinguishable entity whose components lack individual distinction.
- D Property has yielded, or is likely to yield information important in prehistory or history.

Criteria Considerations (Mark "X" in all the boxes that apply.)

- A owned by a religious institution or used for religious purposes.
- B removed from its original location.
- C a birthplace or a grave.
- D a cemetery.
- E a reconstructed building, object, or structure.
- F a commemorative property.
- G less than 50 years of age or achieved significance within the past 50 years.

Maryland Inventory of Historic Properties  
Whetzel Farm  
11425 Scaggsville Road  
Howard County, Maryland

Inventory No. HO-720  
Page 4

=====  
Areas of Significance (Enter categories from instructions)

Architecture

Agriculture

Period of Significance 1875-present

Significant Dates 1875-1880

Significant Person (Complete if Criterion B is marked above)

Cultural Affiliation Undefined

Architect/Builder Unknown

Narrative Statement of Significance (Explain the significance of the property.)

See Continuation Sheet No. 8-1

Maryland Inventory of Historic Properties  
Whetzel Farm  
11425 Scaggsville Road  
Howard County, Maryland

Inventory No. HO-720  
Page 5

=====  
9. Major Bibliographical References  
=====

(Cite the books, articles, legal records, and other sources used in preparing this form.)

Howard County Land Records, Recorder of Deeds, Howard County,  
Ellicott City, Maryland

=====  
10. Geographical Data  
=====

Acreage of Property 30.882 acres

**Verbal Boundary Description (Describe the boundaries of the property.)**

The property at 11425 Scaggsville Road is designated as Parcel 337, as indicated on Map 46, Grid 3.

**Boundary Justification (Explain why the boundaries were selected.)**

The property at 11425 Scaggsville Road has historically been associated with Parcel 337 since the building's construction circa 1875-1890.

=====  
11. Form Prepared By  
=====

name/title Andrea Bakewell Lowery  
organization Traceries date Nov. 10, 1997  
street & number 5420 Western Ave. telephone (301)656-5283  
city or town Chevy Chase state MD zip code 20815  
=====

12. Property Owner  
=====

name Betty L. Whetzel  
street & number 11425 Scaggsville Rd. telephone 301/957-1658  
city or town Fulton state MD zip code 20759  
=====

MARYLAND INVENTORY OF HISTORIC PROPERTIES  
CONTINUATION SHEET

Inventory No. HO-720

Section 7 Page 1

Whetzel Farm  
name of property  
Howard County, Maryland  
county and state

=====

T-shaped in plan and set on a solid parged foundation, the original dwelling at 11425 Scaggsville Road dates from circa 1875-1890. The wood frame, two-and-a-half-story, four-bay house is designed as a vernacular Gothic Revival-style dwelling. The wood frame walls, originally clad in German siding, have since been clad in asbestos shingles. A standing seam metal side gable roof with cornice returns covers the main body of the I-house with a cross gable roof marking the central bay, typical of the Gothic Revival style. Interior end brick chimneys with corbelled caps flank the composition. A two-story rear ell with an interior brick chimney at its ridge extends at the rear of the house. At the rear of the ell is a small one-story wood frame addition clad in German siding and covered by a gable roof. A one-story, four-bay porch with Tuscan columns and a hipped roof extends across the full width of the facade.

The Whetzel Farm is located on a hill above Scaggsville Road behind a commuter lot on the south side of the road. The land slopes to the south, and a number of outbuildings are scattered behind the original dwelling. A gravel drive runs from the east side of the original farm house to the modern dwelling erected at the west end of the property. Bushes have been planted around the original house, and a large shade tree grows at the northwest.

**EXTERIOR DESCRIPTION:**

The northeast elevation of the dwelling, the facade, is four bays in width. The southern inner bay of the first story contains the main entrance to the building. The door, a Craftsman-style multi-light door, is ornamented with a transom and square-edged wood surrounds. The remaining bays of the first story are each marked by a 6/6 wood window with square-edged casings with ears. Each of the bays at the second story of the facade is also marked by a 6/6 window with square-edged casings with ears. The upper half story is articulated at this elevation with a lancet one-light casement window at the center of the cross gable. A one-story porch, divided into four bays by wood Tuscan columns, extends across the facade.

The northwest elevation comprises the gable end of the house, the length of the rear ell, and the small one-story addition. The gable end is pierced at the basement by two windows, now boarded up with plywood. Four window openings mark the northwest elevation, both at the first and second stories, one at each story within the



MARYLAND INVENTORY OF HISTORIC PROPERTIES  
CONTINUATION SHEET

Inventory No. HO-720

Section 7 Page 2

Whetzel Farm  
name of property  
Howard County, MD  
county and state

=====

gable end and three at each story within the ell. All openings are filled with 2/2 windows with square edged casings except the westernmost second story window, which has been boarded up. Within the northwest elevation of the one-story addition at the rear of the ell are two windows, one 1/1 and one 6/6, and a single-leaf panelled door.

Much of the rear elevation of the house has been obscured by the construction of one-story additions. No original openings are visible at the first story of this elevation. At the rear of the ell, a one-story shed roof addition, pierced by a single-leaf door, has been constructed. A one-story porch, enclosed with a 16-light fixed window, fills the eastern corner of this T-shaped house. One original window remains intact at the second story of this elevation, a 2/2 window at the northern end of the elevation. The second-story window opening at the gable end of the ell has been boarded up.

The southeastern elevation comprises the gable end of the main body of the house, the length of the ell and two one-story additions. The gable end of the house is pierced by two windows, one 3-light awning and one one-light awning at the basement level and by a pair of 2/2 windows with square-edged casings at both the first and second stories. Much of the first story is obscured by the one-story enclosed porch in the corner of the "T." The porch has a central multi-light door and is enclosed with 16-light fixed windows. To the south of the porch, the first story of the ell is marked with a non-original 1/1 wood window. The southeastern wall of the one-story shed roof vestibule addition at the rear is pierced by a fixed 6-light window. The second story of the ell is pierced by three openings, two of which contain 2/2 windows with square-edged casings, and one of which has been boarded up.

**OUTBUILDINGS:**

At the rear of the house are a number of outbuildings associated with the farm. Directly northwest of the ell is a small shed that dates from the 1930s. The shed is set on a concrete foundation, and the wood frame walls are clad in German siding. A panelled door is located at the south end of the building, and 6/6 sash windows pierce the side walls. The shed is covered with a front gable roof.

MARYLAND INVENTORY OF HISTORIC PROPERTIES  
CONTINUATION SHEET

Inventory No. HO-720

Section 7 Page 3

Whetzel Farm  
name of property  
Howard County, MD  
county and state

=====  
Northwest of the shed is a machine shed that used to serve as a chicken coop. This building, which dates from the 1930s, is set on a concrete foundation, clad in vertical board siding, and covered with a corrugated metal gable roof.

Behind the house are a coop, now used as a storage shed, two silos, and two animal shelters. The most substantial building, the coop, is located at the east edge of this grouping of outbuildings. The coop. Constructed in the 1940s, the coop is set on a poured concrete foundation and clad in vertical board siding. The uneven gable roof is covered in standing seam sheet metal. Fixed 6/6 windows pierce the walls. South of the coop are two cylindrical corn silos, both set on concrete foundations, clad in metal mesh, and covered with conical metal roofs. North west of the silos are the animal shelters. One of these shelters was formerly a coop that dates from the 1940s, and the other dates from the 1960s. Both, now used to shelter goats, are of wood frame construction and covered with metal gable roofs.

To the west of these buildings is a large two-and-a-half-story hay barn that dates from the 1920s or early 1930s. The barn, set on a concrete foundation, is clad in vertical board siding and covered with a corrugated metal gambrel roof with a hay hood. Shed extensions have been erected both to the east and west, and a ventilator with a weathervane rises above the ridge of the roof.

To the south of these outbuildings is a small dilapidated feed shed dating to the 1930s. The shed is clad in vertical board siding and covered with a corrugated metal gable roof.

At the rear of the property is a large, modern prefabricated stable with metal siding and a front gable roof.

At the west end of the property is a ranch house that was built in 1979. The wood frame house, one-story with a walk-out basement, is clad in brick and parged at the base with aluminum siding above. An asphalt shingle side gable roof covers the house.

Immediately northwest of the house is a prefabricated shed clad in texture 1-11 and covered with a gambrel roof.

MARYLAND INVENTORY OF HISTORIC PROPERTIES  
CONTINUATION SHEET

Inventory No. HO-720

Section 8 Page 1

Whetzel Farm  
name of property  
Howard County, Maryland  
county and state

=====  
The property at 11425 Scaggsville Road is the result of the merging of several properties to form a large farm. These properties were associated with families who held large tracts of land in the late 19th century, including the Renns, the Scaggs, the Iagers, and the Warfields. In the 1910s, Joseph Frank Harrison began to amass land in this area. According to oral tradition, the Harrisons operated a large chicken farm in this location. In 1951, the Harrisons sold the farm to Charles and Caroline Soper. On October 24, 1976, Charles Soper died, leaving his 99.537-acre property to his heirs. He willed the northwestern third of the farm, including farm buildings, to his daughter, Betty L. Whetzel. The middle third of the property was left to Soper's son, Richard Warren Soper, and the southeastern third was left to his widow, Caroline. Since the Whetzels obtained the property, they have continued to farm this land. For many years, the family rented out the 19th century house, and in 1979 they constructed a dwelling for their own use at the northwest edge of the property.

The house presents a typical example of the vernacular Gothic Revival style, as adapted by rural Marylanders. This style, which gained popularity as a "rural" style, was often used in the construction of farmhouses and dwellings throughout agricultural communities across America at the turn of the 20th century. This house -- a two-and-a-half-story, T-shaped house with the center of the facade emphasized by a gable, and a lancet window in the gable -- is typical of the Gothic Revival style.

MARYLAND INVENTORY OF HISTORIC PROPERTIES  
CONTINUATION SHEET

Inventory No. HO-720

Whetzel Farm  
name of property  
Howard County, Maryland  
county and state

=====

**HISTORIC CONTEXT:**

**Geographic Organization:** Piedmont

**Chronological/Development Period (s):**

Industrial/ Urban Dominance (1870-1930)  
Modern Period (1930-present)

**Prehistoric/Historic Period Theme (s):**

Architecture, Landscape, and Community  
Planning  
Agriculture

**RESOURCE TYPE(S)**

**Category:** Building

**Historic Environment:** Rural

**Historic Function (s):** DOMESTIC/Single Dwelling

**Known Design Source:** Unknown

MARYLAND INVENTORY OF HISTORIC PROPERTIES  
CONTINUATION SHEET

Inventory No. HO-720

Whetzel Farm  
name of property  
Howard County, Maryland  
county and state

=====  
**Chain of Title:**

Deed A:

*Deeds A1 and A2:*

September 28, 1865 Rezin H. Snowden to George Aulcorn  
52 acres  
Land Records of Howard County  
Liber 26 Folio 400

*Deed A1:*

April 12, 1883 George Aulcorn to daughter Elizabeth Aulcorn,  
guardian for grandson George Aulcorn, son of  
John Aulcorn  
60 acres, mentions farm on which George  
Aulcorn lives  
Land Records of Howard County  
Liber LJW 46 Folio 214

April 24, 1888

George Alcorn to Robert and Elizabeth Alcorn  
60 acres for \$733.33  
Land Records of Howard County  
Liber LJW 53 Folio 495

*Deed A2:*

April 12, 1883

George Aulcorn to daughter Elizabeth Aulcorn  
Land Records of Howard County  
Liber LJW 46 Folio 213

October 27, 1896

Robert and Elizabeth Alcorn to John G. Rogers  
Land Records of Howard County  
Liber JHO 66 Folio 315

October 27, 1896

John G. Rogers, trustee, to Robert and  
Elizabeth Alcorn  
52 acres  
Land Records of Howard County  
Liber JHO 66 Folio 317

MARYLAND INVENTORY OF HISTORIC PROPERTIES  
CONTINUATION SHEET

Inventory No. HO-720

Whetzel Farm  
name of property  
Howard County, Maryland  
county and state

=====

*Deeds A1 and A2:*

January 19, 1907 Robert Alcorn, widower, to Thomas Miller  
Parker  
Conveyed 107 7/8 acres, combining two parcels  
Land Records of Howard County  
Liber WWLC 83 Folio 245

December 14, 1912 Thomas Miller and Elizabeth Parker to Joseph  
Frank Harrison  
Land Records of Howard County  
Liber WWLC 94 Folio 191

Deed B:

Unable to trace deed back further

March 22, 1890 Mary Cross, George and Leanna Giddings, and  
John H. and Caroline Cross, heirs of late  
Henry Cross, to Dennis Cross and Thomas Cross  
Part of previous land, conveyed 64 acres, 2  
roods, and 26 perches  
Land Records of Howard County  
Liber JHO 55 Folio 47

August 14, 1918 Reuben D. Rogers, Isaac Scaggs, James Clark,  
trustees in suit between John T. Cross et al  
(plaintiffs) v. Isaac Scaggs, et al  
(defendants) to George W. Giddings, Jr.  
Sold 64 acres, 2 roods and 26 perches for  
\$3242.49

August 30, 1919 George W. Giddings, Jr. and wife Nellie to  
Benjamin F. Murphy  
Conveyed 27 acres, 3 roods, 21 square perches,  
part of previous property  
Land Records of Howard County  
Liber 108 Folio 162

September 15, 1919 Benjamin F. and Ida E. Murphy to Joseph Frank  
Harrison  
Land Records of Howard County  
Liber MWB 222 Folio 442

MARYLAND INVENTORY OF HISTORIC PROPERTIES  
CONTINUATION SHEET

Inventory No. HO-720

Whetzel Farm  
name of property  
Howard County, Maryland  
county and state

=====

Deed C:

Deed C1:

December 31, 1867      John Renn and wife to Christopher Renn  
Land Records of Howard County  
Liber WWW 28                      Folio 530

Deed C2:

July 22, 1874              John Renn and wife to Christopher Renn  
Land Records of Howard County  
Liber LJW 34                      Folio 104

Deed C3:

May 10, 1865              Heirs of Robert O. Edmonston to Ethan A.  
Edmonston  
Land Records of Howard County  
Liber WWW 24                      Folio 428

September 2, 1877        Ethan A. and Mary V. Edmonston to Robert  
Edmonston  
Sold land for \$3000  
Land Records of Howard County  
Liber LJW 38                      Folio 326

October 1, 1878            Robert O. Edmonston to Henry Aaron and  
Christina Iager  
Sold land for \$2200  
Land Records of Howard County  
Liber LJW 40                      Folio 98

December 15, 1888        Henry A. and Christina Iager and Peter and  
Elizabeth Bauer to Christopher Renn  
Sold 7.5 acres of Neal's Delight for \$187.50,  
part of previous property  
Land Records of Howard County  
Liber LJW 51                      Folio 396

Deed C4:

March 3, 1874              Benjamin H. Dorsey to Seth W. Warfield  
Land Records of Howard County  
Liber LJW 33                      Folio 334

MARYLAND INVENTORY OF HISTORIC PROPERTIES  
CONTINUATION SHEET

Inventory No. HO-720

Whetzel Farm  
name of property  
Howard County, Maryland  
county and state

=====

November 11, 1884     Seth W. and Lydia Warfield to Christopher Renn  
Sold 6 acres and 28 square perches of Neal's  
Delight or Mobley's Purchase, part of previous  
property, for \$247

*Deeds C1, C2, C3, and C4:*

November 18, 1899     Christopher and Barbara Renn to George W. Renn  
Sold 69 acres and 28 perches, four parcels of  
Neal's Delight, for \$1800  
Land Records of Howard County  
Liber JHO 71                             Folio 287

January 9, 1917        George W. and Louise E. Renn to Joseph F.  
Harrison  
50 acres  
Land Records of Howard County  
Liber HBN 103                            Folio 191

Deeds A, B, and C:

February 9, 1951        Martha E. Harrison to Charles R. and Caroline  
C. Soper  
Land Records of Howard County  
Liber HBN 108                            Folio 512

September 23, 1960     Charles R. and Caroline C. Soper to Maybelle  
Ankney  
Land Records of Howard County  
Liber RHM 361                            Folio 395

September 24, 1960     Maybelle Ankney, unmarried, to Charles R. Soper  
138 acres comprised of 3 parcels of the  
Harrison land, with 5 exceptions  
Land Records of Howard County  
Liber RHM 361                            Folio 397



MARYLAND INVENTORY OF HISTORIC PROPERTIES  
CONTINUATION SHEET

Inventory No. HO-720

Whetzel Farm  
name of property  
Howard County, Maryland  
county and state

=====

July 9, 1976

Charles R. Soper, died testate October 24, 1973, leaving the northwestern third of his 99.537 acre property, including farm buildings, to his daughter, Betty L. Whetzel. According to Charles Soper's will (Wills Liber 19, Folio 131), the middle third of the property was left to Soper's son, Richard Warren Soper, and the southeastern third was left to his widow, Caroline. The property is described as part of the previous 138 acres, located south of 216 and west of Old Columbia Road  
Land Records of Howard County  
Liber CMP 813 Folio 575

# Resource Sketch Map

HO-720

11425 Scaggsville Rd. - Wenzel Farm, Fulton, Howard County, MD

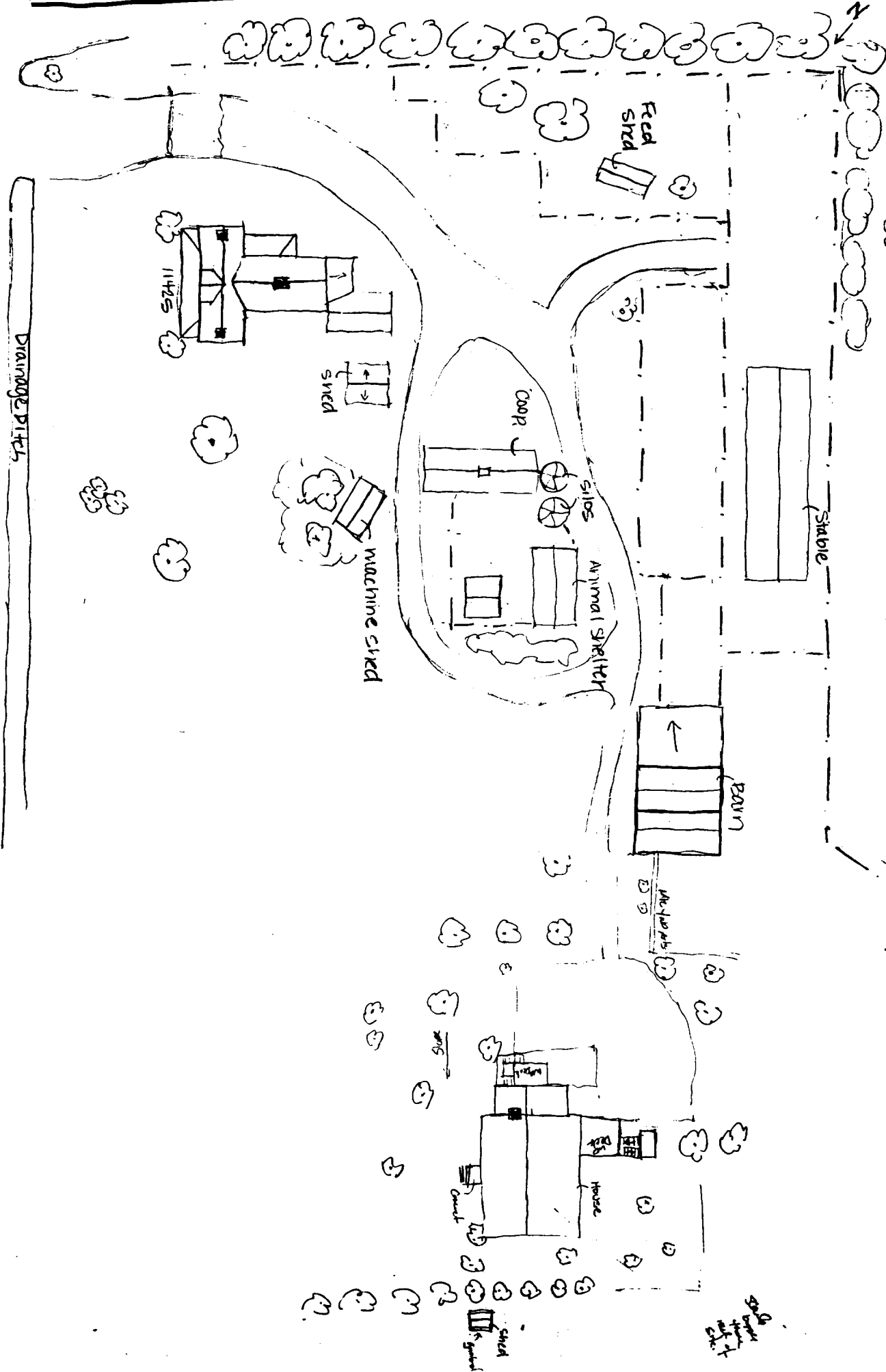

To Scaggsville rd

Commuter Parking

Drainage ditch

Shed

Shed

Garage

House

Counch

Stable

BARN

Animal Shelter

Silo

Coop

Machine shed

shed

HAY

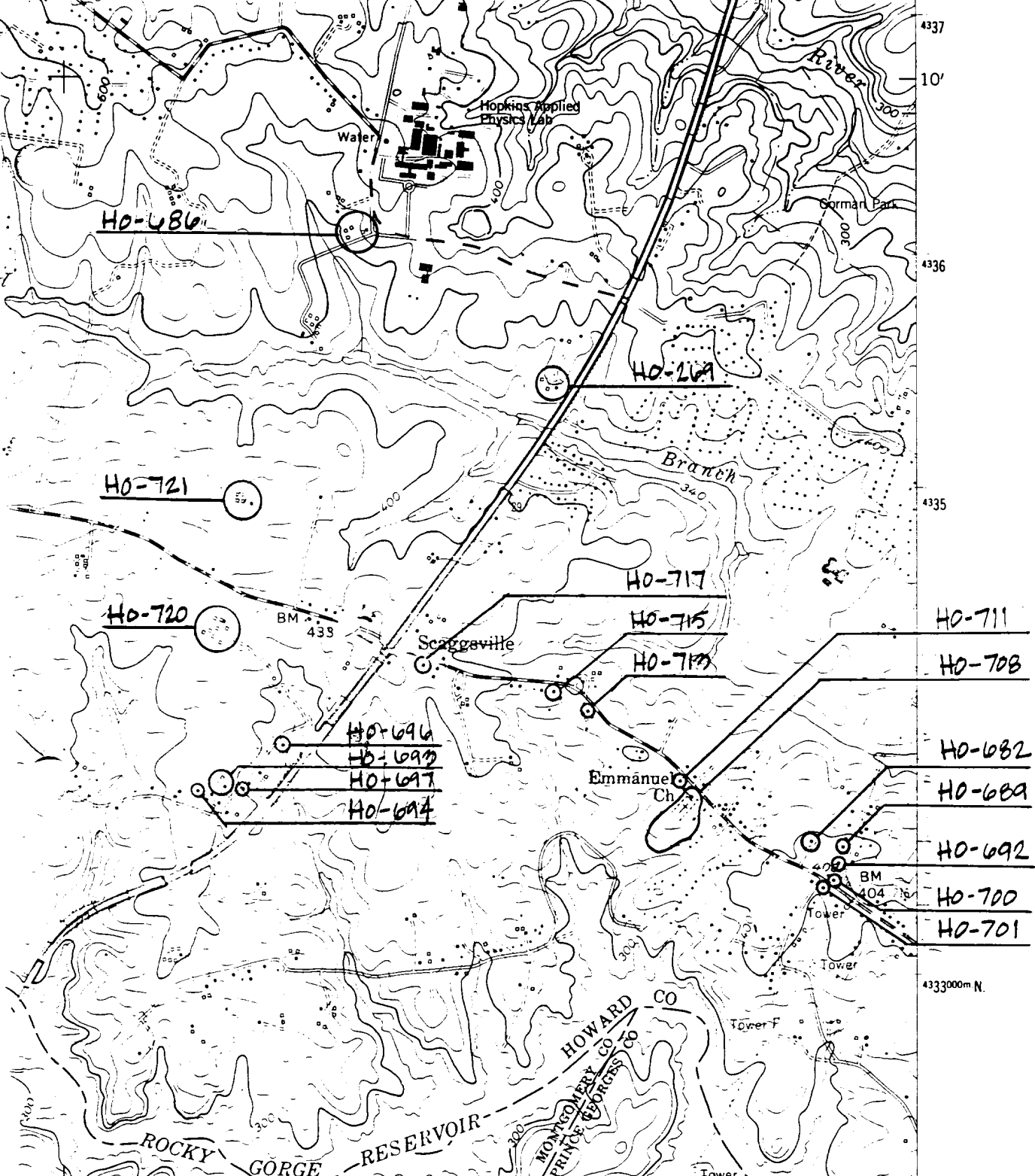

55' 335 336 337 338 339 340 341 342 343 344 345 346 347 348 349 350 351 352 353 354 355 356 357 358 359 360 361 362 363 364 365 366 367 368 369 370 371 372 373 374 375 376 377 378 379 380 381 382 383 384 385 386 387 388 389 390 391 392 393 394 395 396 397 398 399 400 401 402 403 404 405 406 407 408 409 410 411 412 413 414 415 416 417 418 419 420 421 422 423 424 425 426 427 428 429 430 431 432 433 434 435 436 437 438 439 440 441 442 443 444 445 446 447 448 449 450 451 452 453 454 455 456 457 458 459 460 461 462 463 464 465 466 467 468 469 470 471 472 473 474 475 476 477 478 479 480 481 482 483 484 485 486 487 488 489 490 491 492 493 494 495 496 497 498 499 500

1/4 MILE  
 ROAD CLASSIFICATION  
 Heavy-duty ——— Light-duty ———  
 Medium-duty ——— Unimproved dirt - - - - -  
 U. S. Route State Route

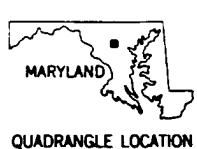

CLARKSVILLE, MD.  
 NW/4 LAUREL 15' QUADRANGLE  
 39076-B8-TF-024

1957  
 PHOTOREVISED 1979  
 DMA 5662 III NW—SERIES V833

To place on the predicted North American Datum 1983  
 move the projection lines 8 meters south and  
 26 meters west as shown by dashed corner ticks

(LAUREL)  
 5662 III SE



HO-720

Whetzel Farm

Howard County, MD

Traces

October 1997

Maryland SHPO

Main House, looking southwest

1 of 15



HO-720  
Whetzel Farm  
Howard County, MD  
Traceries  
October 1997  
Maryland SHPO  
Mainhouse, northwest elevation  
2 of 15





HO-720

Wetzel Farm

Howard County, MD

Traceries

October 1997

Maryland SHPO

Main house, Northeast elevation

4 of 15



HO-720

Whetzel Farm

Howard County, MD

Traceries

October 1997

Maryland SHPO

Main House, Southeast Elevation

3 of 15



HO-720

Whetzel Farm

Howard County, MD

Traceries

October 1997

Maryland SHPO

Shed, looking south

S of IS

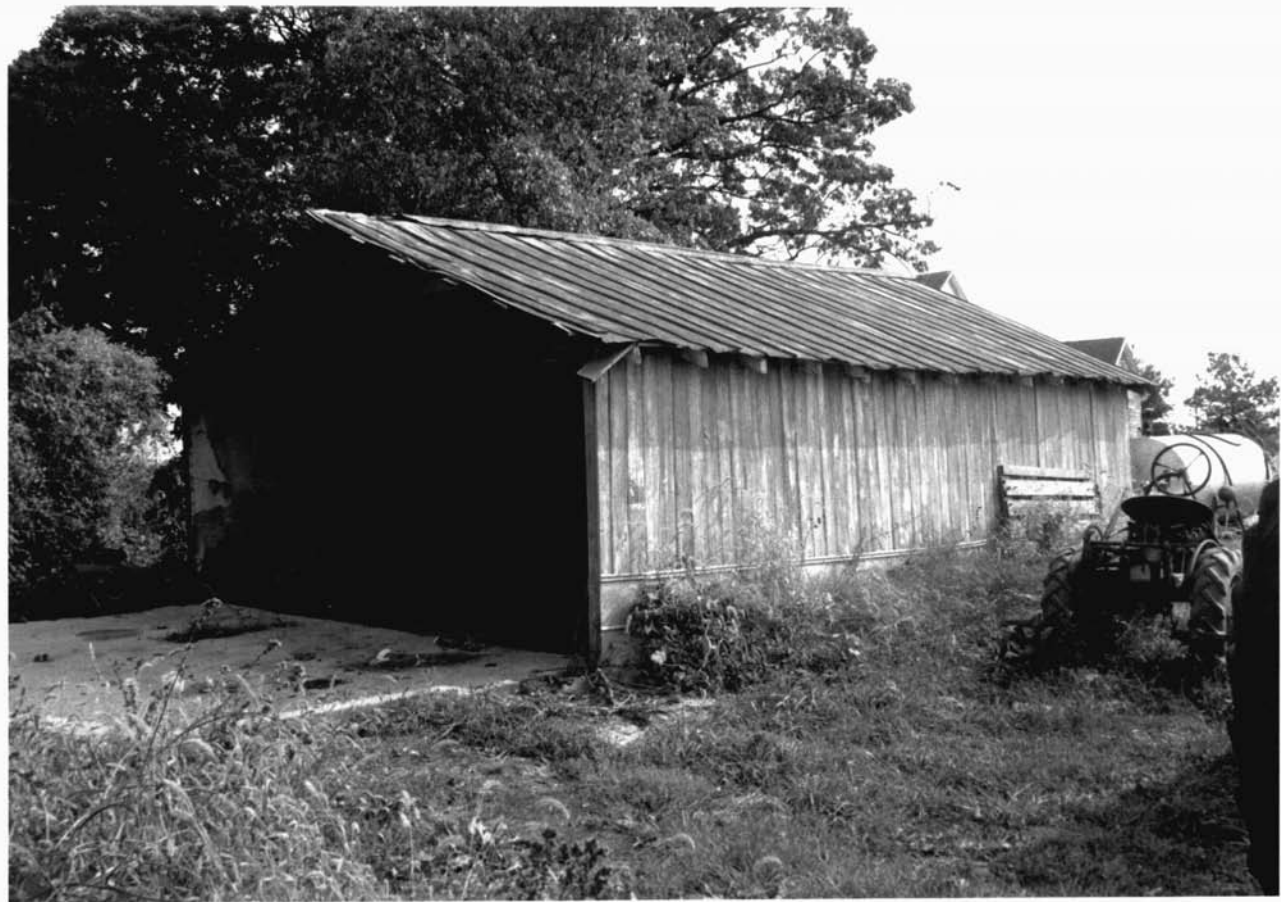

HO-720

Whetzel Farm

Howard County, MD

Tracenes

October 1997

Maryland SHPO

Machine Shed, west corner

6 of 15





HO-720

Wetzel Farm

Howard County, MD

Traceries

October 1997

Maryland SHPO

Animal Shelters? Barn, looking west, with barn in background

7 of 15



HO-720

Whetzel Farm

Howard County, MD

Traceries

October 1997

Maryland SHPO

Silo and Coop, looking north

8 of 15



HO-720

Wetzel Farm

Howard County, MD

Traceries

October 1997

Maryland SHPO

Animal Shelter & Silo, looking northwest

9 of 15



HO-720  
Whetzel Farm  
Howard County, MD  
Traceries  
October 1997  
Maryland SHPO  
Feed, Shed, looking North  
10 of 15





H0-720

Whetzel Farm

Howard County, MD

Traceries

October 1997

Stable, looking south

11 of 15



HO-720

Whetzel Farm

Howard County, MD

Tracenes

October 1997

Barn, looking west

12 of 15



HO-720

Whetzel Farm

Howard County, MD

Traceries

October 1997

House, looking south

13 of 15



HO-720

Whetzel Farm

Howard County, MD

Traceries

October 1997

House, looking north

14 of 15





HO-720

Whetzel Farm

Howard County, MD

Traceries

October 1997

Shed, looking northeast

15 of 15