

**INDIVIDUAL PROPERTY/DISTRICT  
MARYLAND HISTORICAL TRUST  
INTERNAL NR-ELIGIBILITY REVIEW FORM**

Property/District Name: 10787 Scaggsville Road Survey Number: HO-711

Tax Parcel#: 99

Project: Maryland 216/29 Project Planning Study Agency: MDOT-SHA

Site visit by MHT Staff:  no  yes Name \_\_\_\_\_ Date \_\_\_\_\_

Eligibility recommended \_\_\_\_\_ Eligibility **not** recommended  \_\_\_\_\_

Criteria:  A  B  C  D Considerations:  A  B  C  D  E  F  G  None

Justification for decision: (Use continuation sheet if necessary and attach map)

The house at 10787 Scaggsville Road is not eligible due to the fact that it does not meet National Register Criteria A, B, C, or D. Preliminary research has not revealed any association between the dwelling and events that have made a significant contribution to the broad patterns of our history (Criterion A) or the lives of persons significant in our past (Criterion B). Although the building provides an example of the Craftsman-Bungalow style, it is neither unusual nor distinguished; it does not represent the work of a master or display high artistic merit (Criterion C). There is no evidence that the property is likely to yield information important in history or prehistory (Criterion D). Thus, the property is not National Register-eligible.

Documentation on the property/district is presented in: Maryland Historical Trust Inventory Form  
and Maryland 29/216 Project Planning Report

Prepared by: Tracerics, 5420 Western Ave., Chevy Chase, MD 20815 November 1997

Conner - O'Brien Date 2/10/98  
Reviewer, Office of Preservation Services Date

NR program concurrence:  yes  no  not applicable

M. Kuntz Date 3/31/99  
Reviewer, NR Program Date

*gms*

**CAPSULE SUMMARY**  
10787 Scaggsville Road  
(HO-711)

Constructed in 1941, the residence at 10787 Scaggsville Road was designed as a Craftsman-style bungalow. The 1-1/2-story, side gable frame house is set on a panel-faced concrete block foundation. The building's rectangular footprint is interrupted by a one-story, enclosed frame porch set at the center of the rear elevation and by a shallow, projecting rectangular box-bay with a shed roof. Matching gable front dormers pierce the front and rear roof planes, and a full-width, one-story, three-bay porch is incorporated under the main roof at the front. The porch is supported on Craftsman-style columns consisting of dwarf Doric columns set atop brick piers. The building has been only minimally altered by the addition of aluminum siding and the enclosure of the rear porch.

The property has remained in the Scaggs family since the construction of the dwelling. The house passed from its original owners, Arthur and Bessie Scaggs, to their two children Melvin Scaggs and Elsie L. Souder, who was married to Eugene Souder. Eventually, Elsie and Eugene Souder became sole owners of the property. Until the end of 1978, the house was retained by various members of the Souder family. At that time it was passed to a family company, Souder Builders, Inc.

MARYLAND HISTORICAL TRUST  
MD INVENTORY OF HISTORIC PROPERTIES

Inventory No. HO-711

=====

1. Name of Property

=====

historic name \_\_\_\_\_

common/other name \_\_\_\_\_

=====

2. Location

=====

street & number 10787 Scaggsville Road not for publication \_\_\_\_\_

city or town Laurel vicinity \_\_\_\_\_ state Maryland code MD

county Howard County code 27 zip code 20723

=====

3. State/Federal Agency Certification N/A

=====

4. National Park Service Certification N/A

=====

5. Classification

=====

Ownership of Property (Check all that apply)

- private
- public-local
- public-State
- public-Federal

Category of Property (Check only one box)

- building(s)
- district
- site
- structure
- object

Number of Resources within Property

Contributing		Noncontributing		
<u>1</u>		<u>1</u>		buildings
<u>0</u>		<u>0</u>		sites
<u>0</u>		<u>0</u>		structures
<u>0</u>		<u>0</u>		objects
<u>1</u>		<u>1</u>		Total

Is this property listed in the National Register?

Yes \_\_\_\_\_ Name of Listing \_\_\_\_\_

No X

=====  
6. Function or Use  
=====

Historic Functions (Enter categories from instructions)

Cat: DOMESTIC Sub: Single Dwelling

Current Functions (Enter categories from instructions)

Cat: DOMESTIC Sub: Single Dwelling

=====  
7. Description  
=====

Architectural Classification (Enter categories from instructions)

Bungalow/Craftsman

Materials (Enter categories from instructions)

foundation Solid: Panel-faced Concrete Block

roof Side Gable: Asphalt Shingles

walls Wood Frame: Aluminum Siding

other \_\_\_\_\_

Narrative Description (Describe the historic and current condition of the property.)

See Continuation Sheet No. 7-1

=====  
8. Statement of Significance  
=====

Applicable National Register Criteria (Mark "x" in one or more boxes for the criteria qualifying the property for National Register listing)

- A Property is associated with events that have made a significant contribution to the broad patterns of our history.
- B Property is associated with the lives of persons significant in our past.
- C Property embodies the distinctive characteristics of a type, period, or method of construction or represents the work of a master, or possesses high artistic values, or represents a significant and distinguishable entity whose components lack individual distinction.
- D Property has yielded, or is likely to yield information important in prehistory or history.

Criteria Considerations (Mark "X" in all the boxes that apply.)

- A owned by a religious institution or used for religious purposes.
- B removed from its original location.
- C a birthplace or a grave.
- D a cemetery.
- E a reconstructed building, object, or structure.
- F a commemorative property.
- G less than 50 years of age or achieved significance within the past 50 years.

Maryland Inventory of Historic Properties  
10787 Scaggsville Road  
Howard County, Maryland

Inventory No. HO-711  
Page 4

=====  
Areas of Significance (Enter categories from instructions)

Architecture  
\_\_\_\_\_  
\_\_\_\_\_

Period of Significance 1941-present  
\_\_\_\_\_  
\_\_\_\_\_

Significant Dates 1941  
\_\_\_\_\_  
\_\_\_\_\_

Significant Person (Complete if Criterion B is marked above)  
\_\_\_\_\_

Cultural Affiliation Undefined  
\_\_\_\_\_  
\_\_\_\_\_

Architect/Builder Unknown  
\_\_\_\_\_

Narrative Statement of Significance (Explain the significance of the property.)

See Continuation Sheet No. 8-1

=====  
9. Major Bibliographical References  
=====

(Cite the books, articles, legal records, and other sources used in preparing this form.)

Howard County Land Records, Recorder of Deeds, Howard County, Ellicott City, Maryland.

=====  
10. Geographical Data  
=====

Acreage of Property 26,339 Square Feet

**Verbal Boundary Description (Describe the boundaries of the property.)**

The property at 10787 Scaggsville Road is designated as Parcel 99, Grid 81 as indicated on Map 46.

**Boundary Justification (Explain why the boundaries were selected.)**

The property at 10787 Scaggsville Road has historically been associated with Parcel 99 since the building's construction in 1941.

=====  
11. Form Prepared By  
=====

name/title Kathryn A. Gettings, Architectural Historian  
organization Traceries date October 30, 1997  
street & number 5420 Western Avenue telephone 301/656-5283  
city or town Chevy Chase state MD zip code 23185

=====  
12. Property Owner  
=====

name Souder Builders  
street & number 9335 Old Scaggsville Rd. telephone 301/725-5772  
city or town Laurel state MD zip code 20723  
=====

MARYLAND INVENTORY OF HISTORIC PROPERTIES  
CONTINUATION SHEET

Inventory No. HO-711

Section 7 Page 1

10787 Scaggsville Road  
name of property  
Howard County, Maryland  
county and state

=====  
Constructed in 1941, the residence at 10787 Scaggsville Road was designed as a Craftsman-style Bungalow. The 1-1/2-story, side gable frame house is set on a panel-faced concrete block foundation. The building's rectangular footprint is interrupted by a one-story, enclosed frame porch set at the center of the rear elevation and by a shallow, projecting rectangular box-bay with a shed roof. Matching gable front dormers pierce the front and rear roof planes, and a full-width, one-story, three-bay porch is incorporated under the main roof at the front. The porch is supported on Craftsman-style columns consisting of dwarf Doric columns set atop brick piers. The building has been only minimally altered by the addition of aluminum siding and the enclosure of the rear porch.

The dwelling at 10787 Scaggsville Road occupies a large lot on the southwest side of Scaggsville Road. Facing northeast, the house is set back approximately sixty feet from the road. The property, which consists of 26,339 square feet, is dotted with mature trees at the front. Pine trees demarcate the southeast boundary of the site, and a long paved drive, Cairn Wind Way, extends past the house to the rear where several newer dwellings stand.

**EXTERIOR DESCRIPTION:**

A one-story, three-bay front porch dominates the facade of the dwelling at 10787 Scaggsville Road. The facade or northeast elevation is divided into three bays, the center of which contains the main entry. This central opening is filled with a single-leaf, Craftsman-style, panel-and-light door. The main entrance is flanked on either side by window bays. The southeastern of these two bays holds a pair of 3/1 windows, while the northwest bay contains a single window with the same light pattern. The upper half-story is marked by a group of three 3/1 windows. The windows and the door on this elevation are trimmed with simple square-edged wood moldings.

The northwest wall of the building contains three stories, each pierced by a combination of openings. The concrete block foundation contains three openings. One of these openings holds an overhead metal rolling garage door that is paneled and lighted. Two three-light, casement windows provide light to the basement on the northwest. The first story contains three 3/1 windows of varying sizes. Above these, in the upper half story, a pair of 3/1 windows pierces the wall. With the exception of the basement windows and garage door, the windows of this elevation feature the



MARYLAND INVENTORY OF HISTORIC PROPERTIES  
CONTINUATION SHEET

Inventory No. HO-711

Section 7 Page 2

10787 Scaggsville Road  
name of property  
Howard County, Maryland  
county and state

=====

same square-edged wood molding appearing on the facade.

The rear of the building is dominated by a projecting porch which appears to have been enclosed. A single metal sliding glass door has been added to the porch, while a single 3/1 window is located within the enclosed porch, having been moved from another location. The second story dormer contains a pair of the same 3/1 sash windows surrounded with square-edged wood trim.

The building's southeast elevation is divided into four openings at the first story. The center two of these openings are located within the rectangular box-bay that projects from the principle plane of the southeast elevation. All four openings contain 3/1 windows of varying sizes. A pair of 3/1 windows marks the half-story above. The windows are all trimmed in square-edged wood moldings.

**OUTBUILDINGS:**

One outbuilding associated with 10787 Scaggsville Road stands southwest of the main dwelling. Constructed of concrete block, this one-story, side gable, three-car garage appears to have been built in the 1960s. Each bay is filled with a metal, overhead rolling door. The interior is lit by 2/2 windows, and the roof covered in asphalt shingles.

MARYLAND INVENTORY OF HISTORIC PROPERTIES  
CONTINUATION SHEET

Inventory No. HO-711

Section 8 Page 1

10787 Scaggsville Road  
name of property  
Howard County, Maryland  
county and state

=====  
The modest Craftsman-style Bungalow dwelling at 10787 Scaggsville Road was erected in 1941 for Arthur E. Scaggs and his wife Bessie L. Scaggs. The building is representative of the Bungalow form which was popular in this area during the 1920s, 1930s, and 1940s. The Bungalow form offered the homeowner an economical dwelling easily erected and maintained.

The property has remained in the Scaggs family since the construction of the dwelling. The house passed from its original owners, Arthur and Bessie Scaggs, to their two children Melvin Scaggs and Elsie L. Souder, who was married to Eugene Souder. Eventually, Elsie and Eugene Souder became sole owners of the property. Until the end of 1978, the house was retained by various members of the Souder family. At that time it was passed to a family company, Souder Builders, Inc.

MARYLAND INVENTORY OF HISTORIC PROPERTIES  
CONTINUATION SHEET

Inventory No. HO-711

10787 Scaggsville Road  
name of property  
Howard County, Maryland  
county and state

=====

HISTORIC CONTEXT:

Geographic Organization: Piedmont

Chronological/Development Period (s):

Modern Period (1930-present)

Prehistoric/Historic Period Theme (s):

Architecture, Landscape, and  
Community Planning

RESOURCE TYPE(S)

Category: Building

Historic Environment: Rural

Historic Function (s): DOMESTIC/Single Dwelling

Known Design Source: Unknown

MARYLAND INVENTORY OF HISTORIC PROPERTIES  
CONTINUATION SHEET

Inventory No. HO-711

10787 Scaggsville Road  
name of property  
Howard County, Maryland  
county and state

=====  
**Chain of Title:**

July 6, 1907	John H. and Mary E. Hines to Arthur E. Scaggs Land Records of Howard County Liber WWLC 84 Folio 413
September 13, 1944	Arthur E. Scaggs to Marie F. Myers, unmarried Land Records of Howard County Liber BMJr. 182 Folio 525
September 13, 1944	Marie F. Myers, unmarried to Arthur E. and Bessie L. Scaggs Land Records of Howard County Liber BMJr. 182 Folio 535
January 25, 1956	Bessie L. Scaggs to Elsie L. Souder and Melvin F. Scaggs to convey upon death Arthur Scaggs, deceased December 28, 1949 Bessie L. Scaggs, deceased June 20, 1961 Land Records of Howard County Liber RHM 278 Folio 271
March 8, 1962	Eugene D. Souder and wife, Elsie L. Souder and Melvin E. Scaggs and wife, Myrtle E. Scaggs to John L. Clark Land Records of Howard County Liber WHH 381 Folio 352
April 3, 1962	John L. Clark to Eugene Souder and Elsie L. Souder Land Records of Howard County Liber WHH 381 Folio 354
June 22, 1977	Eugene D. Souder to Robert C. Wright Elsie L. Souder, deceased December 14, 1973 Land Records of Howard County Liber CMP 829 Folio 493
June 22, 1977	Robert C. Wright to Eugene D. Souder Land Records of Howard County Liber CMP 830 Folio 569
December 29, 1978	Eugene D. Souder to Souder Builders, Inc. Land Records of Howard County Liber CMP 945 Folio 132

# RESOURCE SKETCH MAP

HO-711

10787 Scaggsville Rd.  
Laurel, Howard County, MD

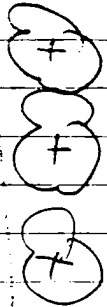
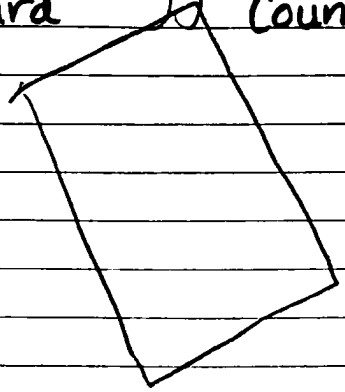
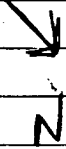

1-story  
concrete block  
garage

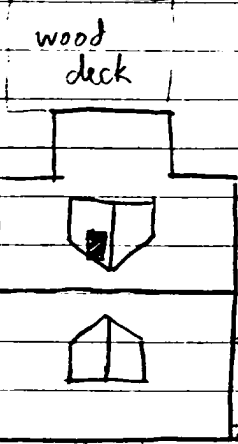
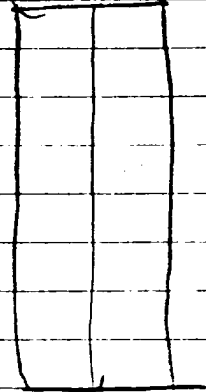

Cairn Wind

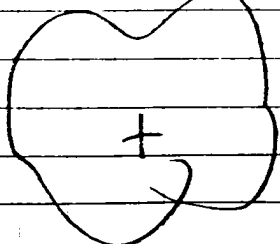
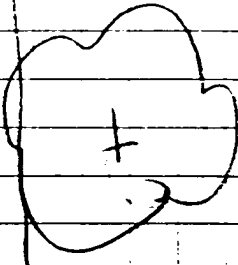
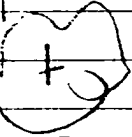
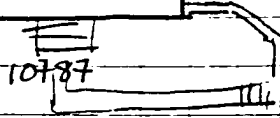

Scaggsville Rd.

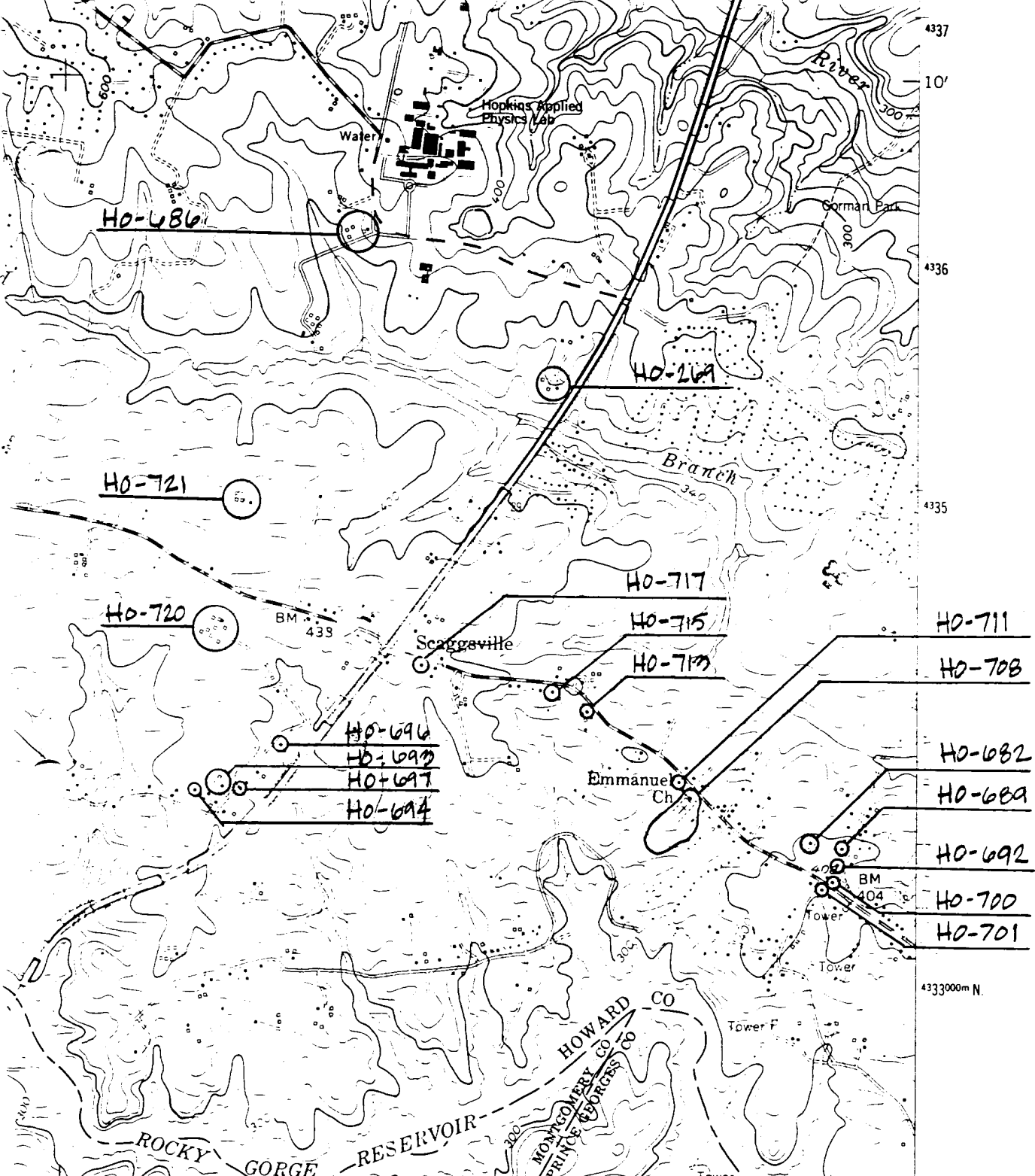

55' 335 336 INTERIOR—GEOLOGICAL SURVEY RESTON VIRGINIA—1989 37000m E 39°07'30" 76°52'30" 433000m N

1 MILE  
 ROAD CLASSIFICATION  
 Heavy-duty ——— Light-duty ———  
 Medium-duty ——— Unimproved dirt - - - - -  
 U. S. Route State Route

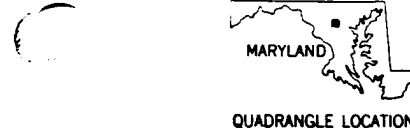

CLARKVILLE, MD.  
 NW/4 LAUREL 15' QUADRANGLE  
 39076-B8-TF-024

1957  
 PHOTOREVISED 1979  
 DMA 5662 III NW—SERIES V833

To place on the predicted North American Datum 1983  
 move the projection lines 8 meters south and  
 26 meters west as shown by dashed corner ticks

(LAUREL)  
 5662 III SE



HO-711

10787 Scaggsville Rd.

Howard County, MD

Traceries

September 1997

Maryland SHPO

House, NE Elevation

1 of 5





HO-711

10787 Scaggsville Rd.

Howard Co., Md.

Tracenes

September 1997

Maryland SHPO

House, NW - Elevation

2 of 5



HO-711

10787 Scaggsville Rd.

Howard County, MD

Tracenes

September 1997

Maryland SHPO

House, SW Elevation

3 of 5



HO-711

10787 Scaggsville Rd.

Howard County, MD

Traceries

September 1997

Maryland SHPO

House, SE Elevation

4 of 5



HO-711

10787 Scaggsville Rd.

Howard County, MD

Traceries

September 1997

Maryland SHPO

Garage, SE Elevation

5 of 5