

**INDIVIDUAL PROPERTY/DISTRICT  
MARYLAND HISTORICAL TRUST  
INTERNAL NR-ELIGIBILITY REVIEW FORM**

Property/District Name: 10756 Scaggsville Road Survey Number: HO-709

Tax Parcel#: 5

Project: Maryland 216/29 Project Planning Study Agency: MDOT-SHA

Site visit by MHT Staff:  no  yes Name \_\_\_\_\_ Date \_\_\_\_\_

Eligibility recommended \_\_\_\_\_ Eligibility **not** recommended  X

Criteria:  A  B  C  D Considerations:  A  B  C  D  E  F  G  None

Justification for decision: (Use continuation sheet if necessary and attach map)

The house at 10756 Scaggsville Road is not eligible due to the fact that it does not meet National Register Criteria A, B, C, or D. Preliminary research has not revealed any association between the dwelling and events that have made a significant contribution to the broad patterns of our history (Criterion A) or the lives of persons significant in our past (Criterion B). Vernacular in design, it is neither unusual nor distinguished; it does not represent the work of a master or display high artistic merit (Criterion C). There is no evidence that the property is likely to yield information important in history or prehistory (Criterion D). Thus, the property is not National Register-eligible.

Documentation on the property/district is presented in: Maryland Historical Trust Inventory Form

and Maryland 29/216 Project Planning Report

Prepared by: Tracerics, 5420 Western Ave., Chevy Chase, MD 20815 November 1997

*Colin Conner* Date 7/10/98  
Reviewer, Office of Preservation Services

NR program concurrence:  yes  no  not applicable

*B. Kuntz* Date 3/31/99  
Reviewer, NR Program

*Am*

**CAPSULE SUMMARY**  
10756 Scaggsville Road  
(HO-709)

Constructed at the turn of the twentieth century, the vernacular dwelling at 10756 Scaggsville Road was originally an T-shaped two-story, three-bay, cross gable roof residence. The house is set on a solid stone foundation, and the wood frame walls are clad in vinyl German siding. The cross gable roof is covered in standing seam sheet metal. An exterior brick chimney, laid in stretcher bond, rises at the original section of the northwest elevation, and a one-story, two-bay porch with square wood posts and a standing seam, sheet metal, shed roof extends across a portion of the facade. A large, two-story, single pile addition extended the rear ell, and a one-story, L-shaped porch with a shed roof was erected at the eastern interior corner of the southwest and northeast elevations.

The dwelling was most likely built by John H. Hines after he purchased the property in November of 1892. The property transferred to John T. and Ida Fyock Hines in 1942, upon the death of John H. Hines. The Hines family still retains ownership of 10756 Scaggsville Road.

The property at 10756 Scaggsville Road illustrates a typical farm house at the turn-of-the-century. The original house and four historic outbuildings provide a strong example of a working farm in rural Maryland during the beginning of the twentieth century.

MARYLAND HISTORICAL TRUST  
MD INVENTORY OF HISTORIC PROPERTIES

Inventory No. HO-709

=====

1. Name of Property

=====

historic name \_\_\_\_\_  
common/other name \_\_\_\_\_

=====

2. Location

=====

street & number 10756 Scaggsville Road not for publication \_\_\_\_\_  
city or town Laurel vicinity \_\_\_\_\_ state Maryland code MD  
county Howard code 027 zip code 20723

=====

3. State/Federal Agency Certification N/A

=====

4. National Park Service Certification N/A

=====

5. Classification

=====

Ownership of Property (Check all that apply)

- private
- public-local
- public-State
- public-Federal

Category of Property (Check only one box)

- building(s)
- district
- site
- structure
- object

Number of Resources within Property

Contributing		Noncontributing		
<u>5</u>		<u>2</u>		buildings
<u>0</u>		<u>0</u>		sites
<u>0</u>		<u>0</u>		structures
<u>0</u>		<u>0</u>		objects
<u>5</u>		<u>2</u>		Total

Is this property listed in the National Register?

Yes \_\_\_\_\_ Name of Listing \_\_\_\_\_  
No X

=====  
6. Function or Use  
=====

Historic Functions (Enter categories from instructions)

Cat: DOMESTIC Sub: SINGLE DWELLING  
AGRICULTURE AGRICULTURAL OUTBUILDINGS

Current Functions (Enter categories from instructions)

Cat: DOMESTIC Sub: SINGLE DWELLING  
AGRICULTURE AGRICULTURAL OUTBUILDINGS

=====  
7. Description  
=====

Architectural Classification (Enter categories from instructions)

Vernacular  
\_\_\_\_\_  
\_\_\_\_\_

Materials (Enter categories from instructions)

foundation Solid: Stone, Parged  
roof Cross Gable: Standing Seam Sheet Metal  
walls Wood Frame: Vinyl German Siding  
other \_\_\_\_\_  
\_\_\_\_\_

Narrative Description (Describe the historic and current condition of the property.)

See Continuation Sheet No. 7-1

=====  
8. Statement of Significance  
=====

Applicable National Register Criteria (Mark "x" in one or more boxes for the criteria qualifying the property for National Register listing)

- A Property is associated with events that have made a significant contribution to the broad patterns of our history.
- B Property is associated with the lives of persons significant in our past.
- C Property embodies the distinctive characteristics of a type, period, or method of construction or represents the work of a master, or possesses high artistic values, or represents a significant and distinguishable entity whose components lack individual distinction.
- D Property has yielded, or is likely to yield information important in prehistory or history.

Criteria Considerations (Mark "X" in all the boxes that apply.)

- A owned by a religious institution or used for religious purposes.
- B removed from its original location.
- C a birthplace or a grave.
- D a cemetery.
- E a reconstructed building, object, or structure.
- F a commemorative property.
- G less than 50 years of age or achieved significance within the past 50 years.

Maryland Inventory of Historic Properties  
10756 Scaggsville Road  
Howard County, Maryland

Inventory No. HO-709  
Page 4

=====  
Areas of Significance (Enter categories from instructions)

Architecture  
Agriculture  
\_\_\_\_\_

Period of Significance ca. 1890-present  
\_\_\_\_\_  
\_\_\_\_\_

Significant Dates ca. 1890-1900  
\_\_\_\_\_  
\_\_\_\_\_

Significant Person (Complete if Criterion B is marked above)  
\_\_\_\_\_

Cultural Affiliation Undefined  
\_\_\_\_\_  
\_\_\_\_\_

Architect/Builder Unknown  
\_\_\_\_\_

Narrative Statement of Significance (Explain the significance of the property.)

See Continuation Sheet No. 8-1

=====  
9. Major Bibliographical References  
=====

(Cite the books, articles, legal records, and other sources used in preparing this form.)

Howard County Land Records, Recorder of Deeds, Howard County, Ellicott City, Maryland.

=====  
10. Geographical Data  
=====

Acreage of Property 15.85 acres

**Verbal Boundary Description (Describe the boundaries of the property.)**

The property at 10756 Scaggsville Road is designated as Parcel 5, as indicated on Map 46, Grid 11.

**Boundary Justification (Explain why the boundaries were selected.)**

The property at 10756 Scaggsville Road has historically been associated with Parcel 5 since the building's construction circa 1890.

=====  
11. Form Prepared By  
=====

name/title Kristyna G. Olsen, Architectural Historian  
organization Traceries date October 29, 1997  
street & number 5420 Western Avenue telephone 301/656-5283  
city or town Chevy Chase state MD zip code 20815

=====  
12. Property Owner  
=====

name John T. and Ida Fyock Hines  
street & number 10752 Scaggsville Rd. telephone \_\_\_\_\_  
city or town Laurel state MD zip code 20723  
=====

MARYLAND INVENTORY OF HISTORIC PROPERTIES  
CONTINUATION SHEET

Inventory No. HO-709

Section 7 Page 1

10756 Scaggsville Road  
name of property  
Howard County, Maryland  
county and state

=====  
Constructed at the turn of the century, the vernacular dwelling at 10756 Scaggsville Road was originally an T-shaped two-story, three-bay, cross gable roof residence. The house is set on a solid stone foundation, and the wood frame walls are clad in vinyl German siding. The cross gable roof is covered in standing seam sheet metal. An exterior brick chimney, laid in stretcher bond, rises at the original section of the northwest elevation, and a one-story, two-bay porch with square wood posts and a standing seam, sheet metal, shed roof extends across a portion of the facade. A large, two-story, single pile addition extended the rear ell, and a one-story, L-shaped porch with a shed roof was erected at the eastern interior corner of the southwest and northeast elevations.

The house is set on a slight rise above the road. The property is dominated to the south by mature trees, and several outbuildings stand to the east of the house. The dwelling addresses Scaggsville Road to the southwest, and a gravel drive leads from the road across the northeast edge of the property, past the main facade, provides access to the various outbuildings.

**EXTERIOR DESCRIPTION:**

The facade of the house is L-shaped, with a one-story two-bay porch in the corner of the "L." The main entrance to the house is situated in the center bay of the three-bay southwest elevation. This entrance is marked with a non-original, single-leaf, panel-and-light metal door. To either side of the entrance, the first story of the house is pierced with two replacement, 6/1 metal sash windows. The second story is pierced by two replacement, 6/1 metal sash windows, one in the gable end wall, one above the entrance, and one in the southeast wall within the corner of the "L."

The northwest elevation consists of the original house with the large, two-story addition to the north. The exterior brick chimney, laid in stretcher bond, rises at the north of the original section of the house. The first story of the original house is pierced by two non-original, 6/1 metal sash windows, and the second story is pierced by two non-original, 6/1 metal sash windows. The first and second stories of the addition are each pierced by a single 6/1 metal sash window.

The northeast elevation consists of the gable end of the rear ell and the rear wall of the original side gable portion of the house. On the northeast elevation, the first story of the original house is entirely covered by the one-story, L-shaped porch with a shed



MARYLAND INVENTORY OF HISTORIC PROPERTIES  
CONTINUATION SHEET

Inventory No. HO-709

Section 7 Page 2

10756 Scaggsville Road  
name of property  
Howard County, Maryland  
county and state

=====  
roof with asphalt shingles. Beneath the porch, on the first story, is an original, single leaf, wood paneled door with lights. The first story is also pierced by one non-original, 6/1 metal sash window. The second story is pierced by one non-original, 6/1 metal sash window.

The first story of the southeast elevation is entirely covered by the one-story, L-shaped porch with an asphalt shingled shed roof. Beneath the porch, on the first story, is a salvaged, single leaf, wood paneled door with lights. The first story of this elevation is pierced by two non-original, 6/1 metal sash windows. The second story, is marked by three non-original 6/1 metal sash windows of varying sizes, two within the original rear ell, and one in the addition.

**OUTBUILDINGS:**

To the southeast of the main house stand two circa 1920, wood frame sheds. The larger shed is set on a stone pier foundation. It has a gable roof with metal sheathing and wood vertical board siding. The smaller shed is also set on a stone pier foundation and has a gable roof, but it clad in board and batten siding.

A large wood frame barn is located to the east of the main dwelling. The original portion of this hay barn dates to circa 1920. The original building sits on a stone foundation and has vertical board siding. The entire building is covered with a metal gable roof. A frame addition on the northeast side sits on a concrete block foundation.

A two-story concrete block barn is also located to the east of the main house. This 1950s building has a metal gable roof and allows vehicles to pass through the interior structure.

A 1930s dilapidated wood frame shed lays to the northeast of the main dwelling. The shed has board and batten siding and a gable roof.

A 1980s wood frame, machine shed is located to the north of the main building. The shed is covered with metal siding and has a gable roof.

MARYLAND INVENTORY OF HISTORIC PROPERTIES  
CONTINUATION SHEET

Inventory No. HO-709

Section 8 Page 1

10756 Scaggsville Road  
name of property  
Howard County, Maryland  
county and state

=====  
Erected circa 1890, the vernacular house at 10756 Scaggsville Road is typical of the dwellings constructed in rural communities across the country in the last decades of the nineteenth century in its lack of detail and ornamentation.

The dwelling was most likely built by John H. Hines after he purchased the property in November of 1892. The property transferred to John T. and Ida Fyock Hines in 1942, upon the death of John H. Hines. The Hines family still retains ownership of 10756 Scaggsville Road.

The property at 10756 Scaggsville Road illustrates a typical farm house at the turn-of-the-century. The original house and four historic outbuildings provide a strong example of a working farm in rural Maryland during the beginning of the twentieth century.

MARYLAND INVENTORY OF HISTORIC PROPERTIES  
CONTINUATION SHEET

Inventory No. HO-709

10756 Scaggsville Road  
name of property  
Howard County, Maryland  
county and state

=====  
**HISTORIC CONTEXT:**

**Geographic Organization:**

Piedmont

**Chronological/Development Period (s):**

Industrial/ Urban Dominance (1870-1930)  
Modern Period (1930-present)

**Prehistoric/Historic Period Theme (s):**

Architecture, Landscape, and Community  
Planning

**RESOURCE TYPE(S)**

**Category:**

Building

**Historic Environment:**

Rural

**Historic Function (s):**

DOMESTIC/ Single Dwelling  
AGRICULTURE/ Agricultural Outbuildings

**Known Design Source:**

Unknown

MARYLAND INVENTORY OF HISTORIC PROPERTIES  
CONTINUATION SHEET

Inventory No. HO-709

10756 Scaggsville Road

name of property

Howard County, Maryland

county and state

=====  
**Chain of Title:**

May 2, 1888	Isabella D. Magruder to John T. Warfield, Cornelia T. Warfield, Mary D. Warfield, Seth W. Warfield, Chloe B. Warfield, Amos W. Warfield, Mary M. Warfield, Amy C. Warfield Land Records of Howard County Liber LJW 53 Folio 492
September 29, 1891	John T. Warfield, Cornelia T. Warfield, Mary D. Warfield, Seth W. Warfield, Chloe B. Warfield, Amos W. Warfield, Mary M. Warfield, Amy C. Warfield by John T. Warfield (attorney) to Albert H. Brown 105 Acres for \$1100 Land Records of Howard County Liber JHO 57 Folio 618
November 26, 1892	Albert H. and Barbara H. Brown to John H. Hines Approximately 20 acres Land Records of Howard County Liber JHO 59 Folio 230
July 22, 1942	C. Ferdinand Sybert, trustee of the estate of John H. Hines to John T. and Ida Fyock Hines Sold for \$4600 at public auction Land Records of Howard County Liber BMJr. 175 Folio 309

# RESOURCE SKETCH MAP

HO-709



107750 Scaggsville Rd,  
Laurel, Howard County, MD

1980s pre-fab  
metal machine shed

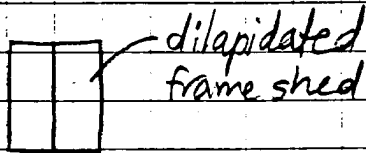

dilapidated  
frame shed

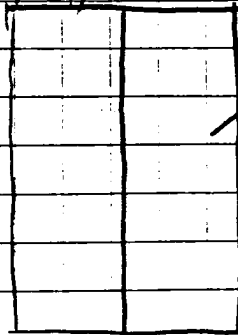

2-story  
1950s  
concrete  
block barn

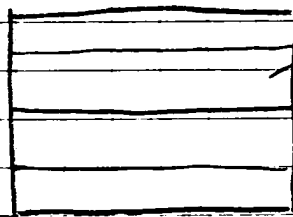
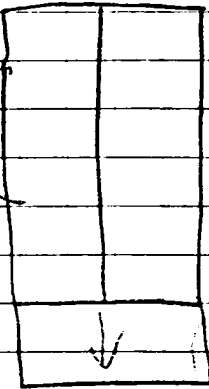

1910s-20s  
frame  
barn

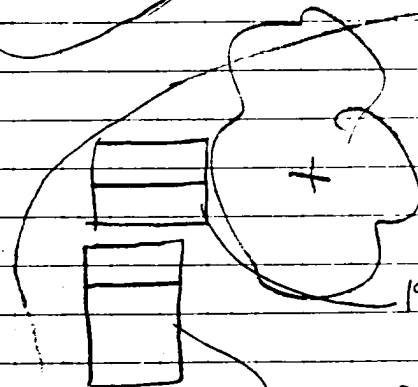
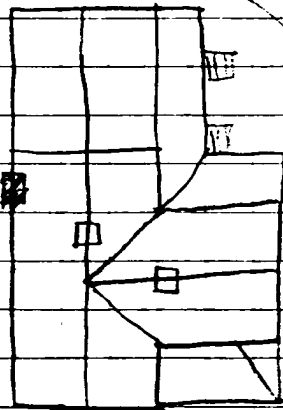

1920s frame  
shed

1920s frame shed

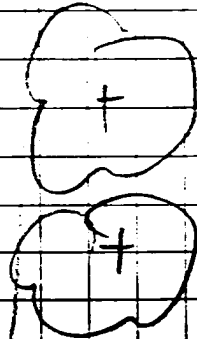
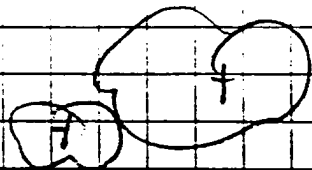

Scaggsville Rd

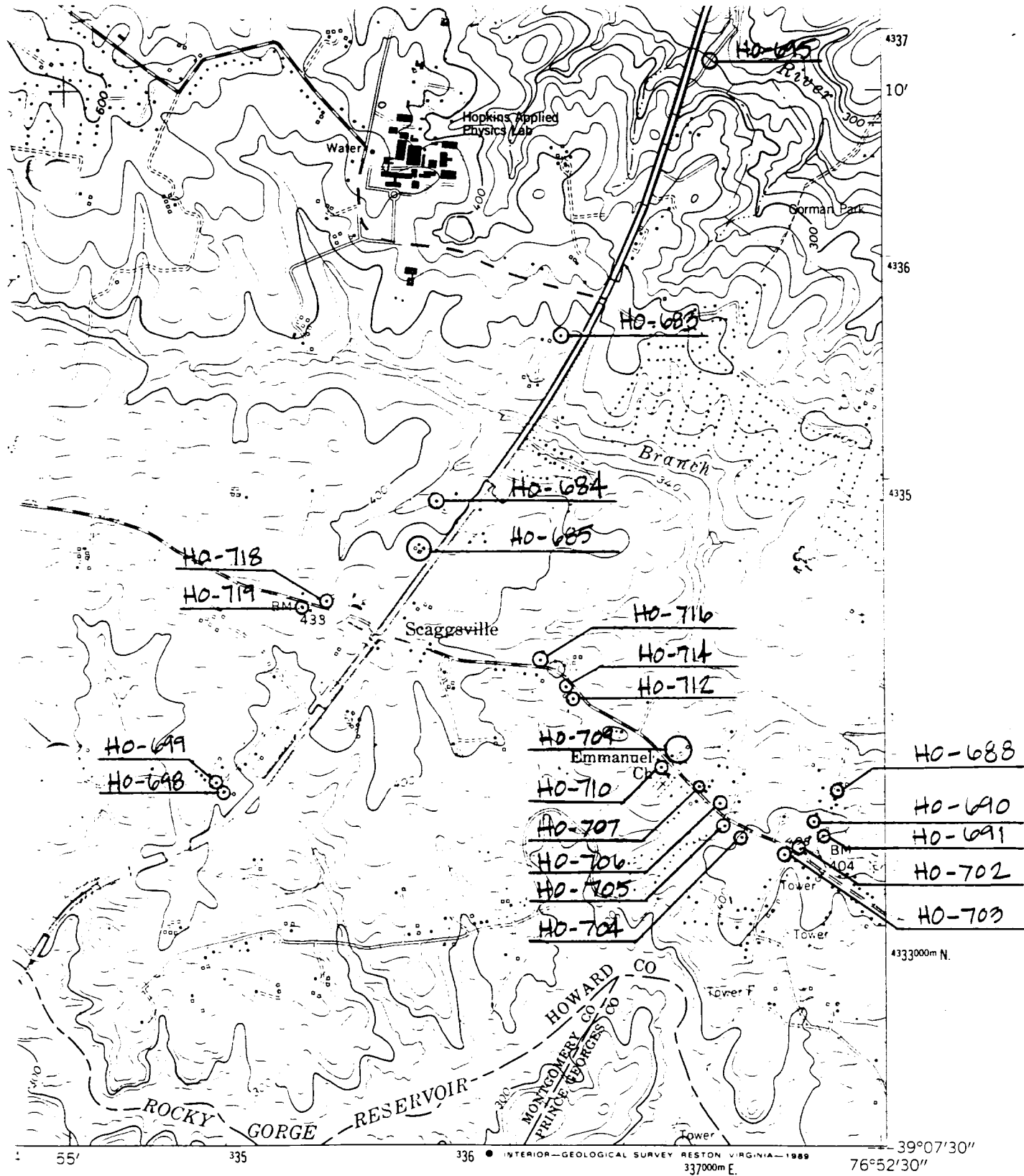

1/4 MILE

ROAD CLASSIFICATION

Heavy-duty		Light-duty	
Medium-duty		Unimproved dirt	
U. S. Route		State Route	

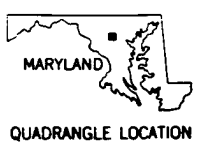

**CLARKSVILLE, MD.**  
 NW/4 LAUREL 15' QUADRANGLE  
 39076-B8-TF-024

1957  
 PHOTOREVISED 1979  
 DMA 5662 III NW-SERIES V833

To place on the predicted North American Datum 1983  
 move the projection lines 8 meters south and  
 26 meters west as shown by dashed corner ticks

(LAUREL)  
 5662 III SE



HO-709

10756 Scaggsville Rd,  
Howard County, MD

Traceries

September 1997

Maryland SHPO

HOUSE, SOUTH CORNER

1 OF 11





Ho-709

10756 Scaggsville Rd.

Howard County, MD

Traceries

September 1997

Maryland SHPO

House, W Corner

2 OF 11



HO-709

10756 Scaggsville Rd.

Howard County, MD

Traceries

September 1997

Maryland SHPO

House, NW Elevation

3 of 11



HO-709

10750 Scaggsville Rd.

Howard County, MD

Traceries

September 1997

Maryland SHPO

House, NE // Elevation

4 of 11



HO-709  
10756 Scaggsville Rd.  
Howard County, MD  
Tracenes  
September 1997  
Maryland SHPO  
House, SE Elevation  
5 of 11



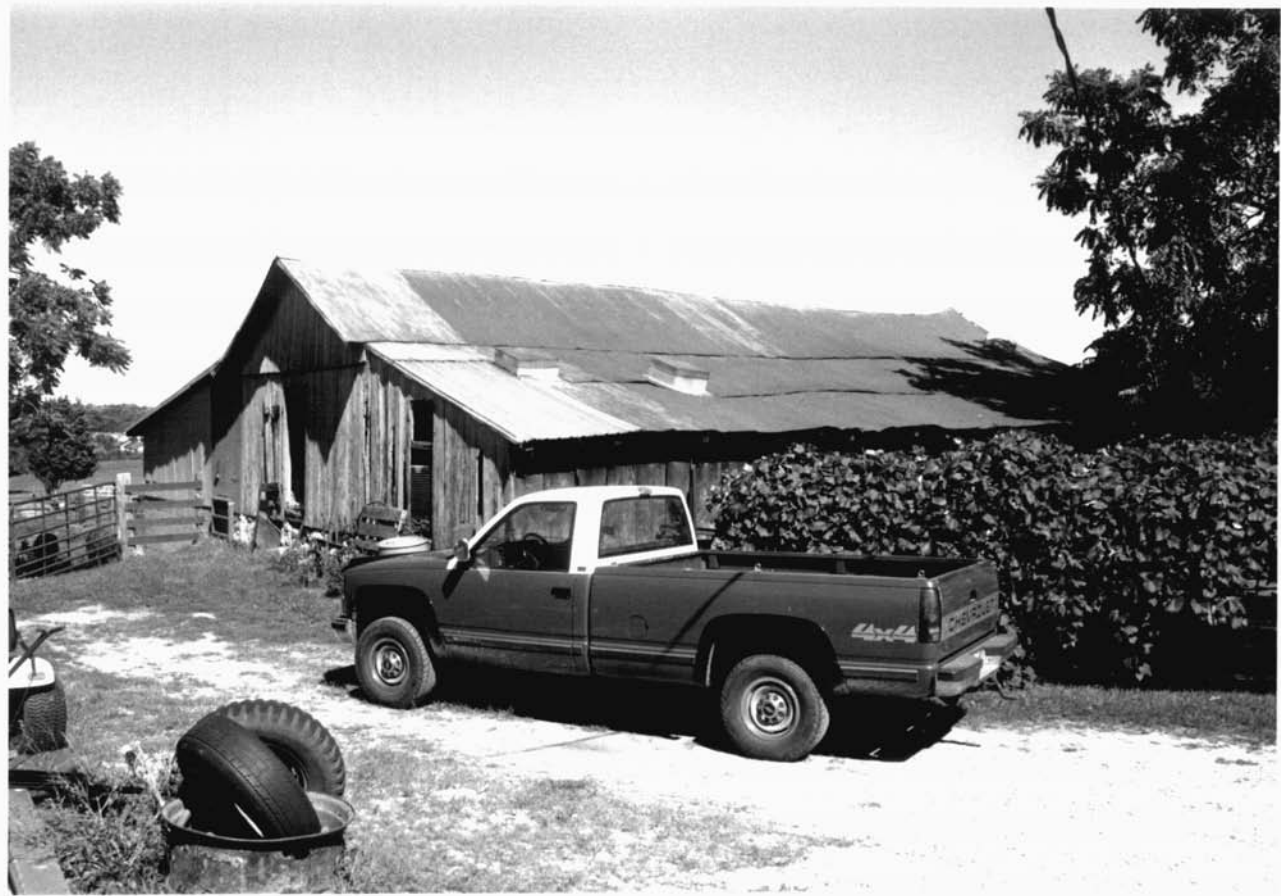

Ho-709

10756 Scaggsville Rd.

Howard County, MD

Traceries

September 1997

Maryland SHPO

Barn, W corner

6 of 11



Ho-709

10756 Scaggsville Rd.

Howard County, MD

Traceries

September 1997

Maryland SHPO

Barn, NW Elevation

7 of 11



HO-709

10756 Scaggsville Rd.

Howard County, MD

Traceries

September 1997

Maryland SHPO

Sheds, NW Elevation

8 of 10



HO-709

10756 Scaggsville Rd

Howard County, MD

Tracenes

September 1997

Maryland SHPO

Barn, W Corner

9 of 14





HO-709

10756 Scaggsville Rd.

Howard County, MD

Traceries

September 1997

Maryland SHPO

Shed, SS corner

10 of 10



HO-709

10756 Scaggsville Rd.

Howard County, MD

Traceries

September 1997

Maryland SHPO

Machine Shed, SE Elevation

11 of 11