

**INDIVIDUAL PROPERTY/DISTRICT
MARYLAND HISTORICAL TRUST
INTERNAL NR-ELIGIBILITY REVIEW FORM**

Property/District Name: 8431 Old Columbia Road Survey Number: HO-698

Tax Parcel#: 60

Project: Maryland 216/29 Project Planning Study Agency: MDOT-SHA

Site visit by MHT Staff: no yes Name _____ Date _____

Eligibility recommended _____ Eligibility **not** recommended _____

Criteria: A B C D Considerations: A B C D E F G None

Justification for decision: (Use continuation sheet if necessary and attach map)

The house at 8431 Old Columbia Road is not eligible due to the fact that it does not meet National Register Criteria A, B, C, or D. Preliminary research has not revealed any association between the dwelling and events that have made a significant contribution to the broad patterns of our history (Criterion A) or the lives of persons significant in our past (Criterion B). Although the building provides an example of the Craftsman-style Bungalow, it is neither unusual nor distinguished; it does not represent the work of a master or display high artistic merit (Criterion C). There is no evidence that the property is likely to yield information important in history or prehistory (Criterion D). Thus, the property is not National Register-eligible.

Documentation on the property/district is presented in: Maryland Historical Trust Inventory Form
and Maryland 29/216 Project Planning Report

Prepared by: Traceries, 5420 Western Ave., Chevy Chase, MD 20815 November 1997

Concun - [Signature] Date 2/10/98
Reviewer, Office of Preservation Services

NR program concurrence: yes no not applicable

[Signature] Date 3/31/99
Reviewer, NR Program

[Handwritten mark]

CAPSULE SUMMARY
8431 Old Columbia Road
(HO-698)

Erected in 1930, the house at 8431 Old Columbia Road is a large illustration of a Craftsman style bungalow. Jointly, this form and style were commonly utilized in rural areas in the first part of the 20th century because it provided homeowners with affordable housing that was both easy to construct and simple to maintain. This Craftsman-style bungalow is a one-and-one-half-story, three-bay building. Typical of the style, the residence has a prominent side gable roof with a front gable dormer centered on both the front and the rear. The dominating roof encompasses the inset front porch, which extends the full-width of the facade. It has a central passage plan and is two-rooms deep. The wood frame house is set on a concrete pier foundation and has an interior brick chimney. The dwelling has been reclad in aluminum siding and has an asphalt shingle roof.

The dwelling was constructed in 1930, shortly after the property was purchased by Laurence and Louise M. Robinson in March 1923. The Robinson family held the land until 1934, when it was purchased by Philip M. and Mary H. Brown. In 1953, present owners James F. and Doris M. Ritter purchased the property.

MARYLAND HISTORICAL TRUST
MD INVENTORY OF HISTORIC PROPERTIES

Inventory No. HO-698

=====

1. Name of Property

=====

historic name _____
common/other name _____

=====

2. Location

=====

street & number 8431 Old Columbia Road not for publication _____
city or town Laurel vicinity _____ state Maryland code MD
county Howard code 027 zip code 20723

=====

3. State/Federal Agency Certification N/A

=====

4. National Park Service Certification N/A

=====

5. Classification

=====

Ownership of Property (Check all that apply)

- private
- public-local
- public-State
- public-Federal

Category of Property (Check only one box)

- building(s)
- district
- site
- structure
- object

Number of Resources within Property

Contributing		Noncontributing		
<u>1</u>		<u>1</u>		buildings
<u>0</u>		<u>0</u>		sites
<u>0</u>		<u>0</u>		structures
<u>0</u>		<u>0</u>		objects
<u>1</u>		<u>1</u>		Total

Is this property listed in the National Register?

Yes _____ Name of Listing _____
No

=====
6. Function or Use
=====

Historic Functions (Enter categories from instructions)
Cat: DOMESTIC Sub: SINGLE DWELLING

Current Functions (Enter categories from instructions)
Cat: DOMESTIC Sub: SINGLE DWELLING

=====
7. Description
=====

Architectural Classification (Enter categories from instructions)
Craftsman/Bungalow

Materials (Enter categories from instructions)
foundation Solid: Concrete, Pier with Lattice
roof Side Gable: Asphalt Shingles
walls Wood Frame: Aluminum Siding
other _____

Narrative Description (Describe the historic and current condition of the property.)

See Continuation Sheet No. 7-1

=====
8. Statement of Significance
=====

Applicable National Register Criteria (Mark "x" in one or more boxes for the criteria qualifying the property for National Register listing)

- A Property is associated with events that have made a significant contribution to the broad patterns of our history.
- B Property is associated with the lives of persons significant in our past.
- C Property embodies the distinctive characteristics of a type, period, or method of construction or represents the work of a master, or possesses high artistic values, or represents a significant and distinguishable entity whose components lack individual distinction.
- D Property has yielded, or is likely to yield information important in prehistory or history.

Criteria Considerations (Mark "X" in all the boxes that apply.)

- A owned by a religious institution or used for religious purposes.
- B removed from its original location.
- C a birthplace or a grave.
- D a cemetery.
- E a reconstructed building, object, or structure.
- F a commemorative property.
- G less than 50 years of age or achieved significance within the past 50 years.

Maryland Inventory of Historic Properties
8431 Old Columbia Road
Howard County, Maryland

Inventory No. HO-698
Page 4

=====
Areas of Significance (Enter categories from instructions)

Architecture

Period of Significance 1930-1947

Significant Dates 1930

Significant Person (Complete if Criterion B is marked above)

Cultural Affiliation Undefined

Architect/Builder Unknown

Narrative Statement of Significance (Explain the significance of the property.)

See Continuation Sheet No. 8-1

=====

9. Major Bibliographical References

=====

(Cite the books, articles, legal records, and other sources used in preparing this form.)

Howard County Land Records, Recorder of Deeds, Howard County, Ellicott City, Maryland.

=====

10. Geographical Data

=====

Acreage of Property 2.69 acres

Verbal Boundary Description (Describe the boundaries of the property.)

The property at 8431 Old Columbia Road is designated as Parcel 60, as indicated on Map 46, Grid 9.

Boundary Justification (Explain why the boundaries were selected.)

The property at 8431 Old Columbia Road has historically been associated with Parcel 60 since its construction in 1930.

=====

11. Form Prepared By

=====

name/title Kristyna G. Olsen, Architectural Historian
 organization Traceries date October 30, 1997
 street & number 5420 Western Avenue telephone 301/656-5283
 city or town Chevy Chase state MD zip code 20815

=====

12. Property Owner

=====

name James F. and Doris M. Ritter
 street & number 8431 Old Columbia Road telephone 301-725-2017
 city or town Laurel state MD zip code 20723

=====

MARYLAND INVENTORY OF HISTORIC PROPERTIES
CONTINUATION SHEET

Inventory No. HO-698

Section 7 Page 1

8431 Old Columbia Road
name of property
Howard County, Maryland
county and state

=====
The Craftsman-style bungalow at 8431 Old Columbia Road is a one-and-one-half-story, three-bay wide building. Dating from 1930, the residence has a prominent side gable roof with a front gable dormer centered on both the front and the rear. The dominating roof encompasses the inset front porch, which extends the full-width of the facade. It has a central passage plan and is two-rooms deep. The wood frame house is set on a concrete pier foundation and has an interior brick chimney. The dwelling has been reclad in aluminum siding and has an asphalt shingle roof.

The dwelling is set on a pie-shaped lot between Route 29 and Old Columbia Road. The property rises from Route 29 to the west. Mature shade trees dominate the property in the southwest.

EXTERIOR DESCRIPTION:

The southwest elevation, or facade of the house, consists of the inset front porch. This porch, strongly denoting the Craftsman style, is finished with brick piers supporting tapered square columns. Flat, square posts comprise the balustrade. The central entry, filled with a multi-light glass and wood door, is surrounded by paired 1/1 replacement windows. The front gable dormer, marked by overhanging eaves, has a paired 1/1 window.

The southeast elevation is pierced by two set of paired 1/1 windows on the first story, while the half-story contains a paired 1/1 windows. The plane of the wall has been interrupted by the construction of a projecting bay with a shed roof. One pair of the 1/1 windows is located in this bay. The openings have thin surrounds provided by the vinyl siding, louvered shutters and thick mullions.

Attached to the northeast elevation is a non-original wood deck. The rear entrance to the house is marked by a single-leaf replacement door. To the west of the entry is a row of three 1/1 windows with thick mullions. As seen on the facade, a front gable dormer with paired 1/1 replacement windows, is centered on the northeast roof plane.

Mirroring the original configuration of the northeast elevation, the northwest elevation has two single and one paired 1/1 windows. The gable end has a paired 1/1 window. The openings have thin surrounds provided by the vinyl siding, louvered shutters and thick mullions.

MARYLAND INVENTORY OF HISTORIC PROPERTIES
CONTINUATION SHEET

Inventory No. HO-698

Section 7 Page 2

8431 Old Columbia Road
name of property
Howard County, Maryland
county and state

=====

OUTBUILDINGS:

A 1950s garage sits to the north of the main dwelling. The garage has a gable roof sheathed in asphalt shingles and is constructed of concrete block with vinyl siding in the gable ends. It measures three bays deep with fixed four-light windows, single entry openings with aluminum doors, and a two-car garage door opening.

MARYLAND INVENTORY OF HISTORIC PROPERTIES
CONTINUATION SHEET

Inventory No. HO-698

Section 8 Page 1

8431 Old Columbia Road
name of property
Howard County, Maryland
county and state

=====
Erected in 1930, the house at 8431 Old Columbia Road is a large illustration of a Craftsman-style bungalow. Jointly, this form and style were commonly utilized in rural areas in the first part of the 20th century because it provided homeowners with affordable housing that was both easy to construct and simple to maintain.

The dwelling was constructed in 1930, shortly after the property was purchased by Laurence and Louise M. Robinson in March 1923. The Robinson family held the land until 1934, when it was purchased by Philip M. and Mary H. Brown. In 1953, present owners James F. and Doris M. Ritter purchased the property.

MARYLAND INVENTORY OF HISTORIC PROPERTIES
CONTINUATION SHEET

Inventory No. HO-698

8431 Old Columbia Road
name of property
Howard County, Maryland
county and state

=====

HISTORIC CONTEXT:

Geographic Organization: Piedmont

Chronological/Development Period (s):

Industrial/ Urban Dominance (1870-1930)
Modern Period (1930-present)

Prehistoric/Historic Period Theme (s):

Architecture, Landscape, and Community
Planning

RESOURCE TYPE(S)

Category: Building

Historic Environment: Rural

Historic Function (s): DOMESTIC/ Single Dwelling

Known Design Source: Unknown

MARYLAND INVENTORY OF HISTORIC PROPERTIES
CONTINUATION SHEET

Inventory No. HO-698

8431 Old Columbia Road
name of property
Howard County, Maryland
county and state

=====
Chain of Title:

- March 22, 1923 William W.L. Cissel, trustee in a court case
between Annie Renn, plaintiff, and Elizabeth
Schaub, defendant, to Laurence Robinson
Sold four lots: (1) 28 acres, (2) 5 acres, (3) 5.5
acres, and (4) 2 acres
Land Records of Howard County
Liber HBN 117 Folio 251
- May 7, 1930 Laurence and Louise M. Robinson to Howard M.
Robinson
Sold four lots for \$2800
Land Records of Howard County
Liber HSK 138 Folio 467
- March 6, 1934 Howard M. and Martha E. Robinson and Laurence
Robinson (holder of mortgage recorded in Liber HSK
138, Folio 469) to Philip M. and Mary H. Brown
10 acres, part of previous property
Land Records of Howard County
Liber BMJr. 147 Folio 565
- April 22, 1953 Philip M. and Mary E. Brown to James F. and Doris
M. Ritter
4 acres, part of previous property
Land Records of Howard County
Liber MWB 243 Folio 13

8431 Old Columbia Rd
Laurel, Howard County, MD

RESOURCE
SKETCH MAP

HO-698

N

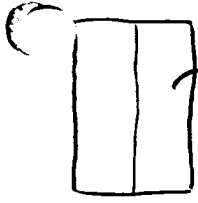

conc
block
garage

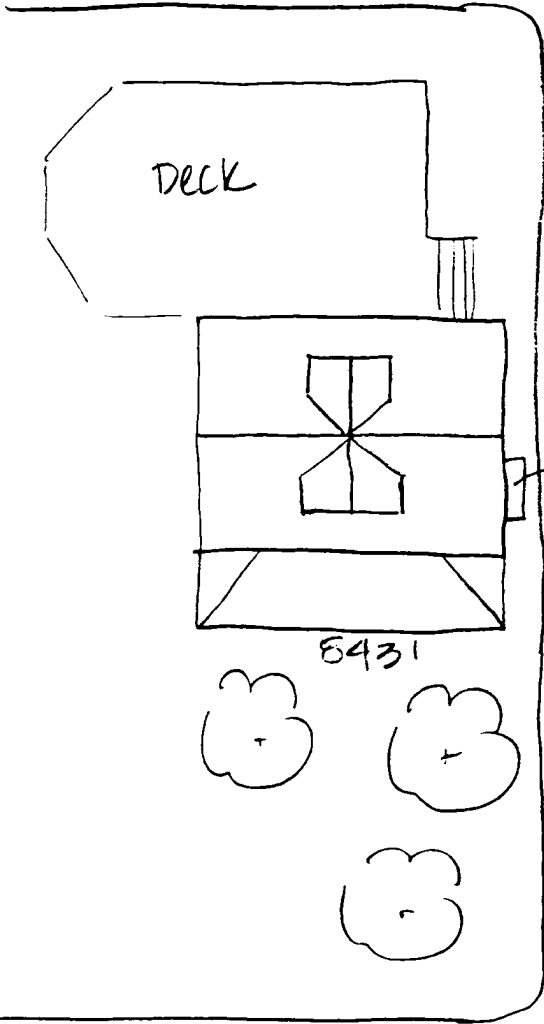

DECK

box bay

8431

Old Columbia Rd



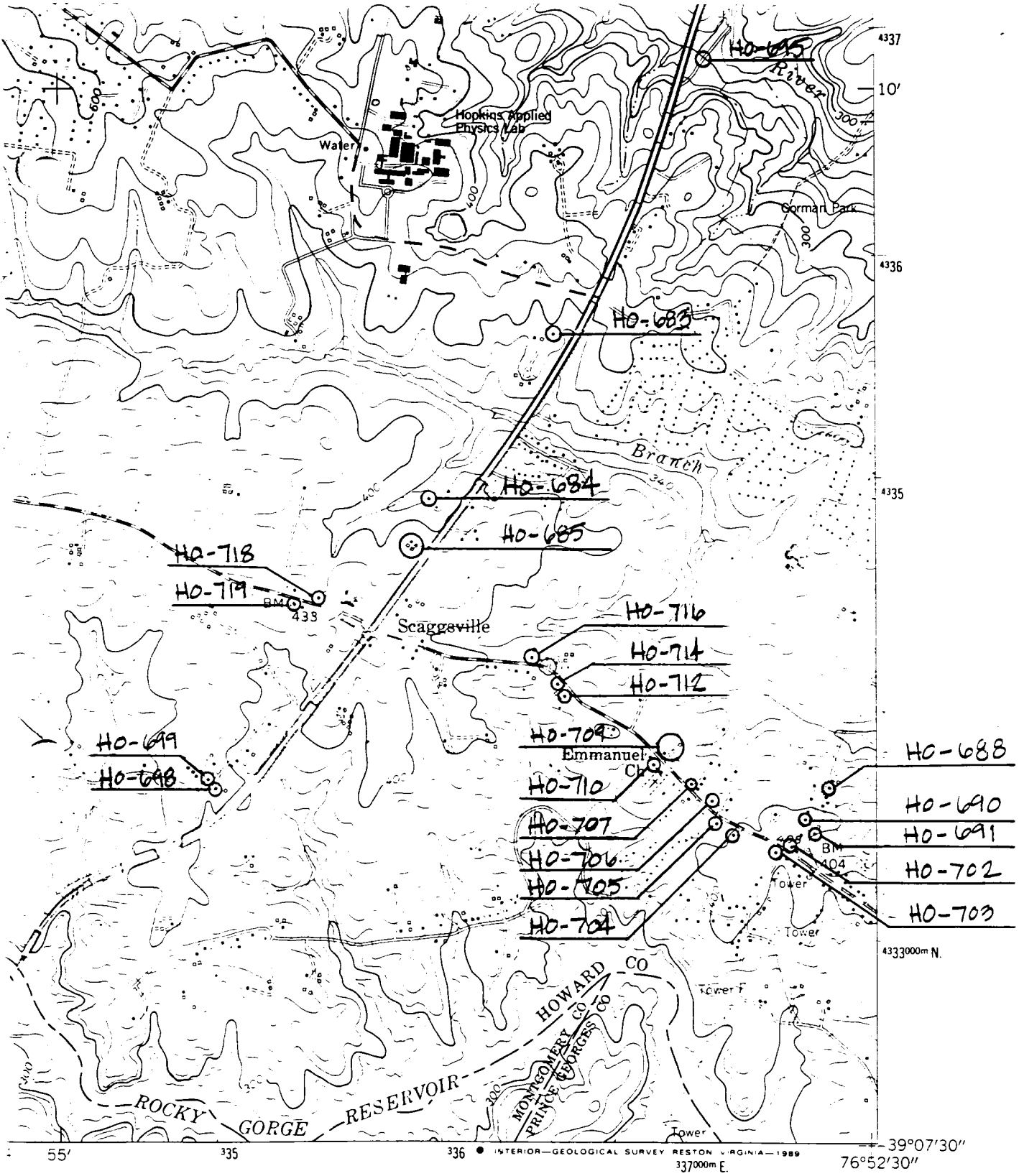

ROAD CLASSIFICATION
 Heavy-duty ————— Light-duty —————
 Medium-duty ————— Unimproved dirt - - - - -
 U. S. Route State Route

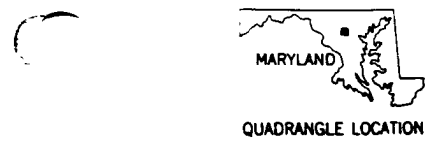

CLARKSVILLE, MD.
 NW/4 LAUREL 15' QUADRANGLE
 39076-B8-TF-024

1957
 PHOTOREVISED 1979
 DMA 5662 III NW-SERIES V833

To place on the predicted North American Datum 1983
 move the projection lines 8 meters south and
 26 meters west as shown by dashed corner ticks

(LAUREL)
 5662 III SE



H0-698

8431 Old Columbia Road

Howard County, MD

Traceries

October 1997

Maryland SHPO

House, S Corner

Id 4



HO-698

8431 OLD COLUMBIA ROAD

Howard County, MD

Traceries

October 1997

Maryland SHPO

House, NW Elevation

2 of 4



H0-698

8431 Old Columbia Rd.

Howard County, MD

Traceries

October 1997

Maryland SHPO

House/Garage: General view looking W

3 of 4



H0-698

8431 Old Columbia Rd.

Howard County, MD

Traceries

October 1997

Maryland SHPO

Garage, Looking NE

4 of 4