

HO-561
The Ryerson House ("Bessie Hall")
Columbia
Private

Circa 1874

The Ryerson House ("Bessie Hall") faces east on the west side of Cedar Lane 2400 feet south of its intersection with Hickory Ridge Road.

It is a five bay wide, one room deep, two and a half story high, gabled roof (running north-south) frame structure with square brick chimneys inset into its north and south walls and an intersecting, central gable on its east elevation. This elevation holds a central rectangular, entrance door, flanked by three vertical side lights and surmounted by a four light transom.

Fenestration is rectangular, double-hung, holding two-over-two lights, proportionally scaled, vertically aligned, and decorated with black shutters.

A hipped roof, one story high, open porch runs along this elevation, supported by square wooden posts. A two bay wide, one room deep, two story high, intersecting gable (running east-west) frame kitchen "L" extends from the two north bays of the west wall of the house. Its west wall holds a central, square, brick chimney. Its south wall holds a central, rectangular entrance and a one light, rectangular picture window, east of the door, with two rectangular, second floor windows, with two-over-two lights above. A shed roofed, one story high, enclosed porch runs along the south wall.

Bessie Hall is a good example of Howard County vernacular frame architecture, constructed in an "L" plan by John Wall, circa 1874.

MARYLAND HISTORICAL TRUST

HO-561
Dist. 5
Clarksville Quad.
MAGI # 1405615504

INVENTORY FORM FOR STATE HISTORIC SITES SURVEY

1 NAME

HISTORIC "Bessie Hall"

AND/OR COMMON

2 LOCATION

STREET & NUMBER
6050 Cedar Lane (Now on Cedar Court)

CITY, TOWN
Columbia

___ VICINITY OF

CONGRESSIONAL DISTRICT
6th

STATE
Maryland

COUNTY
Howard

3 CLASSIFICATION

| CATEGORY | OWNERSHIP | STATUS | PRESENT USE | |
|---|---|--|--|---|
| <input type="checkbox"/> DISTRICT | <input type="checkbox"/> PUBLIC | <input checked="" type="checkbox"/> OCCUPIED | <input type="checkbox"/> AGRICULTURE | <input type="checkbox"/> MUSEUM |
| <input checked="" type="checkbox"/> BUILDING(S) | <input checked="" type="checkbox"/> PRIVATE | <input type="checkbox"/> UNOCCUPIED | <input type="checkbox"/> COMMERCIAL | <input type="checkbox"/> PARK |
| <input type="checkbox"/> STRUCTURE | <input type="checkbox"/> BOTH | <input type="checkbox"/> WORK IN PROGRESS | <input type="checkbox"/> EDUCATIONAL | <input checked="" type="checkbox"/> PRIVATE RESIDENCE |
| <input type="checkbox"/> SITE | PUBLIC ACQUISITION | ACCESSIBLE | <input type="checkbox"/> ENTERTAINMENT | <input type="checkbox"/> RELIGIOUS |
| <input type="checkbox"/> OBJECT | <input type="checkbox"/> IN PROCESS | <input checked="" type="checkbox"/> YES RESTRICTED | <input type="checkbox"/> GOVERNMENT | <input type="checkbox"/> SCIENTIFIC |
| | <input type="checkbox"/> BEING CONSIDERED | <input type="checkbox"/> YES UNRESTRICTED | <input type="checkbox"/> INDUSTRIAL | <input type="checkbox"/> TRANSPORTATION |
| | | <input type="checkbox"/> NO | <input type="checkbox"/> MILITARY | <input type="checkbox"/> OTHER |

4 OWNER OF PROPERTY

NAME
Mrs. Knowles A. Ryerson

Telephone #: 730-8350

STREET & NUMBER
15 Arlmonite Dr

CITY, TOWN
Berkeley,

___ VICINITY OF

STATE, zip code
California, 94707

5 LOCATION OF LEGAL DESCRIPTION

COURTHOUSE. Tax Map 35, p. 39
REGISTRY OF DEEDS, ETC. Hall of Records

Liber #: 689
Folio #: 711

STREET & NUMBER
Howard County Court House

CITY, TOWN
Ellicott City

STATE

Maryland

6 REPRESENTATION IN EXISTING SURVEYS

TITLE
Howard County Historic Sites Inventory

DATE
1978-1979

___ FEDERAL STATE ___ COUNTY ___ LOCAL

DEPOSITORY FOR
SURVEY RECORDS
Maryland Historical Trust

CITY, TOWN
21 State Circle, Annapolis

STATE

Maryland

7 DESCRIPTION

| CONDITION | | CHECK ONE | CHECK ONE |
|---|---------------------------------------|---|---|
| <input checked="" type="checkbox"/> EXCELLENT | <input type="checkbox"/> DETERIORATED | <input checked="" type="checkbox"/> UNALTERED | <input checked="" type="checkbox"/> ORIGINAL SITE |
| <input type="checkbox"/> GOOD | <input type="checkbox"/> RUINS | <input type="checkbox"/> ALTERED | <input type="checkbox"/> MOVED DATE _____ |
| <input type="checkbox"/> FAIR | <input type="checkbox"/> UNEXPOSED | | |

DESCRIBE THE PRESENT AND ORIGINAL (IF KNOWN) PHYSICAL APPEARANCE

The Ryerson House faces east on the west side of Cedar Lane 2400 feet south of its intersection with Hickory Ridge Road.

It is a five bay wide, one room deep, two and a half story high, gabled roof (running north-south) frame structure with square brick chimneys inset into its north and south walls and an intersecting, central gable on its east elevation. This elevation holds a central rectangular, entrance door, flanked by three vertical side lights and surmounted by a four light transom.

Fenestration is rectangular, double-hung, holding two-over-two lights, proportionally scaled, vertically aligned, and decorated with black shutters.

A hipped roof, one story high, open porch runs along this elevation, supported by square wooden posts. A two bay wide, one room deep, two-story high, intersecting gable (running east-west) frame kitchen "L" extends from the two north bays of the west wall of the house. Its west wall holds a central, square, brick chimney. Its south wall holds a central, rectangular entrance and a one light, rectangular picture window, east of the door, with two rectangular, second floor windows, with two-over-two lights above. A shed roofed, one story high, enclosed porch runs along the south wall.

The west bay of this porch has been enclosed to create what once may have been a pantry, whose south wall holds a rectangular, two-over-two light window and is now used as a powder room.

A rectangular entrance lies east of the enclosure with three tall, rectangular eight light windows east of the entrance. The main building

block of the house features a central hall with east and west rectangular entrances.

The interior of the Ryerson House features random width floors, cross paneled entrance doors and door and window frames flanked by fluted pilasters, surmounted by fluted lintels, joined by square blocks, decorated with circles. The house has an "L" shaped stone walled basement foundation, indicating the entire house was constructed at one time. The woodwork, interior doors and floors also match throughout the house, a further indication of this.

The front door is of particular interest. On the exterior it is a rectangular, Roman-arched, cross paneled door, while on its interior it is simply a rectangular, cross paneled door. The intersecting front gable once held a Roman-arched, double-hung window, holding two-over-two lights. These two features are representative of the second half of the Nineteenth Century.

8 SIGNIFICANCE

Page 1 of 2

HO-561
District 5
Columbia

| PERIOD | AREAS OF SIGNIFICANCE -- CHECK AND JUSTIFY BELOW | | | |
|---|--|---|---|--|
| <input type="checkbox"/> PREHISTORIC | <input type="checkbox"/> ARCHEOLOGY-PREHISTORIC | <input type="checkbox"/> COMMUNITY PLANNING | <input type="checkbox"/> LANDSCAPE ARCHITECTURE | <input type="checkbox"/> RELIGION |
| <input type="checkbox"/> 1400-1499 | <input type="checkbox"/> ARCHEOLOGY-HISTORIC | <input type="checkbox"/> CONSERVATION | <input type="checkbox"/> LAW | <input type="checkbox"/> SCIENCE |
| <input type="checkbox"/> 1500-1599 | <input type="checkbox"/> AGRICULTURE | <input type="checkbox"/> ECONOMICS | <input type="checkbox"/> LITERATURE | <input type="checkbox"/> SCULPTURE |
| <input type="checkbox"/> 1600-1699 | <input checked="" type="checkbox"/> ARCHITECTURE | <input type="checkbox"/> EDUCATION | <input type="checkbox"/> MILITARY | <input type="checkbox"/> SOCIAL/HUMANITARIAN |
| <input type="checkbox"/> 1700-1799 | <input type="checkbox"/> ART | <input type="checkbox"/> ENGINEERING | <input type="checkbox"/> MUSIC | <input type="checkbox"/> THEATER |
| <input checked="" type="checkbox"/> 1800-1899 | <input type="checkbox"/> COMMERCE | <input type="checkbox"/> EXPLORATION/SETTLEMENT | <input type="checkbox"/> PHILOSOPHY | <input type="checkbox"/> TRANSPORTATION |
| <input type="checkbox"/> 1900- | <input type="checkbox"/> COMMUNICATIONS | <input type="checkbox"/> INDUSTRY | <input type="checkbox"/> POLITICS/GOVERNMENT | <input checked="" type="checkbox"/> OTHER (SPECIFY) Local History |
| | | <input type="checkbox"/> INVENTION | | |

SPECIFIC DATES Circa 1874

BUILDER/ARCHITECT John Wall

STATEMENT OF SIGNIFICANCE

The Ryerson House ("Bessie Hall") is a good example of Howard County vernacular frame architecture¹, constructed in an "L" plan by John Wall, circa 1874².

EXPLANATORY NOTES:

- The Ryerson House, also known as "Bessie Hall", is typical of the two-story high, gabled roof, farm house with "L" service wing, which was being constructed in Howard County in the second half of the Nineteenth Century. Often these houses featured a central intersecting gable, such as we find here, inset with either a Roman-arched or Gothic-arched attic window. This latter feature, a Roman-arched attic window, has been covered so that it does not appear on the facade, only on the interior. The central, rectangular, cross-paneled doorway for the house also features two top, Roman-arched panels on its exterior, another feature of this period. The house also retains much of its original interior, such as its cross-paneled doors, basic floor plan, staircase, and woodwork, the latter of which is composed of fluted pilasters and lintels joined by square blocks, decorated with circles.
- This house is situated on land once belonging to a farm given to

CONTINUE ON SEPARATE SHEET IF NECESSARY

Amos Dorsey by his father, Eli. The third line of this farm once intersected Lot #3 of the division of real estate of Amos Dorsey, which Lot #3 was on April 8, 1818, conveyed to Charles Worthington and Mary Ann Worthington. On January 20, 1874, 145 acres of the original farm was sold at public auction to John P. Wall. This man is believed to have constructed the present house. He, James Wall and Robert Lilly entered into a petition to create a right-of-way to the public road known as "Cedar Lane", confirmed by Circuit Court of Howard County 30 March, 1880 (5-98). The residence of James Wall is also indicated on the Hopkins' Atlas of 1878, with no direct access to Cedar Lane at that time. By 1883, Pulaski Dorsey acquired the 145 acre farm, willing it to Annie E. Simpson. She, in turn, conveyed it to James Goodman in 1913, who lived there until the time of his death. By 1941, his widow, Pearl Lee Peters and their children, Woodrow Wilson Goodman, Irene Virginia Goodman, Vernon Eugene Goodman, and James Ellis Goodman conveyed the 145 acre farm to Emma A. Pierson. In her deed conveyance to Dorsey E. West in 1948, the following tracts of land were named, of which this farm was a part; "Dorsey Land", "The Discovery", "Luck Support", "Geists Plains" and "Dorsey's Search Enlarged."

In 1951, 32 acres of the farm were acquired by Neil and Beverly Besse. Ten years later, Hammond and Ella Mae Bosse acquired "Bessie Hall", holding it one year and then conveying it to its present owner, Mrs. Edith P. Popenoe Ryerson.

9 MAJOR BIBLIOGRAPHICAL REFERENCES

Lane Records of Howard County
Interview with Mrs. Streich, resident of the house, July 25, 1978
Correspondence with Mrs. Edith Ryerson, September 28, 1978

CONTINUE ON SEPARATE SHEET IF NECESSARY

10 GEOGRAPHICAL DATA

ACREAGE OF NOMINATED PROPERTY 32.24 Acres

Please see Attachment 1, Tax Map 35

VERBAL BOUNDARY DESCRIPTION

Please see Howard County Land Records, Liber 680 Folio 711

LIST ALL STATES AND COUNTIES FOR PROPERTIES OVERLAPPING STATE OR COUNTY BOUNDARIES

STATE Maryland COUNTY Howard

STATE _____ COUNTY _____

11 FORM PREPARED BY

NAME / TITLE

Cleora Barnes Thompson, Archivist

ORGANIZATION

Office of Planning & Zoning-Comprehensive Planning Section DATE 465-5000 x 257

STREET & NUMBER

3450 Court House Drive

TELEPHONE

CITY OR TOWN

Ellicott City

STATE

Maryland

The Maryland Historic Sites Inventory was officially created by an Act of the Maryland Legislature, to be found in the Annotated Code of Maryland, Article 41, Section 181 KA, 1974 Supplement.

The Survey and Inventory are being prepared for information and record purposes only and do not constitute any infringement of individual property rights.

RETURN TO: Maryland Historical Trust
The Shaw House, 21 State Circle
Annapolis, Maryland 21401
(301) 267-1438

TITLE SEARCH
 HO-561 The Ryerson House (Bessie Hall")
 Prepared by Cleora Thompson, AICP

| <u>DATE</u> | <u>LIBER - FOLIO</u> | <u>GRANTOR</u> | <u>GRANTEE</u> | <u>TRANSACTION</u> |
|----------------|----------------------|---|---|--|
| a July, 1974 | 689 - 711 | Edith P. Ryerson | Charles H. Popenoe and Peter Popenoe | Deed to 32.24 acres 1/4 interest to Charles and Peter as tenants in common with the grantor of 32.24 acres. |
| Sept 6, 1962 | 388 - 748 | Hammond E. Bosse and Ella Mae Bosse | Edith P. Popenoe, now remarried to Knowles A. Ryerson | Deed to Lot 6 Block A as laid out on the plat of Cedar Acres, H.C. dated April 1951 # 4-11 |
| May 12, 1961 | 368 - 26 | Neil K. Besse & Beverly L. Besse | Hammond E. Bosse and Ella Mae Bosse | Same as above |
| April 16, 1951 | 224 - 315 | Kensington Realty Co., Inc. | Neil K & Beverly L. Besse | Same as above |
| April 16, 1951 | 224 - 312 | Dorsey E. West | Kensington Realty Co. | Deed to 145 acres [±] |
| July 8, 1948 | 204 - 509 | Emma A. Pierson and Everett, her husband | Dorsey E. West and Louise R. West | p/o tract called "Dorsey Land" p/o "The Discovery" (5th and 4th divis) p/o Luck Support p/o Geists Plains p/o Dorsey's Search Enlarged. Deeed to 2 parcels 1 - 14 5.9 acres [±] 2 - 145 A ⁻ |
| 31 May, 1941 | 170 - 383 | Pearl Lee Peters etal (widow of James Goodman) Woodrow Wilson Goodman Irene Virginia Goodman Vernon Eugene Goodman James Ellis Goodman | Emma A. Pierson —his children | Deed to 145 A [±] |

TITLE SEARCH
HO-561- The Ryerson House
Prepared by Cleora B. Thompson, AICP

"All that farm situate and lying in of H.C." "at a stone st 3rd line in a deed from Eli Dorsey to his son Amos ...to intersect Lot #3 of the Division of real estate of Amos Dorsey, which Lot #3 was on 8 April, 1818 conveyed to Charles Worthington and Mary Ann - especially as an easement appurtengnce to said trust, a right of way to the public road, known as "Cedar Lane" established by County Commissioners on petition of John Wall and Robert Lilly confirmed by Circuit Court 30 March, 1880 5-98

| DATE | LIBER - FOLIO | GRANTOR | GRANTEE | TRANSACTION |
|---------------|---------------|---|--|--|
| Feb. 13, 1913 | 94 - 316 | Annie E. Simpson | James Goodman (on which he resided at time of his death) | Deed to 145 A "a certain Pulaski Dorsey willed 145A to Annie E. Simpson for life with a remainder to Mary Ann Carr |
| 1 March 1883 | 46 - 86 | Harrison Dorsey | Pulaski Dorsey | Deed to 145 A for \$ 3,000 |
| 15 Sept, 1874 | 34 - 231 | William A. Hammond, Mortgagee and trustee to John P. Wall | John P. Wall | Deed to 145 A |

Trustee named in a mortgage from Dr. Charles Ridgely to G. Burke and Wm. A. Hammond 10 Dec. 1870 (3-253)

Expose at public aution at the Ct Hse door in E.C.
The property mentioned Jan 20, 1874
John P. Wall highest bidder for \$1180
"together with all and singular the rights, privileges and appurtenances . .

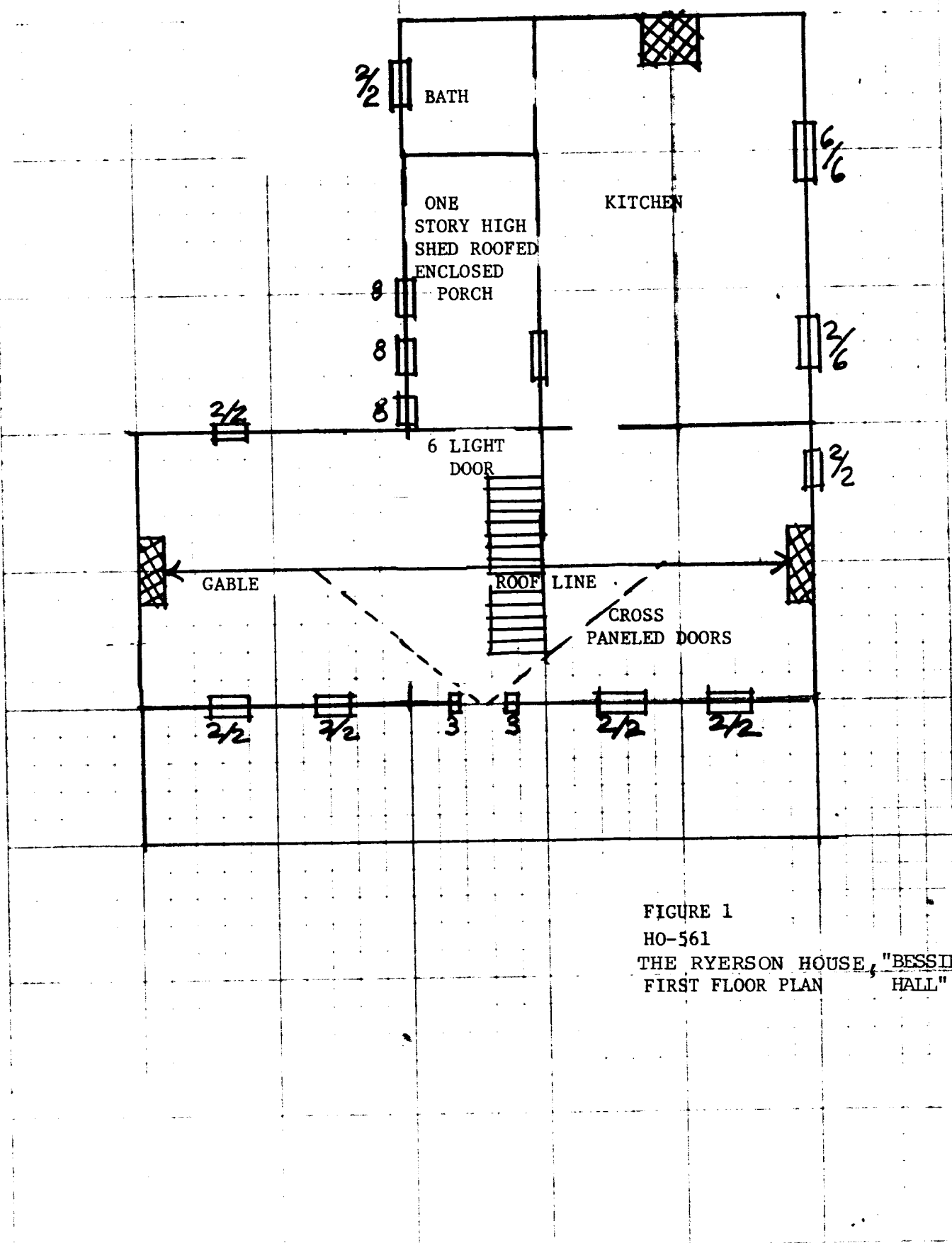

FIGURE 1
 HO-561
 THE RYERSON HOUSE, "BESSIE
 FIRST FLOOR PLAN HALL"

HOWARD RESEARCH
& DEV. CORP.
401/124
267.53A.

486/224
112.70A.
P.47

Attachment 1
HO-561
"Bessie Hall"
Tax Map 35

DEV. CORP.

29-P.57

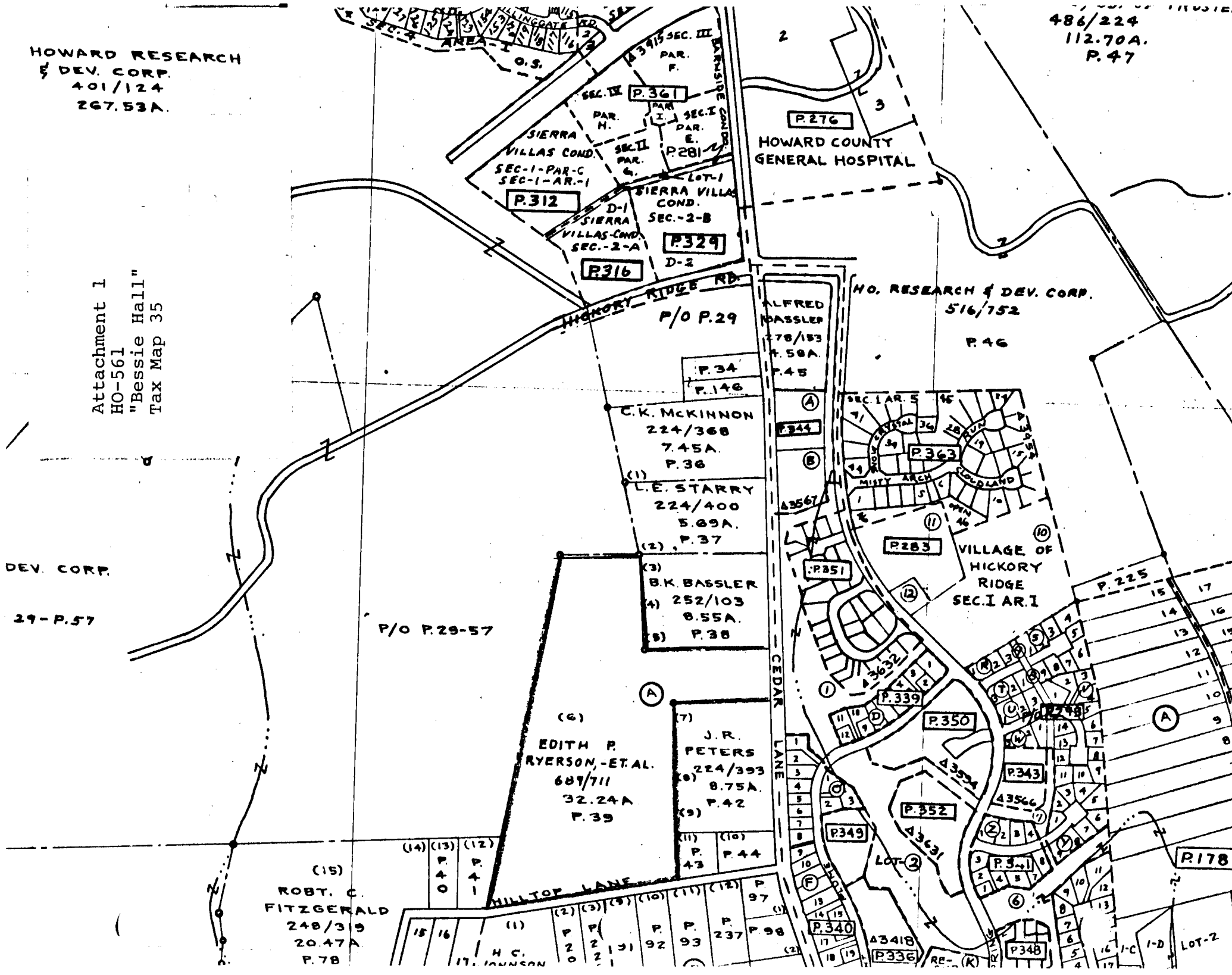

HOWARD COUNTY
GENERAL HOSPITAL

HO. RESEARCH & DEV. CORP.
516/752

ALFRED
BASSLER
278/183
4.58A.
P.45

C.K. MCKINNON
224/368
7.45A.
P.36

L.E. STARRY
224/400
5.69A.
P.37

B.K. BASSLER
252/103
8.55A.
P.38

EDITH P.
RYERSON, -ETAL.
687/711
32.24A
P.39

J.R.
PETERS
224/393
8.75A.
P.42

ROBT. C.
FITZGERALD
248/319
20.47A
P.78

VILLAGE OF
HICKORY
RIDGE
SEC. I AR. I

R178

| | | | | | | | | | | | | | |
|------|------|------|------|------|------|------|------|------|------|------|------|------|------|
| (14) | (13) | (12) | (11) | (10) | (9) | (8) | (7) | (6) | (5) | (4) | (3) | (2) | (1) |
| P.40 | P.41 | P.42 | P.43 | P.44 | P.45 | P.46 | P.47 | P.48 | P.49 | P.50 | P.51 | P.52 | P.53 |
| 15 | 16 | 17 | 18 | 19 | 20 | 21 | 22 | 23 | 24 | 25 | 26 | 27 | 28 |
| 17 | 18 | 19 | 20 | 21 | 22 | 23 | 24 | 25 | 26 | 27 | 28 | 29 | 30 |

H.C.
JOHNSON

P.340
P.336

P.348

LOT-2

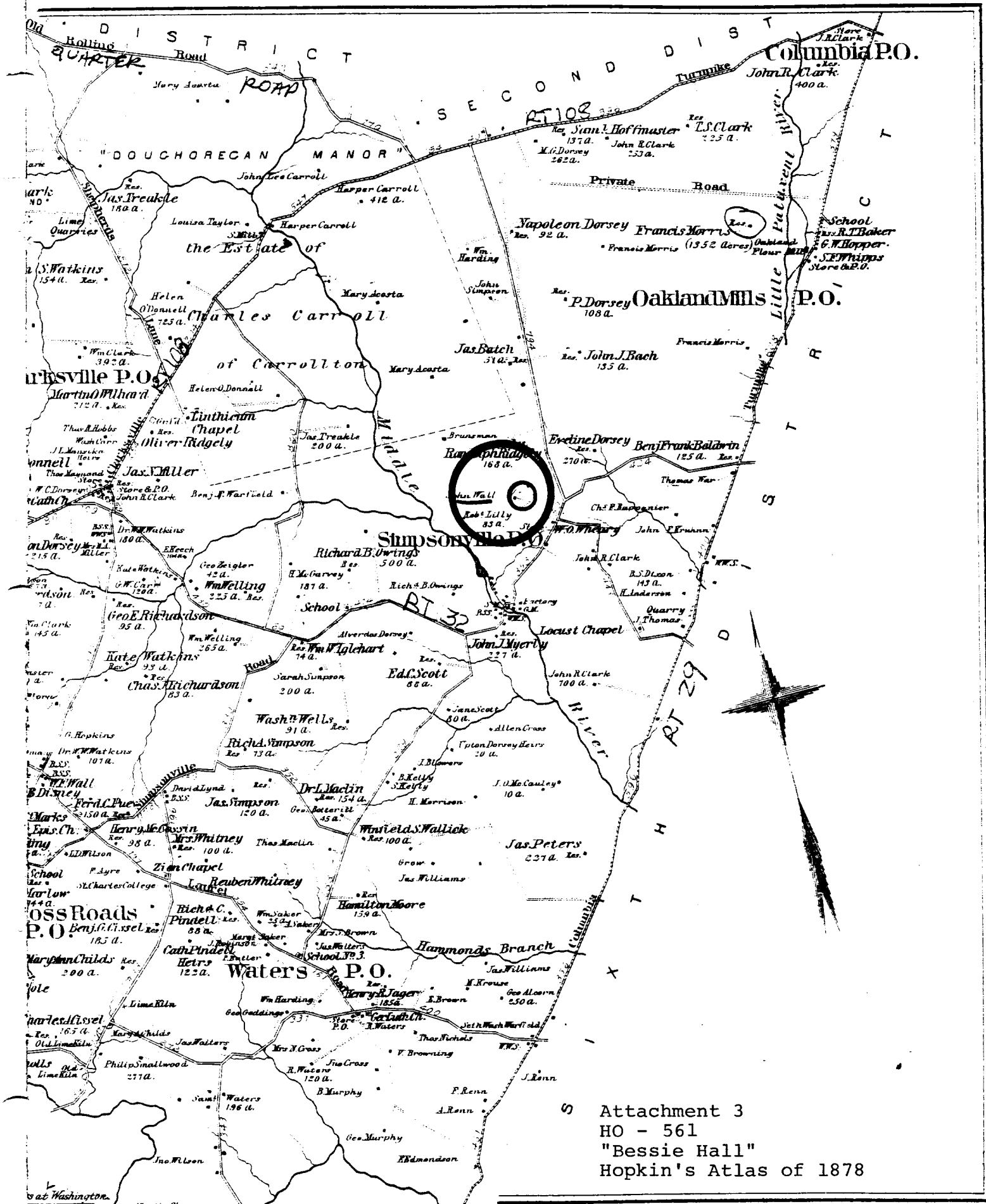

Attachment 3
 HO - 561
 "Bessie Hall"
 Hopkin's Atlas of 1878

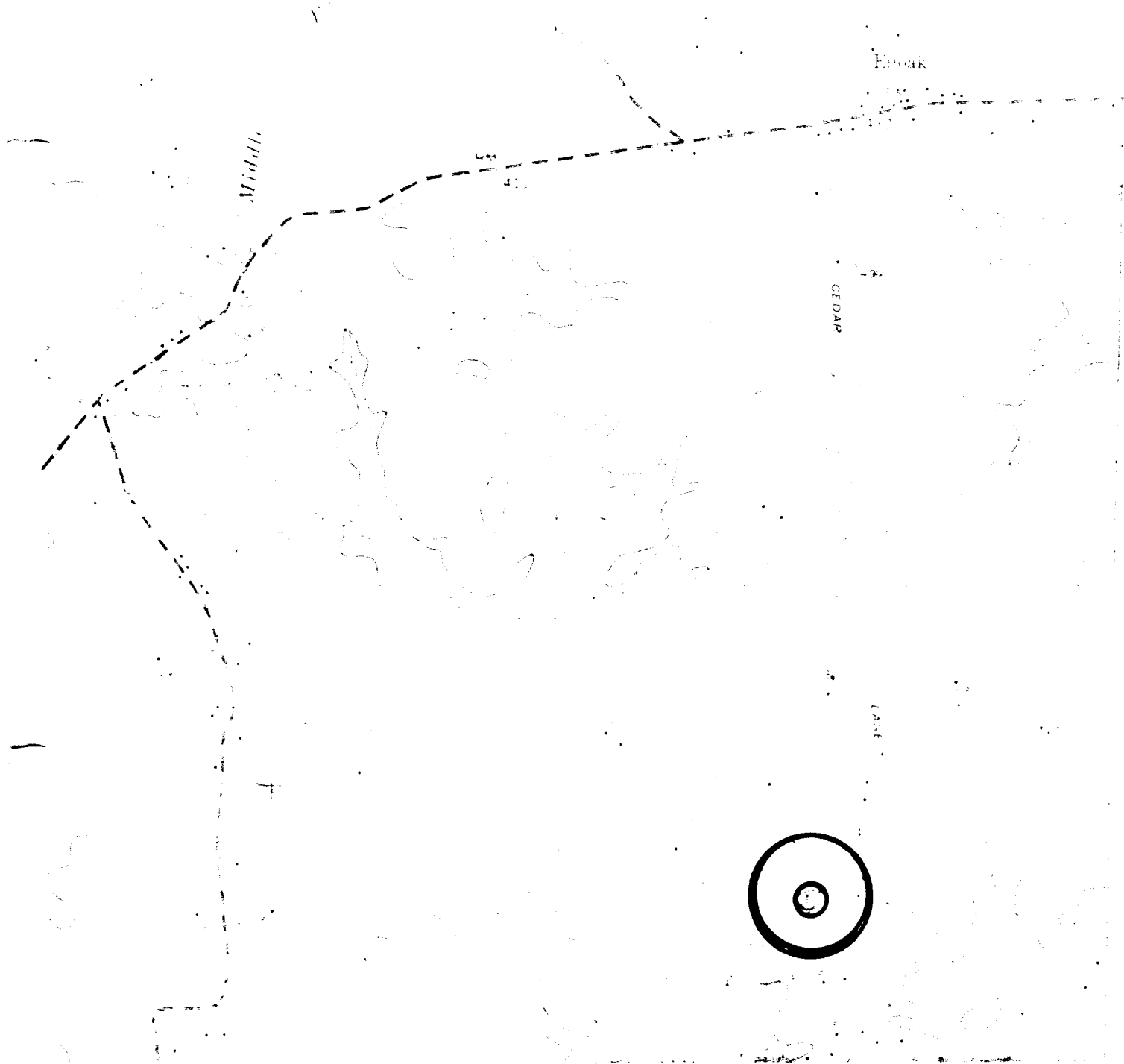

Attachment 2
HO-561
"
Bessie Hall"
U.S. Geological Survey Map
Clarksville Quadrangle

1915
U.S. Geol. Surv.