

HO-560
The Hoffman Farm
West Friendship
Private

1812

The Hoffman Farm faces north on the south side of Route 144, 4/10 of a mile east of its intersection with Route 32.

It is a five bay wide, one room deep, two story high, gabled roof (running east-west) stone (covered with stucco) house, resting on a stone foundation, featuring wide brick chimneys inset into its east and west walls, a central, intersecting attic gable on its north facade, and a two bay wide, one room deep, two story high, intersecting gable roof (running north-south) frame (covered with clapboard) south wing, resting on a stone foundation, extending from the west side of the main building block's south wall, creating an "L" plan. A wide, central brick chimney is inset into its south wall. A hipped roof, one story high, open porch runs along the east side of the main building block's south wall, connecting with a one story high, shed roofed, open porch running along the entire east elevation of the south wing, supported by six square, wooden posts.

The north facade features a central, rectangular entrance door, covered by a one story high, hipped roof, open porch which runs along this elevation, supported by five turned posts and two pilasters.

MARYLAND HISTORICAL TRUST

HO-560
 Sykesville Quad
 District 3
 MAGI #1405605335

INVENTORY FORM FOR STATE HISTORIC SITES SURVEY

1 NAME
 HISTORIC
 AND/OR COMMON The Hoffman Farm

2 LOCATION
 STREET & NUMBER 12393 Route 144, Frederick Road
 CITY, TOWN West Friendship VICINITY OF CONGRESSIONAL DISTRICT 6th
 STATE Maryland COUNTY Howard

3 CLASSIFICATION

CATEGORY	OWNERSHIP	STATUS	PRESENT USE	
<input type="checkbox"/> DISTRICT	<input type="checkbox"/> PUBLIC	<input type="checkbox"/> OCCUPIED	<input type="checkbox"/> AGRICULTURE	<input type="checkbox"/> MUSEUM
<input checked="" type="checkbox"/> BUILDING(S)	<input checked="" type="checkbox"/> PRIVATE	<input checked="" type="checkbox"/> UNOCCUPIED	<input type="checkbox"/> COMMERCIAL	<input type="checkbox"/> PARK
<input type="checkbox"/> STRUCTURE	<input type="checkbox"/> BOTH	<input type="checkbox"/> WORK IN PROGRESS	<input type="checkbox"/> EDUCATIONAL	<input checked="" type="checkbox"/> PRIVATE RESIDENCE Farm
<input type="checkbox"/> SITE	PUBLIC ACQUISITION	ACCESSIBLE	<input type="checkbox"/> ENTERTAINMENT	<input type="checkbox"/> RELIGIOUS planned
<input type="checkbox"/> OBJECT	<input type="checkbox"/> IN PROCESS	<input checked="" type="checkbox"/> YES RESTRICTED	<input type="checkbox"/> GOVERNMENT	<input type="checkbox"/> SCIENTIFIC for devel-
	<input type="checkbox"/> BEING CONSIDERED	<input type="checkbox"/> YES UNRESTRICTED	<input type="checkbox"/> INDUSTRIAL	<input type="checkbox"/> TRANSPORTATION opment
		<input type="checkbox"/> NO	<input type="checkbox"/> MILITARY	<input type="checkbox"/> OTHER

4 OWNER OF PROPERTY
 NAME Mr. Donald & Mr. William C. Hoffman Telephone #:
 STREET & NUMBER 12393 Route 144
 CITY, TOWN West Friendship VICINITY OF STATE, zip code Maryland 21794

5 LOCATION OF LEGAL DESCRIPTION
 COURTHOUSE, Tax Map 15, p. 88 Liber #: 55
 REGISTRY OF DEEDS, ETC. Hall of Records Folio #: 414
 STREET & NUMBER Howard County Court House
 CITY, TOWN Ellicott City STATE Maryland

6 REPRESENTATION IN EXISTING SURVEYS
 TITLE Howard County Historic Sites Inventory
 DATE 1978-1979 FEDERAL STATE COUNTY LOCAL
 DEPOSITORY FOR SURVEY RECORDS Maryland Historical Trust
 CITY, TOWN 21 State Circle, Annapolis STATE Maryland

7 DESCRIPTION

CONDITION		CHECK ONE	CHECK ONE
<input checked="" type="checkbox"/> EXCELLENT	<input type="checkbox"/> DETERIORATED	<input type="checkbox"/> UNALTERED	<input checked="" type="checkbox"/> ORIGINAL SITE
<input type="checkbox"/> GOOD	<input type="checkbox"/> RUINS	<input checked="" type="checkbox"/> ALTERED	<input type="checkbox"/> MOVED DATE _____
<input type="checkbox"/> FAIR	<input type="checkbox"/> UNEXPOSED		

DESCRIBE THE PRESENT AND ORIGINAL (IF KNOWN) PHYSICAL APPEARANCE

The Hoffman Farm faces north on the south side of Route 144, 4/10 of a mile east of its intersection with Route 32.

It is a five bay wide, one room deep, two story high, gabled roof (running east-west) stone (covered with stucco) house, resting on stone foundation, featuring wide, brick chimneys inset into its east and west walls, a central, intersecting attic gable on its north facade, and a two bay wide, one room deep, two story high, intersecting gable roof (running north-south) frame (covered with clapboard) south wing, resting on a stone foundation, extending from the west side of the main building block's south wall, creating an "L" plan. A wide central, brick chimney is inset into its south wing. A hipped roof, one story high, open porch runs along the east side of the main building block's south wall, connecting with a one story high, shed roofed, open porch, running along the entire east elevation of the south wing. Six square, wooden posts support its roof.

THE NORTH ELEVATION

The north facade features a central, rectangular, cross paneled entrance door, surmounted by a transom and flanked on either side by two rectangular, double-hung windows, holding two-over-two lights, surmounted by flat, wooden lintels, underlined by flat wooden sills and decorated with shutters, all of which is vertically aligned and proportionally scaled to five similar, second floor windows. A one story high, hipped roof, open porch runs along this elevation, supported by five turned posts and two pilasters, held by scrolled brackets. Four wooden steps lead to its landing.

This elevation also features the central intersecting gable, which holds a roman arched, six-over-six light window.

THE SOUTH ELEVATION

The east side of the main building block holds a central bay, rectangular, cross paneled door, surmounted by a four light transom. A rectangular, double-hung first floor window rests in the second east bay. The second floor of this section holds two rectangular, double-hung windows, with six-over-six lights, underlined by wooden sills and decorated with green shutters.

The south elevation of the south wing holds a one story high, shed roofed, frame appendage with two, two light, rectangular windows.

CONTINUE ON SEPARATE SHEET IF NECESSARY

This section holds no second floor windows, but two six light, horizontal, rectangular, attic windows.

THE WEST ELEVATION OF THE STONE HOUSE

The east and west elevations of the stone house hold two square, four light, attic windows.

THE EAST ELEVATION OF THE FRAME SOUTH WING

The east elevation of the south wing holds two central bay, rectangular, fifteen light, first floor, entrance doors, flanked by single rectangular, double-hung windows, holding two-over-two lights. Two similar, second floor windows rest above.

THE WEST ELEVATION OF THE FRAME SOUTH WING

The west wall of the south wing holds two first and second floor, rectangular, double-hung, vertically aligned windows, holding two-over-two lights.

Southeast of the house lies a stone smoke house, and outbuildings and south west of the house a frame tenant house.

8 SIGNIFICANCE

HO-560
Sykesville Quad
District 3

PERIOD	AREAS OF SIGNIFICANCE -- CHECK AND JUSTIFY BELOW			
<input type="checkbox"/> PREHISTORIC	<input type="checkbox"/> ARCHEOLOGY-PREHISTORIC	<input type="checkbox"/> COMMUNITY PLANNING	<input type="checkbox"/> LANDSCAPE ARCHITECTURE	<input type="checkbox"/> RELIGION
<input type="checkbox"/> 1400-1499	<input checked="" type="checkbox"/> ARCHEOLOGY-HISTORIC	<input type="checkbox"/> CONSERVATION	<input type="checkbox"/> LAW	<input type="checkbox"/> SCIENCE
<input type="checkbox"/> 1500-1599	<input type="checkbox"/> AGRICULTURE	<input type="checkbox"/> ECONOMICS	<input type="checkbox"/> LITERATURE	<input type="checkbox"/> SCULPTURE
<input type="checkbox"/> 1600-1699	<input checked="" type="checkbox"/> ARCHITECTURE	<input type="checkbox"/> EDUCATION	<input type="checkbox"/> MILITARY	<input type="checkbox"/> SOCIAL/HUMANITARIAN
<input type="checkbox"/> 1700-1799	<input type="checkbox"/> ART	<input type="checkbox"/> ENGINEERING	<input type="checkbox"/> MUSIC	<input type="checkbox"/> THEATER
<input checked="" type="checkbox"/> 1800-1899	<input type="checkbox"/> COMMERCE	<input type="checkbox"/> EXPLORATION/SETTLEMENT	<input type="checkbox"/> PHILOSOPHY	<input type="checkbox"/> TRANSPORTATION
<input type="checkbox"/> 1900-	<input type="checkbox"/> COMMUNICATIONS	<input type="checkbox"/> INDUSTRY	<input type="checkbox"/> POLITICS/GOVERNMENT	<input type="checkbox"/> OTHER (SPECIFY)
		<input type="checkbox"/> INVENTION		

SPECIFIC DATES *circa 1812*

BUILDER/ARCHITECT

STATEMENT OF SIGNIFICANCE

The Hoffman Farm is significant to Howard County and the State of Maryland historically through its association with the Hammond, Hipsley and Selby families of Howard County and architecturally as a fine example of an early nineteenth century stone building.

Historically, the property can be traced to 1798 when Charles Hammond laid out "Hammond's Discovery". The building is said to have been constructed by 1812. The property can be traced back in the Howard County Land Records to 1836 when Charles A. Hipsley conveyed some 158 acres to William Gibbons. The property passed through several owners, until it was acquired by Mr. Joseph Selby in 1890 and to this day is owned by this same family. Mrs. Ethel Hoffman was only two years old when she moved into the house in 1890. In 1935, the property was willed to Mrs. Ethel Hoffman, and in 1978, she willed the property to her two sons, who are in the process of selling the farm for development.

Architecturally, the building is a notable stone building, two and a half stories high, featuring a wide, central hall and staircase, basement cooking fireplace, hand hewn log joists and stone walls of two feet in depth.

CONTINUE ON SEPARATE SHEET IF NECESSARY

9 MAJOR BIBLIOGRAPHICAL REFERENCES

Howard County Land Records

CONTINUE ON SEPARATE SHEET IF NECESSARY

10 GEOGRAPHICAL DATA

ACREAGE OF NOMINATED PROPERTY 257 acres

Please see Attachment 1, Tax Map 15

VERBAL BOUNDARY DESCRIPTION

Please see Howard County Land Records, Liber 55 Folio 414

LIST ALL STATES AND COUNTIES FOR PROPERTIES OVERLAPPING STATE OR COUNTY BOUNDARIES

STATE Maryland COUNTY Howard

STATE _____ COUNTY _____

11 FORM PREPARED BY

NAME/TITLE

Cleora Barnes Thompson, Archivist

ORGANIZATION

Office of Planning & Zoning-Comprehensive Planning Section

DATE

STREET & NUMBER

3450 Court House Drive

TELEPHONE

CITY OR TOWN

Ellicott City

STATE

Maryland

The Maryland Historic Sites Inventory was officially created by an Act of the Maryland Legislature, to be found in the Annotated Code of Maryland, Article 41, Section 181 KA, 1974 Supplement.

The Survey and Inventory are being prepared for information and record purposes only and do not constitute any infringement of individual property rights.

RETURN TO: Maryland Historical Trust
The Shaw House, 21 State Circle
Annapolis, Maryland 21401
(301) 267-1438

)))

TITLE SEARCH

HO-560 THE HOFFMAN FARM

prepared by Cleora B. Thompson, A.I.C.P.

<u>DATE</u>	<u>LIBER-FOLIO</u>	<u>GRANTOR</u>	<u>GRANTEE</u>	<u>TRANSACTION</u>
NOTE: This property is now owned by Donald and William C. Hoffman, sons of Ethel Hoffman, who acquired the property in 1935 from her father, Joseph Selby.				
26 Feb. 1890	55-414	Harry M. Benzinger, Trustee	Joseph Selby	Deed to: 1) 25½ acres 2) 6¼ acres for \$10,050.
14 Aug. 1875	35-438	C. O'Donnell Lee and Matilda, of City of Balto.	Frederick Benzinger City of Baltimore	"Hammond's Discovery" Charles Hammond, 1798 Deed to: 1) 25½ acres 2) 6¼ acres for \$5,000
14 Aug. 1875	35-434	Mary Diggs Gouverneur, executrix (by virtue of a mortgage)	C. O'Donnell Lee	Deed to: 1) 25½ acres 2) 6¼ acres
15 April 1863	22-384	William Gibbons	Joseph Renehan	Deed to: 1) 25½ acres 2) 6¼ acres
22 Jan. 1836	20-500	Charles A. Hipsley	William Gibbons	Deed to: 1) 25½ acres 2) 6¼ acres
27 Mar. 1834	18-536 (Anne Arundel County Land Records)	Zachariah Barlow	Charles A. Hipsley	Deed to: 2) 6¼ acres
27 Mar. 1827	12-396 (Anne Arundel County Land Records)	Robert Welsh, Sheriff	Charles A. Hipsley	Deed to: 1) 25½ acres

534

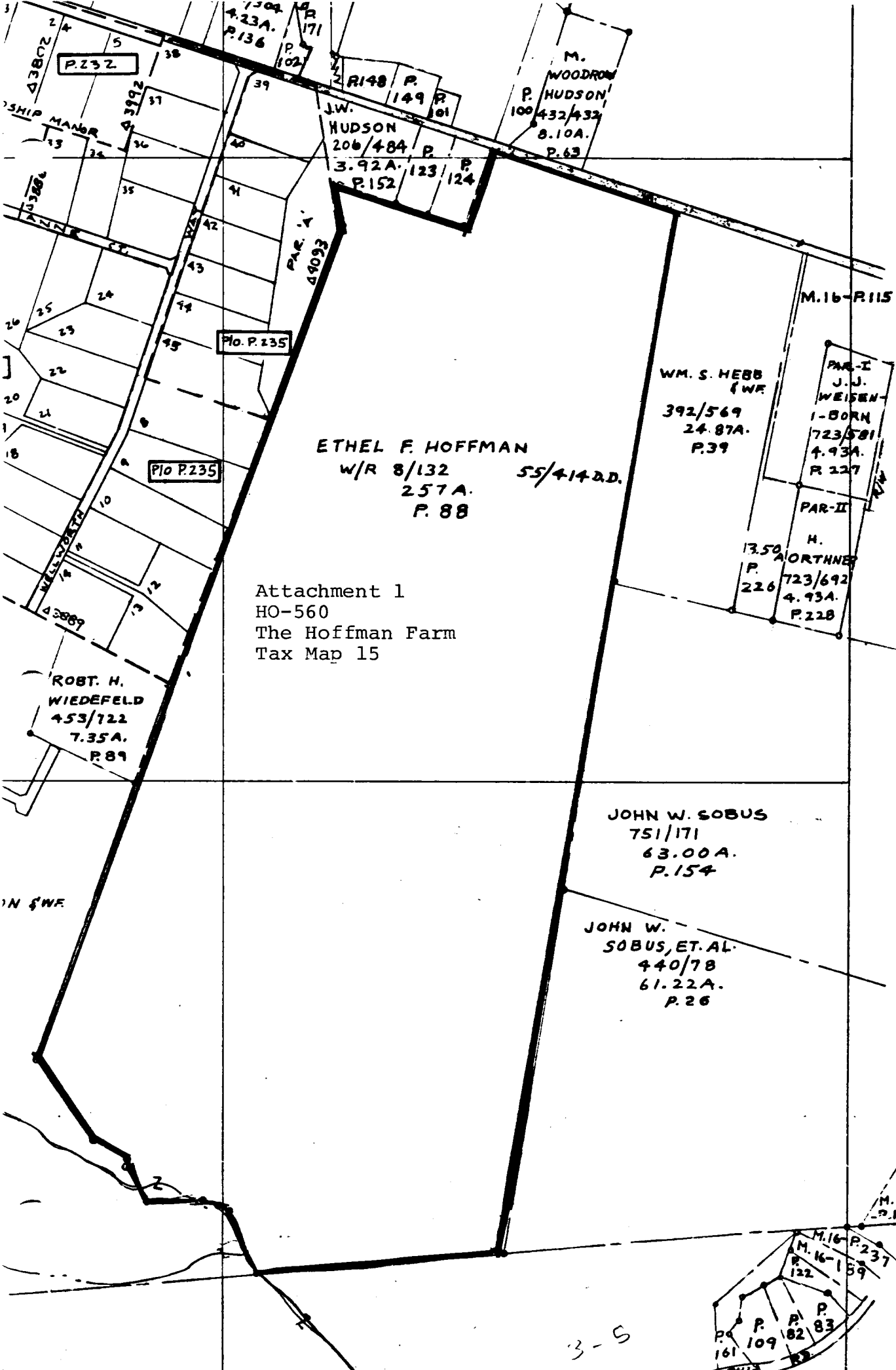

ETHEL F. HOFFMAN
 W/R 8/132 55/4142.D.
 257A.
 P. 88

Attachment 1
 HO-560
 The Hoffman Farm
 Tax Map 15

WM. S. HEBB
 & WF
 392/569
 24.87A.
 P.39

M.16-P.115

PAR-I
 J.J.
 WEISEN-
 1-BORN
 723/581
 4.93A.
 P. 227

PAR-II

H.
 AORTNER
 13.50
 P. 723/692
 4.93A.
 P.228

JOHN W. SOBUS
 751/171
 63.00A.
 P.154

JOHN W.
 SOBUS, ET. AL.
 440/78
 61.22A.
 P.26

531

M.16-
 P.191

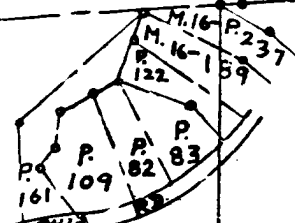

3-5

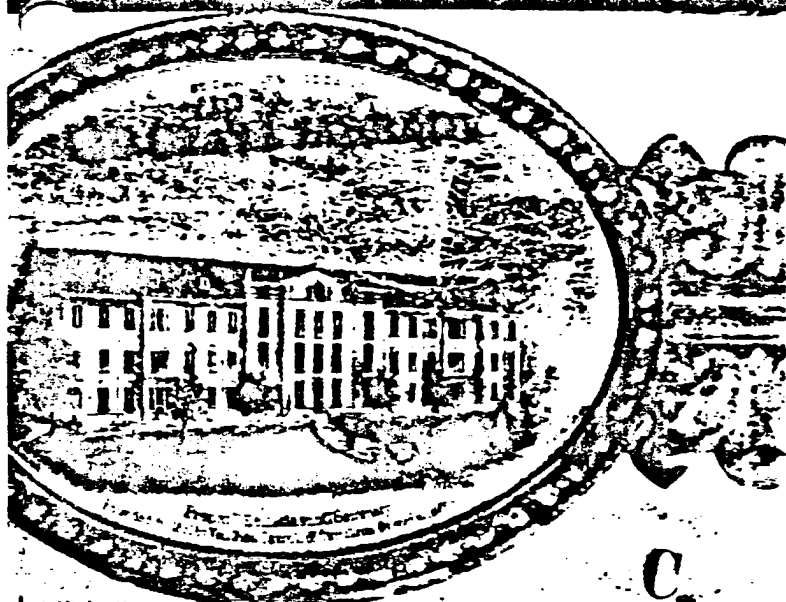

Attachment 4
HO-560
The Hoffman Farm
Martennet Map of 1860



3

CROSS DISTRICT

Third District.

BLACKSMITH.

J. T. ISAAC,
Blacksmith in General,
Woodstock, Howard Co.

Buggies and Carriages on hand and Built to Order. Cast Steel Work of every description, and all kinds of Country Work. Machines Repaired.

HOWARD COUNTY

Scale 1 1/2 inches per Mile



EXPLANATIONS

- Dist. & Co. Lines
 - County Roads
 - Private
 - Turpicks
 - Rail Roads
 - Streams
- The figures along the Roads shows the distance in Rods from junction to junction thereof.

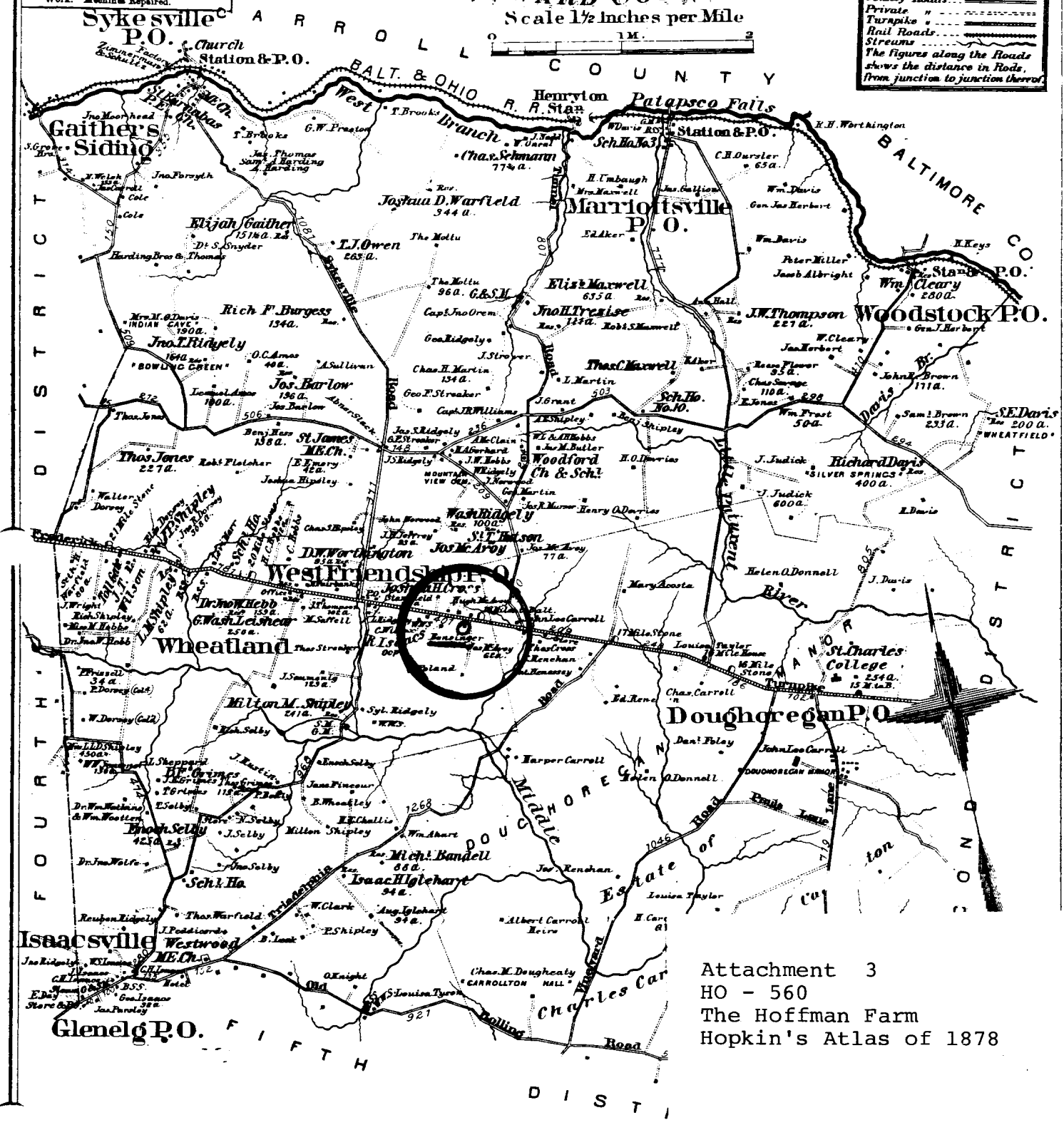

Attachment 3
 HO - 560
 The Hoffman Farm
 Hopkin's Atlas of 1878

Entered according to act of Congress in the year 1878 by C.M. Hopkins in the Office of the Librarian of Congress at Washington

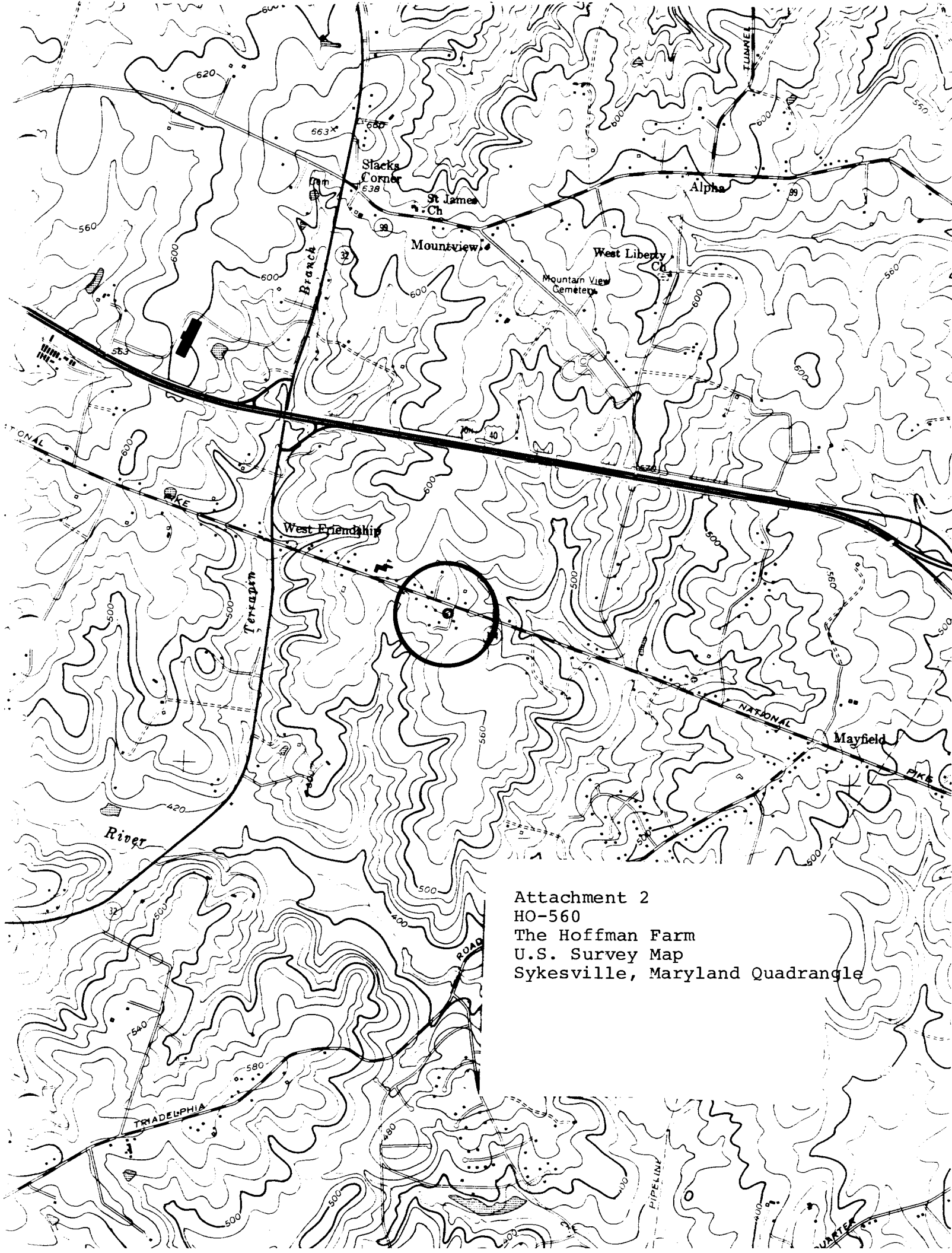

Attachment 2
HO-560
The Hoffman Farm
U.S. Survey Map
Sykesville, Maryland Quadrangle



Name: HO-560
The Hoffman Farm
Location: 12393 Route #144
West Friendship, Maryland
Photographer: Cleora B. Thompson, A.I.C.P.
Date of Photograph: April, 1980
Negatives in possession of the Maryland Historical Trust
View: Southeast
Photographer looking: Northwest
Photograph number: 1 of 1