

HO-552
The Homestead
Woodbine
Private

Circa 1800

The Homestead faces east on the west side of Daisy Road, one mile south of its intersection with Bushy Park Road. It is a four bay wide, one room deep, two story high, gabled roof (running north-south) log (covered with frame ship lap and aluminum siding) house, with a post and beam southeast corner, all of which rests on a stone foundation, featuring wide, brick chimneys inset into its north and south walls and a four bay wide, one room deep, two story high, intersecting gable roof (running east-west) log (covered with aluminum siding) west wing, resting on a stone foundation with wide, stone and brick, central chimney, which extends from the south side of the building's west wall, creating an "L" plan.

A two bay wide, one room deep, one story high, shed roofed kitchen wing is centered on the east wall of the main building block. A one story high, shed roofed, open porch covers the north bay window and second north bay entrance of the main building block's west wall, connecting to a similar, open porch, running along the three east bays of the north wall of the west wing. The west bay of this latter porch is enclosed, providing a pantry for what may once have been the kitchen for the house.

The original barn, smoke house and other outbuildings are located west and south of the house.

Located on a tract of land called "Columbia" which was composed of parts of Snowden's Range and Ridgely's Range, this outstanding log building features unusually fine woodwork, original staircase, wide, random width floors, original open bible and cross paneled doors, and double-hung window sashes featuring pegged, mortise and tenon construction.

MARYLAND HISTORICAL TRUST

HO-552
Woodbine Quad.
District 4
MAGI #1405525235

INVENTORY FORM FOR STATE HISTORIC SITES SURVEY

1 NAME

HISTORIC The Homestead
AND/OR COMMON

2 LOCATION

STREET & NUMBER 2250 Daisy Road
CITY, TOWN Woodbine VICINITY OF CONGRESSIONAL DISTRICT 6th
STATE Maryland COUNTY Howard

3 CLASSIFICATION

CATEGORY	OWNERSHIP	STATUS	PRESENT USE	
<input checked="" type="checkbox"/> DISTRICT	<input type="checkbox"/> PUBLIC	<input checked="" type="checkbox"/> OCCUPIED	<input type="checkbox"/> AGRICULTURE	<input type="checkbox"/> MUSEUM
<input type="checkbox"/> BUILDING(S)	<input checked="" type="checkbox"/> PRIVATE	<input type="checkbox"/> UNOCCUPIED	<input type="checkbox"/> COMMERCIAL	<input type="checkbox"/> PARK
<input type="checkbox"/> STRUCTURE	<input type="checkbox"/> BOTH	<input type="checkbox"/> WORK IN PROGRESS	<input type="checkbox"/> EDUCATIONAL	<input checked="" type="checkbox"/> PRIVATE RESIDENCE
<input type="checkbox"/> SITE	PUBLIC ACQUISITION	ACCESSIBLE	<input type="checkbox"/> ENTERTAINMENT	<input type="checkbox"/> RELIGIOUS
<input type="checkbox"/> OBJECT	<input type="checkbox"/> IN PROCESS	<input checked="" type="checkbox"/> YES: RESTRICTED	<input type="checkbox"/> GOVERNMENT	<input type="checkbox"/> SCIENTIFIC
	<input type="checkbox"/> BEING CONSIDERED	<input type="checkbox"/> YES: UNRESTRICTED	<input type="checkbox"/> INDUSTRIAL	<input type="checkbox"/> TRANSPORTATION
		<input type="checkbox"/> NO	<input type="checkbox"/> MILITARY	<input type="checkbox"/> OTHER

4 OWNER OF PROPERTY

NAME Mr. & Mrs. Larry Drummond Telephone #: 489-4558
STREET & NUMBER 2250 Daisy Road
CITY, TOWN Woodbine VICINITY OF STATE, zip code Maryland

5 LOCATION OF LEGAL DESCRIPTION

Tax Map 13, Blk. 6 - p. 157 Liber #: 915
COURTHOUSE, REGISTRY OF DEEDS, ETC. Hall of Records Folio #: 232
STREET & NUMBER Howard County Court House
CITY, TOWN Ellicott City STATE Maryland

6 REPRESENTATION IN EXISTING SURVEYS

TITLE Howard County Historic Sites Inventory
DATE 1978-1979 FEDERAL STATE COUNTY LOCAL
DEPOSITORY FOR SURVEY RECORDS Maryland Historical Trust
CITY, TOWN 21 State Circle, Annapolis STATE Maryland

7 DESCRIPTION

CONDITION		CHECK ONE	CHECK ONE
<input checked="" type="checkbox"/> EXCELLENT	<input type="checkbox"/> DETERIORATED	<input type="checkbox"/> UNALTERED	<input checked="" type="checkbox"/> ORIGINAL SITE
<input type="checkbox"/> GOOD	<input type="checkbox"/> RUINS	<input checked="" type="checkbox"/> ALTERED	<input type="checkbox"/> MOVED DATE _____
<input type="checkbox"/> FAIR	<input type="checkbox"/> UNEXPOSED		

DESCRIBE THE PRESENT AND ORIGINAL (IF KNOWN) PHYSICAL APPEARANCE

The Homestead faces east on the west side of Daisy Road, one mile south of its intersection with Bushy Park Road. It is a four bay wide, one room deep, two story high, gabled roof (running north-south) log (covered with frame ship lap and aluminum siding) house with a post and beam southeast corner, all of which rests on a stone foundation, featuring wide, brick, chimneys inset into its north and south walls and a four bay wide, one room deep, two story high, intersecting gable roof (running east-west) log (covered with aluminum siding) west wing, resting on a stone foundation with wide, stone and brick, central chimney, which extends from the south side of the building's west wall, creating an "L" plan.

A two bay wide, one room deep, one story high, shed roofed kitchen wing is centered on the east wall of the main building block. A one story high, shed roofed, open porch covers the north bay window and second north bay entrance of the main building block's west wall, connecting to a similar, open porch, running along the three east bays of the north wall of the west wing. The west bay of this latter porch is enclosed, providing a pantry for what may once have been the kitchen for the house.

EAST ELEVATION

The east elevation of the east wing holds end bay, rectangular, first floor windows, with pegged, double-hung sashes, holding six-over-six lights. Four, similar, vertically aligned, second floor windows rest above.

The two first floor central bays of this wall are covered by a one story high, shed roofed, bath-kitchen appendage, constructed in 1936. It holds the original, central, rectangular, open bible and cross paneled entrance door for the east wing, which is of pegged mortise and tenon construction. A one-one light, rectangular, kitchen window lies south of this entrance. The north and south walls of this bath-kitchen appendage hold singular, rectangular, one-one light windows.

THE WEST ELEVATION OF THE EAST WING

The west elevation of the east wing holds a first floor, north bay, end window, similar to those already described and a rectangular, open bible and cross paneled, first floor entrance door in the second north bay. Two second floor windows, similar to those described, punctuate this wall.

A one story high, shed roofed, open porch covers this door and window and connects with the open porch along the north wall of the west wing.

The two south bays of the west wall of the east wing are composed of the east wall of the four bay wide, one room deep, two story high, intersecting gable roof (running east-west) log west wing.

The west elevation of this latter section holds a central, rectangular, first and second floor, double-hung window, holding six-over-six lights.

THE NORTH ELEVATION

The north elevation of the east wing holds a rectangular basement entrance, east of center, covered by a gabled roof (running north-south) enclosure. Two square, four light attic windows alone punctuate this wall.

The north elevation of the west wing holds rectangular entrances in its east end bay and second west bay, the latter of which enters into a pantry which has been created by enclosing this section of the one story high, shed roofed, open porch, running along this elevation. A rectangular, double-hung, first floor window, holding six-over-six lights, rests in the west end bay of this wall.

On the east side of this wall a second floor, eyebrow, sliding window, holding four-four lights is found.

THE SOUTH ELEVATION

The south elevation of the east wing is composed of post and plank construction, rather than log. It holds a first and second floor, vertically aligned window in its west bay and two square, four light, attic windows above.

The south elevation of the west wing holds two central bay, rectangular, first floor, double-hung windows, holding six-over-six lights. Originally this wall held end bay rectangular, entrance doors. That in the west end bay remains, but that in the east end bay has been replaced by the addition of a hipped roof, one story high, bay window, which holds three rectangular, double-hung windows, holding six-over-six lights.

The east side of the west wing's south wall holds two four-four light, second floor, sliding, eyebrow windows, with a similar, but six light, second floor, eyebrow window located on the west side of this wall.

It is not in the exterior, however, that this building is notable, though it features fine scale and proportions, and beneath the aluminum, ship lap siding, but it is in the original detail of the interior that this building excels, presenting one of the most notable examples of vernacular, eighteenth century construction and stylistic detail in Howard County.

THE ORIGINAL DWELLING

The north half of the east wing is the original log dwelling, a two bay wide, one room deep, two story high, gabled roof (running north-south) log (covered with ship lap siding) structure.

It was constructed on a full field stone foundation, with the stone base for the wide brick chimney on its north wall. It features large log joists (running east-west). An open door with five wide, poured in place concrete steps, leads to ground level on the east side of the chimney, with another interior staircase to the first floor, located along its south wall.

The small, open bible and cross paneled, rectangular, entrance door, from the first floor hall to this staircase, exemplifies the fine construction and stylistic detail, found throughout the house. It is of pegged mortise and tenon construction. Its door frame matches those of the east and west entrance doors, with similar frames for the first floor east and west windows. These frames are exquisitely sculptured into three deep, flutes with a deep central "V" cut. Such woodwork can be found in Williamsburg circa 1725.

The pilasters and lintels of these door and window frames are joined by squares inscribed with deeply cut circles, all of which are encased in a mitred molding.

The log construction features one log over another, with very few notches, and those low pitched, when they occur. These logs are filled with small, flat, diagonally placed stones, then covered with plaster. The lathing, which holds the plaster, is also unusual, of hand split construction.

Floors throughout the house are of wide, random width and are top nailed in the original dwelling unit with hand wrought nails.

THE PLAN

The plan for this original dwelling was quite simple, a wide hall (running east-west) along the south wall of the house, with east, west, and south entrance doors and one large room on the north side of the house, heated by a central fire place on its north wall. The fluted pilasters flanking the fireplace match those of the east and west windows, which light this room, as well as the four entrance doors (i.e. the east door, the west door, the cellar door, and the south door.)

The only alteration which has occurred in this section has been the opening up of the north wall of the hall, providing a greater flow of space.

The staircase, which runs up the south wall of the entrance hall, features square balusters, held by a balustrade, which curves at the top of the stairs to form a very graceful line for the upstairs hall.

The plan for the upstairs of this section is similar to that below, but features a less ornate, but similar woodwork. The two flutes of the pilasters are more squarely cut and the central circle is flat, surrounded by another more squarely cut circular motif, decorating the squares, which join the pilasters and lintels. The woodwork of the east and west hall windows, as well as the east and west bedroom windows, all match.

This section is believed to be the first section constructed, although no such dwelling unit has yet been found listed under the 1798 Tax Assessment List. Mrs. Drummond spent two days in Annapolis examining records dealing with Snowden's Range, Ridgely's Range and Columbia, which is the tract of land carved out of both on which the house stands. In her search, only a 16' x 14' log stable was found belonging to a Samuel Welsh. It is conceivable then, that the log stable mentioned in that Tax List was "the keeping room" now a den, called the log room, or the kitchen, each of which features these dimensions. If so, one of these rooms may be the first structure on the property. These rooms, however, appear to have been constructed as a whole, each being only half of the four bay wide, one room deep, two story high gabled roof, log, west wing, whose east side probably served as the "keeping room" for the property and whose west side served as the kitchen for the house, with a large, double stone chimney placed between them.

Servants quarters might have been located above the kitchen, with additional bedrooms located over the "keeping room". This entire service wing is constructed in the same manner as the dwelling, but without embellishments.

THE KEEPING ROOM, COMMONLY CALLED THE LOG ROOM

The "keeping room" is a two bay wide, one room deep, exposed log room measuring 16' x 14', with a small enclosed staircase located along its east wall and a wide stone chimney taking up most of its west wall.

An open court yard was originally formed from the south wall of the dwelling unit and the east wall of the service wing, with an entrance into the service wing, located on the north side of the east wall of the "keeping room". This room, thus, originally had three, exterior, rectangular entrances; north and south entrance doors in the east bay, and the east entrance just mentioned which led in and out of the courtyard. Today, its south door has been replaced by a bay window. What remains of the original door frame is of note for it is put together with square pegs hammered into round holes.

The enclosed staircase located along its east wall, features a pantry beneath the staircase. A rectangular entrance, surmounted by a four light transom opens into this storage area. The ceiling of this area reveals a rectangular cut leading to a theory that originally a ladder led to the loft above. The log construction is completely exposed on the south walls of this room and part of its west wall. The major part of this west wall, however, is taken up by the large, stone, cooking fireplace, which features a double header, arched brick, lintel,

covered by a copper hood, which has recently been installed.

An interior, rectangular entrance on the north side of the west wall leads into what may have been the kitchen for the house.

THE KITCHEN

The kitchen is two bays wide and one room deep, also measuring 16' x 14'. It features a wide, central, stone cooking fireplace, with wide, hand hewn log lintel, on its east wall and an enclosed staircase in its southwest corner. The walls and ceiling of this entire room are paneled with tongue-and-groove, full height wainscoting. The floors for this room are laid diagonally.

SERVANTS QUARTERS NOW GUEST ROOM

The large room above the kitchen, measures 14 x 16 and features a central, west, rectangular, double-hung window and small south, six light, sliding eye brow window. Floors are of very wide, random width. A very wide stone fireplace is centered on the east wall of this room. A doorway north of the fireplace leads into a hall, which runs the length of the east side of the service wing.

SECOND FLOOR ABOVE "KEEPING ROOM"

The second floor of the east side of the west wing has been altered, probably around 1910. Originally it may have held one large sleeping loft or been divided into two rooms. The present arrangement, which features a hall (running east-west) along its north wall, with two south rooms and a staircase running along its east wall; probably stems from circa 1910. The west wall of the second floor bath covers the east side of the double chimney stack, which probably holds a large fireplace, similar to that found on the east wall of the guest room.

THE POST AND PLANK ADDITION

It is believed that, by the mid eighteenth century and certainly circa 1800, the log dwelling unit and its log service wing were constructed and that later, the corner, formed by these two buildings, was filled in by a two bay wide, one room deep, two story high, gabled roof (running north-south) post and plank extension.

This theory was developed when it was found that the south side of the east wall and the entire south wall of the east wing were not of solid log construction, but post and plank.

THE DINING ROOM

The corner, which formerly provided a sheltered courtyard now provides one large, two bay wide, one bay deep, well lighted dining room. It holds an east and south window, as well as three entrances, one of which leads into the kitchen, which once was another east window for the house, prior to 1936, when the kitchen was added. A north door enters into the large hall of the original dwelling unit and a west door leads into the "keeping room".

A fireplace is centered on the south wall of this room, which features wide, random width floors.

THE MASTER BEDROOM

Above the dining room was the master bedroom. It is another large, well lighted room, featuring two east windows and a south window. An enclosed staircase to the attic runs along its north wall, while a brick chimney is centered on its south wall. This chimney was originally covered with plaster and its east side deepened by some inches to place the fireplace in the center of the chimney stack, although as it is now exposed, it is seen to be on the east side of this stack, allowing the flue from the dining room fireplace to run up its west side.

The floors are of wide random width, similar to those throughout each section of the house

The entire house is in excellent condition and is being thoroughly restored by its owners Larry and Kay Drummond, who are making a study of early eighteenth and nineteenth century construction methods.

Auxiliary farm buildings lie west of the house, which is built on a high knoll overlooking Daisy Road.

8 SIGNIFICANCE

HO-552
Woodbine Quad
District 4

PERIOD	AREAS OF SIGNIFICANCE -- CHECK AND JUSTIFY BELOW			
<input type="checkbox"/> PREHISTORIC	<input type="checkbox"/> ARCHEOLOGY-PREHISTORIC	<input type="checkbox"/> COMMUNITY PLANNING	<input type="checkbox"/> LANDSCAPE ARCHITECTURE	<input type="checkbox"/> RELIGION
<input type="checkbox"/> 1400-1499	<input checked="" type="checkbox"/> ARCHEOLOGY-HISTORIC	<input type="checkbox"/> CONSERVATION	<input type="checkbox"/> LAW	<input type="checkbox"/> SCIENCE
<input type="checkbox"/> 1500-1599	<input type="checkbox"/> AGRICULTURE	<input type="checkbox"/> ECONOMICS	<input type="checkbox"/> LITERATURE	<input type="checkbox"/> SCULPTURE
<input type="checkbox"/> 1600-1699	<input checked="" type="checkbox"/> ARCHITECTURE	<input type="checkbox"/> EDUCATION	<input type="checkbox"/> MILITARY	<input type="checkbox"/> SOCIAL/HUMANITARIAN
<input checked="" type="checkbox"/> 1700-1799	<input type="checkbox"/> ART	<input type="checkbox"/> ENGINEERING	<input type="checkbox"/> MUSIC	<input type="checkbox"/> THEATER
<input type="checkbox"/> 1800-1899	<input type="checkbox"/> COMMERCE	<input type="checkbox"/> EXPLORATION/SETTLEMENT	<input type="checkbox"/> PHILOSOPHY	<input type="checkbox"/> TRANSPORTATION
<input type="checkbox"/> 1900-	<input type="checkbox"/> COMMUNICATIONS	<input type="checkbox"/> INDUSTRY	<input type="checkbox"/> POLITICS/GOVERNMENT	<input type="checkbox"/> OTHER (SPECIFY)
		<input type="checkbox"/> INVENTION		

SPECIFIC DATES circa 1799 BUILDER/ARCHITECT

STATEMENT OF SIGNIFICANCE

The Homestead is significant to Howard County and the State of Maryland historically through its association with the Snowden family and architecturally as one of the finest and best preserved examples of eighteenth century construction in Howard County.

Historically, the building is placed on part of a tract of land called "Columbia", which was carved out of two large tracts of land called "Snowden's Range" and "Ridgely's Range." The 1878 Hopkin's Atlas notes the property as owned by Samuel Waters.

Although only a 16' X 14' log stable was found in the 1798 property tax list under this property, it is believed that the building stood here prior to that time.

It is in its architecture and its stylistic interior detail, that the building excels, featuring exceptionally fine woodwork, characteristic of that found in Williamsburg in 1725. Open bible and cross paneled doors, wide, random width floors, log construction, covered with ship-lap siding, as well as hand hewn lathing, on which plaster was placed all point to an early construction date and offer an excellent example of eighteenth century building techniques.

9 MAJOR BIBLIOGRAPHICAL REFERENCES

Interview with Larry and Kay Drummond at their residence, Saturday, April 5, 1980. Private Research of Larry and Kay Drummond

CONTINUE ON SEPARATE SHEET IF NECESSARY

10 GEOGRAPHICAL DATA

ACREAGE OF NOMINATED PROPERTY 14.80 acres

Please see Attachment 1, Tax Map 13

VERBAL BOUNDARY DESCRIPTION

Please see Howard County Land Records, Liber 915 Folio 232

LIST ALL STATES AND COUNTIES FOR PROPERTIES OVERLAPPING STATE OR COUNTY BOUNDARIES

STATE Maryland COUNTY Howard

STATE COUNTY

11 FORM PREPARED BY

NAME / TITLE

Cleora Barnes Thompson, Archivist

ORGANIZATION

Office of Planning & Zoning-Comprehensive Planning Section

DATE

STREET & NUMBER

3450 Court House Drive

TELEPHONE

CITY OR TOWN

Ellicott City

STATE

Maryland

The Maryland Historic Sites Inventory was officially created by an Act of the Maryland Legislature, to be found in the Annotated Code of Maryland, Article 41, Section 181 KA, 1974 Supplement.

The Survey and Inventory are being prepared for information and record purposes only and do not constitute any infringement of individual property rights.

RETURN TO: Maryland Historical Trust
The Shaw House, 21 State Circle
Annapolis, Maryland 21401
(301) 267-1438

Attachment 1
 HO-552
 The Homestead
 Tax Maps 13 and 14

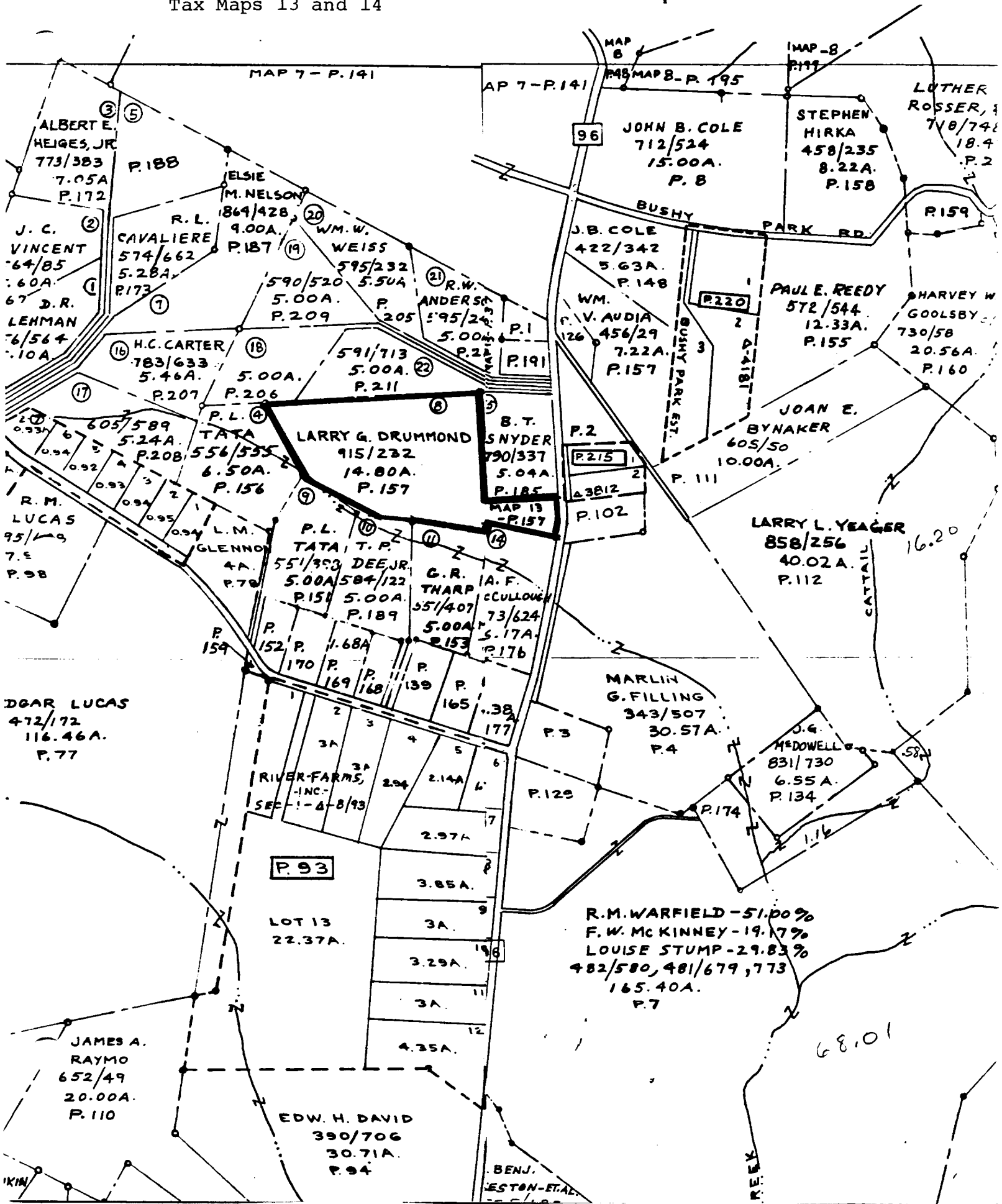

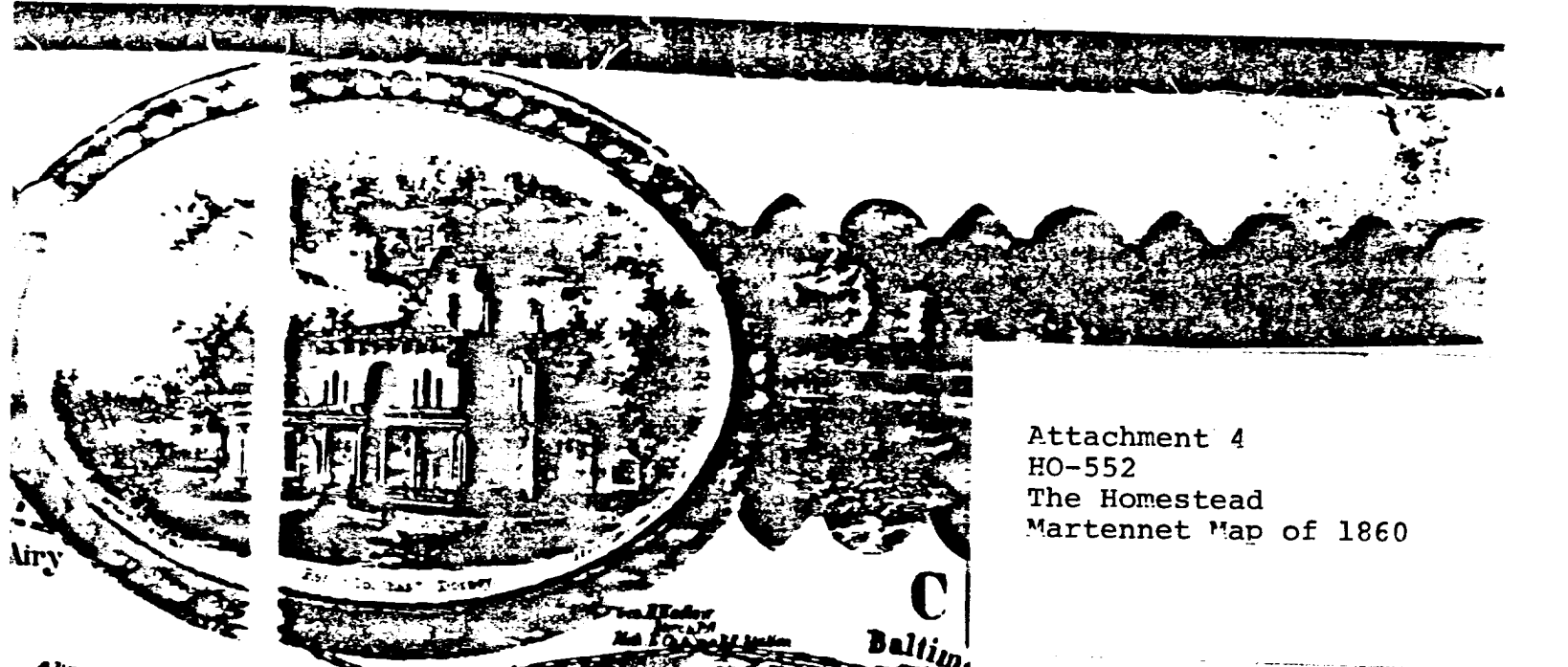

Attachment 4
 HO-552
 The Homestead
 Martennet Map of 1860





Attachment 3
 HO - 552
 The Homestead
 Hopkin's Atlas of 1878

Entered according to act of Congress in the year 1878 by E.H. Hopkins in the Office of the Librarian of Congress at Washington

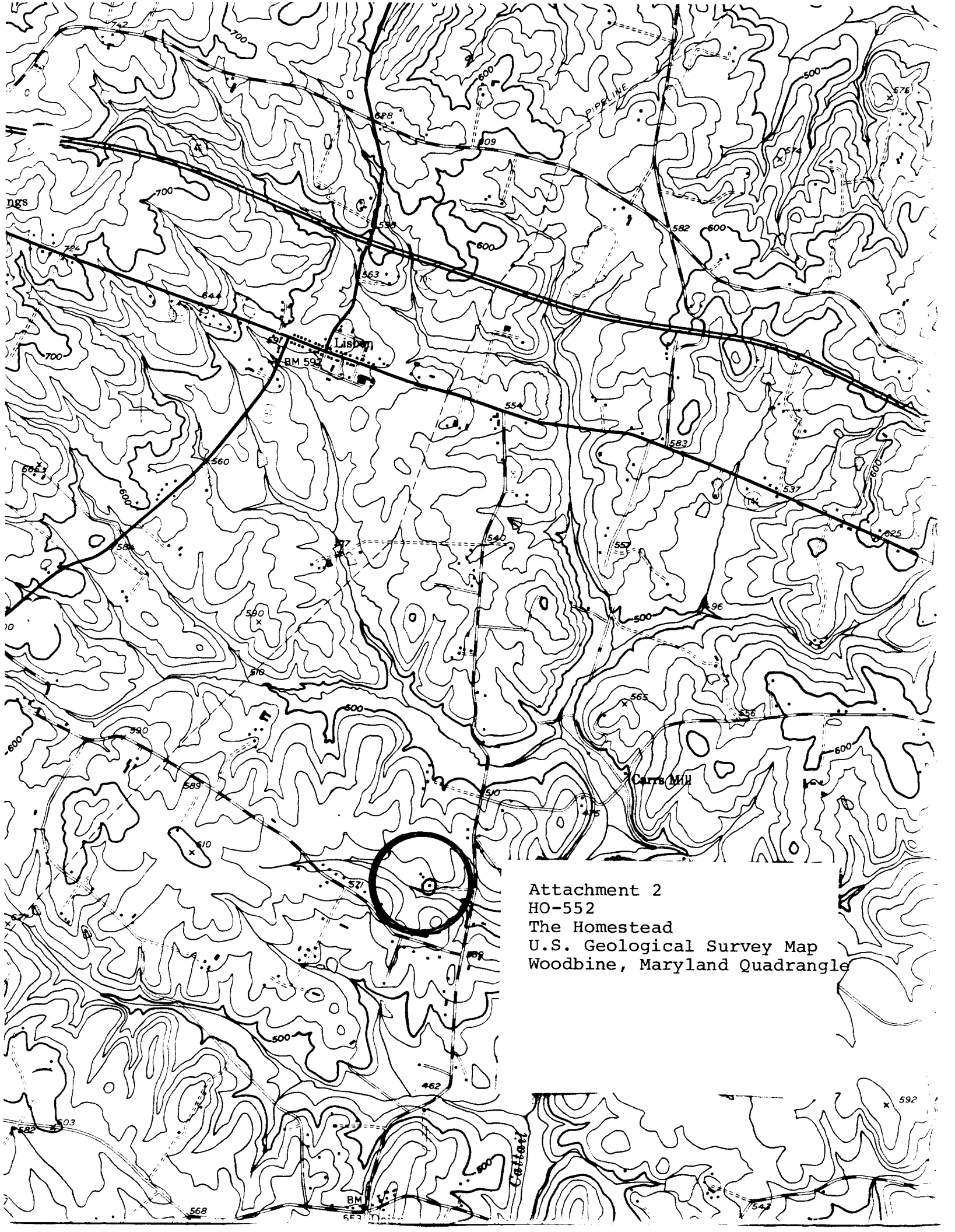

Attachment 2
HO-552
The Homestead
U.S. Geological Survey Map
Woodbine, Maryland Quadrangle



Name: HO-552
The Homestead
Location: 2250 Daisy Road
Woodbine, Maryland
Photographer: Cleora B. Thompson, A.I.C.P.
Date of Photograph: April, 1980
Negatives in possession of the Maryland Historical Trust
View: Northwest
Photographer looking: Southeast
Photograph number: 1 of 1