

HO-527

1890

The Miller Farmhouse  
Miller's Corner  
Private

The Miller Farmhouse faces north on the southeast corner of Route 103 and Meadowridge Road. It is a three bay wide, one room deep, two story high, gabled roof (running east-west), frame (covered with asbestos shingles) house, resting on a stone foundation. A one room deep, two bay wide, kitchen wing, resting on a stone foundation extending from the west side of the building's south wall, creates an "L" plan for the house.

Square, thin, corbeled brick chimneys rise from either side of the building's central hall and another similar chimney rises from the center of the kitchen section's south wall.

Fenestration for the house is vertically aligned and proportionally scaled. Windows are double-hung, holding two-over-two lights, underlined by flat wooden sills.

A central, rectangular, nine light north entrance door is flanked by two vertical side lights, surmounted by a two light transom and covered by a one story high, hipped roof, open porch, supported by four scrolled columns.

Constructed in 1890 by Henry Otten, the house has continued to be the home of family members.

MARYLAND HISTORICAL TRUST

MAGI # 1405275604

INVENTORY FORM FOR STATE HISTORIC SITES SURVEY

**1 NAME**

HISTORIC

AND/OR COMMON

The Miller Farmhouse

**2 LOCATION**

STREET & NUMBER 5748 Montgomery Rd. - S.E. corner of Rt. 103 & Meadowridge

CITY, TOWN

CONGRESSIONAL DISTRICT

--- VICINITY OF Miller's Corner 6th

STATE

Maryland

COUNTY

Howard

**3 CLASSIFICATION**

CATEGORY	OWNERSHIP	STATUS	PRESENT USE	
<input type="checkbox"/> DISTRICT	<input type="checkbox"/> PUBLIC	<input checked="" type="checkbox"/> OCCUPIED	<input type="checkbox"/> AGRICULTURE	<input type="checkbox"/> MUSEUM
<input checked="" type="checkbox"/> BUILDING(S)	<input checked="" type="checkbox"/> PRIVATE	<input type="checkbox"/> UNOCCUPIED	<input type="checkbox"/> COMMERCIAL	<input type="checkbox"/> PARK
<input type="checkbox"/> STRUCTURE	<input type="checkbox"/> BOTH	<input type="checkbox"/> WORK IN PROGRESS	<input type="checkbox"/> EDUCATIONAL	<input type="checkbox"/> PRIVATE RESIDENCE
<input type="checkbox"/> SITE	<b>PUBLIC ACQUISITION</b>	<b>ACCESSIBLE</b>	<input type="checkbox"/> ENTERTAINMENT	<input type="checkbox"/> RELIGIOUS
<input type="checkbox"/> OBJECT	<input type="checkbox"/> IN PROCESS	<input checked="" type="checkbox"/> YES: RESTRICTED	<input type="checkbox"/> GOVERNMENT	<input type="checkbox"/> SCIENTIFIC
	<input type="checkbox"/> BEING CONSIDERED	<input type="checkbox"/> YES: UNRESTRICTED	<input type="checkbox"/> INDUSTRIAL	<input type="checkbox"/> TRANSPORTATION
		<input type="checkbox"/> NO	<input type="checkbox"/> MILITARY	<input type="checkbox"/> OTHER: Unoccupied

**4 OWNER OF PROPERTY**

NAME

Mrs. Leo Miller and Mrs. Arthur Miller

Telephone #:

STREET & NUMBER

5818 Montgomery Road

CITY, TOWN

Baltimore

--- VICINITY OF

STATE, zip code

Maryland 21227

**5 LOCATION OF LEGAL DESCRIPTION**

COURTHOUSE,  
REGISTRY OF DEEDS, ETC.

Hall of Records

Tax Map 37, p. 31

Liber #: 211

Folio #: 272

STREET & NUMBER

Howard County Court House

CITY, TOWN

Ellicott City

STATE

Maryland

**6 REPRESENTATION IN EXISTING SURVEYS**

TITLE

Howard County Historic Sites Inventory

DATE

1978-1979

FEDERAL  STATE  COUNTY  LOCAL

DEPOSITORY FOR  
SURVEY RECORDS

Maryland Historical Trust

CITY, TOWN

21 State Circle, Annapolis

STATE

Maryland

## 7 DESCRIPTION

CONDITION		CHECK ONE	CHECK ONE
<input type="checkbox"/> EXCELLENT	<input type="checkbox"/> DETERIORATED	<input checked="" type="checkbox"/> UNALTERED	<input checked="" type="checkbox"/> ORIGINAL SITE
<input checked="" type="checkbox"/> GOOD	<input type="checkbox"/> RUINS	<input type="checkbox"/> ALTERED	<input type="checkbox"/> MOVED DATE _____
<input type="checkbox"/> FAIR	<input type="checkbox"/> UNEXPOSED		

---

### DESCRIBE THE PRESENT AND ORIGINAL (IF KNOWN) PHYSICAL APPEARANCE

The Miller Farmhouse faces north on the southeast corner of Route 103 and Meadowridge Road. It is a three bay wide, one room deep, two story high, gabled roof (running east-west), frame (covered with asbestos shingles) house, resting on a stone foundation with central, twin, square, corbeled brick chimneys rising from either side of its central hall.

A one room deep, two bay wide, kitchen wing, resting on a stone foundation, and featuring a square brick chimney in its south wall extends from the west side of the building's south wall. A shed roofed, enclosed porch runs along its east wall. The north side of it provides an entrance vestibule to the kitchen entrance, located in the center of this section's east wall.

Fenestration for the house is vertically aligned and proportionally scaled. Windows are double-hung, holding two-over-two lights, and underlined by flat wooden sills.

The other predominant architectural feature of the house is the central, rectangular nine light entrance door, located in the central bay of the building's north wall. It is surmounted by a two light transom, flanked by two vertical side lights, and covered by a one story high, hipped roof, open porch, supported by four scrolled columns. Another entrance is located in the east bay of the main section's south wall. It is a four light rectangular entrance, surmounted by a one light transom.

The interior features original woodwork and mantle pieces. An interesting cornerstone, marked HO 1890 is located on the south side of the building's east foundation.

CONTINUE ON SEPARATE SHEET IF NECESSARY

**8 SIGNIFICANCE**

PERIOD	AREAS OF SIGNIFICANCE -- CHECK AND JUSTIFY BELOW				
<input type="checkbox"/> PREHISTORIC	<input type="checkbox"/> ARCHEOLOGY-PREHISTORIC	<input type="checkbox"/> COMMUNITY PLANNING	<input type="checkbox"/> LANDSCAPE ARCHITECTURE	<input type="checkbox"/> RELIGION	
<input type="checkbox"/> 1400-1499	<input type="checkbox"/> ARCHEOLOGY-HISTORIC	<input type="checkbox"/> CONSERVATION	<input type="checkbox"/> LAW	<input type="checkbox"/> SCIENCE	
<input type="checkbox"/> 1500-1599	<input type="checkbox"/> AGRICULTURE	<input type="checkbox"/> ECONOMICS	<input type="checkbox"/> LITERATURE	<input type="checkbox"/> SCULPTURE	
<input type="checkbox"/> 1600-1699	<input checked="" type="checkbox"/> ARCHITECTURE	<input type="checkbox"/> EDUCATION	<input type="checkbox"/> MILITARY	<input type="checkbox"/> SOCIAL/HUMANITARIAN	
<input type="checkbox"/> 1700-1799	<input type="checkbox"/> ART	<input type="checkbox"/> ENGINEERING	<input type="checkbox"/> MUSIC	<input type="checkbox"/> THEATER	
<input checked="" type="checkbox"/> 1800-1899	<input type="checkbox"/> COMMERCE	<input type="checkbox"/> EXPLORATION/SETTLEMENT	<input type="checkbox"/> PHILOSOPHY	<input type="checkbox"/> TRANSPORTATION	
<input type="checkbox"/> 1900-	<input type="checkbox"/> COMMUNICATIONS	<input type="checkbox"/> INDUSTRY	<input type="checkbox"/> POLITICS/GOVERNMENT	<input checked="" type="checkbox"/> OTHER (SPECIFY) Other Local History	
		<input type="checkbox"/> INVENTION			

SPECIFIC DATES      Date 1890

BUILDER/ARCHITECT

**STATEMENT OF SIGNIFICANCE**

The Miller Farmhouse is significant architecturally to Howard County and the State of Maryland as an example of vernacular architecture in Howard County in the late nineteenth century, and historically as the home of Henry Otten, constructed by him in 1890. A cornerstone on the north side of the building's east wall holds the initials "H.O." with what appears to be the date 1890.

Historically, this property was known as "Good for Little." It consisted of three parcels of land or a total of some 86 acres. Henry J. Otten constructed the house and lived here with his wife, Mary. They raised a family of six children, four daughters (Annie, Mary, Alphonsia, and Elizabeth) and two sons (George and William).

On Henry's death in 1898, all the property was left to Mary, and upon her death, to their son William F. Otten, with the following stipulation to his son: "said son, shall within two years after the death of my wife, pay to each of his sisters . . . , and his brother . . . \$500.00 . . ." (Wills 4-238)

William F. Otten and his wife Sophia conveyed the property to William's brother, George in 1911 for \$5,800. (91-241). Twenty years later, George, who remained unmarried, conveyed the three parcels of "Good for Little" to his sister, Alphonsia, who married Frank J. Miller. (142-439) It was they who gave their name to this intersection, commonly known as "Miller's Corner."

Frank and Alphonsia raised a large family of six daughters (Margaret m Roy Shilling, Katharine m John C. Duvall, Regina m Woodrow Tipton, Barbara m Stewart Wilderson, Mary m Daniel Wilderson, and M. Ethel as of 21 May 1949 remained unmarried), and four sons (Gerald, Frank, Leo and Arthur). Leo and Arthur took a keen interest in the operation of the dairy farm, while their father acted as a deputy sheriff for Howard County. Upon his death in 1946, and the death of his wife, Alphonsia in 1948, the remaining family, together, conveyed the farm to Leo and Arthur, who had been operating it, "subject to reservation to George H. Otten to have a home on the premises . . . for and during the period of his natural life."

Today the farm remains in the hands of the wives of Arthur and Leo and one of their sons is living in the old farm house, the fourth generation to reside there. The house is located on the old road to Elkridge Landing and is among the oldest roads in Howard County, noted on both the 1860 Martennet Map and the 1878 Hopkin's Atlas. Meadow Ridge Road does not appear on the 1860 Map, but was constructed by 1878, when it was indicated on the Hopkin's Atlas.

CONTINUE ON SEPARATE SHEET IF NECESSARY

Architecturally, the Miller Farmhouse provides a well preserved example of a vernacular building of the 1890 period in Howard County. The regularity of its interior central hall plan suggests a certain formality on the part of the builder. The building's appearance is otherwise quite devoid of stylistic detail with the exception of the nine light, central entrance door, characteristic of the Victorian style which was affecting American architecture at this time.

For these reasons, the building is of historic and architectural significance and should be placed on the National Register of Historic Places, should its owners so wish, as well as the State Critical Areas Program and any local landmark ordinance which the citizens of Howard County may wish to initiate.

**9 MAJOR BIBLIOGRAPHICAL REFERENCES**

Interview with Mrs. Leroy Miller, 1810 Old Washington Road, daughter of Mrs. Arthur Miller, co-owner of the property, April 3, 1979  
Interview with Mrs. Arthur Miller, co-owner, April 4, 1979  
Interview with Mrs. George Haker, jr., April 5, 1979

CONTINUE ON SEPARATE SHEET IF NECESSARY

**10 GEOGRAPHICAL DATA**

ACREAGE OF NOMINATED PROPERTY 85.04 acres

Please see Attachment 1, Tax Map 37

VERBAL BOUNDARY DESCRIPTION

Please see Howard County Land Records, Liber 211 Folio 272

LIST ALL STATES AND COUNTIES FOR PROPERTIES OVERLAPPING STATE OR COUNTY BOUNDARIES

STATE Maryland COUNTY Howard

STATE \_\_\_\_\_ COUNTY \_\_\_\_\_

**11 FORM PREPARED BY**

NAME / TITLE  
Cleora Barnes Thompson, Archivist

ORGANIZATION Office of Planning & Zoning-Comprehensive Planning Section DATE \_\_\_\_\_

STREET & NUMBER 3450 Court House Drive TELEPHONE \_\_\_\_\_

CITY OR TOWN Ellicott City STATE Maryland

The Maryland Historic Sites Inventory was officially created by an Act of the Maryland Legislature, to be found in the Annotated Code of Maryland, Article 41, Section 181 KA, 1974 Supplement.

The Survey and Inventory are being prepared for information and record purposes only and do not constitute any infringement of individual property rights.

RETURN TO: Maryland Historical Trust  
The Shaw House, 21 State Circle  
Annapolis, Maryland 21401  
(301) 267-1438

31-P.197

MAP 31-F

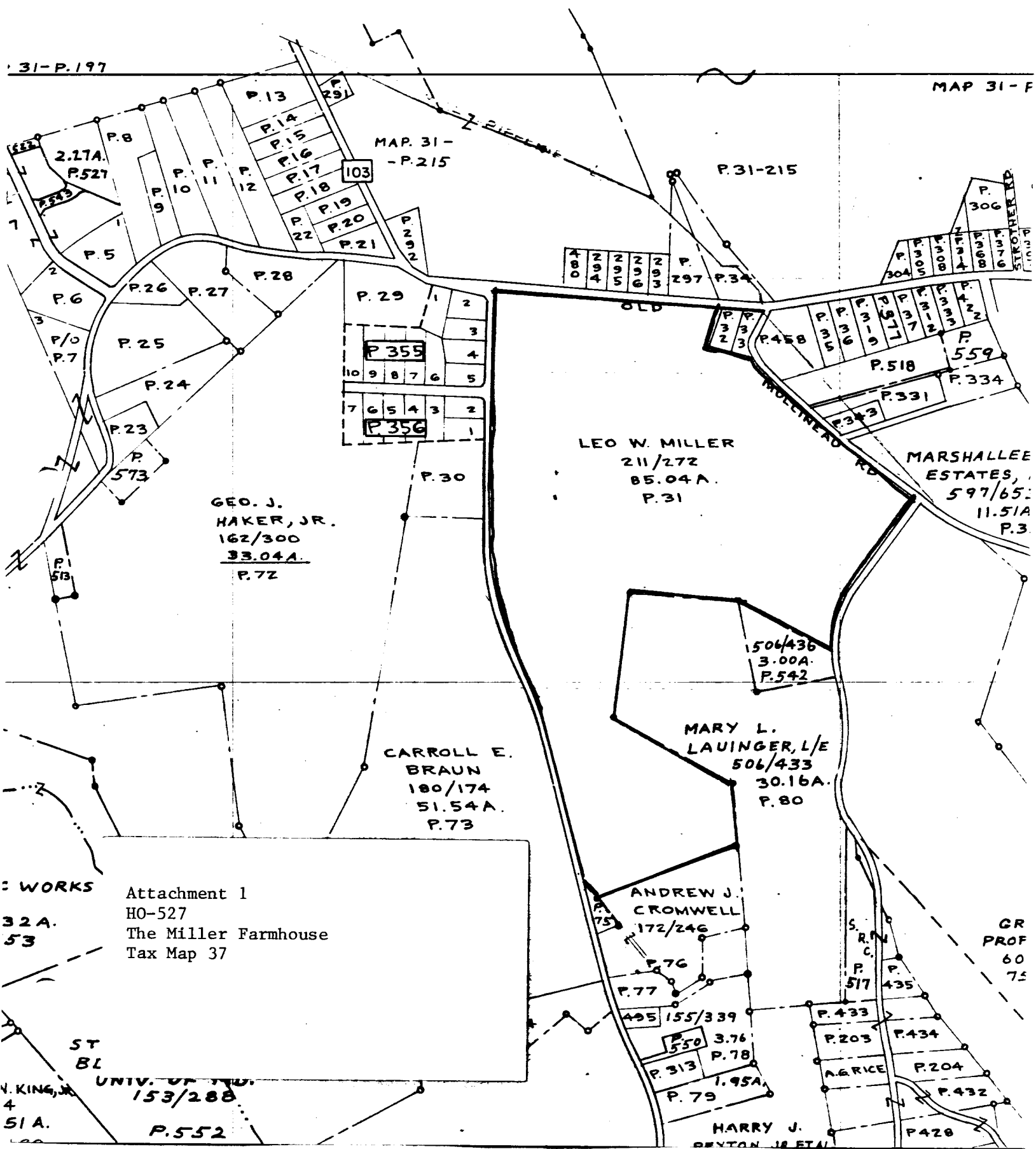

WORKS  
32A.  
53

Attachment 1  
HO-527  
The Miller Farmhouse  
Tax Map 37

ST BL  
N. KING, JR.  
4  
51A.

UNIV. OF MD.  
153/288  
P.552

GR  
PROF  
60  
75

# LOOD-PRONE AREAS

SAVAGE QU

MARY

7.5 MINUTE SERIE

NE 4 LAUREL

5002 IV SE 0.6 MI. 78 U.S. 29  
ELICOTT CITY 644



Attachment 2  
HO-527  
The Miller Farmhouse  
U.S. Geological Survey Map  
Savage, Maryland Quadrangle





Ho-527  
The Miller Farmhouse  
Norty  
CB THOMPSON, AICP  
APRIL 1979