

HO-475
JERICO FARMS
Ellicott City
Private

Circa 1940

Jericho Farms faces north on the south side of Route 108, just west of Harper's Farm Road. It is a three bay wide, two bay deep, two story high, gabled roof (running east-west) frame house with two story east and west wings, smaller in scale than the central house whose east wall holds a square stone chimney with a very wide exterior stone chimney, located on the north side of of its west wall.

A one story high, shed roofed portico covers the rectangular dutch door entrance located in the west bay of the north wall. Three additional entrances are located on the south elevation.

Fenestration is rectangular, vertically aligned, and double-hung, holding six-over-six lights.

The east wing is the garage, while the west wing is a two bay wide, one room deep, two story high, gabled roof (running east west) frame section, on whose south wall is featured a fine stone patio and whose north and south elevations hold two gabled roof dormer windows.

Jericho Farms is notable as a neo-colonial twentieth century structure built on the foundation of an old log tenant house connected with the Carroll family of Doughoregan Manor and identified on the Hopkins Atlas of 1878 as the farm of Harper Carroll.

MAEI # 1404155835

INVENTORY FORM FOR STATE HISTORIC SITES SURVEY

1 NAME

HISTORIC

AND/OR COMMON

Jericho Farm

2 LOCATION

STREET & NUMBER

Jericho Farm, 11349 Clarksville Pike (MD 108)

6th

CITY, TOWN

Ellicott City

CONGRESSIONAL DISTRICT

— VICINITY OF

Howard

STATE

Maryland

COUNTY

3 CLASSIFICATION

CATEGORY	OWNERSHIP	STATUS	PRESENT USE	
<input checked="" type="checkbox"/> DISTRICT	<input type="checkbox"/> PUBLIC	<input checked="" type="checkbox"/> OCCUPIED	<input type="checkbox"/> AGRICULTURE	<input type="checkbox"/> MUSEUM
<input type="checkbox"/> BUILDING(S)	<input checked="" type="checkbox"/> PRIVATE	<input type="checkbox"/> UNOCCUPIED	<input type="checkbox"/> COMMERCIAL	<input type="checkbox"/> PARK
<input type="checkbox"/> STRUCTURE	<input type="checkbox"/> BOTH	<input type="checkbox"/> WORK IN PROGRESS	<input type="checkbox"/> EDUCATIONAL	<input checked="" type="checkbox"/> PRIVATE RESIDENCE
<input type="checkbox"/> SITE	PUBLIC ACQUISITION	ACCESSIBLE	<input type="checkbox"/> ENTERTAINMENT	<input type="checkbox"/> RELIGIOUS
<input type="checkbox"/> OBJECT	<input type="checkbox"/> IN PROCESS	<input checked="" type="checkbox"/> YES: RESTRICTED	<input type="checkbox"/> GOVERNMENT	<input type="checkbox"/> SCIENTIFIC
	<input type="checkbox"/> BEING CONSIDERED	<input type="checkbox"/> YES: UNRESTRICTED	<input type="checkbox"/> INDUSTRIAL	<input type="checkbox"/> TRANSPORTATION
		<input type="checkbox"/> NO	<input type="checkbox"/> MILITARY	<input type="checkbox"/> OTHER

4 OWNER OF PROPERTY

NAME

Muriel D. Carroll

Telephone #: unlisted

STREET & NUMBER

Jericho Farm

CITY, TOWN

Ellicott City,

— VICINITY OF

STATE, zip code

Maryland, 21043

5 LOCATION OF LEGAL DESCRIPTION

COURTHOUSE, Tax Map 29, p.55
REGISTRY OF DEEDS, ETC. Hall of Records

Liber #: 151/170

Folio #: 336/529

STREET & NUMBER

Howard County Court House

CITY, TOWN

Ellicott City

STATE

Maryland

6 REPRESENTATION IN EXISTING SURVEYS

TITLE

Howard County Historic Sites Inventory

DATE

1978

— FEDERAL STATE — COUNTY — LOCAL

DEPOSITORY FOR SURVEY RECORDS

Maryland Historical Trust

CITY, TOWN

21 State Circle, Annapolis

STATE

Maryland

7 DESCRIPTION

CONDITION		CHECK ONE	CHECK ONE
<input checked="" type="checkbox"/> EXCELLENT	<input type="checkbox"/> DETERIORATED	<input checked="" type="checkbox"/> UNALTERED	<input checked="" type="checkbox"/> ORIGINAL SITE
<input type="checkbox"/> GOOD	<input type="checkbox"/> RUINS	<input type="checkbox"/> ALTERED	<input type="checkbox"/> MOVED DATE _____
<input type="checkbox"/> FAIR	<input type="checkbox"/> UNEXPOSED		

DESCRIBE THE PRESENT AND ORIGINAL (IF KNOWN) PHYSICAL APPEARANCE

Jericho Farm is located on the south side of Route 108, just west of its intersection with Harpers' Farm Road. It is a three bay wide, two bay deep, two story high, gabled roof (running east-west) house with two story high east and west wings, smaller in scale than the central house which holds a 1/2 story high greenhouse along its south wall.

A square stone chimney is centered into its east wall and a very wide stone exterior chimney on the north side of its west wall.

The main entrance to the house is located in the west bay of this section's north wall, which is three bays wide, while its south wall is only two bays wide.

Three stone steps lead to the landing for the dutch door, rectangular entrance, which is covered by a shed roofed portico, supported by square posts. Wooden benches flank this entrance.

The west wing of the house features a rectangular entrance in the east bay of its south wall, with a flag stone, walled patio, covered by a canvas awning running along this elevation, and two gabled roof dormer windows on its north and south elevations.

Fenestration for these two sections of the house is rectangular, double-hung, vertically aligned, holding six-over-six lights, decorated with green shutters. An exception is the tri-partite kitchen window, west of the rectangular entrance on the south wall of the main house.

The east wing is a garage with a second floor above. A shed roofed, one story high portico covers the rectangular kitchen entrance located in the east bay of the main house's south wall and the entrance to the second floor, above the garage, which is located in the west bay of the east wing's south wall. These two walls lie flush with one another and the doors, side by side. The south wall of the garage wing holds one first floor and two second floor six light casement windows which add to the quaintness and charm of the house. Its north wall features a dormer window.

The entire building exudes a quiet, unassuming air of always having been there and totally compatible with its site which slopes southward toward the Hobbits' Glen Golf Course.

Though not a new building, it is not an historic one, for it was constructed by Mr. and Mrs. Harper Carroll sometime around the year 1940.

An old 18th century log house featuring dormer windows and porches, a part of Doughoregan Manor stood here, but when restoration efforts were begun, the wood was found to be termite ridden and a total replacement of the house was deemed necessary.

CONTINUE ON SEPARATE SHEET IF NECESSARY

What replaced the log house is a charming, well-executed structure which totally blends into its site and gives the impression of also being a century old house.

Southeast of the home is a bank barn, constructed a decade or so before the house and a horse barn featuring two cupolas.

8 SIGNIFICANCE

PERIOD		AREAS OF SIGNIFICANCE -- CHECK AND JUSTIFY BELOW			
<input type="checkbox"/> PREHISTORIC	<input type="checkbox"/> ARCHEOLOGY-PREHISTORIC	<input type="checkbox"/> COMMUNITY PLANNING	<input type="checkbox"/> LANDSCAPE ARCHITECTURE	<input type="checkbox"/> RELIGION	
<input type="checkbox"/> 1400-1499	<input checked="" type="checkbox"/> ARCHEOLOGY-HISTORIC	<input type="checkbox"/> CONSERVATION	<input type="checkbox"/> LAW	<input type="checkbox"/> SCIENCE	
<input type="checkbox"/> 1500-1599	<input checked="" type="checkbox"/> AGRICULTURE	<input type="checkbox"/> ECONOMICS	<input type="checkbox"/> LITERATURE	<input type="checkbox"/> SCULPTURE	
<input type="checkbox"/> 1600-1699	<input type="checkbox"/> ARCHITECTURE	<input type="checkbox"/> EDUCATION	<input type="checkbox"/> MILITARY	<input type="checkbox"/> SOCIAL/HUMANITARIAN	
<input type="checkbox"/> 1700-1799	<input type="checkbox"/> ART	<input type="checkbox"/> ENGINEERING	<input type="checkbox"/> MUSIC	<input type="checkbox"/> THEATER	
<input type="checkbox"/> 1800-1899	<input type="checkbox"/> COMMERCE	<input type="checkbox"/> EXPLORATION/SETTLEMENT	<input type="checkbox"/> PHILOSOPHY	<input type="checkbox"/> TRANSPORTATION	
<input checked="" type="checkbox"/> 1900-	<input type="checkbox"/> COMMUNICATIONS	<input type="checkbox"/> INDUSTRY	<input type="checkbox"/> POLITICS/GOVERNMENT	<input checked="" type="checkbox"/> OTHER (SPECIFY) Local History	
		<input type="checkbox"/> INVENTION			

SPECIFIC DATES Circa 1940

BUILDER/ARCHITECT

STATEMENT OF SIGNIFICANCE

Jericho Farm is significant architecturally and historically.

Historically, the house is located on a part of Doughoregan Manor, a large tract of land owned by Charles Carroll of Carrollton, signer of the Declaration of Independence. It is noted on the Hopkins Atlas of 1878 as the home of Harper Carroll, comprising 412 acres of land.

Today the house remains in the Harper Carroll family and is occupied as their residence.

The old log eighteenth century house which once stood here, was in such a dilapidated condition when Mrs. Muriel Carroll and her husband acquired the property, that little but the foundation remains. The old house which featured dormer windows and porches, was replaced by a circa 1940 structure, which through its scale and proportions, gives the feeling of being a century old country house.

The three bay wide, two story high, gabled roof (running east-west) mid section of the house is flanked by a two story high, gabled roof (running east-west) two car garage, east wing and a two bay wide, one room deep, two story high, gabled roof, west wing with dormer windows on its north and south elevations.

The south elevation of the mid section of the house features a green house, while its west wing features a stone walled patio, covered by a shed roofed, one story high, canvas awing along its south wall. The garage east wing features six light windows on this south elevation, which helps add to the feeling of Jericho Farms being a century old house. Nestled on the top of a gentle slope of land, it overlooks the Hobbits Glen Golf Course on the south and Route 108 on the north.

Historically connected to the nationally significant Carroll family as well as architecturally noteworthy as a fine example of neo-colonial architecture of the twentieth century, Jericho Farms is one of twenty sites chosen by the Maryland Historical Trust in their inventory of properties located along Route 108. This survey was begun after the initiation of plans to widen and realign Route 108 from Route 29 to Clarksville. This project has since been abandoned for the time being, but its re-emergence in the future is most probable. Any future plans to widen or realign Route 108 should consider the continued preservation of the integrity of this house, its outbuildings and its site.

CONTINUE ON SEPARATE SHEET IF NECESSARY

9 MAJOR BIBLIOGRAPHICAL REFERENCES

Interview with Mrs. M. D. Carroll at Jericho Farms, July 25, 1978.

CONTINUE ON SEPARATE SHEET IF NECESSARY

10 GEOGRAPHICAL DATA

ACREAGE OF NOMINATED PROPERTY 20.25 Acre

Please see Attachment 1, Tax Map 29.

VERBAL BOUNDARY DESCRIPTION

Please see Howard County Land Records, Liber 151, folio 336, and Liber 170, folio 529.

LIST ALL STATES AND COUNTIES FOR PROPERTIES OVERLAPPING STATE OR COUNTY BOUNDARIES

STATE Maryland COUNTY Howard

STATE COUNTY

11 FORM PREPARED BY

NAME / TITLE

Cleora Barnes Thompson, Archivist

ORGANIZATION

Office of Planning & Zoning-Comprehensive Planning Section 465-5000 x257

STREET & NUMBER

3450 Court House Drive

CITY OR TOWN

Ellicott City

DATE

TELEPHONE

STATE

Maryland

The Maryland Historic Sites Inventory was officially created by an Act of the Maryland Legislature, to be found in the Annotated Code of Maryland, Article 41, Section 181 KA, 1974 Supplement.

The Survey and Inventory are being prepared for information and record purposes only and do not constitute any infringement of individual property rights.

RETURN TO: Maryland Historical Trust
The Shaw House, 21 State Circle
Annapolis, Maryland 21401
(301) 267-1438

PHILLIP A. CARROLL

P. 28

MURIEL D.
CARROLL
170/529
151/336
20.25A.
P.55

HOWARD RESEARCH
& DEV. CORP.
417/517 99YR. LEASE
417/543
217.06A.
P.126

HOBBITS GLEN GOLF COURSE

Attachment 1
HO-475
Jericho Farm
Tax Map 29

PCARROLL
EPH 1/118

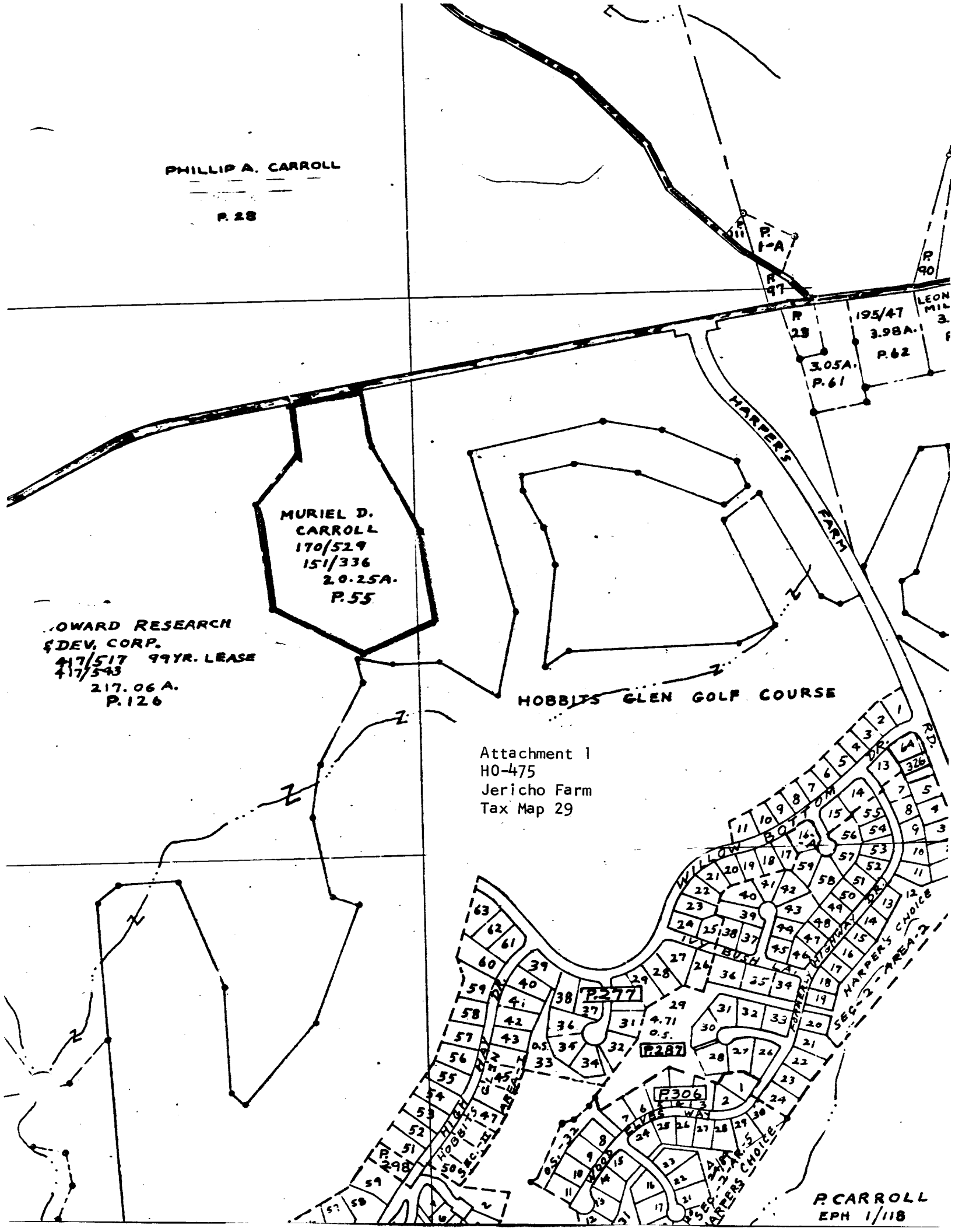

Attachment 2
H0-475
Jericho Farm
Topographic Map of Howard County
Indicating Historic Sites within
the Alternates #5 or #6 State
Highway Project Plan for Route 108
Scale: 1"=200'

11349 JERICHO FARM
CLARKSVILLE
PIKE

432

425

400

427,000



HO-475(0)
JERICHO FARMS
SOUTHEAST
JULY - 1978
CLEORA THOMPSON, A/P