

HO-470

Circa 1900

The Zepp Farm & Outbuilding  
Clarksville  
Private

The Zepp Farmhouse faces south on the northeast corner of Routes 32 and 108. It is composed of a large barn and outbuildings and unusual square shingled farm house, which features a third floor shingled gable on each elevation, superimposed on a second floor tent roof, giving the impression of a cruciform shape. Each dormer holds a tripartite window encased in pediment styled wooden panels.

Each elevation, though equal in width and varied roof design, differs from the other.

The south facade holds a rectangular entrance in the second east bay, flanked by a rectangular, first floor, double-hung window on the east and two similar first floor windows on the west, all vertically aligned and proportionally sealed to the four similar second floor windows.

The east elevation features an interesting square, stained glass staircase window and rectangular kitchen entrance, while the west elevation holds a first floor bay window in its north bay and a covered rectangular, almost central entrance, with a double rectangular window in its south bay, which is separated and flanked by flat pilasters.

The north wall features a shed roofed, two story high, projecting bay, which holds the batten wood basement door. A hipped roof, one story high, open porch, completes the building, running around its northeast corner, with a notable sliding door on the north offering protection from the northwest winds.

Owned by the Zepp family of Howard County, it is presently owned by Mr. and Mrs. Earle Johnston, who plan to subdivide part of the existing farm.

INVENTORY FORM FOR STATE HISTORIC SITES SURVEY

**1 NAME**

HISTORIC The Zepp Farm and Outbuildings

AND/OR COMMON

The Zepp-Johnston Farm and Outbuildings

**2 LOCATION**

STREET & NUMBER

Route 108, Clarksville Pike

CITY, TOWN

Clarksville

\_\_\_ VICINITY OF

CONGRESSIONAL DISTRICT

6th

STATE

Maryland

COUNTY

Howard

**3 CLASSIFICATION**

CATEGORY	OWNERSHIP	STATUS	PRESENT USE
<input checked="" type="checkbox"/> DISTRICT	<input type="checkbox"/> PUBLIC	<input checked="" type="checkbox"/> OCCUPIED	<input checked="" type="checkbox"/> AGRICULTURE
<input type="checkbox"/> BUILDING(S)	<input checked="" type="checkbox"/> PRIVATE	<input type="checkbox"/> UNOCCUPIED	<input type="checkbox"/> MUSEUM
<input type="checkbox"/> STRUCTURE	<input type="checkbox"/> BOTH	<input type="checkbox"/> WORK IN PROGRESS	<input type="checkbox"/> COMMERCIAL
<input type="checkbox"/> SITE	<b>PUBLIC ACQUISITION</b>	<b>ACCESSIBLE</b>	<input type="checkbox"/> EDUCATIONAL
<input type="checkbox"/> OBJECT	<input type="checkbox"/> IN PROCESS	<input checked="" type="checkbox"/> YES: RESTRICTED	<input checked="" type="checkbox"/> PRIVATE RESIDENCE
	<input type="checkbox"/> BEING CONSIDERED	<input type="checkbox"/> YES: UNRESTRICTED	<input type="checkbox"/> ENTERTAINMENT
		<input type="checkbox"/> NO	<input type="checkbox"/> RELIGIOUS
			<input type="checkbox"/> GOVERNMENT
			<input type="checkbox"/> INDUSTRIAL
			<input type="checkbox"/> MILITARY
			<input type="checkbox"/> OTHER

**4 OWNER OF PROPERTY**

NAME

Mr. and Mrs. Earle Johnston

Telephone #:

STREET & NUMBER

Route 108

CITY, TOWN

Clarksville

\_\_\_ VICINITY OF

STATE, zip code

MD 21029

**5 LOCATION OF LEGAL DESCRIPTION**

COURTHOUSE, REGISTRY OF DEEDS, ETC.

Tax Map 34, p. 365  
Hall of Records

Liber #: 291

Folio #: 406

STREET & NUMBER

Howard County Court House

CITY, TOWN

Ellicott City

STATE

Maryland

**6 REPRESENTATION IN EXISTING SURVEYS**

TITLE

Howard County Historic Sites Inventory

DATE

1978

\_\_\_ FEDERAL  STATE \_\_\_ COUNTY \_\_\_ LOCAL

DEPOSITORY FOR SURVEY RECORDS

Maryland Historical Trust

CITY, TOWN

21 State Circle, Annapolis

STATE

Maryland

**7 DESCRIPTION**

CONDITION		CHECK ONE	CHECK ONE
<input type="checkbox"/> EXCELLENT	<input type="checkbox"/> DETERIORATED	<input checked="" type="checkbox"/> UNALTERED	<input checked="" type="checkbox"/> ORIGINAL SITE
<input checked="" type="checkbox"/> GOOD	<input type="checkbox"/> RUINS	<input type="checkbox"/> ALTERED	<input type="checkbox"/> MOVED DATE _____
<input type="checkbox"/> FAIR	<input type="checkbox"/> UNEXPOSED		

**DESCRIBE THE PRESENT AND ORIGINAL (IF KNOWN) PHYSICAL APPEARANCE**

The Zepp Farm complex faces south on the northeast corner of Route #32 and #108. It is a four bay wide, two room deep, square, two story high, tent roofed structure on which a cruciform third floor, composed of a gabled roof dormer window on each elevation has been superimposed.

The dormers on each elevation, except the north, hold tripartite windows which are inset into pediment styled wooden panels. Each section of the tripartite window is rectangular and double-hung, holding one-over-one lights, with its central window taller in height.

Though totally square and featuring a roof line which is varied but identical on each elevation, the building is otherwise asymmetrical.

The south facade is very regular in treatment, holding a rectangular entrance door in the second east bay, flanked by a rectangular first floor, double-hung window on the east and two similar first floor windows on the west, all vertically aligned and proportionally sealed to the four similar second floor windows.

The east elevation features an interesting square, stained glass staircase window and rectangular kitchen entrance, while the west elevation holds a first floor bay window in its north bay and a covered rectangular, almost central entrance, with a double rectangular window in its south bay which is separated and flanked by flat pilasters.

The north wall features a shed roofed, two story high, projecting bay, which holds the batten wood basement door. A hipped roof, one story high, open porch, completes the building, running around its northeast corner, with a notable sliding door on the north offering protection from the north-west winds.

Owned by the Zepp family of Howard County, it is presently owned by Mr. and Mrs. Earle Johnston who plan to subdivide part of the existing farm.

**8 SIGNIFICANCE**

PERIOD	AREAS OF SIGNIFICANCE -- CHECK AND JUSTIFY BELOW				
<input type="checkbox"/> PREHISTORIC	<input type="checkbox"/> ARCHEOLOGY-PREHISTORIC	<input type="checkbox"/> COMMUNITY PLANNING	<input type="checkbox"/> LANDSCAPE ARCHITECTURE	<input type="checkbox"/> RELIGION	
<input type="checkbox"/> 1400-1499	<input checked="" type="checkbox"/> ARCHEOLOGY-HISTORIC	<input type="checkbox"/> CONSERVATION	<input type="checkbox"/> LAW	<input type="checkbox"/> SCIENCE	
<input type="checkbox"/> 1500-1599	<input type="checkbox"/> AGRICULTURE	<input type="checkbox"/> ECONOMICS	<input type="checkbox"/> LITERATURE	<input type="checkbox"/> SCULPTURE	
<input type="checkbox"/> 1600-1699	<input checked="" type="checkbox"/> ARCHITECTURE	<input type="checkbox"/> EDUCATION	<input type="checkbox"/> MILITARY	<input type="checkbox"/> SOCIAL/HUMANITARIAN	
<input type="checkbox"/> 1700-1799	<input type="checkbox"/> ART	<input type="checkbox"/> ENGINEERING	<input type="checkbox"/> MUSIC	<input type="checkbox"/> THEATER	
<input type="checkbox"/> 1800-1899	<input type="checkbox"/> COMMERCE	<input type="checkbox"/> EXPLORATION/SETTLEMENT	<input type="checkbox"/> PHILOSOPHY	<input type="checkbox"/> TRANSPORTATION	
<input checked="" type="checkbox"/> 1900-	<input type="checkbox"/> COMMUNICATIONS	<input type="checkbox"/> INDUSTRY	<input type="checkbox"/> POLITICS/GOVERNMENT	<input checked="" type="checkbox"/> OTHER (SPECIFY)	
		<input type="checkbox"/> INVENTION			Local History

---

SPECIFIC DATES 1900 BUILDER/ARCHITECT \_\_\_\_\_

---

STATEMENT OF SIGNIFICANCE

This fine, well executed example of the shingle style in American Domestic Architecture of the early twentieth century is significant architecturally and histrocially.

Architecturally, it has a symmetry which forms the basic structure of this square, tent roofed structure on which is superimposed a cruciform attic roof line, created by a gabled roof dormer window being placed in the center of each elevation. Upon this very symmetrical building is placed at each elevation a variety of stylistic detail. On the south elevation we find the rectangular entrance door placed asymmetrically in the second east bay with two windows on the west and one on the east.

The west elevation, too, is asymmetrical with a central entrance placed between an oriele window in the north bay and a double window in the south bay, above which are second floor windows.

The fish-scaled shingled dormers are noteworthy, holding tripartite windows, composed of a tall central, one-over-one light double-hung window, flanked by a similar window, all of which is incased withn a pediment styled molding. This occurs on all but the north elevation.

Historically, it is associated with the Zepp family of Clarks-ville, who acquired the property from Catherine Hobbs et al. On January 2, 1900, Covington B. and Carrie Zepp conveyed the property to James Bradle Zepp (JHO 71-466). The present house was probably constructed around this time. On January 16, 1935, James B. Zepp conveyed the farm to George Watton Isenock (150-551). It is now owned by Mr. and Mrs. Earle Johnston, who are planning to subdivide a section of the farm, maintaining the house as their private residence. The alternate #6 plan for the widening and realignment of Route 108 runs just north of the Zepp Farm and outbuildings and appears to take the tree cover which would afford a natural barrier to the property. The barn and outbuildings are well p[la]ced in relation to the house, creating a corridor with path leading to the barn which acts as a focal point. This very pleasing complex could be utilized for housing when the need for agricultural use fades. It is hoped that this interesting grouping will remain and its integrity be insured by careful planning by the Highway Administration in its improvement of Route 108.

CONTINUE ON SEPARATE SHEET IF NECESSARY

For these reasons it is recommended that the Zepp Farm and out-buildings be placed on the National Register and State Critical Areas Program.

**9 MAJOR BIBLIOGRAPHICAL REFERENCES**

Interview with Mrs. Earle Johnston, June 22, 1978  
Howard County Land Records

CONTINUE ON SEPARATE SHEET IF NECESSARY

**10 GEOGRAPHICAL DATA**

ACREAGE OF NOMINATED PROPERTY 94.21 Acres

Please see Attachment 1, Tax Map 34

VERBAL BOUNDARY DESCRIPTION

Please see Howard County Land Records Liber 291, folio 406.

LIST ALL STATES AND COUNTIES FOR PROPERTIES OVERLAPPING STATE OR COUNTY BOUNDARIES

STATE Maryland COUNTY Howard

STATE \_\_\_\_\_ COUNTY \_\_\_\_\_

**11 FORM PREPARED BY**

NAME / TITLE  
Cleora Barnes Thompson, Archivist

ORGANIZATION Office of Planning & Zoning-Comprehensive Planning Section DATE 465-5000 x257

STREET & NUMBER 3450 Court House Drive TELEPHONE \_\_\_\_\_

CITY OR TOWN Ellicott City STATE Maryland

The Maryland Historic Sites Inventory was officially created by an Act of the Maryland Legislature, to be found in the Annotated Code of Maryland, Article 41, Section 181 KA, 1974 Supplement.

The Survey and Inventory are being prepared for information and record purposes only and do not constitute any infringement of individual property rights.

RETURN TO: Maryland Historical Trust  
The Shaw House, 21 State Circle  
Annapolis, Maryland 21401  
(301) 267-1438

ROUTE #108

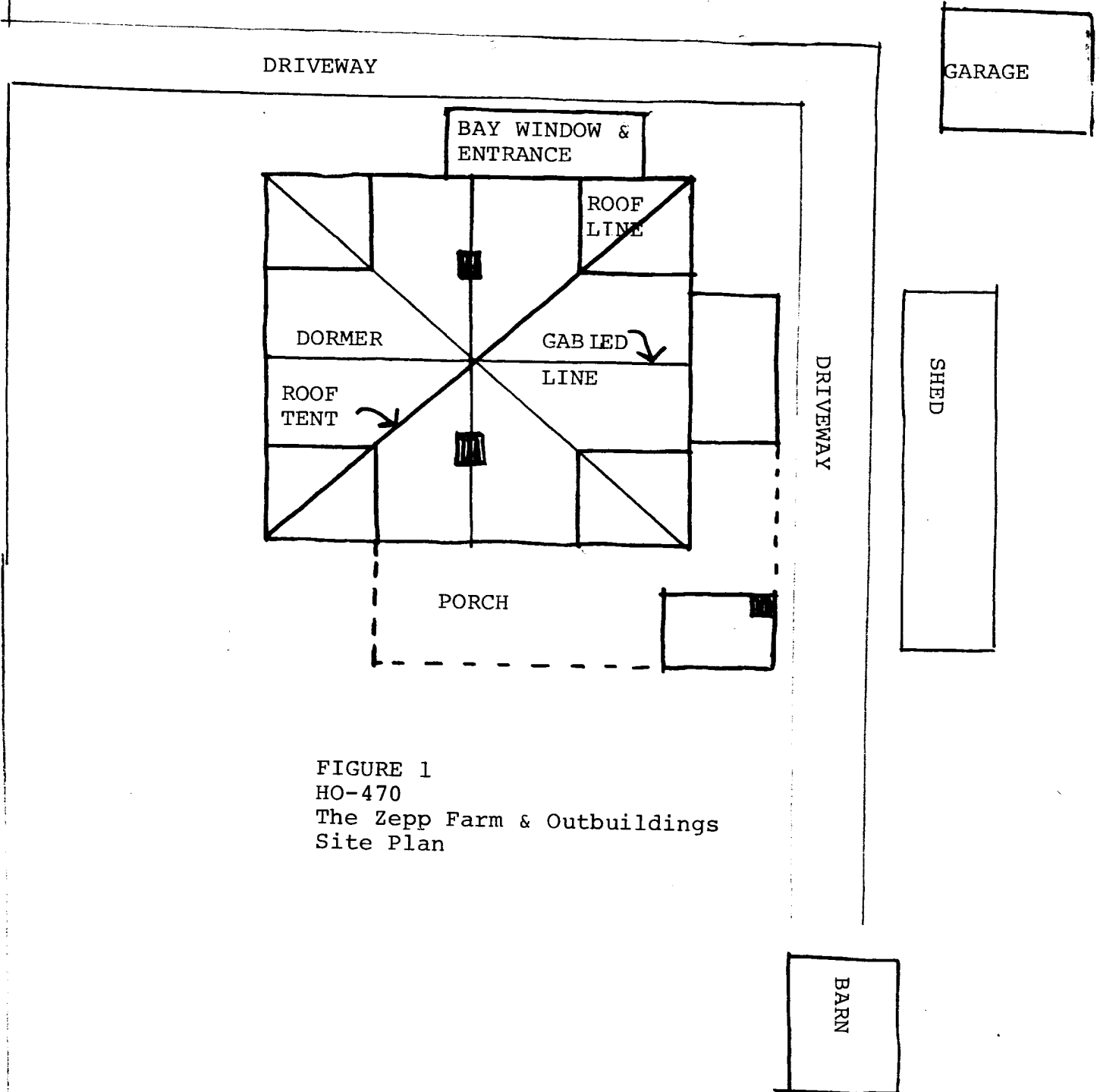

FIGURE 1  
HO-470  
The Zepp Farm & Outbuildings  
Site Plan

DWIN O.  
DAMS, JR.  
159/190 & 430/218  
184.67A.  
P.15

FRANCIS I.  
COCKRELL  
338/562  
96A.  
P.186

MAP 28-P.100

RUTH R. CUNIN, ET.  
578/696 -AL.  
36.95A.  
P.185

R. JOHNSON SUB. Δ 3549

23.90A.

25.78A.

P.365

44.53A

MD-32

P.20

P.214

P.244

P.18

P.19

P.21

P.23

CLARKSVILLE  
HIGH SCHOOL

P.22

F.O. MAHER

218/212

9.23A.

P.178

108

P.27

P.195

P.256

HO.CO.  
RD.  
DEPT.

P.152

P.157

S.R.C.  
R/W-38

CLARKSVILLE

SUSAN M. ZEPP  
182/26  
146.76A.  
P.19

4-3322

P.158

P.336

P.35

P.151

Attachment I  
HO-470  
The Zepp Farm & Out-  
buildings  
Tax Map 34

501





455

Attachment 2 HO-470

The Zepp Farm & Outbuildings  
Topographic Map of Howard County,  
Maryland, Indicating His-  
toric Sites Within the

Alternate #5 State  
Highway Plan for Route 108.

Scale: 1" = 200'

MARYLAND

450

475

475

48'

HO-468

483

(H)

CLARKSVILLE  
PIKE

487

492

U.S.  
POST OFFICE

488

491

483

CLARKSVILLE  
PIKE

486

486

Attachment 3  
HO-470 (H)  
The Zepp Farm and Outbuildings  
Topographic Map of Howard County  
Maryland Indicating Historic  
Sites Within the Alternate #6  
State Highway Plan for Rt. 108  
Scale: 1" = 200'

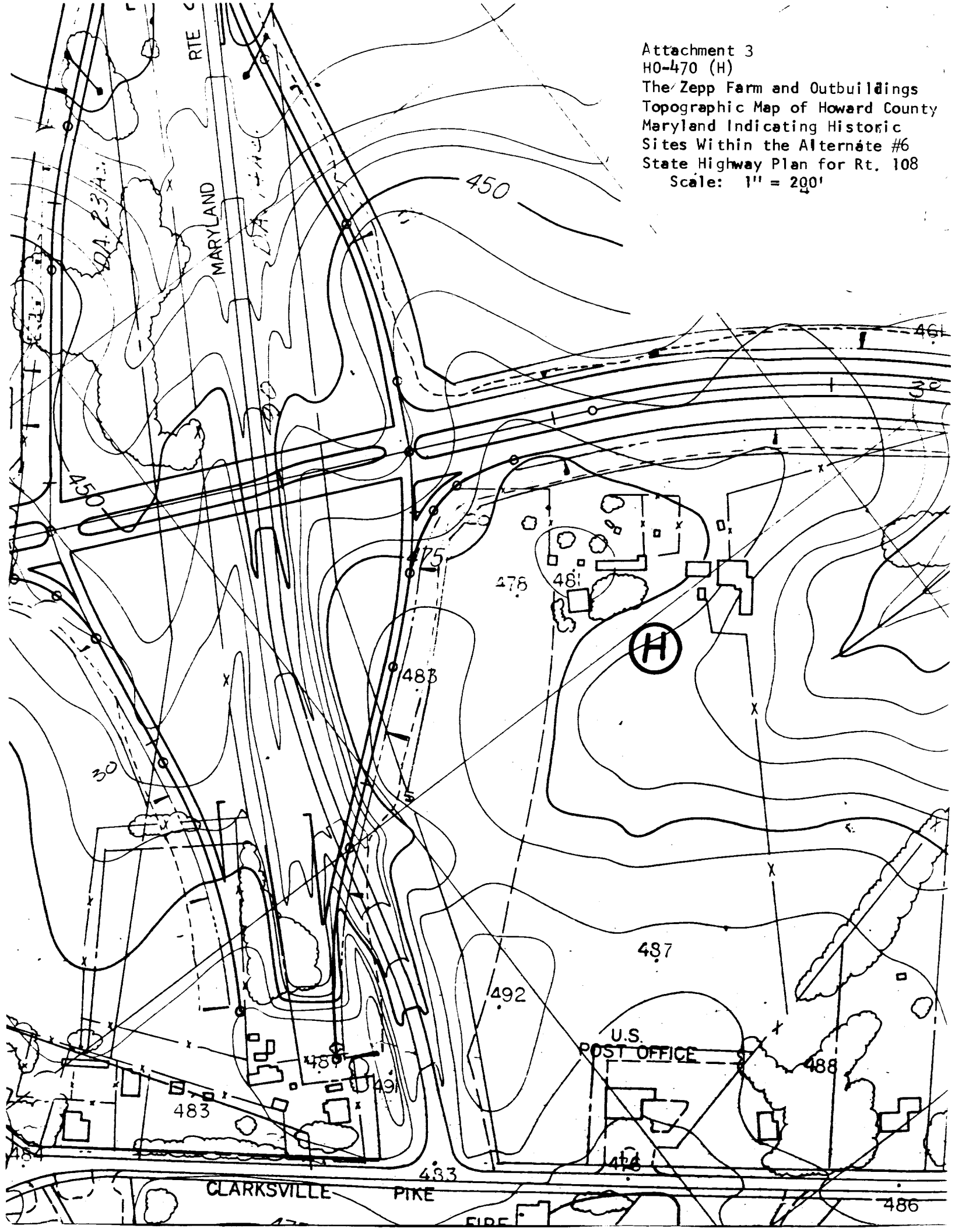



HO-470  
THE ZEPPEL FARM &  
OUTBUILDINGS  
WEST - JUNE 1978  
CB THOMPSON, AIP