

INDIVIDUAL PROPERTY/DISTRICT  
MARYLAND HISTORICAL TRUST  
INTERNAL NR-ELIGIBILITY REVIEW FORM

Property/District Name: Ellicott City - Montgomery County  
Courthouse Road Milestones, Howard County Survey Number: H 0-463

Project: MD 100, from MD 32b Davidge Drive Agency: FHWA

Site visit by MHT Staff:  no  yes Name: \_\_\_\_\_ Date: \_\_\_\_\_

Eligibility recommended:  Eligibility not recommended: \_\_\_\_\_

Criteria:  A  B  C  D Considerations:  A  B  C  E  F  G  None

Justification for decision: (Use continuation sheet if necessary and attach map)

The Ellicott City - Montgomery County Courthouse Road Milestones are significant in the area of transportation. The inscribed granite blocks mark the original route of the Old Ellicott City - Montgomery County Courthouse Road, once the most important road to Washington, D.C. and in existence since 1797. The three- and four-mile milestones are among four still extant. They are important remnants of the historic road which linked government centers. In addition, they are significant for their association with the development of roads in Maryland and throughout the region in the late 18th and early 19th Century, a period of intense infrastructure construction as the young nation sought to improve trade and communication by developing new trans-continental routes.

Documentation on the property/district is presented in: MI form # H0-463

Prepared by: Cleora Barnes Thompson, Office of Planning + Zoning  
Elizabeth Hannold 5/14/91  
Reviewer, Office of Preservation Services

NR program concurrence:  yes  no  not applicable  
Ronald L. Anderson 14 May 91

MARYLAND COMPREHENSIVE HISTORIC PRESERVATION PLAN DATA - HISTORIC CONTEXT

I. Geographic Region:

- Eastern Shore (all Eastern Shore counties, and Cecil)
- Western Shore (Anne Arundel, Calvert, Charles, Prince George's and St. Mary's)
- Piedmont (Baltimore City, Baltimore, Carroll, Frederick, Harford, Howard, Montgomery)
- Western Maryland (Allegany, Garrett and Washington)

II. Chronological/Developmental Periods:

- Paleo-Indian 10000-7500 B.C.
- Early Archaic 7500-6000 B.C.
- Middle Archaic 6000-4000 B.C.
- Late Archaic 4000-2000 B.C.
- Early Woodland 2000-500 B.C.
- Middle Woodland 500 B.C.- A.D.900
- Late Woodland/Archaic A.D. 900-1600
- Contact and Settlement A.D. 1570-1750
- Rural Agrarian Intensification A.D. 1680-1815
- Agricultural-Industrial Transition A.D. 1815-1870
- Industrial/Urban Dominance A.D. 1870-1930
- Modern Period A.D. 1930-Present
- Unknown Period (  prehistoric  historic )

III. Prehistoric Period Themes:

- Subsistence
- Settlement
- Political
- Demographic
- Religion
- Technology
- Environmental Adaptation

IV. Historic Period Themes:

- Agriculture
- Architecture, Landscape Architecture, and Community Planning
- Economic (Commercial and Industrial)
- Government/Law
- Military
- Religion
- Social/Educational/Cultural
- Transportation

V. Resource Type:

Category: object

Historic Environment: Rural

Historic Function(s) and Use(s): Marker / Milestone

Known Design Source: \_\_\_\_\_

HO-463

THE OLD ELLICOTT CITY - MONTGOMERY COUNTY COURTHOUSE ROAD  
MILESTONES

Public

circa 1804

Ellicott City

The 4 and 5 Mile Milestones face South on the North side of Route 108, four and five miles from the Southwest corner of Old Columbia Pike's intersection with Main Street in Ellicott City. They are approximately twelve inches in width and some eight inches in depth, and stand about thirty feet above the ground. On their South face is incised: 4 - (5) MI. To E.C. ( 4 - 5 miles to Ellicott City). A two Mile Milestone faces east on the west side of Old Columbia Pike, 1/10 of a mile south of the Old Wayside Inn, HO-144. Another stone, the ten (10) Mile Milestone faces south on the north side of Route 108 at the entrance to Lambing Meadow Bank Barn and Farm, HO-468.

This old road was once the most important road to Washington, D.C., starting at Ellicott Mills and going to Montgomery County Courthouse as early as 1797.

MARYLAND HISTORICAL TRUST

HO-463  
Dist. 2 & 5

MAGI # 1404633334

INVENTORY FORM FOR STATE HISTORIC SITES SURVEY

**1 NAME**

HISTORIC The Old Ellicott City-Montgomery County Courthouse Road Milestones

AND/OR COMMON

Columbia Pike and Clarksville Pike Milestones

**2 LOCATION**

STREET & NUMBER

Old Columbia Pike, Route 108

CITY, TOWN

CONGRESSIONAL DISTRICT

\_\_\_ VICINITY OF

STATE

Maryland

COUNTY

Howard

**3 CLASSIFICATION**

| CATEGORY                                   | OWNERSHIP                                  | STATUS  | PRESENT USE  |
|--|--|---|--|
| <input type="checkbox"/> DISTRICT          | <input checked="" type="checkbox"/> PUBLIC | <input type="checkbox"/> OCCUPIED                     | <input type="checkbox"/> AGRICULTURE <input type="checkbox"/> MUSEUM                         |
| <input type="checkbox"/> BUILDING(S)       | <input type="checkbox"/> PRIVATE           | <input type="checkbox"/> UNOCCUPIED                   | <input type="checkbox"/> COMMERCIAL <input type="checkbox"/> PARK                            |
| <input type="checkbox"/> STRUCTURE         | <input type="checkbox"/> BOTH              | <input type="checkbox"/> WORK IN PROGRESS             | <input type="checkbox"/> EDUCATIONAL <input type="checkbox"/> PRIVATE RESIDENCE              |
| <input type="checkbox"/> SITE              | <b>PUBLIC ACQUISITION</b>                  | <b>ACCESSIBLE</b>                                     | <input type="checkbox"/> ENTERTAINMENT <input type="checkbox"/> RELIGIOUS                    |
| <input checked="" type="checkbox"/> OBJECT | <input type="checkbox"/> IN PROCESS        | <input type="checkbox"/> YES: RESTRICTED              | <input type="checkbox"/> GOVERNMENT <input type="checkbox"/> SCIENTIFIC                      |
|  | <input type="checkbox"/> BEING CONSIDERED  | <input checked="" type="checkbox"/> YES: UNRESTRICTED | <input type="checkbox"/> INDUSTRIAL <input type="checkbox"/> TRANSPORTATION                  |
|  |  | <input type="checkbox"/> NO                           | <input type="checkbox"/> MILITARY <input checked="" type="checkbox"/> OTHER Measure distance |

**4 OWNER OF PROPERTY**

NAME

State of Md., Dept of Transportation Telephone #:

STREET & NUMBER

State Highway Admin., Office of the Secretary, national Airport Friendship Inter-

CITY, TOWN

Baltimore

\_\_\_ VICINITY OF

STATE, zip code

Maryland

**5 LOCATION OF LEGAL DESCRIPTION**

COURTHOUSE,  
REGISTRY OF DEEDS, ETC.

Hall of Records

Liber #:

Folio #:

STREET & NUMBER

Howard County Court House

CITY, TOWN

Ellicott City

STATE

Maryland

**6 REPRESENTATION IN EXISTING SURVEYS**

TITLE

Howard County Historic Sites Inventory

DATE

1978

\_\_\_ FEDERAL  STATE \_\_\_ COUNTY \_\_\_ LOCAL

DEPOSITORY FOR  
SURVEY RECORDS

Maryland Historical Trust

CITY, TOWN

21 State Circle, Annapolis

STATE

Maryland

**7 DESCRIPTION**

|   |                                       |   |   |
|---|---------------------------------------|---|---|
| <b>CONDITION</b>                              |                                       | <b>CHECK ONE</b>                              | <b>CHECK ONE</b>                                  |
| <input checked="" type="checkbox"/> EXCELLENT | <input type="checkbox"/> DETERIORATED | <input checked="" type="checkbox"/> UNALTERED | <input checked="" type="checkbox"/> ORIGINAL SITE |
| <input type="checkbox"/> GOOD                 | <input type="checkbox"/> RUINS        | <input type="checkbox"/> ALTERED              | <input type="checkbox"/> MOVED    DATE _____      |
| <input type="checkbox"/> FAIR                 | <input type="checkbox"/> UNEXPOSED    |   |   |

**DESCRIBE THE PRESENT AND ORIGINAL (IF KNOWN) PHYSICAL APPEARANCE**

The four and five mile Milestones face south on the north side of the old road leading from Ellicott City to the Montgomery County Court-house. They are four and five miles west of Old Columbia Pike's intersection with Main Street, Ellicott City, Maryland.

The Old Columbia Pike and a section of Route 29, as well as Route 108, running west to Rockville from its intersection with Route 29 follow the old road. Columbia Pike to Route 108, on the west side of Route 29 was also a part of the old road.

The present Route 29 runs just a few feet east of the old road, running parallel to it.

Owned by the State of Maryland on the edge of the right-of-way, the stones are completely assessible to the public.

The granite blocks are about twelve to fourteen inches wide, eight inches deep and project about thirty inches above grade.

On their south face is inscribed "4 M to E.C." (4 miles to Ellicott City) and "5 M to E.C." (5 miles to Ellicott City) respectively. The other three faces bear no inscription.

These stones appear to be of Baltimore gneiss from the Ellicott City area.

A two (2) Mile Milestone faces east on the west side of Old Columbia Pike, 1/10 of a mile south of the Old Wayside Inn, HO-144. Another stone, the ten (10) Mile Milestone faces south on the north side of Route 108 at the entrance to Lambing Meadow Bank Barn & Farm, HO-468.

All these stones mark the old road and should be placed on the National Register to insure their preservation, since present State Highway plans call for a widening of Route 108.

**8 SIGNIFICANCE**

| PERIOD  | AREAS OF SIGNIFICANCE -- CHECK AND JUSTIFY BELOW   |   |   |  |
|---|--|---|---|--|
| <input type="checkbox"/> PREHISTORIC          | <input type="checkbox"/> ARCHEOLOGY-PREHISTORIC    | <input type="checkbox"/> COMMUNITY PLANNING     | <input type="checkbox"/> LANDSCAPE ARCHITECTURE | <input type="checkbox"/> RELIGION                  |
| <input type="checkbox"/> 1400-1499            | <input type="checkbox"/> ARCHEOLOGY-HISTORIC       | <input type="checkbox"/> CONSERVATION           | <input type="checkbox"/> LAW                    | <input type="checkbox"/> SCIENCE                   |
| <input type="checkbox"/> 1500-1599            | <input type="checkbox"/> AGRICULTURE               | <input type="checkbox"/> ECONOMICS              | <input type="checkbox"/> LITERATURE             | <input type="checkbox"/> SCULPTURE                 |
| <input type="checkbox"/> 1600-1699            | <input type="checkbox"/> ARCHITECTURE              | <input type="checkbox"/> EDUCATION              | <input type="checkbox"/> MILITARY               | <input type="checkbox"/> SOCIAL/HUMANITARIAN       |
| <input type="checkbox"/> 1700-1799            | <input type="checkbox"/> ART                       | <input type="checkbox"/> ENGINEERING            | <input type="checkbox"/> MUSIC                  | <input type="checkbox"/> THEATER                   |
| <input checked="" type="checkbox"/> 1800-1899 | <input type="checkbox"/> COMMERCE                  | <input type="checkbox"/> EXPLORATION/SETTLEMENT | <input type="checkbox"/> PHILOSOPHY             | <input checked="" type="checkbox"/> TRANSPORTATION |
| <input type="checkbox"/> 1900-                | <input checked="" type="checkbox"/> COMMUNICATIONS | <input type="checkbox"/> INDUSTRY               | <input type="checkbox"/> POLITICS/GOVERNMENT    | <input type="checkbox"/> OTHER (SPECIFY)           |
|   |  | <input type="checkbox"/> INVENTION              |   |  |

SPECIFIC DATES            circa 1804            BUILDER/ARCHITECT

**STATEMENT OF SIGNIFICANCE**

The Ellicott City- Montgomery County Courthouse Road Milestones are significant in the field of transportation and communications. They mark the original route of this old road, existing in 1797, and designate distances. Plans to widen and realign Route 108 threaten these stones. Any displacement of any of these Milestones as a result of this highway project must include a plan for their immediate relocation on the right of way as close as possible to their original sites. Inclusion to the National Register of Historic ~~Landmarks~~ <sup>Places</sup> would help to insure such preservation, and immediate action should be taken to initiate the proceedings for such inclusion.

A reference in a newspaper article in the Baltimore Telegraphe and Daily Advertiser, dated October 18, 1804, notes Porter's Tavern "standing on the road leading from Ellicott Mills to Montgomery Court House". The four and five mile milestones are found East of HO-135, Porter's Tavern, while a two (2) mile milestone is found facing east on the west side of Old Columbia Pike, 1/10 of a mile South of the Old Wayside Inn, HO-144, and a ten (10) mile milestone is found facing South on the North side of Route 108 at the entrance of Lambing Meadow Bank Barn and Farm.

In conclusion, all existing milestones which remain to mark the original old road leading from Ellicott City to Montgomery County Courthouse and on to Washington, D.C. should immediately be placed on the National Register of Historic Landmarks.

**9 MAJOR BIBLIOGRAPHICAL REFERENCES**

Hopkin's Atlas of 1878

CONTINUE ON SEPARATE SHEET IF NECESSARY

**10 GEOGRAPHICAL DATA**

ACREAGE OF NOMINATED PROPERTY \_\_\_\_\_

N.A.

VERBAL BOUNDARY DESCRIPTION

N.A.

LIST ALL STATES AND COUNTIES FOR PROPERTIES OVERLAPPING STATE OR COUNTY BOUNDARIES

STATE Maryland COUNTY Howard

STATE COUNTY

**11 FORM PREPARED BY**

NAME / TITLE

Cleora Barnes Thompson, Archivist

ORGANIZATION

Office of Planning & Zoning-Comprehensive Planning Section

DATE

465-5000 x257

STREET & NUMBER

3450 Court House Drive

TELEPHONE

CITY OR TOWN

Ellicott City

STATE

Maryland

The Maryland Historic Sites Inventory was officially created by an Act of the Maryland Legislature, to be found in the Annotated Code of Maryland, Article 41, Section 181 KA, 1974 Supplement.

The Survey and Inventory are being prepared for information and record purposes only and do not constitute any infringement of individual property rights.

RETURN TO: Maryland Historical Trust  
The Shaw House, 21 State Circle  
Annapolis, Maryland 21401  
(301) 267-1438

# SECOND DISTRICT

HOWARD COUNTY

Scale 2 Inches per Mile

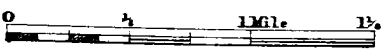

| EXPLANATIONS  |       |
|---|-------|
| Dist. & Co. Lines   | ----- |
| County Roads  | ----- |
| Private " "   | ----- |
| Turnpike " "  | ----- |
| Rail Roads  | ----- |
| Streams   | ----- |
| The figures along the Roads shows the distance in Rods from junction to junction thereof. |       |

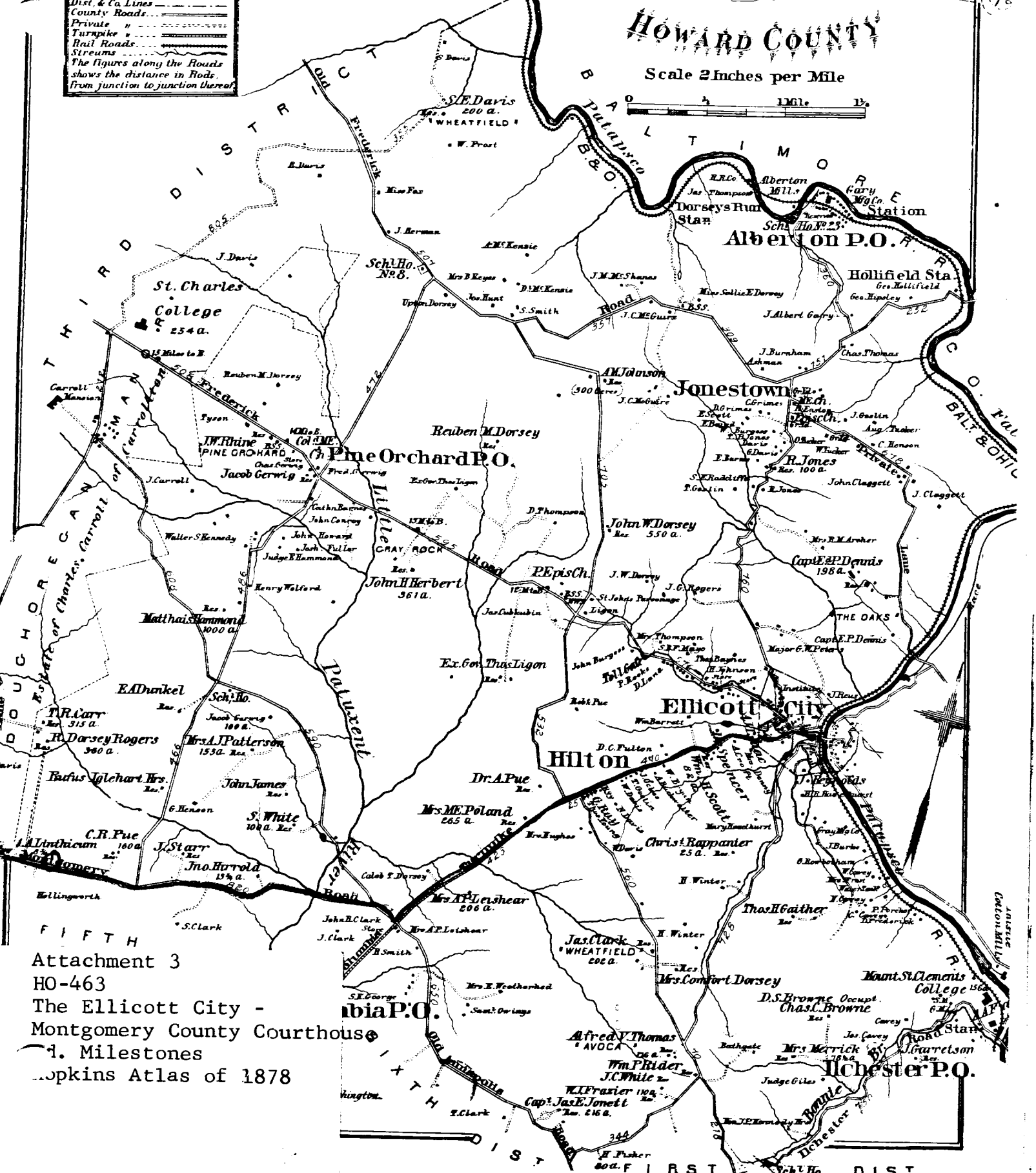

FIFTH  
Attachment 3  
HO-463  
The Ellicott City -  
Montgomery County Courthouse  
4. Milestones  
Hopkins Atlas of 1878



Attachment 2  
HO-463  
The Ellicott City-Montgomery City  
Courthouse Rd. Milestones  
(5m) Topographic Map of Ho.  
County Indicating Historic  
Sites Within the Alternate  
#5 or #6 State Highway Project  
Plan for Route 108  
Scale: 1" = 200'

Attachment 1  
HO-463  
The Old Ellicott City-  
Montgomery County Courthouse  
Road Milestones - 5 Mile  
Milestone  
Tax Map 29

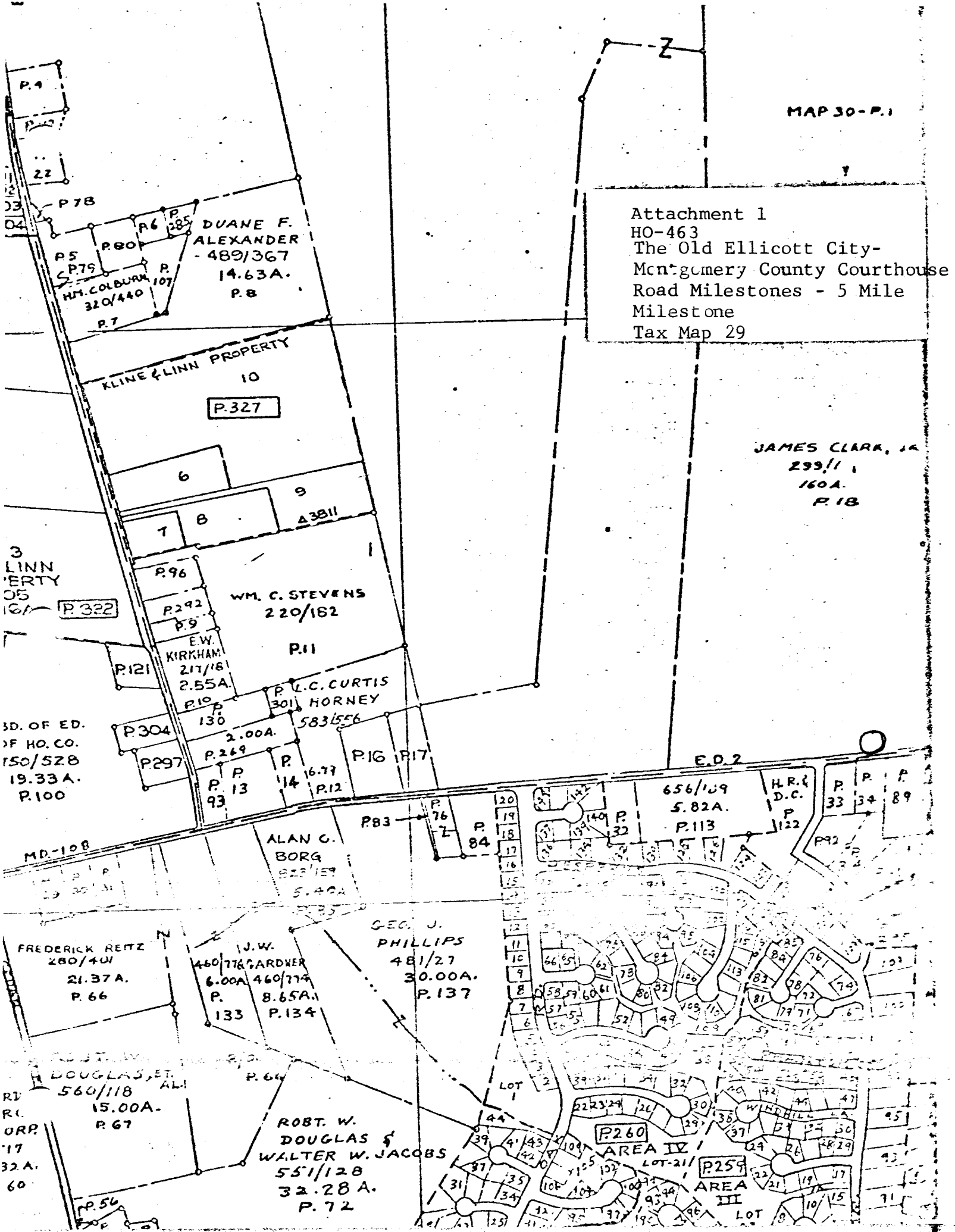

DUANE F.  
ALEXANDER  
- 489/367  
14.63A.  
P. 8

KLINE & LINN PROPERTY  
10

P. 327

WM. C. STEVENS  
220/162  
P. 11

E.W.  
KIRKHAM  
217/18  
2.55A.  
P. 10

P. L.C. CURTIS  
301 HORNEY  
583/556  
P. 10

JAMES CLARK, JR.  
299/1  
160A.  
P. 18

SD. OF ED.  
OF HO. CO.  
150/528  
19.33A.  
P. 100

FREDERICK RETZ  
280/401  
21.37A.  
P. 66

J.W.  
GARDNER  
460/776  
6.00A  
460/774  
8.65A.  
P. 133

GEO. J.  
PHILLIPS  
481/27  
30.00A.  
P. 137

ROBT. W.  
DOUGLAS &  
WALTER W. JACOBS  
551/128  
32.28A.  
P. 72

656/109  
5.82A.  
P. 113

DOUGLAS, ET AL  
560/118  
15.00A.  
P. 67

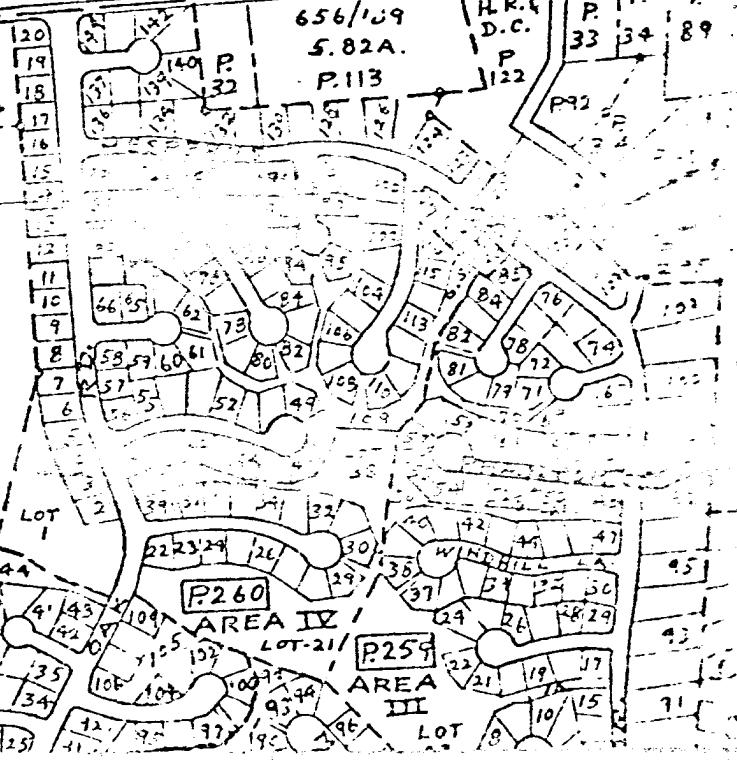



HO-463  
OLD ELLICOTT CITY-  
MONTGOMERY  
COUNTY COURTHOUSE  
ROAD 5 MILE  
MILESTONE  
(SOUTH) JUNE '78

C.B. THOMPSON, AIP