

HO-253
The Old Florence School
Florence
Private

1872

The old Florence School faces south on the north side of Florence Road, two-thirds of a mile east of its intersection with Route 94 and has now been converted from a two room school house to a single family dwelling unit.

It is a three bay wide, three bay deep, one story high, gabled roof (running north-south) frame, clapboard building, once featuring a one story high, shed roofed porch along its south facade, which has now been enclosed, a square, brick, central chimney, and a gabled roof, portico over the central bay, rectangular entrance on its east elevation. One further, shed roofed, one story high, addition has been made along the west wall of the building.

The Old Florence School at Florence, Howard County, Maryland, is one of the earliest school houses still standing in Howard County, which was constructed circa 1872. Distinction attached to this school building is expanded upon by the retention of its east elevation and the central outline of the original building block. Additionally, the pattern of enlargement by increments over a period of time is significant for two reasons: it reflects a common practise in the building history of the United States, and it mirrors the evolution of this particular building from a nineteenth century school house to its present use as a private residence in the twentieth century.

MARYLAND HISTORICAL TRUST

HO-253
Woodbine Quad
District 4
MAGI# 1402535504

INVENTORY FORM FOR STATE HISTORIC SITES SURVEY

1 NAME

HISTORIC
Old Florence School
AND/OR COMMON

2 LOCATION

STREET & NUMBER
2611 Florence Rd. (N. E. Side of Florence Road
about 0.4 miles S.E. of Route 94)
CITY, TOWN
Woodbine _____ VICINITY OF _____ CONGRESSIONAL DISTRICT
6th
STATE
Maryland _____ COUNTY
Howard

3 CLASSIFICATION

CATEGORY	OWNERSHIP	STATUS	PRESENT USE
<input type="checkbox"/> DISTRICT	<input type="checkbox"/> PUBLIC	<input checked="" type="checkbox"/> OCCUPIED	<input type="checkbox"/> AGRICULTURE <input type="checkbox"/> MUSEUM
<input checked="" type="checkbox"/> BUILDING(S)	<input checked="" type="checkbox"/> PRIVATE	<input type="checkbox"/> UNOCCUPIED	<input type="checkbox"/> COMMERCIAL <input type="checkbox"/> PARK
<input type="checkbox"/> STRUCTURE	<input type="checkbox"/> BOTH	<input type="checkbox"/> WORK IN PROGRESS	<input type="checkbox"/> EDUCATIONAL <input type="checkbox"/> PRIVATE RESIDENCE
<input type="checkbox"/> SITE	PUBLIC ACQUISITION	ACCESSIBLE	<input type="checkbox"/> ENTERTAINMENT <input type="checkbox"/> RELIGIOUS
<input type="checkbox"/> OBJECT	<input type="checkbox"/> IN PROCESS	<input checked="" type="checkbox"/> YES: RESTRICTED	<input type="checkbox"/> GOVERNMENT <input type="checkbox"/> SCIENTIFIC
	<input type="checkbox"/> BEING CONSIDERED	<input type="checkbox"/> YES: UNRESTRICTED	<input type="checkbox"/> INDUSTRIAL <input type="checkbox"/> TRANSPORTATION
		<input type="checkbox"/> NO	<input type="checkbox"/> MILITARY <input checked="" type="checkbox"/> OTHER Res.

4 OWNER OF PROPERTY

NAME
Homer F. Day Telephone #: 489-7226
STREET & NUMBER
2611 Florence Road
CITY, TOWN
Woodbine, Maryland _____ VICINITY OF _____ STATE, zip code
21797

5 LOCATION OF LEGAL DESCRIPTION

COURTHOUSE, Tax Map 13 Blk 9 p. 20 Liber #: 893
REGISTRY OF DEEDS, ETC. Hall of Records Folio #: 677
STREET & NUMBER
Howard County Court House
CITY, TOWN
Ellicott City STATE
Maryland

6 REPRESENTATION IN EXISTING SURVEYS

TITLE
Howard County Historic Sites Inventory
DATE
1978-1979 _____ FEDERAL STATE _____ COUNTY _____ LOCAL _____
DEPOSITORY FOR
SURVEY RECORDS Maryland Historical Trust
CITY, TOWN
21 State Circle, Annapolis STATE
Maryland

HO - 253
Woodbine Quad
District 4

7 DESCRIPTION

CONDITION		CHECK ONE	CHECK ONE
<input checked="" type="checkbox"/> EXCELLENT	<input type="checkbox"/> DETERIORATED	<input type="checkbox"/> UNALTERED	<input checked="" type="checkbox"/> ORIGINAL SITE
<input type="checkbox"/> GOOD	<input type="checkbox"/> RUINS	<input checked="" type="checkbox"/> ALTERED	<input type="checkbox"/> MOVED DATE _____
<input type="checkbox"/> FAIR	<input type="checkbox"/> UNEXPOSED		

DESCRIBE THE PRESENT AND ORIGINAL (IF KNOWN) PHYSICAL APPEARANCE

The old Florence School faces south on the north side of Florence Road, two-thirds of a mile east of its intersection with Route 94 and has now been converted from a two room school house to a single family dwelling unit.

It is a three bay wide, three bay deep, one story high, gabled roof (running north-south) frame, clapboard building, once featuring a one story high, shed roofed porch along its south facade, which has now been enclosed, a square, brick, central chimney, and a gabled roof, portico over a central bay, rectangular entrance on its east elevation. One further, shed roofed, one story high, addition has been made along the west wall of the building.

Fenestration for the old school building in the main section of the house is rectangular and double-hung, holding six-over-six lights. Windows placed in the new additions to the building are rectangular and double hung, holding one-over-one lights.

CONTINUE ON SEPARATE SHEET IF NECESSARY

4. With the growth in population, as well as the influx of new families into the western part of Howard County, coupled with greater sophistication in the design of schools to provide several rooms to accommodate this larger school population into separate rooms and grades by age and ability, the extinction of the two room, one teacher school was inevitable. A page in American education turned and was past, and with it, went those buildings which were associated with it. Howard County is indeed fortunate to have only a few, which remain now in private hands and are almost always adapted to residential use. Such a one is the Old Florence School.

9 MAJOR BIBLIOGRAPHICAL REFERENCES

HO-253
Woodbine Quad
District 4

Land Records of Howard County
Hopkins Atlas of 1878

CONTINUE ON SEPARATE SHEET IF NECESSARY

10 GEOGRAPHICAL DATA

ACREAGE OF NOMINATED PROPERTY 1.03 Acres

Please see Attachment 1, Tax Map

VERBAL BOUNDARY DESCRIPTION

Please see Howard County Land Records, Liber 893 Folio 677

LIST ALL STATES AND COUNTIES FOR PROPERTIES OVERLAPPING STATE OR COUNTY BOUNDARIES

STATE	Maryland	COUNTY	Howard
STATE		COUNTY	

11 FORM PREPARED BY

NAME / TITLE
Cleora Barnes Thompson, Archivist

ORGANIZATION
Office of Planning & Zoning-Comprehensive Planning Section

DATE

STREET & NUMBER
3450 Court House Drive

TELEPHONE

CITY OR TOWN
Ellicott City

STATE
Maryland

The Maryland Historic Sites Inventory was officially created by an Act of the Maryland Legislature, to be found in the Annotated Code of Maryland, Article 41, Section 181 KA, 1974 Supplement.

The Survey and Inventory are being prepared for information and record purposes only and do not constitute any infringement of individual property rights.

RETURN TO: Maryland Historical Trust
The Shaw House, 21 State Circle
Annapolis, Maryland 21401
(301) 267-1438

TITLE SEARCH

Page 1 of 1

HO-253 Old Florence School
 Prepared by Cleora Thompson, A.I.C.P.

<u>DATE</u>	<u>LIBER-FOLIO</u>	<u>GRANTOR</u>	<u>GRANTEE</u>	<u>TRANSACTION</u>
14-7-78	893-677	Janet G. Harrison surviving tenant by the Entirety of Raymond E. Harrison	Homer Fay Day, Charslee Day	Deed to 302/1000 of an acre for \$38,500.00
15-9-72	609-4	Ethel F. Harrison, Isabelle D. Eyler	Raymond E. Harrison, and Janet, his wife	302/1000 of an acre of Land
30-5-72	594-144	Ethel F. Harrison, Isabelle Eyler, personal represen- tatives of the Estate of Mary Duvall	Ethel F. Harrison, Isabelle Eyler	1 Acre, 5 Perches of Land
2-5-44	181-511	Thomas G. Pullen, Jr. State Superintendent of Schools	Raymond C. Duvall, Mary E. Duvall, wife	Deed to land known as the Florence School House Lot
24-8-1872	33-131	Samuel Jarden, Amelia J. Jarden	Board of School Commissioners of Howard County	Deed for \$1.00 called "Hobson's Choice" 1 Acre- 5 Perches of Land

HO 253
1402535504

MARYLAND HISTORICAL TRUST WORKSHEET

NOMINATION FORM
for the
NATIONAL REGISTER OF HISTORIC PLACES, NATIONAL PARKS SERVICE

1. NAME

COMMON: Old Florence School

AND/OR HISTORIC:

2. LOCATION

STREET AND NUMBER: North east side of Florence Road about 0.4 mi

CITY OR TOWN: South east of Ellicott Road (Md 94)

STATE: COUNTY:

3. CLASSIFICATION

CATEGORY (Check One)	OWNERSHIP	STATUS	ACCESSIBLE TO THE PUBLIC
<input type="checkbox"/> District <input checked="" type="checkbox"/> Building <input type="checkbox"/> Site <input type="checkbox"/> Structure <input type="checkbox"/> Object	<input type="checkbox"/> Public <input checked="" type="checkbox"/> Private <input type="checkbox"/> Both	Public Acquisition: <input type="checkbox"/> In Process <input type="checkbox"/> Being Considered	<input checked="" type="checkbox"/> Occupied <input type="checkbox"/> Unoccupied <input type="checkbox"/> Preservation work in progress
PRESENT USE (Check One or More as Appropriate)			
<input type="checkbox"/> Agricultural <input type="checkbox"/> Commercial <input type="checkbox"/> Educational <input type="checkbox"/> Entertainment	<input type="checkbox"/> Government <input type="checkbox"/> Industrial <input type="checkbox"/> Military <input type="checkbox"/> Museum	<input type="checkbox"/> Park <input checked="" type="checkbox"/> Private Residence <input type="checkbox"/> Religious <input type="checkbox"/> Scientific	<input type="checkbox"/> Transportation <input type="checkbox"/> Other (Specify) _____ <input type="checkbox"/> Comments _____ _____ _____

4. OWNER OF PROPERTY

OWNER'S NAME: Raymond J and Jennie Harrison

STREET AND NUMBER: Florence Road

CITY OR TOWN: Florence STATE: Md

5. LOCATION OF LEGAL DESCRIPTION

COURTHOUSE, REGISTRY OF DEEDS, ETC.: Clerk of the Circuit Court

STREET AND NUMBER: Howard County Courthouse

CITY OR TOWN: Ellicott City STATE: Md.

Title Reference of Current Deed (Book & Pg. #):

6. REPRESENTATION IN EXISTING SURVEYS

TITLE OF SURVEY:

DATE OF SURVEY: Federal State County Local

DEPOSITORY FOR SURVEY RECORDS:

STREET AND NUMBER:

CITY OR TOWN: STATE:

P. SEE INSTRUCTIONS
13
20

8. SIGNIFICANCE

PERIOD (Check One or More as Appropriate)

<input type="checkbox"/> Pre-Columbian	<input type="checkbox"/> 16th Century	<input type="checkbox"/> 18th Century	<input type="checkbox"/> 20th Century
<input type="checkbox"/> 15th Century	<input type="checkbox"/> 17th Century	<input checked="" type="checkbox"/> 19th Century	

SPECIFIC DATE(S) (If Applicable and Known)

AREAS OF SIGNIFICANCE (Check One or More as Appropriate)

<input type="checkbox"/> Aboriginal	<input checked="" type="checkbox"/> Education	<input type="checkbox"/> Political	<input type="checkbox"/> Urban Planning
<input type="checkbox"/> Prehistoric	<input type="checkbox"/> Engineering	<input type="checkbox"/> Religion/Philosophy	<input type="checkbox"/> Other (Specify)
<input type="checkbox"/> Historic	<input type="checkbox"/> Industry	<input type="checkbox"/> Science	_____
<input type="checkbox"/> Agriculture	<input type="checkbox"/> Invention	<input type="checkbox"/> Sculpture	_____
<input type="checkbox"/> Architecture	<input type="checkbox"/> Landscape Architecture	<input type="checkbox"/> Social/Humanitarian	_____
<input type="checkbox"/> Art	<input type="checkbox"/> Literature	<input type="checkbox"/> Theater	_____
<input type="checkbox"/> Commerce	<input type="checkbox"/> Military	<input type="checkbox"/> Transportation	_____
<input type="checkbox"/> Communications	<input type="checkbox"/> Music		_____
<input type="checkbox"/> Conservation			_____

STATEMENT OF SIGNIFICANCE

Once a two-room school, this has been a dwelling since the 1930's, surviving because of the drastic need for low-cost housing.

SEE INSTRUCTIONS

9 MAJOR BIBLIOGRAPHICAL REFERENCES

Blank area for Major Bibliographical References.

10 GEOGRAPHICAL DATA

LATITUDE AND LONGITUDE COORDINATES DEFINING A RECTANGLE LOCATING THE PROPERTY			O R	LATITUDE AND LONGITUDE COORDINATES DEFINING THE CENTER POINT OF A PROPERTY OF LESS THAN TEN ACRES		
CORNER	LATITUDE	LONGITUDE		LATITUDE	LONGITUDE	
	Degrees Minutes Seconds	Degrees Minutes Seconds		Degrees Minutes Seconds	Degrees Minutes Seconds	
NW	° ' "	° ' "		° ' "	° ' "	
NE	° ' "	° ' "		° ' "	° ' "	
SE	° ' "	° ' "		° ' "	° ' "	
SW	° ' "	° ' "		° ' "	° ' "	

APPROXIMATE ACREAGE OF NOMINATED PROPERTY:

Acreege Justification:

Blank area for Acreege Justification.

LIST ALL STATES AND COUNTIES FOR PROPERTIES OVERLAPPING STATE OR COUNTY BOUNDARIES

STATE:	COUNTY:
STATE:	COUNTY:
STATE:	COUNTY:
STATE:	COUNTY:

SEE INSTRUCTIONS

11. FORM PREPARED BY

NAME AND TITLE: **JEAN S EWING**

ORGANIZATION: **MARYLAND HISTORICAL TRUST** DATE:

STREET AND NUMBER: **2525 RIVA RD**

CITY OR TOWN: **ANNAPOLIS** STATE: **MARYLAND**

12. State Liaison Officer Review: (Office Use Only)

Significance of this property is:

National State Local

Signature _____

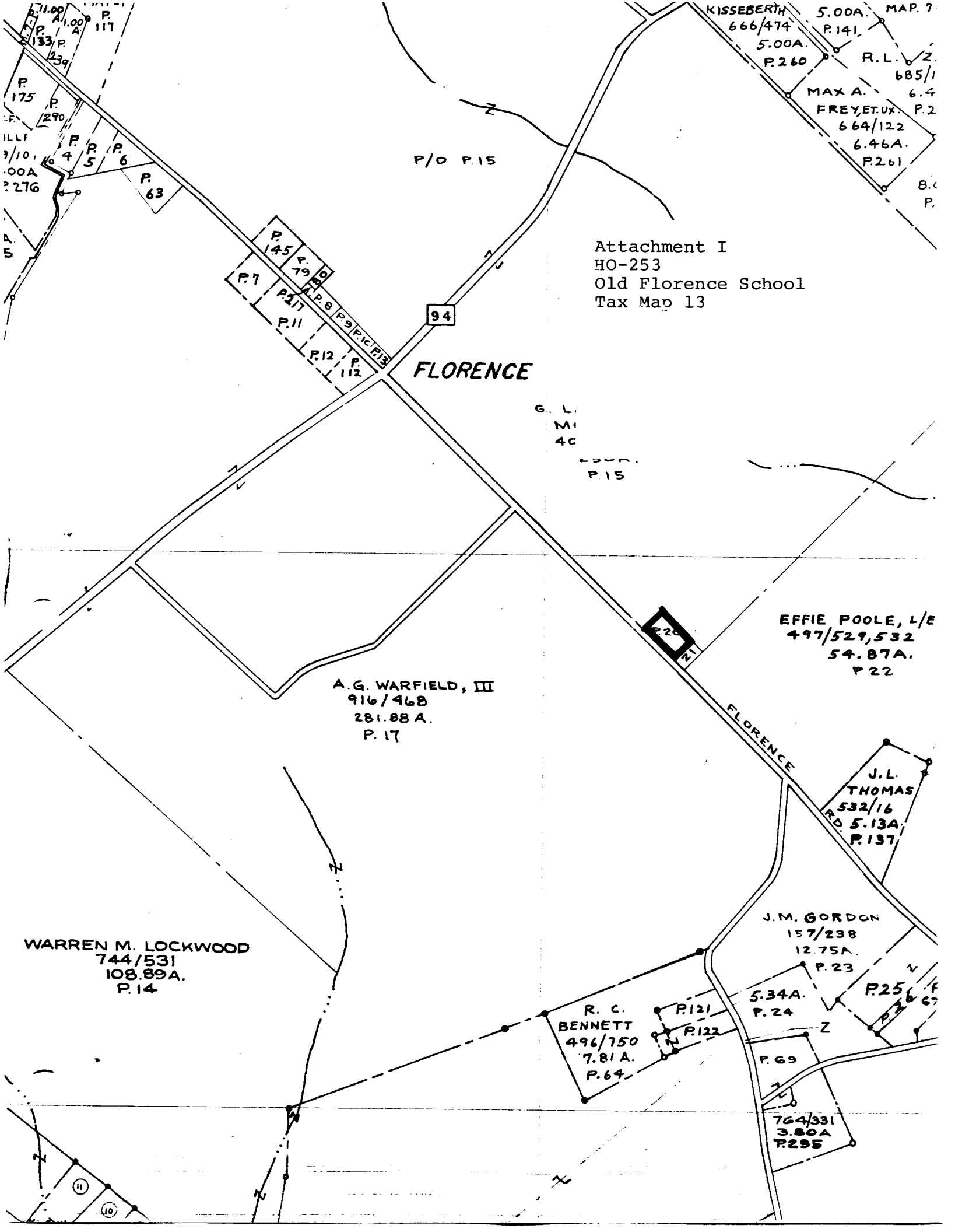

Attachment I
HO-253
Old Florence School
Tax Map 13

FLORENCE

WARREN M. LOCKWOOD
744/531
108.89A.
P. 14

A. G. WARFIELD, III
916/468
281.88A.
P. 17

EFFIE POOLE, L/E
497/529, 532
54.87A.
P. 22

R. C. BENNETT
496/750
7.81A.
P. 64

J. M. GORDON
157/238
12.75A.
P. 23

J. L. THOMAS
532/16
RD 5.13A.
P. 137

5.34A.
P. 24

764/331
3.80A.
P. 295

94



ALLEY		ST.	
100	150	1	1
11	151	2	2
12	152	3	3
13	153	4	4
14	154	5	5
15	155	6	6
16	156	7	7
17	157	8	8
18	158	9	9
19	159	10	10
20	160	11	11
21	161	12	12
22	162	13	13
23	163	14	14
24	164	15	15
25	165	16	16
26	166	17	17
27	167	18	18
28	168	19	19
29	169	20	20
30	170	21	21

Attachment 3
 HO - 253
 The Old Florence School
 Hopkin's Atlas of 1878



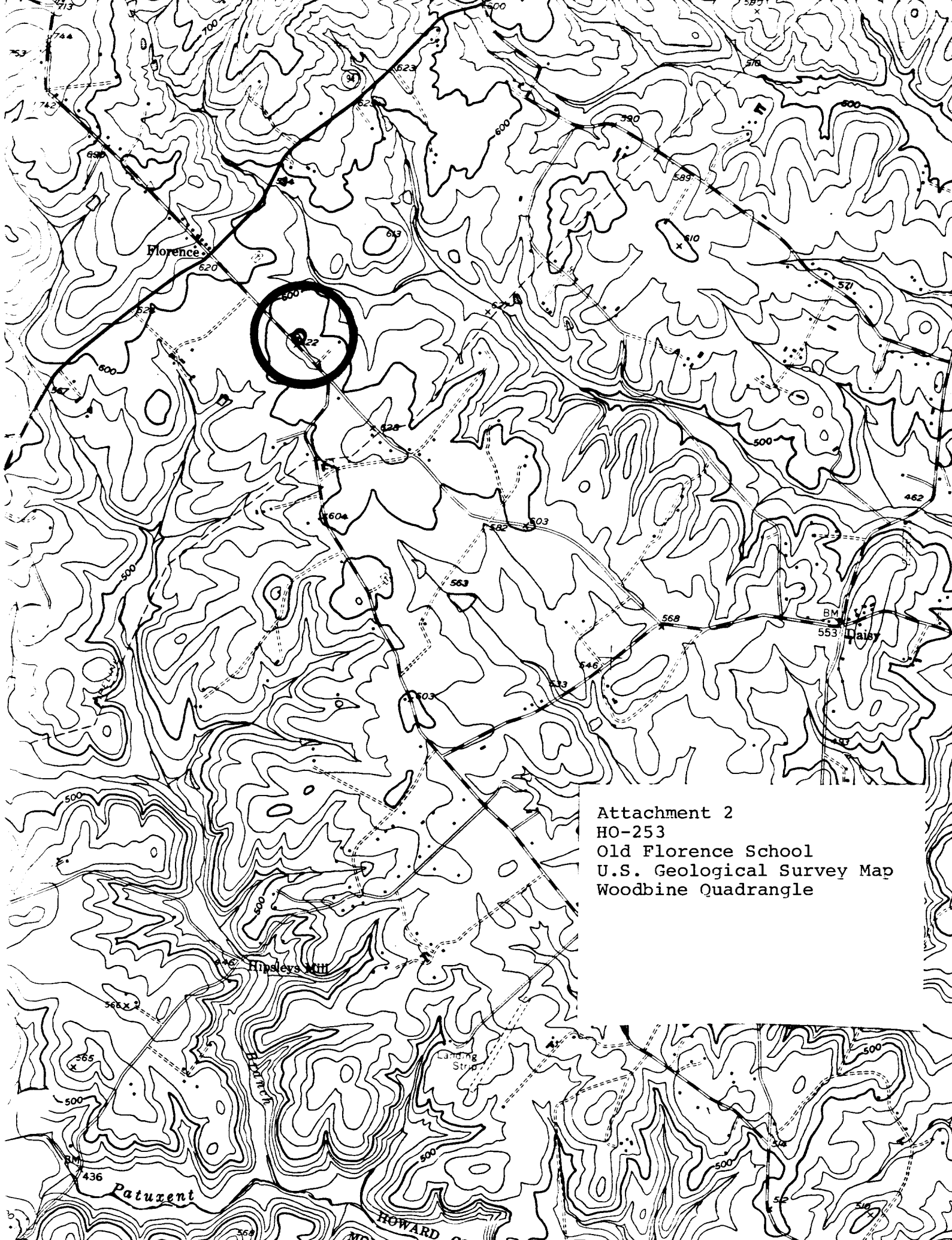

Attachment 2
HO-253
Old Florence School
U.S. Geological Survey Map
Woodbine Quadrangle



H0 253

old Florence Schoolhouse JSE 8/73



Name: HO-253

The Old Florence School
Location: 2611 Florence Road
Woodbine, Maryland

Photographer: Cleora B. Thompson, A.I.C.P.

Date of Photograph: May, 1980

Negatives in possession of the Maryland Historical Trust

View: West

Photographer looking: East

Photograph number: 1 of 1