

HO-252
The Old Florence Store
Florence
Private

1905

The Old Florence Store faces east on the southwest corner of Florence Road and Route 94 in Florence.

This old country store has undergone several transformations since the 1960's, when it was a social center, as well as a store, furnishing general merchandise to the residents of this area. Acquired by Mr. and Mrs. James J. Rosensteel, it has been created into a charming residence with an apartment on the ground floor and second floor.

Originally the country store held one large, rectangular room on the first and second floors, with only a small area of the dirt cellar dug out to store firewood.

Today, little remains except the rectangular, two story high, gabled roof (running north-south) form of the principle building block. The original tall, rectangular, double-hung windows, holding six-over-six lights, have been replaced by more squarely shaped, double-hung windows, holding eight-over-eight lights or smaller windows. A full, cinderblock foundation has been dug out, and, on the east elevation, is faced with brick. This now holds a ground floor apartment.

An old photograph, taken when under the ownership of Mr. J. J. Doherty, indicates a central, rectangular, east entrance door, flanked by six-over-six light, rectangular windows, all of which is covered by a one story high, shed roofed, open porch, supported by four, square, wooden posts. Three similar windows rest above.

This country store replaced a previous store located here and designated on the 1878 Hopkin's Atlas.

MARYLAND HISTORICAL TRUST

HO - 252
 Woodbine Quad
 Dist. 4
 MAGI# 1402525704

INVENTORY FORM FOR STATE HISTORIC SITES SURVEY

1 NAME

HISTORIC The Old Florence Store

AND/OR COMMON
 Warfield-Dougherty Store

2 LOCATION

STREET & NUMBER
 2396 Florence Road

CITY, TOWN
 Woodbine,

___ VICINITY OF

CONGRESSIONAL DISTRICT
 6th

STATE
 Maryland

COUNTY
 Howard

3 CLASSIFICATION

CATEGORY	OWNERSHIP	STATUS	PRESENT USE	
<input type="checkbox"/> DISTRICT	<input type="checkbox"/> PUBLIC	<input checked="" type="checkbox"/> OCCUPIED	<input type="checkbox"/> AGRICULTURE	<input type="checkbox"/> MUSEUM
<input checked="" type="checkbox"/> BUILDING(S)	<input checked="" type="checkbox"/> PRIVATE	<input type="checkbox"/> UNOCCUPIED	<input type="checkbox"/> COMMERCIAL	<input type="checkbox"/> PARK
<input type="checkbox"/> STRUCTURE	<input type="checkbox"/> BOTH	<input type="checkbox"/> WORK IN PROGRESS	<input type="checkbox"/> EDUCATIONAL	<input checked="" type="checkbox"/> PRIVATE RESIDENCE *
<input type="checkbox"/> SITE	PUBLIC ACQUISITION	ACCESSIBLE	<input type="checkbox"/> ENTERTAINMENT	<input type="checkbox"/> RELIGIOUS
<input type="checkbox"/> OBJECT	<input type="checkbox"/> IN PROCESS	<input checked="" type="checkbox"/> YES: RESTRICTED *	<input type="checkbox"/> GOVERNMENT	<input type="checkbox"/> SCIENTIFIC
	<input type="checkbox"/> BEING CONSIDERED	<input type="checkbox"/> YES: UNRESTRICTED	<input type="checkbox"/> INDUSTRIAL	<input type="checkbox"/> TRANSPORTATION
		<input type="checkbox"/> NO	<input type="checkbox"/> MILITARY	<input type="checkbox"/> OTHER

4 OWNER OF PROPERTY

NAME
 Mr. and Mrs. James J. Rosensteel

Telephone #: 489-4727

STREET & NUMBER
 2396 Florence Road

CITY, TOWN
 Woodbine, Maryland

___ VICINITY OF

STATE, zip code
 21797

5 LOCATION OF LEGAL DESCRIPTION

COURTHOUSE. Tax Map 14 p. 112
 REGISTRY OF DEEDS, ETC. Hall of Records

Liber #: 429

Folio #: 476

STREET & NUMBER
 Howard County Court House

CITY, TOWN
 Ellicott City

STATE
 Maryland

6 REPRESENTATION IN EXISTING SURVEYS

TITLE
 Howard County Historic Sites Inventory

DATE
 1978-1979

___ FEDERAL STATE ___ COUNTY ___ LOCAL

DEPOSITORY FOR
 SURVEY RECORDS Maryland Historical Trust

CITY, TOWN
 21 State Circle, Annapolis

STATE
 Maryland

7 DESCRIPTION

CONDITION		CHECK ONE	CHECK ONE
<input checked="" type="checkbox"/> EXCELLENT	<input type="checkbox"/> DETERIORATED	<input type="checkbox"/> UNALTERED	<input checked="" type="checkbox"/> ORIGINAL SITE
<input type="checkbox"/> GOOD	<input type="checkbox"/> RUINS	<input checked="" type="checkbox"/> ALTERED	<input type="checkbox"/> MOVED DATE _____
<input type="checkbox"/> FAIR	<input type="checkbox"/> UNEXPOSED		

DESCRIBE THE PRESENT AND ORIGINAL (IF KNOWN) PHYSICAL APPEARANCE

The Old Florence Store faces east on the southwest corner of Florence Road and Route 94 in Florence.

This old country store has undergone several transformations since the 1960's, when it was a social center, as well as a store, furnishing general merchandise to the residents of this area. Acquired by Mr. and Mrs. James J. Rosensteel, it has been created into a charming residence with an apartment on the ground floor and second floor.

Originally the country store held one large, rectangular room on the first and second floors, with only a small area of the dirt cellar dug out to store fire wood.

Today, little remains except the rectangular, two story high, gabled roof (running north-south) form of the principle building block. The original tall, rectangular, double hung windows, holding six-over-six lights, have been replaced by more squarely shaped, double-hung windows, holding eight-over-eight lights or smaller windows. A full, cinderblock foundation has been dug out, and, on the east elevation, is faced with brick. This now holds a ground floor apartment.

An old photograph, taken when under the ownership of Mr. J. J. Doherty, indicates a central, rectangular, east entrance door, flanked by six-over-six light, rectangular windows, all of which is covered by a one story high, shed roofed, open porch, supported by four, square, wooden posts. Three similar windows rest above.

Today, the building is a three bay wide, two bay deep, two story high, gabled roof (running north-south) frame (covered with aluminum siding) building, originally resting on a stone foundation, which has now been created into a full story, cement block (faced with brick on the east elevation) foundation. A three story high, shed roofed, open porch held on the ground floor by four iron posts, and on the first and second floors, by four square, wooden posts, runs along the entire east elevation. The ground floor of the east facade holds a central, rectangular, entrance flanked by picture windows. The original first floor, central entrance has been replaced by an eight-over-eight light window with the present rectangular entrance placed in the north bay of this wall. Its south bay holds a similar eight-over-eight light window.

The second floor holds end bay, rectangular entrances, with a central bay, eight-over-eight light window.

The south elevation of the building has also been altered. Originally it held a first and second floor, rectangular, six-over-six light, window, in its west bay, the first floor of which was decorated with shutters.

CONTINUE ON SEPARATE SHEET IF NECESSARY

A circular attic window, or bull's eye, was inset into the "A" framed by the gable roof.

Today two narrow, horizontal rectangular, one-one light windows are placed on the first floor of this wall and a west bay, one-over-one light, second floor window with an eight-over-eight light, east bay, second floor window punctuating this wall.

Along the west wall of the building was a one story high, gabled roof (running east-west) pull through garage, with a small area on its east side for supplies and fresh produce from the market, with now has been created into a modern family room with fireplace on its west wall. The large garage doors on the south facade now hold an eighteen light bow window, underlined and supported by an arched brick wall. An entrance door on the east side of the bow window is placed close to the same location as an earlier rectangular entrance into the fresh produce storage area.

One story high, shed roof, open porches have been constructed along both the north and south elevations of this original pull-through garage, which has now become a charming addition to a private residence.

PERIOD	AREAS OF SIGNIFICANCE -- CHECK AND JUSTIFY BELOW				
<input type="checkbox"/> PREHISTORIC	<input type="checkbox"/> ARCHEOLOGY-PREHISTORIC	<input type="checkbox"/> COMMUNITY PLANNING	<input type="checkbox"/> LANDSCAPE ARCHITECTURE	<input type="checkbox"/> RELIGION	
<input type="checkbox"/> 1400-1499	<input checked="" type="checkbox"/> ARCHEOLOGY-HISTORIC	<input type="checkbox"/> CONSERVATION	<input type="checkbox"/> LAW	<input type="checkbox"/> SCIENCE	
<input type="checkbox"/> 1500-1599	<input type="checkbox"/> AGRICULTURE	<input type="checkbox"/> ECONOMICS	<input type="checkbox"/> LITERATURE	<input type="checkbox"/> SCULPTURE	
<input type="checkbox"/> 1600-1699	<input checked="" type="checkbox"/> ARCHITECTURE	<input type="checkbox"/> EDUCATION	<input type="checkbox"/> MILITARY	<input checked="" type="checkbox"/> SOCIAL/HUMANITARIAN	
<input type="checkbox"/> 1700-1799	<input type="checkbox"/> ART	<input type="checkbox"/> ENGINEERING	<input type="checkbox"/> MUSIC	<input type="checkbox"/> THEATER	
<input type="checkbox"/> 1800-1899	<input checked="" type="checkbox"/> COMMERCE	<input type="checkbox"/> EXPLORATION/SETTLEMENT	<input type="checkbox"/> PHILOSOPHY	<input type="checkbox"/> TRANSPORTATION	
<input checked="" type="checkbox"/> 1900-	<input type="checkbox"/> COMMUNICATIONS	<input type="checkbox"/> INDUSTRY	<input type="checkbox"/> POLITICS/GOVERNMENT	<input type="checkbox"/> OTHER (SPECIFY)	
		<input type="checkbox"/> INVENTION			

SPECIFIC DATES 1905 BUILDER/ARCHITECT

STATEMENT OF SIGNIFICANCE

The Old Florence Store at Florence, Howard County, Maryland, is one of the earliest commercial buildings still standing in western Howard County, which was responsible for the creation of Florence as a community.¹ Distinction attaching from age is expanded upon by its original use as a Country Store, for it is, along with the Daisy Trading Post, Pindell's Country Store at Glenwood and Lee's Market in Lisbon, one of the few commercial buildings to serve this area.² Additionally, the pattern of adaptive use from commercial to residential over a period of time is significant for two reasons: it reflects a common building practice in the history of the United States,³ and it mirrors the evolution of this particular community from shortly after the Civil War through the turn of the present century and even to this day.⁴

History and Support

1. J. D. Warfield, a local historian, gives the following history of Florence in which he points out the fact that the community was started as a cross-roads store, this building now in question:

This village was named by Gassaway Watkins Warfield... Though present when it was named, I cannot remember the favorite lady thus honored. Florence was started as a cross-roads store, later becoming a post-office; it is now a business center for a large section of Upper Howard (1905). Hon. Walter M. Black, former delegate to the Legislature, adjoins it on the north and Joshua N. Warfield, of the Democratic Executive Committee and School Commissioner of the County, owns the whole village and adjoins it on the south. Both have converted old fields into productive farms, upon which are commodious houses upon the sites of the progenitor's primitive abodes.

On March 13, 1875 Joshua N. Warfield acquired the property from William R. Warfield. It is generally believed that Joshua Warfield constructed the first country store in this location, which had formerly been used as a blacksmith shop, which stood south of the present building. Joshua Warfield started the store and then rented it out to his brother,

Marshall T. Warfield. Other managers which followed were Clarence Owings, the Warthen Brothers and Mr. Charles Pickett, whose son was once Register of Wills for Howard County. The store burned down one night some seventy-five years ago and the Warfields rebuilt it, renting it out to John J. Doherty, until, in 1923, he bought the store, continuing to operate it until 1964 when it became the property of Mr. and Mrs. James Rosensteel.

2. The Country Store in the rural area of the United States served, not only the commercial needs of its neighborhood, but its social needs as well. As late as 1964, one could find four of five men sitting around the store, spinning yarns and passing the time of day. Messages might be put up, serving to inform the community of various events or encouraging political support for one or another candidate. The importance of the cohesiveness and genuine neighborhood feeling it generated is not easily accessed in today's world, which encompassed the large shopping malls of the Baltimore-Washington Area. Here everything was on the human scale and one, one room store provided feed, fertilizer, shoes, yardgoods, groceries and fresh produce for a small community, who all knew one another and were often related.

3. A pattern of adaptive use from commercial to residential has been seen in several area of Howard County; on Main Street, Elkridge, where former grocery stores are now fine private residences; in Lisbon, where the shops of blacksmiths and wheelrights are now comfortable homes; to this little country store in Florence, now the home of the owner, with an additional ground floor apartment. This pattern of adaptive use is also seen in both Washington and Baltimore as well.

4. The rise of Joshua Warfield's country store and post office in 1878 mirrored and sought to provide for the needs of the community. By 1905, in the words of J. D. Warfield, it was "now a business center for a large section of upper Howard". The store flourished through the next decades until the 1960's, when there was a general decline and final closing. Today, the area remains much as it was at the turn of the century, but two things may be responsible for its demise: 1) the advent of the automobile with its accessibility to other market areas and 2) the rise of the suburban shopping centers of Westview, Normandy, and the Columbia Mall, with their more sophisticated approach to marketing. Fortunately, this Country Store has been adapted to a new residential use and remains as a landmark for the surrounding neighborhood to enjoy.

HO - 252
Woodbine Quad.
Dist. 4

9 MAJOR BIBLIOGRAPHICAL REFERENCES

Warfield, J. D. Founders of Anne Arundel and Howard County, Maryland
Baltimore, 1973.

Interview with Mrs. James J. Rosensteel at her home on May 14, 1980.
Interview with Mr. Charles Layton, longtime resident of Florence on
May 22, 1980

CONTINUE ON SEPARATE SHEET IF NECESSARY

10 GEOGRAPHICAL DATA

ACREAGE OF NOMINATED PROPERTY .50 acres

Please see Attachment 1, Tax Map 13

VERBAL BOUNDARY DESCRIPTION

Please see Howard County Land Records, Liber 429 Folio 476

LIST ALL STATES AND COUNTIES FOR PROPERTIES OVERLAPPING STATE OR COUNTY BOUNDARIES

STATE	Maryland	COUNTY	Howard
STATE		COUNTY	

11 FORM PREPARED BY

NAME - TITLE

Cleora Barnes Thompson, Archivist

ORGANIZATION

Office of Planning & Zoning-Comprehensive Planning Section

DATE

STREET & NUMBER

3450 Court House Drive

TELEPHONE

CITY OR TOWN

Ellicott City

STATE

Maryland

The Maryland Historic Sites Inventory was officially created by an Act of the Maryland Legislature, to be found in the Annotated Code of Maryland, Article 41, Section 181 KA, 1974 Supplement.

The Survey and Inventory are being prepared for information and record purposes only and do not constitute any infringement of individual property rights.

RETURN TO: Maryland Historical Trust
The Shaw House, 21 State Circle
Annapolis, Maryland 21401
(301) 267-1438

TITL SEARCH

HO-252 Old Florence Store
 Prepared by Cleora Thompson, A.I.C.P.

<u>DATE</u>	<u>LIBER-FOLIO</u>	<u>GRANTOR</u>	<u>GRANTEE</u>	<u>TRANSACTION</u>
19-12-64	429-476	John J. Doherty	James H. Rosensteel, Dorothy G. Rosensteel	Deed for P/O larger tract, consisting of 51sq perches for \$4,000
22-9-23	118-537	Norman H. Warfield, Clara Warfield	John J. Doherty	Deed for \$10.00 P/O larger tract, 51 square perches of land
13-3-1875	LJW 35-183	William R. Warfield	Joshua N. Warfield	Deed

MARYLAND HISTORICAL TRUST WORKSHEET

HO 252
140252441

NOMINATION FORM
for the
NATIONAL REGISTER OF HISTORIC PLACES, NATIONAL PARKS SERVICE

1. NAME

COMMON: Florence's Country Store

AND/OR HISTORIC:

2. LOCATION

STREET AND NUMBER: West corner of Ellicott and Florence Roads

CITY OR TOWN: Florence

STATE: Maryland COUNTY: Howard

3. CLASSIFICATION

CATEGORY (Check One)	OWNERSHIP	STATUS	ACCESSIBLE TO THE PUBLIC
<input type="checkbox"/> District <input type="checkbox"/> Site <input checked="" type="checkbox"/> Building <input type="checkbox"/> Structure <input type="checkbox"/> Object	<input type="checkbox"/> Public <input checked="" type="checkbox"/> Private <input type="checkbox"/> Both	Public Acquisition: <input type="checkbox"/> In Process <input type="checkbox"/> Being Considered	<input checked="" type="checkbox"/> Occupied <input type="checkbox"/> Unoccupied <input type="checkbox"/> Preservation work in progress
PRESENT USE (Check One or More as Appropriate)			
<input checked="" type="checkbox"/> Agricultural <input type="checkbox"/> Commercial <input type="checkbox"/> Educational <input type="checkbox"/> Entertainment	<input type="checkbox"/> Government <input type="checkbox"/> Industrial <input type="checkbox"/> Military <input type="checkbox"/> Museum	<input type="checkbox"/> Park <input checked="" type="checkbox"/> Private Residence <input type="checkbox"/> Religious <input type="checkbox"/> Scientific	<input type="checkbox"/> Transportation <input type="checkbox"/> Other (Specify) <u>Chapman's home above</u> <input type="checkbox"/> Comments

4. OWNER OF PROPERTY

OWNER'S NAME: James H. Rosensteel

STREET AND NUMBER: RD 2

CITY OR TOWN: Woodbury STATE: Md 21797

5. LOCATION OF LEGAL DESCRIPTION

COURTHOUSE, REGISTRY OF DEEDS, ETC.: clock of the Circuit Court

STREET AND NUMBER: Howard County Court House

CITY OR TOWN: Ellicott City STATE: Md.

Title Reference of Current Deed (Book & Pg. #):

6. REPRESENTATION IN EXISTING SURVEYS

TITLE OF SURVEY:

DATE OF SURVEY: Federal State County Local

DEPOSITORY FOR SURVEY RECORDS:

STREET AND NUMBER:

CITY OR TOWN: STATE:

SEE INSTRUCTIONS
429/476
112
13

7. DESCRIPTION	
CONDITION	(Check One) <input type="checkbox"/> Excellent <input checked="" type="checkbox"/> Good <input type="checkbox"/> Fair <input type="checkbox"/> Deteriorated <input type="checkbox"/> Ruins <input type="checkbox"/> Unexposed
	(Check One) (Check One) <input checked="" type="checkbox"/> Altered <input type="checkbox"/> Unaltered <input type="checkbox"/> Moved <input checked="" type="checkbox"/> Original Site
DESCRIBE THE PRESENT AND ORIGINAL (if known) PHYSICAL APPEARANCE	
<p>This old country crossroads store faces east; a bank-building, there are 3 stories on the east, 2 on the west side. T shaped, a wind runs west from the center of the building.</p> <p>3 days by 2, windows have 8 lights on 8 or 4 over 4.</p> <p>There is a three-story porch on the front or east of the house sheltering a door to the store-room in the basement. a door on the first floor level, and two doors on the third floor level. The railings are iron.</p>	

SEE INSTRUCTIONS

8. SIGNIFICANCE

PERIOD (Check One or More as Appropriate)

<input type="checkbox"/> Pre-Columbian	<input type="checkbox"/> 16th Century	<input type="checkbox"/> 18th Century	<input type="checkbox"/> 20th Century
<input type="checkbox"/> 15th Century	<input type="checkbox"/> 17th Century	<input checked="" type="checkbox"/> 19th Century	

SPECIFIC DATE(S) (If Applicable and Known)

AREAS OF SIGNIFICANCE (Check One or More as Appropriate)

<input type="checkbox"/> Aboriginal	<input type="checkbox"/> Education	<input type="checkbox"/> Political	<input type="checkbox"/> Urban Planning
<input type="checkbox"/> Prehistoric	<input type="checkbox"/> Engineering	<input type="checkbox"/> Religion/Philosophy	<input type="checkbox"/> Other (Specify)
<input type="checkbox"/> Historic	<input type="checkbox"/> Industry	<input type="checkbox"/> Science	_____
<input type="checkbox"/> Agriculture	<input type="checkbox"/> Invention	<input type="checkbox"/> Sculpture	_____
<input type="checkbox"/> Architecture	<input type="checkbox"/> Landscape Architecture	<input type="checkbox"/> Social/Humanitarian	_____
<input type="checkbox"/> Art	<input type="checkbox"/> Literature	<input type="checkbox"/> Theater	_____
<input checked="" type="checkbox"/> Commerce	<input type="checkbox"/> Military	<input type="checkbox"/> Transportation	_____
<input type="checkbox"/> Communications	<input type="checkbox"/> Music		_____
<input type="checkbox"/> Conservation			_____

STATEMENT OF SIGNIFICANCE

This old general store has now become an appliance center.

Behind the store is a small barn frame with vertical siding.

A hand pump beside the store is housed in a small frame shingle "house". (Undoubtedly there was a public watering trough here 50 years ago)

SEE INSTRUCTIONS

HO-252

9. MAJOR BIBLIOGRAPHICAL REFERENCES

10. GEOGRAPHICAL DATA

LATITUDE AND LONGITUDE COORDINATES DEFINING A RECTANGLE LOCATING THE PROPERTY			O R	LATITUDE AND LONGITUDE COORDINATES DEFINING THE CENTER POINT OF A PROPERTY OF LESS THAN TEN ACRES		
CORNER	LATITUDE	LONGITUDE		LATITUDE	LONGITUDE	
	Degrees Minutes Seconds	Degrees Minutes Seconds		Degrees Minutes Seconds	Degrees Minutes Seconds	
NW	° ' "	° ' "		° ' "	° ' "	
NE	° ' "	° ' "		° ' "	° ' "	
SE	° ' "	° ' "		° ' "	° ' "	
SW	° ' "	° ' "		° ' "	° ' "	

APPROXIMATE ACREAGE OF NOMINATED PROPERTY:

Acreage Justification:

LIST ALL STATES AND COUNTIES FOR PROPERTIES OVERLAPPING STATE OR COUNTY BOUNDARIES

STATE:		COUNTY:	
STATE:		COUNTY:	
STATE:		COUNTY:	
STATE:		COUNTY:	

SEE INSTRUCTIONS

11. FORM PREPARED BY

NAME AND TITLE: **JEAN S. EWING**

ORGANIZATION: **MARYLAND HISTORICAL TRUST** DATE: _____

STREET AND NUMBER: **2525 RIVA ROAD**

CITY OR TOWN: **ANNAPOLIS** STATE: **MARYLAND**

12. State Liaison Officer Review: (Office Use Only)

Significance of this property is:
 National State Local

 Signature

(211.53') 196.53'

I.P.

J. Doherty, situate on the section of Md. Route #94, in Florence, in the 4th County, Maryland.

Scale: 1" = 20'

Survey Koller, L. S. No. 250

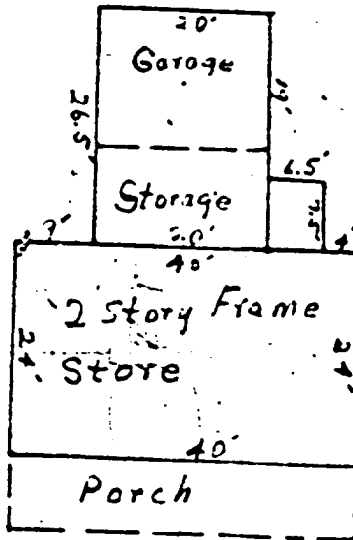
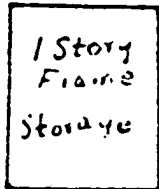

Schaferville - Forence Road

N. 45° W.

191.4'

N. 45° W.

171.5'

Received for record Dec 21 1964 at 2 o'clock P.M. Same day recorded and examined per W. Harvey Hill, Clerk

RR. Spike

N. 64° 45' E.

67'

RR. Spike

N. 41° E.

117.48'

32.3'

RR. Spike

to Lisbon Road

Attachment 4
HO-252
The Old Florence Store
Plat of Property,
Dec, 1964



le
1
2
3
4
5
6
7
8
9
10
11
12
13
14
15
16
17
18
19
20
21
22
23
24
25
26
27
28
29
30
31
32
33
34
35
36
37
38
39
40
41
42
43
44
45
46
47
48
49
50
51
52
53
54
55
56
57
58
59
60
61
62
63
64
65
66
67
68
69
70
71
72
73
74
75
76
77
78
79
80
81
82
83
84
85
86
87
88
89
90
91
92
93
94
95
96
97
98
99
100

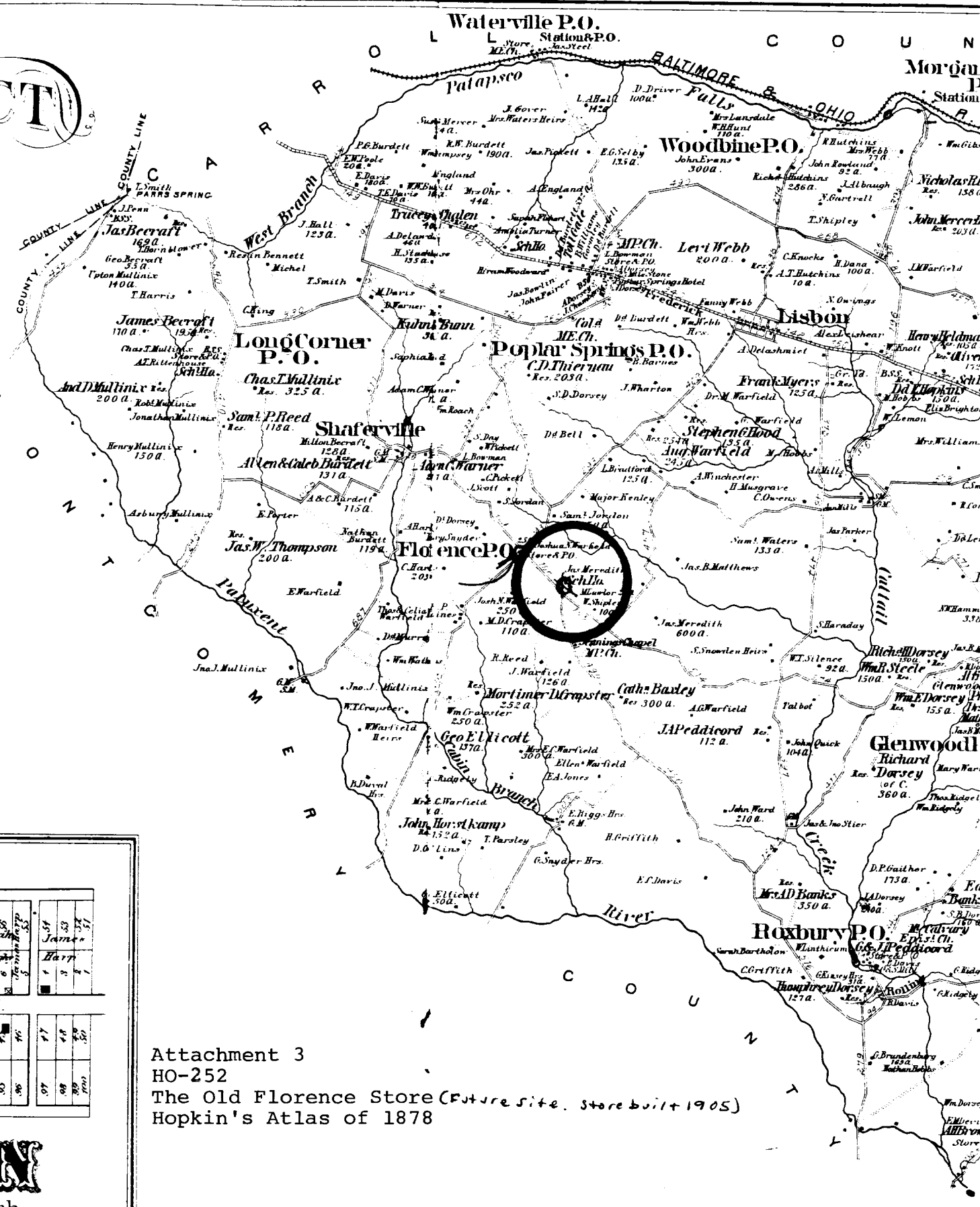

01	02	03	04	05	06	07	08	09	10	11	12	13	14	15	16	17	18	19	20	21	22	23	24	25	26	27	28	29	30	31	32	33	34	35	36	37	38	39	40	41	42	43	44	45	46	47	48	49	50	51	52	53	54	55	56	57	58	59	60	61	62	63	64	65	66	67	68	69	70	71	72	73	74	75	76	77	78	79	80	81	82	83	84	85	86	87	88	89	90	91	92	93	94	95	96	97	98	99	100
----	----	----	----	----	----	----	----	----	----	----	----	----	----	----	----	----	----	----	----	----	----	----	----	----	----	----	----	----	----	----	----	----	----	----	----	----	----	----	----	----	----	----	----	----	----	----	----	----	----	----	----	----	----	----	----	----	----	----	----	----	----	----	----	----	----	----	----	----	----	----	----	----	----	----	----	----	----	----	----	----	----	----	----	----	----	----	----	----	----	----	----	----	----	----	----	----	----	----	-----

Attachment 3
 HO-252
 The Old Florence Store (Future site. store built 1905)
 Hopkin's Atlas of 1878



feet per Inch

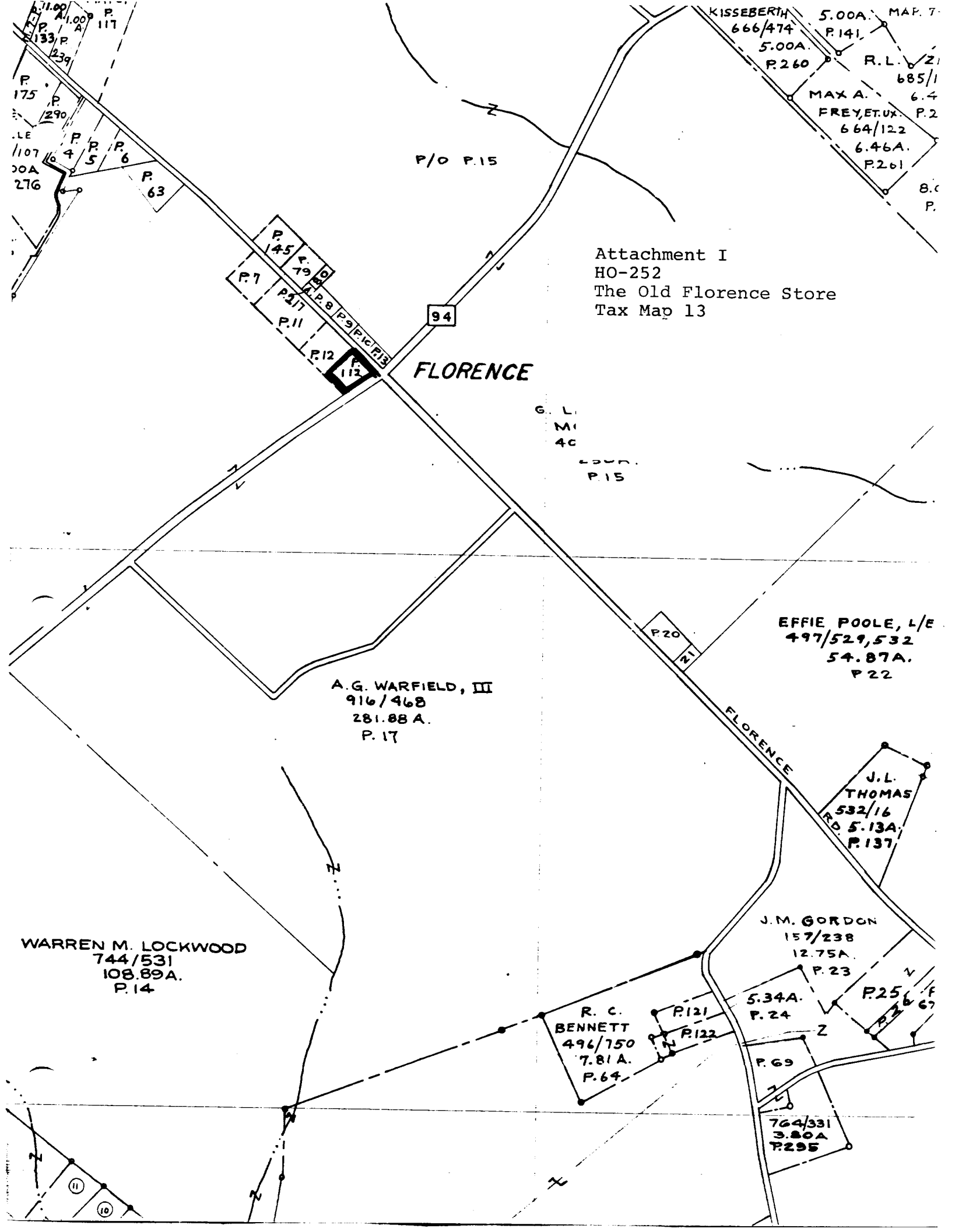

P. 117
11.00 A. 1.00
P. 133/P. 239
P. 175
P. 290
P. 4
P. 5
P. 6
P. 63
P. 107
P. 276

KISSEBERTH
666/474
5.00A.
P.260
P.141
R.L. 21
685/1
MAX A. 6.4
FREY, ET. UX. P.2
664/122
6.46A.
P.261
B.C.
P.

P/O P.15

Attachment I
HO-252
The Old Florence Store
Tax Map 13

P. 145
P. 79
P. 10
P. 11
P. 12
P. 112
P. 13
P. 14
P. 15
P. 16
P. 17
P. 18
P. 19
P. 20
P. 21
P. 22
P. 23
P. 24
P. 25
P. 26
P. 27
P. 28
P. 29
P. 30
P. 31
P. 32
P. 33
P. 34
P. 35
P. 36
P. 37
P. 38
P. 39
P. 40
P. 41
P. 42
P. 43
P. 44
P. 45
P. 46
P. 47
P. 48
P. 49
P. 50
P. 51
P. 52
P. 53
P. 54
P. 55
P. 56
P. 57
P. 58
P. 59
P. 60
P. 61
P. 62
P. 63
P. 64
P. 65
P. 66
P. 67
P. 68
P. 69
P. 70
P. 71
P. 72
P. 73
P. 74
P. 75
P. 76
P. 77
P. 78
P. 79
P. 80
P. 81
P. 82
P. 83
P. 84
P. 85
P. 86
P. 87
P. 88
P. 89
P. 90
P. 91
P. 92
P. 93
P. 94
P. 95
P. 96
P. 97
P. 98
P. 99
P. 100

94

FLORENCE

G. L.
M.
40
P.15

A. G. WARFIELD, III
916/468
281.88 A.
P. 17

EFFIE POOLE, L/E
497/529,532
54.87A.
P.22

J. L. THOMAS
532/16
P. 5.13A.
P.137

WARREN M. LOCKWOOD
744/531
108.89A.
P.14

J. M. GORDON
157/238
12.75A.
P.23

R. C. BENNETT
496/750
7.81A.
P.64

5.34A.
P.24

P.69

764/331
3.80A
P.295

P.25
P.26
P.27
P.28
P.29
P.30
P.31
P.32
P.33
P.34
P.35
P.36
P.37
P.38
P.39
P.40
P.41
P.42
P.43
P.44
P.45
P.46
P.47
P.48
P.49
P.50
P.51
P.52
P.53
P.54
P.55
P.56
P.57
P.58
P.59
P.60
P.61
P.62
P.63
P.64
P.65
P.66
P.67
P.68
P.69
P.70
P.71
P.72
P.73
P.74
P.75
P.76
P.77
P.78
P.79
P.80
P.81
P.82
P.83
P.84
P.85
P.86
P.87
P.88
P.89
P.90
P.91
P.92
P.93
P.94
P.95
P.96
P.97
P.98
P.99
P.100



Attachment 2
HO 252
The Old Florence Store
U. S. Geological Survey Map
Woodbine Quadrangle





H0252c

Pemb at

Store, Florence

MSB 8/73

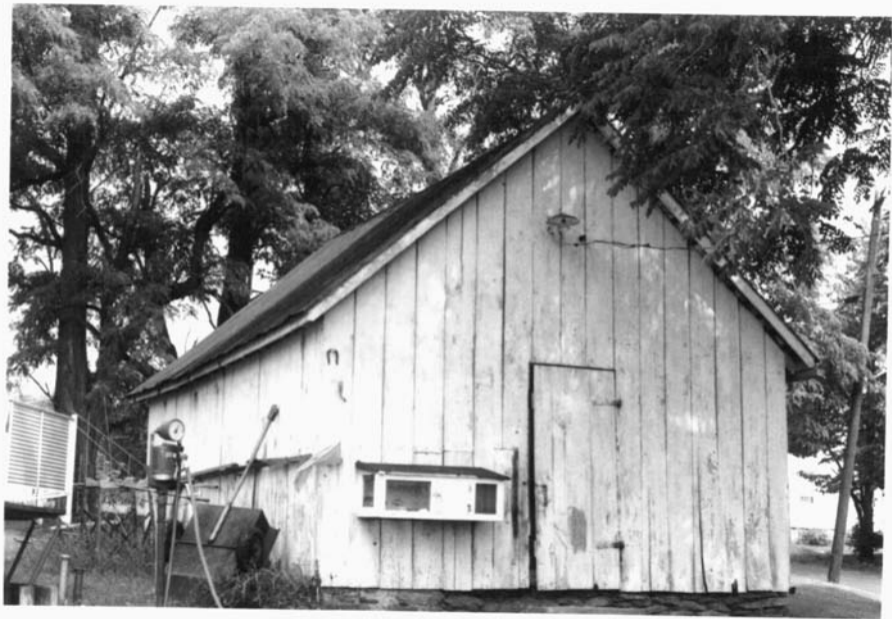

H0252_B

P. T. Ave. Florence JSE 8/72

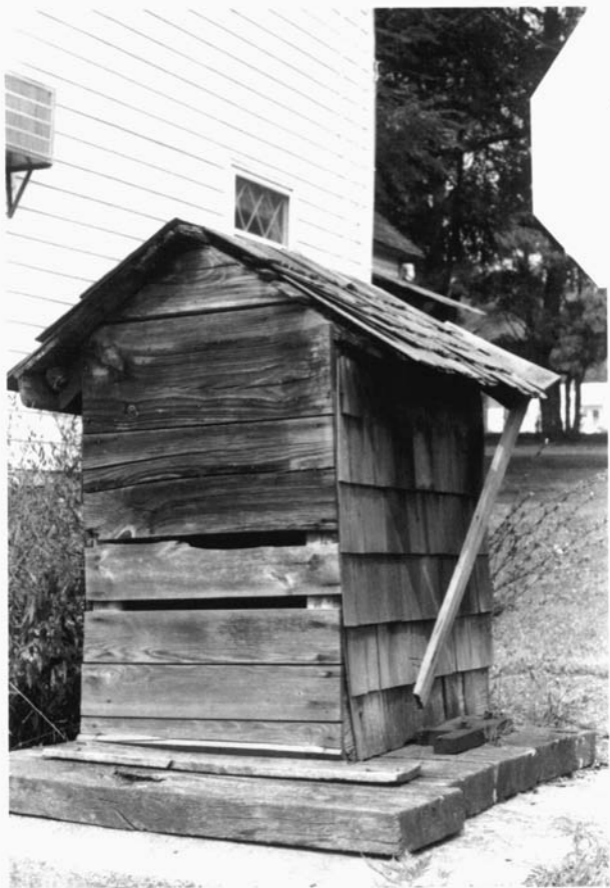

HO 252 A

Geo Florence H.E. 8/73



Name: HO-252
The Old Florence Store
Location: 2685 Daisy Road
Woodbine, Maryland
Photographer: Cleora B. Thompson, A.I.C.P.
Date of Photograph: May, 1980
Negatives in possession of the Maryland Historical Trust
View: West
Photographer looking: East
Photograph number: 1 of 1