

Ho-221
Mill House/Upper Baltimore St.
Savage
Private

Circa 1917

Facing south on the northeast corner of Baltimore and Fair Streets, this four bay wide, four bay deep shed roofed mill house is representative of ten duplexes constructed on the north and south sides of Baltimore Street between Commerce and Fair Streets in the first quarter of the twentieth century.

The south facade of this house has been considerably altered, its two front entrances becoming additional windows and the brick stoops on this elevation removed. The south windows are all decorated by shutters. A shed roofed covered rectangular entrance is located on Fair Street, facing west.

MARYLAND HISTORICAL TRUST

HO-221
Distr. 6

INVENTORY FORM FOR STATE HISTORIC SITES SURVEY

MAGI # 1402215604

1 NAME

HISTORIC Mill Houses - Upper Baltimore Street

AND/OR COMMON The Hutchinson - Hobbs House

2 LOCATION

STREET & NUMBER 9132 - 36 Baltimore Street

CITY, TOWN Savage VICINITY OF CONGRESSIONAL DISTRICT 6th
STATE Maryland COUNTY Howard

3 CLASSIFICATION

CATEGORY	OWNERSHIP	STATUS	PRESENT USE	
<input checked="" type="checkbox"/> DISTRICT	<input type="checkbox"/> PUBLIC	<input checked="" type="checkbox"/> OCCUPIED	<input type="checkbox"/> AGRICULTURE	<input type="checkbox"/> MUSEUM
<input type="checkbox"/> BUILDING(S)	<input checked="" type="checkbox"/> PRIVATE	<input type="checkbox"/> UNOCCUPIED	<input type="checkbox"/> COMMERCIAL	<input type="checkbox"/> PARK
<input type="checkbox"/> STRUCTURE	<input type="checkbox"/> BOTH	<input type="checkbox"/> WORK IN PROGRESS	<input type="checkbox"/> EDUCATIONAL	<input checked="" type="checkbox"/> PRIVATE RESIDENCE
<input type="checkbox"/> SITE	PUBLIC ACQUISITION	<input checked="" type="checkbox"/> ACCESSIBLE	<input type="checkbox"/> ENTERTAINMENT	<input type="checkbox"/> RELIGIOUS
<input type="checkbox"/> OBJECT	<input type="checkbox"/> IN PROCESS	<input type="checkbox"/> YES RESTRICTED	<input type="checkbox"/> GOVERNMENT	<input type="checkbox"/> SCIENTIFIC
	<input type="checkbox"/> BEING CONSIDERED	<input type="checkbox"/> YES UNRESTRICTED	<input type="checkbox"/> INDUSTRIAL	<input type="checkbox"/> TRANSPORTATION
		<input type="checkbox"/> NO	<input type="checkbox"/> MILITARY	<input type="checkbox"/> OTHER

4 OWNER OF PROPERTY

NAME Mr. and Mrs. Bourough Storch Telephone #: 792-0393

STREET & NUMBER 8930 Baltimore St.

CITY, TOWN Savage, VICINITY OF Maryland, STATE, zip code 20883

5 LOCATION OF LEGAL DESCRIPTION

COURTHOUSE, Tax Map 47 p. 406
REGISTRY OF DEEDS, ETC. Hall of Records

Liber #: 391
Folio #: 232

STREET & NUMBER Howard County Court House

CITY, TOWN Ellicott City STATE Maryland

6 REPRESENTATION IN EXISTING SURVEYS

TITLE National Register of Historic Places
Nomination form for Savage Mill Historic District

DATE September 1973 FEDERAL STATE COUNTY LOCAL

DEPOSITORY FOR Office of Archeology and Historic
SURVEY RECORDS Preservation NPS

CITY, TOWN Washington STATE D.C.

7 DESCRIPTION

CONDITION		CHECK ONE	CHECK ONE
<input checked="" type="checkbox"/> EXCELLENT	<input type="checkbox"/> DETERIORATED	<input type="checkbox"/> UNALTERED	<input checked="" type="checkbox"/> ORIGINAL SITE
<input type="checkbox"/> GOOD	<input type="checkbox"/> RUINS	<input checked="" type="checkbox"/> ALTERED	<input type="checkbox"/> MOVED DATE _____
<input type="checkbox"/> FAIR	<input type="checkbox"/> UNEXPOSED		

DESCRIBE THE PRESENT AND ORIGINAL (IF KNOWN) PHYSICAL APPEARANCE

This mill house is located in the Savage Historic District on the north east corner of Fair and Baltimore Streets with an entrance in the rear of the building which faces south on Baltimore Street. It is a four bay wide, four bay deep, two story high, shed roofed brick (laid in English garden wall brick bond) structure with plain, unornamented wooden cornice and narrow stove chimneys. The south elevation of this house has been altered, eliminating the original entrances and now holding four first and second floor rectangular, double-hung windows with six-over-six lights decorated with flat sills and flat arched stretcher brick lintels.

The entrance facing west on Fair Street is located in a rear appendage on the north wall of the house, originally designed as a duplex.

PERIOD		AREAS OF SIGNIFICANCE -- CHECK AND JUSTIFY BELOW			
<input type="checkbox"/> PREHISTORIC	<input type="checkbox"/> ARCHEOLOGY-PREHISTORIC	<input checked="" type="checkbox"/> COMMUNITY PLANNING	<input type="checkbox"/> LANDSCAPE ARCHITECTURE	<input type="checkbox"/> RELIGION	
<input type="checkbox"/> 1400-1499	<input checked="" type="checkbox"/> ARCHEOLOGY-HISTORIC	<input type="checkbox"/> CONSERVATION	<input type="checkbox"/> LAW	<input type="checkbox"/> SCIENCE	
<input type="checkbox"/> 1500-1599	<input type="checkbox"/> AGRICULTURE	<input type="checkbox"/> ECONOMICS	<input type="checkbox"/> LITERATURE	<input type="checkbox"/> SCULPTURE	
<input type="checkbox"/> 1600-1699	<input checked="" type="checkbox"/> ARCHITECTURE	<input type="checkbox"/> EDUCATION	<input type="checkbox"/> MILITARY	<input type="checkbox"/> SOCIAL/HUMANITARIAN	
<input type="checkbox"/> 1700-1799	<input type="checkbox"/> ART	<input type="checkbox"/> ENGINEERING	<input type="checkbox"/> MUSIC	<input type="checkbox"/> THEATER	
<input type="checkbox"/> 1800-1899	<input type="checkbox"/> COMMERCE	<input type="checkbox"/> EXPLORATION/SETTLEMENT	<input type="checkbox"/> PHILOSOPHY	<input type="checkbox"/> TRANSPORTATION	
<input type="checkbox"/> 1900-	<input type="checkbox"/> COMMUNICATIONS	<input checked="" type="checkbox"/> INDUSTRY	<input type="checkbox"/> POLITICS/GOVERNMENT	<input type="checkbox"/> OTHER (SPECIFY)	
		<input type="checkbox"/> INVENTION			

SPECIFIC DATES Circa 1917 BUILDER/ARCHITECT

STATEMENT OF SIGNIFICANCE

Please see significant statements for Ho-215, Ho-216, Ho-221, Ho-223, Ho-224 and Ho-225, dealing with earlier mill houses in the Savage Historic District.

This house, though altered, is similar to those other nine two story brick houses located on Baltimore Street, between Church and Fair Streets, in the Savage Historic District, which contain two units each. This house has been altered to create a more pleasing facade with four first and second floor windows decorated with shutters, rather than two first floor windows and two entrances located one on each end.

These units do not appear on the Hopkins Atlas of 1878 and are believed to date from the first quarter of the twentieth century.

9 MAJOR BIBLIOGRAPHICAL REFERENCES

Interview with Mr. William Reeley, Vice-President and Manager of the Savage Manufacturing Company, 1935-1947. Howard County Land Records Filbey, Vera. Savage, Maryland. Savage, 1965
Savage Historic District Nomination Form for the National Register

CONTINUE ON SEPARATE SHEET IF NECESSARY

10 GEOGRAPHICAL DATA

ACREAGE OF NOMINATED PROPERTY _____

Please see attachment I,
Tax Map 47, p.406
(Lots 2,4 and Imp)

VERBAL BOUNDARY DESCRIPTION

Please see Howard County
Land Records
Liber 391, Folio 232

LIST ALL STATES AND COUNTIES FOR PROPERTIES OVERLAPPING STATE OR COUNTY BOUNDARIES

STATE Maryland COUNTY Howard

STATE COUNTY

11 FORM PREPARED BY

NAME / TITLE

Cleora Barnes Thompson, Archivist

ORGANIZATION

Office of Planning & Zoning-Comprehensive Planning Section 465-5000 x257

DATE

STREET & NUMBER

3450 Court House Drive

TELEPHONE

CITY OR TOWN

Ellicott City

STATE

Maryland

The Maryland Historic Sites Inventory was officially created by an Act of the Maryland Legislature, to be found in the Annotated Code of Maryland, Article 41, Section 181 KA, 1974 Supplement.

The Survey and Inventory are being prepared for information and record purposes only and do not constitute any infringement of individual property rights.

RETURN TO: Maryland Historical Trust
The Shaw House, 21 State Circle
Annapolis, Maryland 21401
(301) 267-1438

HO. 221 1402215604

MD. HISTORICAL TRUST
BOX 1704
ANNAPOLIS, MD. 21404

NATIONAL REGISTER OF HISTORIC PLACES
INVENTORY - NOMINATION FORM

(Type all entries - complete applicable sections)

STATE:	
COUNTY:	
FOR NPS USE ONLY	
ENTRY NUMBER	DATE

1. NAME

COMMON: Hutchinson - Hobbs double house

AND/OR HISTORIC:

2. LOCATION

STREET AND NUMBER: 9132 - 9136 Baltimore Street

CITY OR TOWN: Savage

STATE: Md CODE: COUNTY: HOWARD CODE:

3. CLASSIFICATION

CATEGORY (Check One)	OWNERSHIP	STATUS	ACCESSIBLE TO THE PUBLIC
District <input type="checkbox"/> Building <input checked="" type="checkbox"/> Structure <input type="checkbox"/> Object <input type="checkbox"/>	Public <input type="checkbox"/> Private <input checked="" type="checkbox"/> Both <input type="checkbox"/>	Public Acquisition: <input type="checkbox"/> In Process <input type="checkbox"/> Being Considered <input type="checkbox"/>	Yes: <input checked="" type="checkbox"/> Restricted <input type="checkbox"/> Unrestricted <input type="checkbox"/> No: <input type="checkbox"/>
PRESENT USE (Check One or More as Appropriate)			
Agricultural <input type="checkbox"/> Commercial <input type="checkbox"/> Educational <input type="checkbox"/> Entertainment <input type="checkbox"/>	Government <input type="checkbox"/> Industrial <input type="checkbox"/> Military <input type="checkbox"/> Museum <input type="checkbox"/>	Park <input type="checkbox"/> Private Residence <input checked="" type="checkbox"/> Religious <input type="checkbox"/> Scientific <input type="checkbox"/>	Transportation <input type="checkbox"/> Comments <input type="checkbox"/> Other (Specify) <input type="checkbox"/> <u>Rental Housing</u>

4. OWNER OF PROPERTY

OWNERS NAME: 9132: Marjaret Hutchinson 9136: Hobbs

STREET AND NUMBER: Columbia, Md. 9136 Baltimore St Savage

CITY OR TOWN: STATE: Md CODE:

5. LOCATION OF LEGAL DESCRIPTION

COURTHOUSE, REGISTRY OF DEEDS, ETC:

STREET AND NUMBER:

CITY OR TOWN: STATE: CODE:

APPROXIMATE ACREAGE OF NOMINATED PROPERTY:

6. REPRESENTATION IN EXISTING SURVEYS

TITLE OF SURVEY:

DATE OF SURVEY: Federal State County Local

DEPOSITORY FOR SURVEY RECORDS:

STREET AND NUMBER:

CITY OR TOWN: STATE: CODE:

SEE INSTRUCTIONS

STATE: COUNTY: ENTRY NUMBER DATE FOR NPS USE ONLY

7. DESCRIPTION

CONDITION	(Check One)				
	Excellent <input type="checkbox"/>	Good <input checked="" type="checkbox"/>	Fair <input type="checkbox"/>	Deteriorated <input type="checkbox"/>	Ruins <input type="checkbox"/>
INTEGRITY	(Check One)			(Check One)	
	Altered <input type="checkbox"/>	Unaltered <input checked="" type="checkbox"/>	Moved <input type="checkbox"/>	Original Site <input checked="" type="checkbox"/>	

DESCRIBE THE PRESENT AND ORIGINAL (if known) PHYSICAL APPEARANCE

This double house of brick, painted, is 4 bays x 4 under a flat roof. Almost square, two stories high, it is one of ten similar houses built to house millworkers families.

SEE INSTRUCTIONS

8 SIGNIFICANCE

PERIOD (Check One or More as Appropriate)

Pre-Columbian 16th Century 18th Century 20th Century
 15th Century 17th Century 19th Century

SPECIFIC DATE(S) (If Applicable and Known)

AREAS OF SIGNIFICANCE (Check One or More as Appropriate)

Aboriginal	Education <input type="checkbox"/>	Political <input type="checkbox"/>	Urban Planning <input type="checkbox"/>
Prehistoric <input type="checkbox"/>	Engineering <input type="checkbox"/>	Religion/Phi-	Other (Specify) <input type="checkbox"/>
Historic <input type="checkbox"/>	Industry <input type="checkbox"/>	losophy <input type="checkbox"/>	_____
Agriculture <input type="checkbox"/>	Invention <input type="checkbox"/>	Science <input type="checkbox"/>	_____
Art <input type="checkbox"/>	Landscape <input type="checkbox"/>	Sculpture <input type="checkbox"/>	_____
Commerce <input type="checkbox"/>	Architecture <input type="checkbox"/>	Social/Human-	_____
Communications <input type="checkbox"/>	Literature <input type="checkbox"/>	itarian <input checked="" type="checkbox"/>	_____
Conservation <input type="checkbox"/>	Military <input type="checkbox"/>	Theater <input type="checkbox"/>	_____
	Music <input type="checkbox"/>	Transportation <input type="checkbox"/>	_____

STATEMENT OF SIGNIFICANCE (Include Personages, Dates, Events, Etc.)

This very plain little double house, once a mill-worker's home, has value beyond its own bricks and mortar because of the pleasant village atmosphere, with large lots and fine trees and an absolute lack of any but local ~~neighborhood~~ neighborhood traffic.

~~neighborhood~~

SEE INSTRUCTIONS

9. MAJOR BIBLIOGRAPHICAL REFERENCES

Empty box for major bibliographical references.

10. GEOGRAPHICAL DATA

LATITUDE AND LONGITUDE COORDINATES DEFINING A RECTANGLE LOCATING THE PROPERTY			O R	LATITUDE AND LONGITUDE COORDINATES DEFINING THE CENTER POINT OF A PROPERTY OF LESS THAN ONE ACRE		
CORNER	LATITUDE			LATITUDE		LONGITUDE
	Degrees	Minutes	Seconds	Degrees	Minutes	Seconds
NW	°	'	"	°	'	"
NE	°	'	"	°	'	"
SE	°	'	"	°	'	"
SW	°	'	"	°	'	"

LIST ALL STATES AND COUNTIES FOR PROPERTIES OVERLAPPING STATE OR COUNTY BOUNDARIES

STATE:	CODE	COUNTY	CODE
STATE:	CODE	COUNTY:	CODE
STATE:	CODE	COUNTY:	CODE
STATE:	CODE	COUNTY:	CODE

11. FORM PREPARED BY

NAME AND TITLE: **JEAN S. EWING**

ORGANIZATION: **MARYLAND HISTORICAL TRUST** DATE: _____

STREET AND NUMBER: **53 STATE CIRCLE**

CITY OR TOWN: **ANNAPOLIS** STATE: **MARYLAND** CODE: _____

12. STATE LIAISON OFFICER CERTIFICATION

As the designated State Liaison Officer for the National Historic Preservation Act of 1966 (Public Law 89-665), I hereby nominate this property for inclusion in the National Register and certify that it has been evaluated according to the criteria and procedures set forth by the National Park Service. The recommended level of significance of this nomination is:

National State Local

Name _____

Title _____

Date _____

NATIONAL REGISTER VERIFICATION

I hereby certify that this property is included in the National Register.

Chief, Office of Archeology and Historic Preservation

Date _____

ATTEST:

Keeper of The National Register

Date _____

SEE INSTRUCTIONS

SAVAGE PARK

HO-42
District Boundary

COMMERCIAL

FOUNDRY

STREET

BALTIMORE

★
220

221

223 224

FAIR

222

★ ★ ★ ★ ★
225

214

★
BALDWIN
COMMON

522

ST.

219

218

★

WASHINGTON

216

215

STREET

SAVAGE

WILLIAMS

STREET

★
217

★
213

RACE

SAVAGE

Scale, 1" = 200'

ROAD

BLVD.

Historic Monument
BOLLMAN TRUSS BRIDGE
HO 81

RAILROAD

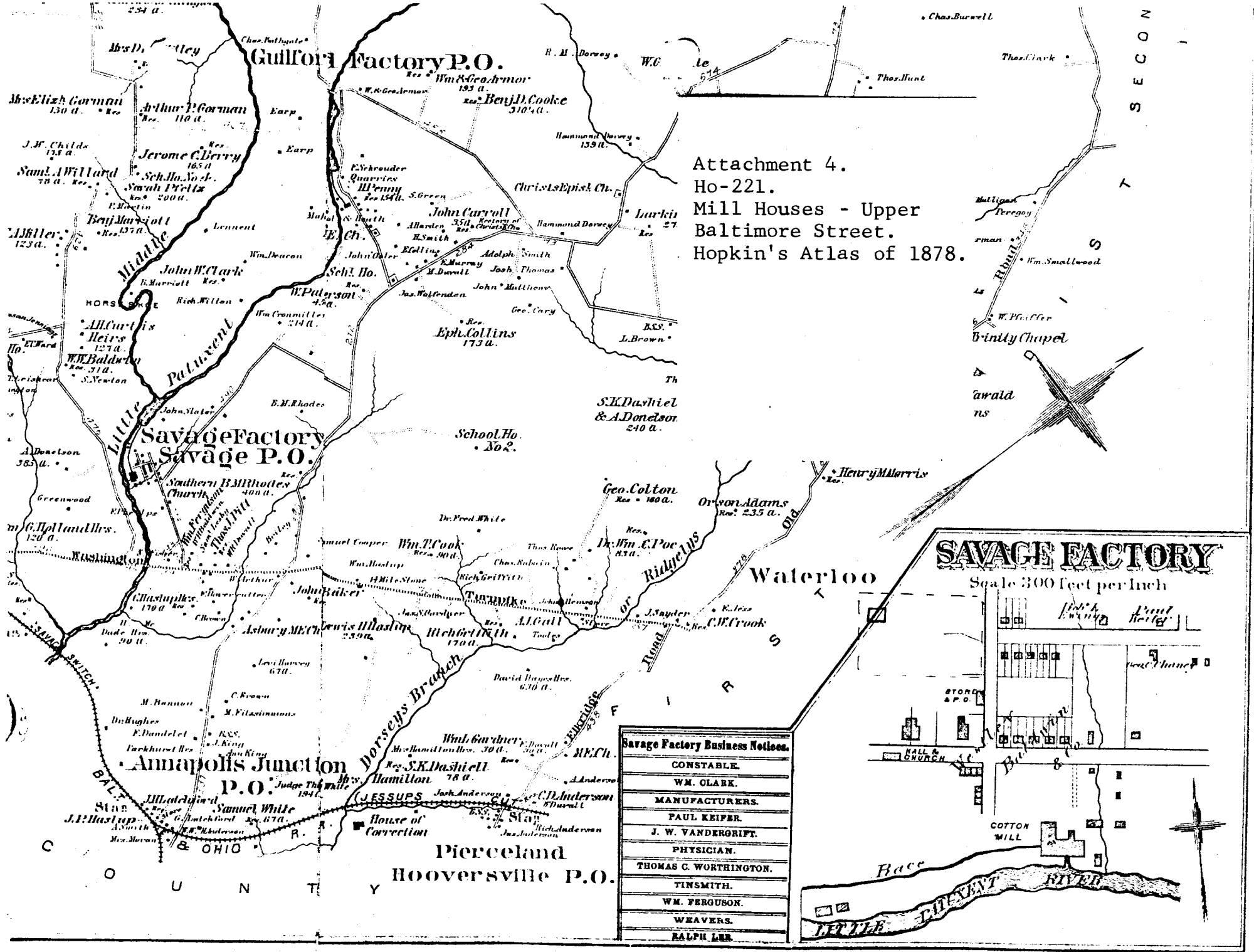

Attachment 4.
 Ho-221.
 Mill Houses - Upper
 Baltimore Street.
 Hopkin's Atlas of 1878.

- c. 1820 to 1879
- 1879 to 1940
- 1941 to

== Historic District Boundaries

SAVAGE HISTORIC DISTRICT
SAVAGE, MARYLAND

Attachment 3.
Ho-221
Mill Houses-Upper Baltimore Street
Savage Historic District
Map

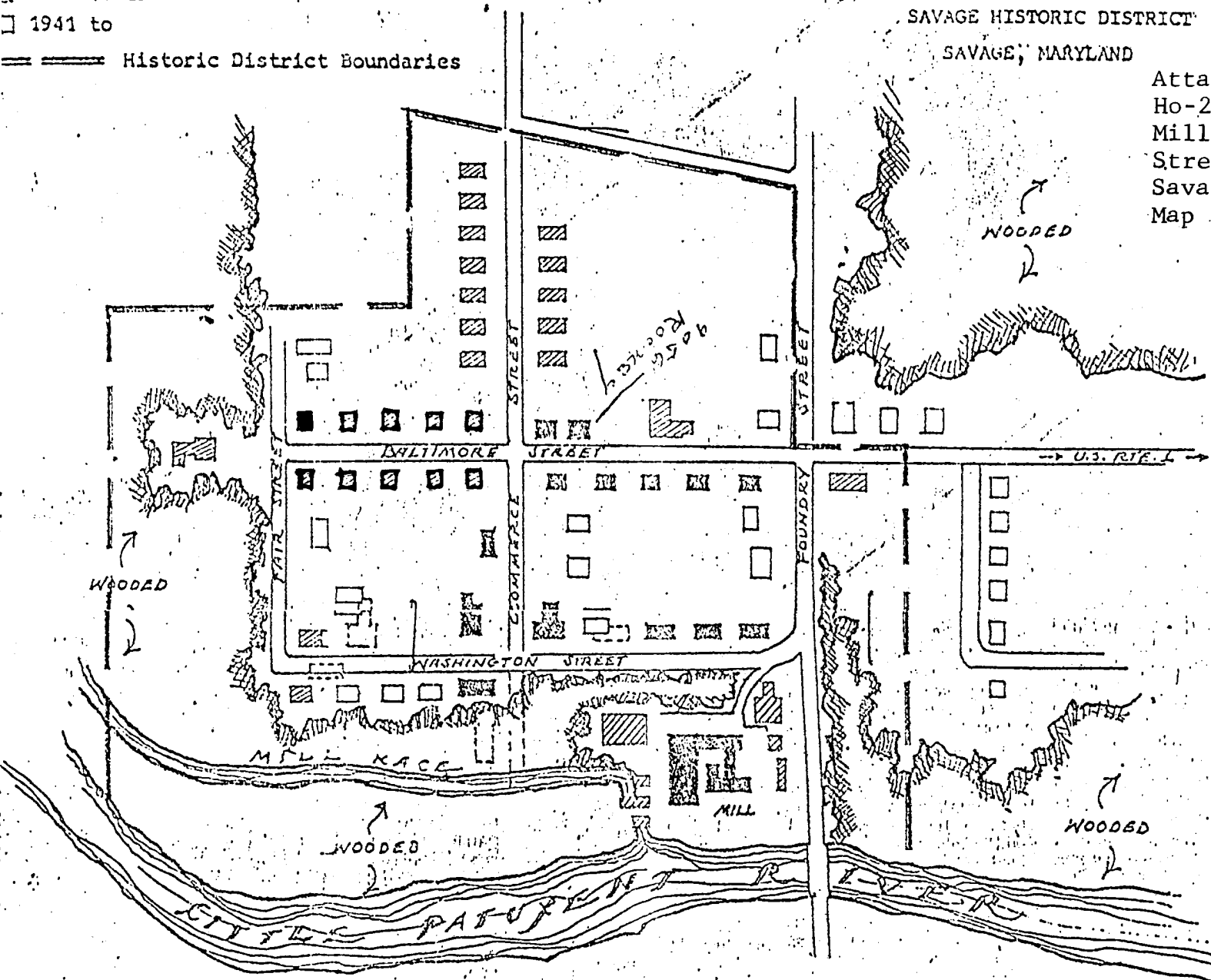

Handwritten initials 'SP' and a vertical line with an arrow pointing upwards.

J.R. Rivoire, 5/74. Not drawn to scale.

Savage Mill District Gets National Designation

The Maryland Historical Places. The district includes... money for maintenance and building of the natural center

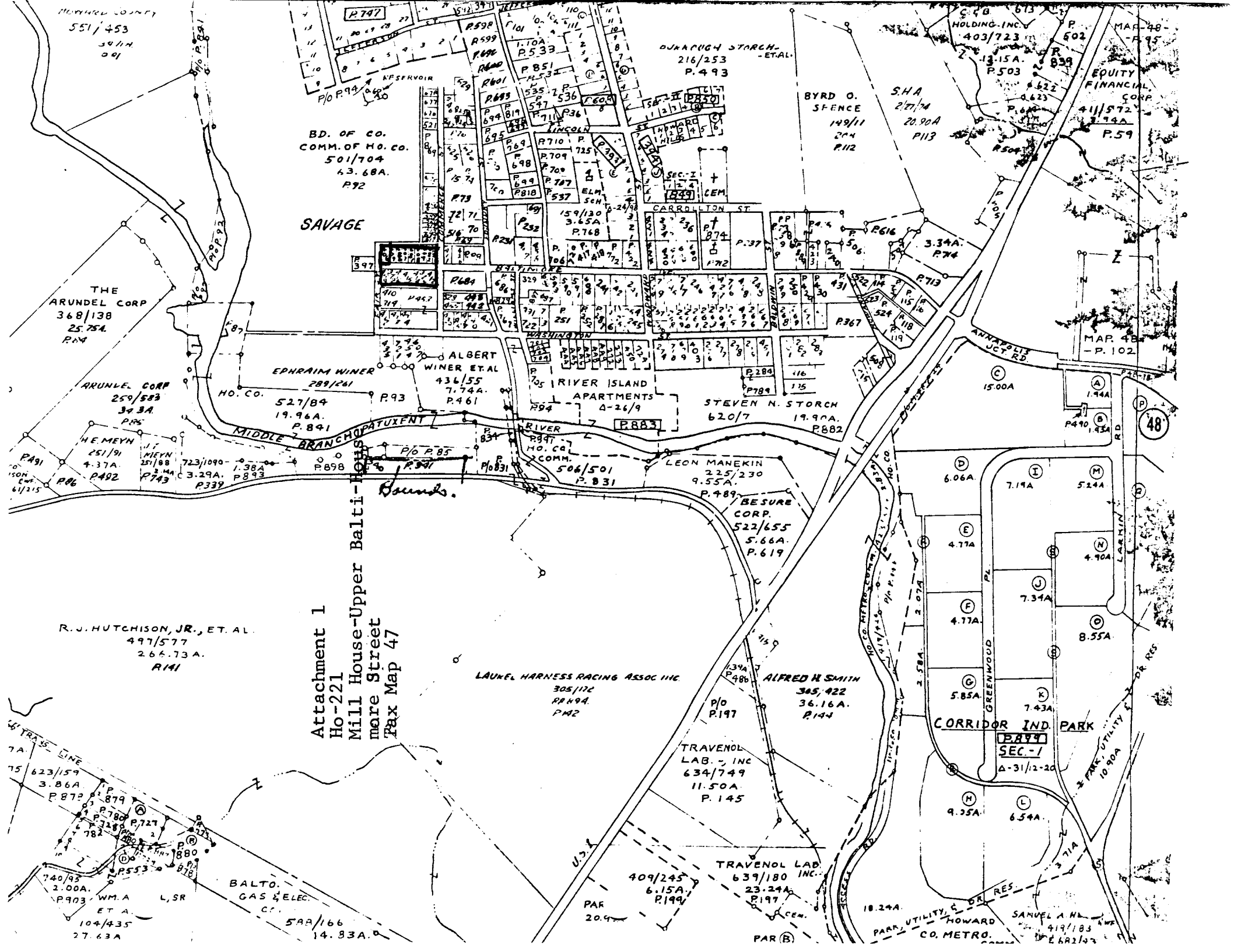

BD. OF CO.
COMM. OF HO. CO.
501/704
43.68A.
P.92

Savage

THE
ARUNDEL CORP
368/138
25.75A.
P.114

ARUNDEL CORP
259/583
34.3A.
P.115

H.E. MEYH
251/91
4.37A.
P.492

R. J. HUTCHISON, JR., ET AL.
497/577
266.73A.
P.141

Attachment 1
Ho-221
Mill House-Upper Balti-Ho
more Street
Tax Map 47

LAUREL HARNES RACING ASSOC INC.
305/172
P.142

BESURE
CORP.
522/655
5.66A.
P.619

TRAVENOL
LAB., INC
634/749
11.50A.
P.145

TRAVENOL LAB.
639/180 INC.
23.24A.
P.197

W.M.A
ET A.
104/435
27.63A

BALTO.
GAS & ELEC.
CI.

588/166
14.83A.

CORRIDOR IND. PARK

SEC-1
A-31/12-20

9.25A
6.54A.

PAR (B)

PAR (A)

48

SAVAGE QUADRANGLE
USGS 7.5 minute map
scale: 1: 24,000
1957

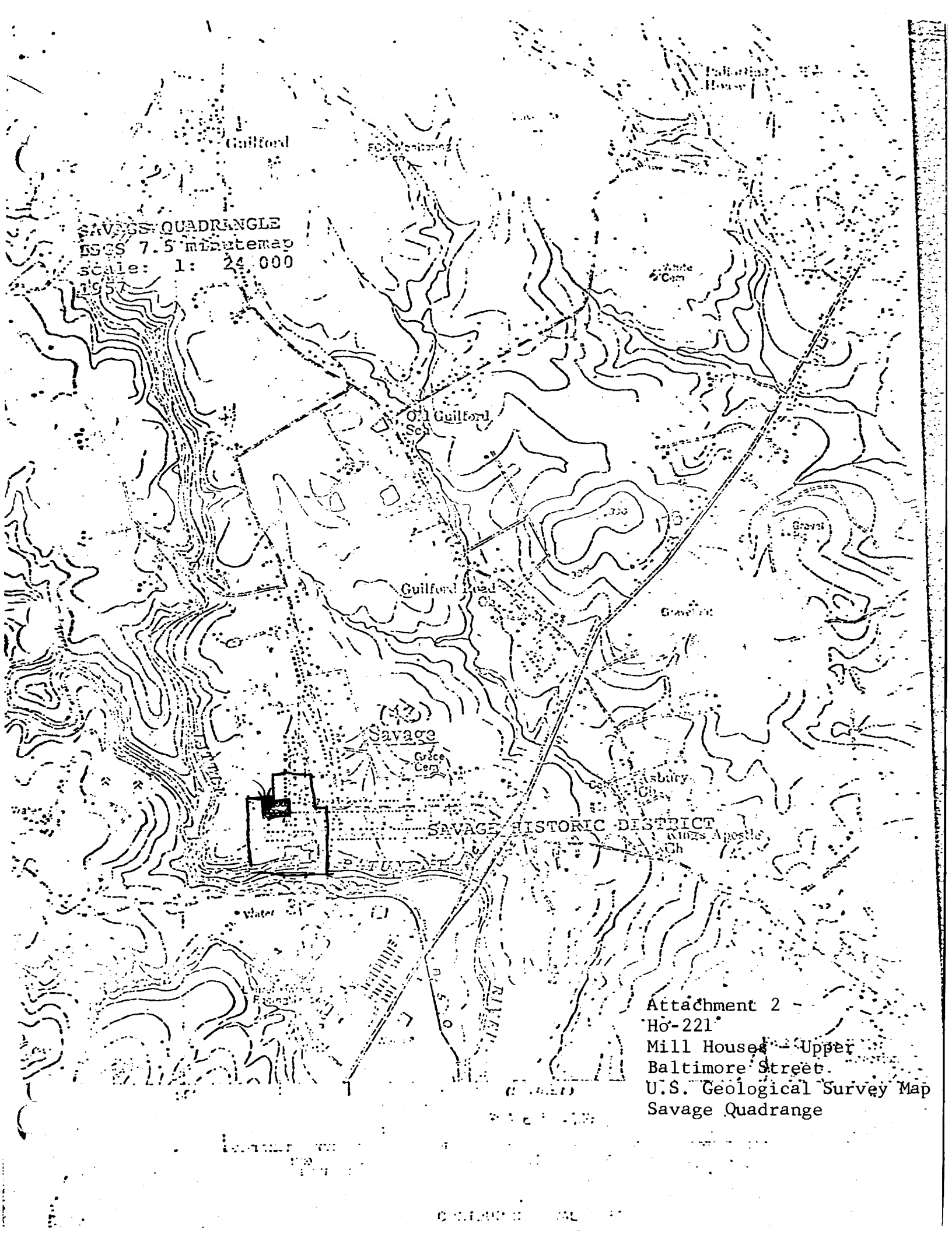

Attachment 2
Ho-221
Mill Houses - Upper
Baltimore Street
U.S. Geological Survey Map
Savage Quadrangle



Ho 221

Hutchinson - Hobbs double house, Savage

KS 11/72





Savage Hist. Det.

S. Side Baltimore St. West of
 intersection of Baltimore and Howard St.

1870-1880



Hb-221
OLD MILL HOUSE
9132-36 BALTIMORE ST
(SOUTH WEST)
CHEORA THOMPSON, AID
NOVEMBER, 1977