

Ho-219  
Masonic Hall  
Savage  
Private

1897

The Masonic Hall stands at the northwest corner of Washington and Fair Streets facing west. It is a three bay wide, five bay deep, two story high, gabled roof (running east-west) brick structure with square brick exterior chimneys, whose tops are decorated with corbeled brick belt courses set into each side of its north and south elevations.

The building is Italianate in style with its scrolled, coupled brackets along the overhanging eaves, its round-headed windows with elaborate arched brick hood moldings and decorative horizontal brick belt courses. Entrances are located in the north bay of the west wall and the second east bay of the south wall. Circular windows are inset into the "A" of the gabled roof decorated with lintels similar to those decorating windows and entrances.

Constructed in 1897 by the Savage Manufacturing Company to serve the social needs of the Savage Mill Village, it served as a community hall, hosting various dinners and gatherings of various kinds. For years Solomon's Lodge No. 12 rented the second floor as a Masonic Temple Room and circa 1950, after the sale of the Savage Mill to Mr. Winer, bought the property. In 1971 a general renovation of the Temple Room was undertaken in memory of the late State Senator, Dr. Frank Shipley, who served for many years as company doctor for the Savage Mill.

INVENTORY FORM FOR STATE HISTORIC SITES SURVEY MAGI # 1402195610

**1 NAME**

HISTORIC

Solomon's Lodge #121 AF.-A.M.

AND/OR COMMON

Masonic Hall

**2 LOCATION**

STREET & NUMBER

2,4 Washington Ave.

CITY, TOWN

Savage

--- VICINITY OF

CONGRESSIONAL DISTRICT

6th Cong. District

STATE

Maryland

20863

COUNTY

Howard

**3 CLASSIFICATION**

CATEGORY	OWNERSHIP	STATUS	PRESENT USE
<input checked="" type="checkbox"/> DISTRICT	<input type="checkbox"/> PUBLIC	<input checked="" type="checkbox"/> OCCUPIED	<input type="checkbox"/> AGRICULTURE <input type="checkbox"/> MUSEUM
<input type="checkbox"/> BUILDING(S)	<input checked="" type="checkbox"/> PRIVATE	<input type="checkbox"/> UNOCCUPIED	<input type="checkbox"/> COMMERCIAL <input type="checkbox"/> PARK
<input type="checkbox"/> STRUCTURE	<input type="checkbox"/> BOTH	<input type="checkbox"/> WORK IN PROGRESS	<input type="checkbox"/> EDUCATIONAL <input type="checkbox"/> PRIVATE RESIDENCE
<input type="checkbox"/> SITE	<b>PUBLIC ACQUISITION</b>	<b>ACCESSIBLE</b>	<input type="checkbox"/> ENTERTAINMENT <input type="checkbox"/> RELIGIOUS
<input type="checkbox"/> OBJECT	<input type="checkbox"/> IN PROCESS	<input checked="" type="checkbox"/> YES RESTRICTED	<input type="checkbox"/> GOVERNMENT <input type="checkbox"/> SCIENTIFIC
	<input type="checkbox"/> BEING CONSIDERED	<input type="checkbox"/> YES UNRESTRICTED	<input type="checkbox"/> INDUSTRIAL <input type="checkbox"/> TRANSPORTATION
		<input type="checkbox"/> NO	<input checked="" type="checkbox"/> OTHER <b>Masonic Hall</b>

**4 OWNER OF PROPERTY**

NAME

Solomon's Lodge #121 A.F. & A.M.

Telephone #:

STREET & NUMBER

c/o Edward E. Stiegler, Secy. Box 18-B

CITY, TOWN

Jessup

--- VICINITY OF

STATE, zip code

Maryland 20794

**5 LOCATION OF LEGAL DESCRIPTION**

COURTHOUSE,  
REGISTRY OF DEEDS, ETC.

Hall of Records Tax Map 47  
p. 432

Liber #: 724

Folio #: 117

STREET & NUMBER

Howard County Court House

CITY, TOWN

Ellicott City

STATE

Maryland

**6 REPRESENTATION IN EXISTING SURVEYS**

TITLE National Register of Historic Places

Nomination form for Savage Mill Historic District

DATE

September 1973

FEDERAL  STATE  COUNTY  LOCAL

DEPOSITORY FOR  
SURVEY RECORDS

Office of Archeology and Historic  
Preservation NPS

CITY, TOWN

Washington

STATE

D.C.

**7 DESCRIPTION**

CONDITION		CHECK ONE	CHECK ONE
<input checked="" type="checkbox"/> EXCELLENT	<input type="checkbox"/> DETERIORATED	<input type="checkbox"/> UNALTERED	<input type="checkbox"/> ORIGINAL SITE
<input type="checkbox"/> GOOD	<input type="checkbox"/> RUINS	<input checked="" type="checkbox"/> ALTERED	<input type="checkbox"/> MOVED DATE <u>1897</u>
<input type="checkbox"/> FAIR	<input type="checkbox"/> UNEXPOSED		

DESCRIBE THE PRESENT AND ORIGINAL (IF KNOWN) PHYSICAL APPEARANCE

The Masonic Hall stands at the northwest corner of Washington and Fair Streets facing west on Fair Street. It is a three bay wide, five bay deep, two story high, gabled roof (running east-west) brick structure (with square brick exterior chimneys, whose tops are decorated with corbeled brick belt courses set into each side of its north and south walls.

The building is Italianate in style with its scrolled, coupled brackets along the overhanging eaves, its round-headed windows with elaborate arched brick hood moldings and decorative horizontal brick belt courses. Almost all the hood moldings or projecting arched brick lintels are composed of alternate rows of stretcher brick with header bricks, giving a three dimensional effect. Fenestration is proportionally scaled and vertically aligned. Originally the windows were double-hung with four-over-four lights. One such window remains on the front facade facing west on Fair Street, in the second floor south bay. Most are filled in with vented wooden slats.

Entrances are located in the north bay of the west elevation and in the second east bay of the south elevation.

The east and west elevations hold circular windows centered into the A line of the gabled roof decorated with the similar projecting lintel of the arched windows. On the west wall beneath this circular window and between the two second floor windows is a arched, almost squarish plate on which is inscribed the masonic emblem G . It is decorated with a lintel similar to the others.

On the north wall of the building rests a one story high shed roofed addition.

The interior first floor holds a dining room and kitchen, while the Temple Room for the Masons takes up the second floor. It was redecorated in 1971 as a memorial to Dr. Frank E. Shipley.

PERIOD		AREAS OF SIGNIFICANCE -- CHECK AND JUSTIFY BELOW			
<input type="checkbox"/> PREHISTORIC	<input type="checkbox"/> ARCHEOLOGY-PREHISTORIC	<input checked="" type="checkbox"/> COMMUNITY PLANNING	<input type="checkbox"/> LANDSCAPE ARCHITECTURE	<input type="checkbox"/> RELIGION	
<input type="checkbox"/> 1400-1499	<input checked="" type="checkbox"/> ARCHEOLOGY-HISTORIC	<input type="checkbox"/> CONSERVATION	<input type="checkbox"/> LAW	<input type="checkbox"/> SCIENCE	
<input type="checkbox"/> 1500-1599	<input type="checkbox"/> AGRICULTURE	<input type="checkbox"/> ECONOMICS	<input type="checkbox"/> LITERATURE	<input type="checkbox"/> SCULPTURE	
<input type="checkbox"/> 1600-1699	<input checked="" type="checkbox"/> ARCHITECTURE	<input type="checkbox"/> EDUCATION	<input type="checkbox"/> MILITARY	<input type="checkbox"/> SOCIAL/HUMANITARIAN	
<input type="checkbox"/> 1700-1799	<input type="checkbox"/> ART	<input type="checkbox"/> ENGINEERING	<input type="checkbox"/> MUSIC	<input type="checkbox"/> THEATER	
<input checked="" type="checkbox"/> 1800-1899	<input type="checkbox"/> COMMERCE	<input type="checkbox"/> EXPLORATION/SETTLEMENT	<input type="checkbox"/> PHILOSOPHY	<input type="checkbox"/> TRANSPORTATION	
<input type="checkbox"/> 1900-	<input type="checkbox"/> COMMUNICATIONS	<input checked="" type="checkbox"/> INDUSTRY	<input type="checkbox"/> POLITICS/GOVERNMENT	<input type="checkbox"/> OTHER (SPECIFY)	
		<input type="checkbox"/> INVENTION			

SPECIFIC DATES 1897

BUILDER/ARCHITECT

STATEMENT OF SIGNIFICANCE

This building is significant historically. In 1897 The Savage Manufacturing Company built the Masonic Hall for community use, to hold dinners and gatherings of various kinds. For years there was a residence apartment on the first floor along with a small dining room and a Temple Room on the second floor. The Masonic Lodge paid rent for years to the Company for the use of this room. After the sale of the company to Mr. Winer in 1950, Solomon's Lodge #12 bought the building and in 1971 redecorated the Temple Room as a memorial to former State Senator, Dr. Frank E. Shipley.

Architecturally it is noteworthy for its fine decorative brick work and as an example of late nineteenth century architecture. The simplicity of the earlier mill houses afford a sharp contrast to this Italianate style structure, with its elaborate, coupled brackets along the overhanging eaves, its round-headed windows with elaborate anchored brick hood moldings and decorative exterior brick chimneys on its north and south elevations.

In the areas of community planning and industry it indicates an attempt by the company to serve the social needs of its village as well as their residential needs. During the 1890's workers received 5¢-10¢ an hour and worked some 55 hours a week. A weaver was a trained craftsman and it behooved the company well after training such a person for some eighteen months to keep him at the plant. The training for the textile industry is a very specialized one and mills attempted to keep large families contented and serving long years after developing their skill. Homes were furnished by the mill with water from the mill race and in the late 1890's with the construction of this community hall the company attempted to meet some of the social needs of the community. Community planning was expanded from work and shelter to social intercourse and the need for social gatherings.

Located on the western boundary of the Savage Historic District, it serves as an architectural anchor to this section of the community.  
CONTINUE ON SEPARATE SHEET IF NECESSARY

**9 MAJOR BIBLIOGRAPHICAL REFERENCES**

Howard County Land Records  
National Register Nomination Form For Savage Historic District  
Filby, Vera. Savage, Maryland. Savage, 1965.

CONTINUE ON SEPARATE SHEET IF NECESSARY

**10 GEOGRAPHICAL DATA**

ACREAGE OF NOMINATED PROPERTY 0.23 Acres

Please see Attachment 1, Tax Map 47, p. 432.

VERBAL BOUNDARY DESCRIPTION

Please see Howard County Land Records Liber 724, Folio 117

LIST ALL STATES AND COUNTIES FOR PROPERTIES OVERLAPPING STATE OR COUNTY BOUNDARIES

STATE Maryland COUNTY Howard

STATE COUNTY

**11 FORM PREPARED BY**

NAME / TITLE

Cleora Barnes Thompson, Archivist

ORGANIZATION

Office of Planning & Zoning-Comprehensive Planning Section

DATE

STREET & NUMBER

3450 Court House Drive

TELEPHONE

465-5000 x257

CITY OR TOWN

Ellicott City

STATE

Maryland 21043

The Maryland Historic Sites Inventory was officially created by an Act of the Maryland Legislature, to be found in the Annotated Code of Maryland, Article 41, Section 181 KA, 1974 Supplement.

The Survey and Inventory are being prepared for information and record purposes only and do not constitute any infringement of individual property rights.

RETURN TO: Maryland Historical Trust  
The Shaw House, 21 State Circle  
Annapolis, Maryland 21401  
(301) 267-1438

HO 2191402195610

MD. HISTORICAL TRUST  
BOX 1704  
ANNAPOLIS, MD. 21404

NATIONAL REGISTER OF HISTORIC PLACES  
INVENTORY - NOMINATION FORM

(Type all entries - complete applicable sections)

STATE:	
COUNTY:	
FOR NPS USE ONLY	
ENTRY NUMBER	DATE

**1. NAME**

COMMON: Masonic Lodge

AND/OR HISTORIC:

**2. LOCATION**

STREET AND NUMBER: North east corner Washinton & Fair Streets

CITY OR TOWN: Savage

STATE: Md CODE: COUNTY: HOWARD CODE:

**3. CLASSIFICATION**

CATEGORY (Check One)	OWNERSHIP	STATUS	ACCESSIBLE TO THE PUBLIC
District <input type="checkbox"/> Building <input checked="" type="checkbox"/>	Public <input type="checkbox"/>	Occupied <input checked="" type="checkbox"/>	Yes: <input checked="" type="checkbox"/> Restricted <input type="checkbox"/>
Site <input type="checkbox"/> Structure <input type="checkbox"/>	Private <input checked="" type="checkbox"/>	Unoccupied <input type="checkbox"/>	Unrestricted <input type="checkbox"/>
Object <input type="checkbox"/>	Public Acquisition: <input type="checkbox"/>	Preservation work in progress <input type="checkbox"/>	No: <input type="checkbox"/>
	In Process <input type="checkbox"/>		
	Being Considered <input type="checkbox"/>		

PRESENT USE (Check One or More as Appropriate)

Agricultural <input type="checkbox"/>	Government <input type="checkbox"/>	Park <input type="checkbox"/>	Transportation <input type="checkbox"/>	Comments <input type="checkbox"/>
Commercial <input type="checkbox"/>	Industrial <input type="checkbox"/>	Private Residence <input type="checkbox"/>	Other (Specify) <input type="checkbox"/>	
Educational <input type="checkbox"/>	Military <input type="checkbox"/>	Religious <input type="checkbox"/>	<u>Masonic Hall</u>	
Entertainment <input type="checkbox"/>	Museum <input type="checkbox"/>	Scientific <input type="checkbox"/>		

**4. OWNER OF PROPERTY**

OWNERS NAME: Masonic Lodge Hall

STREET AND NUMBER: 9140 Washinton Street

CITY OR TOWN: Savage STATE: Md CODE:

**5. LOCATION OF LEGAL DESCRIPTION**

COURTHOUSE, REGISTRY OF DEEDS, ETC.: CLERK OF THE CIRCUIT COURT

STREET AND NUMBER: HARFORD COUNTY COURTHOUSE

CITY OR TOWN: BEL AIR STATE: MARYLAND CODE: 40 S. MAIN ST

APPROXIMATE ACREAGE OF NOMINATED PROPERTY:

**6. REPRESENTATION IN EXISTING SURVEYS**

TITLE OF SURVEY:

DATE OF SURVEY: Federal  State  County  Local

DEPOSITORY FOR SURVEY RECORDS:

STREET AND NUMBER:

CITY OR TOWN: STATE: CODE:

SEE INSTRUCTIONS

STATE: COUNTY: ENTRY NUMBER DATE FOR NPS USE ONLY

7. DESCRIPTION

CONDITION	(Check One)					
	Excellent <input type="checkbox"/>	Good <input checked="" type="checkbox"/>	Fair <input type="checkbox"/>	Deteriorated <input type="checkbox"/>	Ruins <input type="checkbox"/>	Unexposed <input type="checkbox"/>
INTEGRITY	(Check One)			(Check One)		
	Altered <input type="checkbox"/>	? <input checked="" type="checkbox"/>	Unaltered <input type="checkbox"/>	Moved <input type="checkbox"/>	Original Site <input checked="" type="checkbox"/>	

DESCRIBE THE PRESENT AND ORIGINAL (If known) PHYSICAL APPEARANCE

This brick hall, painted pale grey, is oblong, 5 bays by 2, ~~with~~ <sup>at</sup> high-ceilinged two-story structure. Windows on the second floor are larger than on the first suggesting that the meeting room is upstairs, offices below. Windows ~~have~~ <sup>4 lights over 4 are under</sup> ~~are~~ ~~with~~ ~~with~~ a dentelle pattern in the brick arch. The wide eaves have double brackets. Four chimneys rise along the side walls, 2 on each side, with flared or ballooning courses at the top. The roof ridge line runs east-west. There is an oval window under the peak at each end wall.

SEE INSTRUCTIONS

8. SIGNIFICANCE

PERIOD (Check One or More as Appropriate)

- Pre-Columbian
- 16th Century
- 18th Century
- 20th Century
- 15th Century
- 17th Century
- 19th Century

SPECIFIC DATE(S) (If Applicable and Known)

1897

AREAS OF SIGNIFICANCE (Check One or More as Appropriate)

- |   |                                       |   |  |
|---|---------------------------------------|---|--|
| Aboriginal <input type="checkbox"/>     | Education <input type="checkbox"/>    | Political <input type="checkbox"/>                | Urban Planning <input type="checkbox"/>  |
| Prehistoric <input type="checkbox"/>    | Engineering <input type="checkbox"/>  | Religion/Phi-<br>losophy <input type="checkbox"/> | Other (Specify) <input type="checkbox"/> |
| Historic <input type="checkbox"/>       | Industry <input type="checkbox"/>     | Science <input type="checkbox"/>                  | _____                                    |
| Agriculture <input type="checkbox"/>    | Invention <input type="checkbox"/>    | Sculpture <input type="checkbox"/>                | _____                                    |
| Art <input type="checkbox"/>            | Landscape <input type="checkbox"/>    | Social/Human-<br>itarian <input type="checkbox"/> | _____                                    |
| Commerce <input type="checkbox"/>       | Architecture <input type="checkbox"/> | Theater <input type="checkbox"/>                  | _____                                    |
| Communications <input type="checkbox"/> | Literature <input type="checkbox"/>   | Transportation <input type="checkbox"/>           | _____                                    |
| Conservation <input type="checkbox"/>   | Military <input type="checkbox"/>     |   |  |
|   | Music <input type="checkbox"/>        |   |  |

STATEMENT OF SIGNIFICANCE (Include Personages, Dates, Events, Etc.)

Built for the hall of Junior Order of Mechanics, now the Masonic Lodge, and Eastern Star building, membership has fallen off as the population changes to a more itinerant suburban community.

SEE INSTRUCTIONS



9. MAJOR BIBLIOGRAPHICAL REFERENCES

Interview with Mrs. Robert Mathews, Librarian at Savage Community Building 11/72

10. GEOGRAPHICAL DATA

LATITUDE AND LONGITUDE COORDINATES DEFINING A RECTANGLE LOCATING THE PROPERTY			O R	LATITUDE AND LONGITUDE COORDINATES DEFINING THE CENTER POINT OF A PROPERTY OF LESS THAN ONE ACRE		
CORNER	LATITUDE	LONGITUDE		LATITUDE	LONGITUDE	
	Degrees Minutes Seconds	Degrees Minutes Seconds		Degrees Minutes Seconds	Degrees Minutes Seconds	
NW	° ' "	° ' "		° ' "	° ' "	
NE	° ' "	° ' "		° ' "	° ' "	
SE	° ' "	° ' "		° ' "	° ' "	
SW	° ' "	° ' "		° ' "	° ' "	

LIST ALL STATES AND COUNTIES FOR PROPERTIES OVERLAPPING STATE OR COUNTY BOUNDARIES

STATE:	CODE	COUNTY	CODE

SEE INSTRUCTIONS

11. FORM PREPARED BY

NAME AND TITLE: WILLIAM S. FRYING

ORGANIZATION: MARYLAND HISTORICAL TRUST DATE: \_\_\_\_\_

STREET AND NUMBER: \_\_\_\_\_

CITY OR TOWN: ANNAPOLIS STATE: MARYLAND CODE: \_\_\_\_\_

12. STATE LIAISON OFFICER CERTIFICATION

As the designated State Liaison Officer for the National Historic Preservation Act of 1966 (Public Law 89-665), I hereby nominate this property for inclusion in the National Register and certify that it has been evaluated according to the criteria and procedures set forth by the National Park Service. The recommended level of significance of this nomination is:

National  State  Local

Name \_\_\_\_\_

Title \_\_\_\_\_

Date \_\_\_\_\_

NATIONAL REGISTER VERIFICATION

I hereby certify that this property is included in the National Register.

\_\_\_\_\_  
Chief, Office of Archeology and Historic Preservation

Date \_\_\_\_\_

ATTEST:

\_\_\_\_\_  
Keeper of The National Register

Date \_\_\_\_\_

SAVAGE PARK

HO-42  
District Boundary

COMMERCIAL

FOUNDRY

STREET

BALTIMORE

★  
220

221

223

224

FAIR

222

★ ★ ★ ★ ★  
225

214

★  
BALDWIN  
COMMON

WILLIAMS

ST.

522

STREET

SAVAGE

ST.

★

WASHINGTON

218

215

216

STREET

★  
217

★  
213

RACE

SAVAGE

Scale, 1"=200'

ROAD

BLVD.

Historic Monument  
BOLLMAN TRUSS BRIDGE  
HO 81

RAILROAD

- BY:
- [ C. 1820 to 1878
- [ 1879 to 1940
- ] 1941 to

== Historic District Boundaries

SAVAGE HISTORIC DISTRICT  
SAVAGE, MARYLAND

Attachment 3.  
Ho-219  
The Masonic Hall  
Savage Historic District Map

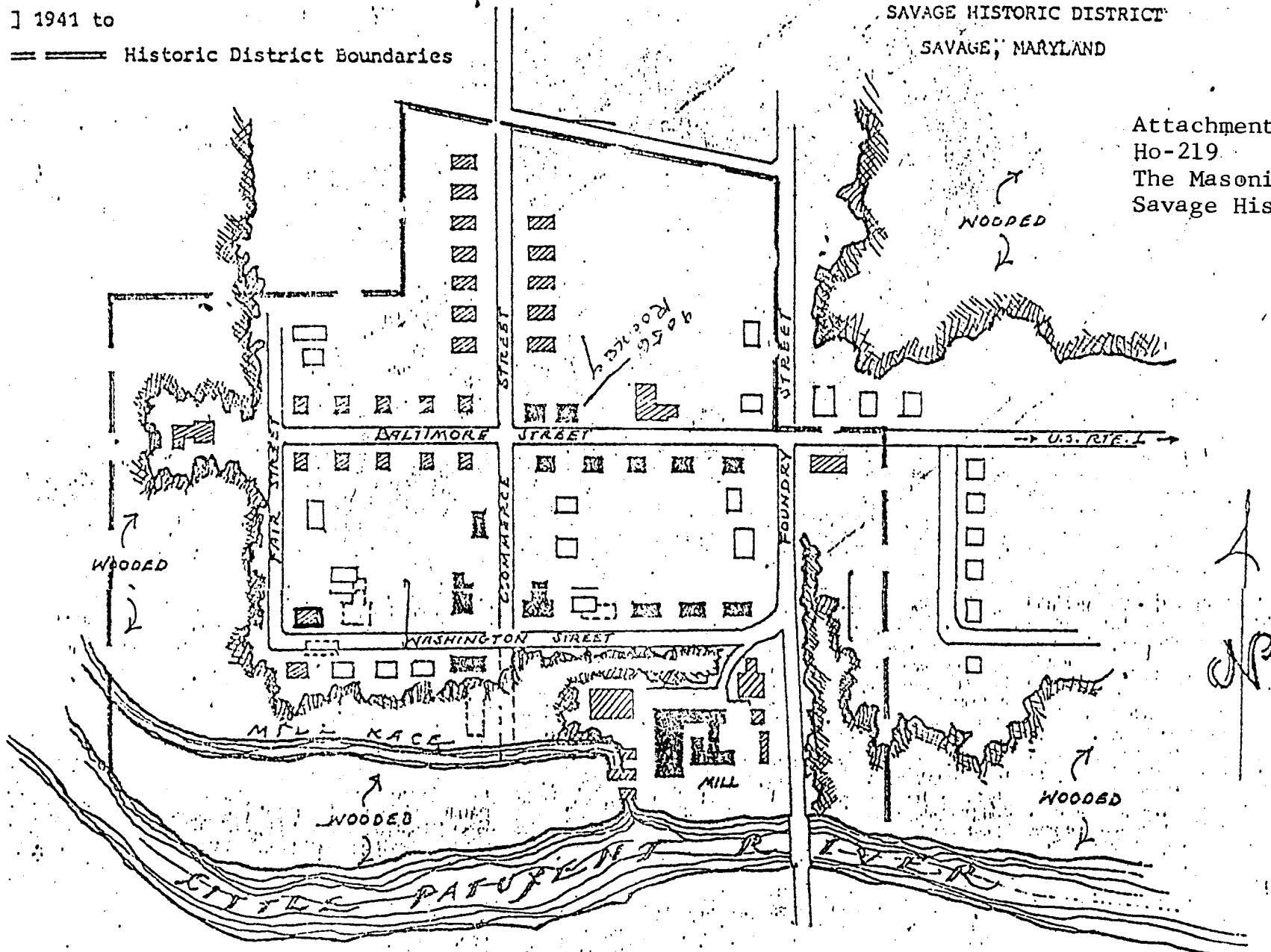

Handwritten initials or signature, possibly 'CP'.

J.R. Rivoire, 5/74. Not drawn to scale.

# Savage Mill District Gets National Designation

... Maryland Historical Places. The district includes... The National Register... money for maintenance and building as the natural center

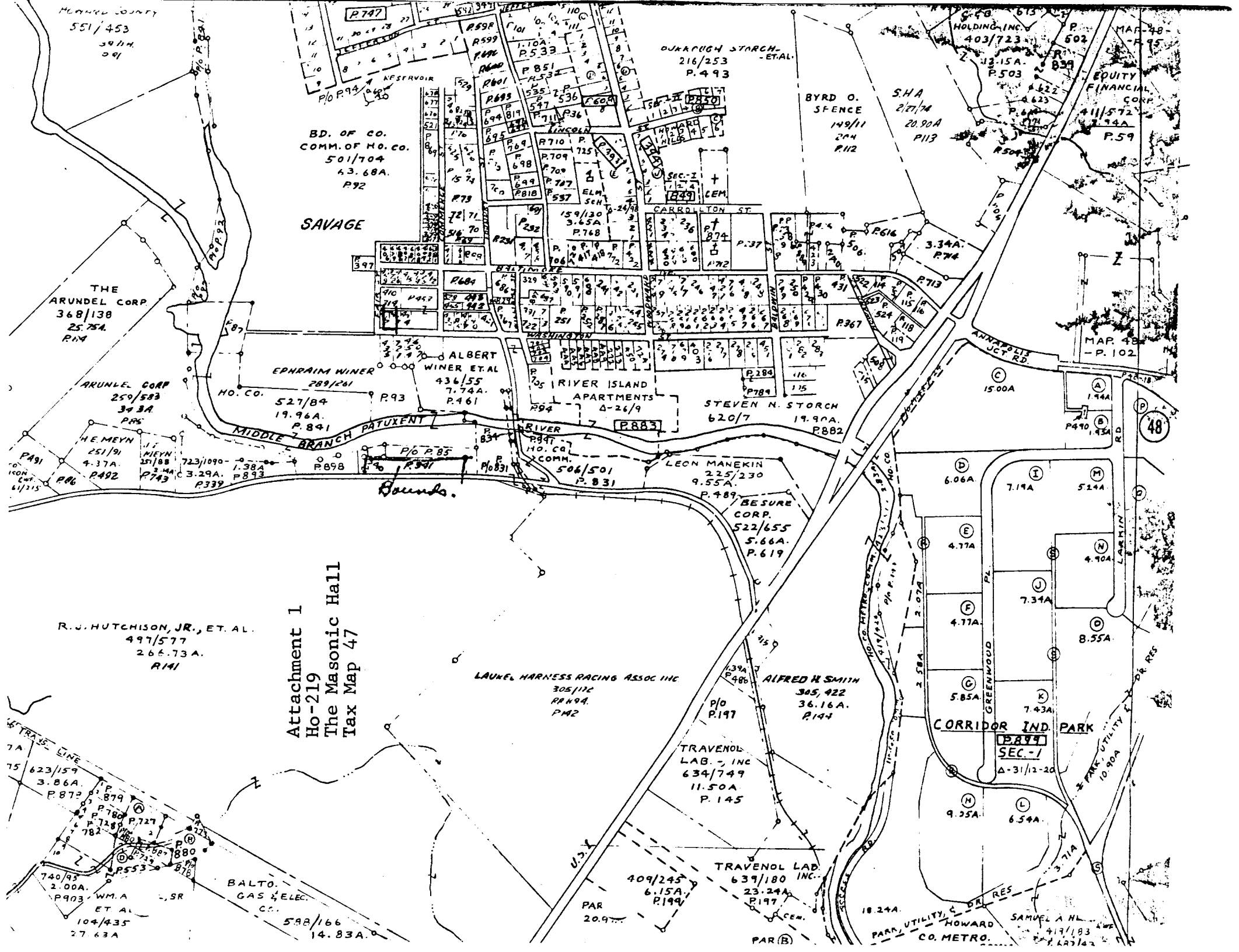

**Attachment 1  
Ho-219  
The Masonic Hall  
Tax Map 47**

R. J. HUTCHISON, JR., ET AL.  
497/577  
266.73A.  
R141

LAUREL HARNES RACING ASSOC INC  
305/112  
R149A.  
P142

TRAVENOL LAB., INC  
634/749  
11.50A  
P.145

TRAVENOL LAD.  
639/180 INC.  
23.24A.  
P197

THE ARUNDEL CORP  
368/138  
25.75A.  
R141

ARUNDEL CORP  
259/583  
34.3A.  
P145

H. E. MEYER  
251/91  
4.37A.  
P142

BD. OF CO.  
COMM. OF HO. CO.  
501/704  
43.68A.  
P92

SAVAGE

EDNRAIM WINER  
289/261  
HO. CO.  
527/84  
19.96A.  
P.841

WINER ET AL  
436/55  
7.74A.  
P.461

RIVER ISLAND  
APARTMENTS  
4-26/9  
P.883

STEVEN N. STORCH  
620/7  
19.90A.  
P.882

LEON MANEKIN  
225/230  
9.55A.  
P.489

BESURE  
CORP.  
522/655  
5.66A.  
P.619

ALFRED H SMITH  
365,422  
36.16A.  
P144

CORRIDOR IND PARK  
P.847  
SEC-1  
A-31/12-20

BALTO.  
GAS & ELEC.  
CO.

588/166  
14.83A.

740/93  
2.00A.  
P.903

WM. A.  
ET AL  
104/435  
27.63A

HOWARD  
CO. METRO.

SAMUEL A. H.  
417/183  
P.142

48

Industrial  
House

Guilford

Old Guilford  
Sch

SAVAGE QUADRANGLE  
EGGS 7.5 minute map  
scale: 1: 24,000  
1957

White  
Cem

Old Guilford  
Sch

Guilford  
Sch

Gravel Pit

Savage  
Grace Cem

Asbury  
Ch

SAVAGE HISTORIC DISTRICT

Kings Apostle  
Ch

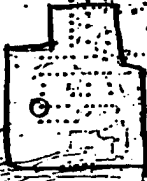

Water

Attachment 2  
Ho-219  
The Masonic Hall  
U.S. Geological Survey Map  
Savage Quadrangle



HO-219  
MASONIC HALL  
SOUTH

CB THOMPSON AIP  
NOV. 77

1





H 219

Masonic Lodge, Sawase Md

11/72  
KS