

HO-156
Dalton
Columbia
Private

Circa 1925

This house, composed of a north and south wing, connected by a one story high, four bay wide, one room deep, flat roofed, brick (covered with stucco) kitchen-hall hyphen, which rests on an eighteenth century brick foundation, is one of Howard County's notable architectural landmarks.

The north wing faces west and is a five bay wide, three bay deep, one and a half story high, gabled roof (running north-south) brick (covered with stucco) building, resting on a nineteenth century, stone foundation. It features a central gabled roof portico, covering an open bible and cross paneled entrance door, flanked by vertical side lights and surmounted by a segmental arched fanlight. Three gabled roof dormer windows hold double-hung, roman arched windows.

The south wing of the house is a one and a half story high, two bay wide, two bay deep, gabled roof (running east-west) brick (laid in running bond) building, which features a wide brick, exterior chimney on the west side of its south wall.

A square stone smoke house lies southeast of the house, on whose threshold stone is inscribed the date 1770.

Dalton is noted as the residence of Dr. Allen Thomas on the 1860 Martennet Map and as the home of Samuel K. George on the 1878 Hopkins Atlas.

The kitchen-hall hyphen rests on the foundation of the Thomas farm house, while the 1925 brick, north wing of the house rests on the foundation of the Samuel K, George home, burned in circa 1920.

The building features a degree of symmetry and formality blended with a modern floor plan.

MARYLAND HISTORICAL TRUST

INVENTORY FORM FOR STATE HISTORIC SITES SURVEY

1 NAME Dalton
HISTORIC

AND/OR COMMON

2 LOCATION

STREET & NUMBER
9315 Mellenbrook Road

CITY, TOWN
Columbia VICINITY OF
6th

STATE
Maryland COUNTY
Howard

3 CLASSIFICATION

CATEGORY	OWNERSHIP	STATUS	PRESENT USE
<input type="checkbox"/> DISTRICT	<input type="checkbox"/> PUBLIC	<input checked="" type="checkbox"/> OCCUPIED	<input type="checkbox"/> AGRICULTURE <input type="checkbox"/> MUSEUM
<input checked="" type="checkbox"/> BUILDING(S)	<input checked="" type="checkbox"/> PRIVATE	<input type="checkbox"/> UNOCCUPIED	<input type="checkbox"/> COMMERCIAL <input type="checkbox"/> PARK
<input type="checkbox"/> STRUCTURE	<input type="checkbox"/> BOTH	<input type="checkbox"/> WORK IN PROGRESS	<input type="checkbox"/> EDUCATIONAL <input checked="" type="checkbox"/> PRIVATE RESIDENCE
<input type="checkbox"/> SITE	PUBLIC ACQUISITION	ACCESSIBLE	<input type="checkbox"/> ENTERTAINMENT <input type="checkbox"/> RELIGIOUS
<input type="checkbox"/> OBJECT	<input type="checkbox"/> IN PROCESS	<input checked="" type="checkbox"/> YES: RESTRICTED	<input type="checkbox"/> GOVERNMENT <input type="checkbox"/> SCIENTIFIC
	<input type="checkbox"/> BEING CONSIDERED	<input type="checkbox"/> YES: UNRESTRICTED	<input type="checkbox"/> INDUSTRIAL <input type="checkbox"/> TRANSPORTATION
		<input type="checkbox"/> NO	<input type="checkbox"/> MILITARY <input type="checkbox"/> OTHER

4 OWNER OF PROPERTY

NAME
Mr. and Mrs. James P. Ryan Telephone #: 730-8860

STREET & NUMBER
9315 Mellenbrook Road

CITY, TOWN
Columbia, Maryland VICINITY OF
STATE, zip code
21044

5 LOCATION OF LEGAL DESCRIPTION

COURTHOUSE, REGISTRY OF DEEDS, ETC.
Tax Map 30 PAR A SEC 1 AREA 2
Hall of Records

Liber #: 471
Folio #: 464

STREET & NUMBER
Howard County Court House

CITY, TOWN
Ellicott City STATE
Maryland

6 REPRESENTATION IN EXISTING SURVEYS

TITLE
Howard County Historic Sites Inventory

DATE
1978-1979
_FEDERAL STATE _COUNTY _LOCAL

DEPOSITORY FOR SURVEY RECORDS
Maryland Historical Trust

CITY, TOWN
21 State Circle, Annapolis STATE
Maryland

7 DESCRIPTION

CONDITION		CHECK ONE	CHECK ONE
<input checked="" type="checkbox"/> EXCELLENT	<input type="checkbox"/> DETERIORATED	<input type="checkbox"/> UNALTERED	<input checked="" type="checkbox"/> ORIGINAL SITE
<input type="checkbox"/> GOOD	<input type="checkbox"/> RUINS	<input checked="" type="checkbox"/> ALTERED	<input type="checkbox"/> MOVED DATE _____
<input type="checkbox"/> FAIR	<input type="checkbox"/> UNEXPOSED		

DESCRIBE THE PRESENT AND ORIGINAL (IF KNOWN) PHYSICAL APPEARANCE

Dalton faces west on the east side of Mellonbrook Road, 2/10 of a mile south of its intersection with Route 108.

It is basically composed of three parts, the oldest of which is a three bay wide, one room deep, one story high, flat roofed, stucco kitchen wing, resting on an old brick foundation, whose east wall has been opened up and extended to create a new modern kitchen. A three feet wide north wall, which holds the wide brick fireplace for the dining room (part of the second section to the house) might originally have held a cooking fireplace for this section. The west facade is set back from the one and a half story high, brick (covered with stucco) house, constructed along, and projecting west from its north wall.

A stone retaining wall runs along this elevation with six wide brick steps ascending to a brick path leading to the four light, roman arched, open bible and cross paneled entrance door, which is now located in the south bay of this wall. A small frame (covered with matching stucco) extension to this wall southward holds a six light circular window. The two north bays of this facade hold two single, rectangular, first floor, double-hung windows, underlined by projecting flat wooden sills and holding six-over-six lights. Above, along the west edge of the flat roof of this one story high kitchen-hyphen, which connects the brick-stucco north wing to the mid twentieth century south wing, runs a ballustrade featuring four square posts connecting a series of turned spindles.

This kitchen-hyphen rests on an old brick foundation. The basement reveals ten inch wide, diagonally placed floorboards in this section of the house, believed to antedate the north wing. Three wide stone steps on the northeast corner of the brick foundation are found in the cellar, believed to have once led to the entrance for this oldest section of the house. The newly constructed east wall of this hyphen section holds a nine light, rectangular entrance in its south bay and a double-kitchen window in its north bay, each component a rectangular, double-hung window, with eight-over-eight plastic insets, underlined by a header brick sill.

A three bay wide, three bay deep, one and a half story high, slate gabled roof (running north-south) brick (covered with stucco) building, resting on basically a stone foundation (the south wall of this section is supported by the brick foundation) has been constructed along the north wall of the kitchen-hyphen, featuring two wide brick chimneys on its south wall and a fine water table running along the perimeter of the base of the house.

Six wide brick steps lead to a brick landing supporting the six doric wooden columns of a central bay, gabled roof portico which covers a rectangular, open bible and cross paneled entrance door. This entrance is flanked by fluted pilasters and four vertical side lights and surmounted by a nine light segmental arch fan light. The north and south bays of this facade hold double first floor windows, underlined by three light

horizontal rectangular basement windows, set into the foundation. Each component of the double window is a rectangular, double-hung window, holding six-over-six lights, all underlined by a projecting sill, and decorated with black shutters.

Three gabled roof dormer windows rest above. They hold Roman Arched, double-hung windows, holding nine-over-six lights, which are set into a wooden, roman arched, archivolt decorated with key stone and flanked by flat pilasters.

The north elevation holds three first and second floor, rectangular double-hung windows, holding six-over-six lights underlined by projecting wooden (covered with stucco) sills and decorated with brick shutters. The east and west bays of this elevation hold cellar windows, similar to those already described. A small, narrow, rectangular, two light attic casement window rests in both the north and south elevations of this section of the building complex.

The south elevation of this section holds a central, second floor, double casement window, holding fifteen-fifteen lights. East of this window is a smaller, second floor, single, rectangular casement window.

EAST ELEVATION

Along the east elevation of the brick (covered with stucco) building runs a one story high, three bay wide, one room deep, slate, hipped roof sun porch, resting on a brick foundation. Upon this section rests a second floor, shed roof addition, super imposed upon a previous second floor, shed roofed addition, which runs along almost the entire east elevation.

The first shed roofed addition held a ten-ten light, rectangular casement window in the south bay of its east wall and a fourteen-fourteen light french-door in the north bay of its east wall, which led out to a widow's walk. This was enclosed and roofed, presenting a shed roofed addition upon a shed roofed addition. It holds a single, rectangular, double-hung, second floor window, holding a six-over-six light plastic inset in its second floor, north and south walls, while six similar second floor windows run along its east wall, but hold eight-over-eight plastic insets. A tall square brick (covered with stucco) chimney rises behind the east window in the second north bay.

Below, five wide brick steps lead to the central, rectangular, twelve-twelve light, french door, which is flanked by twelve lights, underlined by projecting wooden sills. The door and flanking window are inset into a wide arch. This wide arch is repeated on either side of the central entrance. Each holds a tripartite window composed of a rectangular, central, double casement window, holding twelve-twelve lights, flanked by twelve light sections, which follow the line created by the single wide arch of the total window, all of which is underlined by a wide projecting wooden sill.

A similarly arched, tripartite window is set into the north wall of this section, but holds a central eight-eight light rectangular, casement window, flanked by eight light panels, which follow the line of the arch,

all of which is underlined by a wide, projecting, wooden sill. This section rests on a brick foundation and features the continuation of the water table, running along the north wall of the original, brick (covered with stucco) building.

NEW ADDITION - CIRCA 1968

This newly constructed addition is a two bay wide, two bay deep, one story high, slate, gabled roof (running east-west) brick (laid in running bond) garage-family room which runs along the south wall of the kitchen-hyphen, mid section of the house. The east wall of this newly constructed, brick section holds two square, first floor, double-hung windows, holding eight-over-eight plastic insets, each of which are underlined by header brick sills and decorated with black shutters. Two vertically aligned, tall, rectangular, second floor, double-hung windows, are similar to those below. The west wall holds two similar first floor windows and a central, second floor window.

The two car garage takes up the east side of this section's south wall, while the west side holds a wide, exterior, brick chimney for the family room's large mantelpiece.

THE INTERIOR

The interior of the house is outstanding, featuring fine paneling, both new and old, in such excellent taste that there is a unique blending of the two.

The interior plan of the house is quite unique, featuring double pile organization with a central hall and staircase running north-south on the south side of the building.

The central entrance door leads into a large living room which features fine crown molding, decorated with a row of dentils. This molding is repeated in the central hall and dining room of the house, with simpler but equally well executed crown molding featured in the east and west first floor chambers of the north side of the house, installed by Mr. & Mrs. Ryan.

Fine paneling runs up the staircase, which features turnedspindles and knewel post. The entire house features fine interior doors and woodwork with rectangular entrances, decorated with segmental arched recesses and key stones leading from the hall of the living and dining rooms. Fine mantelpieces grace both these rooms.

A one story high, square smoke house stands south of the house, which is surrounded by mature trees, thoughtfully placed boxwood and shrubs, all of which are approached by a circular west drive.

A threshold stone in the smoke house is inscribed 1770.

8 SIGNIFICANCE

HO-156
Dist 6

PERIOD	AREAS OF SIGNIFICANCE -- CHECK AND JUSTIFY BELOW			
<input type="checkbox"/> PREHISTORIC	<input type="checkbox"/> ARCHEOLOGY-PREHISTORIC	<input type="checkbox"/> COMMUNITY PLANNING	<input type="checkbox"/> LANDSCAPE ARCHITECTURE	<input type="checkbox"/> RELIGION
<input type="checkbox"/> 1400-1499	<input type="checkbox"/> ARCHEOLOGY-HISTORIC	<input type="checkbox"/> CONSERVATION	<input type="checkbox"/> LAW	<input type="checkbox"/> SCIENCE
<input type="checkbox"/> 1500-1599	<input type="checkbox"/> AGRICULTURE	<input type="checkbox"/> ECONOMICS	<input type="checkbox"/> LITERATURE	<input type="checkbox"/> SCULPTURE
<input type="checkbox"/> 1600-1699	<input checked="" type="checkbox"/> ARCHITECTURE	<input type="checkbox"/> EDUCATION	<input type="checkbox"/> MILITARY	<input type="checkbox"/> SOCIAL/HUMANITARIAN
<input type="checkbox"/> 1700-1799	<input type="checkbox"/> ART	<input type="checkbox"/> ENGINEERING	<input type="checkbox"/> MUSIC	<input type="checkbox"/> THEATER
<input type="checkbox"/> 1800-1899	<input type="checkbox"/> COMMERCE	<input type="checkbox"/> EXPLORATION/SETTLEMENT	<input type="checkbox"/> PHILOSOPHY	<input type="checkbox"/> TRANSPORTATION
<input checked="" type="checkbox"/> 1900-	<input type="checkbox"/> COMMUNICATIONS	<input type="checkbox"/> INDUSTRY	<input type="checkbox"/> POLITICS/GOVERNMENT	<input checked="" type="checkbox"/> OTHER (SPECIFY) Local History
		<input type="checkbox"/> INVENTION		

SPECIFIC DATES Circa 1925 BUILDER/ARCHITECT

STATEMENT OF SIGNIFICANCE

Dalton, located on the east side of the Dalton Subdivision and within the Columbia neighborhood of Thunder Hill, is a noteworthy twentieth century house, constructed circa 1925 on an eighteenth-nineteenth century brick and stone foundation, the brick section of which may well date to 1770, the date inscribed on the adjoining stone smoke house on the property. A building stood here in 1860, noted on the Martennet Map, See attachment 3, noted as the residence of Allen Thomas. In a bill of complaint, issued May 29, 1863 John R.D. Thomas, porchin ami (believed to be prochain ami or "next friend" in French) of Ellen Hazlehurst, daughter of Dr. Allen Thomas and Eliza Doll Thomas, filed for permission to sell the property. The improvements noted thereon at that time consisted of "a frame dwelling and barn and a small stone dairy. This is believed to have been the present kitchen-hyphen area of the building of which the brick foundation, chimney stack and first floor, diagonally laid 10" floor boards remain, possibly dating from 1770, the date which is inscribed on the threshold stone of the dairy.

Samuel K. George acquired the property and is noted as the owner on the 1878 Hopkin's Atlas. See Attachment 4. The larger brick addition resting on a stone foundation, the north wing of the house, is believed to have been constructed by him. Sometime in the early 1920's this house burned to the ground and was rebuilt by J. Lawrence Clark and his wife Alice, who had acquired the property in 1910 from the heirs of Mr. George. The Clarks constructed a story and a half dwelling unit over this old foundation, holding a first floor north side bedroom section and south side central hall-living-dining room section.

The rectangular building features double pile organization, two rooms deep, with its dining room and living room separated by its central hall, all of which feature exceptionally fine crown molding, decorated with a row of dentils, and staircase paneling, which was installed by the present owners, Mr. and Mrs. James Ryan.

The woodwork throughout the house is of exceptionally fine craftsmanship, featuring open bible and cross paneled doors and ceiling high paneling decorating the fine living room fireplace.

A brightly lighted sun porch, along the east elevation of the house, features an arched, tripartite central entrance, flanked by similar window

CONTINUE ON SEPARATE SHEET IF NECESSARY

arrangement. This feature is representative of the early twentieth century which added whole rooms for plants and sunlight, rather than the simple use of the bay window in the late nineteenth century.

The building combines elegance and formality with the use of a modern floor plan making this an important nineteenth-twentieth century transition building. The facade is more formally styled, but still maintains the symmetrical five bay wide, central portico covering a fine rectangular central entrance, flanked by vertical side lights and surmounted by a segmental arch fanlight reflecting the early Howard County federal house. This formality and symmetry is repeated in the three gabled roof dormer windows above the central portico, which hold roman arched, double-hung windows, reflective of the Beaux Arts classicism so prevalent in the 1920's.

From the traditional facade of the house, a central hall, flanked by living room and dining room is reflected but the interior plan is completely modern. Downstairs bedrooms are linked by a commodious modern bath, while smaller roman arched passages carry on the motif created by the segmental arched lintels and keystones, decorating rectangular hall entrances to the living and dining rooms. A great deal of clarity and simplicity combined with elegant, finely crafted and well executed stylistic interior detail makes this one of Howard County's finest architectural landmarks.

Historically, the house on the old brick foundation, beneath the mid-section of the house may go back to circa 1770, the date inscribed on the old square, stone, tent roofed smoke house for the dwelling unit, standing south of the house. (Only the foundation and first floor floorboards remain of this house which burned.)

The property is notable for its association with Mr. Samuel K. George, who was a friend of Mr. John Clark, grandfather of Judge John Clark and his brother Senator James Clark, now president of the Maryland Senate. A story is told by Judge John Clark that during the Civil War, farmers in the area were constantly beleaguered by Northern Army Cavalry, conscripting horses for use in the field, battlefield that is. The farmers also needed their horses for the field, their wheatfields, cornfields, and money was promised for their horses but not immediately forthcoming. Mr. Clark's grandfather and Mr. George decided to hide their horses in the woods. Unfortunately heavy brew was in the area and one of their workers imbibed so much, he went to the northern authorities and told them about the horses. They were all conscripted and later after the war probably paid for. This little vignette of life in rural Howard County during the Civil War indicates how difficult life was for the border State of Maryland. The farmers, however, never quite lost their sense of humor and were able to laugh, even when the joke was on them.

Associated with the George and Clark families of Howard County, Maryland and notable as a fine piece of twentieth century architecture, which blends formal stylistic detail with a contemporary, workable floor plan, Dalton stands today as a significant Howard County landmark.

9 MAJOR BIBLIOGRAPHICAL REFERENCES

Interview with Mr. and Mrs. Frank Macquire, members of the Clarke family, who once owned

Interview with Judge John Clark, member of the Clark family, who once owned

Interview with Miss Kassy Ryan, daughter of the owners, July 10, 1979

CONTINUE ON SEPARATE SHEET IF NECESSARY

10 GEOGRAPHICAL DATA

ACREAGE OF NOMINATED PROPERTY _____

Please see Attachment 1, Tax Map 30

VERBAL BOUNDARY DESCRIPTION

Please see Howard County Land Records, Liber 471 Folio 464

LIST ALL STATES AND COUNTIES FOR PROPERTIES OVERLAPPING STATE OR COUNTY BOUNDARIES

STATE Maryland COUNTY Howard

STATE COUNTY

11 FORM PREPARED BY

NAME / TITLE

Cleora Barnes Thompson, Archivist

ORGANIZATION

Office of Planning & Zoning-Comprehensive Planning Section

DATE

STREET & NUMBER

3450 Court House Drive

TELEPHONE

CITY OR TOWN

Ellicott City

STATE

Maryland

The Maryland Historic Sites Inventory was officially created by an Act of the Maryland Legislature, to be found in the Annotated Code of Maryland, Article 41, Section 181 KA, 1974 Supplement.

The Survey and Inventory are being prepared for information and record purposes only and do not constitute any infringement of individual property rights.

RETURN TO: Maryland Historical Trust
The Shaw House, 21 State Circle
Annapolis, Maryland 21401
(301) 267-1438

COLUMBIA

Attachment 1
HO-156
Dalton
Map 30

RD RESEARCH
CORP.
484 98YR. LEASE
T.15A.
P.224

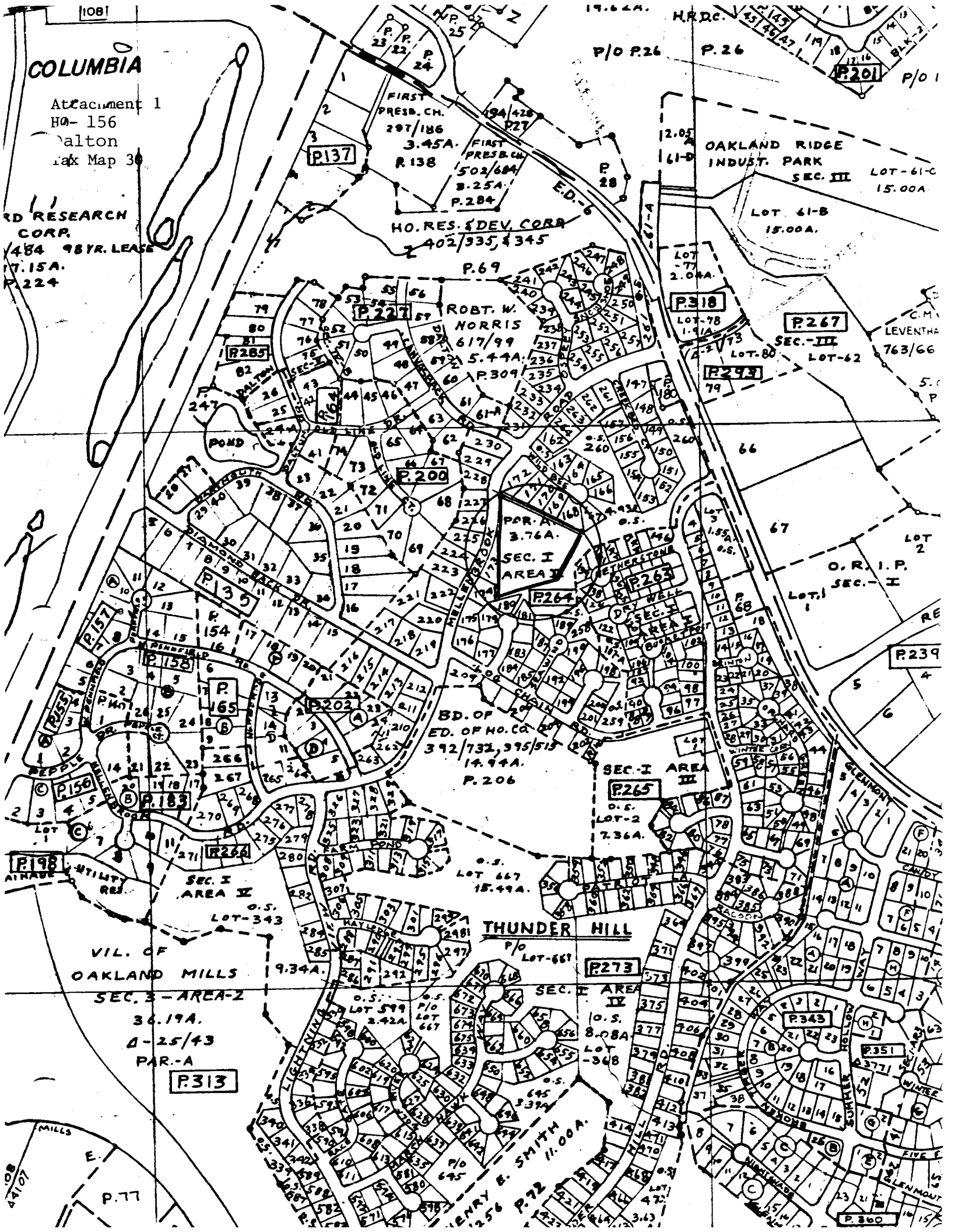



Attachment 3
 Ho-156
 Dalton

Martennet Map of 1860

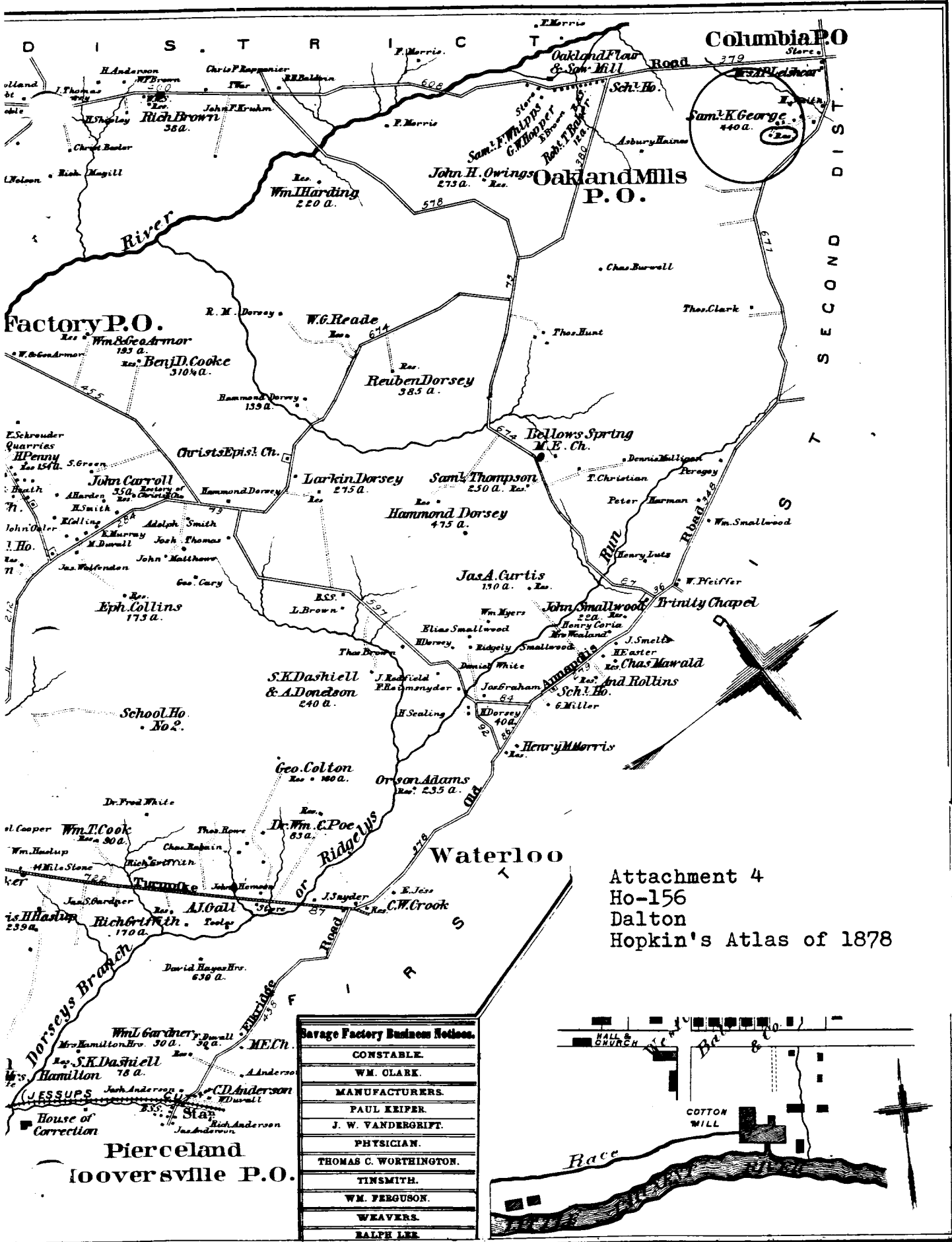

Attachment 4
 Ho-156
 Dalton
 Hopkin's Atlas of 1878

Savage Factory Business Notices.

CONSTABLE.
WM. CLARK.
MANUFACTURERS.
PAUL KEIFER.
J. W. VANDERGRIFT.
PHYSICIAN.
THOMAS C. WORTHINGTON.
TINSMITH.
WM. FERGUSON.
WEAVERS.
RALPH LEE.

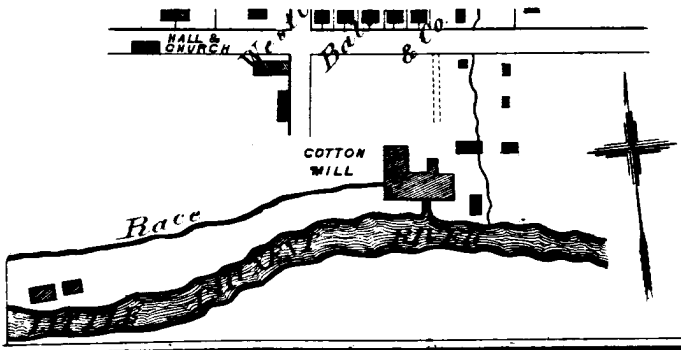

**Pierceland
 looversville P.O.**

MAP O

R

Attachment 2
HO-156
Dalton
U.S. Geological Survey Map
Savage, Maryland Quadrangle

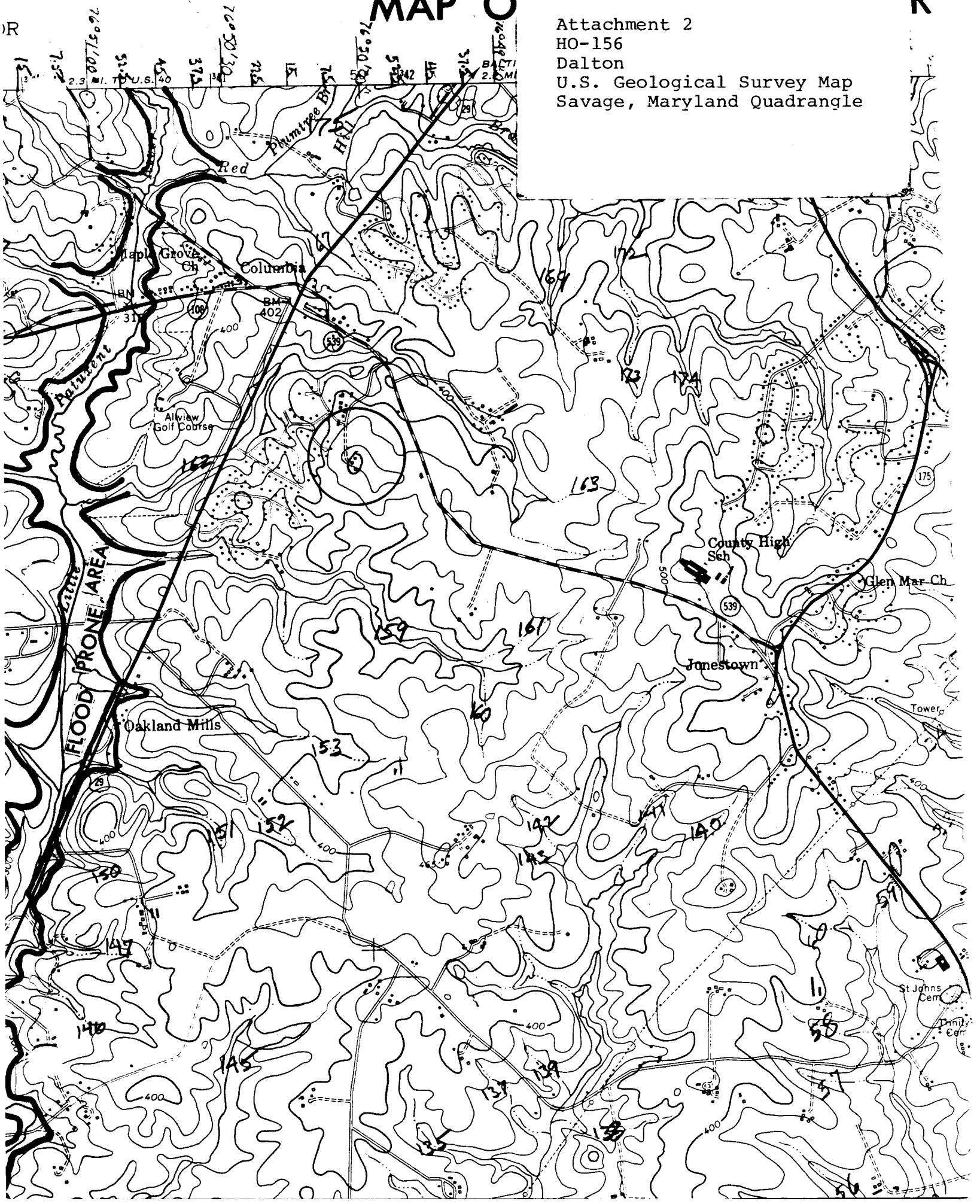



Ho-156
DALTON
WEST

JUNE 1979
CB THOMPSON, AICP