

INDIVIDUAL PROPERTY/DISTRICT
MARYLAND HISTORICAL TRUST
INTERNAL NR-ELIGIBILITY REVIEW FORM

Property/District Name: Russell Maisel's Stone House Survey Number: HO-122
Project: Replace Dorsey Mill Road Bridge Agency: FHWA/Howard County
Site visit by MHT Staff: no yes Name _____ Date _____
Eligibility recommended Eligibility not recommended
Criteria: A B C D Considerations: A B C D E F G None

Justification for decision: (Use continuation sheet if necessary and attach map)

This three bay by one bay, two story, stone house with gable roof was originally a portion of the Stephen Boone Dorsey Property. It is thought to date to circa 1780. In our opinion, the house is eligible under Criterion C as a good example of the modest stone dwellings which typically housed workers on large landholdings and which once dotted Howard County. Based on the available information, we believe the National Register historic property should include the southern portion of the 5.15 acre tax parcel, encompassing the house, log outbuildings and landscaped grounds. A modern rental house is located on the northern end of the property. Further work would be required to develop precise boundaries for the eligible portion of the property.

Documentation on the property/district is presented in: Project File, Maryland Inventory
Form HO-122

Prepared by: Cleora Thompson

Elizabeth Hannold January 27, 1997
Reviewer, Office of Preservation Services Date

NR program concurrence: yes no not applicable
Peter S. Kuntz 1/27/97
Reviewer, NR program Date

mg

MARYLAND COMPREHENSIVE HISTORIC PRESERVATION PLAN DATA - HISTORIC CONTEXT

I. Geographic Region:

- Eastern Shore (all Eastern Shore counties, and Cecil)
- Western Shore (Anne Arundel, Calvert, Charles, Prince George's and St. Mary's)
- Piedmont (Baltimore City, Baltimore, Carroll, Frederick, Harford, Howard, Montgomery)
- Western Maryland (Allegany, Garrett and Washington)

II. Chronological/Developmental Periods:

- Paleo-Indian 10000-7500 B.C.
- Early Archaic 7500-6000 B.C.
- Middle Archaic 6000-4000 B.C.
- Late Archaic 4000-2000 B.C.
- Early Woodland 2000-500 B.C.
- Middle Woodland 500 B.C. - A.D. 900
- Late Woodland/Archaic A.D. 900-1600
- Contact and Settlement A.D. 1570-1750
- Rural Agrarian Intensification A.D. 1680-1815
- Agricultural-Industrial Transition A.D. 1815-1870
- Industrial/Urban Dominance A.D. 1870-1930
- Modern Period A.D. 1930-Present
- Unknown Period (prehistoric historic)

III. Prehistoric Period Themes:

- Subsistence
- Settlement
- Political
- Demographic
- Religion
- Technology
- Environmental Adaption

IV. Historic Period Themes:

- Agriculture
- Architecture, Landscape Architecture, and Community Planning
- Economic (Commercial and Industrial)
- Government/Law
- Military
- Religion
- Social/Educational/Cultural
- Transportation

V. Resource Type:

Category: Buildings

Historic Environment: Rural

Historic Function(s) and Use(s): Domestic-single dwelling, outbuilding

Known Design Source: na

HO-122

RUSSELL MAISEL'S STONE HOUSE

circa 1780

Glenn

Private

This two and a half story stone structure, originally part of the Stephen Boone Dorsey property, is three bays wide and two bays deep facing east with gabled roof and bearing walls 22 inches thick. It is a fine example of vernacular architecture, typical of the modest stone houses which dot Howard County and were at one time attached to larger homes. Named for owner Russel Maisel, its future is uncertain, standing in the way of the flood plain of the Tridelphia Dam expansion.

Restoration of this structure was carefully executed by Mr. and Mrs. Russel Maisel who have maintained the integrity of this eighteenth century structure throughout its interior, giving thoughtful consideration to the placement of their west addition which in no way detracts from the east or front facade of the building.

MARYLAND HISTORICAL TRUST WORKSHEET

NOMINATION FORM
for the
NATIONAL REGISTER OF HISTORIC PLACES, NATIONAL PARKS SERVICE

SEE INSTRUCTIONS

1. NAME				
COMMON: Russell Maisel's Stone House				
AND/OR HISTORIC:				
2. LOCATION				
STREET AND NUMBER: 15282 Roxbury Road				
CITY OR TOWN: Glenelg				
STATE Maryland		COUNTY: Howard		
3. CLASSIFICATION				
CATEGORY (Check One)		OWNERSHIP		STATUS
<input checked="" type="checkbox"/> District <input type="checkbox"/> Building <input type="checkbox"/> Site <input type="checkbox"/> Structure <input type="checkbox"/> Object		<input type="checkbox"/> Public <input checked="" type="checkbox"/> Private <input type="checkbox"/> Both		<input checked="" type="checkbox"/> Occupied <input type="checkbox"/> Unoccupied <input type="checkbox"/> Preservation work in progress
		Public Acquisition: <input type="checkbox"/> In Process <input type="checkbox"/> Being Considered		ACCESSIBLE TO THE PUBLIC Yes: <input checked="" type="checkbox"/> Restricted <input type="checkbox"/> Unrestricted <input type="checkbox"/> No
PRESENT USE (Check One or More as Appropriate)				
<input type="checkbox"/> Agricultural	<input type="checkbox"/> Government	<input type="checkbox"/> Park	<input type="checkbox"/> Transportation	<input type="checkbox"/> Comments
<input type="checkbox"/> Commercial	<input type="checkbox"/> Industrial	<input checked="" type="checkbox"/> Private Residence	<input type="checkbox"/> Other (Specify)	_____
<input type="checkbox"/> Educational	<input type="checkbox"/> Military	<input type="checkbox"/> Religious	_____	_____
<input type="checkbox"/> Entertainment	<input type="checkbox"/> Museum	<input type="checkbox"/> Scientific	_____	_____
4. OWNER OF PROPERTY				
OWNER'S NAME: Mr. & Mrs. Russell Maisel				
STREET AND NUMBER: 15282 Roxbury Road				
CITY OR TOWN: Glenelg		STATE: Maryland		21737
5. LOCATION OF LEGAL DESCRIPTION				
COURTHOUSE, REGISTRY OF DEEDS, ETC.: Hall of Records				
STREET AND NUMBER: Howard County Court House				
CITY OR TOWN: Ellicott City		STATE: Maryland		21043
Title Reference of Current Deed (Book & Pg. #): Tax Map 15 p. 27				
6. REPRESENTATION IN EXISTING SURVEYS /309-254 Acreage 5.15				
TITLE OF SURVEY: Howard County Historic Sites Inventory				
DATE OF SURVEY: 1976 <input type="checkbox"/> Federal <input checked="" type="checkbox"/> State <input type="checkbox"/> County <input type="checkbox"/> Local				
DEPOSITORY FOR SURVEY RECORDS: Maryland Historical Trust				
STREET AND NUMBER: 21 State Circle				
CITY OR TOWN: Annapolis		STATE: Maryland		21401

7. DESCRIPTION	
CONDITION	(Check One)
	<input checked="" type="checkbox"/> Excellent <input type="checkbox"/> Good <input type="checkbox"/> Fair <input type="checkbox"/> Deteriorated <input type="checkbox"/> Ruins <input type="checkbox"/> Unexposed
	(Check One)
	<input type="checkbox"/> Altered <input checked="" type="checkbox"/> Unaltered <input type="checkbox"/> Moved <input checked="" type="checkbox"/> Original Site
DESCRIBE THE PRESENT AND ORIGINAL (if known) PHYSICAL APPEARANCE	
<p style="text-align: center;">Russell Maisel's Stone House</p> <p>This two and a half story stone structure is two bays deep, three bays wide facing east with gabled roof and bearing walls 22 inches thick with upper walls 18 inches thick. Named for owner Russel Maisel, its future is uncertain and standing in the way of the flood plain of the Triadelphia Dam expansion.</p> <p>It has a central rectangular Dutch entrance door (battan wood door on bottom half, six lites on upper half) flanked by double-hung windows with six-over-six lites. Its north wall holds a wide central brick chimney inset into the wall. At one time it is said that the central second floor window used to be a door. Presently the second story of the east facade holds three similar windows with six-over-six lites and shutters.</p> <p>The north wall of the house holds a six lite casement window on either side of the chimney. On the first floor and a four lite square casement window on either side of the chimney on the third floor.</p> <p>A one story brick addition lies on the south wall with a brick chimney on its south wall. Previously a bath, it is now used as a utility room.</p> <p>The west wall central back entrance now leads into a one story kitchen-bedroom bath addition which runs along the entire west wall and extends west on the south bay. Constructed of brick which has been painted to complement the color of the stone, it is a pleasant addition to the living quarters which in no way detracts from the front facade of the building.</p> <p>The landscaping and stone terraces along the east and west facades of the house have been thoughtfully executed. A stone wall also runs along the east boundary of the Roxbury Road. The stonework, landscaping and well-placed west wing all add to the compact and tidy appearance of a well-cared for residence.</p>	

SEE INSTRUCTIONS

SIGNIFICANCE							
PERIOD (Check One or More as Appropriate) <input type="checkbox"/> Pre-Columbian <input type="checkbox"/> 16th Century <input checked="" type="checkbox"/> 18th Century <input type="checkbox"/> 20th Century <input type="checkbox"/> 15th Century <input type="checkbox"/> 17th Century <input type="checkbox"/> 19th Century							
SPECIFIC DATE(S) (If Applicable and Known) 1780							
AREAS OF SIGNIFICANCE (Check One or More as Appropriate) <table style="width: 100%; border: none;"> <tr> <td style="width: 25%; vertical-align: top;"> <input type="checkbox"/> Aboriginal <input type="checkbox"/> Prehistoric <input checked="" type="checkbox"/> Historic <input type="checkbox"/> Agriculture <input checked="" type="checkbox"/> Architecture <input type="checkbox"/> Art <input type="checkbox"/> Commerce <input type="checkbox"/> Communications <input type="checkbox"/> Conservation </td> <td style="width: 25%; vertical-align: top;"> <input type="checkbox"/> Education <input type="checkbox"/> Engineering <input type="checkbox"/> Industry <input type="checkbox"/> Invention <input type="checkbox"/> Landscape <input type="checkbox"/> Literature <input type="checkbox"/> Military <input type="checkbox"/> Music </td> <td style="width: 25%; vertical-align: top;"> <input type="checkbox"/> Political <input type="checkbox"/> Religion/Philosophy <input type="checkbox"/> Science <input type="checkbox"/> Sculpture <input type="checkbox"/> Social/Humanitarian <input type="checkbox"/> Theater <input type="checkbox"/> Transportation </td> <td style="width: 25%; vertical-align: top;"> <input type="checkbox"/> Urban Planning <input type="checkbox"/> Other (Specify) <hr/><hr/><hr/><hr/><hr/><hr/><hr/><hr/> </td> </tr> </table>				<input type="checkbox"/> Aboriginal <input type="checkbox"/> Prehistoric <input checked="" type="checkbox"/> Historic <input type="checkbox"/> Agriculture <input checked="" type="checkbox"/> Architecture <input type="checkbox"/> Art <input type="checkbox"/> Commerce <input type="checkbox"/> Communications <input type="checkbox"/> Conservation	<input type="checkbox"/> Education <input type="checkbox"/> Engineering <input type="checkbox"/> Industry <input type="checkbox"/> Invention <input type="checkbox"/> Landscape <input type="checkbox"/> Literature <input type="checkbox"/> Military <input type="checkbox"/> Music	<input type="checkbox"/> Political <input type="checkbox"/> Religion/Philosophy <input type="checkbox"/> Science <input type="checkbox"/> Sculpture <input type="checkbox"/> Social/Humanitarian <input type="checkbox"/> Theater <input type="checkbox"/> Transportation	<input type="checkbox"/> Urban Planning <input type="checkbox"/> Other (Specify) <hr/> <hr/> <hr/> <hr/> <hr/> <hr/> <hr/> <hr/>
<input type="checkbox"/> Aboriginal <input type="checkbox"/> Prehistoric <input checked="" type="checkbox"/> Historic <input type="checkbox"/> Agriculture <input checked="" type="checkbox"/> Architecture <input type="checkbox"/> Art <input type="checkbox"/> Commerce <input type="checkbox"/> Communications <input type="checkbox"/> Conservation	<input type="checkbox"/> Education <input type="checkbox"/> Engineering <input type="checkbox"/> Industry <input type="checkbox"/> Invention <input type="checkbox"/> Landscape <input type="checkbox"/> Literature <input type="checkbox"/> Military <input type="checkbox"/> Music	<input type="checkbox"/> Political <input type="checkbox"/> Religion/Philosophy <input type="checkbox"/> Science <input type="checkbox"/> Sculpture <input type="checkbox"/> Social/Humanitarian <input type="checkbox"/> Theater <input type="checkbox"/> Transportation	<input type="checkbox"/> Urban Planning <input type="checkbox"/> Other (Specify) <hr/> <hr/> <hr/> <hr/> <hr/> <hr/> <hr/> <hr/>				
STATEMENT OF SIGNIFICANCE <p>This simple structure is significant both architecturally and historically. Historically it belonged to Stephen Boone Dorsey in 1780. In the 1950's, it was owned by Walter Tobriner, Ambassador to Jamaica under the Johnson Administration who bought it in the early thirties from Stephen Boone Dorsey. Historically it served as available housing on the property for workers. In the early colonial period horse drawn wagons stopped at large houses to find a likely place to work and live. Small stone or log houses such as these used to dot the property of many of the large holdings of Howard County. Burleigh Gate House, Spring Hill Quarters and the Russell Maissell Stone House all are representative of these satellite buildings, now used as charming residences with additions thoughtfully arranged.</p> <p>Architecturally it is a fine example of a small stone 18th century house. Increasing its value architecturally has been the thoughtful restoration of the house under Mr. & Mrs. Russel Maissel who have replaced rotting timbers with hand hewn timbers taken out of old structures.</p> <p>The house nestles into a slope creating three stories on the east facade and two on the west facade.</p> <p>The second floor is now the living room and the central back door enters into the new kitchen wing which has been added along the west wall of the house.</p> <p>Originally this living room was two rooms and had an enclosed staircase which has now been opened up to create a more spacious room. The random width poplar floors with square nails are original to the house in the charming half story room in the gable.</p> <p>Stone chimneys on the first and second floors hold original fireplaces.</p>							

SEE INSTRUCTIONS

HO-122

9. MAJOR BIBLIOGRAPHICAL REFERENCES

Interview with Mrs. Russell Maisel, 15282 Roxbury Road. September 9, 1976.

10. GEOGRAPHICAL DATA

LATITUDE AND LONGITUDE COORDINATES DEFINING A RECTANGLE LOCATING THE PROPERTY			O R	LATITUDE AND LONGITUDE COORDINATES DEFINING THE CENTER POINT OF A PROPERTY OF LESS THAN TEN ACRES		
CORNER	LATITUDE	LONGITUDE		LATITUDE	LONGITUDE	
	Degrees Minutes Seconds	Degrees Minutes Seconds		Degrees Minutes Seconds	Degrees Minutes Seconds	
NW	° ' "	° ' "		° ' "	° ' "	
NE	° ' "	° ' "		° ' "	° ' "	
SE	° ' "	° ' "		° ' "	° ' "	
SW	° ' "	° ' "		° ' "	° ' "	

APPROXIMATE ACREAGE OF NOMINATED PROPERTY:

Acreage Justification:

Please see Tax Map 21, Blk 15
p. 27
309-254

Acreage 5.15

SEE INSTRUCTIONS

11. FORM PREPARED BY

NAME AND TITLE:
Cleora Barnes Thompson, Archivist

ORGANIZATION: Office of Planning and Zoning-Comprehensive Planning DATE: _____

STREET AND NUMBER:
3450 Court House Drive

CITY OR TOWN: Ellicott City STATE: Maryland ZIP: 21043

12. State Liaison Officer Review: (Office Use Only)

Significance of this property is:

National State Local

Signature _____

JOHN M.
BEANE
215/202
35.27A.
P.26

P.27

LEO BUTLER
222/291
61.4GA.
P.24

M. GEMMILL
ELLINGSWORTH
230/459
81.48A.
P.23

J. GARRETT
REILLY
257/518
278.63A.
P.13

RUSSELL MAISSELS
STONE HOUSE
HO-122 DISTRICT
TAX MAP # 21

MILLS

E.T.
CONNORS
437/776
4.85A.
R112

W.G.
SARGEANT
225/331
22.25A.
P.16

P.15

504/172
4.83A
P.51

P.87

WARREN C.

97

97

ROXBURY RD.

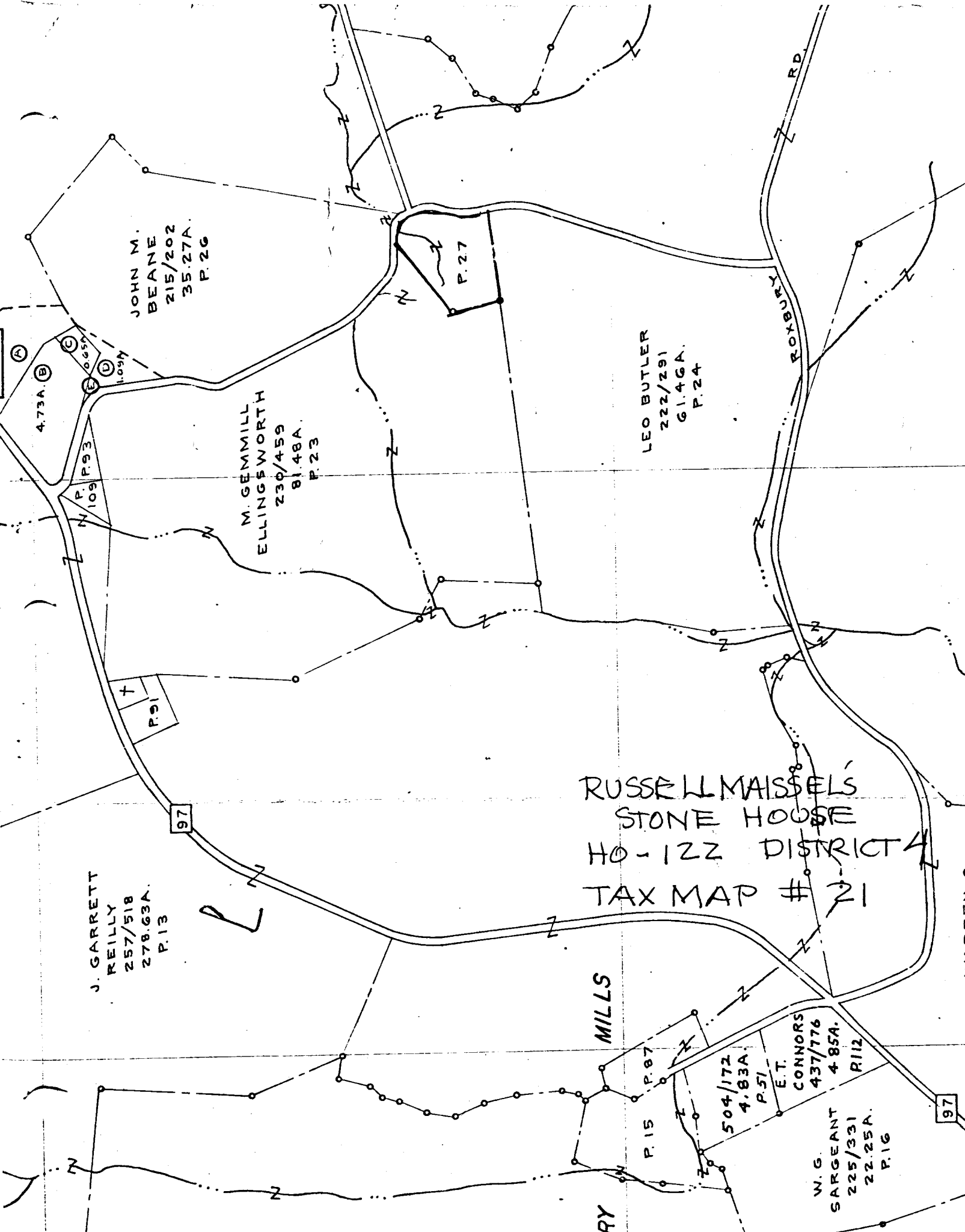



HO.122

9300

SEE April 72

Russell Maisel's stone house



near 122 HO-122

9300

88E 4/72

Russell Maisel's log building



HO-122 DIST 4
RUSSELL MAISEL'S
STONE HOUSE

CLEORA BARNES THOMPSON
PLANNING CONSULTANT
HISTORICAL SITES SURVEY

OCT 76