

HO-119
DEEP MEADOW
Woodbine
Private

Deep Meadow is a simple country farm house believed to have been constructed as two homes which compose an L plan. It appears on the Hopkins Atlas of 1878 as the property of John Quick but its interior woodwork and stone foundation with log supporting beams bespeak an earlier date.

A two bay wide, one room deep, two story gable roofed early structure now facing west originally faced south while a later three bay wide, two bay deep two story gabled roof structure faces south.

Stone chimneys are placed on the north wall of the original kitchen wing and on the east wall of the addition. A one story shed roofed porch runs along the south elevation of the addition supported by six wooden posts. Lying on the west wall of this second structure is a one story high library addition two bays wide and one room deep with exposed brick chimney on its west wall.

Restoration of and addition to this simple farm house have been carried out sensitively and tastefully by the present owners Mrs. Margaret and Mr. David Zeeveld under the guidance of Mr. John Poe Tyler of the architectural firm of Tyler, Chalfant and McShane.

A restored peg barn lies north of the main house.

MARYLAND HISTORICAL TRUST WORKSHEET

140195304

NOMINATION FORM
for the
NATIONAL REGISTER OF HISTORIC PLACES, NATIONAL PARKS SERVICE

SEE INSTRUCTIONS

1. NAME				
COMMON: Deep Meadow				
AND/OR HISTORIC:				
2. LOCATION				
STREET AND NUMBER: Daisy Road				
CITY OR TOWN: Woodbine				
STATE Maryland		COUNTY: Howard 21797		
3. CLASSIFICATION				
CATEGORY (Check One)		OWNERSHIP		STATUS
<input checked="" type="checkbox"/> District <input type="checkbox"/> Building <input type="checkbox"/> Site <input type="checkbox"/> Structure <input type="checkbox"/> Object		<input type="checkbox"/> Public <input checked="" type="checkbox"/> Private <input type="checkbox"/> Both		<input checked="" type="checkbox"/> Occupied <input type="checkbox"/> Unoccupied <input type="checkbox"/> Preservation work in progress
		Public Acquisition: <input type="checkbox"/> In Process <input type="checkbox"/> Being Considered		ACCESSIBLE TO THE PUBLIC Yes: <input checked="" type="checkbox"/> Restricted <input type="checkbox"/> Unrestricted <input type="checkbox"/> No
PRESENT USE (Check One or More as Appropriate)				
<input checked="" type="checkbox"/> Agricultural <input type="checkbox"/> Commercial <input type="checkbox"/> Educational <input type="checkbox"/> Entertainment		<input type="checkbox"/> Government <input type="checkbox"/> Industrial <input type="checkbox"/> Military <input type="checkbox"/> Museum		<input type="checkbox"/> Park <input checked="" type="checkbox"/> Private Residence <input type="checkbox"/> Religious <input type="checkbox"/> Scientific
		<input type="checkbox"/> Transportation <input type="checkbox"/> Other (Specify) _____		<input type="checkbox"/> Comments _____
4. OWNER OF PROPERTY				
OWNER'S NAME: Margaret Zeeveld				
STREET AND NUMBER: Deep Meadow				
CITY OR TOWN: Woodbine		STATE: Maryland 21797		
5. LOCATION OF LEGAL DESCRIPTION				
COURTHOUSE, REGISTRY OF DEEDS, ETC.: Hall of Records				
STREET AND NUMBER: Howard County Court House				
CITY OR TOWN: Ellicott City		STATE: Maryland 21043		
Title Reference of Current Deed (Book & Pg. #): Maps 13, 14, 20 & 21				
6. REPRESENTATION IN EXISTING SURVEYS p. 61 217-343 104.5 A.				
TITLE OF SURVEY: Howard County Historic Sites Inventory				
DATE OF SURVEY: 1976 <input type="checkbox"/> Federal <input checked="" type="checkbox"/> State <input type="checkbox"/> County <input type="checkbox"/> Local				
DEPOSITORY FOR SURVEY RECORDS: Maryland Historical Trust				
STREET AND NUMBER: 21 State Street				
CITY OR TOWN: Annapolis		STATE: Maryland 21401		

9. SIGNIFICANCE

PERIOD (Check One or More as Appropriate)

<input type="checkbox"/> Pre-Columbian	<input type="checkbox"/> 16th Century	<input type="checkbox"/> 18th Century	<input type="checkbox"/> 20th Century
<input type="checkbox"/> 15th Century	<input type="checkbox"/> 17th Century	<input type="checkbox"/> 19th Century	

SPECIFIC DATE(S) (If Applicable and Known)

AREAS OF SIGNIFICANCE (Check One or More as Appropriate)

<input type="checkbox"/> Aboriginal	<input type="checkbox"/> Education	<input type="checkbox"/> Political	<input type="checkbox"/> Urban Planning
<input type="checkbox"/> Prehistoric	<input type="checkbox"/> Engineering	<input type="checkbox"/> Religion/Phi-	<input type="checkbox"/> Other (Specify)
<input type="checkbox"/> Historic	<input type="checkbox"/> Industry	losophy	_____
<input type="checkbox"/> Agriculture	<input type="checkbox"/> Invention	<input type="checkbox"/> Science	_____
<input type="checkbox"/> Architecture	<input type="checkbox"/> Landscape	<input type="checkbox"/> Sculpture	_____
<input type="checkbox"/> Art	Architecture	<input type="checkbox"/> Social/Human-	_____
<input type="checkbox"/> Commerce	<input type="checkbox"/> Literature	itarian	_____
<input type="checkbox"/> Communications	<input type="checkbox"/> Military	<input type="checkbox"/> Theater	_____
<input type="checkbox"/> Conservation	<input type="checkbox"/> Music	<input type="checkbox"/> Transportation	_____

STATEMENT OF SIGNIFICANCE

Deep Meadow is a simple country farm house which has been fortunate in having owners with taste and sensitivity who have restored it and added in 1970 a comfortable library wing.

It is noted on the Hopkins Atlas of 1878 for Howard County as the property of John Quick, consisting of 104.5 acres.

Restoration work has been carried on by Mr. John Poe Tyler, architect of the Baltimore architectural firm of Tyler, Chalfant & McShane who believes the building was constructed as two homes. Another architect, Mr. Gordon Kennedy, friend of the family, believes the kitchen wing to have been constructed circa 1820. The wide stone chimney which lies on the north wall of the kitchen goes down to the basement and may have been used at the time for cooking or for curing meat.

Deep Meadows real significance is due to the care and thought which has gone into a relatively modest farm house, creating a comfortable and tastefully executed exterior and interior plan which has adhered strictly to the original features and character of the house.

SEE INSTRUCTIONS

Deep Meadow - Description (Continued)

A small carriage house lies northwest of the barn and has a gable roof running north-south with south entrance.

Two spring fed ponds as well as field and forest are located on the property.

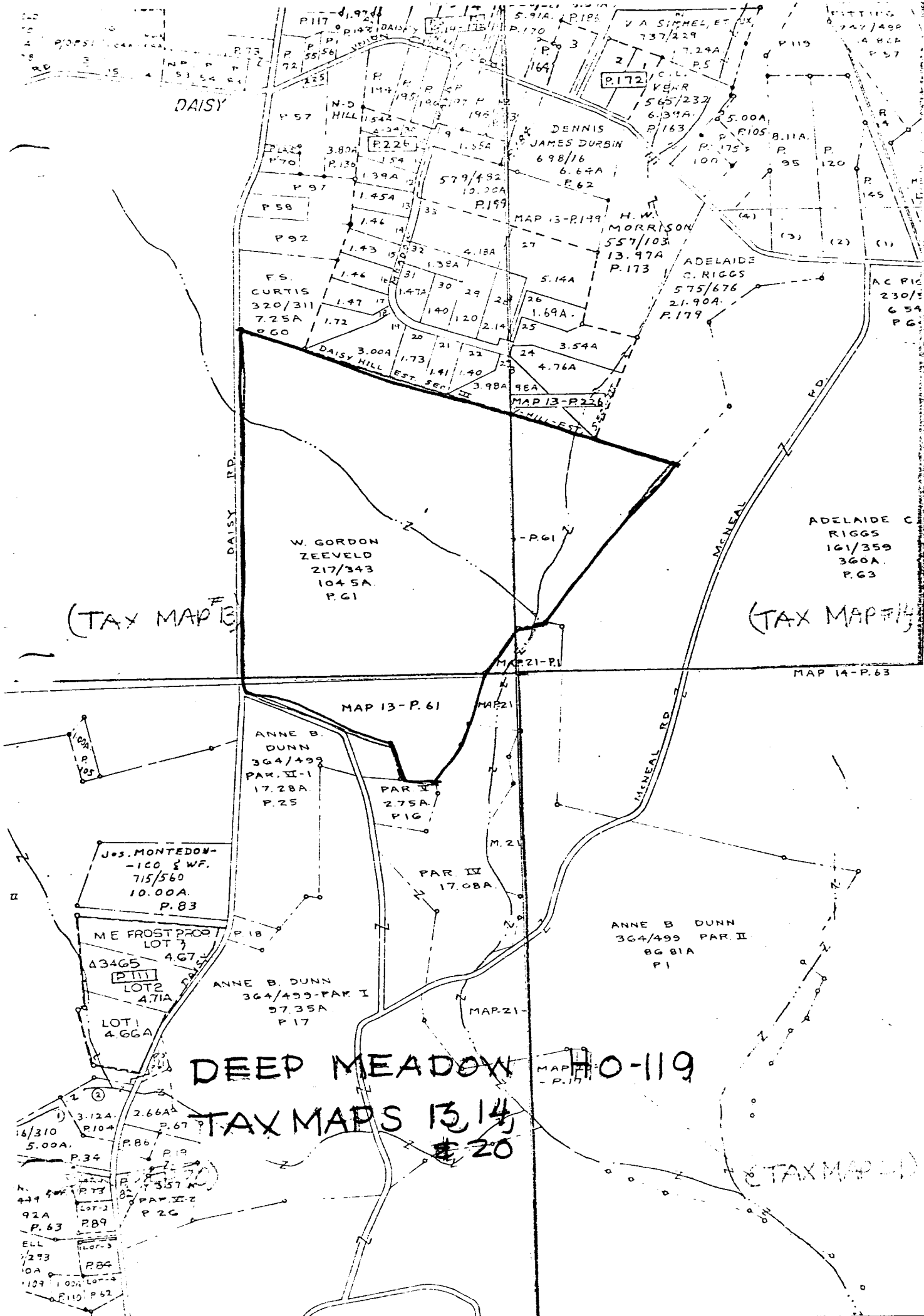

(TAX MAP 13)

(TAX MAP 14)

DEEP MEADOW

TAX MAPS 13, 14

20

(TAX MAP 15)



HO-119 DIST 4
DEEP MEADOW
MHT



HO-119 DIST 4
DEEP MEADOW
BARN

MHT