

HO-103

The Charles Layton, Jr. Log Building

Woodbine

Private

nineteenth century

This log building faces west on the east side of St. Michael's Road at its intersection with Florence Road. It features a central east and west entrance with small six over-three light window north of the west entrance. The building has settled so that only half of the east entrance is seen.

Built by the Bowman family, it was later used by the Pickett family who raised a family of five or six children in this log building. As they prospered a frame house was constructed north of the log house.

This new house of the late nineteenth century saw additions in the first decade of the twentieth so that it stands today as a three bay wide, one room deep, two story high, gabled roof (running north-south) frame house with two story high, intersecting gable roof (running east-west) Kitchen wing off the east wall of the house.

A large 1903 barn, resting on a stone foundation, lies on the west side of St. Michael's Road with a century old log tobacco shed encased within an auxiliary farm building.

INVENTORY FORM FOR STATE HISTORIC SITES SURVEY

**1 NAME**

HISTORIC  
Charles Layton, Jr. Log Building

AND/OR COMMON

**2 LOCATION**

STREET & NUMBER  
E. S. St. Michaels Road

CITY, TOWN  
Woodbine

\_\_\_ VICINITY OF

CONGRESSIONAL DISTRICT  
6th

STATE  
Maryland

COUNTY  
Howard

**3 CLASSIFICATION**

CATEGORY	OWNERSHIP	STATUS	PRESENT USE
<input checked="" type="checkbox"/> DISTRICT	<input type="checkbox"/> PUBLIC	<input checked="" type="checkbox"/> OCCUPIED	<input type="checkbox"/> AGRICULTURE <input type="checkbox"/> MUSEUM
<input type="checkbox"/> BUILDING(S)	<input checked="" type="checkbox"/> PRIVATE	<input type="checkbox"/> UNOCCUPIED	<input type="checkbox"/> COMMERCIAL <input type="checkbox"/> PARK
<input type="checkbox"/> STRUCTURE	<input type="checkbox"/> BOTH	<input type="checkbox"/> WORK IN PROGRESS	<input type="checkbox"/> EDUCATIONAL <input type="checkbox"/> PRIVATE RESIDENCE
<input type="checkbox"/> SITE	<b>PUBLIC ACQUISITION</b>	<b>ACCESSIBLE</b>	<input type="checkbox"/> ENTERTAINMENT <input type="checkbox"/> RELIGIOUS
<input type="checkbox"/> OBJECT	<input type="checkbox"/> IN PROCESS	<input checked="" type="checkbox"/> YES RESTRICTED	<input type="checkbox"/> GOVERNMENT <input type="checkbox"/> SCIENTIFIC
	<input type="checkbox"/> BEING CONSIDERED	<input type="checkbox"/> YES UNRESTRICTED	<input type="checkbox"/> INDUSTRIAL <input type="checkbox"/> TRANSPORTATION
		<input type="checkbox"/> NO	<input checked="" type="checkbox"/> OTHER Auxiliary Bldg.
			<input type="checkbox"/> MILITARY

**4 OWNER OF PROPERTY**

NAME  
Mr. Charles F. Layton, Jr.

Telephone #:

STREET & NUMBER  
E.S. St. Michaels Road

CITY, TOWN  
Woodbine

\_\_\_ VICINITY OF

STATE, zip code  
Maryland 21797

**5 LOCATION OF LEGAL DESCRIPTION**

COURTHOUSE,  
REGISTRY OF DEEDS, ETC. Hall of Records

Liber #: 156  
Folio #: 111  
Tax Map 7 page 112

STREET & NUMBER  
Howard County Court House

CITY, TOWN

Ellicott City

STATE

Maryland

**6 REPRESENTATION IN EXISTING SURVEYS**

TITLE  
Howard County Historic Sites Inventory

DATE  
1978-1979

\_\_\_ FEDERAL  STATE \_\_\_ COUNTY \_\_\_ LOCAL

DEPOSITORY FOR  
SURVEY RECORDS Maryland Historical Trust

CITY, TOWN

21 State Circle, Annapolis

STATE

Maryland

**7 DESCRIPTION**

<b>CONDITION</b>		<b>CHECK ONE</b>		<b>CHECK ONE</b>	
<input type="checkbox"/> EXCELLENT	<input checked="" type="checkbox"/> DETERIORATED	<input checked="" type="checkbox"/> UNALTERED	<input checked="" type="checkbox"/> ORIGINAL SITE	<input type="checkbox"/> MOVED	DATE _____
<input checked="" type="checkbox"/> GOOD	<input type="checkbox"/> RUINS	<input type="checkbox"/> ALTERED			
<input checked="" type="checkbox"/> FAIR	<input type="checkbox"/> UNEXPOSED				

**DESCRIBE THE PRESENT AND ORIGINAL (IF KNOWN) PHYSICAL APPEARANCE**

The Charles Layton, Jr. Log Building faces west on the east side of St. Michaels' Road at its intersection with Florence Road. Originally used as a residence, it was later used for a summer kitchen and presently is used for storage and is in fair to deteriorated condition.

It is a single room with loft above, gabled roof (running north-south) early nineteenth century log structure. Its west elevation features a central batten wood door to whose northside rests a single, rectangular window with two-over-three lights which was originally a six-over-three light window. The hand hewn logs are overlaid at the corners and are filled with a composition of stone and mortar.

The building has settled considerably on the east elevation where a central entrance is only half exposed. A wood shed off its north wall connects the log building to a batten wood, one story high, gabled roof (running east-west) structure. A central loft window with no sash is placed on the south elevation.

North of the log building lies the house, built after the log cabin, sometime in the late nineteenth century. Initially it consisted of one room with second floor above. A living room was added to its north wall and a kitchen off the east wall of the living room some seventy years ago, circa 1910.

Today the house faces west and is a three bay wide, one room deep, two story high, gabled roof (running north-south) frame structure with square brick chimney rising from the north wall of its original room, between the south and central bays. A two story high, two bay wide, one room deep, intersecting gable roof (running east-west) frame kitchen wing forms an "L" off the central and north bay of the buildings east wall. A square brick chimney is inset into the kitchen's east wall whose north and south walls hold rectangular entrances; that on the north is covered by a gabled roof portico; that on the south by a small second floor porch, linking a shed roofed addition to the south wall of the kitchen wing, whose north elevation holds a first and second floor six-over-six light window with four light attic casement window above.

The south elevation of the original part of the house holds a first and second floor, two-over-two light window with four light attic casement window above and a cellar door inset into the stone foundation. Along the entire west elevation of the house is a one story high, shed roofed, open porch, supported by four square posts to which three wide steps lead.

Northwest of the house on the west side of St. Michael's Road lies a large two story high frame barn, resting on a stone foundation. Just north east of the barn, on the same side of the road, is a century old log tobacco shed, from whose center grows a and around which has been constructed an auxiliary frame building, resting on a stone foundation.

CONTINUE ON SEPARATE SHEET IF NECESSARY

PERIOD		AREAS OF SIGNIFICANCE -- CHECK AND JUSTIFY BELOW				
<input type="checkbox"/> PREHISTORIC	<input type="checkbox"/> ARCHEOLOGY-PREHISTORIC	<input type="checkbox"/> COMMUNITY PLANNING	<input type="checkbox"/> LANDSCAPE ARCHITECTURE	<input type="checkbox"/> RELIGION		
<input type="checkbox"/> 1400-1499	<input type="checkbox"/> ARCHEOLOGY-HISTORIC	<input type="checkbox"/> CONSERVATION	<input type="checkbox"/> LAW	<input type="checkbox"/> SCIENCE		
<input type="checkbox"/> 1500-1599	<input checked="" type="checkbox"/> AGRICULTURE	<input type="checkbox"/> ECONOMICS	<input type="checkbox"/> LITERATURE	<input type="checkbox"/> SCULPTURE		
<input type="checkbox"/> 1600-1699	<input checked="" type="checkbox"/> ARCHITECTURE	<input type="checkbox"/> EDUCATION	<input type="checkbox"/> MILITARY	<input type="checkbox"/> SOCIAL/HUMANITARIAN		
<input type="checkbox"/> 1700-1799	<input type="checkbox"/> ART	<input type="checkbox"/> ENGINEERING	<input type="checkbox"/> MUSIC	<input type="checkbox"/> THEATER		
<input checked="" type="checkbox"/> 1800-1899	<input type="checkbox"/> COMMERCE	<input type="checkbox"/> EXPLORATION/SETTLEMENT	<input type="checkbox"/> PHILOSOPHY	<input type="checkbox"/> TRANSPORTATION		
<input type="checkbox"/> 1900-	<input type="checkbox"/> COMMUNICATIONS	<input type="checkbox"/> INDUSTRY	<input type="checkbox"/> POLITICS/GOVERNMENT	<input checked="" type="checkbox"/> OTHER (SPECIFY)		local history
		<input type="checkbox"/> INVENTION				

SPECIFIC DATES early nineteenth century BUILDER/ARCHITECT

**STATEMENT OF SIGNIFICANCE**

The Charles Layton, Jr. Log Building is significant architecturally and historically to Howard County and the state of Maryland.

Architecturally it is noteworthy as an example of a log dwelling house of the early nineteenth century which was inhabited by families who raised as many as five and six children here. The rough hewn oak and chestnut logs were formed by hand and overlaid at the corners. Stones and a dried mud-like mortar form the chinking between the logs. Though the building has settled to such an extent that its central east door is only half evident, the building is not beyond repair and is still in use for storage.

The wide random width boards which form the lofts' floor can be seen as well as the rough hewn ceiling joists. The building has a central west entrance with two-over-three light window, which originally held six-over-three lights.

The work done in restoring old log buildings by several Howard Countians insures the feasibility of the restoration of this log dwelling house, whose association with the Pickett and Bowman families of Howard County give it historical as well as architectural significance.

Not only the log house, but the adjoining residence of Mr. Layton, a late nineteenth century house with later additions, and the large frame barn built on a stone foundation and the century old tobacco barn encased within an auxiliary building north east of the barn should be included in any recommendation for inclusion to the National Register of Historic Places.

CONTINUE ON SEPARATE SHEET IF NECESSARY

**9 MAJOR BIBLIOGRAPHICAL REFERENCES**

N.R. Field Sheet. Maryland  
Historical Trust 7/20/70

CONTINUE ON SEPARATE SHEET IF NECESSARY

**10 GEOGRAPHICAL DATA**

ACREAGE OF NOMINATED PROPERTY 40.85 Tax Map 7 Page 112

Please see Attachment 1, Tax Map 7 p.112

VERBAL BOUNDARY DESCRIPTION

Please see Howard County Land Records, Liber 156 Folio 111

LIST ALL STATES AND COUNTIES FOR PROPERTIES OVERLAPPING STATE OR COUNTY BOUNDARIES

STATE Maryland COUNTY Howard

STATE \_\_\_\_\_ COUNTY \_\_\_\_\_

**11 FORM PREPARED BY**

NAME / TITLE

Cleora Barnes Thompson, Archivist

ORGANIZATION

Office of Planning & Zoning-Comprehensive Planning Section

DATE

465-5000 x257

STREET & NUMBER

3450 Court House Drive

TELEPHONE

CITY OR TOWN

Ellicott City

STATE

Maryland

The Maryland Historic Sites Inventory was officially created by an Act of the Maryland Legislature, to be found in the Annotated Code of Maryland, Article 41, Section 181 KA, 1974 Supplement.

The Survey and Inventory are being prepared for information and record purposes only and do not constitute any infringement of individual property rights.

RETURN TO: Maryland Historical Trust  
The Shaw House, 21 State Circle  
Annapolis, Maryland 21401  
(301) 267-1438

HO-103

Charles Layton Jr Log bldg.  
St. Michael's Road  
beside a farm house located  
at the intersection with Florence Rd.

by MOB 7/20/70

for Map # 7

Chas. F. Layton Jr.

126/572

37.81 A.

p. 112

Old Reg.

1401035304  
HO 103

Form 10-300  
(Dec. 1968)

UNITED STATES DEPARTMENT OF THE INTERIOR  
NATIONAL PARK SERVICE

N. R. FIELD SHEET

STATE:	
COUNTY:	
FOR NPS USE ONLY	
ENTRY NUMBER	DATE

### NATIONAL REGISTER OF HISTORIC PLACES INVENTORY - NOMINATION FORM

(Type all entries - complete applicable sections)

MD. HISTORICAL TRUST  
BOX 1704  
ANNAPOLIS, MD. 21404

**1. NAME**

COMMON: CHARLES LAYTON, JR., 206 BUILDING

AND/OR HISTORIC:

**2. LOCATION**

STREET AND NUMBER:

CITY OR TOWN:

STATE: md CODE: COUNTY: HOWARD CODE:

**3. CLASSIFICATION**

CATEGORY (Check One)	OWNERSHIP	STATUS	ACCESSIBLE TO THE PUBLIC
District <input type="checkbox"/> Building <input checked="" type="checkbox"/>	Public <input type="checkbox"/>	Occupied <input type="checkbox"/>	Yes: <input type="checkbox"/>
Site <input type="checkbox"/> Structure <input type="checkbox"/>	Private <input checked="" type="checkbox"/>	In Process <input type="checkbox"/>	Restricted <input type="checkbox"/>
Object <input type="checkbox"/>	Both <input type="checkbox"/>	Being Considered <input type="checkbox"/>	Unrestricted <input type="checkbox"/>
		Preservation work in progress <input type="checkbox"/>	No: <input type="checkbox"/>

PRESENT USE (Check One or More as Appropriate)

Agricultural <input type="checkbox"/>	Government <input type="checkbox"/>	Park <input type="checkbox"/>	Transportation <input type="checkbox"/>	Comments <input type="checkbox"/>
Commercial <input type="checkbox"/>	Industrial <input type="checkbox"/>	Private Residence <input type="checkbox"/>	Other (Specify) <input checked="" type="checkbox"/>	
Educational <input type="checkbox"/>	Military <input type="checkbox"/>	Religious <input type="checkbox"/>	<u>Storage</u>	
Entertainment <input type="checkbox"/>	Museum <input type="checkbox"/>	Scientific <input type="checkbox"/>		

**4. OWNER OF PROPERTY**

OWNERS NAME: Charles Layton, Jr.

STREET AND NUMBER:

CITY OR TOWN: STATE: md. CODE:

**5. LOCATION OF LEGAL DESCRIPTION**

COURTHOUSE, REGISTRY OF DEEDS, ETC.: Howard Co.

STREET AND NUMBER:

CITY OR TOWN: Elicott City STATE: md CODE:

ACREAGE APPROXIMATE ACREAGE OF NOMINATED PROPERTY:

**6. REPRESENTATION IN EXISTING SURVEYS**

TITLE OF SURVEY:

DATE OF SURVEY: Federal  State  County  Local

DEPOSITORY FOR SURVEY RECORDS:

STREET AND NUMBER:

CITY OR TOWN: STATE: CODE:

STATE:  
COUNTY:  
ENTRY NUMBER  
DATE

FOR NPS USE ONLY

7. DESCRIPTION

CONDITION	(Check One)					
	Excellent <input type="checkbox"/>	Good <input type="checkbox"/>	Fair <input type="checkbox"/>	Deteriorated <input type="checkbox"/>	Ruins <input type="checkbox"/>	Unexposed <input type="checkbox"/>
INTEGRITY	(Check One)			(Check One)		
	Altered <input type="checkbox"/>	Unaltered <input type="checkbox"/>		Moved <input type="checkbox"/>	Original Site <input type="checkbox"/>	

DESCRIBE THE PRESENT AND ORIGINAL (if known) PHYSICAL APPEARANCE

This early 19th log structure, situated in close proximity to the circa 1900 dwelling of Mr Layton, is of 1 1/4 storeys with an A frame roof running N-S.

at the W elevation is a centered batten door flanked by a single window of 6/3 pane sash.

The logs are overlaid at the corners, are very crudely hewn, and are chinked with a composition of stone and mortar.

Poor condition

FOR THE USE OF THE BUREAU



8. SIGNIFICANCE

PERIOD (Check One or More as Appropriate)

- Pre-Columbian       16th Century       18th Century       20th Century
- 15th Century       17th Century       19th Century

SPECIFIC DATE(S) (If Applicable and Known)

AREAS OF SIGNIFICANCE (Check One or More as Appropriate)

- |   |                                       |  |  |
|---|---------------------------------------|--|--|
| Aboriginal <input type="checkbox"/>     | Education <input type="checkbox"/>    | Political <input type="checkbox"/>           | Urban Planning <input type="checkbox"/>  |
| Prehistoric <input type="checkbox"/>    | Engineering <input type="checkbox"/>  | Religion/Philosophy <input type="checkbox"/> | Other (Specify) <input type="checkbox"/> |
| Historic <input type="checkbox"/>       | Industry <input type="checkbox"/>     | Science <input type="checkbox"/>             | _____                                    |
| Agriculture <input type="checkbox"/>    | Invention <input type="checkbox"/>    | Sculpture <input type="checkbox"/>           | _____                                    |
| Art <input type="checkbox"/>            | Landscape <input type="checkbox"/>    | Social/Humanitarian <input type="checkbox"/> | _____                                    |
| Commerce <input type="checkbox"/>       | Architecture <input type="checkbox"/> | Theater <input type="checkbox"/>             | _____                                    |
| Communications <input type="checkbox"/> | Literature <input type="checkbox"/>   | Transportation <input type="checkbox"/>      | _____                                    |
| Conservation <input type="checkbox"/>   | Military <input type="checkbox"/>     |  | _____                                    |
| Architecture <input type="checkbox"/>   | Music <input type="checkbox"/>        |  | _____                                    |

STATEMENT OF SIGNIFICANCE (Include Personages, Dates, Events, Etc.)

*(This section contains a large grid for handwritten text, which is mostly illegible due to fading and bleed-through from the reverse side of the page.)*

9. MAJOR BIBLIOGRAPHICAL REFERENCES

<input type="checkbox"/>	<input type="checkbox"/>	<input type="checkbox"/>	<input type="checkbox"/>	<input type="checkbox"/>
<input type="checkbox"/>	<input type="checkbox"/>	<input type="checkbox"/>	<input type="checkbox"/>	<input type="checkbox"/>
<input type="checkbox"/>	<input type="checkbox"/>	<input type="checkbox"/>	<input type="checkbox"/>	<input type="checkbox"/>
<input type="checkbox"/>	<input type="checkbox"/>	<input type="checkbox"/>	<input type="checkbox"/>	<input type="checkbox"/>
<input type="checkbox"/>	<input type="checkbox"/>	<input type="checkbox"/>	<input type="checkbox"/>	<input type="checkbox"/>
<input type="checkbox"/>	<input type="checkbox"/>	<input type="checkbox"/>	<input type="checkbox"/>	<input type="checkbox"/>
<input type="checkbox"/>	<input type="checkbox"/>	<input type="checkbox"/>	<input type="checkbox"/>	<input type="checkbox"/>
<input type="checkbox"/>	<input type="checkbox"/>	<input type="checkbox"/>	<input type="checkbox"/>	<input type="checkbox"/>
<input type="checkbox"/>	<input type="checkbox"/>	<input type="checkbox"/>	<input type="checkbox"/>	<input type="checkbox"/>
<input type="checkbox"/>	<input type="checkbox"/>	<input type="checkbox"/>	<input type="checkbox"/>	<input type="checkbox"/>

10. GEOGRAPHICAL DATA

LATITUDE AND LONGITUDE COORDINATES DEFINING A RECTANGLE LOCATING THE PROPERTY			O R	LATITUDE AND LONGITUDE COORDINATES DEFINING THE CENTER POINT OF A PROPERTY OF LESS THAN ONE ACRE		
CORNER	LATITUDE	LONGITUDE		LATITUDE	LONGITUDE	
	Degrees Minutes Seconds	Degrees Minutes Seconds		Degrees Minutes Seconds	Degrees Minutes Seconds	
NW	° ' "	° ' "		° ' "	° ' "	
NE	° ' "	° ' "		° ' "	° ' "	
SE	° ' "	° ' "		° ' "	° ' "	
SW	° ' "	° ' "		° ' "	° ' "	

LIST ALL STATES AND COUNTIES FOR PROPERTIES OVERLAPPING STATE OR COUNTY BOUNDARIES

STATE:	CODE	COUNTY	CODE
STATE:	CODE	COUNTY:	CODE
STATE:	CODE	COUNTY:	CODE
STATE:	CODE	COUNTY:	CODE

11. FORM PREPARED BY

NAME AND TITLE: Rivore

ORGANIZATION: MTT DATE: 3/71

STREET AND NUMBER:

CITY OR TOWN: STATE: CODE:

12. STATE LIAISON OFFICER CERTIFICATION

As the designated State Liaison Officer for the National Historic Preservation Act of 1966 (Public Law 89-665), I hereby nominate this property for inclusion in the National Register and certify that it has been evaluated according to the criteria and procedures set forth by the National Park Service. The recommended level of significance of this nomination is:

National  State  Local

Name \_\_\_\_\_

Title \_\_\_\_\_

Date \_\_\_\_\_

NATIONAL REGISTER VERIFICATION

I hereby certify that this property is included in the National Register.

\_\_\_\_\_  
Chief, Office of Archeology and Historic Preservation

Date \_\_\_\_\_

ATTEST:

\_\_\_\_\_  
Keeper of The National Register

Date \_\_\_\_\_

6

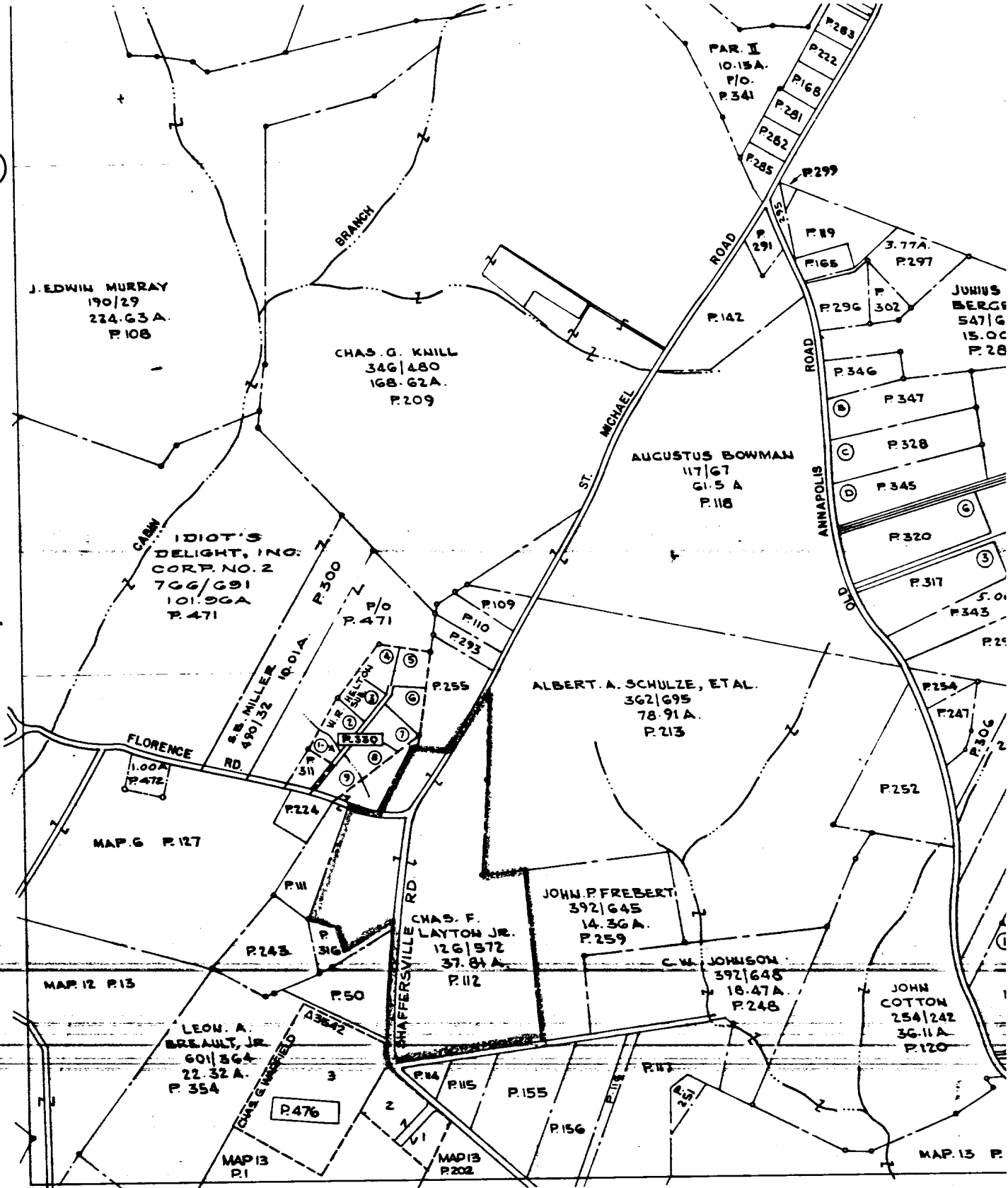

Attachment 1  
 HO-103  
 The Charles F. Layton, Jr.  
 Log House  
 Tax Map 7

SCALE  
 1"=800'

PUBLISHED  
 1977

HO-103

MAP COORDINATE  
 NUMBER SE

1	2	3	4
7	8	9	10
13	14	15	16
19	20	21	22

HAGERSTOWN 42 MI.  
FREDERICK 40 MI.

39° 21' 00" N  
52.5  
45  
37.5  
39° 20' 30" N  
52.5  
45  
39° 20' 00" N  
52.5  
45  
39° 19' 30" N  
52.5  
45  
39° 19' 00" N  
52.5  
45  
39° 18' 30" N  
52.5  
45  
39° 18' 00" N

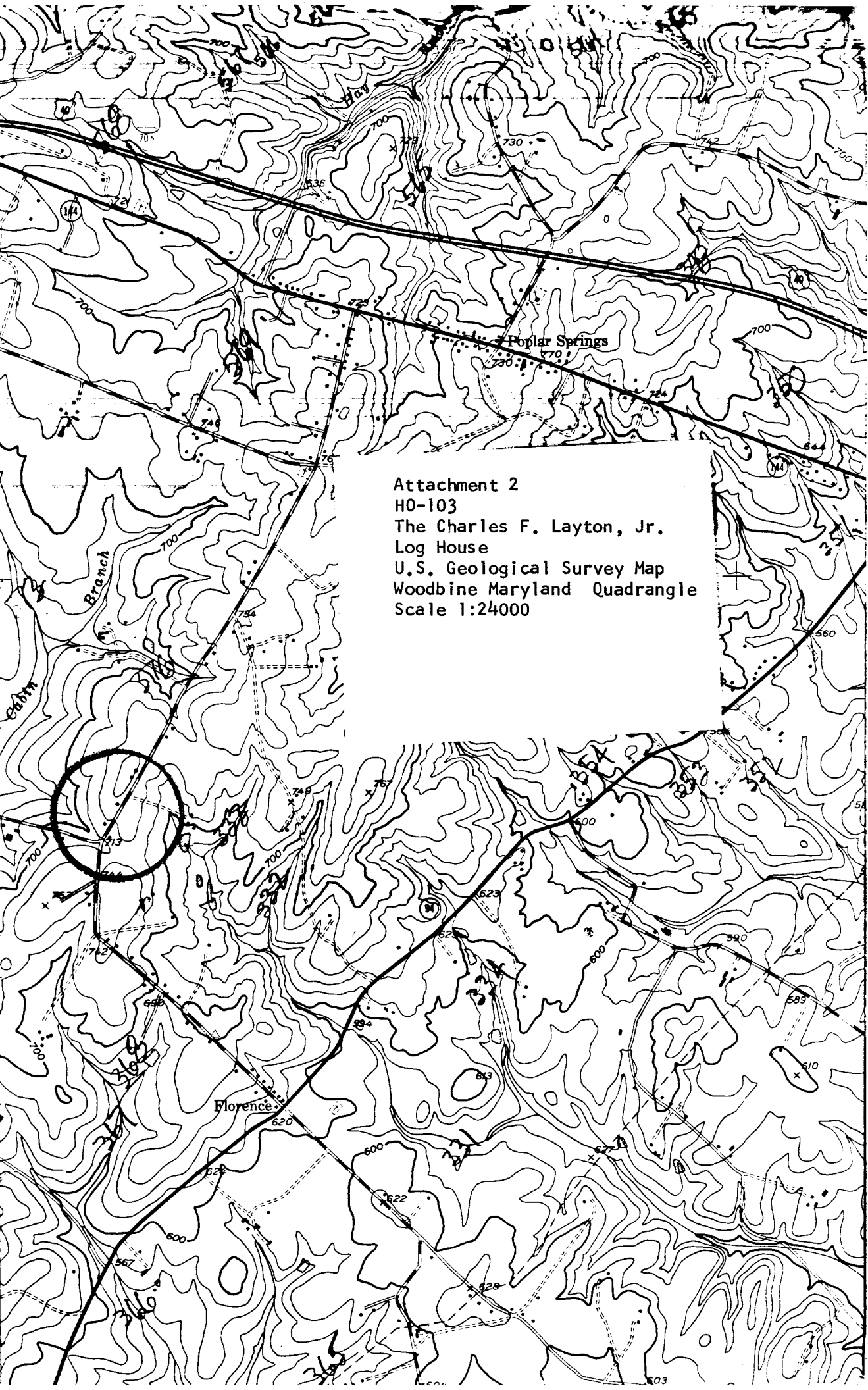

Attachment 2  
H0-103  
The Charles F. Layton, Jr.  
Log House  
U.S. Geological Survey Map  
Woodbine Maryland Quadrangle  
Scale 1:24000



HO.103

775A

JSE May 72

Charles Layton's log house



HG-103  
CHARLES' WAYTON'S LOG HOUSE  
EAST

CLEORA THOMPSON, AIP  
AUGUST - 1978