

HO-76

ST. PAUL'S SCHOOL or PATAPSCO NATIONAL BANK

Circa 1840

Ellicott City

Private

Two full stories rise from the full basement foundation of this three bay wide, three bay deep tent roofed granite block structure with central first floor entrances on the north and west and similar single gabled roof dormer windows at each elevation. A third floor east entrance is covered by a one story high screened-in porch on its east wall. It is of historical merit for its use by the first bank in Ellicott Mills, the Patapsco National Bank and later for its use as the first parochial school, St. Paul's.

MARYLAND HISTORICAL TRUST WORKSHEET

NOMINATION FORM
for the
NATIONAL REGISTER OF HISTORIC PLACES, NATIONAL PARKS SERVICE

1. NAME				
COMMON: St. Paul's School, St. Paul's Catholic School				
AND/OR HISTORIC: West Ilchester, Patapsco National Bank				
2. LOCATION				
STREET AND NUMBER: St. Paul Street				
CITY OR TOWN: Ellicott City				
STATE: Maryland			COUNTY: Howard	
3. CLASSIFICATION				
CATEGORY <i>(Check One)</i>	OWNERSHIP		STATUS	ACCESSIBLE TO THE PUBLIC
<input checked="" type="checkbox"/> District <input type="checkbox"/> Building <input type="checkbox"/> Site <input type="checkbox"/> Structure <input type="checkbox"/> Object	<input type="checkbox"/> Public <input checked="" type="checkbox"/> Private <input type="checkbox"/> Both	Public Acquisition: <input type="checkbox"/> In Process <input type="checkbox"/> Being Considered	<input type="checkbox"/> Occupied <input checked="" type="checkbox"/> Unoccupied <input type="checkbox"/> Preservation work in progress	Yes: <input checked="" type="checkbox"/> Restricted <input type="checkbox"/> Unrestricted <input type="checkbox"/> No
PRESENT USE <i>(Check One or More as Appropriate)</i>				
<input type="checkbox"/> Agricultural	<input type="checkbox"/> Government	<input type="checkbox"/> Park	<input type="checkbox"/> Transportation	<input type="checkbox"/> Comments
<input type="checkbox"/> Commercial	<input type="checkbox"/> Industrial	<input type="checkbox"/> Private Residence	<input checked="" type="checkbox"/> Other (Specify) Vacant	_____
<input type="checkbox"/> Educational	<input type="checkbox"/> Military	<input type="checkbox"/> Religious	_____	_____
<input type="checkbox"/> Entertainment	<input type="checkbox"/> Museum	<input type="checkbox"/> Scientific	_____	_____
4. OWNER OF PROPERTY				
OWNER'S NAME: St. Paul's Church				
STREET AND NUMBER: College Avenue				
CITY OR TOWN: Ellicott City			STATE: Maryland	
			21043	
5. LOCATION OF LEGAL DESCRIPTION				
COURTHOUSE, REGISTRY OF DEEDS, ETC.: Hall of Records				
STREET AND NUMBER: Howard County Courthouse				
CITY OR TOWN: Ellicott City			STATE: Maryland	
			21043	
Title Reference of Current Deed (Book & Pg. #): See Tax Map 25				
6. REPRESENTATION IN EXISTING SURVEYS				
TITLE OF SURVEY: Howard County Historic Sites Inventory				
DATE OF SURVEY: 1977 <input type="checkbox"/> Federal <input checked="" type="checkbox"/> State <input type="checkbox"/> County <input type="checkbox"/> Local				
DEPOSITORY FOR SURVEY RECORDS: Maryland Historical Trust				
STREET AND NUMBER: 21 State Circle				
CITY OR TOWN: Annapolis			STATE: Maryland	
			21401	

SEE INSTRUCTIONS

7. DESCRIPTION

CONDITION	(Check One)					
	<input checked="" type="checkbox"/> Excellent	<input type="checkbox"/> Good	<input type="checkbox"/> Fair	<input type="checkbox"/> Deteriorated	<input type="checkbox"/> Ruins	<input type="checkbox"/> Unexposed
	(Check One)			(Check One)		
	<input type="checkbox"/> Altered	<input checked="" type="checkbox"/> Uncolored		<input type="checkbox"/> Moved	<input checked="" type="checkbox"/> Original Site	

DESCRIBE THE PRESENT AND ORIGINAL (if known) PHYSICAL APPEARANCE

St. Paul's School is a three and a half story, three bay deep, five bay wide ashlar granite stone hipped roof structure with single gabled roof dormers centered into each elevation of the roof line.

The granite exterior is accented by flat stone lintels, projecting stone sills and a stone belt course separating the ground or full basement floor from the "primiere etage". The other significant architectural element of the building, the central bay entrances, are located on the north, and west elevations. The north entrance is flanked by stone pilasters. Twelve granite steps set into a ashlar stone base and flanked by a decorative wrought iron railing lead to this entrance. A cornice crowns the doorway which is surmounted by a square flat stone lintel.

The west entrance is covered by a hipped roof portico supported by four square columns and two pilasters applied to the west wall on either side of the central entrance which has been encased by a vestibule which has nine lite double doors surmounted by six lite transoms. Side panels also have nine lites surmounted by six lite transoms. Twelve iron stairs lead to the portico's landing which is encompassed by a wooden railing decorated with a diamond pattern. The portico rests on four stone pillars which form an open porch for the ground floor entrance located beneath the porticoed west entrance.

Symmetrical fenestration, vertically aligned from first to third floors, punctuates the facade. The windows are double-hung with six-over-six lights. Double dormer windows on the west elevation is topped by a single pointed pediment, centered in the hipped roof, with pilasters applied on either side of and between each dormer window. Two separate dormer windows on the north and south elevations are topped by a single pointed pediment, centered into the hipped roof with pilasters applied on either side of each dormer window.

A simple wooden cornice adorns the roof line. In addition to the dormers, small square twin chimneys located on the north and south side of the hipped roof line are the other significant features of the building profile. An exterior square brick chimney with wide stone base is located on the south wall of the building.

The east elevation holds a tripartite dormer window. Each section is double hung with two-over-two lites except the north side which holds one-over-one lites.

The ground floor holds no apertures. The second floor holds three rectangular double-hung windows while the third floor holds a central entrance with a hipped roof screened-in porch running along the major part of the third floor east elevation, approached by a flight of wooden steps on the south side of the east wall.

SEE INSTRUCTIONS

8. SIGNIFICANCE

PERIOD (Check One or More as Appropriate)

<input type="checkbox"/> Pre-Columbian	<input type="checkbox"/> 16th Century	<input type="checkbox"/> 18th Century	<input type="checkbox"/> 20th Century
<input type="checkbox"/> 15th Century	<input type="checkbox"/> 17th Century	<input checked="" type="checkbox"/> 19th Century	

SPECIFIC DATE(S) (If Applicable and Known) C. 1840

AREAS OF SIGNIFICANCE (Check One or More as Appropriate)

<input type="checkbox"/> Aboriginal	<input checked="" type="checkbox"/> Education	<input type="checkbox"/> Political	<input type="checkbox"/> Urban Planning
<input type="checkbox"/> Prehistoric	<input type="checkbox"/> Engineering	<input checked="" type="checkbox"/> Religion/Phi-	<input type="checkbox"/> Other (Specify)
<input checked="" type="checkbox"/> Historic	<input type="checkbox"/> Industry	osophy	_____
<input type="checkbox"/> Agriculture	<input type="checkbox"/> Invention	<input type="checkbox"/> Science	_____
<input checked="" type="checkbox"/> Architecture	<input type="checkbox"/> Landscape	<input type="checkbox"/> Sculpture	_____
<input type="checkbox"/> Art	Architecture	<input type="checkbox"/> Social/Human-	_____
<input type="checkbox"/> Commerce	<input type="checkbox"/> Literature	itarian	_____
<input type="checkbox"/> Communications	<input type="checkbox"/> Military	<input type="checkbox"/> Theater	_____
<input type="checkbox"/> Conservation	<input type="checkbox"/> Music	<input type="checkbox"/> Transportation	_____

STATEMENT OF SIGNIFICANCE

St. Paul's Catholic School was the first parochial school in Ellicott City. It was begun through the efforts of Father Ryan (see also St. Paul's Church H0-348 and St. Paul's Rectory H0-347) who acquired the old Patapsco National Bank building on St. Paul Street to use to house the school which opened on September 11, 1922 for seventy-five pupils. Begun with six grades in 1922, in 1923 and 1924 a grade was added to cover eight grades. Twelve students graduated on June 12, 1925.

The School Sisters of Notre Dame staffed the school, whose excellency in academic training was reflected by a student receiving Archbishops Scholarships to a Catholic high school each of the first two years of its opening: Margaret Miller and James Lilley, the latter attending Mt. Joseph's in Baltimore.

A new school with modern facilities located off St. John's Lane north of Route 40 opened its doors on September 8, 1966, due to the efforts of the present rector, Father Dohony. It is now called Resurrection School. It accomodates more than 350 students with Sister Mary Kevin S.S.N.P. serving as its first principal. Eight months later mass was said in its auditorium for the first time with a schedule of 8, 10, and 12:30 masses.

In the Master Plan for Ellicott City working papers it was noted that the old St. Paul's Parochial School, originally built as the Patapsco National Bank, the first bank in Ellicott City was vacant, and in disrepair. It was noted that reuse of the building as professional office space is being given primary consideration though considerable renovation costs must be incurred to bring the building up to code. The space could be adapted for other uses if desired.

In deed book two of the Howard County Land Records office, an old Plat showing the Patapsco National Bank building on the present site dates the building to circa 1840.

The building is basically a simple granite structure with first floor entrance on the north and west. Gabled roof dormers on each elevation lend a further symmetry to a basically square building.

Associated with the early commercial activities of Ellicott Mills as well as serving as its first Catholic parochial school, this building has exceptional historical significance for Howard County and should be placed

SEE INST. ACTIONS

ST. PAUL'S CATHOLIC SCHOOL
SIGNIFICANCE CONT.

on the National Register of Historic Places, included in the State Critical Area Program and incorporated into any future local landmark legislation.

9. MAJOR BIBLIOGRAPHICAL REFERENCES

Holland, Celia. Ellicott City, Maryland Mill Town, U.S.A. 1772-1972. Bladensburg, 1972.

Howard County Records Office.

10. GEOGRAPHICAL DATA

LATITUDE AND LONGITUDE COORDINATES DEFINING A RECTANGLE LOCATING THE PROPERTY			O R	LATITUDE AND LONGITUDE COORDINATES DEFINING THE CENTER POINT OF A PROPERTY OF LESS THAN TEN ACRES		
CORNER	LATITUDE	LONGITUDE		LATITUDE	LONGITUDE	
	Degrees Minutes Seconds	Degrees Minutes Seconds		Degrees Minutes Seconds	Degrees Minutes Seconds	
NW	° ' "	° ' "		° ' "	° ' "	
NE	° ' "	° ' "		° ' "	° ' "	
SE	° ' "	° ' "		° ' "	° ' "	
SW	° ' "	° ' "		° ' "	° ' "	

APPROXIMATE ACREAGE OF NOMINATED PROPERTY:

Acreage Justification:

See Tax Map 25,
p. 61 3-221

SEE INSTRUCTIONS

11. FORM PREPARED BY

NAME AND TITLE: Cleora Barnes Thompson, Archivist		
ORGANIZATION Comprehensive Planning Section	DATE	
STREET AND NUMBER: 3450 Courthouse Drive		
CITY OR TOWN: Ellicott City	STATE Maryland	21043

12. State Liaison Officer Review: (Office Use Only)

Significance of this property is:

National State Local

Signature _____

PATAPSCO

OHO AND BALTIMORE

R/R STATION

MARYLAND STREET

AVE.

TIBER STREET

PAUL STREET

PAUL PL.

COLLEGE RD

ROSS RD

ST PAUL'S SCHOOL
213/296
P. 61

ST PAUL'S CATHOLIC CHURCH
342/146
P. 121

SAMUEL M. CAPLAN
117/24
P. 120

PARKING LOT FOR CHURCH

JOHN A. HINEGARDNER
473/109
P. 117

SAMUEL M. CAPLAN
240/85
P. 228

WALTER S. FISSELL
181/41
B.A.
P. 118

MARION MEADE
165/85
P. 119

BD. OF EDUCATION
ELLICOTT ELEM. SCH.
118/73, 125/308
4.29A
P. 295

SAMUEL M. CAPLAN
184/435
P. 31

WEST CHESTER CEMETERY
8/442
P. 313

THE SCHOOL FOR CONTEMPORARY EDUCATION, INC.
1.13A & 1.74A
P. 234

FRIENDS CEMETERY
43/159
O. 22A
P. 236

Attachment 2
HO-76
St. Paul's Catholic School
Tax Map 25

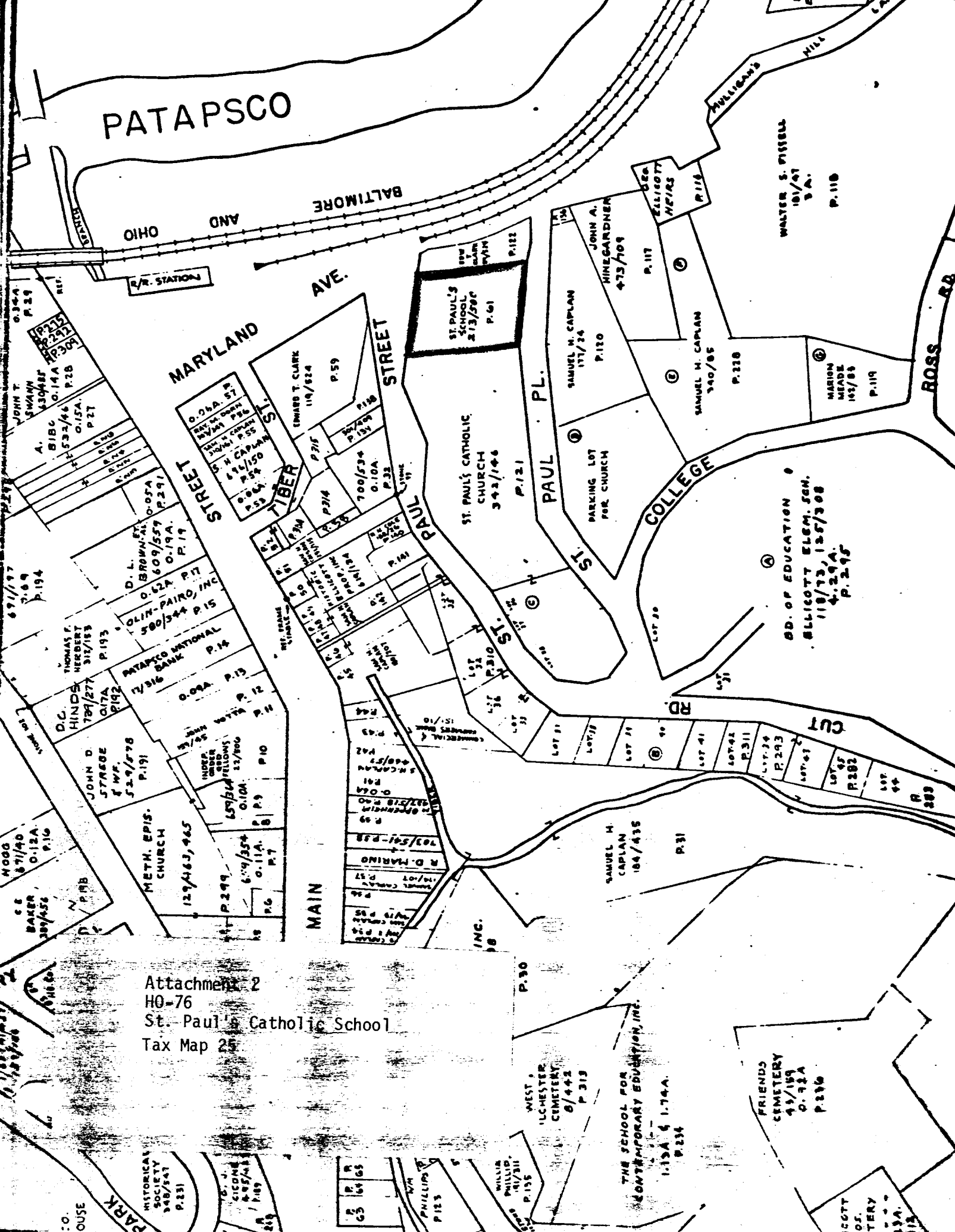

PLAT NO. 1

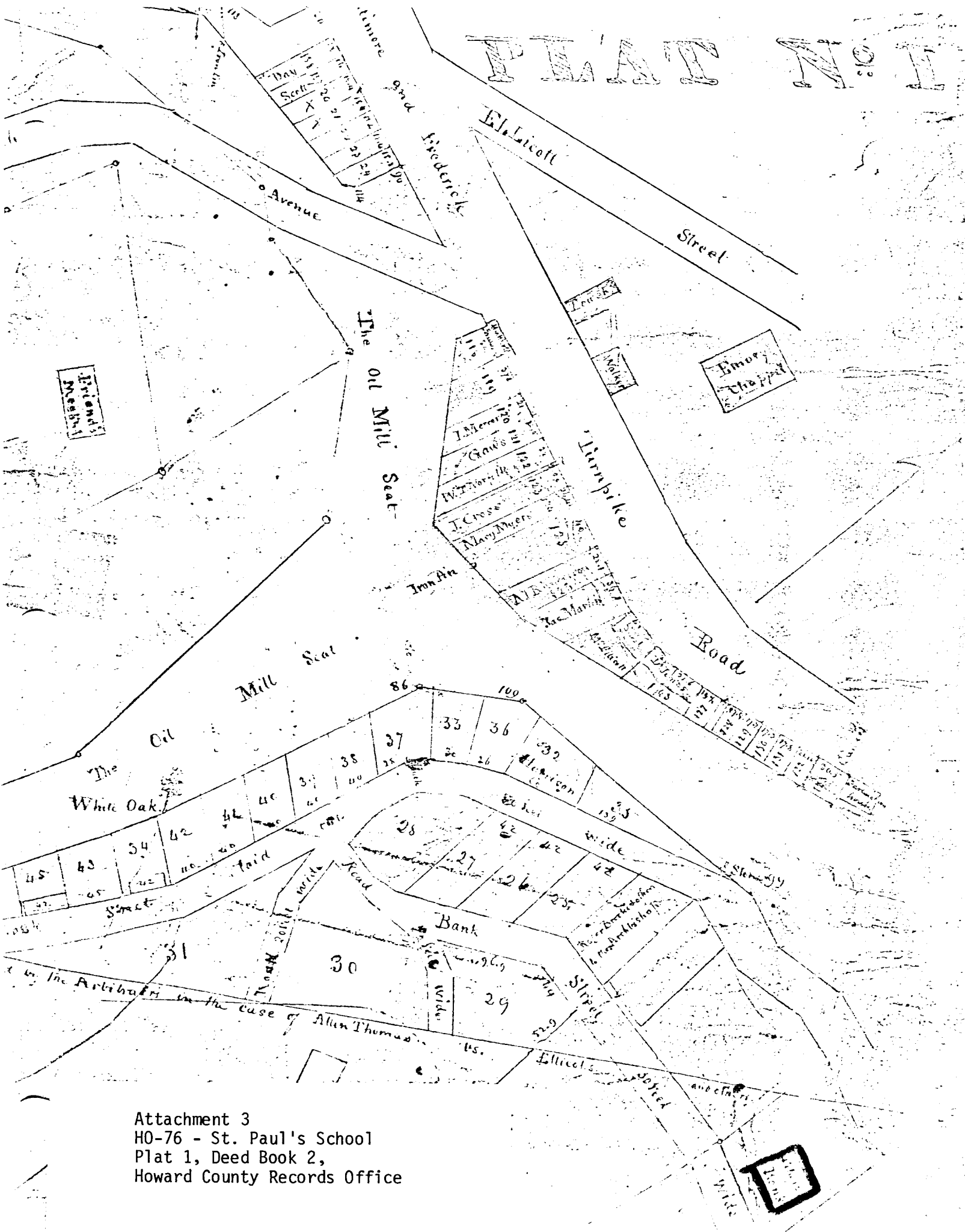

Attachment 3
HO-76 - St. Paul's School
Plat 1, Deed Book 2,
Howard County Records Office

Attachment 4
 HO-76 St. Paul's School
 Deed Book 3-221
 Howard County Records Office

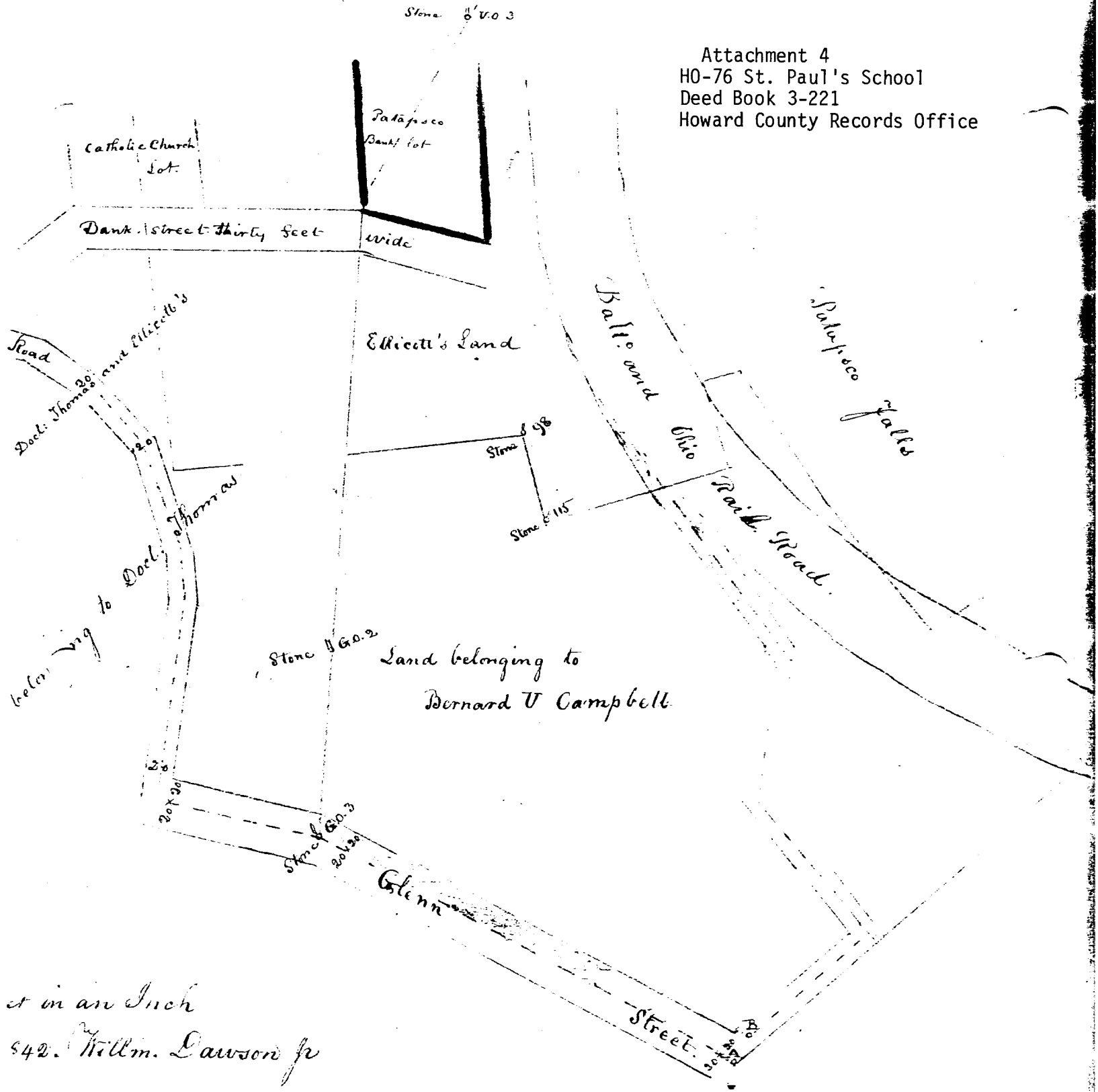

at an Inch
 542. Willm. Dawson jr

ry land, Howard District of Anne Arundel County etc.
 embere and it is hereby certified, that on this sixteenth day of May
 ear our Lord one thousand eight hundred and forty two
 Chief Judge of the third Judicial District of the State of Maryland
 appear Doctor Allen Thomas and Bernard M. Campbell

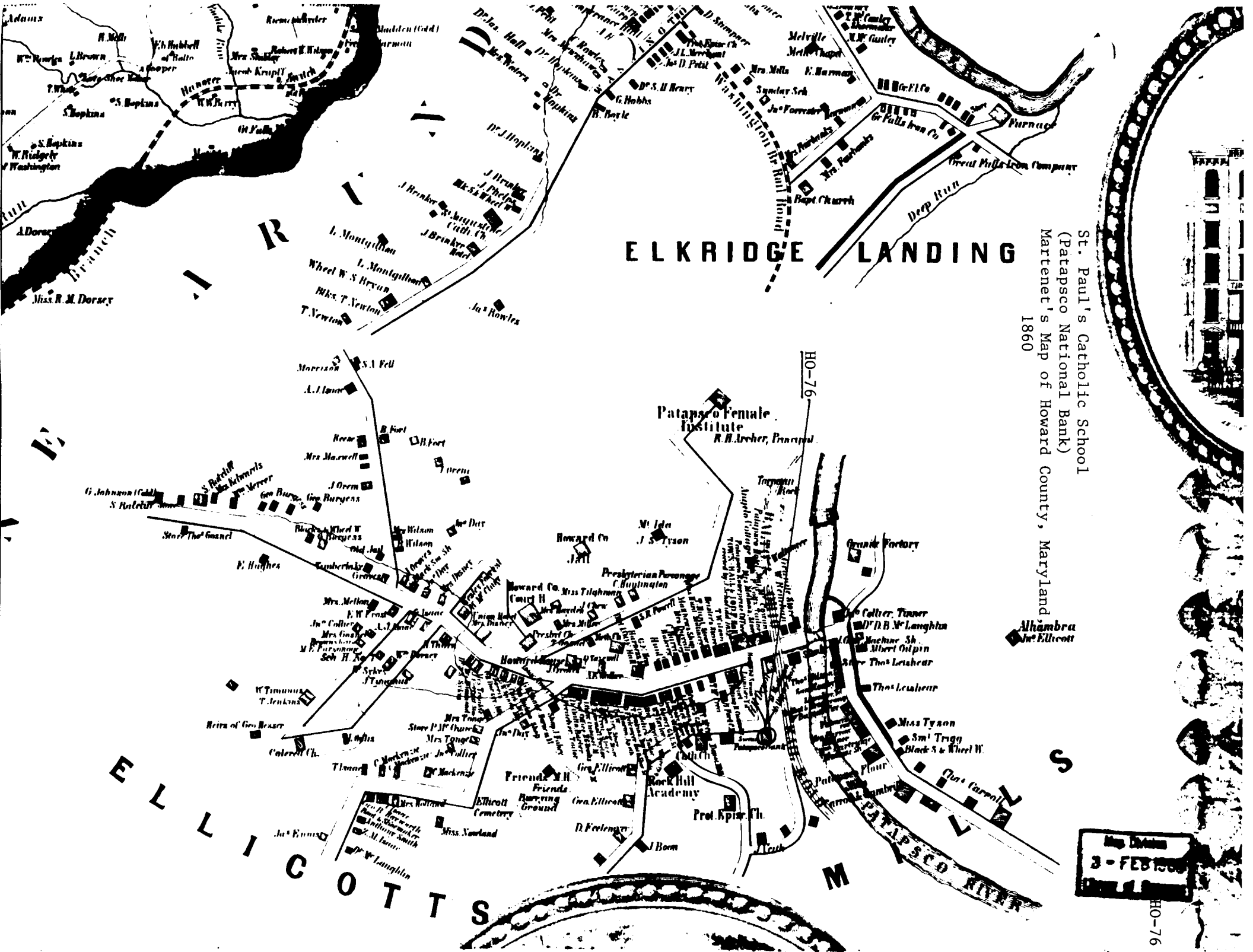

St. Paul's Catholic School
 (Patapsco National Bank)
 Martenetti's Map of Howard County, Maryland
 1860
 Alhambra
 J. H. Elliott

Map Edition
 3 - FEB 1860

HO-76

PLAN OF ELLICOTT CITY

HOWARD & BALTIMORE COUNTIES

Scale. 300 feet per inch.

Explanation.

- indicates Stone building
- " Brick "
- " Frame "
- Brick or Stone Stable.
- Frame Stable or shed.

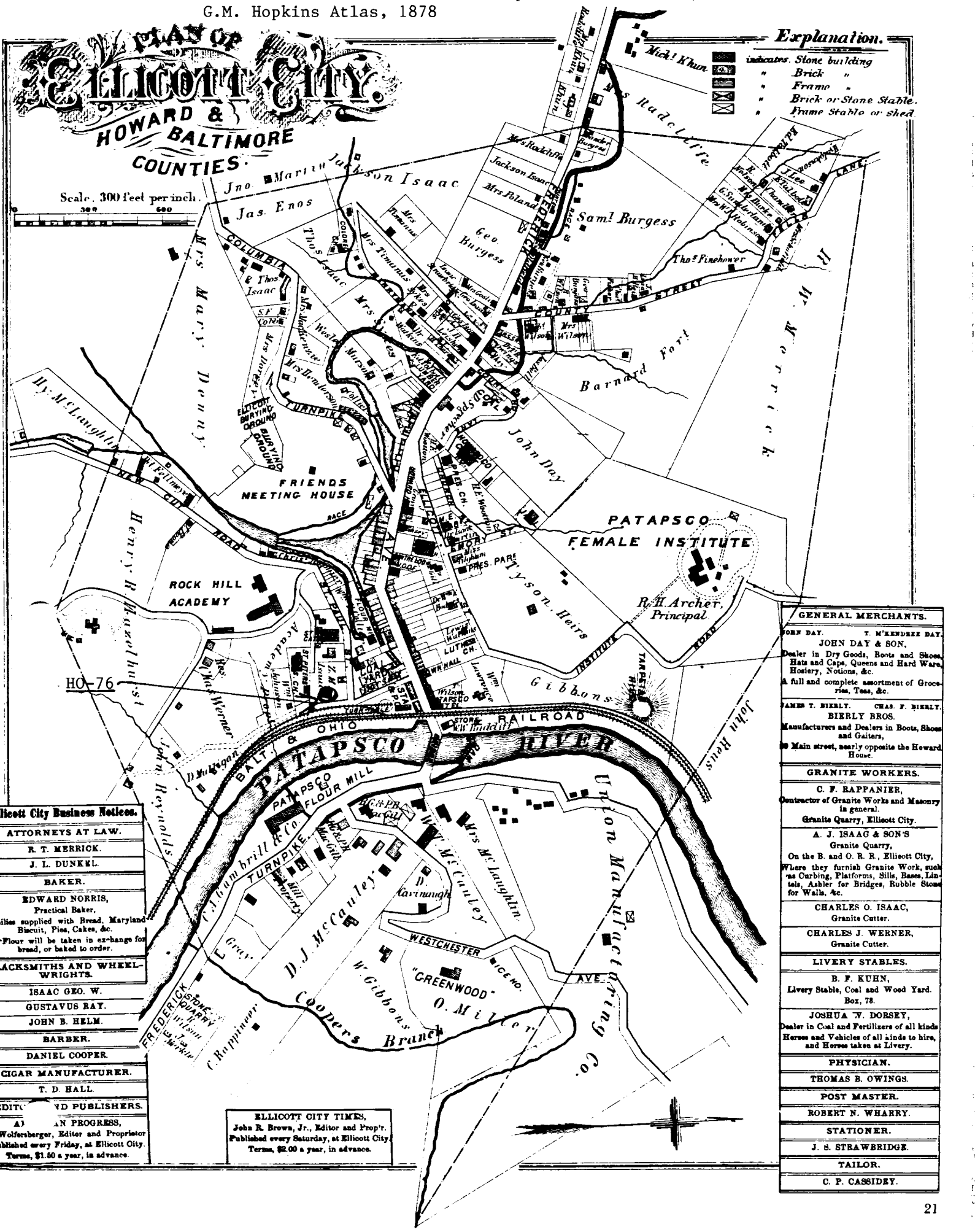

GENERAL MERCHANTS.	
JOHN DAY.	T. M'KENZIE DAY.
JOHN DAY & SON.	
Dealer in Dry Goods, Boots and Shoes, Hats and Caps, Queens and Hard Ware, Hosiery, Notions, &c.	
A full and complete assortment of Groceries, Tea, &c.	
JAMES T. BIERLY.	CHAR. F. BIERLY.
BIERLY BROS.	
Manufacturers and Dealers in Boots, Shoes and Gaiters.	
Main street, nearly opposite the Howard House.	
GRANITE WORKERS.	
C. F. RAPPANIER,	
Contractor of Granite Works and Masonry in general.	
Granite Quarry, Ellicott City.	
A. J. ISAAC & SON'S	
Granite Quarry,	
On the B. and O. R. R., Ellicott City,	
Where they furnish Granite Work, such as Carbing, Platforms, Sills, Bases, Lintels, Ashler for Bridges, Rubble Stone for Walk, &c.	
CHARLES O. ISAAC,	
Granite Cutter.	
CHARLES J. WERNER,	
Granite Cutter.	
LIVERY STABLES.	
B. F. KUHN,	
Livery Stable, Coal and Wood Yard. Box, 78.	
JOSHUA W. DORSEY,	
Dealer in Coal and Fertilizers of all kinds. Horses and Vehicles of all kinds to hire, and Horses taken at Livery.	
PHYSICIAN.	
THOMAS B. OWINGS.	
POST MASTER.	
ROBERT N. WHARRY.	
STATIONER.	
J. S. STRAWBRIDGE.	
TAILOR.	
C. P. CASSIDY.	

Ellicott City Business Notices.

ATTORNEYS AT LAW.	
R. T. MERRICK.	
J. L. DUNKEL.	
BAKER.	
EDWARD NORRIS,	
Practical Baker,	
supplies with Bread, Maryland Biscuit, Pies, Cakes, &c.	
Flour will be taken in exchange for bread, or baked to order.	
BLACKSMITHS AND WHEEL-WRIGHTS.	
ISAAC GEO. W.	
GUSTAVUS BAY.	
JOHN B. HELM.	
BARBER.	
DANIEL COOPER.	
CIGAR MANUFACTURER.	
T. D. HALL.	
EDITORS AND PUBLISHERS.	
THE PROGRESS,	
Wolferberger, Editor and Proprietor	
Published every Friday, at Ellicott City.	
Terms, \$1.50 a year, in advance.	

ELlicOTT CITY TIMES,
John R. Brown, Jr., Editor and Proprietor.
Published every Saturday, at Ellicott City.
Terms, \$2.00 a year, in advance.

Attachment 2
H0-76 St. Paul's Catholic School
U.S. Geological Survey Map
Ellicott City Quad

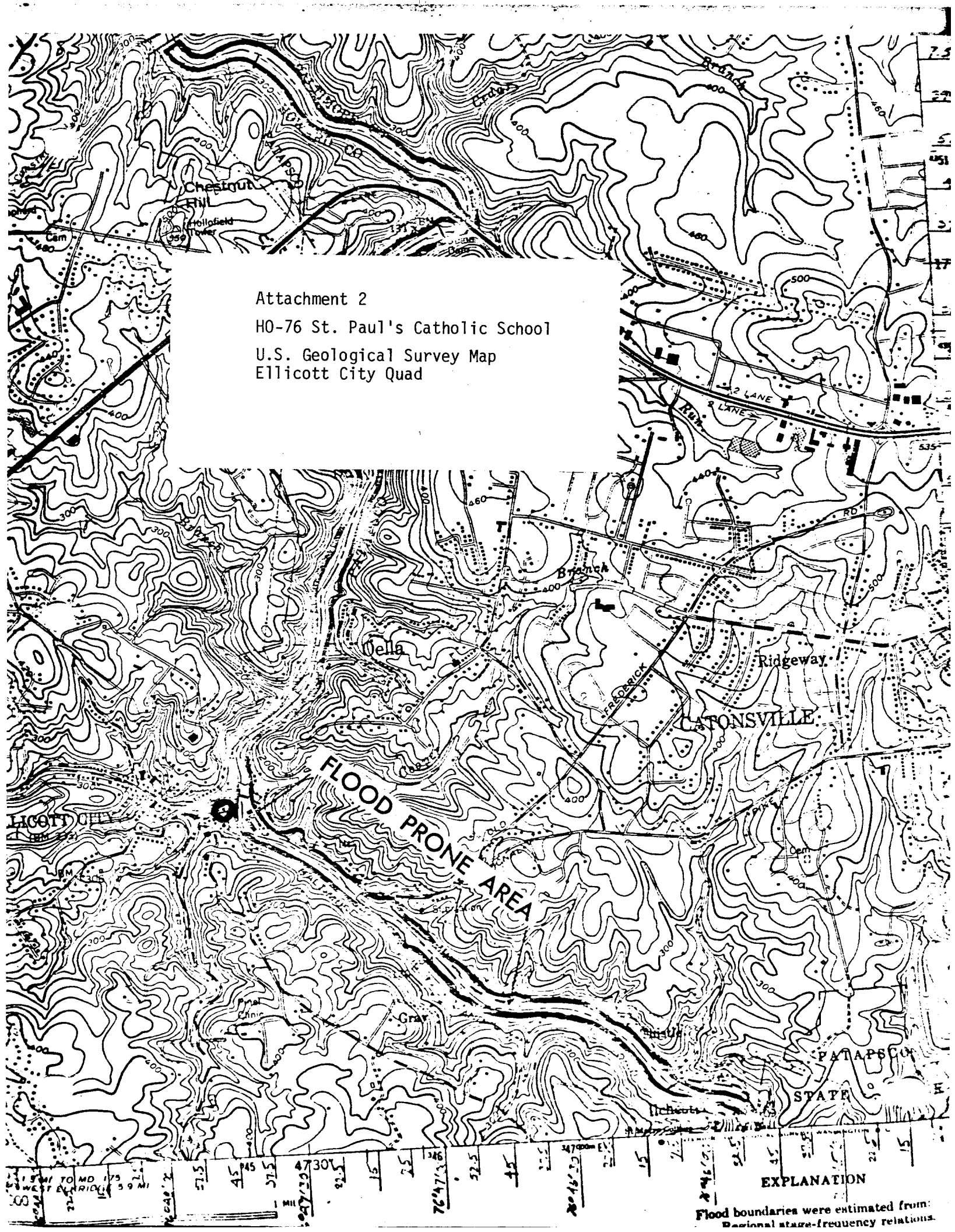

EXPLANATION

Flood boundaries were estimated from:
Regional stage-frequency relations.



HO. 76

Shiloh City

W. B. P. P.

St Paul's church catholic school



Hb-76 St. Paul's Catholic School
(West)
Mar. 77

CLEORA BARNES THOMPSON
PLANNING CONSULTANT
HISTORICAL SITES SURVEY



Ho. 76 S. PAUL'S CATHOLIC SCHOOL
(SOUTH WEST)
APRIL 1977

CLEORA BARNES THOMPSON
PLANNING CONSULTANT
HISTORICAL SITES SURVEY