

INDIVIDUAL PROPERTY/DISTRICT
MARYLAND HISTORICAL TRUST
INTERNAL NR-ELIGIBILITY REVIEW FORM

Property/District Name: Duvall's Range Survey Number: HO-11

Project: Replace Dorsey Mill Road Bridge Agency: FHWA/Howard County

Site visit by MHT Staff: no yes Name Various easement staff Date _____

Eligibility recommended Eligibility not recommended

Criteria: A B C D Considerations: A B C D E F G None

Justification for decision: (Use continuation sheet if necessary and attach map)

Also known as the Stephen Boone Dorsey House, this property is subject to a perpetual preservation easement held by the Maryland Historical Trust. The house is a two story, three bay by one bay, gable roofed stone house covered in stucco. A small log house, now attached to the stone house, and a smoke house are believed to have been constructed as early as 1695. The stone house is thought to have been built some one hundred years after the log house. A two story frame section connects the stone and log portions. The property is eligible under Criterion C for architecture as a representative example of Howard County domestic architecture illustrating two distinct periods and methods of construction. In addition, the property retains a pristine setting of agricultural fields and woodlands. Based on available information, we believe the National Register historic property boundaries are equivalent to all that property which is covered by the Maryland Historical Trust preservation easement (76.5 acres).

(*Note that as part of the above mentioned bridge replacement project, Howard County Division of Transportation acquired in fee simple and easement less than .5 acres along the road at the southeastern corner of the property. This parcel will remain under MHT easement.)

Documentation on the property/district is presented in: Project File, Maryland Inventory
Form HO-11

Prepared by: Cleora Thompson

Elizabeth Hannold January 27, 1997
Reviewer, Office of Preservation Services Date

NR program concurrence: yes no not applicable
Peter E. Kuntz 1/27/97
Reviewer, NR program Date

[Handwritten mark]

Easement

H0-11
Stephen BooneDorsey House
Private
Glenwood

18th & 19th centuries

The Stephen Boone Dorsey House, known also as Duvall's Range, is a three bay wide, one room deep, two and a half story stone covered with stucco gabled roof (running north-south) structure with wide brick chimneys inset into its north and south walls and an old log house now the library, which could date from as early as 1695, connected to the main structure by a two and a half story frame hyphen. A one story porch lies along the east wall of the stone and frame sections. A kitchen addition lies on the two east bays of the west wall, a two bay deep, two bay wide, two story high intersecting gabled roof stone structure.

The log house and smoke house are believed to have existed in 1695, when John Duvall sold his Duvall's Range to John Dorsey.

Family tradition says the stone house was built by Stephen Boone Dorsey, Sr.

MARYLAND HISTORICAL TRUST WORKSHEET

NOMINATION FORM
for the
NATIONAL REGISTER OF HISTORIC PLACES, NATIONAL PARKS SERVICE

SEE INSTRUCTIONS

1. NAME

COMMON:
Stephen Boone Dorsey House

AND/OR HISTORIC:
Duvall's Range

2. LOCATION

STREET AND NUMBER:
Roxbury Road

CITY OR TOWN:
Glenwood

STATE: Maryland COUNTY:

3. CLASSIFICATION

CATEGORY (Check One)	OWNERSHIP	STATUS	ACCESSIBLE TO THE PUBLIC
<input checked="" type="checkbox"/> District <input type="checkbox"/> Site <input type="checkbox"/> Building <input type="checkbox"/> Structure <input type="checkbox"/> Object	<input type="checkbox"/> Public <input checked="" type="checkbox"/> Private <input type="checkbox"/> Both	<input checked="" type="checkbox"/> Occupied <input type="checkbox"/> Unoccupied <input type="checkbox"/> Preservation work in progress	Yes: <input checked="" type="checkbox"/> Restricted <input type="checkbox"/> Unrestricted <input type="checkbox"/> No
PRESENT USE (Check One or More as Appropriate)			
<input checked="" type="checkbox"/> Agricultural <input type="checkbox"/> Commercial <input type="checkbox"/> Educational <input type="checkbox"/> Entertainment	<input type="checkbox"/> Government <input type="checkbox"/> Industrial <input type="checkbox"/> Military <input type="checkbox"/> Museum	<input type="checkbox"/> Park <input checked="" type="checkbox"/> Private Residence <input type="checkbox"/> Religious <input type="checkbox"/> Scientific	<input type="checkbox"/> Transportation <input type="checkbox"/> Other (Specify) _____ _____

4. OWNER OF PROPERTY

OWNER'S NAME:
Mrs. M. Gemmill Ellingsworth

STREET AND NUMBER:
Roxbury Road

CITY OR TOWN: Glenwood STATE: Maryland

5. LOCATION OF LEGAL DESCRIPTION

COURTHOUSE, REGISTRY OF DEEDS, ETC.:
Hall of Records

STREET AND NUMBER:
Howard County Courthouse

CITY OR TOWN: Ellicott City STATE: Maryland ZIP: 21043

Title Reference of Current Deed (Book & Pg. #): Tax Map 21, page 23

6. REPRESENTATION IN EXISTING SURVEYS

TITLE OF SURVEY:
Howard County Historic Sites Inventory

DATE OF SURVEY: Federal State County Local

DEPOSITORY FOR SURVEY RECORDS:
Maryland Historical Trust

STREET AND NUMBER:
21 State Circle

CITY OR TOWN: STATE:

7. DESCRIPTION

CONDITION	(Check One)					
	<input checked="" type="checkbox"/> Excellent	<input type="checkbox"/> Good	<input type="checkbox"/> Fair	<input type="checkbox"/> Deteriorated	<input type="checkbox"/> Ruins	<input type="checkbox"/> Unexposed
	(Check One)			(Check One)		
	<input type="checkbox"/> Altered	<input checked="" type="checkbox"/> Uncolored		<input type="checkbox"/> Moved	<input checked="" type="checkbox"/> Original Site	

DESCRIBE THE PRESENT AND ORIGINAL (If known) PHYSICAL APPEARANCE

Duvall's Range began as a simple log cabin, now two bays wide and one room deep with wide stone chimney which has an added brick chimney top, lying on the north wall of the house which faces east. Two gabled roof dormer windows are set into its east and west roof lines holding rectangular double-hung windows with six-over-six lites.

A rectangular eight lite east entrance door lies in the south bay of the east wall, with a double first floor window to the north which holds two square six lite casement windows. The gable roof on this side extends downward to form a roof for the one story porch which lies along this east elevation.

The north elevation holds a square four lite second floor casement window on each side of the stone chimney; while a tri-partite horizontal rectangular window is composed of three square six lite casement windows. The log house is placed on a stone foundation. Four brick and flagstone steps on the north lead up to the east porch and are connected to the old round stone well by a brick patio.

A three bay wide, two bay deep, two and a half story stone covered with stucco house is connected to the original log cabin by a two and a half story frame addition, one bay wide and two bays deep.

The first floor of the east wall of the stone house holds twin doors in the central bay divided by a fluted pilaster. The rectangular entrance doors hold 12 lites and are flanked by rectangular double-hung windows with six-over-six lites, decorated with projecting flat stone sills and black shutters. Three similar second floor windows lie above, vertically aligned in the north and south bays. A three lite basement window also lies in the north and south bay.

Wide brick chimneys are centered into the north and south walls. The south wall holds a first floor six-over-six lite window in the east bay, a second floor similar window in the west bay and two four lite square casement windows in the attic. A stone gabled roof basement entrance lies in the west bay of this south wall.

The west elevation of the stone house holds a three lite basement window with first and second floor windows, similar to the others on the east wall, in its north bay. From its central and south bays springs a two bay wide, one bay deep, two story high gabled roof (running east-west and intersecting with the gabled roof of the stone structure) stone addition.

★ A one story shed roofed enclosed entrance way lies on its south wall. From the west wall of this entrance springs a gabled roof, one story high screened in porch which takes approximately two-fifths of the west wall of the stone addition. ★ Connecting the original log house with the stone house is the one bay wide, one room deep, two and a half story, frame addition which is used as a large hall with east and west entrance.

The east entrance is rectangular 12 lite door flanked by fluted pilasters and surmounted by a flat lintel and closed pediment. A four lite square casement window lies south of the door which is flanked by wrought iron lanterns and approached by a wide stone step. A flagstone patio runs along the entire east elevation of the stone house and its hall connector and is covered by a one story shed roofed porch supported by five square columns.

The north wall of this frame connector or hyphen holds a square brick central chimney and two four lite casement attic windows.

SEE INSTRUCTIONS

Duvall's Range
Description
Cont.

The west wall of the hyphen holds a cross and open bible paneled entrance door flanked by fluted pilasters and surmounted by a closed pediment. A rectangular double-hung window with six-over-six lites decorated with shutters lies south with a similar second floor window above. Four stone steps and landing with wrought iron guard rail allow entrance to this west door.

A two story (from west) gabled roof (running east-west) one room square frame house with a brick chimney on southwest corner lies southeast of the house with old frame barns and three car cinderblock garage lying south.

The interior log house has exposed logs and wide chimney.

Enclosed staircases are located in the hall and on the west wall of the dining room. Original mantles grace the living and dining room of the old stone structure, believed to have been built some hundred years after the log house now holding the library and connected by the hall. A gabled roof (running north-south) log house lies west of the original structure with battenwood east door. A spring house is located northeast of the house.

8. SIGNIFICANCE

PERIOD (Check One or More as Appropriate)

- | | | | |
|--|---------------------------------------|--|---------------------------------------|
| <input type="checkbox"/> Pre-Columbian | <input type="checkbox"/> 16th Century | <input checked="" type="checkbox"/> 18th Century | <input type="checkbox"/> 20th Century |
| <input type="checkbox"/> 15th Century | <input type="checkbox"/> 17th Century | <input checked="" type="checkbox"/> 19th Century | |

SPECIFIC DATE(S) (If Applicable and Known)

AREAS OF SIGNIFICANCE (Check One or More as Appropriate)

- | | | | |
|--|---|--|--|
| <input type="checkbox"/> Aboriginal | <input type="checkbox"/> Education | <input type="checkbox"/> Political | <input type="checkbox"/> Urban Planning |
| <input type="checkbox"/> Prehistoric | <input type="checkbox"/> Engineering | <input type="checkbox"/> Religion/Philosophy | <input type="checkbox"/> Other (Specify) |
| <input checked="" type="checkbox"/> Historic | <input type="checkbox"/> Industry | <input type="checkbox"/> Science | _____ |
| <input checked="" type="checkbox"/> Agriculture | <input type="checkbox"/> Invention | <input type="checkbox"/> Sculpture | _____ |
| <input checked="" type="checkbox"/> Architecture | <input type="checkbox"/> Landscape Architecture | <input type="checkbox"/> Social/Humanitarian | _____ |
| <input type="checkbox"/> Art | <input type="checkbox"/> Literature | <input type="checkbox"/> Theater | _____ |
| <input type="checkbox"/> Commerce | <input type="checkbox"/> Military | <input type="checkbox"/> Transportation | _____ |
| <input type="checkbox"/> Communications | <input type="checkbox"/> Music | | |
| <input type="checkbox"/> Conservation | | | |

STATEMENT OF SIGNIFICANCE Duvall's Range

John Dorsey is said to have bought Duvall's Range from John Duvall in 1695. At that time the log house now the library and the smoke house is said to have existed. John Dorsey, a descendent, married Margaret Boone, daughter of Captain John Boone. A son of John and Margaret, Humphrey Dorsey is believed to have lived in the present house. He married Catherin A. Riggs and they had several children, among them Stephen Boone Dorsey. It may well have been he who constructed the hall connector during his tenure as a fireplace is located on the north side of the hall, evidently the sole method of heating the house at that time. Stephen Boone Dorsey lived here and later his son Stephen Boone Dorsey, Jr., who had four daughters.

A story is told that the school master lived in the southeast corner of the house and helped Mr. Dorsey mend his fences as well as tutor his children.

Later, due to the poor road conditions on Roxbury Mill Road, Stephen Jr., and his wife built across the road and north of the present house, on Route 97.

Presently owned by Mrs. Ellingsworth, it is beautifully and tastefully maintained.

SEE INSTRUCTIONS

9. MAJOR BIBLIOGRAPHICAL REFERENCES

Warfield, J.P., Founders of Anne Arundel and Howard Counties, Maryland.
Baltimore, 1973. pp. 360,441,537.
Interview with Mrs. Ellingsworth at Duvall's Range, March 10, 1977.

10. GEOGRAPHICAL DATA

LATITUDE AND LONGITUDE COORDINATES DEFINING A RECTANGLE LOCATING THE PROPERTY			O R	LATITUDE AND LONGITUDE COORDINATES DEFINING THE CENTER POINT OF A PROPERTY OF LESS THAN TEN ACRES		
CORNER	LATITUDE	LONGITUDE		LATITUDE	LONGITUDE	
	Degrees Minutes Seconds	Degrees Minutes Seconds		Degrees Minutes Seconds	Degrees Minutes Seconds	
NW	° ' "	° ' "		° ' "	° ' "	
NE	° ' "	° ' "		° ' "	° ' "	
SE	° ' "	° ' "		° ' "	° ' "	
SW	° ' "	° ' "		° ' "	° ' "	

APPROXIMATE ACREAGE OF NOMINATED PROPERTY:

Acreage Justification:

Please see Attachment 1, Tax Map 21, p.23, 23/459, 81.48A.

SEE INSTRUCTIONS

11. FORM PREPARED BY

NAME AND TITLE:
Cleora Barnes Thompson, Archivist

ORGANIZATION: Comprehensive Planning Section DATE:

STREET AND NUMBER:
3450 Courthouse Drive

CITY OR TOWN: Ellicott City STATE: Maryland 21043

12. State Liaison Officer Review: (Office Use Only)

Significance of this property is:

National State Local

Signature _____

ALSTON
SPECHT
166/167
295A
P 14

ROXBURY

Attachment I

H0-11 The Stephen Boone Dorsey House
or Duvall's Range
Tax Map #21

J. GARRETT
REILLY
257/518
278/63A
P 13

REILLY
CNC
5/31
P 22

7,964
P.132

M. GEMMILL
ELIHIGSWORTH
230/459
81,484V
P 23

FRANCIS B. DEVLIN
521/412
61,464
P.24

GEORGE CHASE
208/423
207,81A
P.25

JOHN M.
BEANE
215/202
35,27A
P 26

P.27

ROXBURY
Rd

DOBSON
GOSSETT

FRANCIS

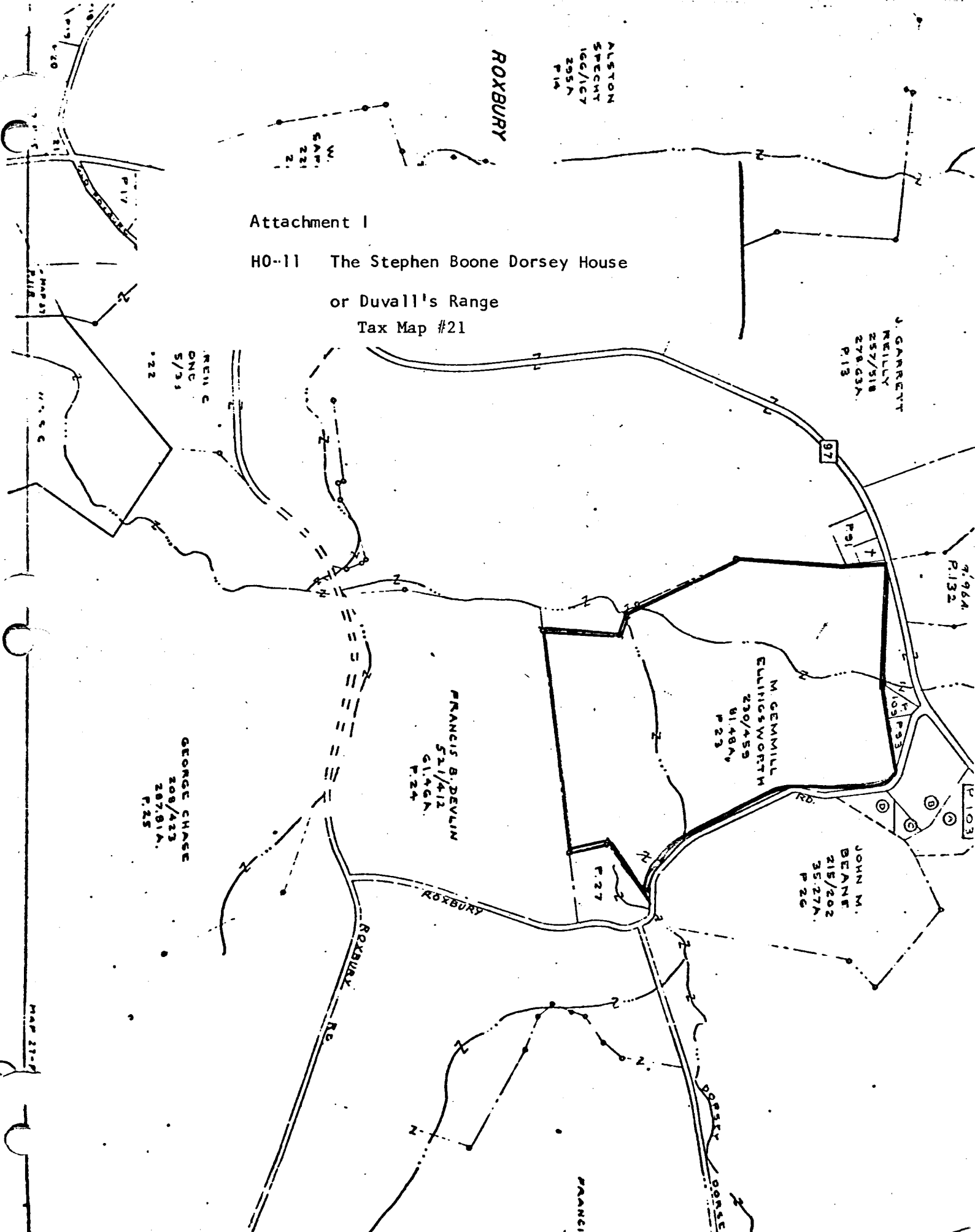

Attachment 2

H0-11 Stephen Boone Dorsey House or Duvall's Range

U.S. Geological Survey Map

Woodbine, Maryland Quad

WETLAND PRONE AREA

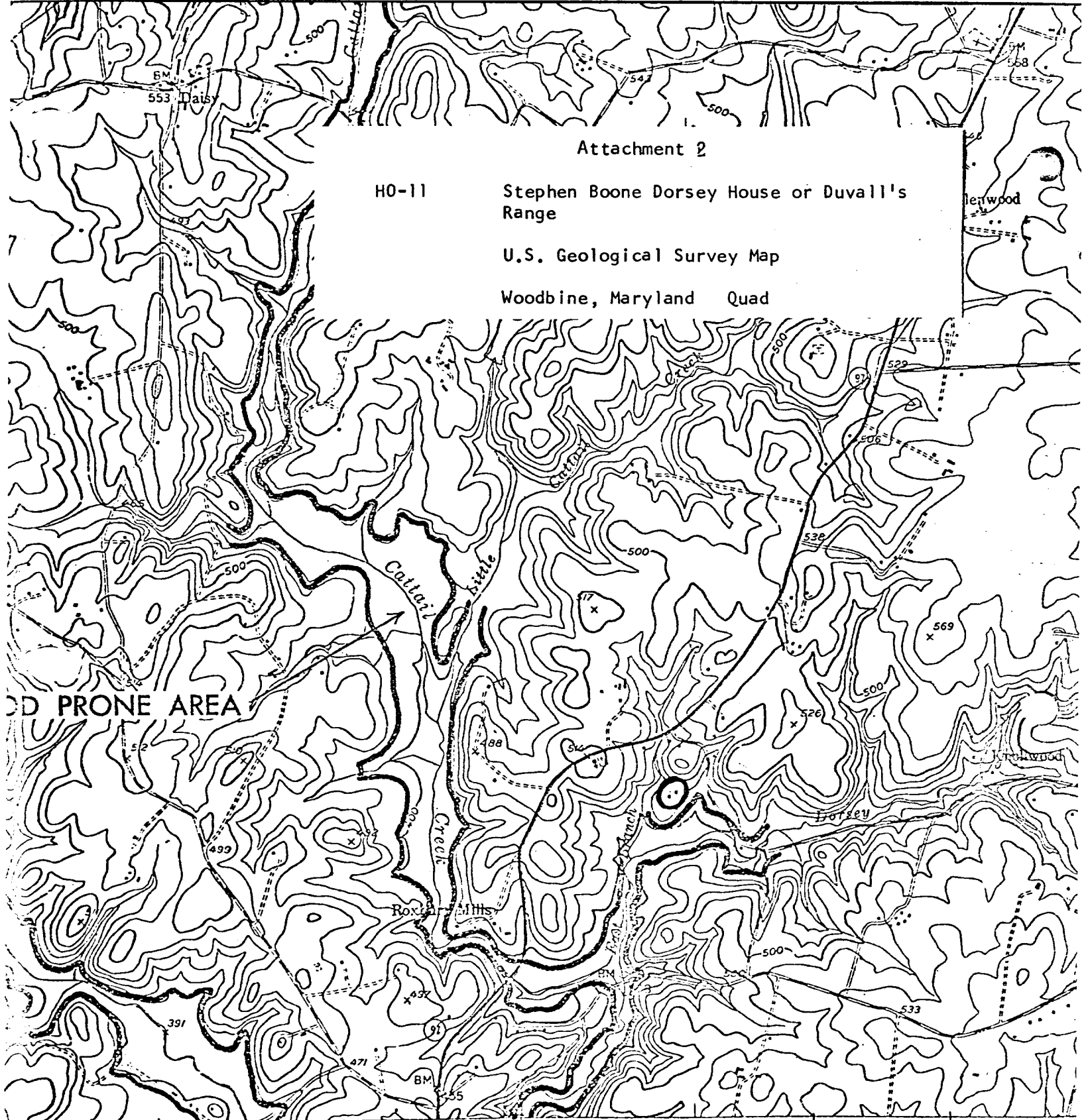

(SANDY SPRING) 5562 II NE

SUNSHINE 2.1 MI. BROOKEVILLE 5 MI.

2'30" 1324

INTERIOR-GEOLOGICAL 325

SCALE 1:24000

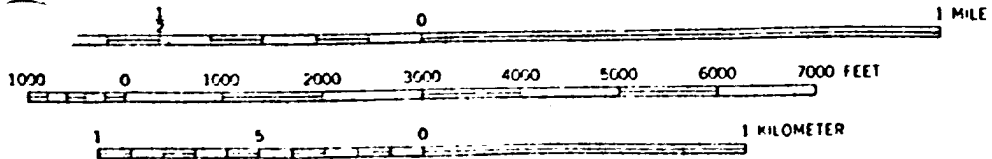

CONTOUR INTERVAL 20 FEET
DATUM IS MEAN SEA LEVEL



QUADRANGLE LOCATION



CLEORA BARNES THOMPSON
PLANNING CONSULTANT
HISTORICAL SITES SURVEY

HO-11 STEPHEN BOONE DORSEY HOUSE, DUVAH'S RANGE
(EAST)
MAR.77

Roxbury Mill
HO-12
Glenwood vicinity
Howard County
Surveyor: Kathryn G. Smith
December 2002 (Field Inspection – September 2002)

ADDENDUM

Section 3. Owner of Property.

John E. and Janet F. Cremeans
4152 Roxbury Mill Road
Glenwood, MD 21738

Section 4. Location of Legal Description.

Howard County Courthouse
Ellicott City
Liber 4639, Folio 279
Tax Map 21, Parcel 87

Roxbury Mill – ADDENDUM
HO-12

Section 7. Description.

Condition: Ruins

The remains of Roxbury Mill lie south of the Glenwood area of Howard County. The site is located to the east of Roxbury Mill Road (former Route 97), approximately one-quarter mile from its intersection with the present Route 97. The remains of this grist mill are found in a wooded area containing large sycamore trees, near a small bridge crossing Cattail Creek. The mill was dismantled in Summer 2002 due to safety issues and concerns about vandalism. The fieldstone foundation, the interior post-and-beam assembly to house gears and pulleys, and the steel waterwheel were intact at the time of documentation in September 2002. The waterwheel will be removed in October 2002. Window and door openings with exterior stone lintels, interior wood lintels, and wood frames and sills, are evident in the foundation. Former elements of the mill, such as lumber, hoppers, and various types of equipment, are scattered on the ground around the mill foundation. Some of these elements will be used in a functional reconstructed mill (though not identical to Roxbury) to be built by the Howard County Antique Farm Machinery Club as part of a farm heritage museum, which will be located on a different site that is yet to be determined. The Roxbury Mill Miller's House (HO-169) and the Wilson Place at Roxbury Mill (HO-294) still stand near the mill site. These homes were previously part of the early Roxbury Mills village.

The rectangular foundation consists of plain and split fieldstone and measures approximately 40 feet 8 inches by 30 feet 8 inches. The foundation walls are approximately 2 feet thick.

The north façade contains a 4-foot door opening slightly east of center.

The three-bay west façade features, from north to south, a 4-foot window opening, a 4-foot 8-inch central door opening with an interior wood sill, and a 3-foot window opening, from which a stone lintel measuring 13 feet 5 inches in height has fallen to the ground. This window opening has a partial wood frame and an interior wood lintel.

The south façade contains, from west to east, an approximately 11-foot opening offset to the west of center. An overshot steel waterwheel is located directly outside this opening. The waterwheel is assembled via riveting as opposed to welding. The diameter of the waterwheel measures 11 feet, the wheel width is 6 feet, and the spokes are 5 inches wide and 5/8 inches thick. The paddles measure 13-1/2 inches from top to bottom. A window opening with a wood frame, a stone sill, and an interior wood lintel occurs to the east of the waterwheel. This window opening is too high from the ground to measure, but it is topped with a stone lintel more shallow in height than those on the other elevations.

Roxbury Mill – ADDENDUM
HO-12

Section 7. Description (cont'd).

The three-bay east façade features, from south to north, a window opening filled with stone, a former 4-foot central door opening (now converted to a window) with a wood lintel and circular-sawn sill, and a 3-foot window opening with a huge stone lintel measuring 15 feet 2 inches in height. All three openings on this façade have interior lintels made of hewn lumber.

A post-and-beam apparatus to support the mill's gears and pulleys fills the south end of the foundation's interior. Concrete blocks support the posts. The lumber is a combination of circular-sawn and planed members. Rusted gears are present.

Various types of structural lumber are strewn across the ground outside the foundation; it is not possible to determine its former location inside the mill. Hand-hewn, up-and-down sawn, circular-sawn, and sawn-and-planed elements are present. In one ground location, hand-hewn lumber measures 10 by 8 inches, circular-sawn lumber measures 9-1/2 by 2 inches, and sawn-and-planed lumber measures 12 by 11 inches. Many structural members have pegged mortise-and-tenon joints.

Other mill elements can also be found on the ground. Hollow posts to house conveyor belts are planed and beaded one inch from the corners. A wood pulley case displays the inscription, "The Wolf Co., Chambersburg, Pennsylvania." A small wood hopper, a large beaded wood hopper, an iron hopper, and a Eureka Dustless Receiving Separator are present. A platform to support the former millstone has up-and-down sawn floor joists with square-headed cut nails. Wood wedges to secure the millstone are visible inside a circular opening in the platform. No millstones currently exist at the site. John Frank, President of the Howard County Antique Farm Machinery Club, recently removed one millstone. It is located in storage at Mr. Frank's home, along with the mill's flour dressing equipment.

Mr. Frank describes the mill as rising to a height of 33 feet at the roof ridge, encompassing two-and-one-half stories and a cellar. Before dismantling, the building had a tin roof. Most window panes were missing; those remaining appeared "old." The mill did not have a fireplace. A brick chimney with stovepipe openings was located in the interior northeast corner of the building. Platforms to secure millstones were located in the southeast and the southwest corners, with a swing arm located in the center. According to Mr. Frank, the millstones were replaced with a steel burr mill in the late-nineteenth or early-twentieth century. A sign that read "Roxbury Mill" had been painted on the weatherboard on the north exterior wall, but vandals removed it.

According to the present owner, John Cremeans, steel gears and the steel waterwheel were installed circa 1917. Roxbury Mill operated until 1962. In 1972, Hurricane Agnes damaged the mill's foundation and left a hole in the roof that was never repaired. This led to the deterioration of the mill and its subsequent dismantling. Hurricane Agnes also destroyed the millrace and dam, located approximately one mile up Cattail Creek.

Section 8. Significance.

The previous Maryland Historical Trust form included attached narrative information on Roxbury Mill and a copy of a license from Oliver Evans, but the source was not clear. It has been confirmed that this documentation was from John McGrain, Baltimore County historian. The narrative came from the Howard County chapter of his manuscript, “The Molinography of Maryland,” located on microfilm at the Maryland State Archives. The original engraved license is enclosed with Chancery Papers No. 11,141 at the Maryland State Archives.

Oliver Evans invented a system in 1787 that sped up and automated flour milling, thus reducing labor costs. Evans’ invention significantly increased mill construction in Maryland, Delaware, Pennsylvania, and Virginia. Most large merchant mills and small rural mills adopted the new system. According to Mr. McGrain, if a miller paid Evans for the use of his patented invention, Evans issued a license, one side of which was a copperplate engraving from the *Young Mill-Wright and Miller’s Guide* written by Evans and published in Philadelphia in 1795.

John Cremeans, current owner of the Roxbury Mill property, resides in what was previously identified as the Wilson Place at Roxbury Mill (HO-294). Mr. Cremeans supplied the following information:

“J. D. Matthews,* who later founded Glenwood, built a house and store in the town of Roxbury Mills in 1825 and there are some indications that he was Davis’ partner in the mill at that time. (My house was built at that time and I believe it was Matthews’.) Matthews left the partnership after a few years and moved to what became the village of “Mathews” (later Glenwood) where he opened the general store that became “Pindell’s.”

Raymond Smallwood, Jr. operated the mill on Fridays and Saturdays from his father’s death in 1958 until 1962 when his mother sold the mill to Shelley Grover. Ray, who is still living and who owned the house immediately to the West of the Mill until 5 years ago, told me this himself. Also several older residents of the area, e.g. Charlie Hobbs and Bill Pindell, confirmed that the mill was running when Grover bought it in 1962.

In the 1920’s, a man named Ed Higgins bought the house I now live in and opened a still in the back part of the house. He was allegedly the biggest bootlegger in the west county. He got his “middlins” from Ray Smallwood’s mill and bought his sugar from several local stores. (Bill Pindell told me he sold Higgins sugar each year as long as he was in business. Higgins limited his purchases to 900 pounds because storekeepers were required to report any purchase of 1000 pounds or more.) Ray Smallwood, Jr. told me that the “Feds” raided Higgins’ still in the late 1920’s, smashing the still and mash boxes and pouring the whiskey out the windows. Many older locals have also told me that Ray Sr. sold bootleg whiskey at the mill well into the 1950’s.”

*Published Howard County histories identify “James B. Mathews” as the founder of Glenwood.

Roxbury Mill – ADDENDUM
HO-12

Section 8. Significance (cont'd).

NOTE: A copy of a hand-tinted historic photograph of Roxbury Mill in the 1930s, taken by the Jones Sisters, is submitted with this documentation. A black-and-white copy is also provided. Courtesy of John McGrain, Baltimore County Office of Planning, Towson, MD.

Section 9. Bibliography.

Cremeans, Jack, Owner of Roxbury Mill, Glenwood, MD, to Kay Smith, Historic Sites Surveyor, Howard County Department of Planning and Zoning, Ellicott City, MD, 26 September 2002.

Electronic mail correspondence with John W. McGrain, Baltimore County Historian, Office of Planning, Towson, MD, 22 October 2002.

McGrain, John W. ““Good Bye Old Burr”: The Roller Mill Revolution in Maryland, 1882.”
Maryland Historical Magazine 77, no. 2 (Summer 1982): 154-171.

Section 10. Geographical Data.

Acreage of surveyed property: approx. 1 acre

Acreage of historical setting: 2.7 acres

Quadrangle name: Woodbine, MD

Quadrangle scale: 1:24000

Verbal boundary description and justification:

Tax map 21, parcel 87. The area surveyed included the ruins of the mill (foundation and waterwheel) and the surrounding ground upon which former elements of the mill were scattered. The entire historical setting is the same as the area to which the owners hold title.

Section 11. Form Prepared by

Kathryn G. Smith, Historic Sites Surveyor
Howard County Department of Planning and Zoning
3430 Courthouse Drive
Ellicott City, MD 21043
410-313-4374

6 December 2002 (Field Inspection - September 2002)

HQ-12 (ADDENDUM)
ROXBURY MILL
GLENWOOD VICINITY
HOWARD COUNTY

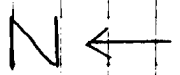

40 FT & IN

30 FT & IN

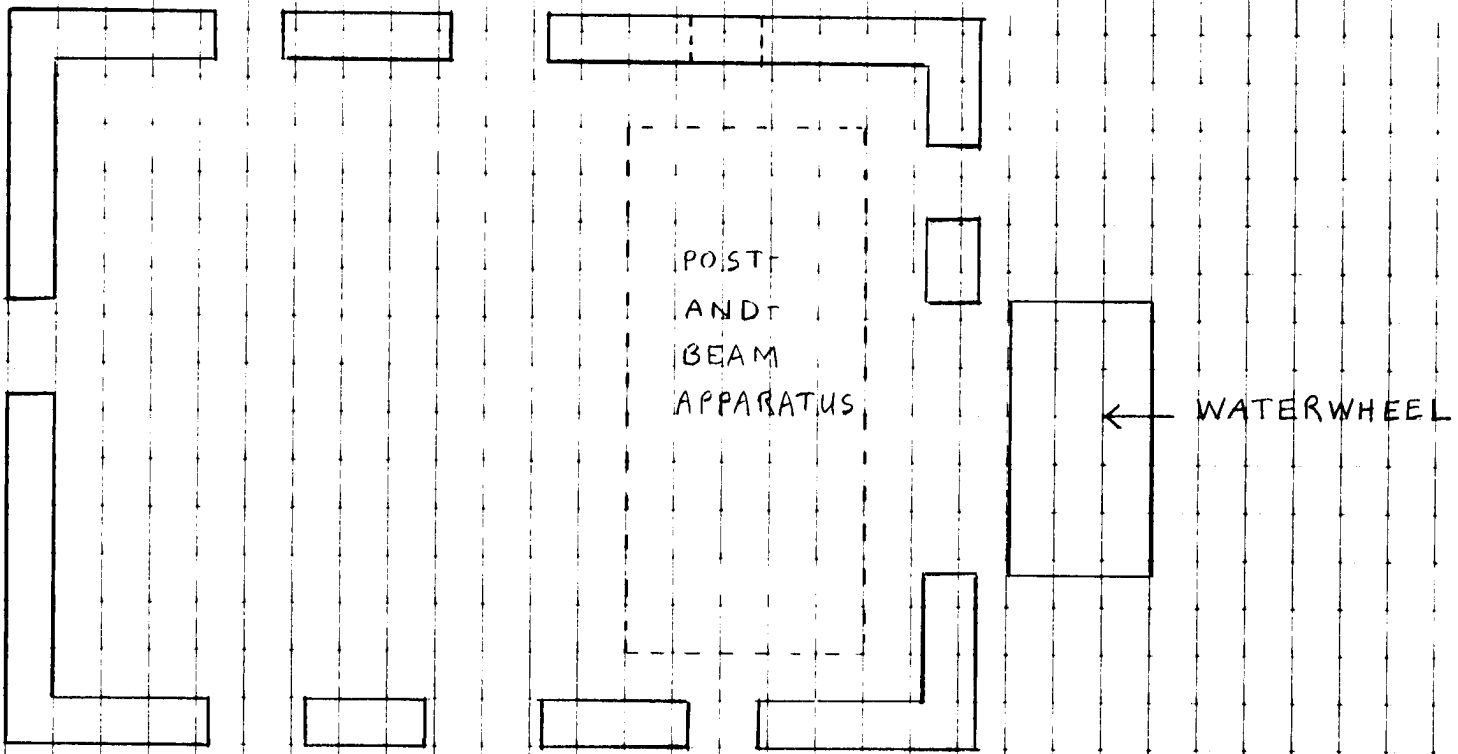

FOUNDATION
(APPROX. SCALE 1/8" = 1 FT)

DRAWN BY KATHRYN G. SMITH
2002

HO-12 (ADDENDUM)
ROXBURY MILL
GLENWOOD VICINITY
HOWARD COUNTY



ROXBURY MILL MILLER'S HOUSE
HO-169

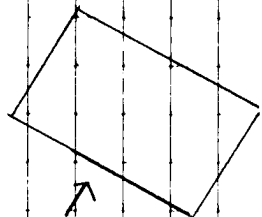

ROXBURY MILL RD.

← ROXBURY MILL

CATTAIL CREEK

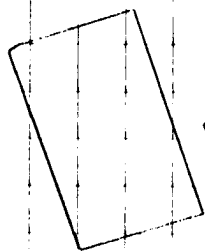
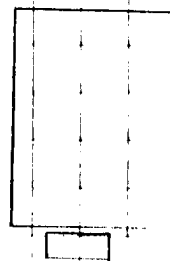

← WILSON PLACE AT
ROXBURY MILL
HO-294
(JAMES B. MATHEWS HOUSE?)

CONTEXT SKETCH

DRAWN BY KATHRYN G. SMITH
2002

(NOT TO SCALE)



HO-12 (ADDENDUM)
 ROXBURY MILL
 GLENWOOD VICINITY
 HOWARD COUNTY
 MARTINET MAP, 1860



A.B. Davis

H. Brown

Elisha Riggs

M.H. Butson

G. Johnson

Mrs. M. Gauthier

Triadelphia

Rolling

David Clark

Mrs. M. Dorsey

Rolling

Rolling

Rolling

Waterville P.O.

Stations P.O.

Falls

Woodbine P.O.

Poplar Springs P.O.

ME. Ch.

ME. Ch.

ME. Ch.

ME. Ch.

ME. Ch.

ME. Ch.

ME. Ch.

ME. Ch.

ME. Ch.

ME. Ch.

ME. Ch.

ME. Ch.

ME. Ch.

ME. Ch.

ME. Ch.

ME. Ch.

ME. Ch.

ME. Ch.

ME. Ch.

ME. Ch.

ME. Ch.

ME. Ch.

ME. Ch.

ME. Ch.

ME. Ch.

ME. Ch.

ME. Ch.

ME. Ch.

ME. Ch.

ME. Ch.

ME. Ch.

ME. Ch.

ME. Ch.

ME. Ch.

ME. Ch.

ME. Ch.

ME. Ch.

ME. Ch.

ME. Ch.

ME. Ch.

ME. Ch.

C O U N T Y

Morgan's Switch P.O.

Gaithers Siding

Woodbine P.O.

Hoods Mills P.O.

Lisbon

Cooksville P.O.

Glenwood P.O.

Dorseyville

Roxbury P.O.

Glenelg P.O.

Triadelphia P.O.

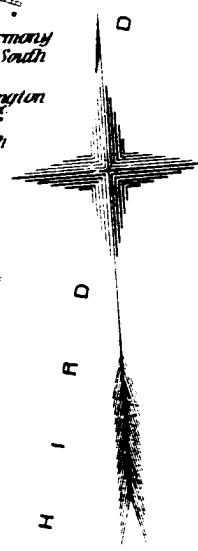

HO-12 (ADDENDUM)
ROXBURY MILL
GLENWOOD VICINITY
HOWARD COUNTY
HOPKINS ATLAS, 1878

Entered according to act of Congress in the year 1878 by E. H. Hopkins in the Office of the Librarian of Congress at Washington.

HO-12 (ADDENDUM)
 ROXBURY MILL
 GLENWOOD VICINITY
 HOWARD COUNTY
 USGS QUADRANGLE MAP:
 WOODBINE, MD

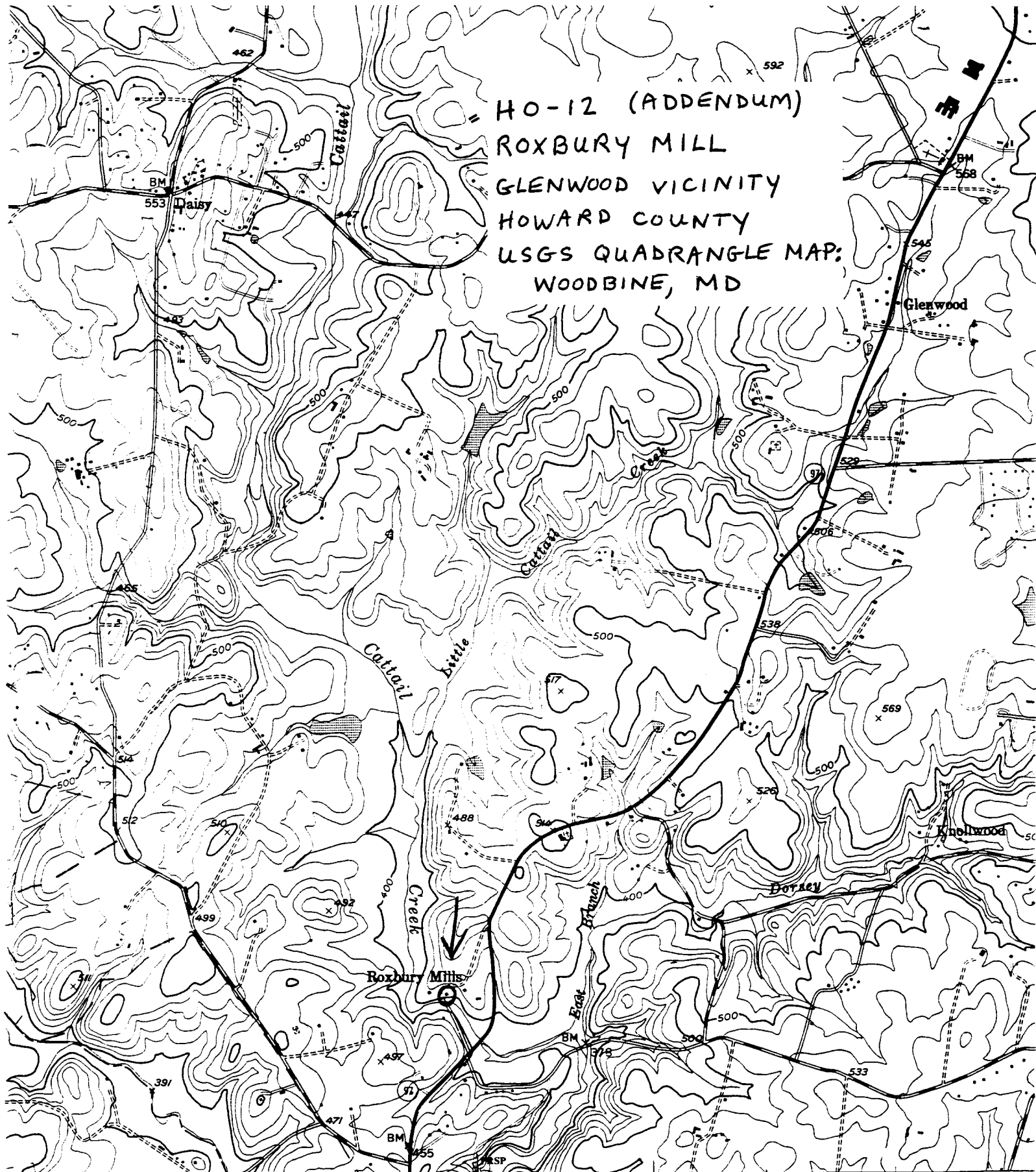

(SANDY SPRING)
5562 II NE

SUNSHINE 2.1 MI.
BROOKVILLE 5 MI.

INTERIOR-GEOLOGICAL SURVEY
325

SCALE 1:24000

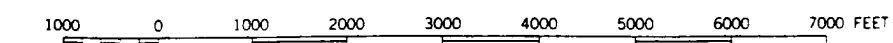
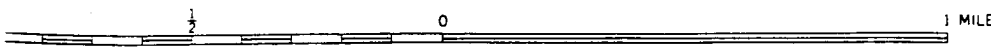

CONTOUR INTERVAL 20 FEET



Hea
Med



HO-12 (Addendum)

Roxbury Mill

Howard County, MD

Photographer: Kathryn G. Smith

September 2002

Negative: MD SHPO

Wooded setting, view facing SE

1 of 14



HO-12 (Addendum)

Roxbury Mill

Howard County, MD

Photographer: Kathryn G. Smith

September 2002

Negative: MD SHPO

NW corner

#2 of 14

NOT REPRODUCIBLE FOR THE STATE OF MARYLAND
BY THE STATE ARCHIVES AND HISTORICAL SOCIETY



H0-12 (Addendum)

Roxbury Mill

Howard County, MD

Photographer: Kathryn G. Smith

September 2002

Negative: MD SHPO

South elevation

3 of 14



H0-12 (Addendum)

Roxbury Mill

Howard County, MD

Photographer: Kathryn G. Smith

September 2002

Negative: MD SHPO

SE corner

#4 of 14

NOT RECORDED
ALL INFORMATION CONTAINED
HEREIN IS UNCLASSIFIED
DATE 11/19/02 BY 60322 UCBAW



HO-12 (Addendum)

Roxbury Mill

Howard County, MD

Photographer: Kathryn G. Smith

September 2002

Negative: MD SHPO

Waterwheel

5 of 14



HO-12 (Addendum)

Roxbury Mill

Howard County, MD

Photographer: Kathryn G. Smith

September 2002

Negative: MD SHPO

Post-and-beam apparatus, view facing south

#6 of 14



HO-12 (Addendum)

Roxbury Mill

Howard County, MD

Photographer: Kathryn G. Smith

September 2002

Negative: MD SHPO

gears & pulleys, view facing SE

#7 of 14



HO-12 (Addendum)

Roxbury Mill

Howard County, MD

Photographer: Kathryn G. Smith

September 2002

Negative: MD SHPO

Variety of hand-hewn and sawn lumber

8 of 14



HO-12 (Addendum)

Roxbury Mill

Howard County, MD

Photographer: Kathryn G. Smith

September 2002

Negative: MD SHPO

Small wood hopper (left) + Eureka Dustless Receiving
Separator (right)

#9 of 14



HO-12 (Addendum)

Roxbury Mill

Howard County, MD

Photographer: Kathryn G. Smith

September 2002

Negative: MD SHPO

Large beaded wood hopper

10 of 14

ENT 5445 (11) 2 1/2" x 1 1/2" x 1/2" (1000)
DATE 10/20/02 12:00 PM



HO-12 (Addendum)

Roxbury Mill

Howard County, MD

Photographer: Kathryn G. Smith

September 2002

Negative: MD SHPO

Iron hopper

#11 of 14



Ho-12 (Addendum)

Roxbury Mill

Howard County, MD

Photographer: Kathryn G. Smith

September 2002

Negative: MD SHPo

Platform for mill stone

#12 of 14



HO-12 (Addendum)

Roxbury Mill

Howard County, MD

Photographer: Kathryn G. Smith

September 2002

Negative: MD SHPO

Roxbury Mill Miller's House (HO-169)

13 of 14



HO-12 (Addendum)

Roxbury Mill

Howard County, MD

Photographer: Kathryn G. Smith

September 2002

Negative: MD SHPO

Wilson Place at Roxbury Mill (HO-294)

(James B. Mathews House?)

#14 of 14



"The Old Mill"

Long Point

HO-12 (Addendum)

Roxbury Mill

Howard County, MD

Jones Sisters

1930s

Photo obtained from John McGrain,
Baltimore County Office of Planning,
Towson, MD

SW corner

Circa 1795

Ho-12
ROXBURY MILL
Glenwood
Private

Basically a very simple clapboard structure with heavy stone foundation, Roxbury Mills is two and a half stories high, three bays wide and three bays deep with gabled roof running north-south and brick chimney located in its northeast corner. Fenestration is rectangular and proportionally scaled with central north entrance, and wide south basement entrance.

The original tract patented in 1700 as "Hard to Get and Dear Paid For" probably held an earlier Dorsey Mill. Later owned by Allen Bowie Davis of Glenwood who also owned Glenwood Mills in Montgomery County, Roxbury Mill is shown on the 1878 Hopkins Atlas as B. Davis grist and saw mill.

1400125214

HO-12
District 4

MARYLAND HISTORICAL TRUST WORKSHEET

NOMINATION FORM
for the
NATIONAL REGISTER OF HISTORIC PLACES, NATIONAL PARKS SERVICE

1. NAME				
COMMON: Roxbury Mill				
AND/OR HISTORIC:				
2. LOCATION				
STREET AND NUMBER: Roxbury Mill Road				
CITY OR TOWN: Glenwood				
STATE Maryland		COUNTY: Howard		
3. CLASSIFICATION				
CATEGORY (Check One)		OWNERSHIP		STATUS
<input type="checkbox"/> District <input type="checkbox"/> Building <input type="checkbox"/> Site <input checked="" type="checkbox"/> Structure <input type="checkbox"/> Object		<input type="checkbox"/> Public <input checked="" type="checkbox"/> Private <input type="checkbox"/> Both		Public Acquisition: <input type="checkbox"/> In Process <input type="checkbox"/> Being Considered
				<input type="checkbox"/> Occupied <input checked="" type="checkbox"/> Unoccupied <input type="checkbox"/> Preservation work in progress
ACCESSIBLE TO THE PUBLIC				
Yes:				
<input checked="" type="checkbox"/> Restricted				
<input type="checkbox"/> Unrestricted				
<input type="checkbox"/> No				
PRESENT USE (Check One or More as Appropriate)				
<input type="checkbox"/> Agricultural <input type="checkbox"/> Commercial <input type="checkbox"/> Educational <input type="checkbox"/> Entertainment		<input type="checkbox"/> Government <input type="checkbox"/> Industrial <input type="checkbox"/> Military <input type="checkbox"/> Museum		<input type="checkbox"/> Park <input type="checkbox"/> Private Residence <input type="checkbox"/> Religious <input type="checkbox"/> Scientific
				<input type="checkbox"/> Transportation <input checked="" type="checkbox"/> Other (Specify) <u>Unoccupied</u>
				<input type="checkbox"/> Comments _____ _____ _____
4. OWNER OF PROPERTY				
OWNER'S NAME: Grover, Shelley A. and Wife				
STREET AND NUMBER: 9310 Wire Avenue				
CITY OR TOWN: Silver Spring			STATE: Maryland	
			20901	
5. LOCATION OF LEGAL DESCRIPTION				
COURTHOUSE, REGISTRY OF DEEDS, ETC.: Records Office				
STREET AND NUMBER: Howard County Courthouse				
CITY OR TOWN: Ellicott City			STATE: Maryland	
			21043	
Title Reference of Current Deed (Book & Pg. #): Tax Map 21, p.87				
6. REPRESENTATION IN EXISTING SURVEYS				
TITLE OF SURVEY: Howard County Historic Sites Inventory				
DATE OF SURVEY: 1976 <input type="checkbox"/> Federal <input checked="" type="checkbox"/> State <input type="checkbox"/> County <input type="checkbox"/> Local				
DEPOSITORY FOR SURVEY RECORDS: Maryland Historical Trust				
STREET AND NUMBER: 21 State Circle				
CITY OR TOWN: Annapolis			STATE: Maryland	
			21401	

SEE INSTRUCTIONS

7. DESCRIPTION

CONDITION	(Check One)				
	<input type="checkbox"/> Excellent	<input type="checkbox"/> Good	<input type="checkbox"/> Fair	<input checked="" type="checkbox"/> Deteriorated	<input type="checkbox"/> Ruins
	(Check One)			(Check One)	
	<input type="checkbox"/> Altered	<input checked="" type="checkbox"/> Unaltered		<input type="checkbox"/> Moved	<input checked="" type="checkbox"/> Original Site

DESCRIBE THE PRESENT AND ORIGINAL (if known) PHYSICAL APPEARANCE

Roxbury Mill is a two and a half story frame building with full stone basement three bays wide and three bays deep with gabled roof running north-south. Fenestration is proportionally scaled rectangular in shape with double-hung sashes holding six-over-six lites. A third story window rests in the north and south walls with a central first floor entrance on the north wall and a wide basement entrance on the south elevation.

A brick chimney is located in the north east corner of the building.

A second basement entrance is located in the central bay of the west wall flanked by two rectangular windows surmounted by flat stone lintels.

SEE INSTRUCTIONS

SIGNIFICANCE

PERIOD (Check One or More as Appropriate)

<input type="checkbox"/> Pre-Columbian	<input type="checkbox"/> 16th Century	<input type="checkbox"/> 18th Century	<input type="checkbox"/> 20th Century
<input type="checkbox"/> 15th Century	<input type="checkbox"/> 17th Century	<input checked="" type="checkbox"/> 19th Century	

SPECIFIC DATE(S) (If Applicable and Known)

AREAS OF SIGNIFICANCE (Check One or More as Appropriate)

<input type="checkbox"/> Aboriginal	<input type="checkbox"/> Education	<input type="checkbox"/> Political	<input type="checkbox"/> Urban Planning
<input type="checkbox"/> Prehistoric	<input type="checkbox"/> Engineering	<input type="checkbox"/> Religion/Philosophy	<input type="checkbox"/> Other (Specify)
<input checked="" type="checkbox"/> Historic	<input checked="" type="checkbox"/> Industry		_____
<input checked="" type="checkbox"/> Agriculture	<input type="checkbox"/> Invention	<input type="checkbox"/> Science	_____
<input type="checkbox"/> Architecture	<input type="checkbox"/> Landscape Architecture	<input type="checkbox"/> Sculpture	_____
<input type="checkbox"/> Art	<input type="checkbox"/> Literature	<input type="checkbox"/> Social/Humanitarian	_____
<input type="checkbox"/> Commerce	<input type="checkbox"/> Military	<input type="checkbox"/> Theater	_____
<input type="checkbox"/> Communications	<input type="checkbox"/> Music	<input type="checkbox"/> Transportation	_____
<input type="checkbox"/> Conservation			_____

STATEMENT OF SIGNIFICANCE

An alternate name for Maryland 97 near Roxbury is Roxbury Mill Road. The old mill which was once located on old 97 has since been by passed by the present main road. (Initially almost all roads led to a mill and were so named.)

According to Mr. John McGrain, an authority on early Maryland industry, the original tract was patented in 1700 as "Hard to Get and Dear Paid For". The present mill is probably the second mill on the site since an earlier Dorsey Mill is conjectured. Dorsey was succeeded by Samuel Davis, a Quaker minister. A Mr. Allen Bowie Davis then took over, son of Thomas. He also owned Glenwood Mills in Montgomery County.

Roxbury Mill is shown on the 1795 map and also the G. M. Hopkins Atlas of 1878. The latter shows the building as B. Davis grist and saw mill.

Roxbury is described as a "rocky and romantic settlement", with a general store and post office (established in 1832). Roxbury was the last operating grist mill in Howard County. Raymond Smallwood, who died in 1958 was the last miller. Mrs. Smallwood still occupied the house in 1967.

Served by the Cat Tail Creek, the mill is of clap board with a stone foundation.

SEE INSTRUCTIONS

9. MAJOR BIBLIOGRAPHICAL REFERENCES

Warfield, J. D. Founders of Ann Arundel and Howard Counties, Maryland.
Baltimore, 1972

Hopkins Atlas 1878

10. GEOGRAPHICAL DATA

LATITUDE AND LONGITUDE COORDINATES DEFINING A RECTANGLE LOCATING THE PROPERTY			O R	LATITUDE AND LONGITUDE COORDINATES DEFINING THE CENTER POINT OF A PROPERTY OF LESS THAN TEN ACRES		
CORNER	LATITUDE	LONGITUDE		LATITUDE	LONGITUDE	
	Degrees Minutes Seconds	Degrees Minutes Seconds		Degrees Minutes Seconds	Degrees Minutes Seconds	
NW	° ' "	° ' "		° ' "	° ' "	
NE	° ' "	° ' "		° ' "	° ' "	
SE	° ' "	° ' "		° ' "	° ' "	
SW	° ' "	° ' "		° ' "	° ' "	

APPROXIMATE ACREAGE OF NOMINATED PROPERTY:

Acreage Justification:

Please see Tax Map 21, page 87

SEE INSTRUCTIONS

11. FORM PREPARED BY

NAME AND TITLE:
Cleora B. Thompson, Archivist

ORGANIZATION: Comprehensive Planning Section DATE:

STREET AND NUMBER:
3450 Courthouse Drive

CITY OR TOWN: Ellicott City STATE: Maryland 21043

12. State Liaison Officer Review: (Office Use Only)

Significance of this property is:

National State Local

Signature _____

RIGGS MILL (4)

Shown in the atlas on Cabin Branch, 1 mile from the Patuxent, this was a gristmill belonging to the heirs of E. Riggs.

To: Cleo

NO-12

ROBERTS MILL (1)

Same as Hockley Mill.

ROCKY GLEN MILL (4)

This mill was owned by Charles Hobbs and was still operating when listed in the Times, Ellicott City, March 17, 1941. Cf. Hobbs Mill.

ROVERS MILL (4)
ROVERS MILL ROAD

Rovers Mill Road runs east from McKendree Road, crossing the Middle Patuxent River and coming to a dead end. A grist and saw mill appears at the Rover site on the 1860 Martenet map, but its name is not legible (H. For---). Possibly related to Hobbs Mill.

ROXBURY MILL (4) ◆
ROXBURY MILL ROAD

Roxbury Mill Road is an alternate name for Md. 97, which now bypasses the mill on Cattail Creek. The present structure is at least the second mill on the site, replacing that of Philemon Dorsey. In the Md. Journal of August 5, 1791, Dorsey advertised a two-story mill, 26 x 22, half stone, half wood; two pair of stones, one of Cologne, the other short-hill; the mill was rebuilt in 1788; undershot wheel, 9-foot head of water; sawmill partly built. Captain Dorsey was district surveyor and owned thousands of acres in Howard County, HECM, p. 250. *

Philemon Dorsey, Planter and Farmer, conveyed part of Vanity Mount and Duvall's Range to Dr. Charles Alexander Warfield, 1792 (AA Liber NH 6:172). The deed mentioned "a small rill that runs into the mill Dam" and also a Tumbling Dam. Dr. Warfield sold to Samuel Thomas, Gentleman, in 1794 for natural love and affection, plus 5 Shillings. The tract was on the "Catt Tale river" (NH 7:269).

Thomas' daughter married Isaac Knight, who bought the mill from his father-in-law and gave a mortgage for part of the price. "There was in use in the said mill certain machinery for the invention of which a certain Oliver Evans had obtained a patent ... but the said Samuel Thomas had never paid the said Oliver Evans for his patent right."

"Evans brought suit against him ... and other millers in that part of the country, who used the same kind of machinery, for the violation of his patent rights and the respondent [Knight] believing that it would be better both for him and the said Samuel Thomas to compromise with the said Oliver Evans, than to incur the expense and risk of a law suit, with the approbation of the said Samuel Thomas, agreed to pay, and did pay to the said Oliver Evans the sum of four hundred dollars on the 14th day of April 1818." Chancery Papers, No. 11,141 (Nicholas and Elizabeth Snowden-vs-Isaac Knight and Julianna, uxor, 1822).

-more-

* Historic Montgomery County, Maryland

The license from Oliver Evans to Isaac Knight specifies his mill of "1 water wheel driving not more than one pair of millstones on Cattale Branch ... Rock's Busy Mill." The opposite side of the license is a cross-sectional view of an Evans Mill, Plate VIII from the Young Mill-Wright.

Samuel Davis, a Quaker minister, came to own the mill, followed by Allen Bowie Davis, who also owned Glemwood Mills in Montgomery County. Roxbury mill had appeared on the 1795 Griffith map; a post office of that name was established in 1832. The atlas showed it as B. Davis grist and saw mill.

In the 1850 census, Allen Bowie Davis' Roxbury Grist Merchant Mill was valued at \$3000, with 3 pair of stones, 1 packer, 2 employees, and output of 125,000 lb meal, 200 bbl superfine flour, 3300 lb buckwheat, and 25,000 lb chop flour, worth \$2666. The sawmill worth \$200 had 2 employees and 1 saw to cut 40,000 ft oak and chestnut plank (\$500).

Davis sold in 1874 to George T.R. Peddicord the Roxbury Mills, a store-dwelling, and the "miller's house ... lately occupied by George Brandenburg" plus right of access to clean out the head race and dam (LJW 35:124). Peddicord appeared in the 1880 census with a sawmill worth \$500, 1 employee, and 1 gang saw; a 13-foot fall on Cattail Creek drove a 12 hp overshot wheel 10 ft broad at 9 rpm; output was less than \$500/annum. The custom gristmill was worth \$3000 and had 1 employee, 2 run of stones, and 50 bu/diem maximum capacity. Output was 300 bbl flour, 46 tons meal, 20 tons feed, and 1000 lb hominy (\$3650).

In 1895, Joseph H. Peddicord sold to Stephen A. Brandenburg; subsequent owners were William B. Rucker (1903), Victoria Duvall (1919), Walter Jacob Livesay (1920), and Raymond L. and William N. Smallwood (1922). Raymond L. Smallwood and wife became owners in 1929 and Shelley A. Grover in 1961 (369:506).

It was "a rocky and romantic settlement" in 1905 with a post office and mill, FAACHC, p. 440. Roxbury was the last operating gristmill in Howard County, and Raymond Smallwood was the last miller; he died in 1958, but his widow continued in the miller's house (1967). The mill is of frame and clapboard, standing but disused in 1975, west of Md. 97 on a bypassed segment of road.

RUSSELL LIME KILN ()

The 1850 census listed John Russell's hand-powered lime kiln worth \$300 and producing 10,800 bu annually (\$1250).

* Founders of AA & Howard Counties

LICENSE.

Know all Men, that I, OLIVER EVANS, of the City of Phi-

ladelphia, have received of Isaac Throught of the County of and City of Baltimore the sum of

\$ 1,00

of one thousand Dollars

in full, for License hereby granted to the said Isaac Throught Heirs, Executors, Administrators or Assigns, to construct, make, and use, my Patented Machines and Patented Improvements in the art of manufacturing flour or meal, as follow, viz. For elevating grain and meal and conveying the same from one part of the mill to another, and for cooling the meal and attending the bolting-hoppers; for the use of his Mill consisting of one waterwheel, driving not more than one pair of millstones at the same time, situate on the State Branch

called Rocks Run Mill for and during my present or any future patent term. In witness whereof I have hereunto set my hand and seal, this 11 day of April 1818

Sealed and delivered in the presence of us,

Witness my hand and seal this 11th day of April 1818
Oliver Evans
By his Agent
Evan Evans

Alfred Throught
Charles H. ...

[On the other side is the eighth plate of the Millwright and Miller's Guide, published by Oliver Evans, showing the Machinery receiving the grain from the wagon or ship, and carrying it through all the operations until manufactured and ready to be packed into barrels, producing his patented improvements in the art of manufacturing flour; to which book the miller is referred for instructions to build and use the machinery.]

ROXBURY MILLS. Certificate for the use of Oliver Evans' patented milling inventions issued to Isaac Knight of Roxbury Mills, 1816 (H.R.).

Oliver Evans

HO-12

ROXBURY MILLS. Reverse of a certificate issued by Oliver Evans to Isaac Knight,
Miller at Roxbury Mills on Cattail Creek, 1818 (H.R.).

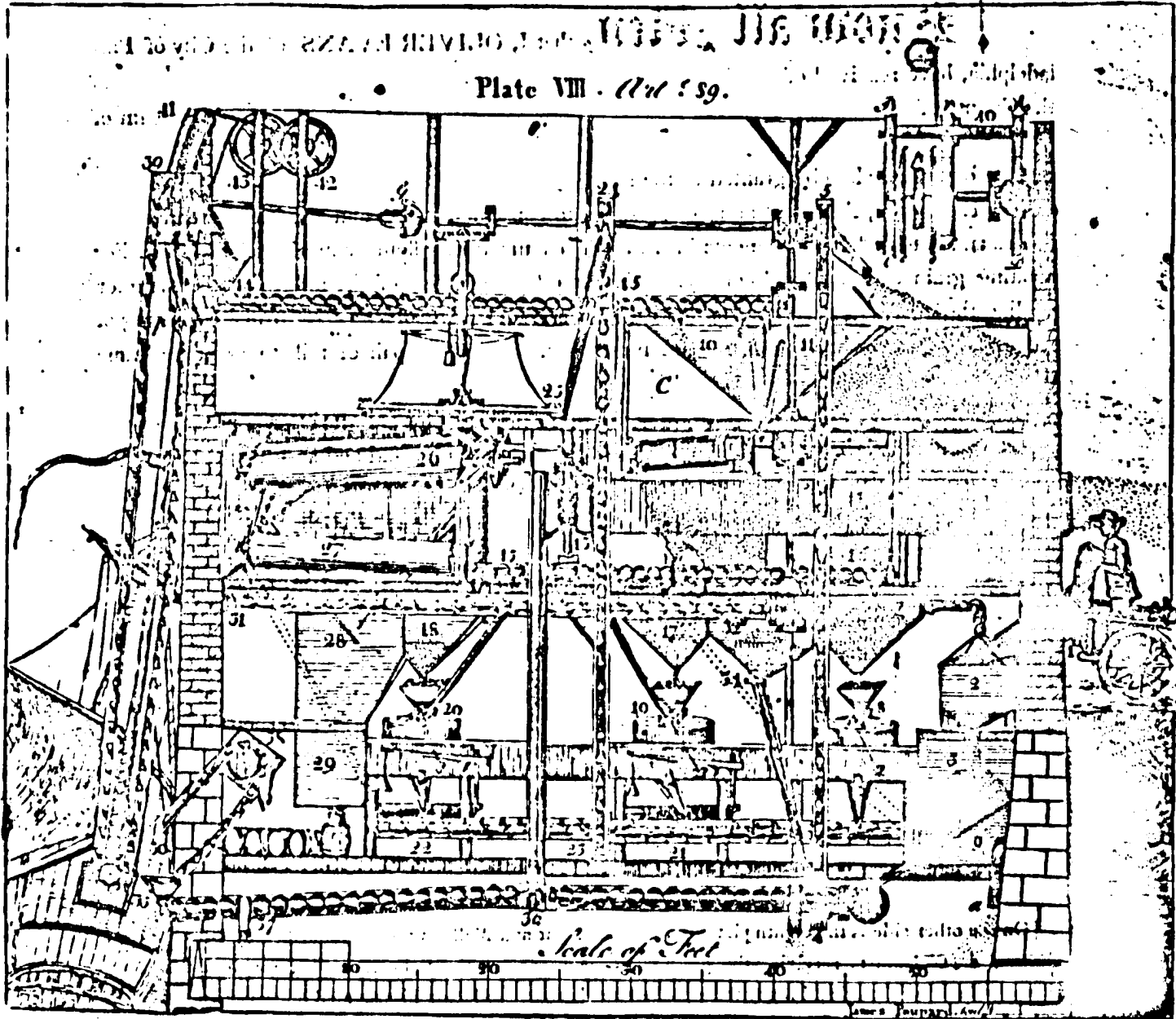

NO-12



HO. 12

9270

Roxbury Mill JSE 4/72



DIST 4 HO-12
ROXBURY MILLS
CB THOMPSON



ROXBURY MILL

#0-12

HOWARD CO, MD

PETER KURTZE 3/88

NEG AT MD SHPD



ROXBURY MILL HO-12

HOWARD CO., MD

PETER KURTZE 3/88

NEG AT MD S&PO



HO-12
ROXBURY MILL
HOWARD CO., MD
PETER KURTZE 3/88
NEG AT MD SHPO