

GENERAL NOTES

PART I

- APPROXIMATE LOCATIONS OF EXISTING MAINS ARE SHOWN. THE CONTRACTOR SHALL TAKE ALL NECESSARY PRECAUTIONS TO PROTECT EXISTING MAINS AND SERVICES AND MAINTAIN UNINTERRUPTED SERVICE. ANY DAMAGE INCURRED SHALL BE REPAIRED IMMEDIATELY TO THE SATISFACTION OF THE ENGINEER AT THE CONTRACTOR'S EXPENSE.
- THE EXISTING TOPOGRAPHY SHOWN HEREON IS TAKEN FROM AN AERIAL TOPOGRAPHIC SURVEY PREPARED BY ROBERT H. VOGEL ENGINEERING INC; DATED OCTOBER, 2014.
- THE COORDINATES SHOWN ON THE DRAWINGS ARE BASED ON MARYLAND STATE REFERENCE SYSTEM NAD '83/91 AS PROJECTED BY HOWARD COUNTY GEODETIC CONTROL STATIONS 43EB AND 43HB. ALL VERTICAL CONTROLS ARE BASED ON NAVD'88. VERTICAL CONTROLS PROVIDED ON DRAWINGS ARE:
 GEODETIC SURVEY CONTROL 43EB N 545963.6476 E 1371573.8400
 BRASS DISC SET ON TOP OF A CONCRETE MONUMENT.
 GEODETIC SURVEY CONTROL 43HB (N 453166.729 E 1374425.0243)
 BRASS DISC SET ON TOP OF A CONCRETE MONUMENT.
- ALL PIPE ELEVATIONS SHOWN ARE INVERT ELEVATIONS UNLESS OTHERWISE NOTED.
- CLEAR ALL UTILITIES BY A MINIMUM OF 12 INCHES. CLEAR ALL POLES BY 5'-0" MINIMUM OR TUNNEL AS REQUIRED UNLESS OTHERWISE NOTED. THE OWNER HAS CONTACTED THE UTILITY COMPANIES AND HAS MADE ARRANGEMENTS FOR BRACING OF POLES AS SHOWN ON DRAWINGS. IN THE EVENT THE CONTRACTOR'S WORK REQUIRES THE BRACING OF ADDITIONAL POLES, ANY COST INCURRED BY THE OWNER FOR BRACING OF ADDITIONAL POLES OR DAMAGES SHALL BE DEDUCTED FROM MONIES OWED THE CONTRACTOR. THE CONTRACTOR SHALL COORDINATE WITH THE UTILITY COMPANIES TO SCHEDULE THE BRACING OF THE POLES.
- FOR DETAILS NOT SHOWN ON THE DRAWINGS, AND FOR MATERIALS AND CONSTRUCTION METHODS, USE HOWARD COUNTY DESIGN MANUAL, VOLUME IV, STANDARD SPECIFICATIONS AND DETAILS FOR CONSTRUCTION (LATEST EDITION). THE CONTRACTOR SHALL HAVE A COPY OF VOLUME IV ON THE JOB.
- WHERE TEST PITS HAVE BEEN MADE ON EXISTING UTILITIES, THEY ARE NOTED BY THE SYMBOL AT THE LOCATIONS OF THE TEST PITS. A NOTE OR NOTES CONTAINING THE RESULTS OF THE TEST PIT OR PITS IS INCLUDED ON THE DRAWINGS. EXISTING UTILITIES IN THE VICINITY OF THE PROPOSED WORK FOR WHICH TEST PITS HAVE NOT BEEN DUG SHALL BE LOCATED BY THE CONTRACTOR TWO WEEKS IN ADVANCE OF CONSTRUCTION OPERATION AT HIS OWN EXPENSE.
- THE CONTRACTOR SHALL NOTIFY THE FOLLOWING UTILITY COMPANIES OR AGENCIES AT LEAST FIVE WORKING DAYS BEFORE STARTING WORK SHOWN ON THESE PLANS:
 AT&T 1-800-252-1133
 BGE (CONSTRUCTION SERVICES) 410-637-8713
 BGE (EMERGENCY) 410-685-0123
 BUREAU OF UTILITIES 410-313-4900
 COLONIAL PIPELINE CO. 410-795-1390
 MISS UTILITY 1-800-257-7777
 STATE HIGHWAY ADMINISTRATION 410-531-5533
 VERIZON 1-800-743-0033
- TREES AND SHRUBS ARE TO BE PROTECTED FROM DAMAGE TO THE MAXIMUM EXTENT. TREES AND SHRUBS LOCATED WITHIN THE CONSTRUCTION STRIP ARE NOT TO BE REMOVED OR DAMAGED BY THE CONTRACTOR.
- THE CONTRACTOR SHALL REMOVE TREES, STUMPS AND ROOTS ALONG THE LINE OF EXCAVATION. PAYMENT FOR SUCH REMOVAL SHALL BE INCLUDED IN THE UNIT PRICE BID FOR THE CONSTRUCTION OF THE MAIN.
- THE CONTRACTOR SHALL NOTIFY THE BUREAU OF HIGHWAYS, HOWARD COUNTY, AT (410) 313-7450 AT LEAST FIVE WORKING DAYS BEFORE OPEN CUTTING OR BORING/JACKING OF ANY COUNTY ROAD FOR LAYING WATER/SEWER MAINS OR HOUSE CONNECTIONS. THE APPROVAL OF THESE DRAWINGS WILL CONSTITUTE COMPLIANCE WITH DPW REQUIREMENTS PER SECTION 18.114(g) OF THE HOWARD COUNTY CODE.

PART II - WATER

- ALL WATER MAINS TO BE PVC C-900 UNLESS OTHERWISE NOTED.
- TOPS OF ALL WATER MAINS TO HAVE A MINIMUM OF 3'-6" COVER UNLESS OTHERWISE NOTED.
- VALVES ADJACENT TO TEES SHALL BE STRAPPED TO TEES.
- ALL FITTINGS SHALL BE BUTTRESSED OR ANCHORED WITH CONCRETE IN ACCORDANCE WITH THE STANDARD DETAILS UNLESS OTHERWISE PROVIDED FOR ON THE DRAWINGS.
- FIRE HYDRANTS SHALL BE SET TO THE BURY LINE ELEVATIONS SHOWN ON THE DRAWINGS. ALL FIRE HYDRANTS SHALL BE RESTRAINED AND BUTTRESSED WITH CONCRETE IN ACCORDANCE WITH THE STANDARD DETAIL. THE SOIL AROUND THE FIRE HYDRANT SHALL BE COMPACTED IN ACCORDANCE WITH SECTION 1000 AND 1005 OF THE STANDARD SPECIFICATIONS.
- THE CONTRACTOR SHALL NOT OPERATE ANY WATER MAIN VALVES ON THE EXISTING WATER SYSTEM.
- FOR PVC WATER MAINS, ALL RECORDS FOR THE QUALITY CONTROL AND QUALIFICATION TEST REQUIREMENTS NOTED IN SECTION 5.1 OF THE ANWA STANDARD SPECIFICATIONS FOR PRESSURE PIPE SHALL BE SUBMITTED WITH THE PIPE MATERIAL CERTIFICATIONS OR SHOP DRAWINGS PRIOR TO APPROVAL OF THE MATERIAL FOR USE. THE TEST RECORDS SHALL BE FOR THE PIPE TO BE INSTALLED UNDER THIS CONTRACT. ALL PVC PIPE SHALL CONTAIN MARKINGS TO ALLOW CROSS REFERENCING OF THE PIPE SUPPLIED TO THE REST RECORDS RECEIVED.
- UNLESS OTHERWISE NOTED ON THE PLANS OR IN THE SPECIFICATIONS, SEVENTEEN (17) POUND SACRIFICIAL ANODES SHALL BE INSTALLED ON ALL VALVES AND METALLIC FITTINGS USED WITH PVC WATER MAINS IN ACCORDANCE WITH VOLUME IV, STANDARD SPECIFICATIONS AND DETAILS FOR CONSTRUCTION. MAGNESIUM ANODES SHALL BE INSTALLED ON ALL VALVES AND DUCTILE IRON FITTINGS INCLUDING RESTRAINTS AND HARNESSSES. ZINC ANODES SHALL BE INSTALLED ON ALL STAINLESS STEEL FITTINGS AND SADDLES USED WITH PVC MAINS. ALL "TEES" USED WITH PVC MAINS SHALL BE DUCTILE IRON.

PART III - SEWER

- ALL SEWER MAINS SHALL BE D.I.P. OR P.V.C UNLESS OTHERWISE NOTED.
- ALL MANHOLES SHALL BE 4'-0" INSIDE DIAMETER UNLESS OTHERWISE NOTED.
- FORCE MAINS SHALL BE D.I.P. ONLY.
- MANHOLES SHOWN WITH 12" AND 16" WALLS ARE FOR BRICK MANHOLES ONLY.
- MANHOLES DESIGNATED W.T. IN PLAN AND PROFILE SHALL HAVE WATERTIGHT FRAME AND COVERS, STANDARD DETAIL G5.52, WHERE WATERTIGHT FRAME AND COVER IS USED, SET TOP OF FRAME 1'-6" ABOVE FINISHED GRADE UNLESS OTHERWISE NOTED ON THE DRAWINGS.
- HOUSE(S) WITH THE SYMBOL "C.M.S." INDICATES THAT CELLAR CANNOT BE SERVED.

SEDIMENT CONTROL MEASURES WILL BE IMPLEMENTED IN ACCORDANCE WITH SECTION 308 OF THE SPECIFICATIONS AND WITH SITE DEVELOPMENT PLAN SDP-16-012.

THIS DEVELOPMENT IS APPROVED FOR SOIL EROSION AND SEDIMENT CONTROL BY THE HOWARD SOIL CONSERVATION DISTRICT.

John K. Blanton 3/14/16
 SOIL CONSERVATION DISTRICT DATE

DEPARTMENT OF PUBLIC WORKS
 HOWARD COUNTY, MARYLAND

DEPARTMENT OF PLANNING & ZONING
 HOWARD COUNTY, MARYLAND

ROBERT H. VOGEL ENGINEERING, INC.
 ENGINEERS • SURVEYORS • PLANNERS
 8407 MAIN STREET TEL: 410.461.7666
 ELLICOTT CITY, MD 21043 FAX: 410.461.8996

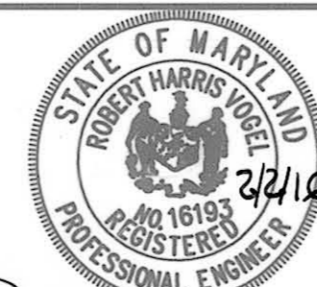

PROFESSIONAL CERTIFICATE
 I HEREBY CERTIFY THAT THESE DOCUMENTS WERE PREPARED OR APPROVED BY ME, AND THAT I AM A DULY LICENSED PROFESSIONAL ENGINEER UNDER THE LAWS OF THE STATE OF MARYLAND, LICENSE NO. 16193, EXPIRATION DATE: 03-27-2016

DRN:	KG	DES:	RHV	RHV	2	REVISE WATERLINE 'A' PROFILE TO AVOID 60°SD	08/17/16
CHK:	RHV	RHV	1	REVISE SEWER LOCATION			6/14/16
DATE:	FEBRUARY 2016	BY NO.		REVISION			

FINAL WATER AND SEWER CONSTRUCTION PLAN CONTRACT 24-4941-D

MARYLAND FOOD CENTER AUTHORITY - P/O PARCEL 'J'
 PROPOSED WAREHOUSE
 7540 ASSATEAGUE DRIVE
 ZONED: M-2
 L16203/F.246 - PLAT 19144
 TAX MAP 43 GRID 15 PARCEL 2, PARCEL J
 6TH ELECTION DISTRICT HOWARD COUNTY, MARYLAND

SCALE AS SHOWN
 SHEET 1 OF 3

FINAL WATER AND SEWER CONSTRUCTION PLAN

MARYLAND FOOD CENTER AUTHORITY

P/O PARCEL 'J'

PROPOSED WAREHOUSE

CONTRACT 24-4941-D

HOWARD COUNTY, MARYLAND



VICINITY MAP
 SCALE: 1"=600'

WATER ZONE	400
TEST GRADIENT:	550

Type of Building :	WAREHOUSE
No. of Lots/Parcels :	1
No. of single Water House Connections :	1
No. of Sewer House Connections :	1
Sewer Shed :	LITTLE PATUXENT RIVER
Treatment Plant :	LITTLE PATUXENT RIVER

BENCHMARKS
 HOWARD COUNTY BENCHMARK 43EB
 N 545963.6476 E 1371573.8400 ELEV.: 216.327'
 HOWARD COUNTY BENCHMARK 43HB
 N 453166.729 E 1374425.0243 ELEV.: 251.622'

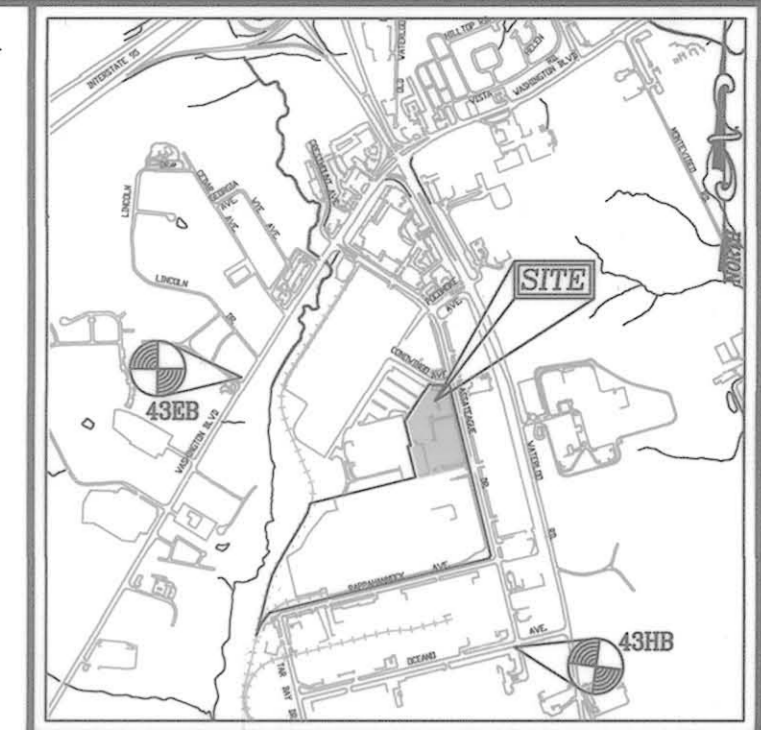

VICINITY MAP
 SCALE: 1"=2000'
 ADC MAP COORDINATES: 20 J3

LEGEND

EXISTING WATER MAIN	— W —
PROPOSED WATER MAIN	— [Symbol] —
FIRE HYDRANT	[Symbol]
PROPOSED VALVE	[Symbol]
PROPOSED TEE	[Symbol]
PROPOSED STORM DRAIN	— [Symbol] —
EXISTING STORM DRAIN	— SD —
EXISTING SEWER	— SS —
SEWER MANHOLE	[Symbol]
PRIVATE WATER HOUSE CONNECTION	— [Symbol] —
PRIVATE SEWER HOUSE CONNECTION	— [Symbol] —
PROPOSED SIGN	[Symbol]
PROPOSED LIGHT	[Symbol]
PUBLIC SEWER MAIN	— [Symbol] —

QUANTITIES

NAME OF UTILITY CONTRACTOR :		SURVEY AND DRAFTING DIVISION AS-BUILT DATE :	
ITEMS	QUANTITIES ESTIMATED	AS-BUILT	
		QUANTITIES	TYPE MANUFACTURER/SUPPLIER
WATER			
12" WATER (C-900 DR-16)	676 LF		
8" WATER (C-900 DR-16)	346 LF		
6" WATER (C-900 DR-16)	34 LF		
12" X 12" TEE	2 EA	FUSION BONDED EPOXY GATED	J M EAGLE
12" X 8" TEE	2 EA		
8" X 6" TEE	1 EA		
12" VALVE	3 EA	SERIES 2500	AMERICAN FLOW CONTROL
8" VALVE	4 EA		
6" VALVE	2 EA		
6" FIRE HYDRANT	2 EA		
12" CAP	3 EA	FUSION BONDED EPOXY MJ	TYLER UNION
8" CAP	3 EA		
1/16" HORIZONTAL BEND	1 EA	FUSION BONDED EPOXY MJ	TYLER UNION
1/32" HORIZONTAL BEND	2 EA		
12"-3" HORIZONTAL COUPLING	2 EA	HIGH DEFLECTION	NORTH AMERICAN SPECIALTY
8"-3" HORIZONTAL COUPLING	1 EA		
12"-1.5" VERTICAL COUPLING	1 EA		
8" WATER (HOPE 6416)	54 LF		
SEWER			
8" SEWER	28 LF	SEWER SDR 35	J M EAGLE

AS-BUILT
 By: *[Signature]* Date: 3/9/16

OWNER/DEVELOPER
 MCA ASSATEAGUE HOLDINGS LLC
 9601 ROBERT FULTON DR
 SUITE 200
 COLUMBIA, MD 21046
 410-290-1400

CHIEF, BUREAU OF UTILITIES
 3/11/16 DATE

CHIEF, DEVELOPMENT ENGINEERING DIVISION
 3-18-16 DATE

ROBERT H. VOGEL, PE, No. 16193

600' SCALE MAP NO. 43 BLOCK NO. 15

TAX MAP 43 GRID 15 6TH ELECTION DISTRICT

PARCEL 2, PARCEL J HOWARD COUNTY, MARYLAND

SDP-16-012

LEGEND:

	PROPERTY LINE
	RIGHT-OF-WAY LINE
	ADJACENT PROPERTY LINE
	EXISTING CURB AND GUTTER
	PROPOSED CURB AND GUTTER
	EXISTING UTILITY POLE
	EXISTING LIGHT POLE
	EXISTING SIGN
	EXISTING SANITARY MANHOLE
	EXISTING SANITARY LINE
	EXISTING CLEANOUT
	EXISTING FIRE HYDRANT
	EXISTING WATER LINE
	PROP. PERMEABLE CONCRETE
	PROPOSED WATER MAIN
	FIRE HYDRANT
	PROPOSED VALVE
	PROPOSED TEE
	PROPOSED PUBLIC SEWER
	PROPOSED PRIVATE S/C
	PROPOSED PRIVATE WHC

- NOTES:**
- PROCEDURE TO ABANDON EX. 12" WHC AND CONNECT PROPOSED 12" WHC: (REFERENCE DESIGN MANUAL VOLUME IV FOR ABANDONMENT PROCEDURES)
- ANY INTERRUPTION OF WATER SERVICE TO BE COORDINATED WITH AFFECTED BUSINESSES.
- INSTALL 12" TAPPING SLEEVE AND VALVE AT STATION 0+00 MAIN "D". CONSTRUCT MAIN "D" INCLUDING 12" VALVE AT STATION 0+04 AT MAIN "D". CLOSE 12" VALVE AT STATION 0+04 AT MAIN "D".
 - INSTALL MAIN "C". CLOSE 8" VALVE AT STATION 0+04 ON MAIN "C". CLOSE EXISTING 8" VALVE ON EXISTING 8" WATER (ADJACENT TO EXISTING 12" WATER MAIN, ASSATEAGUE DRIVE). CUT EXISTING 8" WATER MAIN AND PROVIDE CAP AND BUTTRISS. ABANDON 8" VALVE AND MAIN IN PLACE. OPEN 8" VALVE AT STATION 0+04 ON MAIN "C".
 - INSTALL REMAINING 12" WATER (MAIN "D") AND 12" WHC, INCLUDING 12" TAPPING SLEEVE AND VALVE TO EXISTING 12" WHC.
 - CLOSE 12" VALVE AT WHC IN ASSATEAGUE DRIVE AND ANY OTHER VALVE SO THAT 12" WHC IS OUT OF SERVICE. CUT EXISTING WHC SOUTH OF TAPPING SLEEVE AND VALVE AND INSTALL CAP AND BUTTRISS.
 - OPEN ALL VALVES AND RESTORE SERVICE TO 12" WHC.
 - ABANDON EXISTING 12" VALVE FOR WHC IN ASSATEAGUE DRIVE. SITE CONTRACTOR TO REMOVE ON-SITE 12" WHC.

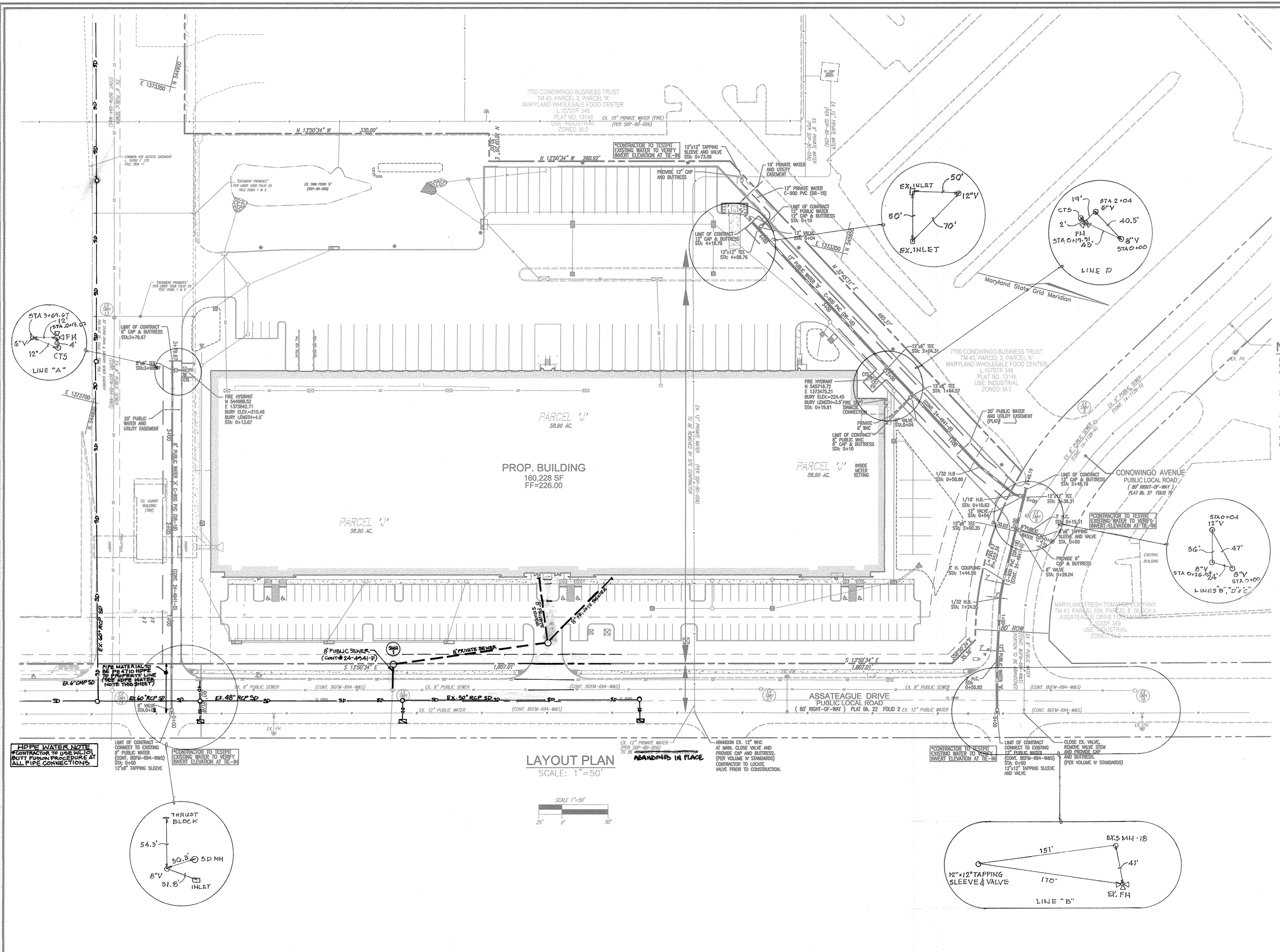

AS-BUILT

Jam Date 2/9/17

OWNER/DEVELOPER
MCA ASSATEAGUE HOLDINGS LLC
9601 ROBERT FULTON DR
SUITE 200
COLUMBIA, MD 21046
410-290-1400

MARYLAND FOOD CENTER
AUTHORITY - P/O PARCEL 'J'
PROPOSED WAREHOUSE
7540 ASSATEAGUE DRIVE
ZONED: M-2
L.16203/F.246 - PLAT 19144

TAX MAP 43, GRID 15
6TH ELECTION DISTRICT

PARCEL 2, PARCEL 'J'
HOWARD COUNTY, MARYLAND

SCALE AS SHOWN
SHEET 2 OF 3

FINAL WATER AND SEWER
CONSTRUCTION PLAN
CONTRACT 24-4941-D

DRN:	KG	DES:	RHV	RHV	2	REVISE WATERLINE 'A' PROFILE TO AVOID EX. 60" SD	08/17/16
CHK:	RHV	RHV	1	REVISE SEWER LOCATION			6/14/16
DATE:	FEBRUARY 2016		BY NO.	REVISION	DATE		

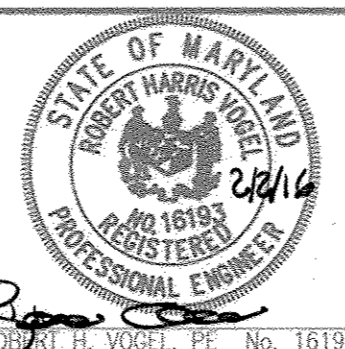

ROBERT H. VOGEL ENGINEERING, INC.
ENGINEERS • SURVEYORS • PLANNERS
8407 MAIN STREET
ELLICOTT CITY, MD 21043
TEL: 410.461.7666
FAX: 410.461.8966

DEPARTMENT OF PLANNING & ZONING
HOWARD COUNTY, MARYLAND

Robert H. Vogel
DATE 3-12-16
MCA

DEPARTMENT OF PUBLIC WORKS
HOWARD COUNTY, MARYLAND

Steve Chen
DATE

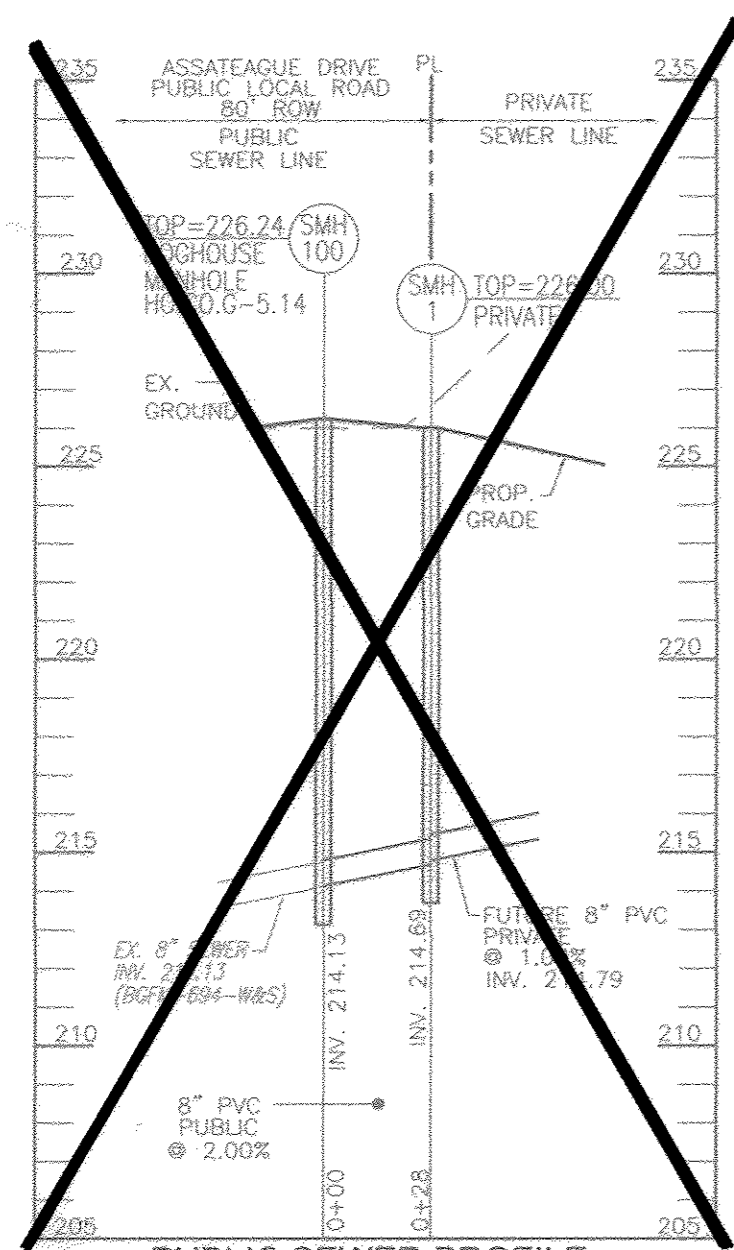

PUBLIC SEWER PROFILE
SCALE: HORIZONTAL - 1"=50'
VERTICAL - 1"=5'

BUTT FUSION PROCEDURE
BEFORE STARTING THE PROCEDURE, BE SURE PORTABLE GENERATORS ARE FUELED UP AND HEATING TOOL SURFACES ARE AT THE PRESCRIBED HEATING TOOL SURFACE TEMPERATURE.
THE STEPS FOR MAKING A BUTT FUSION JOINT ARE:
1. CLEAN THE COMPONENT ENDS AND SECURE THE COMPONENTS IN THE BUTT FUSION EQUIPMENT.
2. FACE (FLAND) THE COMPONENT ENDS.
3. ALIGN THE FACED COMPONENT ENDS.
4. MELT THE COMPONENT ENDS - CHECK FOR PROPER MELT.
5. JOIN THE MELTED COMPONENT ENDS TOGETHER - APPLY AND MAINTAIN JOINING PRESSURE DURING COOLING.
6. INSPECT THE COMPLETED JOINT.

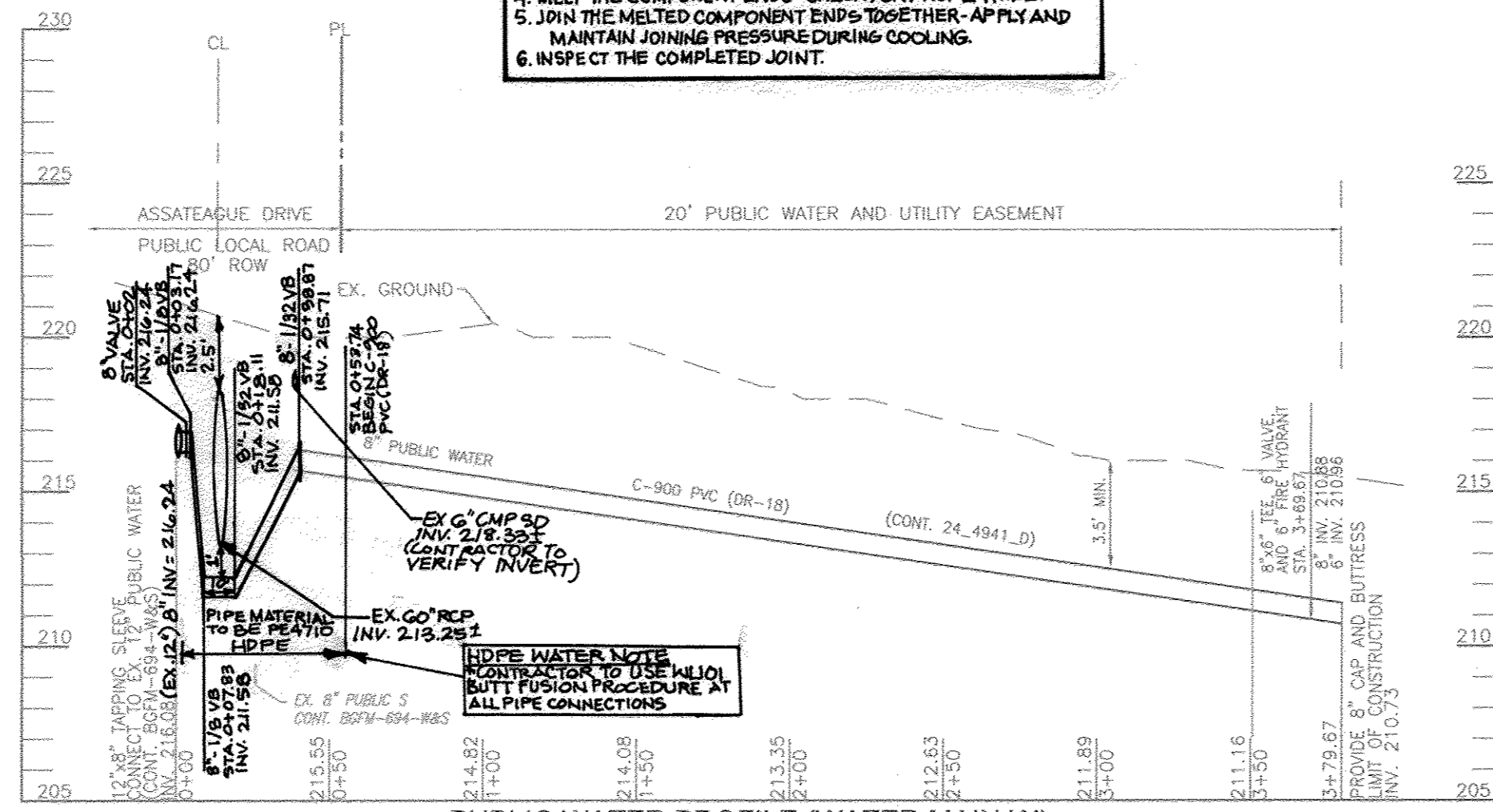

PUBLIC WATER PROFILE (WATER MAIN 'A')
SCALE: HORIZONTAL - 1"=50'
VERTICAL - 1"=5'

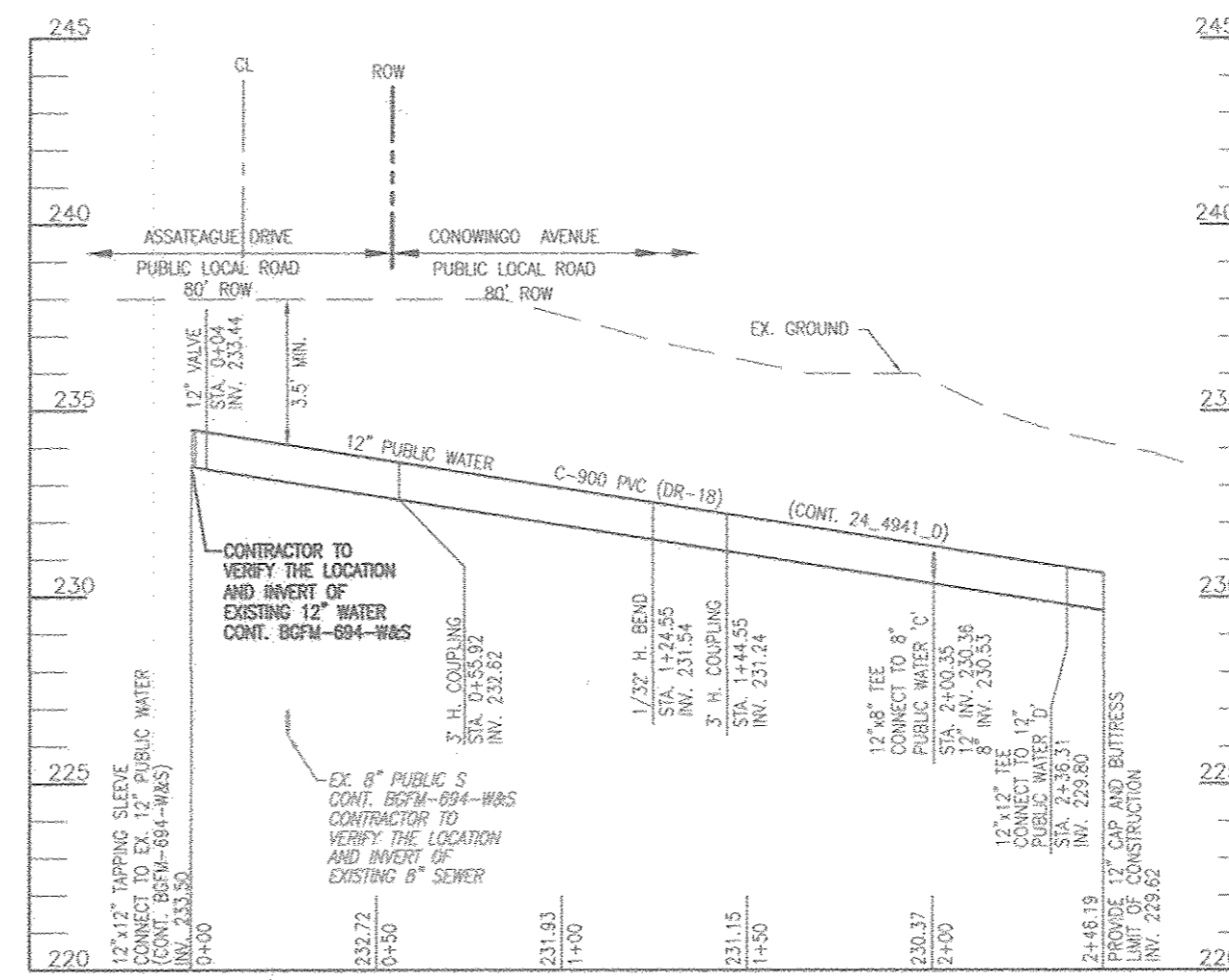

PUBLIC WATER PROFILE (WATER MAIN 'B')
SCALE: HORIZONTAL - 1"=50'
VERTICAL - 1"=5'

WATER MAIN LOCATION CHART	
WATER MAIN 'A'	
WL STA.	APPURTENANCE
WL STA. 0+00.00	CONNECT TO EX. 12" WATER (12"x8" TAPPING SLEEVE)
WL STA. 0+04.00	8" VALVE
WL STA. 3+69.67	8" x 6" TEE (6" VALVE AND FIRE HYDRANT)
WL STA. 3+79.67	8" CAP AND BUTTRISS
WATER MAIN 'B'	
WL STA.	APPURTENANCE
WL STA. 0+00.00	CONNECT TO EX. 12" WATER (12"x12" TAPPING SLEEVE)
WL STA. 0+04.00	12" VALVE
WL STA. 0+55.92	5" HORIZONTAL COUPLING
WL STA. 1+24.55	1/32" HORIZONTAL BEND
WL STA. 1+44.55	3" HORIZONTAL COUPLING
WL STA. 2+00.35	12"x6" TEE
WL STA. 2+36.31	12"x12" TEE
WL STA. 2+46.19	12" CAP AND BUTTRISS
WATER MAIN 'C'	
WL STA.	APPURTENANCE
WL STA. 0+00.00	CONNECT TO EX. 8" WATER (8"x8" TAPPING SLEEVE)
WL STA. 0+04.00	8" VALVE
WL STA. 0+15.51	3" HORIZONTAL COUPLING
WL STA. 0+26.04	8" VALVE
WL STA. 0+30.03	12" x 8" TEE
WATER MAIN 'D'	
WL STA.	APPURTENANCE
WL STA. 0+00.00	12"x12" TEE
WL STA. 0+04.00	12" VALVE
WL STA. 0+10.63	1/16" HORIZONTAL BEND
WL STA. 0+58.66	1/32" HORIZONTAL BEND
WL STA. 1+64.57	12"x8" TEE AND 8" VALVE, 10L 8" W.H.C. 8" CAP & BUTTRISS
WL STA. 2+04.31	12" x 6" TEE (6" VALVE AND FIRE HYDRANT)
WL STA. 2+77.31	1.5" VERTICAL COUPLING
WL STA. 4+09.76	12"x12" TEE
WL STA. 4+19.76	12" CAP AND BUTTRISS

MANHOLE LOCATION CHART

MH No.	TYPE	LOCATION	TOP ELEV.	INV. IN	INV. OUT
1	SMH	ASSATEAGUE DRIVE	226.24	214.00	214.00

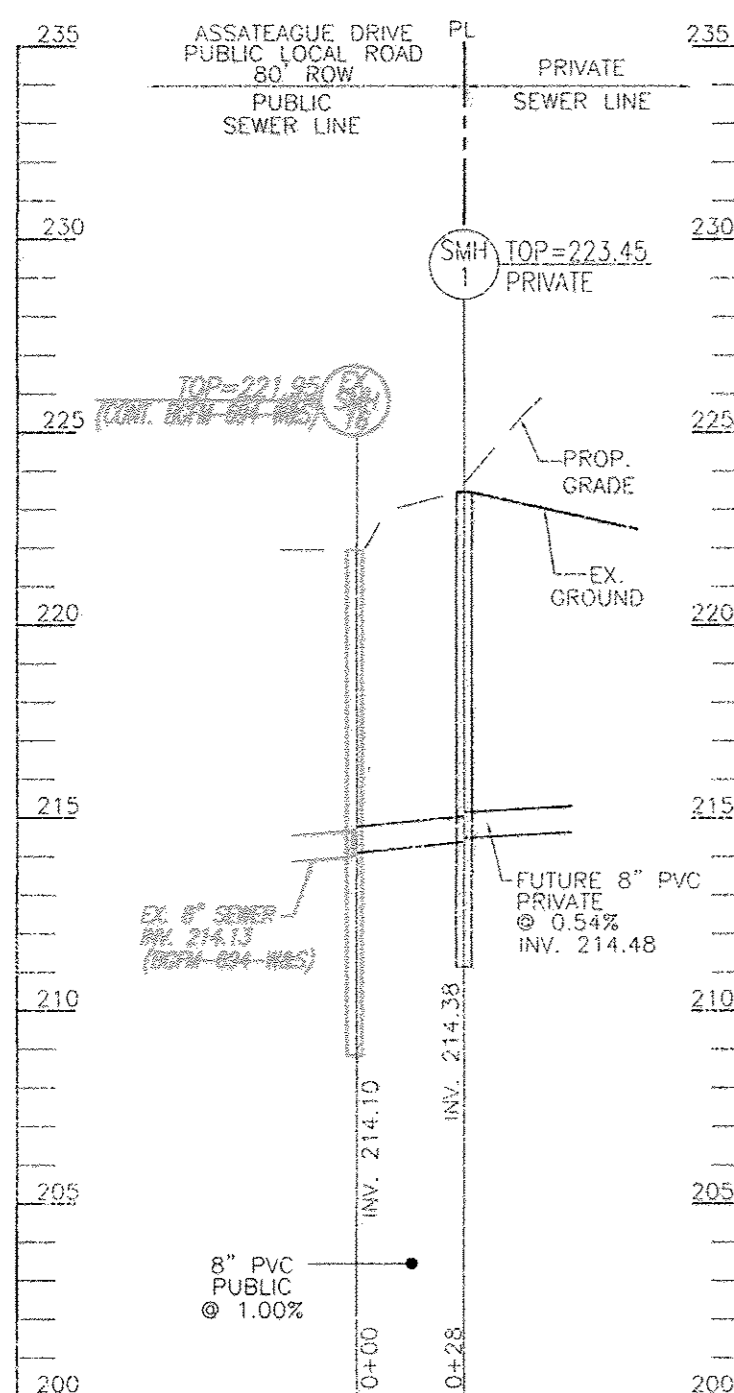

PUBLIC SEWER PROFILE
SCALE: HORIZONTAL - 1"=50'
VERTICAL - 1"=5'

*CONTRACTOR TO TEST PIT EXISTING WATER TO VERIFY INVERT ELEVATION AT TIE-IN

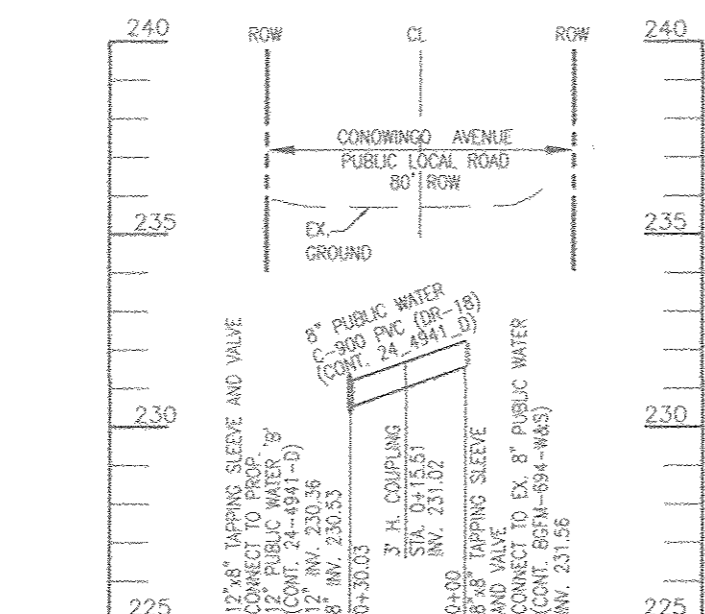

PUBLIC WATER PROFILE (WATER MAIN 'C')
SCALE: HORIZONTAL - 1"=50'
VERTICAL - 1"=5'

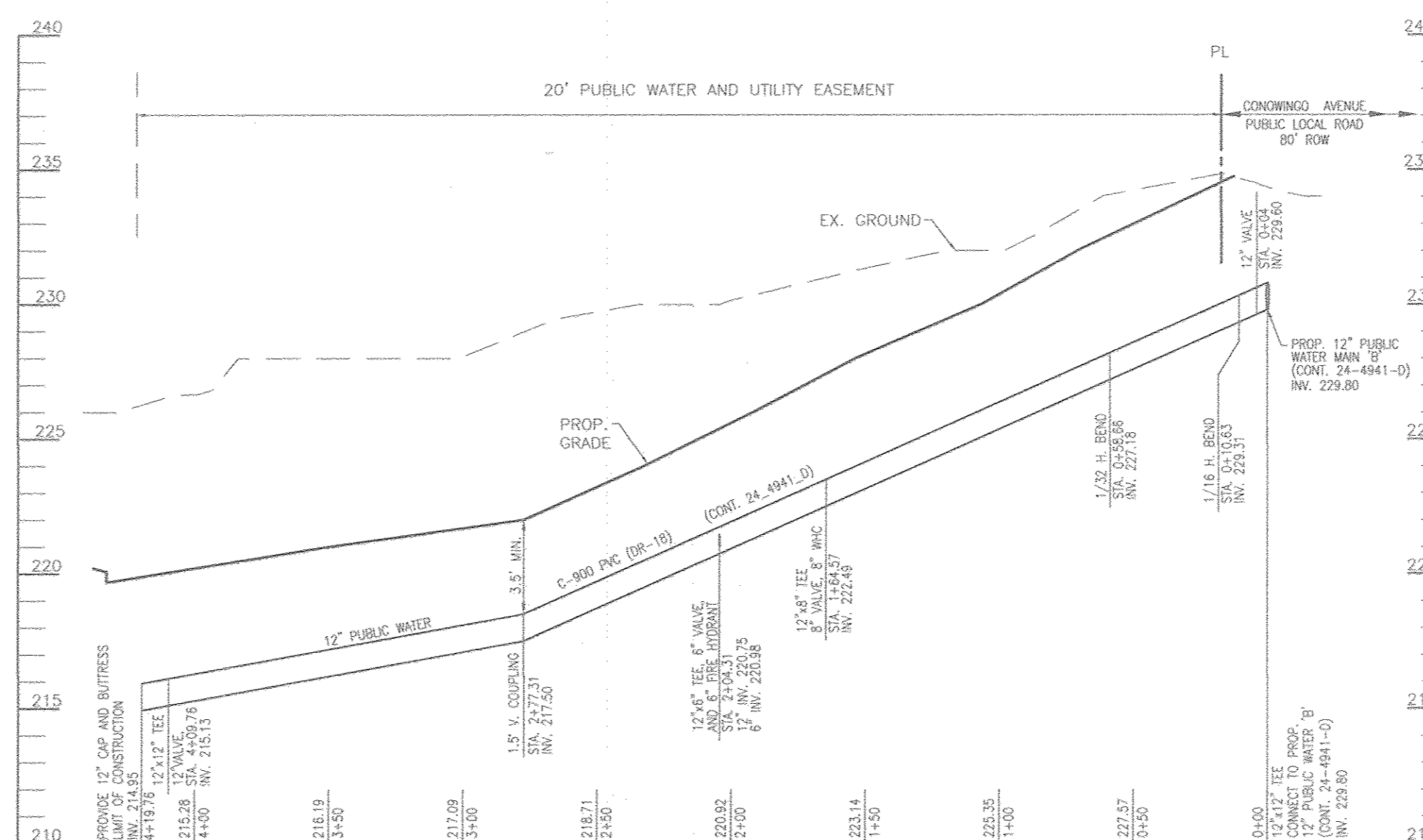

PUBLIC WATER PROFILE (WATER MAIN 'D')
SCALE: HORIZONTAL - 1"=50'
VERTICAL - 1"=5'

AS-BUILT

By *[Signature]* Date 2/9/17

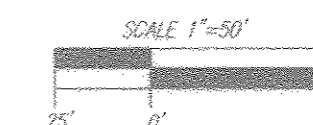

OWNER/DEVELOPER
MCA ASSATEAGUE HOLDING LLC
9601 ROBERT FULTON DR
SUITE 200
COLUMBIA, MD 21046
410-290-1400

DEPARTMENT OF PUBLIC WORKS
HOWARD COUNTY, MARYLAND

DEPARTMENT OF PLANNING & ZONING
HOWARD COUNTY, MARYLAND

ROBERT H. VOGEL ENGINEERING, INC.
ENGINEERS • SURVEYORS • PLANNERS
8407 MAIN STREET TEL: 410.461.7666
ELLCOTT CITY, MD 21043 FAX: 410.461.8991

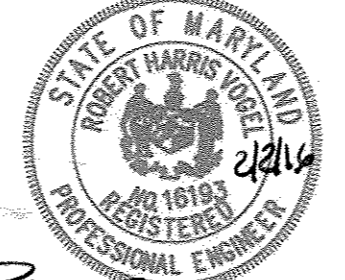

PROFESSIONAL CERTIFICATE
I HEREBY CERTIFY THAT THESE DOCUMENTS WERE PREPARED OR APPROVED BY ME AND THAT I AM A DULY LICENSED PROFESSIONAL ENGINEER UNDER THE LAWS OF THE STATE OF MARYLAND LICENSE NO. 16193 EXPIRES DATE 08-27-2016

DRN	CHK	DES	REV	DATE
KG	RHV	RHV	2	08-17-16
RHV	RHV	RHV	1	01-19-16

FINAL WATER AND SEWER CONSTRUCTION PLAN CONTRACT 24-4941-D

MARYLAND FOOD CENTER AUTHORITY - P/O PARCEL 'J'
PROPOSED WAREHOUSE
7540 ASSATEAGUE DRIVE
ZONED: M-2
L16203/F.246 - PLAT 19144

SCALE AS SHOWN
SHEET 3 OF 3

TAX MAP 43 GRID 15
6TH ELECTION DISTRICT
PARCEL 2, PARCEL 'J'
HOWARD COUNTY, MARYLAND