

QUANTITIES				
ITEM	ESTIMATED	AS-BUILT		
		QUANTITIES	TYPE	SUPPLIER
4" S PVC	5 FEET			
6" S PVC	155 FEET			
8" S PVC	265 FEET			
DOG HOUSE M.H.	1 EACH			
M.H.	3 EACH			
EX. M.H. LIFT	1 EACH			
CLEANOUT	2 EACH			
6" W C900 PVC, DR-18	550 FEET			
8" W C900 PVC, DR-18	365 FEET			
8" x 6" TEE	2 EACH			
8" x 6" REDUCER	1 EACH			
6" VALVE	4 EACH			
1/8" H.B.	6 EACH			
1/32" V.B.	4 EACH			
FIRE HYDRANT	2 EACH			

NAME OF UTILITY CONTRACTOR:
SURVEY & DRAFTING DIVISION AS-BUILT DATE:

BENCHMARK INFORMATION

B.M.#1 - HOWARD COUNTY CONTROL STATION #48DH - HORIZONTAL - (NAD '83)
(LOCATED ALONG CORRIDOR RD, APPROX. 205' SOUTHEAST OF LARKIN RD AND CORRIDOR RD INTERSECTION. APPROX. 23' OFF EDGE OF PAVEMENT)
N 533615.392
E 1368378.368
ELEVATION = 220.090 - VERTICAL - (NAD '88)

B.M.#2 - HOWARD COUNTY CONTROL STATION #48DG - HORIZONTAL - (NAD '83)
(LOCATED BETWEEN CORRIDOR RD AND MD ROUTE 32, APPROX. 295' SOUTHEAST OF BOLLMAN RD AND CORRIDOR RD INTERSECTION. APPROX. 80' OFF EDGE OF PAVEMENT)
N 535073.399
E 1366524.368
ELEVATION = 206.674 - VERTICAL - (NAD '88)

LEGEND

WATER MAIN	
SANITARY SEWER OR STORM DRAIN	
SANITARY SEWER OR STORM DRAIN MANHOLE	
SANITARY SEWER TERMINAL MANHOLE	
SANITARY SEWER HOUSE CONNECTION	
STORM DRAIN JUNCTION CHAMBER	
WATER HOUSE SERVICE & METER BOX	
WATER VALVE, TEE, & CROSS	
WATER REDUCER, Y-BRANCH, & BEND	
WATER BLOW-OFF, AIR RELEASE, & FIRE HYDRANT	

DEVELOPER'S CERTIFICATE

"I/WE CERTIFY THAT ALL DEVELOPMENT AND CONSTRUCTION WILL BE DONE ACCORDING TO THIS PLAN FOR SEDIMENT AND EROSION CONTROL, AND THAT ALL RESPONSIBLE PERSONNEL INVOLVED IN THE CONSTRUCTION PROJECT WILL HAVE A CERTIFICATE OF ATTENDANCE AT A DEPARTMENT OF THE ENVIRONMENT APPROVED TRAINING PROGRAM FOR THE CONTROL OF SEDIMENT AND EROSION BEFORE BEGINNING THE PROJECT. I ALSO AUTHORIZE PERIODIC ON-SITE INSPECTION BY THE HOWARD SOIL CONSERVATION DISTRICT OR THEIR AUTHORIZED AGENTS, AS DEEMED NECESSARY"

SIGNATURE OF DEVELOPER _____ DATE _____

ENGINEER'S CERTIFICATE

"I CERTIFY THAT THIS PLAN FOR SEDIMENT AND EROSION CONTROL REPRESENTS A PRACTICAL AND WORKABLE PLAN BASED ON MY KNOWLEDGE OF THE SITE CONDITIONS AND THAT IT WAS PREPARED IN ACCORDANCE WITH THE REQUIREMENTS OF THE HOWARD SOIL CONSERVATION DISTRICT"

SIGNATURE OF ENGINEER _____ DATE _____

SEDIMENT CONTROL MEASURES FOR THIS CONTRACT WILL BE IMPLEMENTED IN ACCORDANCE WITH SECTION 308 OF THE HOWARD COUNTY DESIGN MANUAL - VOLUME IV: STANDARD SPECIFICATIONS AND DETAILS FOR CONSTRUCTION AND AS SHOWN ON THE SITE DEVELOPMENT PLAN SDP-13-039.

SIGNATURE OF DEVELOPER _____ DATE _____

THIS DEVELOPMENT PLAN IS APPROVED FOR SOIL EROSION AND SEDIMENT CONTROL BY THE HOWARD SOIL CONSERVATION DISTRICT

APPROVED:

HOWARD SOIL CONSERVATION DISTRICT

7/16/13
DATE

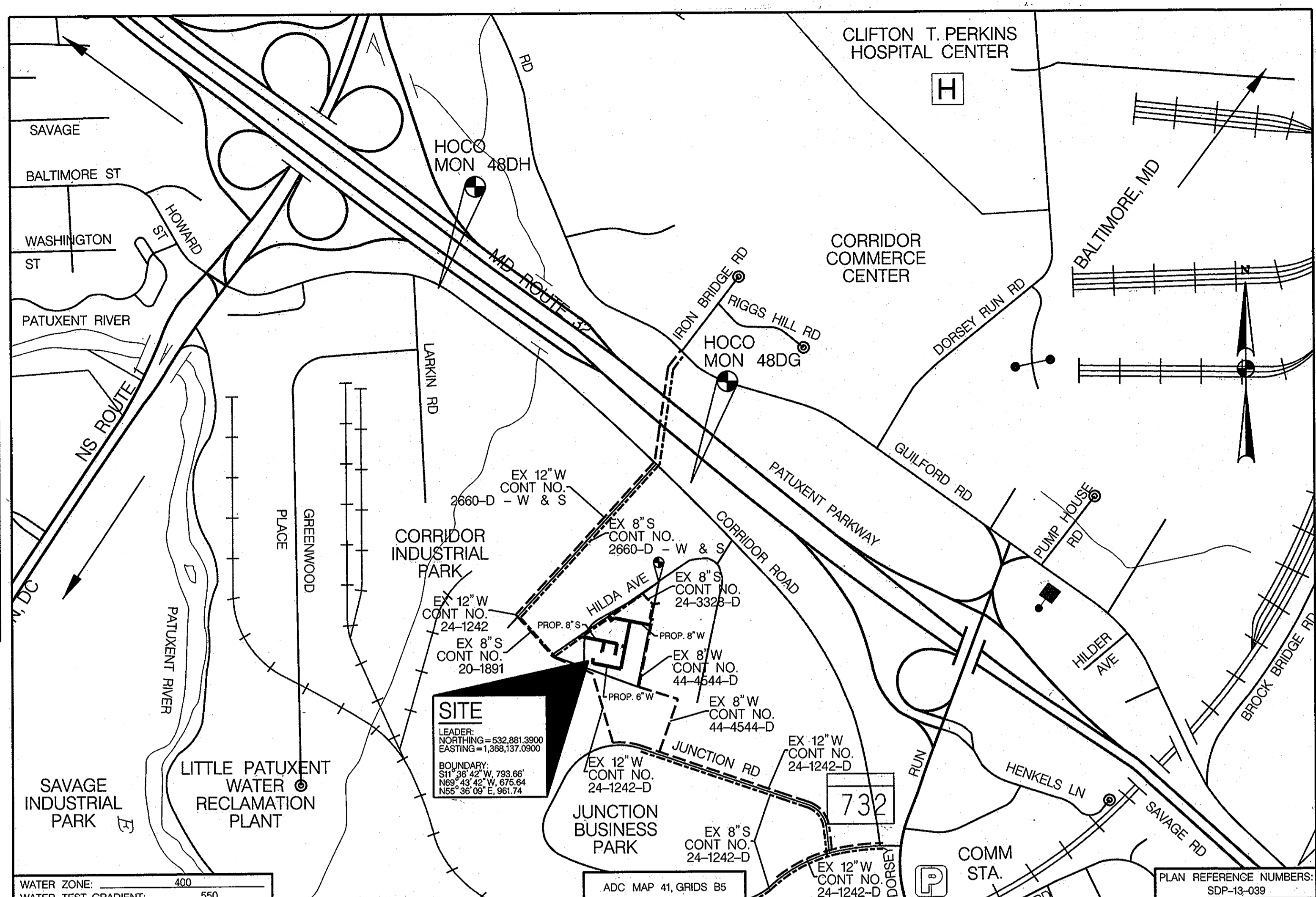

LOCATION MAP
Scale: 1" = 600'

CENTRAL MARYLAND TRANSIT & OPERATIONS FACILITY

CONTRACT NUMBER: 24-4789-D

WATER AND SEWER PLANS

HOWARD COUNTY, MARYLAND

SHEET INDEX

SHEET NO.	DESCRIPTION
1	TITLE SHEET
2	PROPOSED UTILITY COMPOSITE PLAN
3	PROPOSED WATER & SANITARY PROFILES

GENERAL NOTES:

- PART A
- APPROXIMATE LOCATION OF EXISTING MAINS ARE SHOWN. THE CONTRACTOR SHALL TAKE ALL NECESSARY PRECAUTIONS TO PROTECT THE EXISTING MAINS AND SERVICES AND MAINTAIN UNINTERRUPTED SUPPLY. ANY DAMAGE INCURRED SHALL BE REPAIRED IMMEDIATELY TO THE SATISFACTION OF THE ENGINEER AT THE CONTRACTOR'S EXPENSE.
 - TOPOGRAPHIC FIELD SURVEYS WERE PERFORMED ON FEBRUARY 2, 2012 BY WHITMAN, REQUARDT AND ASSOCIATES.
 - HORIZONTAL AND VERTICAL SURVEY CONTROLS:
THE COORDINATES SHOWN ON THE DRAWINGS ARE BASED ON MARYLAND STATE REFERENCE SYSTEM NAD '83/91 AS PROJECTED BY HOWARD COUNTY GEODETIC CONTROL STATIONS NO. 48DG & NO. 48DH. ALL VERTICAL CONTROLS ARE BASED ON NAVD '88. VERTICAL CONTROLS PROVIDED ON THE DRAWINGS.
 - ALL PIPE ELEVATIONS SHOWN ARE INVERT ELEVATIONS UNLESS OTHERWISE NOTED ON PLANS.
 - CLEAR ALL UTILITIES BY A MINIMUM OF 12 INCHES. CLEAR ALL POLES BY 5'-0" MINIMUM OR TUNNEL AS REQUIRED UNLESS OTHERWISE NOTED. THE OWNER HAS CONTACTED THE UTILITY COMPANIES AND HAS MADE ARRANGEMENTS FOR BRACING OF POLES AS SHOWN ON THE DRAWINGS. IN THE EVENT THE CONTRACTOR'S WORK REQUIRES THE BRACING OF ADDITIONAL POLES, ANY COST INCURRED BY THE CONTRACTOR FOR THE BRACING OF ADDITIONAL POLES OR DAMAGES SHALL BE DEDUCTED FROM MONIES OWED THE CONTRACTOR. THE CONTRACTOR SHALL COORDINATE WITH UTILITY COMPANIES TO SCHEDULE THE BRACING OF POLES.
 - FOR DETAILS NOT SHOWN ON THE DRAWINGS, AND FOR MATERIALS AND CONSTRUCTION METHODS, USE HOWARD COUNTY DESIGN MANUAL, VOLUME IV, STANDARD SPECIFICATIONS AND DETAILS FOR CONSTRUCTION (LATEST EDITION). THE CONTRACTOR SHALL HAVE A COPY OF VOLUME IV ON THE JOB.
 - WHERE TEST PITS HAVE BEEN MADE ON EXISTING UTILITIES, THEY ARE NOTED BY THE SYMBOL AT THE LOCATION OF THE TEST PIT. A NOTE OR NOTES CONTAINING THE RESULTS OF THE TEST PIT OR PITS IS INCLUDED ON THE DRAWINGS. EXISTING UTILITIES IN THE VICINITY OF THE PROPOSED WORK FOR WHICH TEST PITS HAVE NOT BEEN DUG SHALL BE LOCATED BY THE CONTRACTOR TWO WEEKS IN ADVANCE OF CONSTRUCTION OPERATIONS AT HIS OWN EXPENSE.
 - THE CONTRACTOR SHALL NOTIFY THE FOLLOWING UTILITIES OR AGENCIES AT LEAST FIVE WORKING DAYS BEFORE STARTING WORK SHOWN ON THESE PLANS:

AT&T	1-800-252-1133
BGE (CONTRACTOR SERVICES)	410-637-8713
BGE (EMERGENCY)	410-685-0123
BUREAU OF UTILITIES	410-313-4900
COLONIAL PIPELINE CO	410-795-1390
MISS UTILITY	1-800-257-7777
STATE HIGHWAY ADMINISTRATION	410-531-5533
VERIZON	1-800-743-0033 / 410-224-9210
 - TREES AND SHRUBS IDENTIFIED FOR RETENTION IN LANDSCAPING PLAN ARE TO BE PROTECTED FROM DAMAGE TO MAXIMUM EXTENT. TREES AND SHRUBS LOCATED WITHIN THE CONSTRUCTION AREA ARE NOT TO BE REMOVED OR DAMAGED BY THE CONTRACTOR.
 - THE CONTRACTOR SHALL REMOVE TREES, STUMPS AND ROOTS ALONG LINE OF EXCAVATION. PAYMENT FOR SUCH REMOVAL SHALL BE INCLUDED IN THE UNIT PRICE BID FOR CONSTRUCTION OF THE MAIN.
 - THE CONTRACTOR SHALL NOTIFY THE HOWARD COUNTY BUREAU OF HIGHWAYS, AT (410) 313-7450 AT LEAST FIVE WORKING DAYS BEFORE OPEN CUTTING OR BORING/JACKING OF ANY COUNTY ROAD FOR LAYING WATERSSEWER MAINS OR HOUSE CONNECTIONS. THE APPROVAL OF THESE DRAWINGS WILL CONSTITUTE COMPLIANCE WITH DPW REQUIREMENTS PER SECTION 18.11(a) OF THE HOWARD COUNTY CODE.
- PART B: WATER MAIN GENERAL NOTES
- ALL WATER MAINS SHALL BE C900 PVC, DR-18 UNLESS OTHERWISE NOTED.
 - TOPS OF ALL WATER MAINS TO HAVE A MINIMUM OF 3'-6" COVER UNLESS OTHERWISE NOTED.
 - VALVES ADJACENT TO TEES SHALL BE STRAPPED TO TEES.
 - ALL FITTINGS SHALL BE BUTTRESSED OR ANCHORED WITH CONCRETE IN ACCORDANCE WITH THE STANDARD DETAILS UNLESS OTHERWISE PROVIDED FOR ON THE DRAWINGS.
 - FIRE HYDRANTS SHALL BE SET TO THE BURY LINE ELEVATIONS SHOWN ON THE DRAWINGS. ALL FIRE HYDRANTS SHALL BE INSTALLED IN ACCORDANCE WITH STANDARD DETAILS. THE SOIL AROUND THE FIRE HYDRANT SHALL BE COMPACTED IN ACCORDANCE WITH SECTION 1000 AND SECTION 1005 OF THE STANDARD SPECIFICATIONS.
 - THE CONTRACTOR SHALL NOT OPERATE ANY WATER MAIN VALVES ON THE EXISTING WATER SYSTEM.
 - TRACER WIRE AND CONTINUITY TEST STATIONS SHALL BE INSTALLED ON ALL D.I.P. AND PVC WATER MAINS IN ACCORDANCE WITH HOWARD COUNTY DESIGN MANUAL.
 - FOR PVC WATER MAINS, ALL RECORDS FOR QUALITY CONTROL AND QUALIFICATION TEST REQUIREMENTS NOTED IN SECTION 5.1 OF THE AWWA STANDARD C900 FOR PVC PRESSURE PIPE SHALL BE SUBMITTED WITH THE PIPE MATERIAL CERTIFICATIONS OR SHOP DRAWINGS PRIOR TO APPROVAL OF THE MATERIAL FOR USE. THE TEST RECORDS SHALL BE FOR THE PIPE INSTALLED UNDER THIS CONTRACT. ALL PVC PIPE SHALL CONTAIN MARKINGS TO ALLOW CROSS REFERENCING OF THE PIPE SUPPLIED TO THE TEST RECORDS RECEIVED.
 - UNLESS OTHERWISE NOTED ON THE PLANS OR IN THE SPECIFICATIONS, SEVENTEEN (17) POUND SACRIFICIAL ANODES SHALL BE INSTALLED ON ALL VALVES AND METALLIC FITTINGS USED WITH PVC WATER MAINS IN ACCORDANCE WITH VOLUME IV, STANDARD SPECIFICATIONS AND DETAILS FOR CONSTRUCTION. MAGNESIUM ANODES SHALL BE INSTALLED ON ALL VALVES AND DUCTILE IRON FITTINGS INCLUDING RESTRAINTS AND HARNESSES. ZINC ANODES SHALL BE INSTALLED ON ALL STAINLESS STEEL FITTINGS AND SADDLES USED WITH PVC MAINS. ALL "TEES" USED WITH PVC MAINS SHALL BE DUCTILE IRON.
- PART C: SEWER MAIN GENERAL NOTES
- ALL SEWER MAINS SHALL BE D.I.P. OR P.V.C. UNLESS OTHERWISE NOTED.
 - ALL MANHOLES SHALL BE 4'-0" INSIDE DIAMETER UNLESS OTHERWISE NOTED.
 - FORCE MAINS SHALL BE D.I.P. ONLY.
 - MANHOLES SHOWN WITH 12" AND 16" WALLS ARE FOR BRICK MANHOLES ONLY.
 - MANHOLES DESIGNATED W.T. IN PLAN AND PROFILE SHALL HAVE WATERTIGHT FRAME AND COVER. STANDARD DETAIL G5.52 WHERE WATERTIGHT MANHOLE FRAMES AND COVERS ARE USED. SET TOP OF FRAME 1'-6" ABOVE FINISHED GRADE UNLESS OTHERWISE NOTED ON THE DRAWINGS.
 - HOUSE(S) WITH THE SYMBOL "C.N.S." INDICATES THAT CELLAR CANNOT BE SERVED.

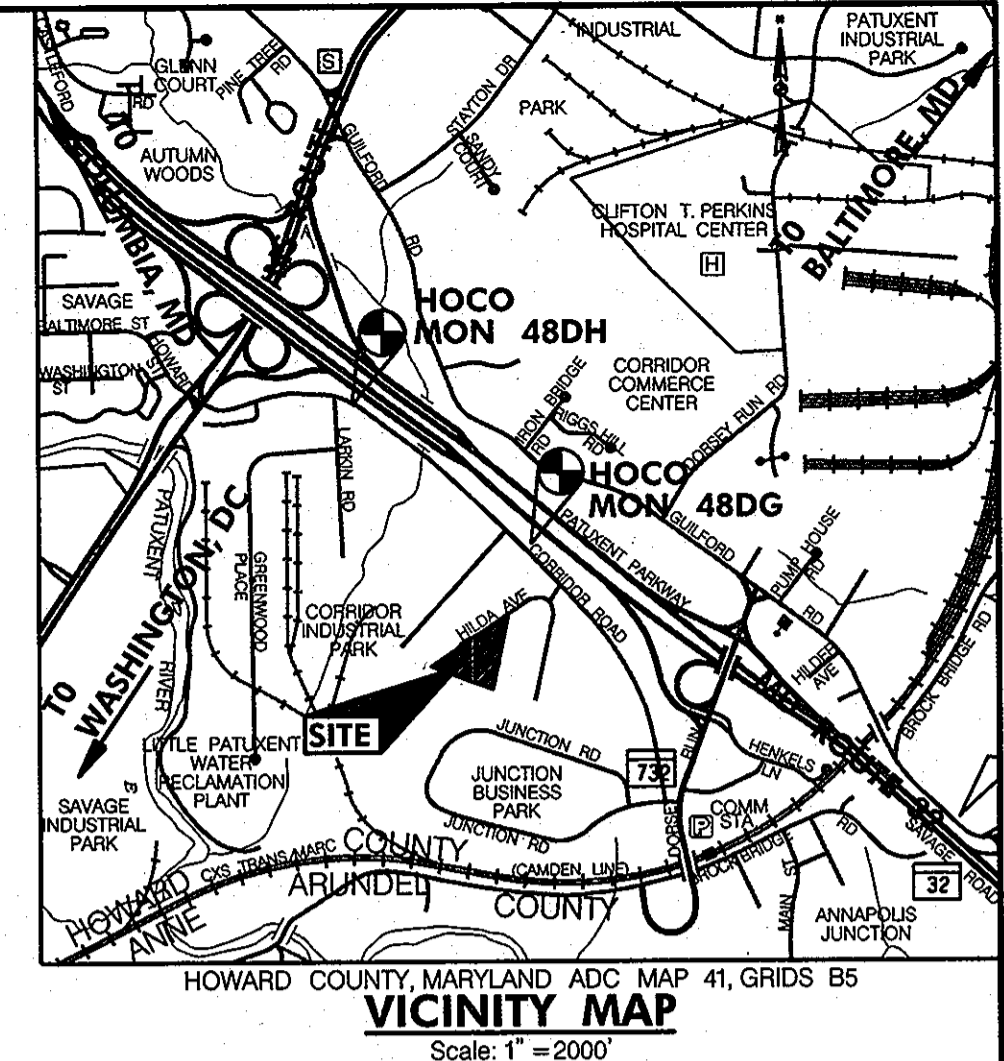

DEPARTMENT OF PUBLIC WORKS
HOWARD COUNTY, MARYLAND

DIRECTOR OF PUBLIC WORKS

CHIEF, BUREAU OF ENGINEERING

CHIEF, DEVELOPMENT ENGINEERING DIVISION

7/30/13
DATE

7/29/13
DATE

8/5/13
DATE

RK&K
CONSULTING ENGINEERS
81 MOSHER STREET
BALTIMORE, MARYLAND 21217
(800)-787-3755



PROFESSIONAL CERTIFICATION

I hereby certify that these documents were prepared or approved by me, and that I am a duly licensed professional engineer under the laws of the State of Maryland

24851 License No. 03/15/2014 Expiration Date

NO.	DESCRIPTION	BY	DATE
DESIGN	JRN		
DRAWN	JRN		
CHECK	MBH		
APPR			

REVISIONS

TITLE SHEET

SCALE: AS SHOWN

BLOCK NO. 13

**CENTRAL MARYLAND
TRANSIT OPERATIONS FACILITY**
CONTRACT NUMBER: 24-4789-D
(LOT 1 OF THE LATE J. DUINKER SUBDIVISION)

TAX MAP 48
CAPITAL PROJECT NO: C-0289
6TH ELECTION DISTRICT

GRID 13
PARCEL 75
HOWARD COUNTY, MD

DISCIPLINE ABBREVIATION GN-01

SHEET NO. 1 OF 3

HOWARD COUNTY
CO DEPT OF PUBLIC WORKS
TAX MAP 48
PARCEL 165
LIBER 1765 @ FOLIO 206

BOLLMAN PLACE LLC
TAX MAP 48
PARCEL 16
LOT C
PLAT 5070
LIBER 10095 @ FOLIO 620

SCOTT BUILDING LLC
CO CHESAPEAKE RESOURCES INC
TAX MAP 48
PARCEL 16
LOT D-1
PLAT 5988
LIBER 11359 @ FOLIO 293

CABOT III-MD1WII LLC
TAX MAP 48
PARCEL 16
LOT D-2
PLAT 5988
LIBER 14034 @ FOLIO 463

DCT BOLLMAN MD LLC
TAX MAP 48
PARCEL 16
LOT E-1
PLAT 5988
LIBER 10095 @ FOLIO 168

TAX MAP 48
PARCEL 165
LIBER 1765 @ FOLIO 206

INSTALL 1" RISER
TO EX. MANHOLE
STRUCTURE

GROUND ELECTRICAL
TRANSFORMER

OVERHEAD UTILITIES TO
BE RELOCATED/REMOVED
BEYOND THIS POINT
BY OTHERS

EXISTING POLE
TO REMAIN

COMMERCIAL ACCESS

9040 JUNCTION DRIVE, LLC.
CO PHILIP MERCER
TAX MAP 48
PARCEL 177
LOT E2
PLAT 11256
LIBER 7205 @ FOLIO 597

30' WATER, STORMDRAIN & UTILITY EASEMENT
CONTRACT NO. 24-1242

PACE INCORPORATED
TAX MAP 48
PARCEL 177
LOT E4
PLAT 11256

EX. 8" 1/8" H.B.
EX. 8" 1/8" H.B.

20' STORMDRAIN & UTILITY EASEMENT
CONTRACT NO. 44-1872-D

CORRIDOR ROAD LLC
SUBDIVISION OF PROPERTY OF THE "LATE J. DUINKER"
MAP TAX 48
PARCEL 73
LOT 3
LIBER 7720 @ FOLIO 180

ROLLINS LEASING CORP
CO PENSKE TRUCK LEASING
SUBDIVISION OF PROPERTY OF THE "LATE J. DUINKER"
MAP TAX 48
PARCEL 104
LOT 2
LIBER 2907 @ FOLIO 316

WATER MAIN TABULATION CHART			
W.M. STA.	APPURTENANCE	NORTHING	EASTING
0+00.00	8" x 6" F.H. TEE	532,573.2429	1,367,924.9535
0+08.00	6" VALVE	532,574.4506	1,367,919.0763
1+39.56	FIRE HYDRANT	532,601.3399	1,367,788.2476

WATER MAIN TABULATION CHART			
W.M. STA.	APPURTENANCE	NORTHING	EASTING
0+00.00	FIRE HYDRANT	532,405.8562	1,367,865.7749
0+18.25	6" VALVE	532,402.1782	1,367,883.6694
0+24.25	8" x 6" F.H. TEE	532,400.9704	1,367,889.5466

WATER MAIN TABULATION CHART			
W.M. STA.	APPURTENANCE	NORTHING	EASTING
0+00.00	8" x 8" CROSS	532,565.8811	1,368,082.0638
0+07.00	8" VALVE	532,566.3043	1,368,078.4674
0+23.50	8" 1/32 V.B.	532,568.5043	1,368,067.7431
0+30.07	8" 1/32 V.B.	532,570.7027	1,368,057.0467
1+41.27	8" 1/8 H.B.	532,594.0076	1,367,943.6586
1+61.27	8" 1/8 H.B.	532,583.0016	1,367,926.9592
1+71.24	8" x 6" F.H. TEE	532,573.2429	1,367,924.9535
1+81.58	8" 1/32 V.B.	532,562.1497	1,367,922.6732
1+89.13	8" 1/32 V.B.	532,555.7142	1,367,921.3507
3+47.11	8" x 6" F.H. TEE	532,400.9704	1,367,889.5466
3+58.86	8"-6" REDUCER	532,389.4609	1,367,887.1814
3+67.11	6" VALVE	532,381.3803	1,367,885.5206
5+07.22	6" 1/8 H.B.	532,244.1348	1,367,857.3124
5+17.22	6" 1/8 H.B.	532,238.6320	1,367,848.9628
7+08.89	6" 1/8 H.B.	532,277.2369	1,367,661.1051
7+31.67	6" 1/8 H.B.	532,296.4210	1,367,648.9677
7+46.22	6" VALVE	532,310.6689	1,367,651.8957
7+51.22	BUILDING CONNECTION	532,315.5666	1,367,652.9021

MANHOLE TABULATION CHART			
NO.	NORTHING	EASTING	RIM ELEV.
EX. MH 1	532,333.0252	1,367,368.7758	219.56'
MH 2	532,475.7743	1,367,572.3138	232.81'
CO 1	532,473.5396	1,367,582.3173	232.81'
MH 3	532,442.5109	1,367,733.6049	233.36'
MH 4	532,422.7701	1,367,829.5437	233.50'
CO 2	532,366.9538	1,367,718.0778	234.00'

NOTE:
1. CONTACT INITIATED WITH BALTIMORE GAS AND ELECTRIC (BGE) ON REVISIONS
ELECTRICAL SERVICE AND PROVIDING NATURAL GAS SERVICE TO PROPERTY.
2. WATER METER TO BE LOCATED INSIDE ADMINISTRATION BUILDING.

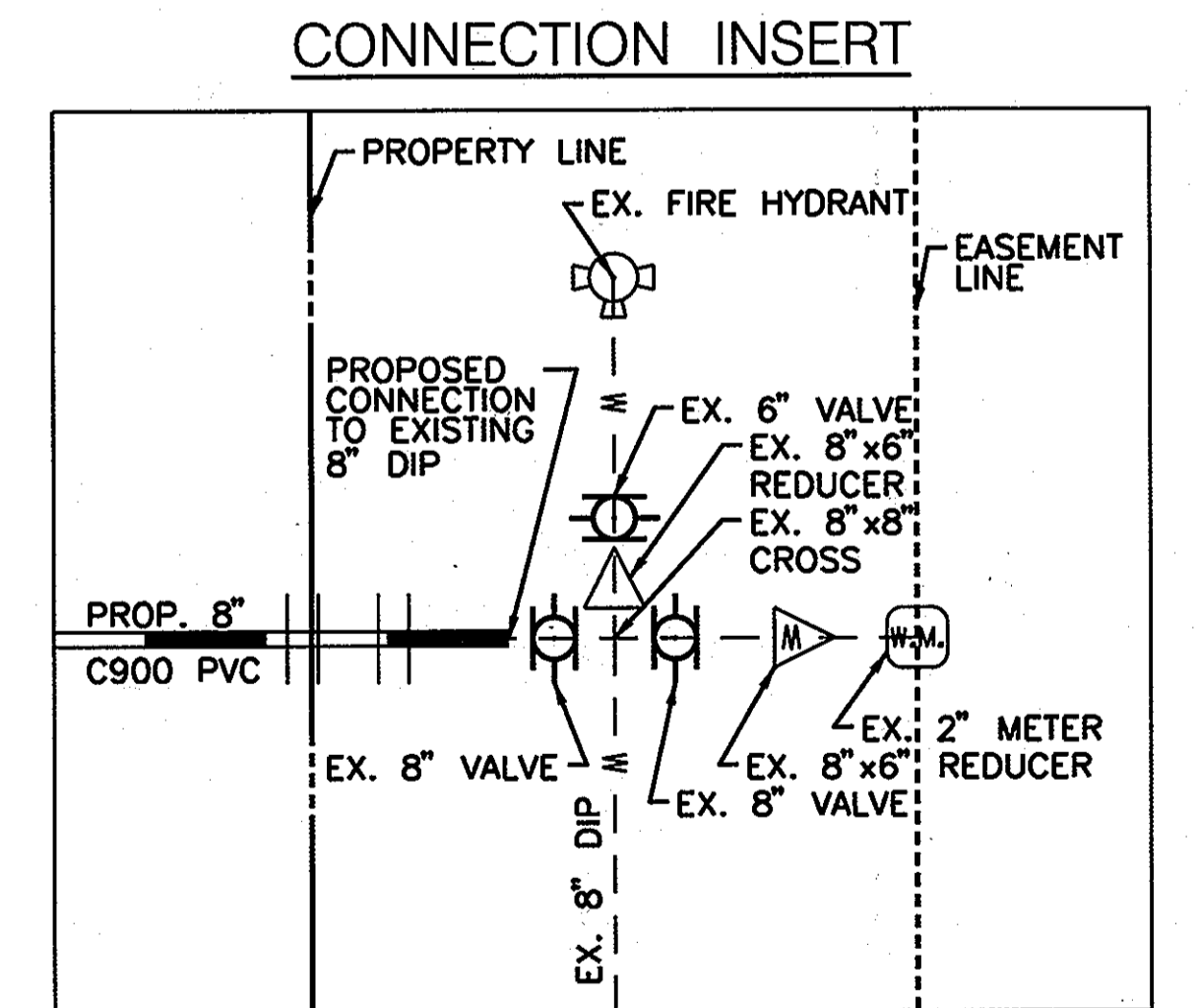

OWNER/DEVELOPER

Howard County
% Mr. Brandon Love, Project Manager
Department of Public Works, Special Projects
9250 Bendix Road
Columbia, Maryland 21045
410-313-5398

50' 0 50' 100'
SCALE: 1" = 50'

DEPARTMENT OF PUBLIC WORKS
HOWARD COUNTY, MARYLAND

[Signature] 7/30/13
DIRECTOR OF PUBLIC WORKS DATE
[Signature] 7/29/13
CHIEF, BUREAU OF ENGINEERING DATE
[Signature] 8/5/13
CHIEF, BUREAU OF UTILITIES DATE
[Signature] M.C.
CHIEF, DEVELOPMENT ENGINEERING DIVISION DATE

RK&K
CONSULTING ENGINEERS
81 MOSHER STREET
BALTIMORE, MARYLAND 21217
(800)-787-3755



PROFESSIONAL CERTIFICATION
I hereby certify that these documents were prepared or approved by me, and that I am a duly licensed professional engineer under the laws of the State of Maryland
24851 03/15/2014
License No. Expiration Date

NO.	DESCRIPTION	BY	DATE
1	REVISED SERVICE CONNECTIONS	MBA	10/10/2013

PROPOSED UTILITY COMPOSITE PLAN
SCALE: 1" = 50'
BLOCK NO. 13

CENTRAL MARYLAND TRANSIT OPERATIONS FACILITY
CONTRACT NUMBER: 24-4789-D
(LOT 1 OF THE LATE J. DUINKER SUBDIVISION)
TAX MAP 48
CAPITAL PROJECT NO: C-0289
6TH ELECTION DISTRICT
GRID 13
PARCEL 75
HOWARD COUNTY, MD

DISCIPLINE ABBREVIATION UT-01
SHEET NO. 2 OF 3

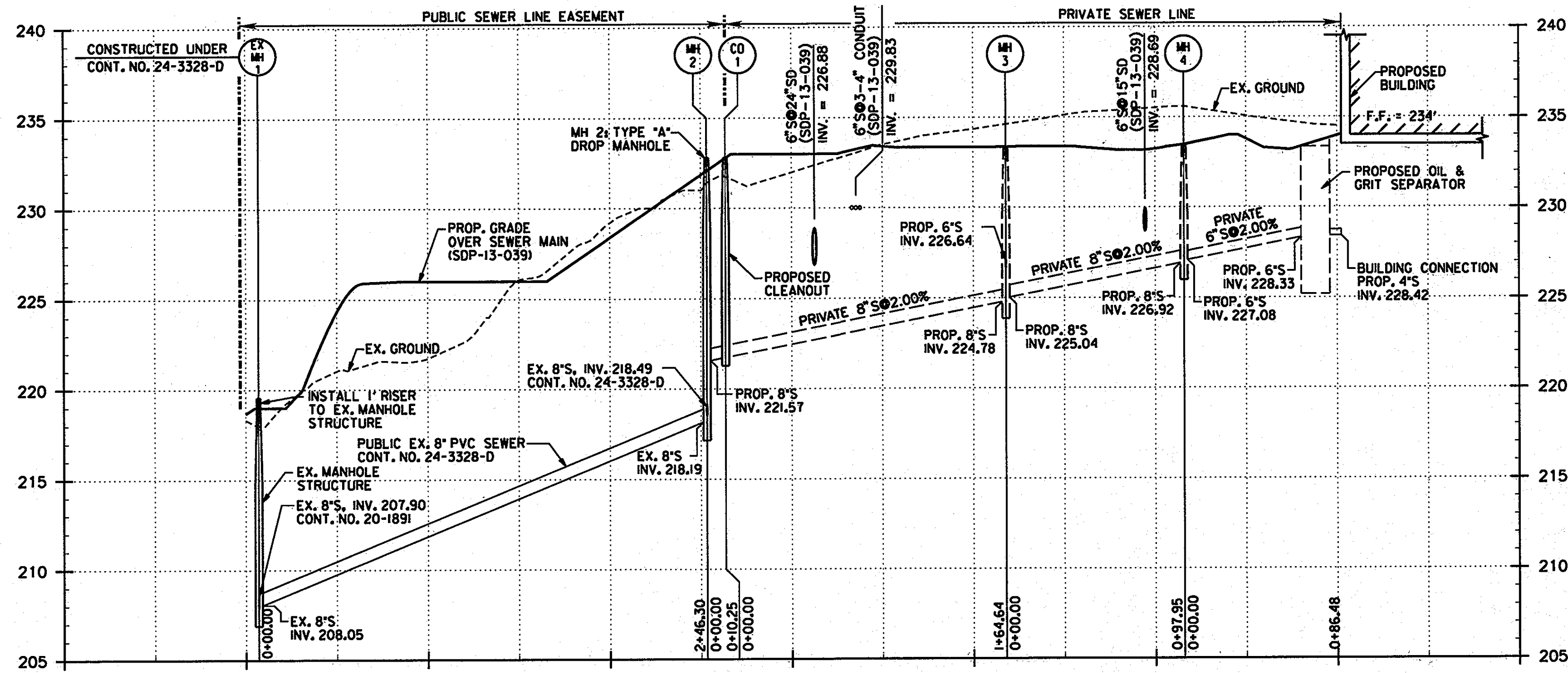

WASH FACILITY CONNECTION
6" SANITARY LINE

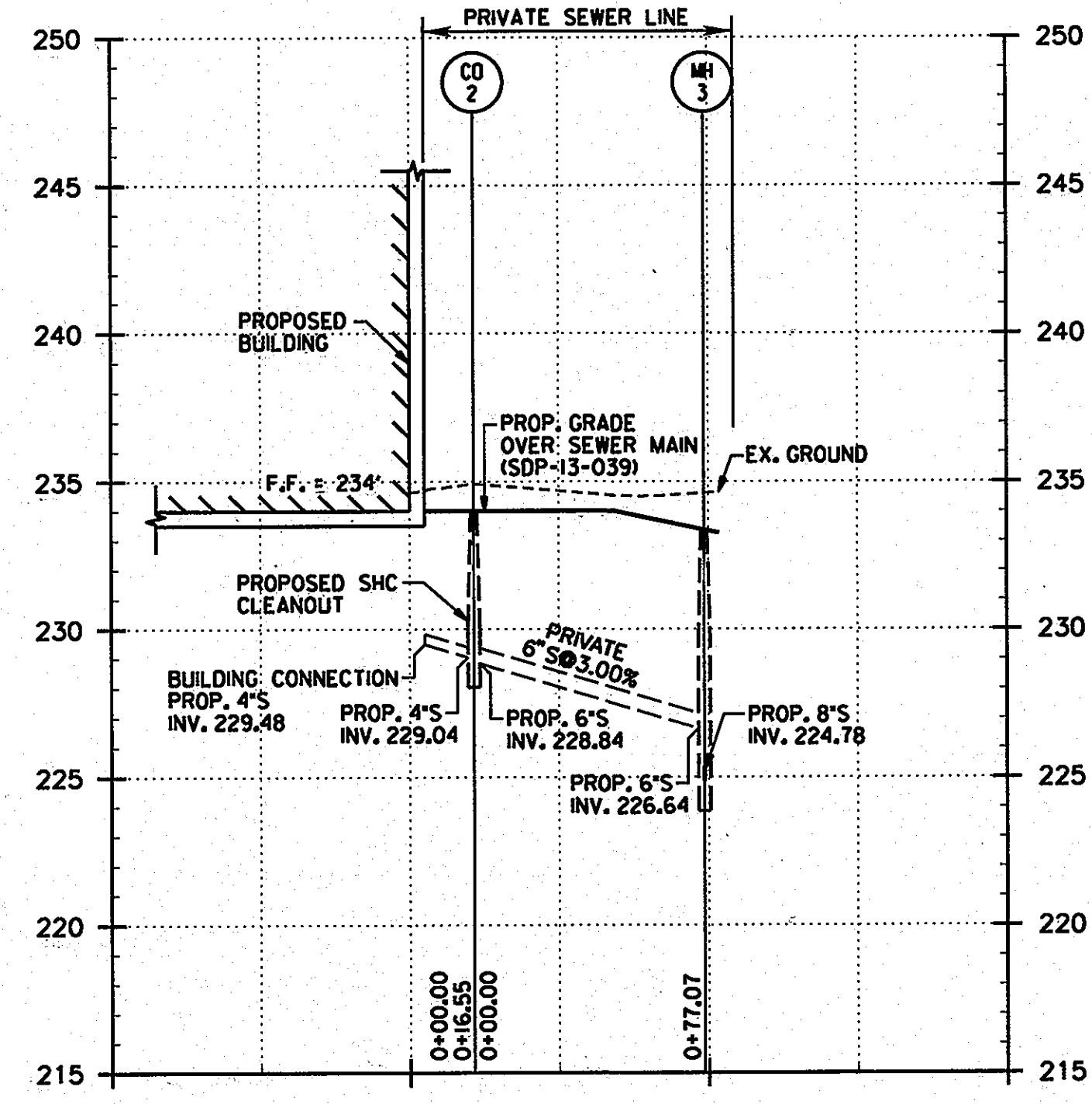

ADMINISTRATION BUILDING CONNECTION
6" SANITARY LINE

MANHOLE TABULATION CHART			
NO.	NORTHING	EASTING	RIM ELEV.
EX. MH 1	532,333.0252	1,367,368.7758	219.56'
MH 2	532,475.7743	1,367,572.3138	232.81'
CO 1	532,473.5396	1,367,582.3173	232.81'
MH 3	532,442.5109	1,367,733.6049	233.36'
MH 4	532,422.7701	1,367,829.5437	233.50'
CO 2	532,366.9538	1,367,718.0778	234.00'

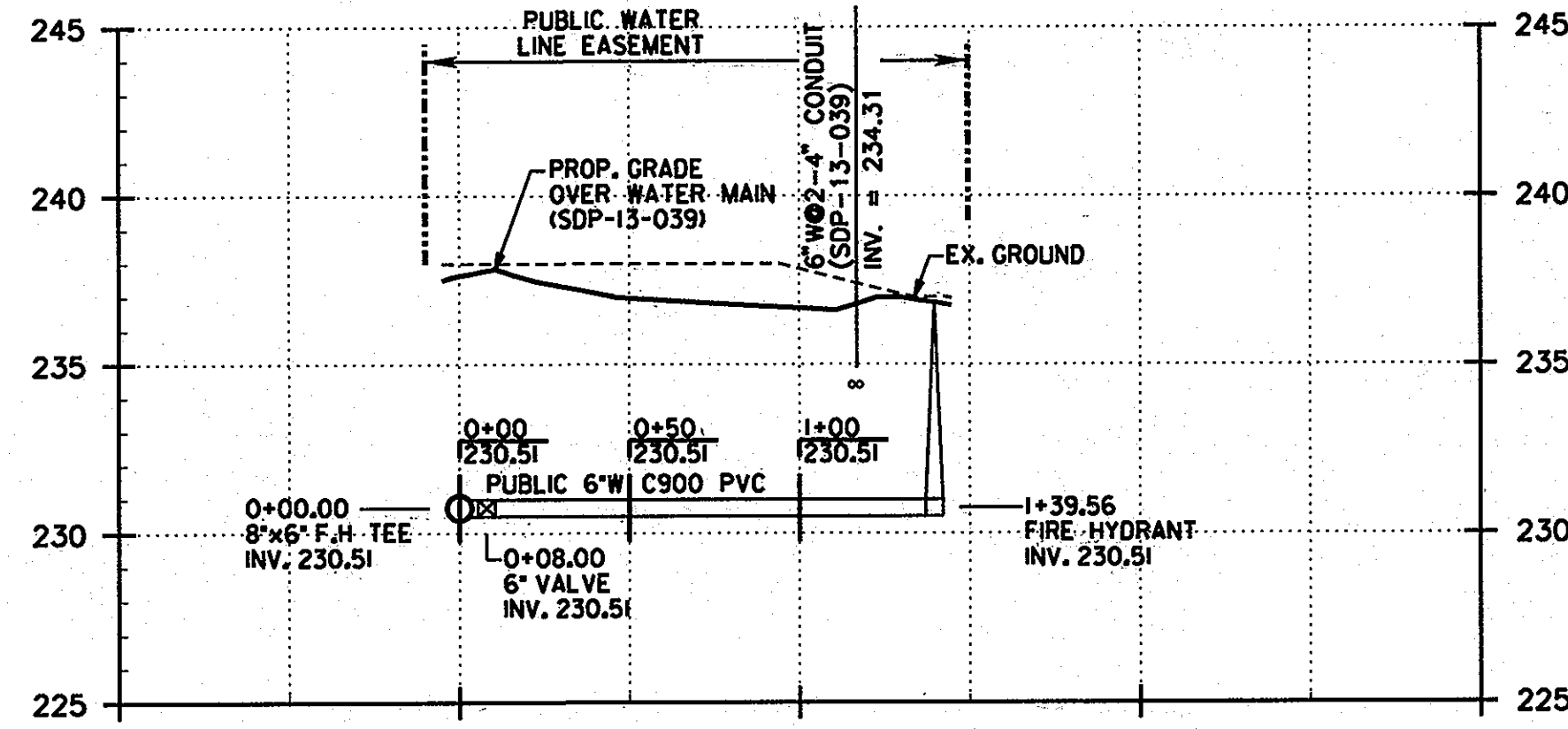

FUELING AREA FIRE HYDRANT
6" WATER LINE

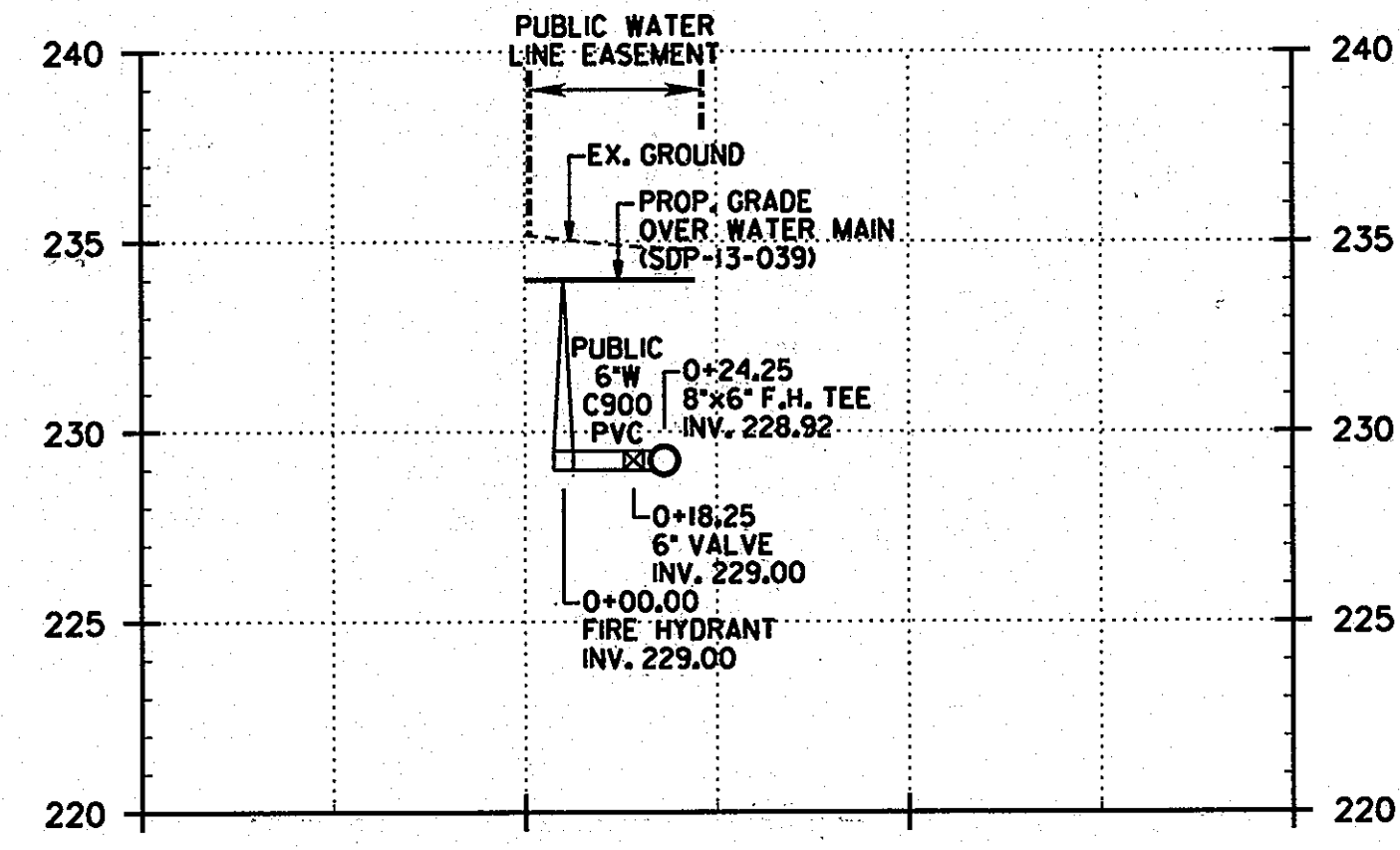

MAINTENANCE BAYS FIRE HYDRANT
6" WATER LINE

WATER MAIN TABULATION CHART			
W.M. STA.	APPURTENANCE	NORTHING	EASTING
0+00.00	8" x 6" F.H. TEE	532,573.2429	1,367,924.9535
0+08.00	6" VALVE	532,574.4506	1,367,919.0763
1+39.56	FIRE HYDRANT	532,601.3399	1,367,788.2476

WATER MAIN TABULATION CHART			
W.M. STA.	APPURTENANCE	NORTHING	EASTING
0+00.00	FIRE HYDRANT	532,405.8562	1,367,865.7749
0+18.25	6" VALVE	532,402.1782	1,367,883.6694
0+24.25	8" x 6" F.H. TEE	532,400.9704	1,367,889.5466

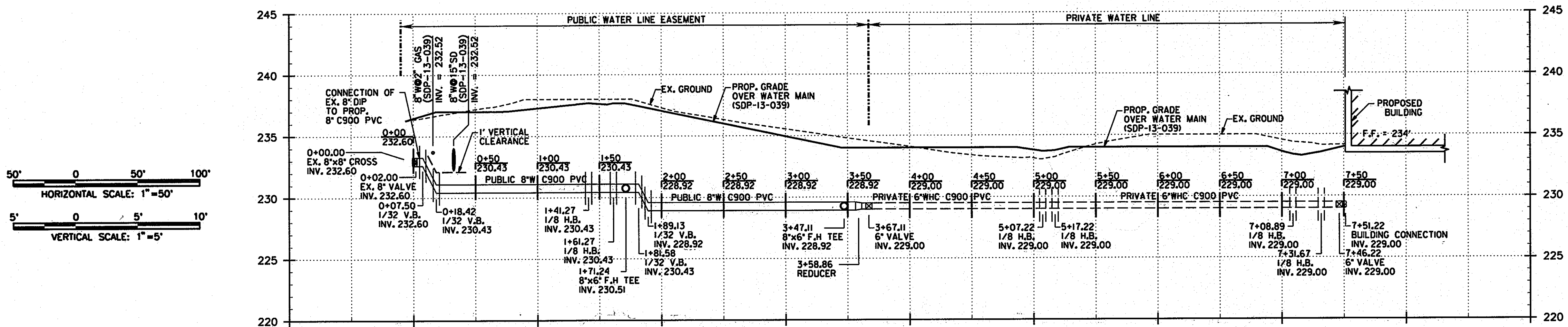

CONNECTION TO BUILDING
8" TO 6" WATER LINE

WATER MAIN TABULATION CHART			
W.M. STA.	APPURTENANCE	NORTHING	EASTING
0+00.00	8" x 8" CROSS	532,565.6811	1,368,082.0638
0+07.00	8" VALVE	532,566.3043	1,368,078.4674
0+23.50	8" 1/32 V.B.	532,568.5043	1,368,067.7431
0+30.07	8" 1/32 V.B.	532,570.7027	1,368,057.0467
1+41.27	8" 1/8 H.B.	532,594.0076	1,367,943.6586
1+61.27	8" 1/8 H.B.	532,583.0016	1,367,926.9592
1+71.24	8" x 6" F.H. TEE	532,573.2429	1,367,924.9535
1+81.58	8" 1/32 V.B.	532,562.1497	1,367,922.6732
1+89.13	8" 1/32 V.B.	532,555.7142	1,367,921.3507
3+47.11	8" x 6" F.H. TEE	532,400.9704	1,367,889.5466
3+58.86	8"-6" REDUCER	532,389.4609	1,367,887.1814
3+67.11	6" VALVE	532,381.3803	1,367,885.5206
5+07.22	6" 1/8 H.B.	532,244.1348	1,367,857.3124
5+17.22	6" 1/8 H.B.	532,238.6320	1,367,848.9628
7+08.89	6" 1/8 H.B.	532,277.2369	1,367,861.1051
7+31.67	6" 1/8 H.B.	532,296.4210	1,367,848.9677
7+46.22	6" VALVE	532,310.6689	1,367,651.8957
7+51.22	BUILDING CONNECTION	532,315.5666	1,367,652.9021

OWNER/DEVELOPER

Howard County
% Mr. Brandon Love, Project Manager
Department of Public Works, Special Projects
9250 Bendix Road
Columbia, Maryland 21045
410-313-5398

DEPARTMENT OF PUBLIC WORKS
HOWARD COUNTY, MARYLAND

[Signature] 7/20/13
DIRECTOR OF PUBLIC WORKS DATE
[Signature] 7/29/13
CHIEF, BUREAU OF ENGINEERING DATE
[Signature] 8/1/13
CHIEF, BUREAU OF UTILITIES DATE
[Signature] M6
CHIEF, DEVELOPMENT ENGINEERING DIVISION DATE

RK&K
CONSULTING ENGINEERS
81 MOSHER STREET
BALTIMORE, MARYLAND 21217
(800)-787-3755



PROFESSIONAL CERTIFICATION
I hereby certify that these documents were prepared or approved by me, and that I am a duly licensed professional engineer under the laws of the State of Maryland.
24851 03/15/2014
License No. Expiration Date

NO.	DESCRIPTION	BY	DATE
		JRN	
		JRN	
		MBH	

PROPOSED WATER &
SANITARY PROFILES

SCALE: AS SHOWN
BLOCK NO. 13

**CENTRAL MARYLAND
TRANSIT OPERATIONS FACILITY**
CONTRACT NUMBER: 24-4789-D
(LOT 1 OF THE LATE J. DUINKER SUBDIVISION)

TAX MAP 48
CAPITAL PROJECT NO: C-0289
6TH ELECTION DISTRICT
GRID 13
PARCEL 75
HOWARD COUNTY, MD

DISCIPLINE
ABBREVIATION
UT-02
SHEET NO.
3 OF 3