

QUANTITIES			
ITEM	ESTIMATED	AS-BUILT QUANTITIES	MANUFACTURER / SUPPLIER
3" PLUG	33 L.F.	33 L.F.	DR-35 PVC, N. AMERICAN PIPE CORP.
8" PLUG	1 EACH	1 EA	C-153 TYLER/UNTON
8" W.C. 900	1,530 L.F.	1,530	DR-12 PVC, N. AMERICAN PIPE
8" W.C. 900	31 L.F.	31	DR-12 PVC, N. AMERICAN PIPE
8" X 8" TEE	4 EACH	4 EA	C-153 TYLER/UNTON
8" X 8" TEE	2 EACH	2 EA	C-153 TYLER/UNTON
1/8" H.B.	5 EACH	5 EA	C-153 TYLER/UNTON
1/16" H.B.	8 EACH	8 EA	C-153 TYLER/UNTON
1/32" H.B.	6 EACH	6 EA	C-153 TYLER/UNTON
4" H.B.	3 EACH	3 EA	
8" VALVE	0 EACH	0 EA	2500-1 AMERICAN FLOW CONTROL
6" VALVE	2 EACH	2 EA	2500-1 "
FIRE HYDRANT	2 EACH	2 EA	D-61-D-S AMERICAN DARLING
CONTINUITY TEST STATION	2 EACH	2 EA	

BENCHMARK INFORMATION

B.M.#1 - HOWARD COUNTY CONTROL STATION #3710 - HORIZONTAL - NAD '83
 (LOCATED ALONG U.S. ROUTE 1, APPROX. 375' NORTH OF TROY HILL INDUSTRIAL PARK, BRASS DISC
 LOCATED APPROX. 2.5' OFF EDGE OF PAVING)
 N 556,907.4177
 E 1,384,460.9875
 ELEVATION = 157.314 - VERTICAL - (NAVD '88)

B.M.#2 - HOWARD COUNTY CONTROL STATION #3806 - HORIZONTAL - NAD '83
 (LOCATED ALONG U.S. ROUTE 1, DIRECTLY ACROSS FROM ATLANTIC SUPPLY CO., APPROX. 6.6' FROM
 QUADRANT)
 N 557,155.4454
 E 1,384,992.2276
 ELEVATION = 174.506 - VERTICAL - (NAVD '88)

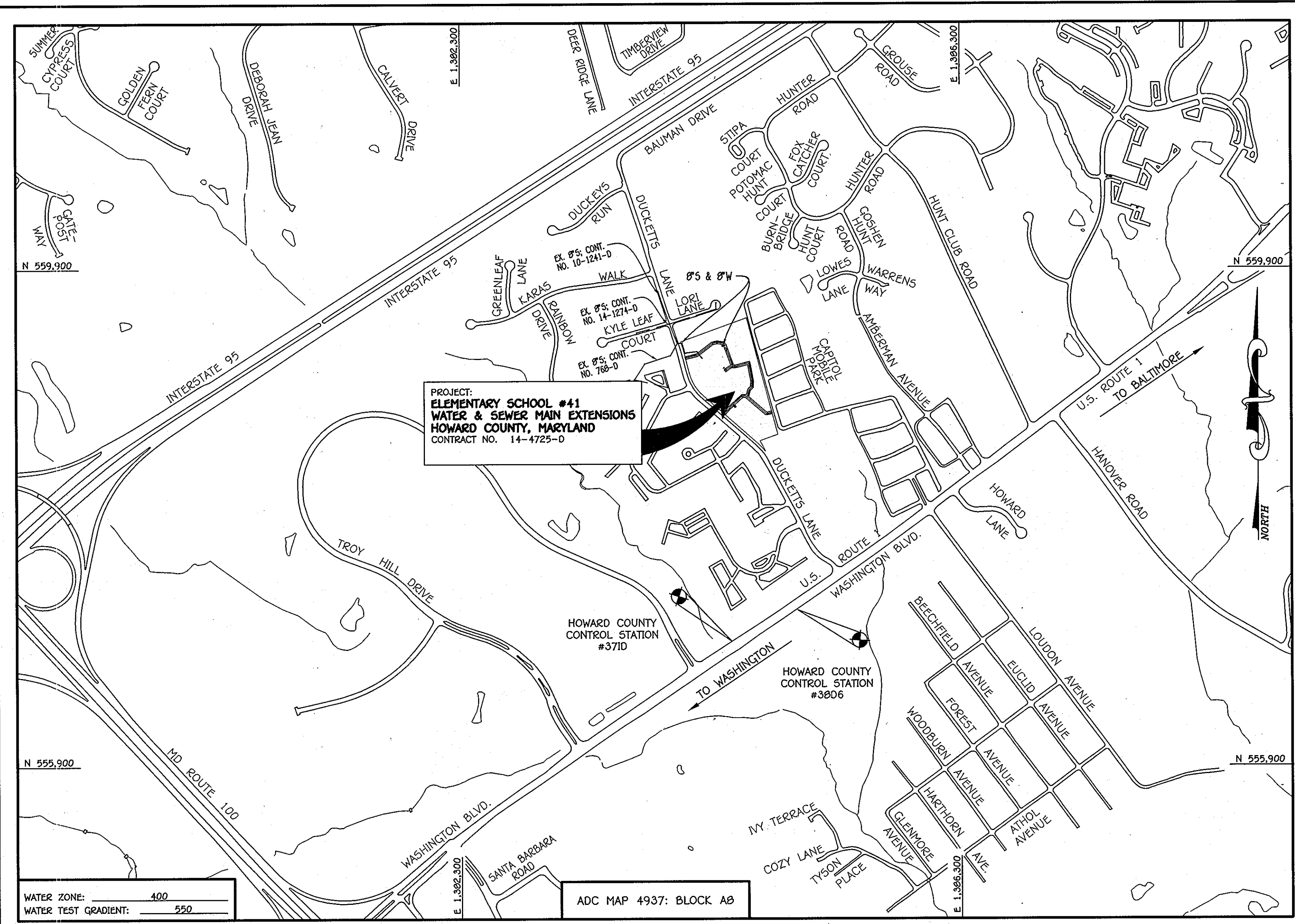

TYPE OF BUILDING:	ELEMENTARY SCHOOL
NUMBER OF PARCELS:	1
NO. OF WATER HOUSE CONNECTIONS:	1
NO. OF SEWER HOUSE CONNECTIONS:	1
SEWER SHED:	PATAPSCO
TREATMENT PLANT:	PATAPSCO WASTEWATER TREATMENT PLANT CITY OF BALTIMORE

LOCATION MAP
SCALE: 1" = 600'

PLAN REFERENCE NUMBERS:
 SDP-12-042 F-12-XXX
 (RECORD PLAT)

CONTRACT NO. 14-4725-D

ELEMENTARY SCHOOL #41

WATER & SEWER MAIN EXTENSIONS

HOWARD COUNTY, MARYLAND

DEVELOPER'S CERTIFICATION

I/WE HEREBY CERTIFY THAT ALL DEVELOPMENT AND CONSTRUCTION WILL BE DONE ACCORDING TO THIS PLAN OF DEVELOPMENT AND PLAN FOR EROSION AND SEDIMENT CONTROL, AND THAT ALL RESPONSIBLE PERSONNEL INVOLVED IN THE CONSTRUCTION PROJECT WILL HAVE A CERTIFICATE OF ATTENDANCE AT THE DEPARTMENT OF THE ENVIRONMENT APPROVED TRAINING PROGRAM FOR THE CONTROL OF SEDIMENT AND EROSION BEFORE BEGINNING THE PROJECT. I ALSO AUTHORIZE PERIODIC ON-SITE INSPECTION BY THE HOWARD SOIL CONSERVATION DISTRICT OR THEIR AUTHORIZED AGENTS, AS ARE DEEMED NECESSARY.

Paul W. Keibel, FOR:
 HOWARD COUNTY PUBLIC SCHOOL SYSTEM 02-09-12
 SIGNATURE OF DEVELOPER DATE

ENGINEER'S CERTIFICATION

I HEREBY CERTIFY THAT THIS PLAN FOR EROSION AND SEDIMENT CONTROL REPRESENTS A PRACTICAL AND WORKABLE PLAN BASED ON MY PERSONAL KNOWLEDGE OF THE SITE CONDITIONS AND THAT IT WAS PREPARED IN ACCORDANCE WITH THE REQUIREMENTS OF THE HOWARD SOIL CONSERVATION DISTRICT.

Paul W. Keibel 02/09/12
 SIGNATURE OF ENGINEER DATE

SEDIMENT CONTROL MEASURES FOR THIS CONTRACT WILL BE IMPLEMENTED IN ACCORDANCE WITH SECTION 309 OF THE HOWARD COUNTY DESIGN MANUAL - VOLUME IV STANDARD SPECIFICATIONS AND DETAILS FOR CONSTRUCTION AND AS SHOWN ON THE SITE DEVELOPMENT PLAN.

Paul W. Keibel, FOR:
 HOWARD COUNTY PUBLIC SCHOOL SYSTEM 02-09-12
 SIGNATURE OF DEVELOPER DATE

GP-12-41

THIS DEVELOPMENT IS APPROVED FOR EROSION AND SEDIMENT CONTROL BY HOWARD SOIL CONSERVATION DISTRICT.

APPROVED:
John P. Rhoads 3/1/12
 CHIEF, BUREAU OF UTILITIES DATE

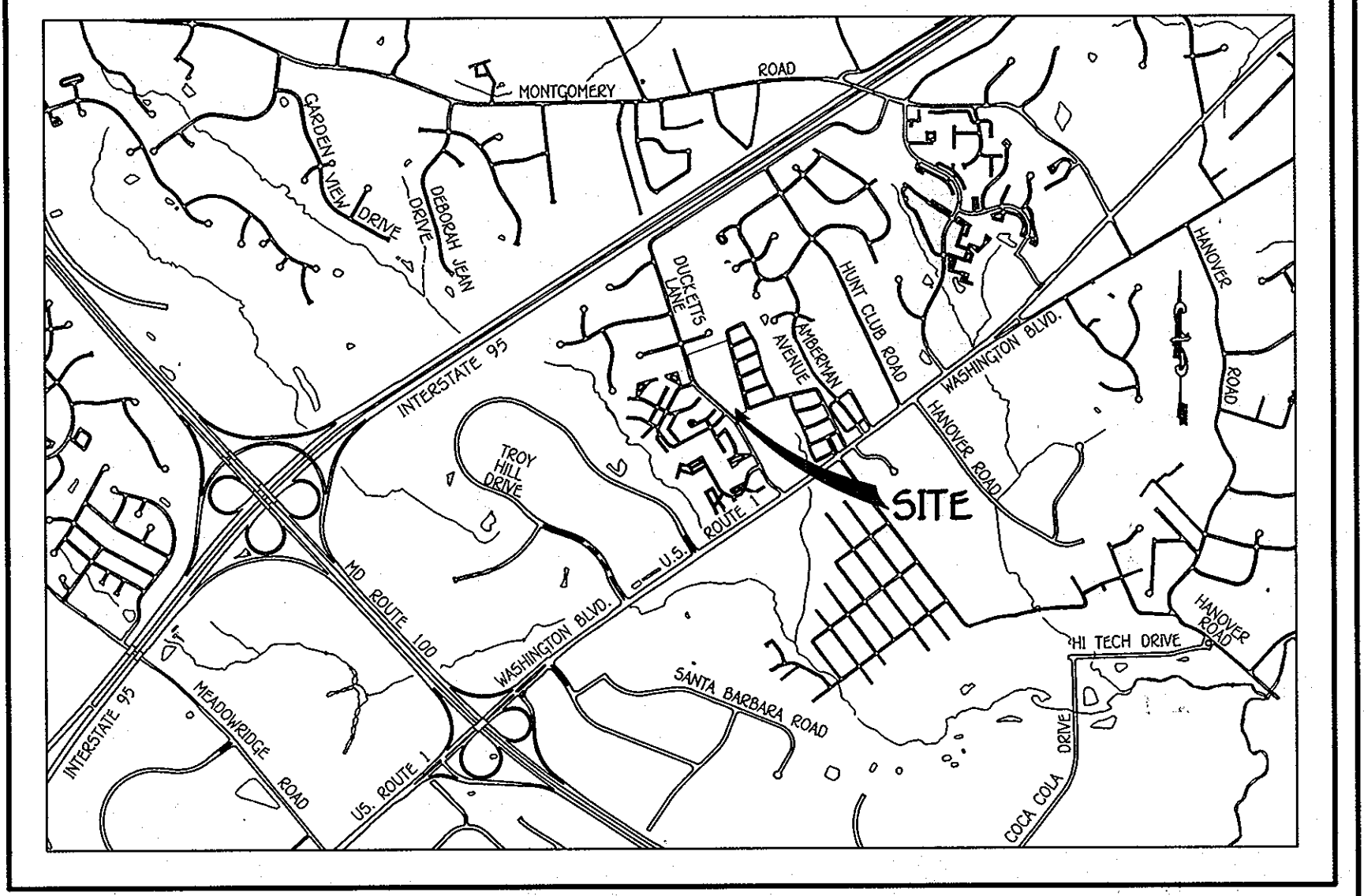

VICINITY MAP
SCALE: 1" = 2000'

- GENERAL NOTES**
- PART A
- APPROXIMATE LOCATIONS OF EXISTING MAINS ARE SHOWN. THE CONTRACTOR SHALL TAKE ALL NECESSARY PRECAUTIONS TO PROTECT EXISTING MAINS AND SERVICES AND MAINTAIN UNINTERRUPTED SERVICE. ANY DAMAGE INCURRED SHALL BE REPAIRED IMMEDIATELY TO THE SATISFACTION OF THE ENGINEER AT THE CONTRACTOR'S EXPENSE.
 - TOPOGRAPHIC FIELD SURVEYS WERE PERFORMED ON OR ABOUT JULY, 2011 BY FISHER, COLLINS & CARTER, INC.
 - HORIZONTAL AND VERTICAL SURVEY CONTROLS:
 THE COORDINATES SHOWN ON THE DRAWINGS ARE BASED ON MARYLAND STATE REFERENCE SYSTEM NAD '83/91' AS PROJECTED BY HOWARD COUNTY GEODETIC CONTROL STATIONS NO. 3710 & NO. 3806.
 - ALL VERTICAL CONTROLS ARE BASED ON NAVD '88. VERTICAL CONTROLS PROVIDED ON THE DRAWINGS.
 - ALL PIPE ELEVATIONS SHOWN ARE INVERT ELEVATIONS UNLESS OTHERWISE NOTED ON THE PLANS.
 - CLEAR ALL UTILITIES BY A MINIMUM OF 12 INCHES. CLEAR ALL POLES BY 5'-0" MINIMUM OR TUNNEL AS REQUIRED UNLESS OTHERWISE NOTED. THE OWNER HAS CONTACTED THE UTILITY COMPANIES AND HAS MADE ARRANGEMENTS FOR BRACING OF POLES AS SHOWN ON THE DRAWINGS. IN THE EVENT THE CONTRACTOR'S WORK REQUIRES BRACING OF ADDITIONAL POLES, ANY COST INCURRED BY THE OWNER FOR THE BRACING OF THE ADDITIONAL POLES OR DAMAGES SHALL BE DEDUCTED FROM MONIES OWED THE CONTRACTOR. THE CONTRACTOR SHALL COORDINATE WITH THE UTILITY COMPANIES TO SCHEDULE THE BRACING OF THE POLES.
 - FOR DETAILS NOT SHOWN ON THE DRAWINGS, AND FOR MATERIALS AND CONSTRUCTION METHODS, USE HOWARD COUNTY DESIGN MANUAL, VOLUME IV, STANDARD SPECIFICATIONS AND DETAILS FOR CONSTRUCTION (LATEST EDITION). THE CONTRACTOR SHALL HAVE A COPY OF VOLUME IV ON THE JOB SITE.
 - WHERE TEST PITS HAVE BEEN MADE ON EXISTING UTILITIES, THEY ARE NOTED BY THE SYMBOL AT THE LOCATIONS OF THE TEST PITS. A NOTE OR NOTES CONTAINING THE RESULTS OF THE TEST PIT OR PITS IS INCLUDED ON THE DRAWINGS. EXISTING UTILITIES IN THE VICINITY OF THE PROPOSED WORK FOR WHICH TEST PITS HAVE NOT BEEN DUG SHALL BE LOCATED BY THE CONTRACTOR TWO WEEKS IN ADVANCE OF CONSTRUCTION OPERATIONS AT HIS OWN EXPENSE.
 - THE CONTRACTOR SHALL NOTIFY THE FOLLOWING UTILITY COMPANIES OR AGENCIES AT LEAST FIVE WORKING DAYS BEFORE STARTING WORK SHOWN ON THESE PLANS:
 AT&T 1-800-252-1133
 BGE (CONTRACTOR SERVICES) 410-637-8713
 BGE (EMERGENCY) 410-695-0123
 BUREAU OF UTILITIES 410-313-4900
 COLONIAL PIPELINE CO 410-795-1390
 MISS UTILITY 1-800-257-7777
 STATE HIGHWAY ADMINISTRATION 410-531-5533 / 410-224-9210
 VERIZON 1-800-743-0033 / 410-224-9210
 - TREES AND SHRUBS ARE TO BE PROTECTED FROM DAMAGE TO THE MAXIMUM EXTENT. TREES AND SHRUBS LOCATED WITHIN THE CONSTRUCTION STRIP ARE NOT TO BE REMOVED OR DAMAGED BY THE CONTRACTOR.
 - CONTRACTOR SHALL REMOVE TREES, STUMPS AND ROOTS ALONG THE LINE OF EXCAVATION. PAYMENT FOR SUCH REMOVAL SHALL BE INCLUDED IN THE UNIT PRICE BID FOR THE CONSTRUCTION OF THE MAIN.
 - THE CONTRACTOR SHALL NOTIFY THE BUREAU OF HIGHWAYS, HOWARD COUNTY, AT (410)-313-7450 AT LEAST FIVE WORKING DAYS BEFORE OPEN CUTTING OR BORING/JACKING OF ANY COUNTY ROAD FOR LAYING WATER/SEWER MAINS OR HOUSE CONNECTIONS. THE APPROVAL OF THESE DRAWINGS WILL CONSTITUTE COMPLIANCE WITH DPM REQUIREMENTS PER SECTION 18.114(a) OF THE HOWARD COUNTY CODE.

- PART B: WATER MAIN GENERAL NOTES
- ALL WATER MAINS SHALL BE AWWA C900 PVC 12" DIA.
 - TOPS OF ALL WATER MAINS SHALL HAVE A MINIMUM OF 3'-6" OF COVER UNLESS OTHERWISE NOTED.
 - VALVES ADJACENT TO TEES SHALL BE STRAPPED TO TEES.
 - ALL FITTINGS SHALL BE BUTTRESSED OR ANCHORED WITH CONCRETE IN ACCORDANCE WITH STANDARD DETAILS UNLESS OTHERWISE PROVIDED FOR ON THE DRAWINGS.
 - FIRE HYDRANTS SHALL BE SET TO THE BUZY LINE ELEVATIONS SHOWN ON THE DRAWINGS. ALL FIRE HYDRANTS SHALL BE INSTALLED IN ACCORDANCE WITH STANDARD DETAILS. THE SOIL AROUND THE FIRE HYDRANT SHALL BE COMPACTED IN ACCORDANCE WITH SECTION 1000 AND SECTION 1005 OF THE STANDARD SPECIFICATIONS.
 - THE CONTRACTOR SHALL NOT OPERATE ANY WATER MAIN VALVES ON THE EXISTING WATER SYSTEM.
 - TRACER WIRE AND CONTINUITY TEST STATIONS SHALL BE INSTALLED ON ALL D.I.P. AND PVC WATER MAINS IN ACCORDANCE WITH HOWARD COUNTY DESIGN MANUAL.
 - FOR PVC WATER MAINS, ALL RECORDS FOR THE QUALITY CONTROL AND QUALIFICATION TEST REQUIREMENTS NOTED IN SECTION 5.1 OF THE AWWA STANDARD C900 FOR PVC PRESSURE PIPE SHALL BE SUBMITTED WITH THE PIPE MATERIAL CERTIFICATIONS OR SHOP DRAWINGS PRIOR TO APPROVAL OF THE MATERIAL FOR USE. THE TEST RECORDS SHALL BE FOR THE PIPE TO BE INSTALLED UNDER THIS CONTRACT. ALL PVC PIPE SHALL CONTAIN MARKINGS TO ALLOW CROSS REFERENCING OF THE PIPE SUPPLIED TO THE TEST RECORDS RECEIVED.
 - UNLESS OTHERWISE NOTED ON THE PLANS OR IN THE SPECIFICATIONS, SEVENTEEN (17) POUND SACRIFICIAL ANODES SHALL BE INSTALLED ON ALL VALVES AND METALLIC FITTINGS USED WITH PVC WATER MAINS IN ACCORDANCE WITH VOLUME IV, STANDARD SPECIFICATIONS AND DETAILS FOR CONSTRUCTION. MAGNESIUM ANODES SHALL BE INSTALLED ON ALL VALVES AND DUCTILE IRON FITTINGS INCLUDING RESTRAINTS AND HARNESSSES. ZINC ANODES SHALL BE INSTALLED ON ALL STAINLESS STEEL FITTINGS AND SADDLES USED WITH PVC MAINS. ALL "TEES" USED WITH PVC MAINS SHALL BE DUCTILE IRON.

- PART C: SEWER MAIN GENERAL NOTES
- ALL SEWER MAINS SHALL BE D.I.P. OR P.V.C. UNLESS OTHERWISE NOTED.
 - ALL MANHOLES SHALL BE 4'-0" INSIDE DIAMETER UNLESS OTHERWISE NOTED.
 - FORCE MAINS SHALL BE D.I.P. ONLY.
 - MANHOLES SHOWN WITH 12" AND 18" WALLS ARE FOR BRICK MANHOLES ONLY.
 - MANHOLES DESIGNATED W.T. IN PLAN AND PROFILE SHALL HAVE WATERTIGHT FRAME AND COVER, STANDARD DETAIL G5.52, WHERE WATERTIGHT MANHOLE FRAMES AND COVERS ARE USED, SET TOP OF FRAME 1'-6" ABOVE FINISHED GRADE UNLESS OTHERWISE NOTED ON THE DRAWINGS.
 - HOUSE(S) WITH THE SYMBOL "C.N.S." INDICATES THAT CELLAR CANNOT BE SERVED.

DEVELOPER / OWNER

HOWARD COUNTY PUBLIC SCHOOL SYSTEM
 10910 MARYLAND ROUTE 108
 ELLICOTT CITY, MD 21042
 ATTN: BRUCE GIST
 410-313-6790

CONTRACT NO. 14-4725-D
 ELEMENTARY SCHOOL #41
 WATER & SEWER MAIN EXTENSIONS
 HOWARD COUNTY, MARYLAND

DEPARTMENT OF PUBLIC WORKS
 HOWARD COUNTY, MARYLAND

John P. Rhoads 2/12/12
 CHIEF, BUREAU OF UTILITIES DATE

DEPARTMENT OF PLANNING AND ZONING
 HOWARD COUNTY, MARYLAND

Paul W. Keibel 3/12/12
 CHIEF, DEVELOPMENT ENGINEERING DIVISION DATE

I HEREBY CERTIFY THAT THESE DOCUMENTS WERE PREPARED OR APPROVED BY ME, AND THAT I AM A DULY LICENSED PROFESSIONAL ENGINEER UNDER THE LAWS OF THE STATE OF MARYLAND, LICENSE NO. 12043 EXPIRATION DATE IS 7/16/12.

FISHER, COLLINS & CARTER, INC.
 CIVIL ENGINEERING CONSULTANTS & LAND SURVEYORS

CENTRAL SQUARE OFFICE PARK - 10272 BALTIMORE NATIONAL PIKE
 ELICOTT CITY, MARYLAND 21042
 (410) 461-2000

Paul W. Keibel
 PROFESSIONAL ENGINEER
 PAUL W. KEIBEL

DESIGNED BY:
 B.C.R.

DRAWN BY:
 B.C.R.

CHECKED BY:
 P.W.K.

DATE:
 FEBRUARY, 2012

WATER & SEWER MAIN EXTENSIONS
 TITLE SHEET

600' SCALE MAP NO. 37 BLOCK NO. 12
 F.C.C. WORK ORDER NO. 11022

FILE NAME: WATER & SEWER MAIN EXTENSION TITLE SHEET

WATER & SEWER MAIN EXTENSIONS
 TITLE SHEET

600' SCALE MAP NO. 37 BLOCK NO. 12
 F.C.C. WORK ORDER NO. 11022

FILE NAME: WATER & SEWER MAIN EXTENSION TITLE SHEET

ELEMENTARY SCHOOL #41
 WATER & SEWER MAIN EXTENSIONS
 CONTRACT NO. 14-4725-D
 FIRST ELECTION DISTRICT
 HOWARD COUNTY, MARYLAND

SCALE AS SHOWN

SHEET 1 OF 3

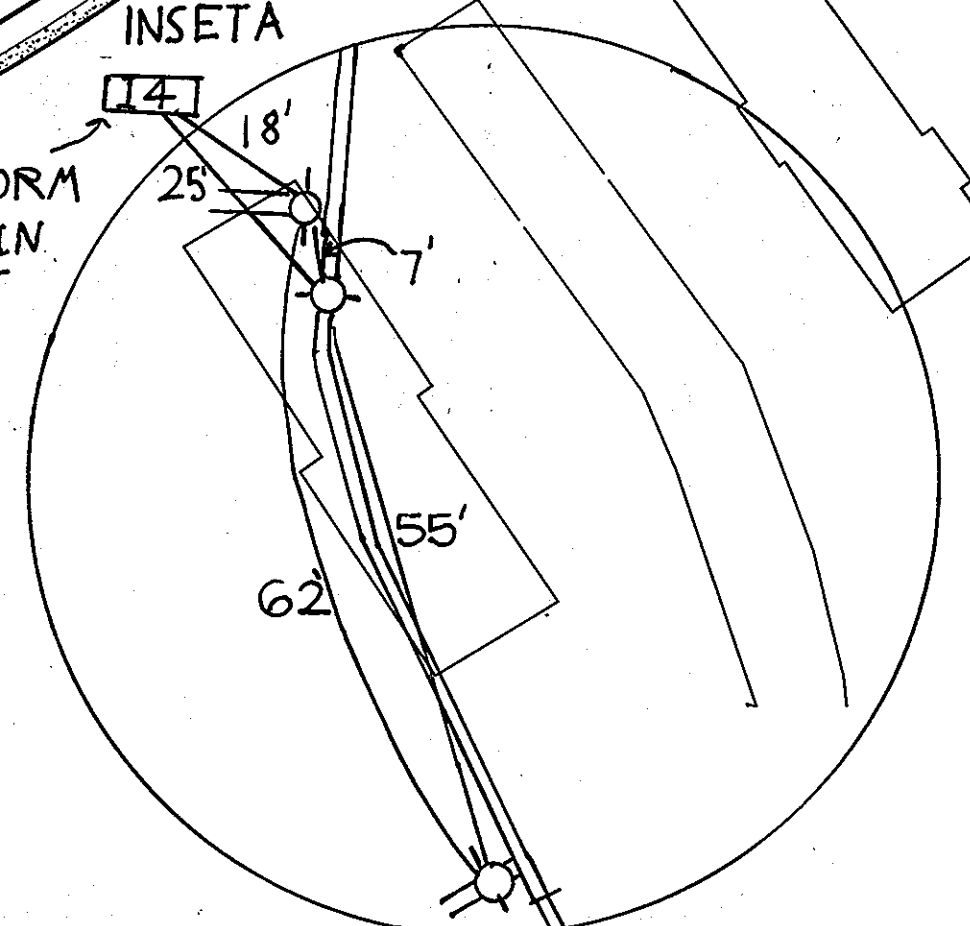
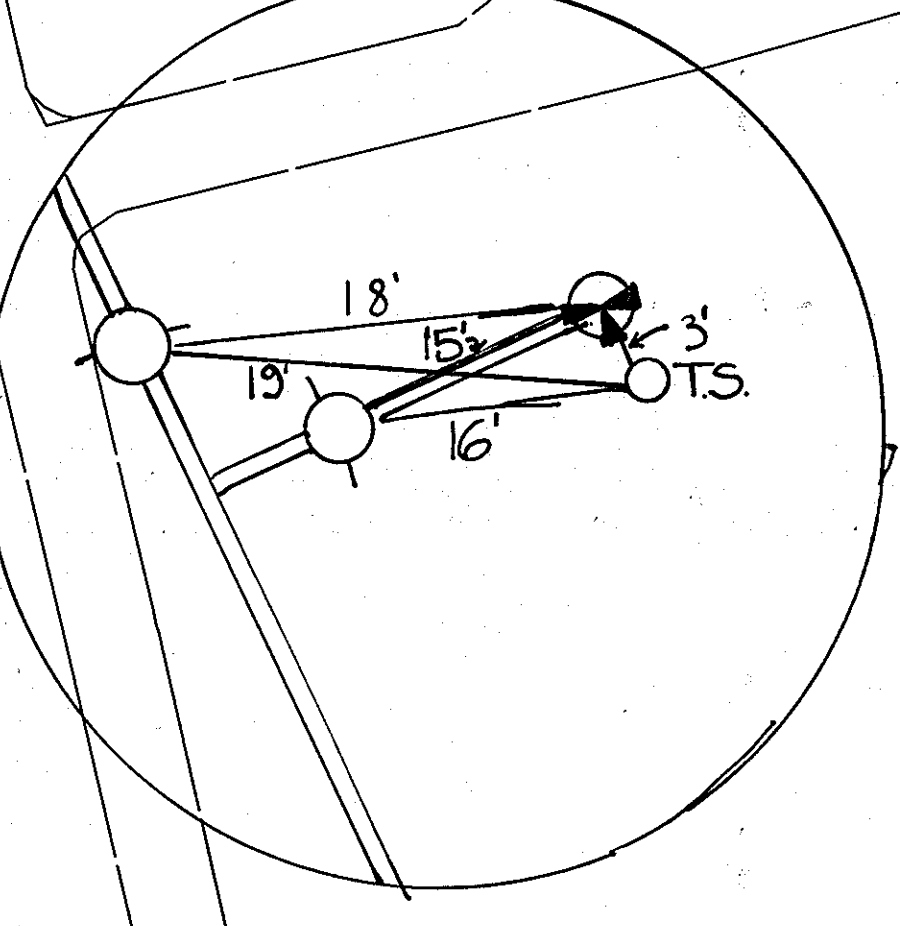
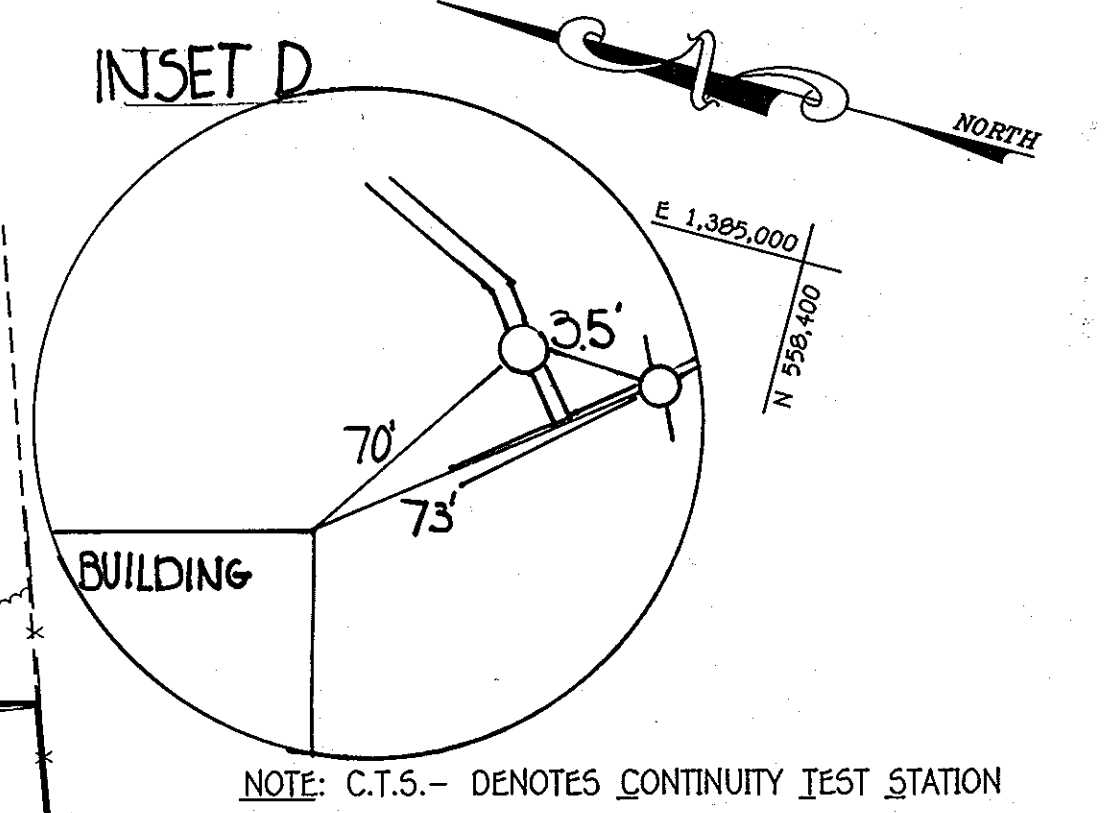
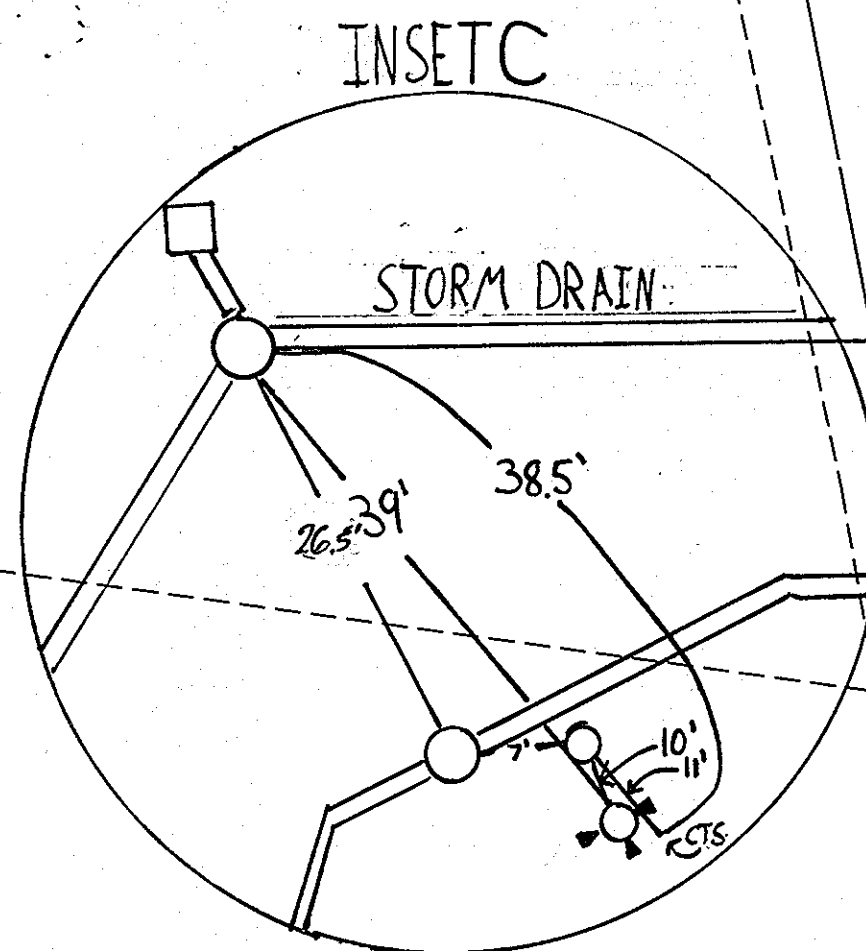
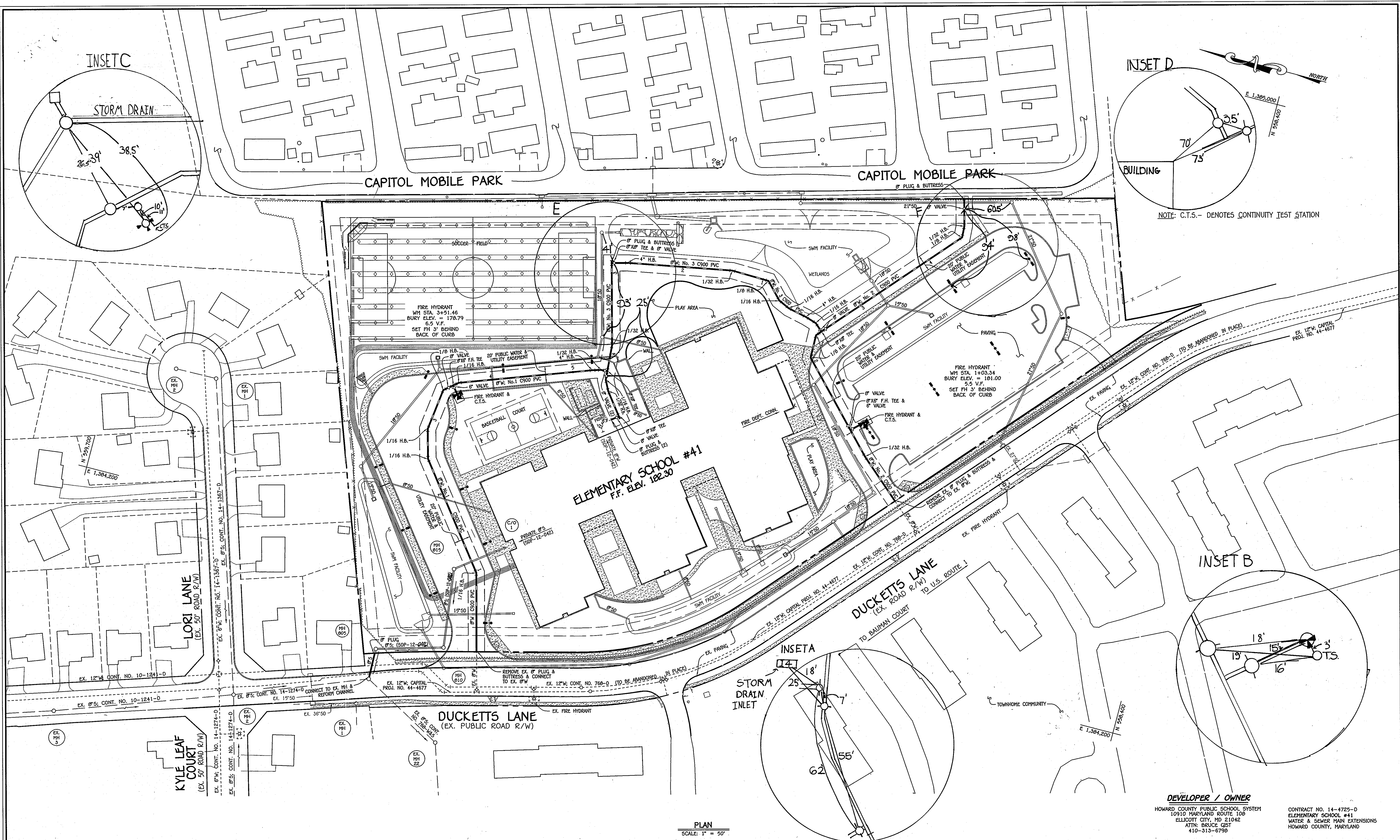

PLAN
SCALE: 1" = 50'

DEPARTMENT OF PUBLIC WORKS
HOWARD COUNTY, MARYLAND

Shea C. Cunn
CHIEF, BUREAU OF UTILITIES

DEPARTMENT OF PLANNING AND ZONING
HOWARD COUNTY, MARYLAND

Paul F. Prindel
CHIEF, DEVELOPMENT ENGINEERING DIVISION

I HEREBY CERTIFY THAT THESE DOCUMENTS WERE PREPARED OR APPROVED BY ME, AND THAT I AM A DULY LICENSED PROFESSIONAL ENGINEER UNDER THE LAWS OF THE STATE OF MARYLAND. LICENSE NO. 12043 EXPIRATION DATE IS 7/16/12.

FISHER, COLLINS & CARTER, INC.
CIVIL ENGINEERING CONSULTANTS & LAND SURVEYORS

CENTRAL SQUARE OFFICE PARK - 10272 BALTIMORE NATIONAL PIKE
ELICOTT CITY, MARYLAND 21042
(410) 461-2895

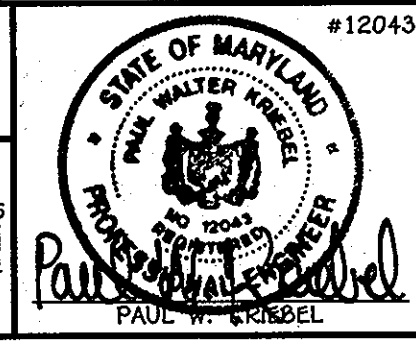

DESIGNED BY: B.C.R.
DRAWN BY: B.C.R.
CHECKED BY: P.W.K.
DATE: 1/31/14

BY: *AS-CWELT*

WATER & SEWER MAIN EXTENSIONS
PLAN

600' SCALE MAP NO. 37 BLOCK NO. 12
F.C.C. WORK ORDER NO. 11022
FILE NAME: WATER & SEWER MAIN EXTENSION PLAN

DEVELOPER / OWNER
HOWARD COUNTY PUBLIC SCHOOL SYSTEM
10910 MARYLAND ROUTE 108
ELICOTT CITY, MD 21042
ATTN: BRUCE GST
410-313-6798

CONTRACT NO. 14-4725-D
ELEMENTARY SCHOOL #41
WATER & SEWER MAIN EXTENSIONS
HOWARD COUNTY, MARYLAND

SCALE AS SHOWN
SHEET 2 OF 3

1301111022.dwg(11022) Water and Sewer Main Plan.dwg_2012012 3:40:48 PM

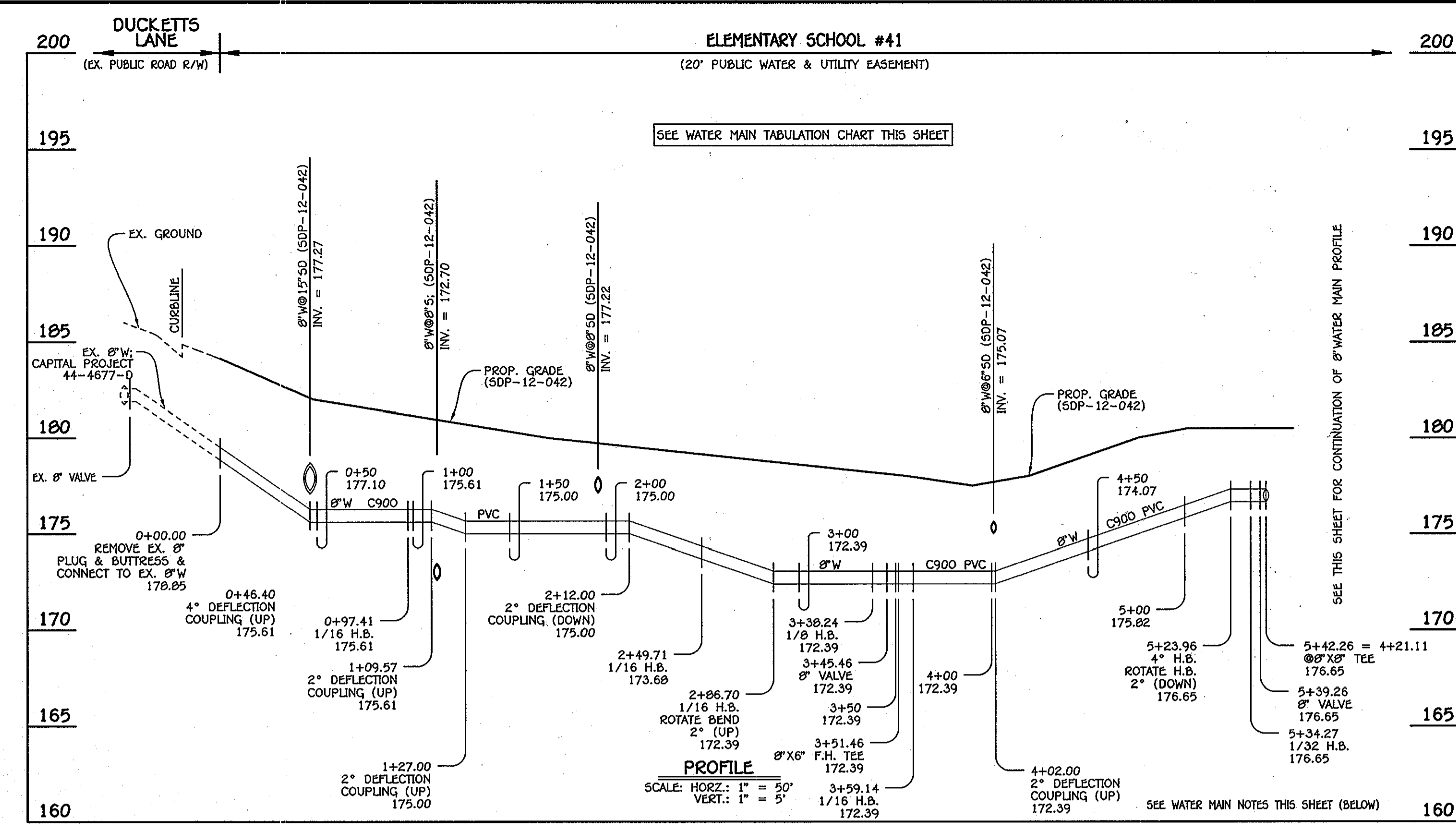
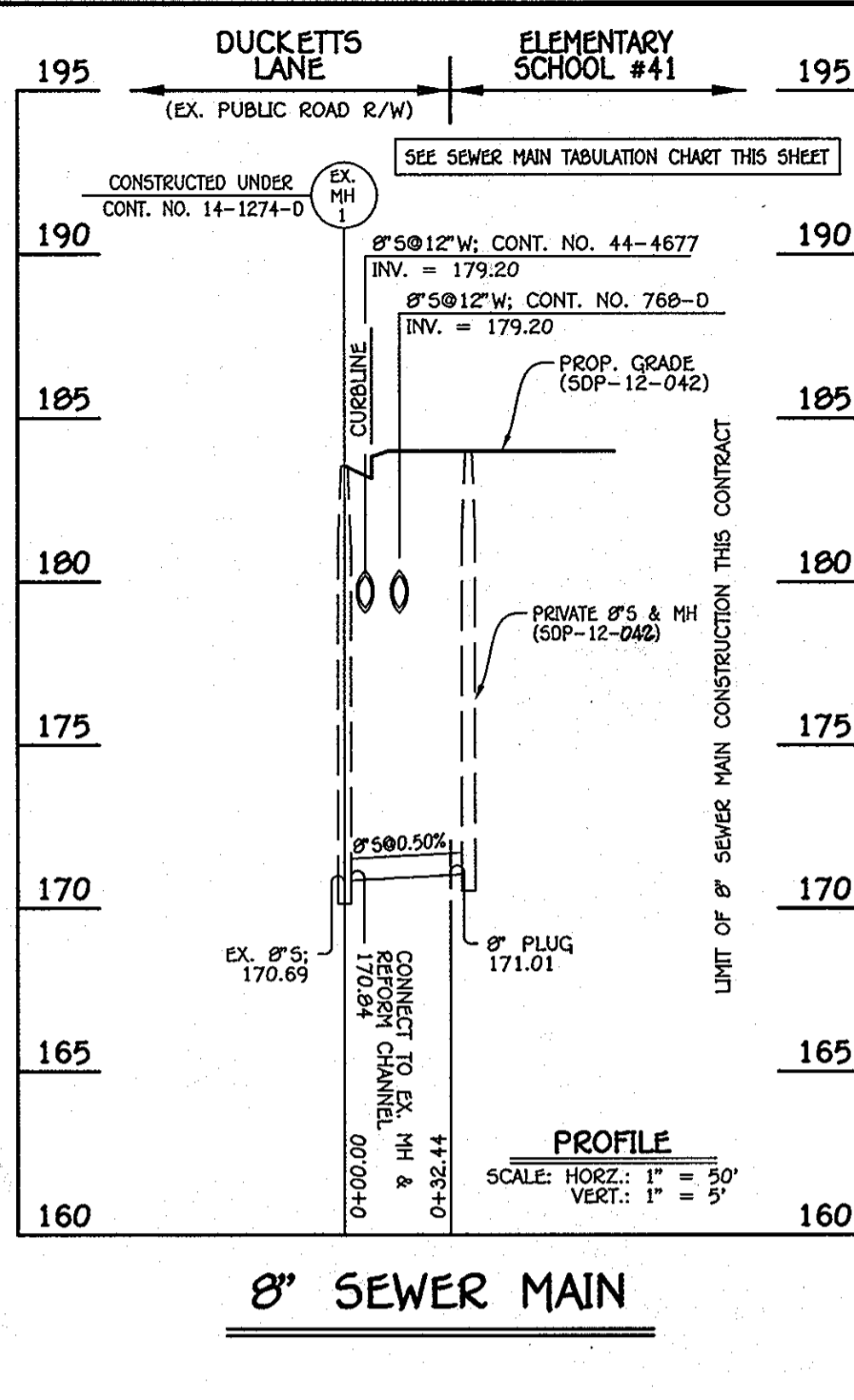

WATER MAIN TABULATION CHART			
W.M. STA.	APPURTENANCE	NORTHING	EASTING
8" WATER MAIN No. 1: ELEMENTARY SCHOOL #41			
0+00.00	EX. 8" PLUG & BUTTRESS	559180.15	1384100.26
0+97.41	1/16 H.B.	559205.05	1384194.44
2+49.71	1/16 H.B.	559297.71	1384315.30
2+86.70	1/16 H.B.	559307.37	1384351.01
3+38.24	1/8 H.B.	559300.90	1384402.14
3+45.46	8" VALVE	559295.35	1384406.77
3+51.46	8" X 6" F.H. TEE	559290.75	1384410.62
3+59.14	1/16 H.B.	559284.86	1384415.55
5+23.96	4" H.B.	559129.98	1384471.93
5+34.27	1/32 H.B.	559120.10	1384474.84
5+39.26	8" VALVE	559115.11	1384475.21
5+42.26	8" X 8" TEE	559112.12	1384475.43

WATER MAIN TABULATION CHART			
W.M. STA.	APPURTENANCE	NORTHING	EASTING
8" WATER MAIN No. 3: ELEMENTARY SCHOOL #41			
0+00.00	8" X 8" TEE	55870.20	1384588.53
0+03.00	8" VALVE	55872.45	1384590.52
0+12.66	1/16 H.B.	55879.69	1384596.92
0+26.87	4" H.B.	55893.24	1384601.18
0+50.42	1/16 H.B.	558916.23	1384606.33
0+65.57	1/16 H.B.	558929.77	1384612.70
0+92.96	1/8 H.B.	558948.73	1384632.64
1+39.07	1/32 H.B.	558994.83	1384633.77
2+67.48	4" H.B.	559121.16	1384610.76
2+84.42	8" VALVE	559137.54	1384606.43
2+87.42	8" X 8" TEE	559140.44	1384605.66
3+88.77	1/32 H.B.	559114.52	1384507.68
4+21.11	8" X 8" TEE	559112.12	1384475.43
4+27.11	8" VALVE	559111.68	1384469.45
4+31.93	1/16 H.B.	559111.32	1384464.64
4+46.38	1/32 H.B.	559104.87	1384451.71
4+80.18	8" X 8" TEE	559084.30	1384423.06
4+83.18	8" VALVE	559086.68	1384423.06
4+90.18	8" PLUG & BUTTRESS	559092.23	1384418.80

WATER MAIN TABULATION CHART			
W.M. STA.	APPURTENANCE	NORTHING	EASTING
8" WATER MAIN No. 2: ELEMENTARY SCHOOL #41			
0+00.00	EX. 8" PLUG & BUTTRESS	558730.37	1384409.24
0+65.99	1/32 H.B.	558779.77	1384452.98
1+03.34	8" X 6" F.H. TEE	558805.36	1384480.19
1+09.34	8" VALVE	558809.49	1384484.56
2+05.01	1/8 H.B.	558875.01	1384554.26
2+33.33	1/8 H.B.	558875.47	1384582.57
2+41.28	8" X 8" TEE	558870.20	1384588.53
2+47.28	8" VALVE	558866.23	1384593.03
4+49.21	1/8 H.B.	558732.55	1384744.37
4+63.35	1/32 H.B.	558733.42	1384758.49
4+84.91	8" VALVE	558738.94	1384779.33
4+96.91	8" PLUG & BUTTRESS	558742.01	1384790.93

MANHOLE TABULATION CHART			
NO.	NORTHING	EASTING	RJM ELEVATION
8" PLUG	559300.50	1384067.11	-----

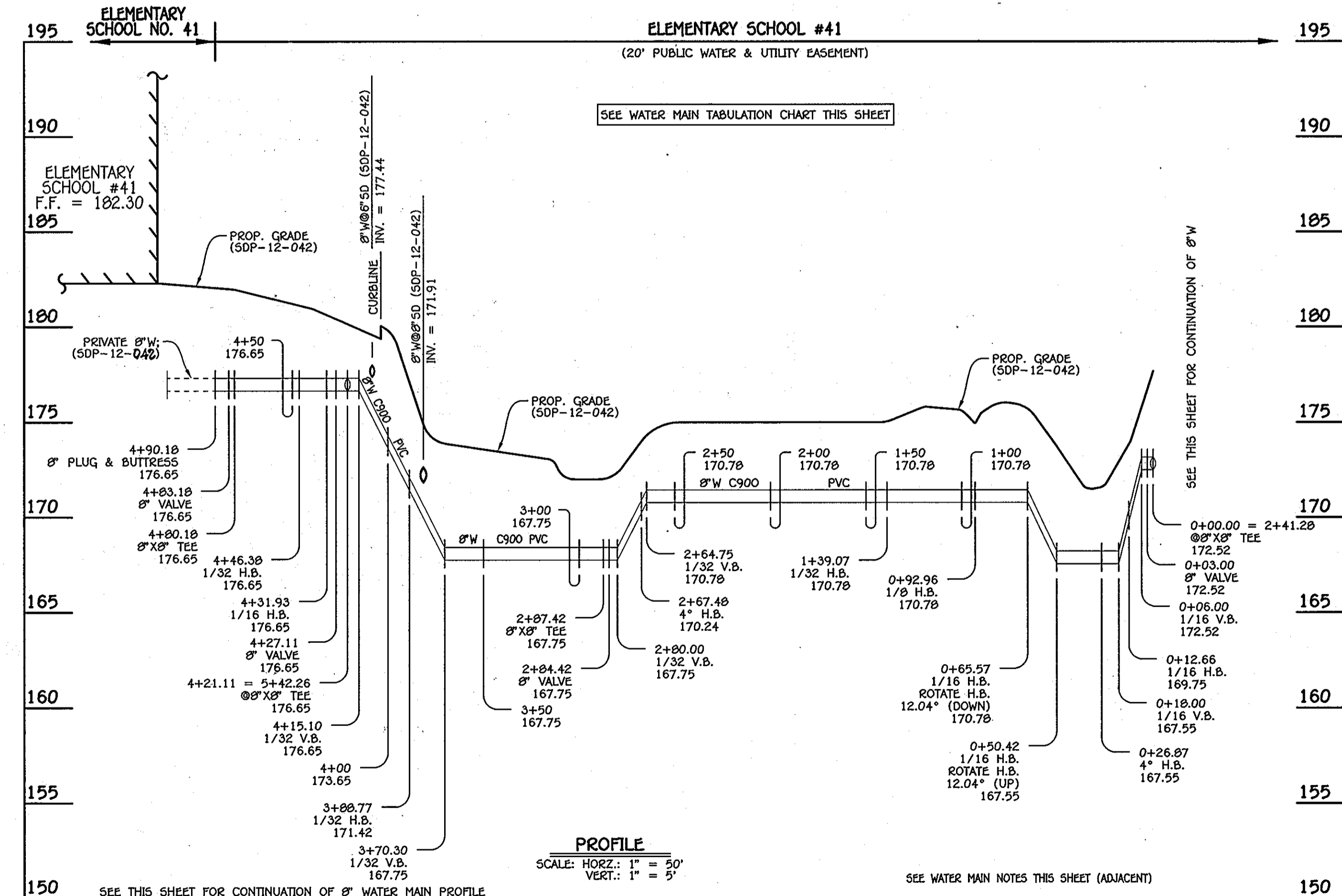
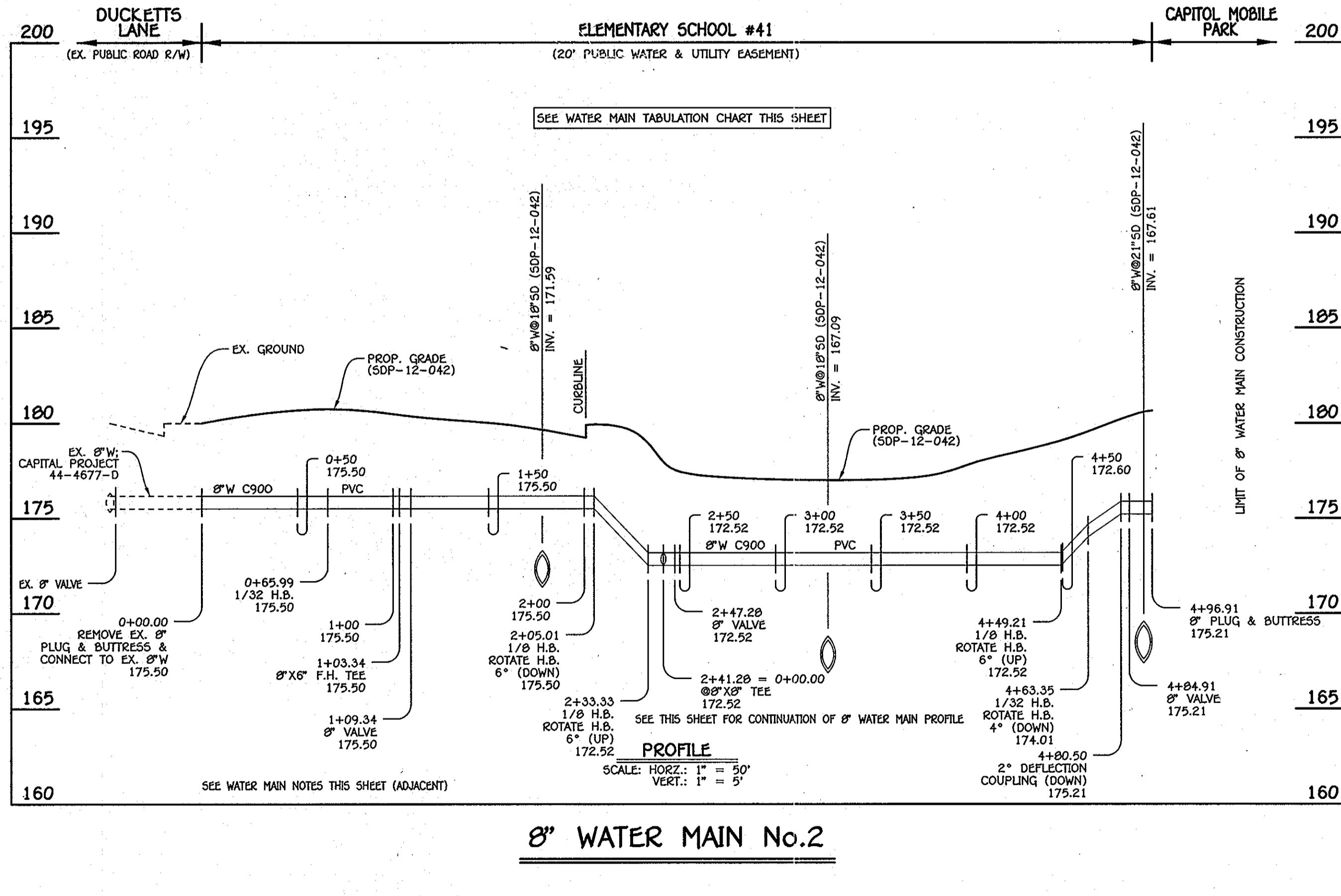

- WATER MAIN NOTES:**
- ALL WATER MAINS SHALL BE AWWA C900 PVC PIPE.
 - ALL PIPE BEDDING, TRACER WIRE, LOCATING TAPE AND OTHER APPURTENANCES SHALL BE IN ACCORDANCE WITH THE HOWARD COUNTY DESIGN MANUAL, VOLUME II - WATER AND SEWER STANDARDS FOR AWWA C900 PVC WATER PIPE INSTALLATION.
 - DEFLECTION COUPLINGS SHALL BE CERTAIN-TEED PVC HIGH DEFLECTION COUPLINGS.
 - ALL WATER HOUSE CONNECTIONS AND TAPS SHALL BE PERFORMED USING A SADDLE.

DEPARTMENT OF PUBLIC WORKS
HOWARD COUNTY, MARYLAND

Steve C. Green
CHIEF, BUREAU OF UTILITIES

DEPARTMENT OF PLANNING AND ZONING
HOWARD COUNTY, MARYLAND

William
CHIEF, DEVELOPMENT ENGINEERING DIVISION

I HEREBY CERTIFY THAT THESE DOCUMENTS WERE PREPARED OR APPROVED BY ME, AND THAT I AM A DULY LICENSED PROFESSIONAL ENGINEER UNDER THE LAWS OF THE STATE OF MARYLAND.
LICENSE NO. 12843 EXPIRATION DATE 5/7/16/12.

FISHER, COLLINS & CARTER, INC.
CIVIL ENGINEERING CONSULTANTS & LAND SURVEYORS
CENTRAL SQUARE OFFICE PARK - 10272 BALDWIN NATIONAL FREE
BLUETT CITY, MARYLAND 21042
(410) 461-2895

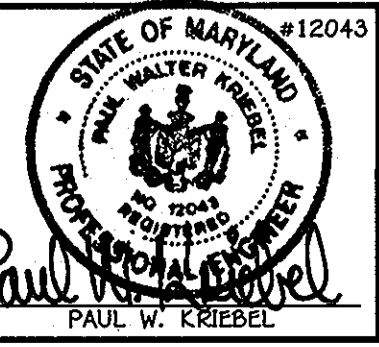

DESIGNED BY: B.C.R.
DRAWN BY: B.C.R.
CHECKED BY: P.W.K.
DATE: FEBRUARY, 2012

WATER & SEWER MAIN EXTENSIONS PROFILES & CHARTS

600' SCALE MAP NO. 37 BLOCK NO. 12
F.C.C. WORK ORDER NO. 11022
DATE: FILE NAME: WATER & SEWER MAIN EXTENSION PROFILES

ELEMENTARY SCHOOL #41
WATER & SEWER MAIN EXTENSIONS
CONTRACT NO. 14-4725-D
FIRST ELECTION DISTRICT
HOWARD COUNTY, MARYLAND

SCALE AS SHOWN
SHEET 3 OF 3