

SHEET INDEX

|   |                           |
|---|---------------------------|
| 1 | TITLE SHEET               |
| 2 | UTILITY PLAN AND PROFILES |

GENERAL NOTES

- APPROXIMATE LOCATIONS OF EXISTING MAINS ARE SHOWN. THE CONTRACTOR SHALL TAKE ALL NECESSARY PRECAUTIONS TO PROTECT EXISTING MAINS AND SERVICES AND MAINTAIN UNINTERRUPTED SERVICE. ANY DAMAGE INCURRED SHALL BE REPAIRED IMMEDIATELY TO THE SATISFACTION OF THE ENGINEER AT THE CONTRACTOR'S EXPENSE.
- THE TOPOGRAPHY SHOWN IS BASED ON A SURVEY BY THE TECH GROUP, ENTITLED "ALTA/ACSM LAND TITLE SURVEY, FOR PARCELS AT U.S. ROUTE 40, MD ROUTE 144 AND CEMETERY LANE" DATED JULY 26, 2005.
- HORIZONTAL AND VERTICAL SURVEY CONTROLS:
 

THE COORDINATES SHOWN ON THE DRAWINGS ARE BASED ON MARYLAND STATE REFERENCE SYSTEM NAD '83/'91 AS PROJECTED BY HOWARD COUNTY GEODETIC CONTROL STATIONS NO. 161A AND NO. 161B. ALL VERTICAL CONTROLS ARE ON NAVD '88.
- ALL PIPE ELEVATIONS SHOWN ARE INVERT ELEVATIONS UNLESS OTHERWISE NOTED ON THE PLANS.
- CLEAR ALL UTILITIES BY A MINIMUM OF 12 INCHES. CLEAR ALL POLES BY 5'-0" MINIMUM OR TUNNEL AS REQUIRED UNLESS OTHERWISE NOTED. THE OWNER HAS CONTACTED THE UTILITY COMPANIES AND HAS MADE ARRANGEMENTS FOR BRACING OF POLES AS SHOWN ON THE DRAWINGS. IN THE EVENT THE CONTRACTOR'S WORK REQUIRES THE BRACING OF ADDITIONAL POLES, ANY COST INCURRED BY THE OWNER FOR THE BRACING OF ADDITIONAL POLES OR DAMAGES SHALL BE DEDUCTED FROM MONIES OWED TO THE CONTRACTOR. THE CONTRACTOR SHALL COORDINATE WITH THE UTILITY COMPANIES TO SCHEDULE THE BRACING OF THE POLES.
- FOR DETAILS NOT SHOWN ON THE DRAWINGS, AND FOR MATERIALS AND CONSTRUCTION METHODS, USE HOWARD COUNTY DESIGN MANUAL, VOLUME IV, STANDARD SPECIFICATIONS AND DETAILS FOR CONSTRUCTION (LATEST EDITION). THE CONTRACTOR SHALL HAVE A COPY OF VOLUME IV ON THE JOB.
- WHERE TEST PITS HAVE BEEN MADE ON EXISTING UTILITIES, THEY ARE NOTED BY THE SYMBOL  AT THE LOCATIONS OF THE TEST PITS. EXISTING UTILITIES IN THE VICINITY OF THE PROPOSED WORK FOR WHICH TEST PITS HAVE NOT BEEN DUG SHALL BE LOCATED BY THE CONTRACTOR TWO WEEKS IN ADVANCE OF CONSTRUCTION OPERATIONS AT HIS OWN EXPENSE.
- THE CONTRACTOR SHALL NOTIFY THE FOLLOWING UTILITY COMPANIES OR AGENCIES AT LEAST FIVE WORKING DAYS BEFORE STARTING WORK SHOWN ON THESE PLANS:
 

|                                  |              |
|----------------------------------|--------------|
| AT&T                             | 800-252-1133 |
| BGE (CONSTRUCTION SERVICES)      | 410-950-4620 |
| BGE (UNDERGROUND DAMAGE CONTROL) | 410-787-9068 |
| BUREAU OF UTILITIES              | 410-513-4900 |
| COLONIAL PIPELINE COMPANY        | 410-795-1390 |
| MISS UTILITY                     | 800-257-7777 |
| STATE HIGHWAY ADMINISTRATION     | 410-531-5533 |
| VERIZON                          | 410-224-9210 |
- TREES AND SHRUBS ARE TO BE PROTECTED FROM DAMAGE TO THE MAXIMUM EXTENT. TREES AND SHRUBS LOCATED WITHIN THE CONSTRUCTION STRIP ARE NOT TO BE REMOVED OR DAMAGED BY THE CONTRACTOR.
- THE CONTRACTOR SHALL REMOVE TREES, STUMPS AND ROOTS ALONG THE LINE OF EXCAVATION. PAYMENT FOR SUCH REMOVAL SHALL BE INCLUDED IN THE UNIT PRICE BID FOR CONSTRUCTION OF THE MAIN.
- THE CONTRACTOR SHALL NOTIFY THE BUREAU OF HIGHWAYS, HOWARD COUNTY, AT 410-313-7450 AT LEAST FIVE WORKING DAYS BEFORE OPEN CUTTING OR BORING/JACKING OF ANY COUNTY ROAD FOR LAYING WATER/SEWER MAINS OR HOUSE CONNECTIONS. THE APPROVAL OF THESE DRAWINGS WILL CONSTITUTE COMPLIANCE WITH DPW REQUIREMENTS PER SECTION 18.114(A) OF THE HOWARD COUNTY CODE.

BENCHMARK

GEODETIC SURVEY CONTROL - 161A  
 N 528,760.4  
 E 833,926.6  
 ELEV. 463.7'  
 LOCATED WITHIN THE MEDIAN OF U.S. ROUTE 40, APPROX. 0.35 MILES WEST OF MD ROUTE 144.

GEODETIC SURVEY CONTROL - 161B  
 N 529,726.3  
 E 833,926.6  
 ELEV. 470.600'  
 LOCATED WITHIN THE MEDIAN OF U.S. ROUTE 40 APPROX. 0.80 MILES EAST OF MARRIOTTVILLE ROAD

QUANTITIES

| ITEMS                    | QUANTITIES ESTIMATED | QUANTITIES | AS-BUILT TYPE | MANUFACTURER / SUPPLIER |
|--------------------------|----------------------|------------|---------------|-------------------------|
| 8" VALVE                 | 2 EA                 |            |               |                         |
| 6" PVC C900 (WATERLINE)  | 44 LF                |            |               |                         |
| 8"x8" TEE                | 1 EA                 |            |               |                         |
| 1/16 BEND                | 1 EA                 |            |               |                         |
| 1/8 BEND                 | 5 EA                 |            |               |                         |
| 8"x6" TEE                | 3 EA                 |            |               |                         |
| 8" PVC C900 (WATERLINE)  | 456 LF               |            |               |                         |
| 6" VALVE                 | 3 EA                 |            |               |                         |
| FIRE HYDRANTS            | 2 EA                 |            |               |                         |
| CAP & BUTTRESS           | 1 EA                 |            |               |                         |
| 6" PVC SDR 35 (SANITARY) | 18 LF                |            |               |                         |

NAME OF UTILITY CONTRACTOR :  
 Sediment control measures for this contract will be implemented in accordance with Section 219 of the Specifications and as shown on SDP-09-44)

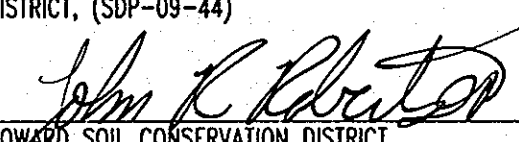
THIS PLAN IS APPROVED FOR SOIL EROSION AND SEDIMENT CONTROL BY THE HOWARD SOIL CONSERVATION DISTRICT, (SDP-09-44)  
  
 JOHN C. GREEN  
 CHIEF, BUREAU OF UTILITIES  
 DATE: 11/14/09

CHECKBOX  
 AS-BUILT DATE  
 SURVEY AND DRAFTING DIVISION

OWNER:  
 PARCELS 10 AND 39  
 KAULFUSS JACK  
 13715 OLD ROVER ROAD  
 WEST FRIENDSHIP MD 21794-9718  
 PHONE: 410-442-2011

OWNER:  
 PARCEL 96  
 CALABRESE JOHN & WF ET AL  
 3282 OLD FENCE ROAD  
 ELLICOTT CITY, MD 21042-2440  
 PHONE: 410-465-3519

DEVELOPER  
 RITE AID CORPORATION  
 P.O. BOX 3165  
 HARRISBURG, PA 17105  
 ATTN: LANCE MASON  
 PHONE: 804-745-622

# RITE AID CORPORATION PUBLIC WATER PLAN TAX MAP 23, GRID 6, PARCEL A HOWARD COUNTY, MARYLAND CONTRACT NO. 24-4619-D

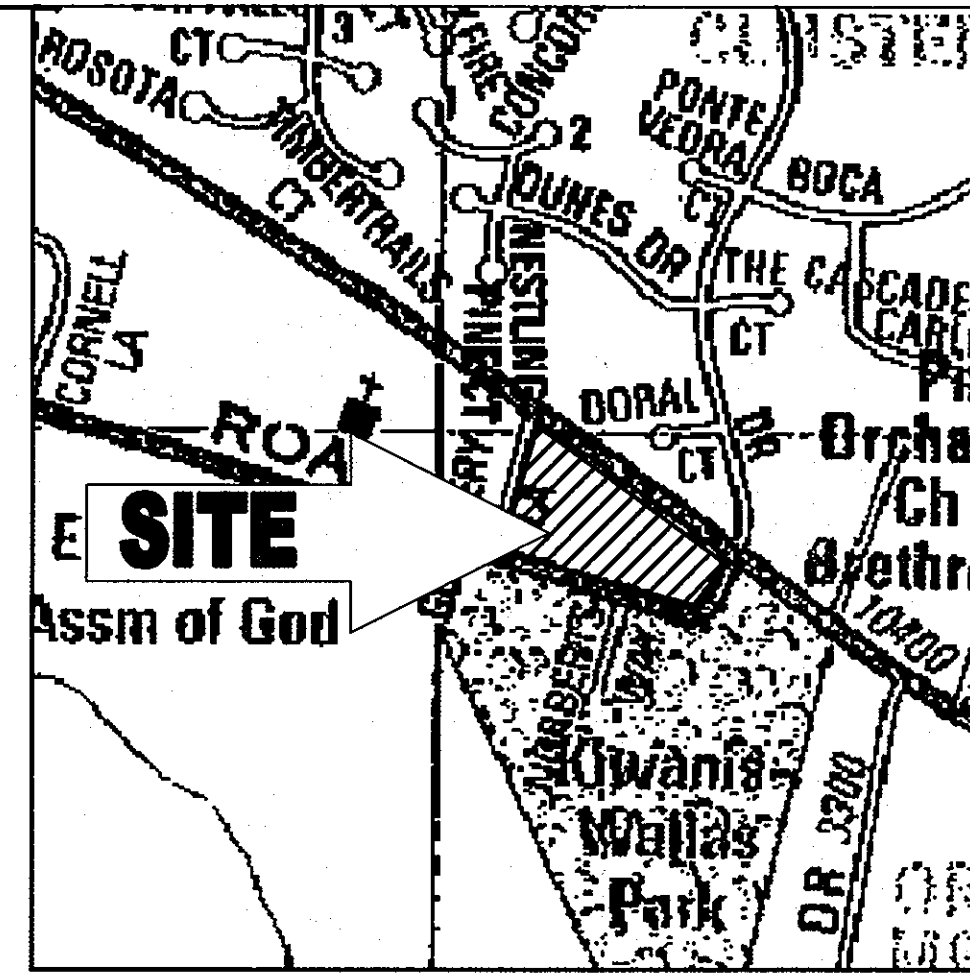

VICINITY MAP  
 COPYRIGHT ADC THE MAP PEOPLE  
 PERMIT USE NO. 20502153-5  
 SCALE: 1"=600'

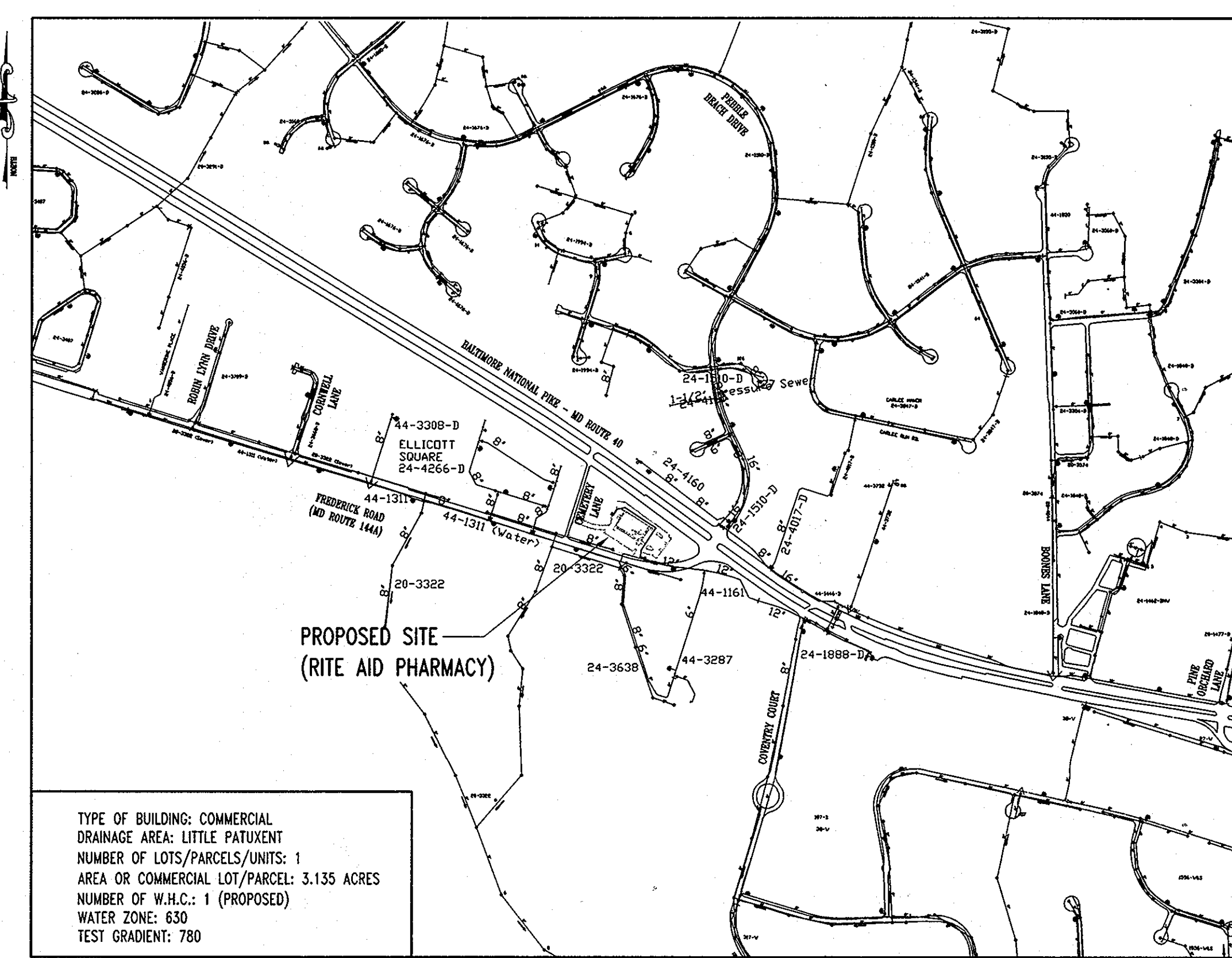

TYPE OF BUILDING: COMMERCIAL  
 DRAINAGE AREA: LITTLE PATUXENT  
 NUMBER OF LOTS/PARCELS/UNITS: 1  
 AREA OR COMMERCIAL LOT/PARCEL: 3.135 ACRES  
 NUMBER OF W.H.C.: 1 (PROPOSED)  
 WATER ZONE: 630  
 TEST GRADIENT: 780

LOCATION MAP  
 SCALE: 1"=600'

WATER NOTES

- EXCEPT WHERE INDICATED ON THE PLANS, ALL PUBLIC WATER MAINS SHALL BE PVC PIPE MEETING THE REQUIREMENTS AWWA C900 DR18, PRESSURE CLASS 150 AND THE HOWARD COUNTY DESIGN MANUAL VOLUME IV-STANDARD SPECIFICATIONS AND DETAILS FOR CONSTRUCTION AND ALL SUBSEQUENT AMENDMENTS THERETO.
- TOPS OF ALL WATER MAINS SHALL HAVE A MINIMUM OF 3'-6" OF COVER UNLESS OTHERWISE NOTED.
- VALVES ADJACENT TO TEES SHALL BE STRAPPED TO TEES.
- ALL FITTINGS SHALL BE BUTTRESSED OR ANCHORED WITH CONCRETE IN ACCORDANCE WITH THE STANDARD DETAILS UNLESS OTHERWISE PROVIDED FOR ON THE DRAWINGS.
- FIRE HYDRANTS SHALL BE SET TO THE BURY LINE ELEVATIONS SHOWN ON THE DRAWINGS. ALL FIRE HYDRANTS SHALL BE RESTRAINED AND BUTTRESSED OR ANCHORED WITH CONCRETE IN ACCORDANCE WITH THE STANDARD DETAILS. THE SOIL AROUND THE FIRE HYDRANT SHALL BE COMPACTED IN ACCORDANCE WITH SECTION 1000 AND 1005 OF THE STANDARD SPECIFICATIONS.
- THE CONTRACTOR SHALL NOT OPERATE ANY WATER MAIN VALVES ON THE EXISTING WATER SYSTEM.
- ALL WATER HOUSE CONNECTIONS SHALL BE FOR INSIDE METER SETTING UNLESS OTHERWISE NOTED ON PLANS OR IN SPECIFICATIONS.
- FIRE HYDRANTS ARE TO BE D.I.P. ONLY.
- FOR SPRINKLER SYSTEM FOR ALL TOWN HOMES OR MULTI-FAMILY DWELLING UNITS THE SHOULD HAVE A MINIMUM OF 1" CONNECTION WITH A 3/4" METER.
- VALVES ARE TO BE ATTACHED WITH IRON FITTINGS OR CONCRETE ANCHORS.
- THE DIMENSION RATIO FOR THE PVC MAIN SHALL BE DR18.
- WATER MAIN CONSTRUCTION SHALL CONSIST OF PVC MAIN WITH EPOXY COATED D.I.P. FITTINGS OR PVC MAIN WITH PVC FITTINGS.

SEWER NOTES

- ALL SEWER MAINS SHALL BE D.I.P. OR P.V.C. UNLESS OTHERWISE NOTED.
- ALL MANHOLES SHALL BE 4'-0" INSIDE DIAMETER UNLESS OTHERWISE NOTED.
- FORCE MAINS SHALL BE D.I.P. ONLY.
- MANHOLES SHOWN WITH 12" AND 16" WALLS ARE FOR BRICK MANHOLES ONLY.
- MANHOLES DESIGNED W.T. IN PLAN AND PROFILE SHALL HAVE WATERTIGHT FRAME AND COVERS, STANDARD DETAIL G5.52. WHERE WATERTIGHT FRAME AND COVER IS USED, SET TOP FRAME 1"-6" ABOVE FINISHED GRADE UNLESS OTHERWISE NOTED ON THE DRAWINGS.
- HOUSE(S) WITH THE SYMBOL "C.N.S." INDICATES THAT CELLAR CANNOT BE SERVED.

LEGEND

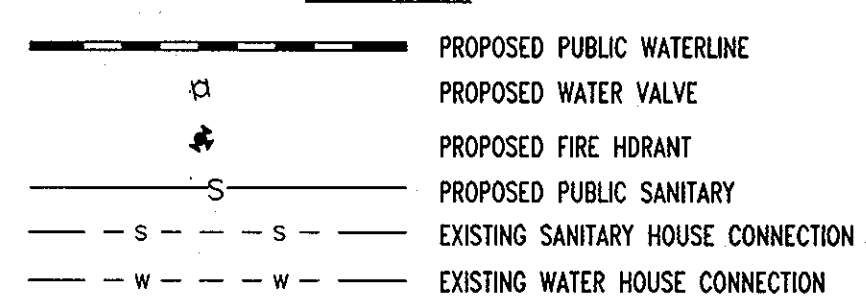

MISS UTILITY



THIS DRAWING DOES NOT INCLUDE NECESSARY COMPONENTS FOR CONSTRUCTION SAFETY. ALL CONSTRUCTION MUST BE DONE IN COMPLIANCE WITH THE OCCUPATIONAL SAFETY AND HEALTH ACT OF 1970 AND ALL RULES AND REGULATIONS THERETO APPROPRIATE.

PROFESSIONAL CERTIFICATION

I, MATTHEW T. ALLEN, HEREBY CERTIFY THAT THESE DOCUMENTS WERE PREPARED OR APPROVED BY ME, AND THAT I AM A DULY LICENSED PROFESSIONAL ENGINEER UNDER THE LAWS OF THE STATE OF MARYLAND, LICENSE NO. 28567, EXPIRATION DATE: 4/16/11

DEPARTMENT OF PUBLIC WORKS  
 HOWARD COUNTY, MARYLAND  
  
 JOHN C. GREEN  
 CHIEF, BUREAU OF UTILITIES  
 DATE: 11/22/09

DEPARTMENT OF PLANNING & ZONING  
 HOWARD COUNTY, MARYLAND  
  
 MATTHEW T. ALLEN  
 CHIEF, DEVELOPMENT ENGINEERING DIVISION  
 DATE: 11/22/09

**BOHLER ENGINEERING**  
 CIVIL & CONSULTING ENGINEERS  
 SURVEYORS  
 PROJECT MANAGERS  
 ENVIRONMENTAL ENGINEERS  
 LANDSCAPE ARCHITECTS

OFFICES:  
 WARREN, NJ  
 SOUTHBOROUGH, MA  
 ALBANY, NY  
 PURCHASE, NY  
 RONKONKOMA, NY  
 CHALFONT, PA

STERLING, VA  
 BOWIE, MD  
 TOWSON, MD  
 WARRENTON, VA  
 FORT LAUDERDALE, FL  
 CENTER VALLEY, PA

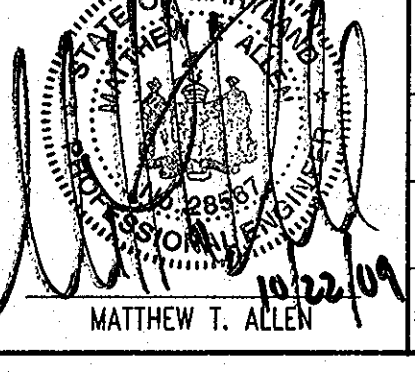

|                |      |
|----------------|------|
| DES: T.A.C.    |      |
| DRN: T.A.C.    |      |
| CHK: M.J.G.    |      |
| DATE: 10/22/09 |      |
| REV.           | DATE |
|                |      |
|                |      |
|                |      |
|                |      |
|                |      |

|            |    |
|------------|----|
| PARCEL NO. | A  |
| MAP NO.    | 23 |
| BLOCK NO.  |    |

RITE AID CORPORATION  
 10470 FREDERICK ROAD  
 TAX MAP 23, PARCEL A  
 2ND ELECTION DISTRICT  
 HOWARD COUNTY, MARYLAND  
 CONTRACT NO.: 24-4619-D

SCALE AS SHOWN  
 SHEET 1 OF 2

H:\07 Rite Aid Corporation\MD07-2009-10470 Frederick Road, Ellicott City, MD\CAD\Public Water Plans\Rev 3\MD07-2009\DWG3.dwg  
 10/22/09 10:22:09 AM

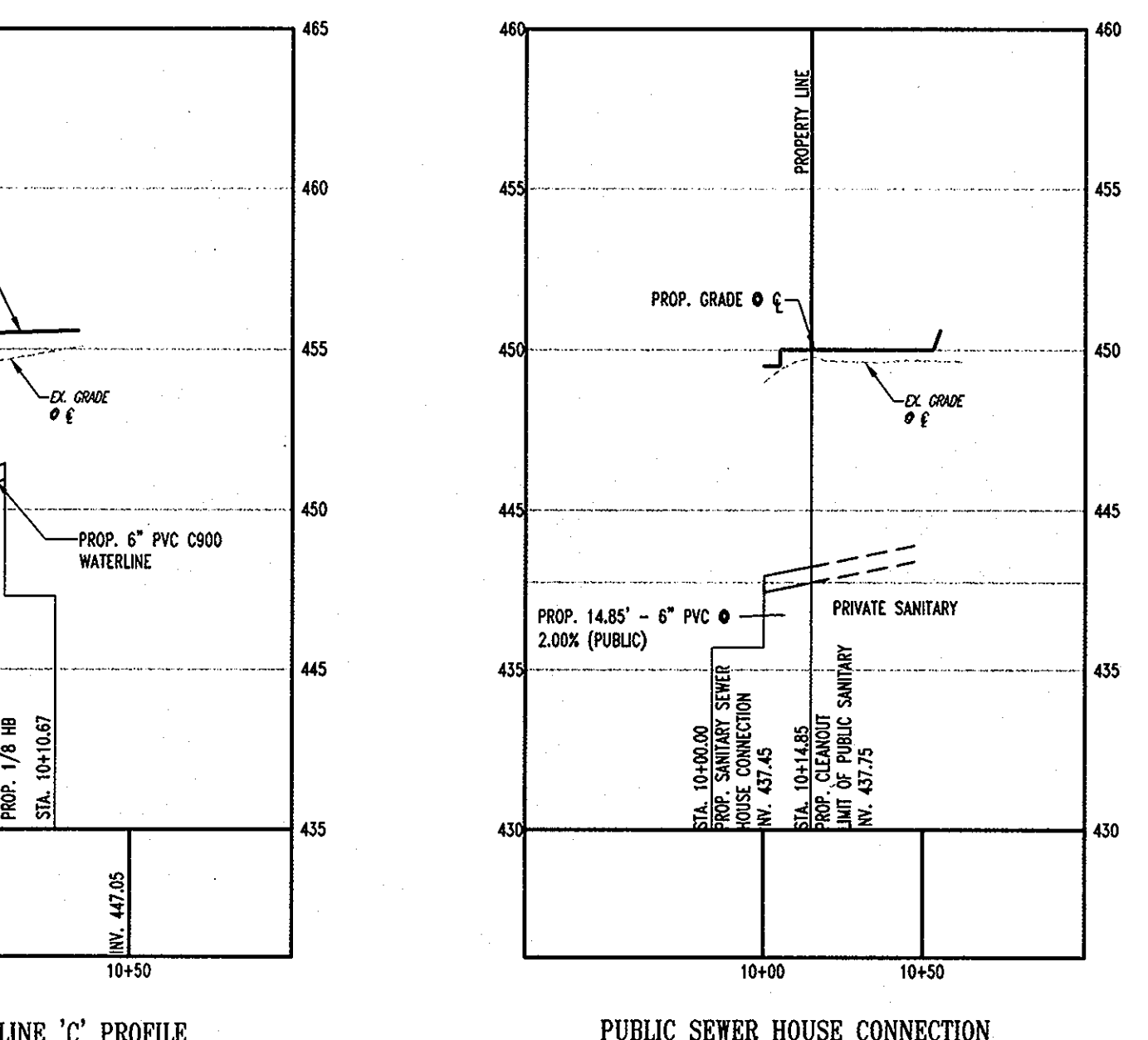
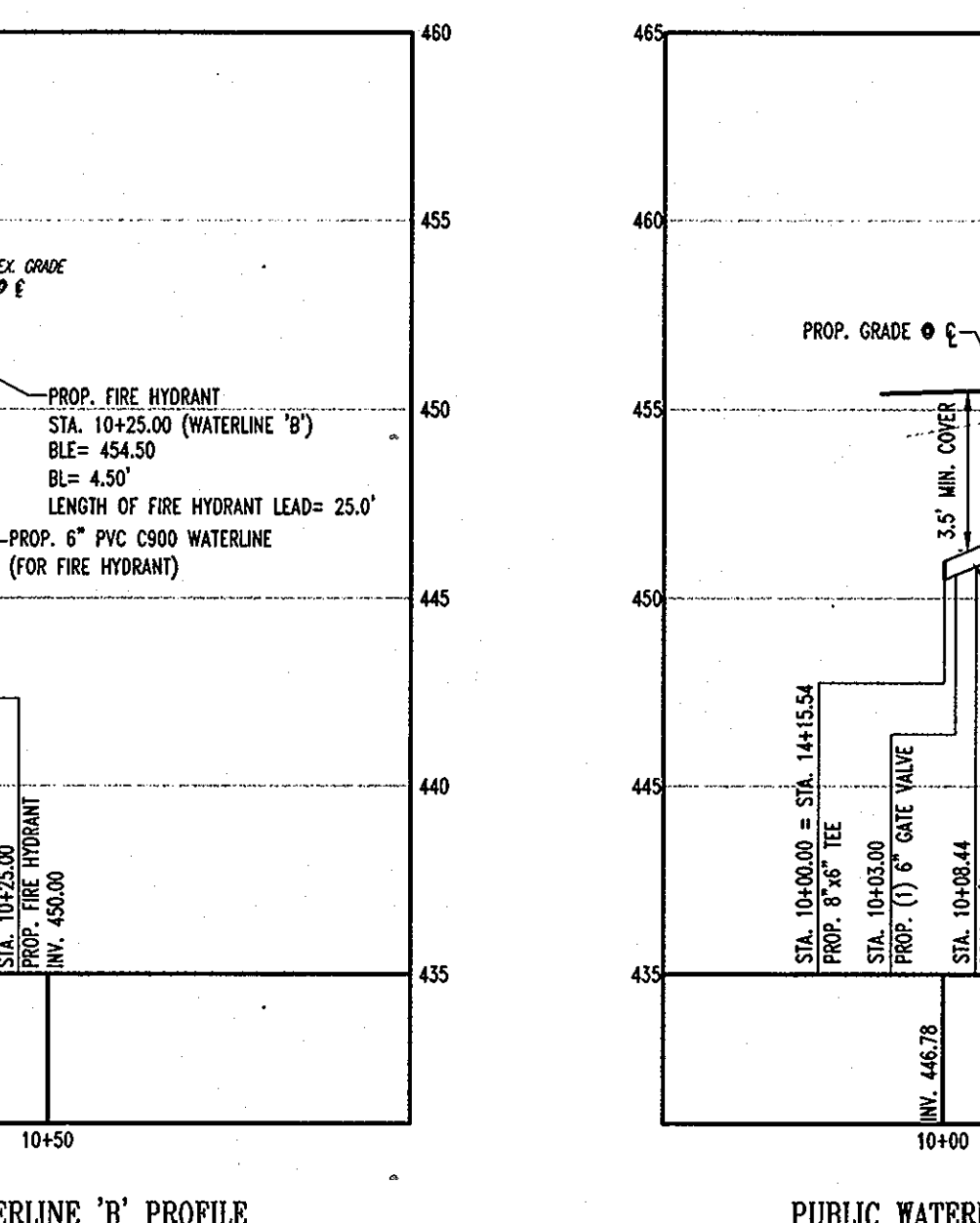
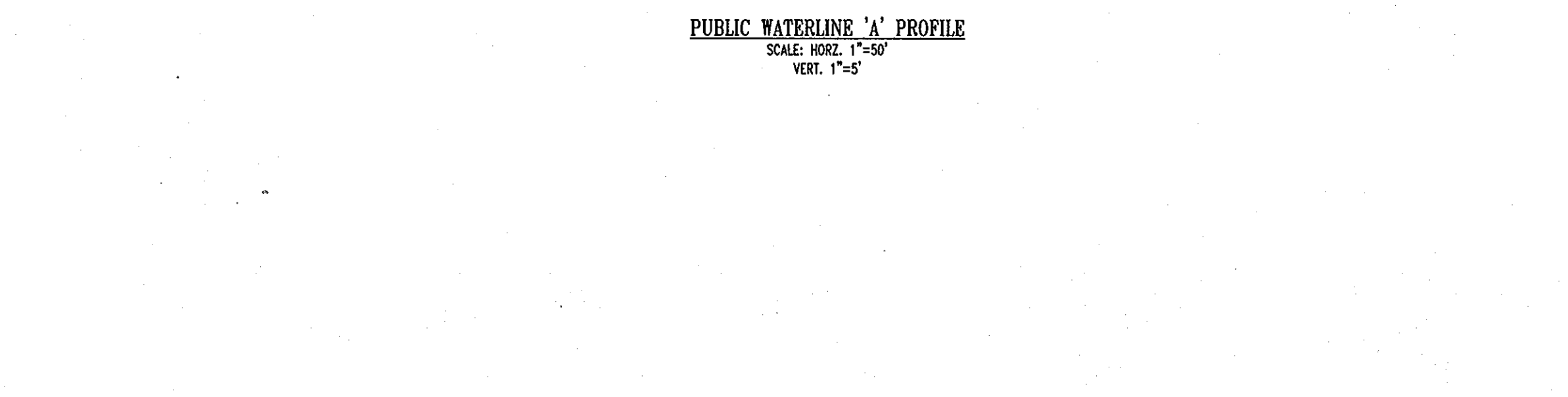
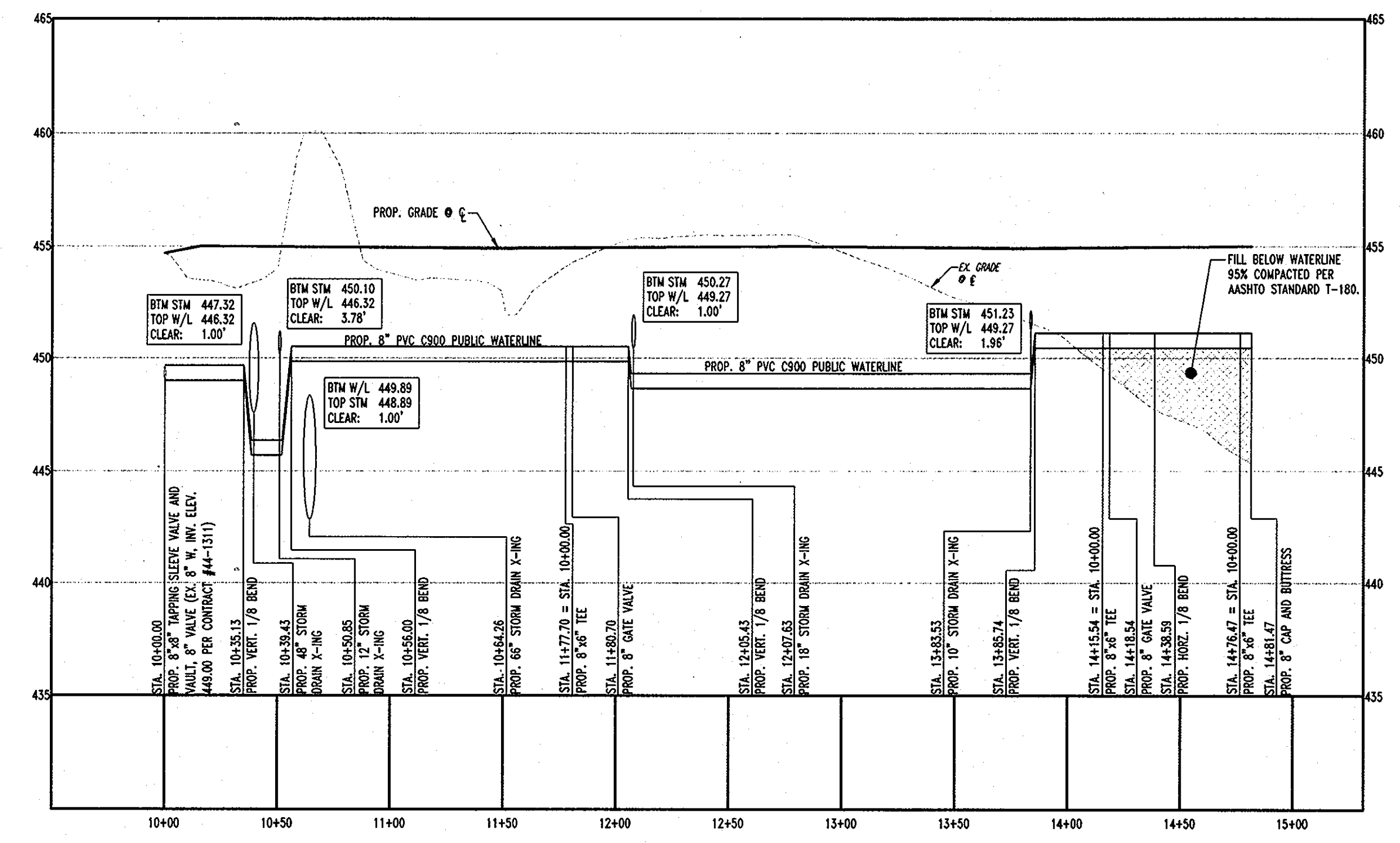
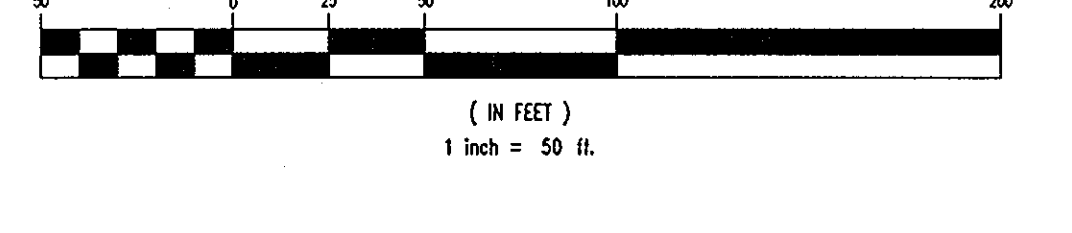
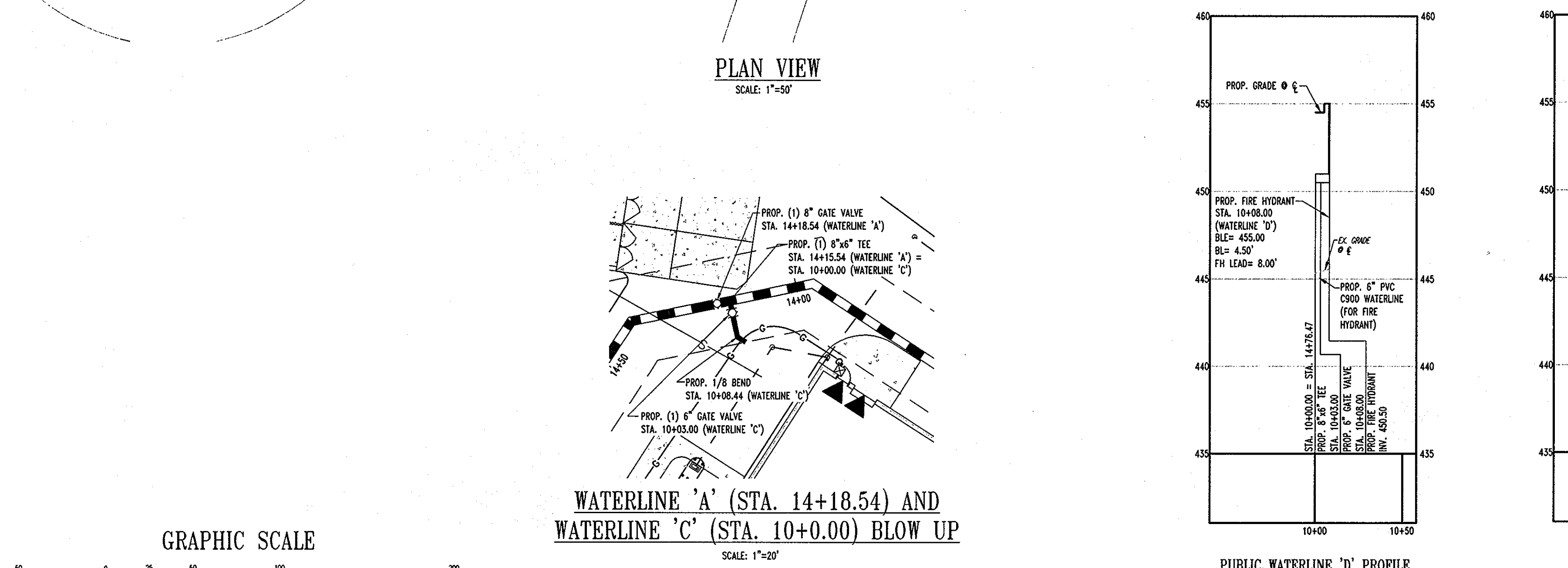
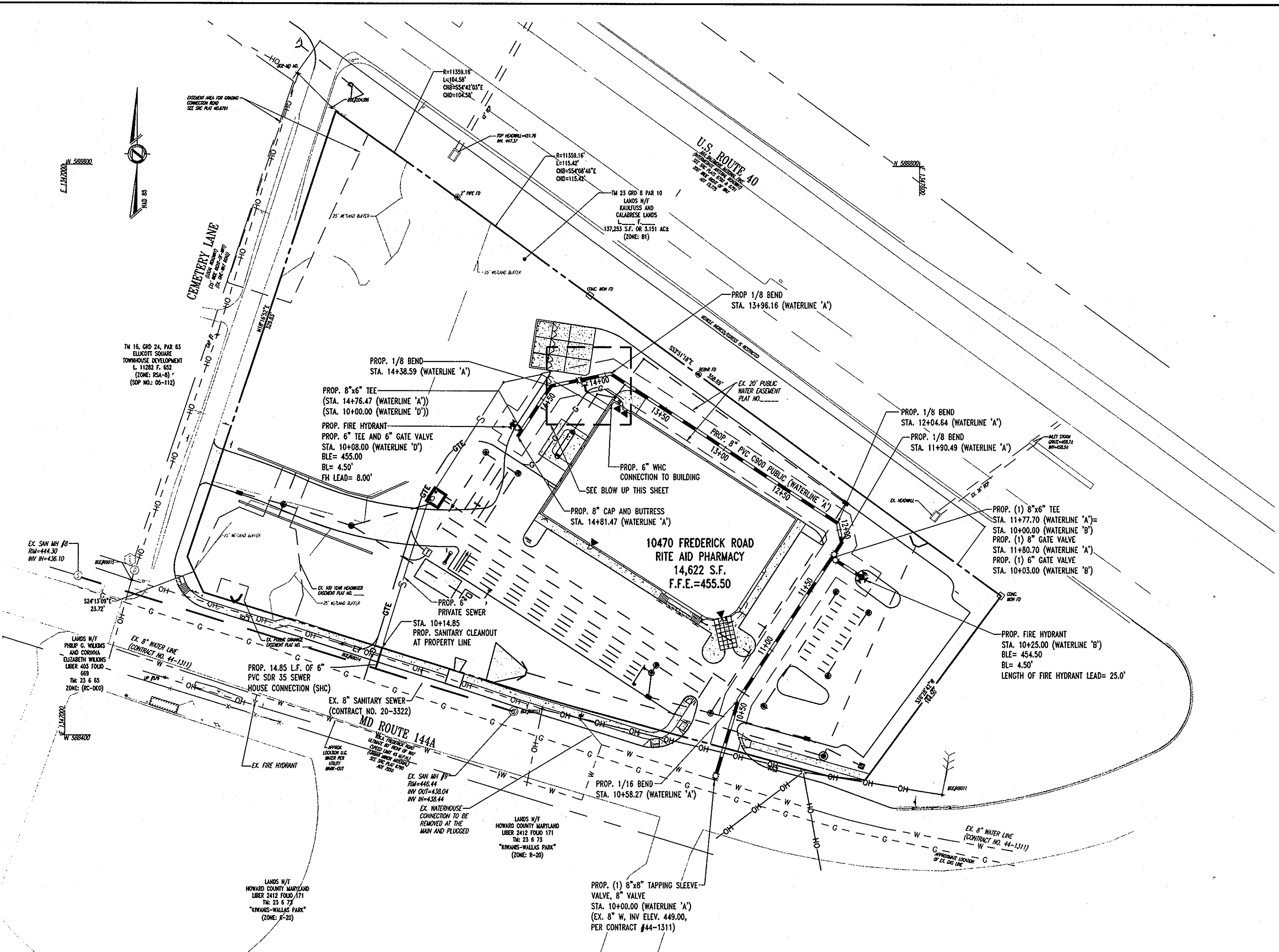

DEPARTMENT OF PUBLIC WORKS  
HOWARD COUNTY, MARYLAND

*Shelton C. Curran* 10/27/09  
CHIEF, BUREAU OF UTILITIES DATE

DEPARTMENT OF PLANNING & ZONING  
HOWARD COUNTY, MARYLAND

*Matthew T. Allen* 11/16/09  
CHIEF, DEVELOPMENT ENGINEERING DIVISION DATE

**BOHLER ENGINEERING**

CIVIL & CONSULTING ENGINEERS  
SURVEYORS  
PROJECT MANAGERS  
ENVIRONMENTAL ENGINEERS  
LANDSCAPE ARCHITECTS

OFFICES:  
 ● WARREN, NJ  
 ● SOUTHBOROUGH, MA  
 ● ALBANY, NY  
 ● PURCHASE, NY  
 ● RONKONKOMA, NY  
 ● CHALFONT, PA  
 ● STERLING, VA  
 ● BOWIE, MD  
 ● TOWSON, MD  
 ● WASHINGTON, VA  
 ● FORT LAUDERDALE, FL  
 ● CENTER VALLEY, PA

*Matthew T. Allen*  
MATTHEW T. ALLEN  
DATE: 10/22/2009

|                  |             |
|------------------|-------------|
| DES: T.A.C.      |             |
| DRN: T.A.C.      |             |
| CHK: M.J.G.      |             |
| DATE: 10/22/2009 |             |
| REV.             | DATE        |
|                  | DESCRIPTION |

UTILITY  
PLAN AND PROFILES

PARCEL NO.           
600' SCALE MAP NO. 23 BLOCK NO.         

RITE AID CORPORATION  
10470 FREDERICK ROAD  
TAX MAP 23, PARCEL A  
2ND ELECTION DISTRICT  
HOWARD COUNTY, MARYLAND  
CONTRACT NO.: 24-4619-D

SCALE AS SHOWN  
SHEET 2 OF 2

**MISS UTILITY**

BEFORE YOU DIG CALL  
811 IN MD  
OR 1-800-257-7777  
PROTECT YOURSELF. GIVE TWO  
WORKING DAYS NOTICE.

THIS DRAWING DOES NOT INCLUDE NECESSARY  
COMPONENTS FOR CONSTRUCTION SAFETY. ALL  
CONSTRUCTION MUST BE DONE IN  
COMPLIANCE WITH THE OCCUPATIONAL SAFETY  
AND HEALTH ACT OF 1970 AND ALL RULES  
AND REGULATIONS THEREOF APPROPRIATE.

THE CONTRACTOR TO CALL MISS UTILITY  
TO HAVE ALL EXISTING UTILITIES MARKED  
48 HOURS PRIOR TO ANY CONSTRUCTION.