

QUANTITY TABLE

ITEMS	QUANTITIES		TYPE	MANUFACTURER/SUPPLIER	
	ESTIMATED	QUANTITIES			
STANDARD MH (HO. CO. STD.G-5.01)	15	15	FEBCAST	ATLANTIC	ATLANTIC
TYPE B DROP MANHOLE (HO. CO. STD. S 1.32)	2	2	"	"	"
8" SEWER MAIN (PVC)	1981 L.F.	1405	SDR 35	J.M.	BELAIR RD SUP.
8" SEWER MAIN (DIP)	119 L.F.	114	CL-52	GRIFFIN	"
4" SEWER HOUSE CONNECTION	1498 L.F.	1682	SDR 35	J.M.	"
# SEWER HOUSE CONNECTIONS	48 EACH				
# MH SHC CONNECTIONS	8 EACH	5EA.	2 D.I.P. 3 P.V.C.	GRIFFIN J.M.	BELAIR RD. SUP.
8" WATER MAIN	2367 L.F.	2,169	CL-52	GRIFFIN	"
1" WATER HOUSE CONNECTION	1425 L.F.	1,310	K	HOWELL METAL	"
# 1" TWHC	8 EACH				
# 1" WHC	39 EACH	55	K	"	"
1.5" TWHC	112 L.F.				
8"x8" T	2 EACH	1EA	M.J.	SIGMA	"
8" V	4 EACH	4EA	RSCV	MUELLER	"
8" CAP & BUTTRESS	3 EACH	3EA	M.J.	SIGMA	"
1/32 H.B. (8")	8 EACH	4EA	3A,3	SIGMA	"
1/16 H.B. (8")	5 EACH	3EA	M.J.	SIGMA	"
F.H.	5 EACH	5EA		MUELLER	"
8" X 6" F.H.T. & V.	5 EACH	5EA	M.J.	SIGMA	"
12" X 8" T.S. & V.	1 EACH	1EA	SS	J.C.M.	"
8" X 8" CROSS	1 EACH	1EA		SIGMA	"
6" WATER MAIN		110LF	CL-52	GRIFFIN	"

NAME OF UTILITY CONTRACTOR: G.C.S.
 SURVEY AND DRAFTING DIVISION AS-BUILT DATE

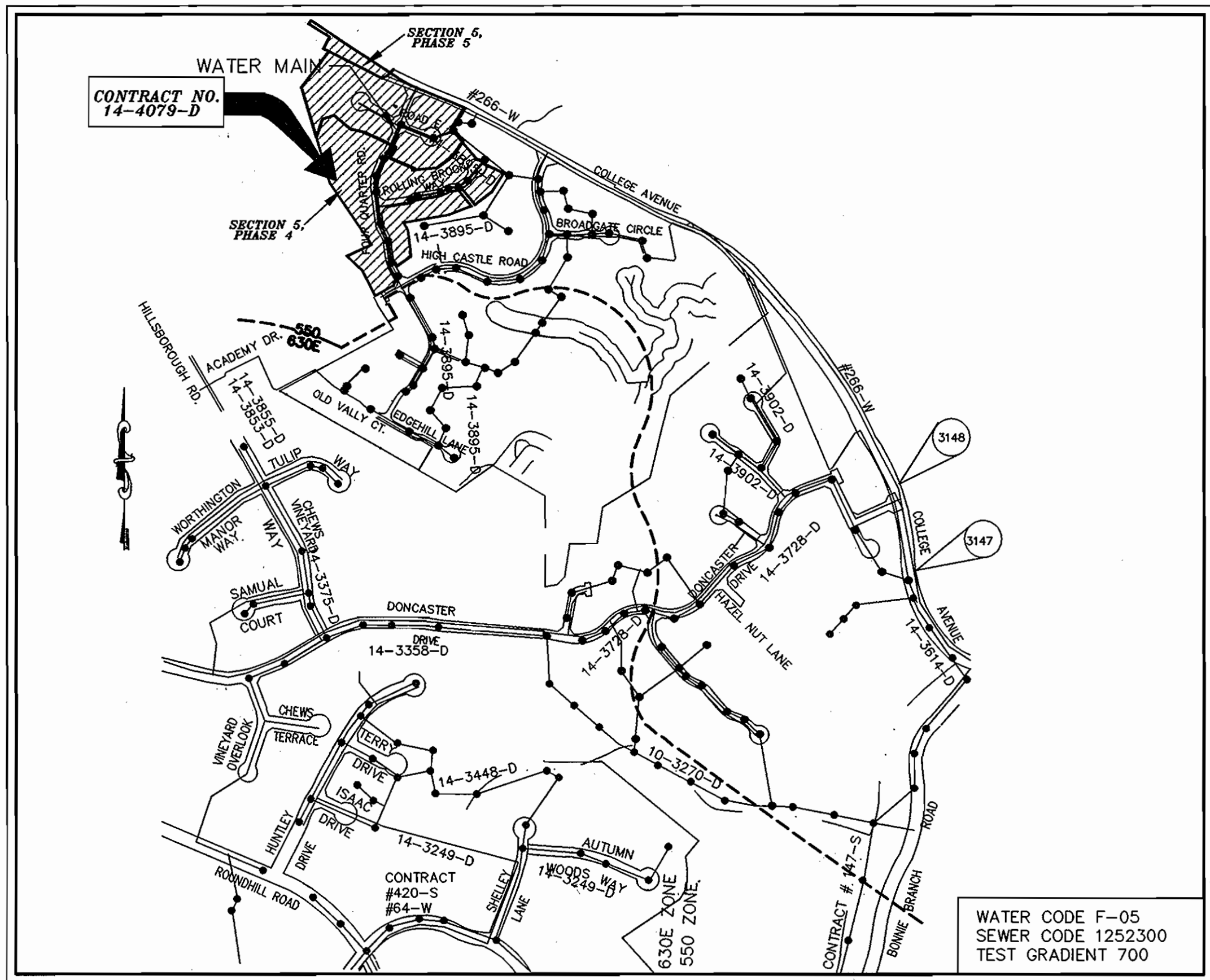

VICINITY MAP
 SCALE: 1"=600'

TYPE OF BUILDING	SFA
No. of SFA UNITS	22
TYPE OF BUILDING	SFD
No. of SFD UNITS	21
No. of FUTURE SFD UNITS (380-396)	17
No. of WATER HOUSE CONNECTION	38
No. of SEWER HOUSE CONNECTIONS	39
No. of FUTURE WATER HOUSE CONNECTION	17
No. of FUTURE SEWER HOUSE CONNECTIONS	17
No. of EXISTING WATER HOUSE CONNECTIONS	5
No. of EXISTING SEWER HOUSE CONNECTIONS	4
DRAINAGE AREA	PATAPSCO
TREATMENT PLANT	PATAPSCO WASTEWATER TREATMENT PLANT VIA COLLEGE AVENUE WASTE WATER PUMPING STATION

EXISTING WATER AND SEWER HOUSE CONNECTIONS ARE UNDER CONTRACT # 14-3895-D
 FUTURE WATER AND SEWER HOUSE CONNECTIONS ARE UNDER CONTRACT # 14-4079-D

EROSION AND SEDIMENT CONTROL FOR THIS CONTRACT IS PROVIDED UNDER F-03-08, F-03-208

GENERAL NOTES

- APPROXIMATE LOCATION OF EXISTING MAINS ARE SHOWN. THE CONTRACTOR SHALL TAKE ALL NECESSARY PRECAUTIONS TO PROTECT EXISTING MAINS AND SERVICES AND MAINTAIN UNINTERRUPTED SUPPLY. ANY DAMAGE INCURRED SHALL BE REPAIRED IMMEDIATELY TO THE SATISFACTION OF THE ENGINEER AT THE CONTRACTOR'S EXPENSE.
- ALL HORIZONTAL CONTROLS ARE BASED ON MARYLAND STATE COORDINATES.
- ALL VERTICAL CONTROLS ARE BASED ON U.S.G.S. DATA.
- COORDINATES BASED ON NAD'83 MARYLAND COORDINATE SYSTEM AS PROJECTED BY HOWARD COUNTY GEODETIC CONTROL STATIONS NO. 3147 AND 3148.
 STA. 3147 N575598.0794, E137581.7684 EL.335.987
 STA. 3148 N576015.4313, E1375770.4364 EL.379.248
- ALL PIPE ELEVATIONS SHOWN ARE INVERT ELEVATIONS.
- CLEAR ALL UTILITIES BY A MINIMUM OF 1'. CLEAR ALL POLES BY 2'-0" MINIMUM OR TUNNEL AS REQUIRED. THE OWNER HAS CONTACTED THE UTILITY COMPANIES AND HAS MADE ARRANGEMENTS FOR BRACING OF POLES AS SHOWN ON THE DRAWINGS. IN THE EVENT THE CONTRACTOR'S WORK REQUIRES THE BRACING OF ADDITIONAL POLES, ANY COST INCURRED BY THE OWNER FOR BRACING OF ADDITIONAL POLES OR DAMAGES SHALL BE DEDUCTED FROM MONEY OWED THE CONTRACTOR. THE CONTRACTOR SHALL COORDINATE WITH THE UTILITY COMPANIES TO SCHEDULE THE BRACING OF THE POLES.
- FOR DETAILS NOT SHOWN ON THE DRAWINGS, AND FOR MATERIALS AND CONSTRUCTION METHODS USE HOWARD COUNTY DESIGN MANUAL, VOLUME IV, STANDARD SPECIFICATIONS AND DETAILS FOR CONSTRUCTION (LATEST EDITION). THE CONTRACTOR SHALL HAVE A COPY OF VOLUME IV ON THE JOB.
- WHERE TEST PITS HAVE BEEN MADE ON EXISTING UTILITIES, THEY ARE NOTED BY THE SYMBOL [] AT THE LOCATION OF THE TEST PIT. A NOTE OR NOTES CONTAINING THE RESULTS OF THE TEST PIT OR PITS IS INCLUDED ON THE DRAWINGS. EXISTING UTILITIES IN THE VICINITY OF THE PROPOSED WORK FOR WHICH TEST PITS HAVE NOT BEEN DUG SHALL BE LOCATED BY THE CONTRACTOR TWO WEEKS IN ADVANCE OF CONSTRUCTION OPERATIONS AT HIS OWN EXPENSE.
- CONTRACTOR SHALL NOTIFY THE FOLLOWING UTILITY COMPANIES OR AGENCIES AT LEAST FIVE WORKING DAYS BEFORE STARTING WORK SHOWN ON THESE PLANS:
 STATE HIGHWAY ADMINISTRATION (410) 531-5533
 BG & E CO. CONTRACTOR SERVICES (410) 850-4620
 BG & E CO. UNDERGROUND DAMAGE CONTROL (410) 787-9688
 MISS UTILITY 1-800-257-7777
 COLONIAL PIPELINE CO. (410) 795-1390
 HOWARD COUNTY DEPARTMENT OF PUBLIC WORKS (410) 313-4900
 BUREAU OF UTILITIES
- TREES AND SHRUBS ARE TO BE PROTECTED FROM DAMAGE TO THE MAXIMUM EXTENT. TREES AND SHRUBS LOCATED OUTSIDE THE CONSTRUCTION STRIP ARE NOT TO BE REMOVED OR DAMAGED BY THE CONTRACTOR.
- CONTRACTOR SHALL REMOVE TREES, STUMPS AND ROOTS ALONG LINE OF EXCAVATION. PAYMENT FOR SUCH REMOVAL SHALL BE INCLUDED IN THE UNIT PRICE BID FOR CONSTRUCTION OF THE MAIN.
- THE CONTRACTOR SHALL NOTIFY THE BUREAU OF HIGHWAYS, HOWARD COUNTY, AT (410)313-2450 AT LEAST FIVE (5) WORKING DAYS BEFORE ANY OPEN CUT OF ANY COUNTY ROAD OR BORING/JACKING OPERATION IN COUNTY ROADS FOR LAYING WATER/SEWER MAINS OR HOUSE CONNECTIONS. THE APPROVAL OF THESE DRAWINGS WILL CONSTITUTE COMPLIANCE WITH DPW REQUIREMENTS PER SECTION 18.114(a) OF HOWARD COUNTY CODE.
- ALL WATER MAINS TO BE D.I.P. CLASS 52 UNLESS OTHERWISE NOTED.
- TOPS OF ALL WATER MAINS TO HAVE A MINIMUM OF 3'-1/2" COVER UNLESS OTHERWISE NOTED.
- VALVES ADJACENT TO TEES SHALL BE STRAPPED TO TEES.
- ALL FITTINGS SHALL BE BUTTRESSED OR ANCHORED WITH CONCRETE IN ACCORDANCE WITH THE STANDARD DETAILS UNLESS OTHERWISE PROVIDED FOR ON THE DRAWINGS.
- FIRE HYDRANTS SHALL BE SET TO THE BURY LINE ELEVATIONS SHOWN ON THE DRAWINGS. ALL FIRE HYDRANTS SHALL BE STRAPPED AND BUTTRESSED WITH CONCRETE IN ACCORDANCE WITH STANDARD DETAILS. SOIL AROUND THE FIRE HYDRANT SHALL BE COMPACTED IN ACCORDANCE WITH SECTION 1000 AND 1005 OF THE STANDARD SPECIFICATIONS.
- THE CONTRACTOR SHALL NOT OPERATE ANY WATER MAIN VALVES ON THE EXISTING WATER SYSTEM.
- ALL WATER HOUSE CONNECTIONS SHALL BE FOR INSIDE METER SETTING UNLESS OTHERWISE NOTED ON PLANS OR IN SPECIFICATIONS.
- SPRINKLER SYSTEMS FOR ALL TOWNHOMES OR MULTI-FAMILY DWELLING UNITS SHOULD HAVE A MINIMUM OF 1" CONNECTION WITH A 3/4" METER.
- ALL SEWER MAINS SHALL BE P.V.C. OR D.I.P. CLASS 52 UNLESS OTHERWISE NOTED.
- ALL MANHOLES SHALL BE 4'-0" INSIDE DIAMETER UNLESS OTHERWISE NOTED.
- MANHOLES DESIGNATED W.T. IN PLAN AND PROFILE SHALL HAVE WATERTIGHT FRAME AND COVERS, STANDARD DETAIL G5.52. WHERE WATERTIGHT MANHOLE FRAME AND COVER IS USED, SET TOP OF FRAME 1" - 6" ABOVE FINISHED GRADE UNLESS OTHERWISE NOTED ON THE DRAWINGS.
- HOUSE(S) WITH THE SYMBOL "C.N.S." INDICATES THAT CELLAR CANNOT BE SERVED.
- STATIONING SHOWN IS WATER MAIN AND CENTER LINE STATIONING.
- CONTRACTOR TO VERIFY THE LOCATION OF ALL EXISTING UTILITIES PRIOR TO COMMENCING CONSTRUCTION.
- SEDIMENT CONTROL TO BE PROVIDED BY F-03-08.
- ALL SEWER HOUSE CONNECTIONS TO BE 4" IN SIZE.
- ALL WATER HOUSE CONNECTIONS TO BE 1" IN SIZE UNLESS OTHERWISE NOTED.
- ALL HOUSES WILL HAVE SERVICE TO LOWEST FLOOR UNLESS OTHERWISE NOTED.
- STORM DRAIN SYSTEM INDICATED FOR INFORMATIONAL PURPOSES ONLY, SEE ROAD PLANS FOR CONSTRUCTION DATA.
- COMPACTION IN FILL AREAS TO BE 95% AS DETERMINED PER AASHTO T-180.

INDEX OF DRAWINGS

NO.	DESCRIPTION
1	TITLE SHEET
2	WATER AND SEWER PLAN
3	WATER PROFILES
4	WATER PROFILES
5	SEWER PROFILES
6	SEWER PROFILES

NOTE: SEE SHEET 3 OF 6 FOR ASBUILT FIELD MEASUREMENTS.

CONTRACT NO.: 14-4079-D
AUTUMN VIEW, SECTION 5, PHASE 4, LOTS 336-379,
FOUR QUARTER ROAD AND ROLLING BROOK WAY AND
AUTUMN VIEW, SECTION 5 PHASE 5, FUTURE LOTS 380-397 (18 LOTS),
SONG SMITH LANE AND SEAWARD CIRCLE
WATER AND SEWER MAIN EXTENSIONS
HOWARD COUNTY, MARYLAND
DEPARTMENT OF PUBLIC WORKS

PLAN REFERENCE NUMBERS
 F-03-08 - F-03-208

I/WE CERTIFY THAT ALL DEVELOPMENT AND CONSTRUCTION WILL BE DONE ACCORDING TO THIS PLAN, AND THAT ANY RESPONSIBLE PERSONNEL INVOLVED IN THE CONSTRUCTION PROJECT WILL HAVE A CERTIFICATE OF ATTENDANCE AT A DEPARTMENT OF THE ENVIRONMENT APPROVED TRAINING PROGRAM FOR THE CONTROL OF SEDIMENT AND EROSION BEFORE BEGINNING THE PROJECT. I ALSO AUTHORIZE PERIODIC ON-SITE INSPECTION BY THE HOWARD SOIL CONSERVATION DISTRICT.

David R. Reiker 8/19/03
 DEVELOPER'S SIGNATURE DATE
 DAVID R. REIKER
 DEVELOPER'S NAME

I HEREBY CERTIFY THAT THIS PLAN FOR EROSION AND SEDIMENT CONTROL REPRESENTS A PRACTICAL AND WORKABLE PLAN BASED ON MY PERSONAL KNOWLEDGE OF THE SITE CONDITIONS AND THAT IT WAS PREPARED IN ACCORDANCE WITH THE REQUIREMENTS OF THE HOWARD SOIL CONSERVATION DISTRICT.

R. Jacob Hikmat 7/21/03
 ENGINEER'S SIGNATURE DATE
 R. JACOB HIKMAT
 ENGINEER'S NAME

REVIEWED FOR HOWARD SCD AND MEETS TECHNICAL REQUIREMENTS.

Jim Moran 8/4/03
 USFWS/NRCS/CONSERVATION SERVICE DATE

THIS DEVELOPMENT PLAN IS APPROVED FOR SOIL EROSION AND SEDIMENT CONTROL BY THE SOIL CONSERVATION DISTRICT.

John C. Reuter 8/4/03
 HOWARD SCD DATE

DEPARTMENT OF PUBLIC WORKS
 HOWARD COUNTY, MARYLAND

John C. Reuter 7-29-03
 CHIEF, BUREAU OF UTILITIES DATE

DEPARTMENT OF PLANNING & ZONING
 HOWARD COUNTY, MARYLAND

John C. Reuter 8/15/03
 CHIEF, DEVELOPMENT ENGINEERING DIVISION DATE

MILDENBERG, BOENDER & ASSOC., INC.
 Engineers Planners Surveyors
 5072 Dorsey Hall Drive, Suite 202, Ellicott City, Maryland 21042
 (410) 997-0286 Ball. (301) 621-6521 Wash. (410) 997-0286 Fax.



engineering	HSP				
illustration	HSP				
approval	RJH				
project	01046	KCI	I	ASBUILT DATA	10/03/03
date	JULY 2003	BY	NO.	REVISION	DATE

TITLE SHEET

600' SCALE MAP NO. 25 BLOCK NO. 22

AUTUMN VIEW, SECTION 5, PHASE 4, LOTS 336-379,
FOUR QUARTER ROAD AND ROLLING BROOK WAY AND
AUTUMN VIEW, SECTION 5 PHASE 5, FUTURE LOTS 380-397 (18 LOTS),
SONG SMITH LANE AND SEAWARD CIRCLE

scale AS SHOWN

CONTRACT NO.: 14-4079-D
 SECOND ELECTION DISTRICT
 HOWARD COUNTY

1 OF 6



SEWER HOUSE CONNECTION TABLE

LOT #	% SLOPE	INVERT @ EASE	MIN. CELLAR ELEV.
336**	2	437.16	441.00
337**	2	436.15	438.89
338**	2	435.41	439.24
339**	2	435.95	438.73
340	2	427.81	431.90
409	2	427.16	431.28
410	2	406.25	404.52
411	2	401.75	401.75
344	2	399.50	403.50
345	2	398.21	402.23
346	2	396.29	400.33
347	2	395.15	399.21
348	2	392.72	396.77
349	2	390.91	395.00
350	2	389.20	393.30
351	2	386.85	390.86
352	2	385.46	389.49
353	2	383.29	387.34
354	2	382.02	386.08
355	2	380.81	384.87
356	2	379.10	383.26
357	2	376.75	380.89
358	2	382.45	387.21
359	2	388.13	392.96
360	1	396.48	400.15
361	2	391.03	395.86
362	2	385.83	390.64
363	2	382.74	387.53
364	2	376.66	381.28
365	2	371.09	375.87
366	2	362.73	367.44
367	2	362.03	366.81
368	2	362.77	367.71
369	2	371.18	376.11
370	2	375.90	380.90
371	2	380.45	385.37
372	2	384.91	389.75
373	2	389.27	394.21
374	2	393.37	398.20
375	2	407.27	412.21
376	2	414.49	419.29
377	2	419.44	424.19
378	2	425.20	429.95
380	1	373.13	376.73
381	2	370.57	373.88
382	2	370.23	373.45
383	1	370.53	373.65
384	1	371.46	374.86
385	1	371.45	374.78
386	1	370.50	373.59
387	2	370.42	373.49
388	2	370.67	373.79
389	2	367.31	370.42
390	2	364.91	369.98
391*	2	369.80	372.50
392*	2	368.39	371.50
393	2	363.74	368.49
394	2	365.13	370.24
395*	2	373.54	376.50
396	2	377.00	381.80

* DENOTES DROP SEWER HOUSE CONNECTION
 ** DENOTES EXISTING SEWER HOUSE CONNECTION

MANHOLE LOCATION CHART

SMH#	ROAD NAME	C STATION (NORTHING)	OFFSET (EASTING)
401	SEWARD CIRCLE	N 577998.530	E 1373242.607
402	FOUR QUARTER ROAD	9+38.70	2.0' RT.
403	FOUR QUARTER ROAD	7+65.30	4.5' RT.
404	FOUR QUARTER ROAD	7+28.25	2.0' RT.
405	FOUR QUARTER ROAD	6+24.07	0.3' LT.
406	FOUR QUARTER ROAD	5+37.28	2.0' RT.
407	FOUR QUARTER ROAD	3+65.21	2.0' RT.
408	FOUR QUARTER ROAD	2+59.19	2.0' RT.
409	ROLLING BROOK WAY	5+17.88	0.0'
410	ROLLING BROOK WAY	4+56.37	0.8' LT.
411	ROLLING BROOK WAY	3+99.30	4.0' LT.
412	ROLLING BROOK WAY	3+52.67	3.9' LT.
413	ROLLING BROOK WAY	2+22.67	4.0' LT.
414	ROLLING BROOK WAY	1+84.34	5.6' LT.
415	SONGSMTIH LANE	N 578196.577	E 1372844.646

(S) DENOTES STORMDRAIN STRUCTURE
 [22.38] DENOTES FRONTAGE
 (MH) DENOTES SEWER MANHOLE

8" WATER MAIN TABULATION CHART
 ROLLING BROOK WAY

ROAD @ STATION	APPURTENANCE	O/S FROM ROAD @
0+44.98	8" X 6" F.H.T. & V.	6.01' RT.
0+44.98	F.H.	20.0' RT.
1+70.45	1/32" H.B.	6.01' RT.
2+22.83	1/32" H.B.	6.01' RT.
3+54.75	1/32" H.B.	6.75' RT.
3+97.53	1/32" H.B.	6.00' RT.
4+56.59	1/16" H.B.	9.26' RT.
5+17.57	1/32" H.B.	10.09' RT.
5+30.56	8" X 6" F.H.T. & V.	9.10' RT.
5+30.56	F.H.	20.0' RT.
8" CAP & BUTRESS		N 577831.147 E 1373495.921

8" WATER MAIN TABULATION CHART
 FOUR QUARTER ROAD

ROAD @ STATION	APPURTENANCE	O/S FROM ROAD @
1+44.26	1/16" H.B.	11.63' LT.
2+59.33	1/32" H.B.	8.00' LT.
3+63.91	1/32" H.B.	8.00' LT.
4+59.40	8" X 8" T	8.00' LT.
4+59.40	B" V	2.50' LT.
4+64.90	B" V	8.00' LT.
7+28.25	1/16" H.B.	8.00' LT.
7+61.96	1/16" H.B.	4.9' LT.
7+92.32	8" X 6" F.H.T. & V.	8.00' LT.
7+92.32	F.H.	23.0' LT.
9+28.69	B" V	13.51' LT.
9+28.69	8" X 8" CROSS	8.00' LT.
9+28.69	B" V	2.50' LT.
12" X 8" TAP SLEEVE & VALVE		N 578176.077 E 1373149.596

8" WATER MAIN TABULATION CHART
 SONGSMITH LANE

ROAD @ STATION	APPURTENANCE	O/S FROM ROAD @
0+68.09	1/16" H.B.	8.16' LT.
0+97.17	1/32" H.B.	9.72' LT.
2+37.20	F.H.T. & V.	8.27' LT.
2+37.20	F.H.	47.73' LT.
8" CAP & BUTRESS		N 578187.856 E 1372839.750

8" WATER MAIN TABULATION CHART
 SEWARD CIRCLE

ROAD @ STATION	APPURTENANCE	O/S FROM ROAD @
1+72.33	F.H.T. & V.	6.66' RT.
1+72.33	F.H.	46.38' RT.
8" CAP & BUTRESS		N 577986.738 E 1373244.915

DEPARTMENT OF PUBLIC WORKS
 HOWARD COUNTY, MARYLAND
 R. J. B... 7-29-03
 CHIEF, BUREAU OF UTILITIES

DEPARTMENT OF PLANNING & ZONING
 HOWARD COUNTY, MARYLAND
 ... 8/25/03
 CHIEF, DEVELOPMENT ENGINEERING DIVISION

MILDENBERG, BOENDER & ASSOC., INC.
 Engineers Planners Surveyors
 5072 Dorsey Hall Drive, Suite 202, Ellicott City, Maryland 21042
 (410) 997-0286 Bolk. (301) 621-5521 Wash. (410) 997-0288 Fax



engineering HSP
 illustration HSP
 approval RJH
 project 01046
 date JULY 2003
 ASBUILT DATA SHOWN
 REVISED LOT LAYOUT, ADDED V&V & S&C FOR LOT 410
 10/11/03
 8/19/06
 600' SCALE MAP NO. 25 BLOCK NO. 22

WATER AND SEWER PLAN

AUTUMN VIEW, SECTION 5, PHASE 4, LOTS 336-378,
 FOUR QUARTER ROAD AND ROLLING BROOK WAY AND
 AUTUMN VIEW, SECTION 5, PHASE 5, FUTURE LOTS 380-397 (18 LOTS),
 SONG SMITH LANE AND SEWARD CIRCLE
 CONTRACT NO.: 14-4079-D
 SECOND ELECTION DISTRICT
 HOWARD COUNTY

scale
 1" = 50'
 2 OF 6

WATER AND SEWER ASBUILT DATA

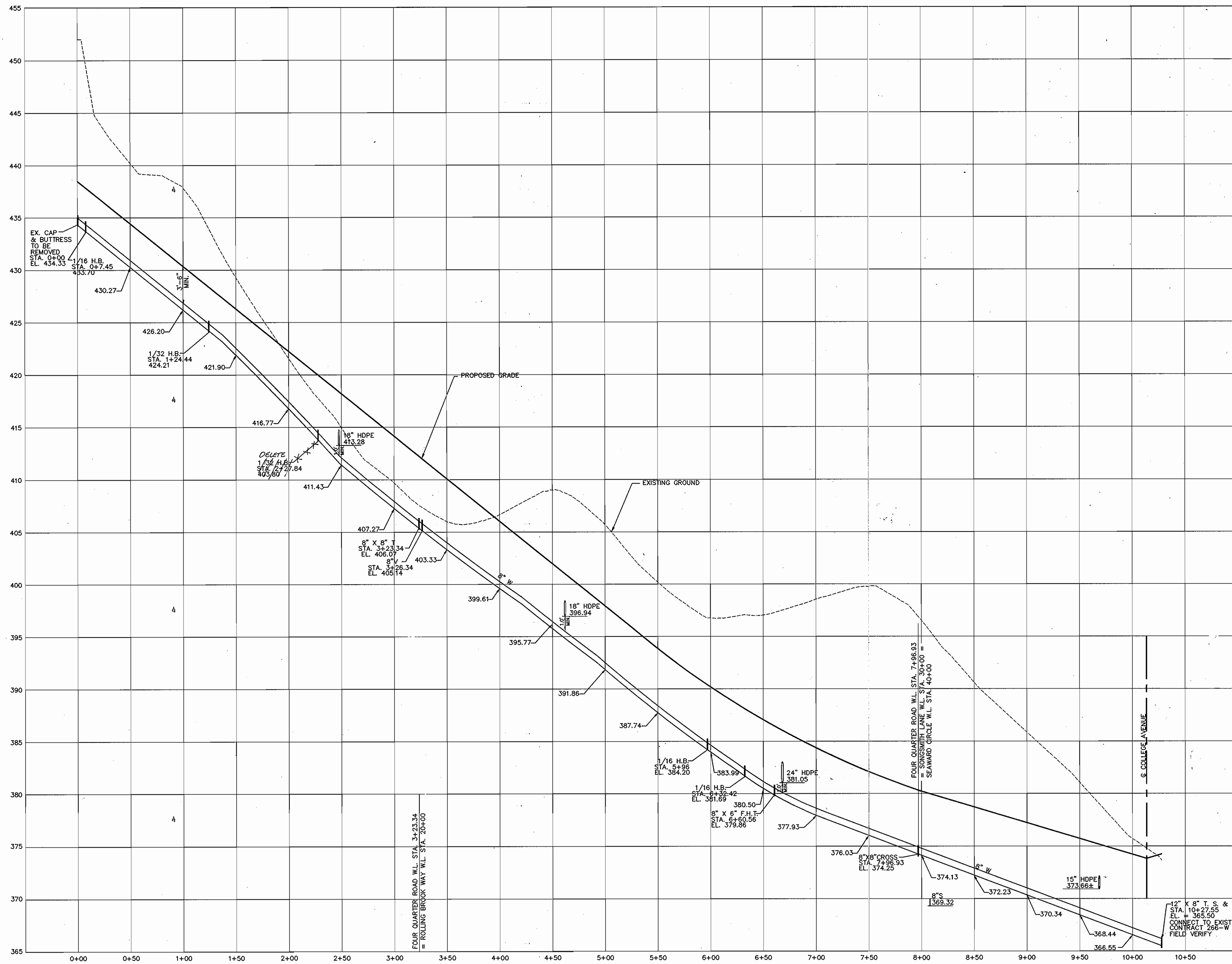

FROM	TO	LOT #	FEET	FROM	TO	LOT #	FEET
MH 29	341	~	F.H.	5H.C.	387	178	
341	378	~	MH 402	~	390	34.2	
378	377	~	MH 402	~	390	34.2	
MH 402	377	315	~	~	390	19.7	
377	378	~	~	~	390	34.2	
378	379	~	~	~	390	34.2	
379	380	~	~	~	390	34.2	
380	381	~	~	~	390	34.2	
381	382	~	~	~	390	34.2	
382	383	~	~	~	390	34.2	
383	384	~	~	~	390	34.2	
384	385	~	~	~	390	34.2	
385	386	~	~	~	390	34.2	
386	387	~	~	~	390	34.2	
387	388	~	~	~	390	34.2	
388	389	~	~	~	390	34.2	
389	390	~	~	~	390	34.2	
390	391	~	~	~	390	34.2	
391	392	~	~	~	390	34.2	
392	393	~	~	~	390	34.2	
393	394	~	~	~	390	34.2	
394	395	~	~	~	390	34.2	
395	396	~	~	~	390	34.2	
396	397	~	~	~	390	34.2	
397	398	~	~	~	390	34.2	
398	399	~	~	~	390	34.2	
399	400	~	~	~	390	34.2	
400	401	~	~	~	390	34.2	
401	402	~	~	~	390	34.2	
402	403	~	~	~	390	34.2	
403	404	~	~	~	390	34.2	
404	405	~	~	~	390	34.2	
405	406	~	~	~	390	34.2	
406	407	~	~	~	390	34.2	
407	408	~	~	~	390	34.2	
408	409	~	~	~	390	34.2	
409	410	~	~	~	390	34.2	
410	411	~	~	~	390	34.2	
411	412	~	~	~	390	34.2	
412	413	~	~	~	390	34.2	
413	414	~	~	~	390	34.2	
414	415	~	~	~	390	34.2	
415	416	~	~	~	390	34.2	
416	417	~	~	~	390	34.2	
417	418	~	~	~	390	34.2	
418	419	~	~	~	390	34.2	
419	420	~	~	~	390	34.2	
420	421	~	~	~	390	34.2	
421	422	~	~	~	390	34.2	
422	423	~	~	~	390	34.2	
423	424	~	~	~	390	34.2	
424	425	~	~	~	390	34.2	
425	426	~	~	~	390	34.2	
426	427	~	~	~	390	34.2	
427	428	~	~	~	390	34.2	
428	429	~	~	~	390	34.2	
429	430	~	~	~	390	34.2	
430	431	~	~	~	390	34.2	
431	432	~	~	~	390	34.2	
432	433	~	~	~	390	34.2	
433	434	~	~	~	390	34.2	
434	435	~	~	~	390	34.2	
435	436	~	~	~	390	34.2	
436	437	~	~	~	390	34.2	
437	438	~	~	~	390	34.2	
438	439	~	~	~	390	34.2	
439	440	~	~	~	390	34.2	
440	441	~	~	~	390	34.2	
441	442	~	~	~	390	34.2	
442	443	~	~	~	390	34.2	
443	444	~	~	~	390	34.2	
444	445	~	~	~	390	34.2	
445	446	~	~	~	390	34.2	
446	447	~	~	~	390	34.2	
447	448	~	~	~	390	34.2	
448	449	~	~	~	390	34.2	
449	450	~	~	~	390	34.2	
450	451	~	~	~	390	34.2	
451	452	~	~	~	390	34.2	
452	453	~	~	~	390	34.2	
453	454	~	~	~	390	34.2	
454	455	~	~	~	390	34.2	

WATER MAIN PROFILE- FOUR QUARTER ROAD

SCALE: HOR. 1"=50'
VER. 1"=5'

D:\046\DWG\FINAL\WKS\701046-FINAL-WATER PROFILE 4DR.DWG

DEPARTMENT OF PUBLIC WORKS
HOWARD COUNTY, MARYLAND

John B. Quinn
7-29-03
DATE

DEPARTMENT OF PLANNING & ZONING
HOWARD COUNTY, MARYLAND

Robert J. Quinn
8/15/03
DATE

MILDENBERG, BOENDER & ASSOC., INC.
Engineers Planners Surveyors
5072 Dorsey Hall Drive, Suite 202, Ellicott City, Maryland 21042
(410) 997-0296 Fax (301) 621-5521 Wash. (410) 997-0298 Fax



engineering	HSP				
illustration	HSP				
approval	RJH				
project	01046	W.C.1	ASBUILT DATA SHOW	12/1/02	
date	JULY 2003	BY	NO.	REVISION	DATE

WATER PROFILES

600' SCALE MAP NO. 25 BLOCK NO. 22

**AUTUMN VIEW, SECTION 5, PHASE 4, LOTS 336-379,
FOUR QUARTER ROAD AND ROLLING BROOK WAY AND
AUTUMN VIEW, SECTION 5 PHASE 5, FUTURE LOTS 380-397 (18 LOTS)
SONG SMITH LANE AND SEAWARD CIRCLE**

CONTRACT NO.: 14-4079-D
SECOND ELECTION DISTRICT
HOWARD COUNTY

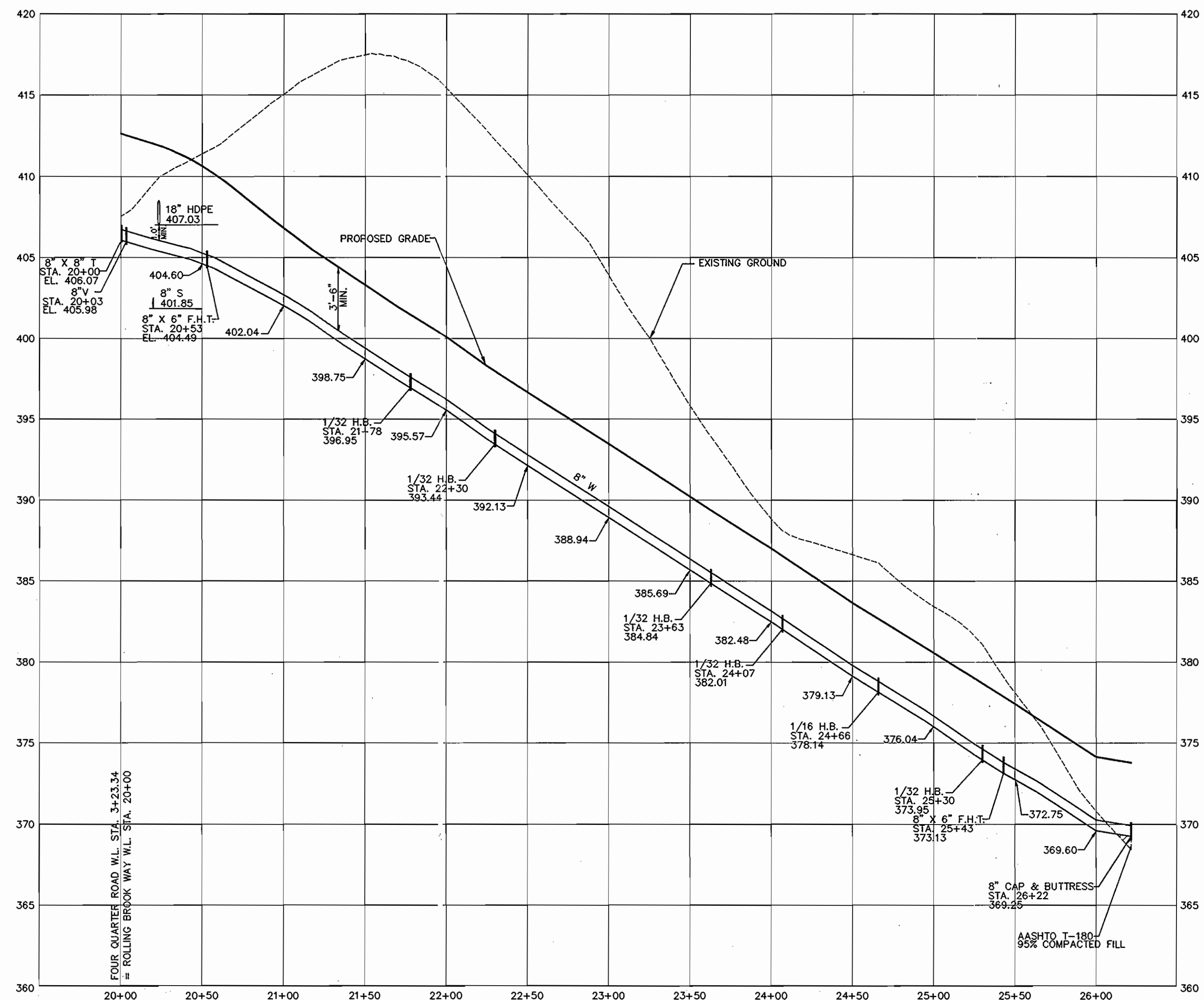

WATER MAIN PROFILE- ROLLING BROOK WAY

SCALE: HOR. 1"=50'
VER. 1"=5'

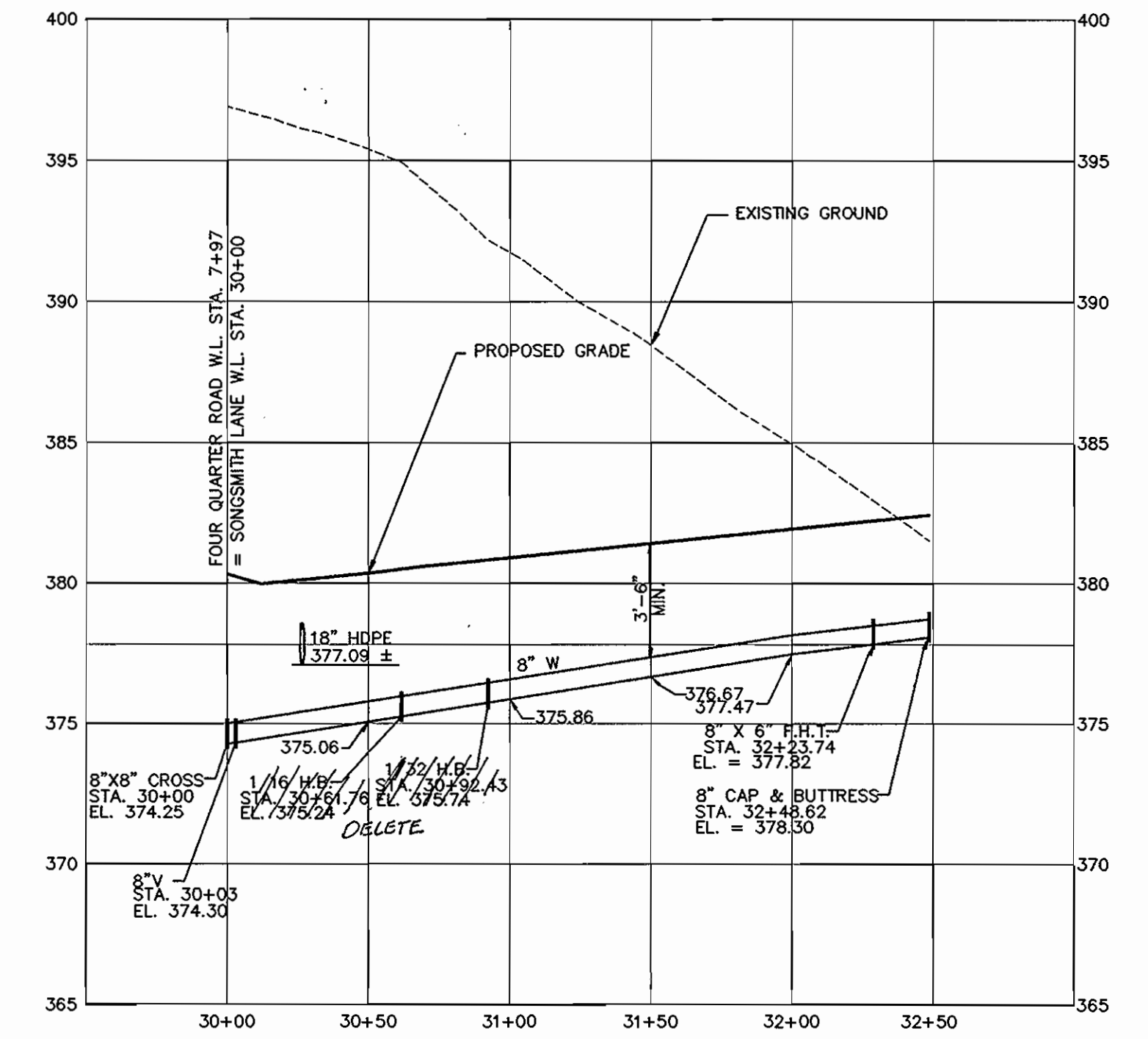

WATER MAIN PROFILE- SONGSMITH LANE

SCALE: HOR. 1"=50'
VER. 1"=5'

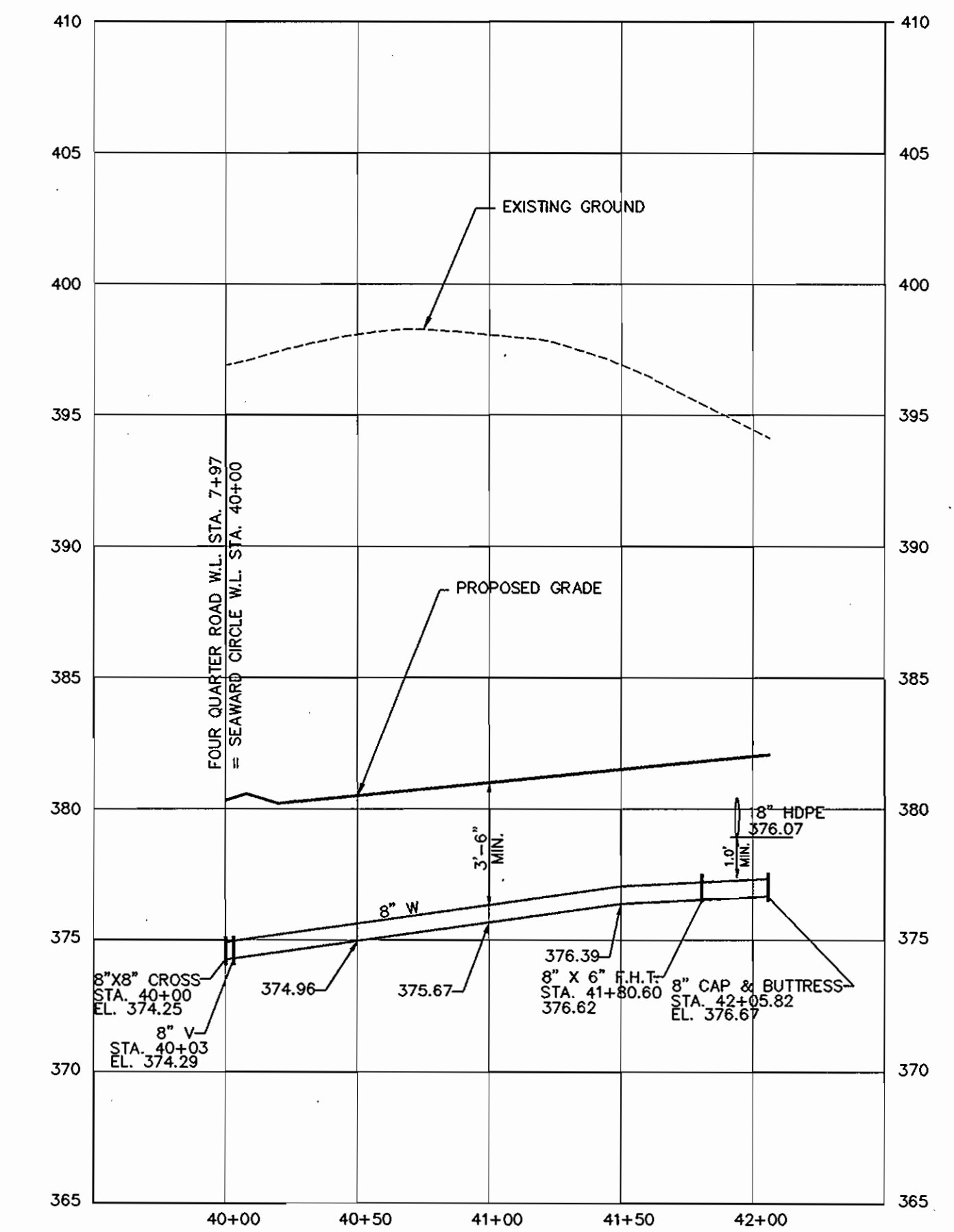

WATER MAIN PROFILE- SEAWARD CIRCLE

SCALE: HOR. 1"=50'
VER. 1"=5'

01046 (LONG) FINAL W&S 01046-FINAL-WATER PROFILE RBW/DWG

DEPARTMENT OF PUBLIC WORKS
HOWARD COUNTY, MARYLAND

DEPARTMENT OF PLANNING & ZONING
HOWARD COUNTY, MARYLAND

**MILDENBERG,
BOENDER & ASSOC., INC.**
Engineers Planners Surveyors

5072 Dorsey Hall Drive, Suite 202, Elkton City, Maryland 21042
(410) 897-0286 Ball. (301) 621-5321 Wash. (410) 897-0288 Fax

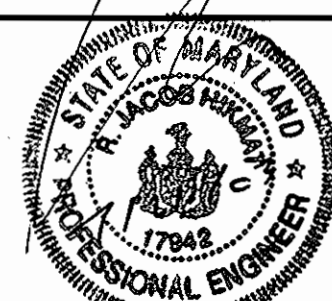

engineering	HSP				
illustration	HSP				
approval	RJH				
project	01046	KCI	1	ASBUILT DATA	10/10/03
date	JULY 2003	BY	NO.	REVISION	DATE

WATER PROFILES

**AUTUMN VIEW, SECTION 5, PHASE 4, LOTS 336-378,
FOUR QUARTER ROAD AND ROLLING BROOK WAY AND
AUTUMN VIEW, SECTION 5 PHASE 5, FUTURE LOTS 380-397 (18 LOTS)
SONG SMITH LANE AND SEAWARD CIRCLE**
CONTRACT NO.: 14-4079-D
SECOND ELECTION DISTRICT
HOWARD COUNTY

scale
AS SHOWN

4 OF 6

Randy Bunker 7-29-03
CHIEF, BUREAU OF UTILITIES DATE

Rob Danzani 8/1/03
CHIEF, DEVELOPMENT ENGINEERING DIVISION DATE

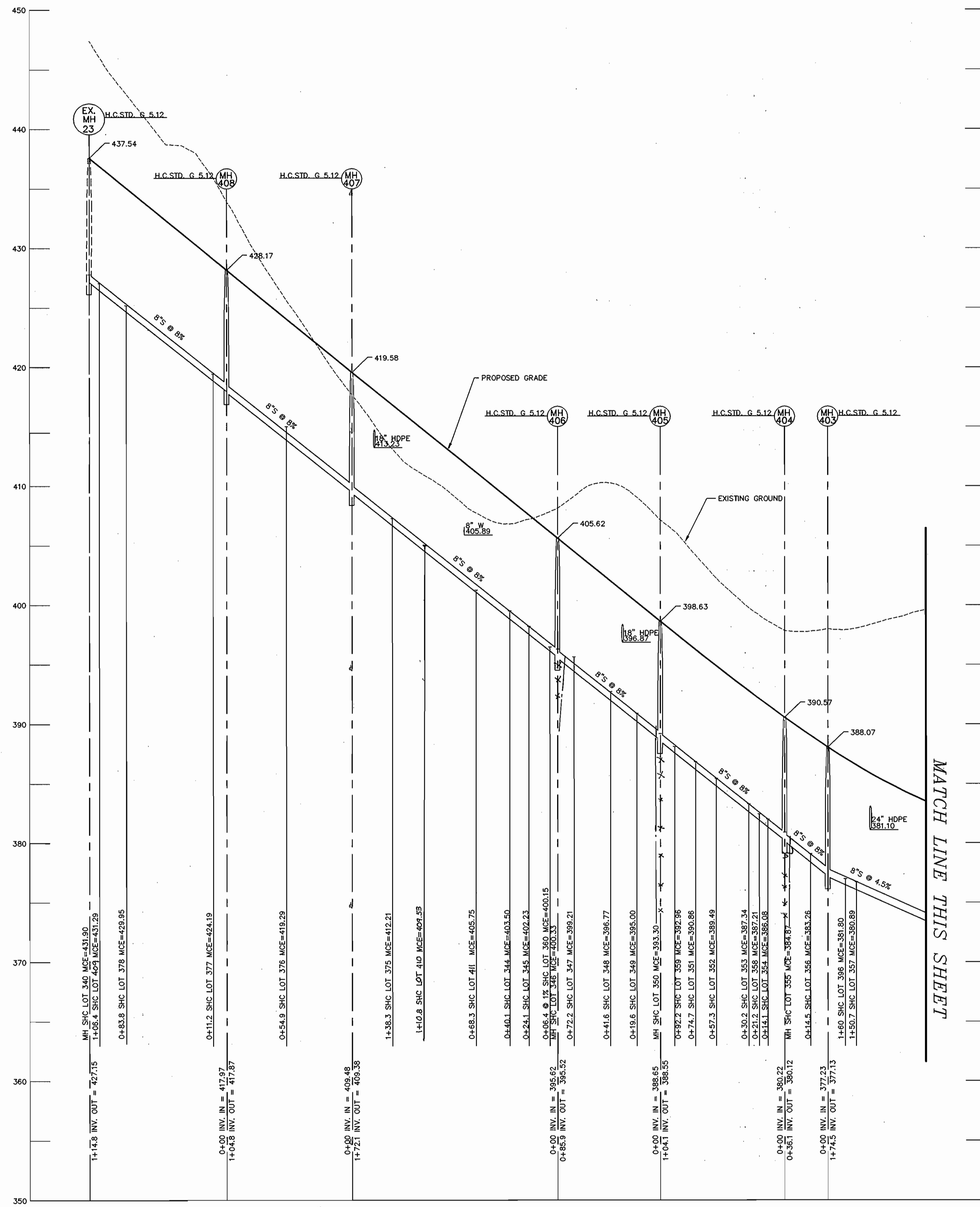

8" SEWER MAIN - FOUR QUARTER ROAD

SCALE: HOR. 1"=50'
VER. 1"=5'

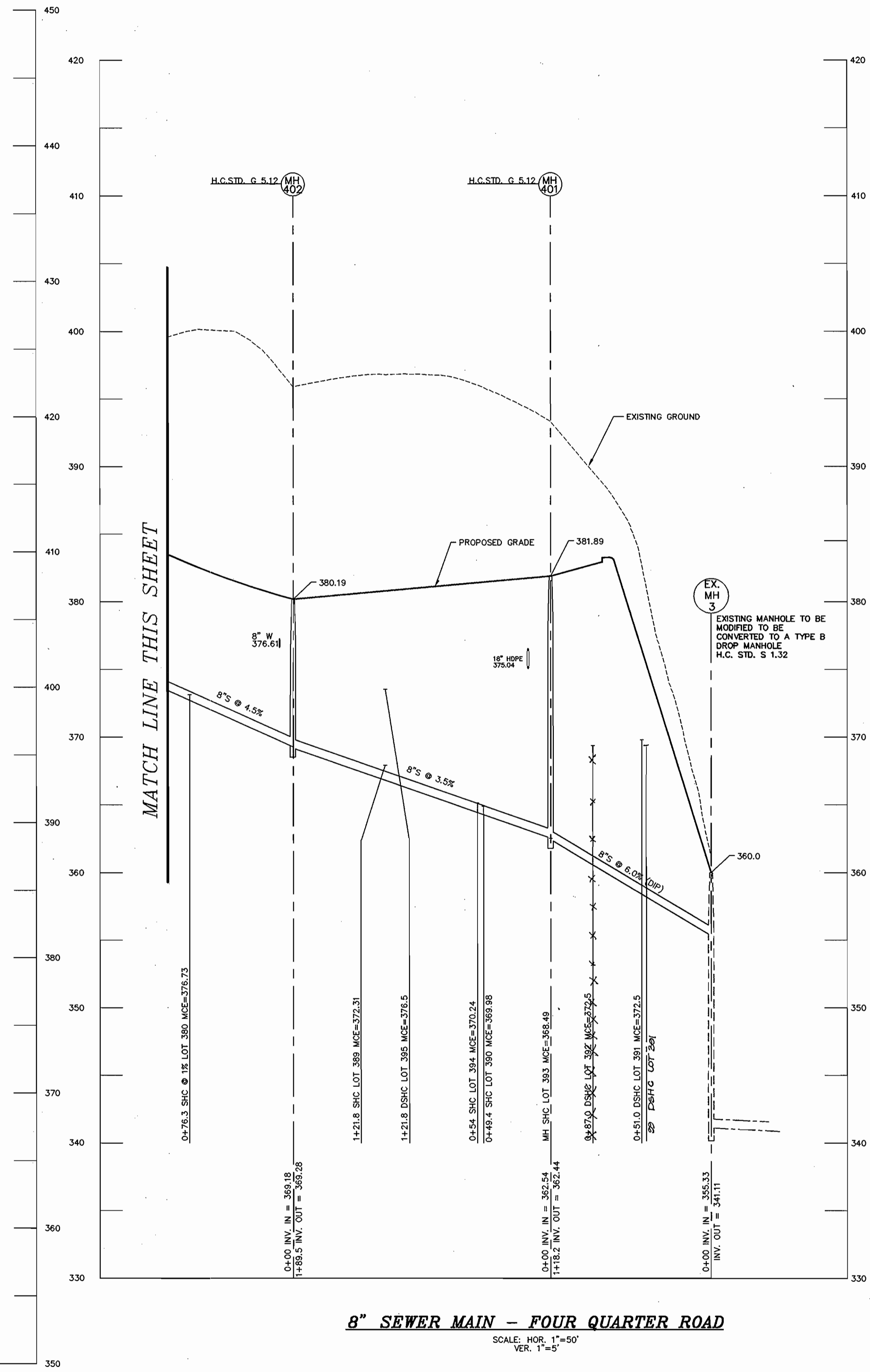

8" SEWER MAIN - FOUR QUARTER ROAD

SCALE: HOR. 1"=50'
VER. 1"=5'

D:\046\DWG\FINAL\WKS\01046-FINAL-SEWER PROFILE 48R.DWG

DEPARTMENT OF PUBLIC WORKS
HOWARD COUNTY, MARYLAND

DEPARTMENT OF PLANNING & ZONING
HOWARD COUNTY, MARYLAND

**MILDENBERG,
BOENDER & ASSOC., INC.**
Engineers Planners Surveyors

5072 Dorsey Hall Drive, Suite 202, Ellicott City, Maryland 21042
(410) 997-0298 Fax (301) 821-5521 Wash. (410) 997-0298 Fax

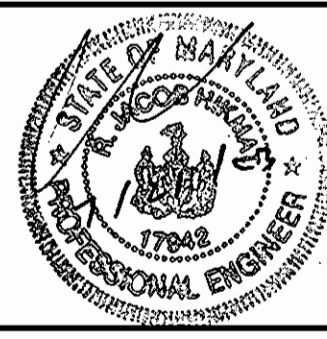

engineering	HSP				
illustration	HSP				
approval	RHB				
project	01046				
date	JULY 2003				
BY	NO.				
REVISION					
DATE					

SEWER PROFILES

600' SCALE MAP NO. 25 BLOCK NO. 22

AUTUMN VIEW, SECTION 5, PHASE 4, LOTS 336-379,
FOUR QUARTER ROAD AND ROLLING BROOK WAY AND
AUTUMN VIEW, SECTION 5 PHASE 5, FUTURE LOTS 380-397 (18 LOTS)
SONG SMITH LANE AND SEAWARD CIRCLE
CONTRACT NO.: 14-4079-D
SECOND ELECTION DISTRICT
HOWARD COUNTY

Robert B. Boender 7-29-03
CHIEF, BUREAU OF UTILITIES DATE

Robert B. Boender 8/5/03
CHIEF, DEVELOPMENT ENGINEERING DIVISION DATE

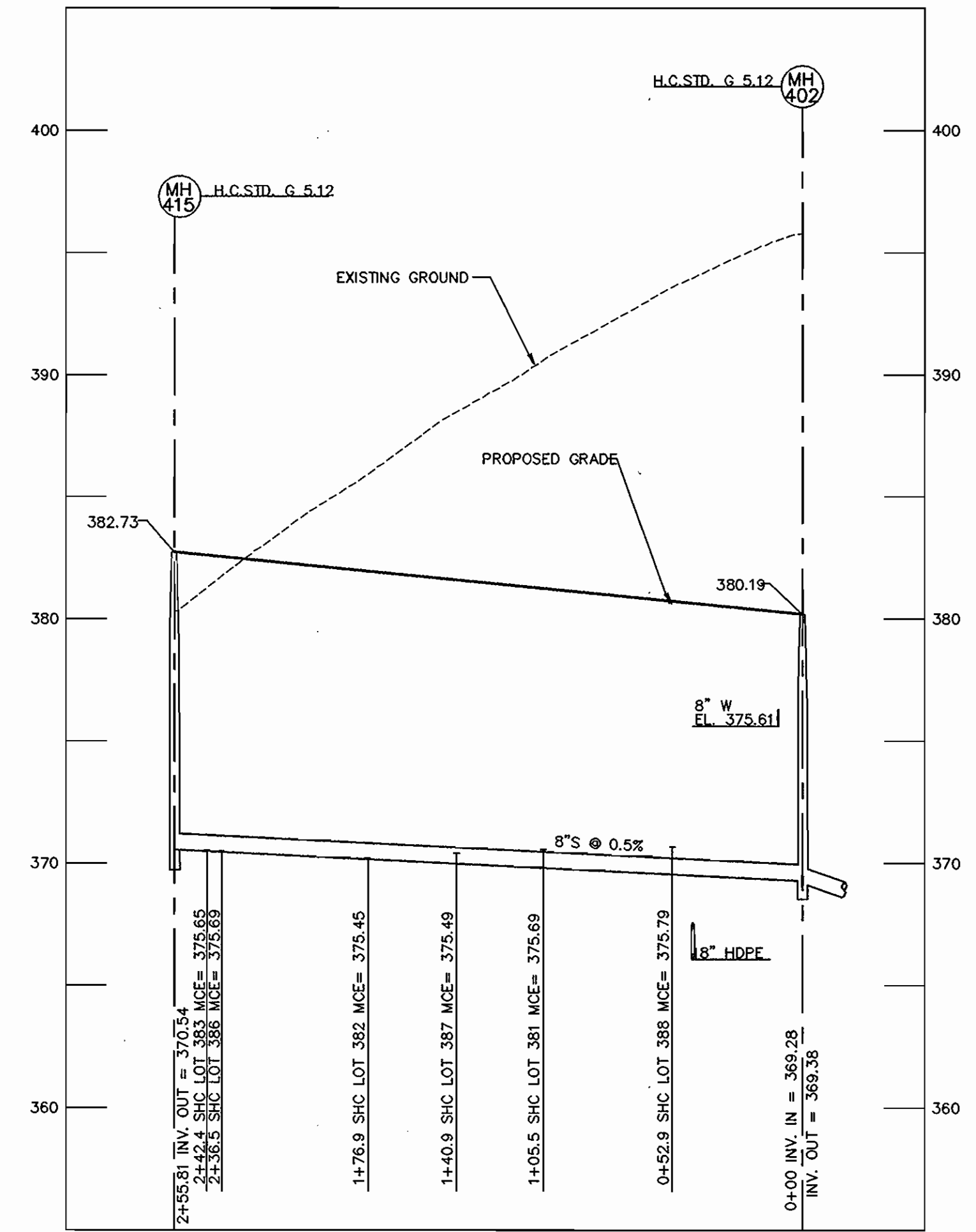
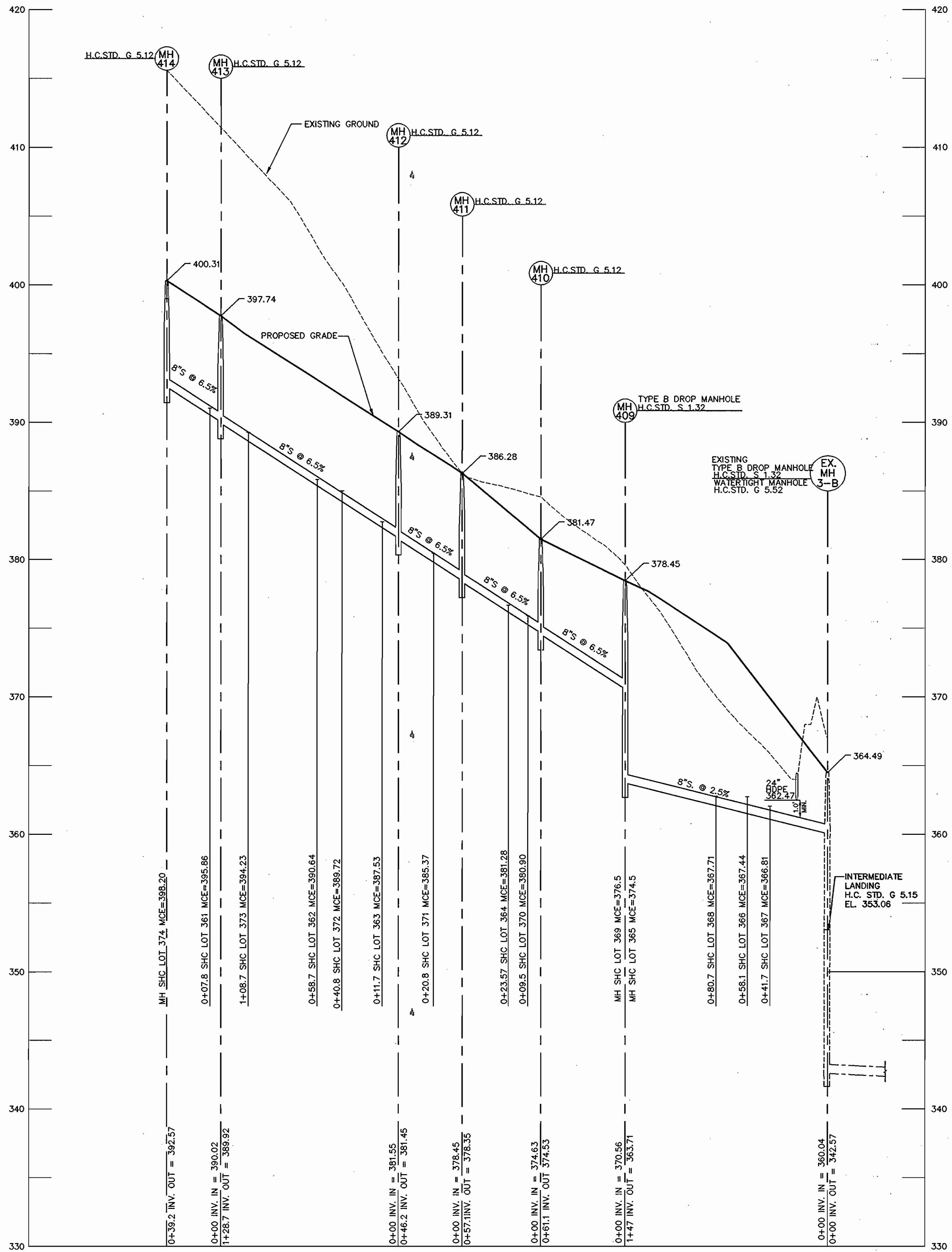

01046 UNV FINAL VIKES 01046-FINAL-SEWER PROFILE RBW/DWG

DEPARTMENT OF PUBLIC WORKS
HOWARD COUNTY, MARYLAND

DEPARTMENT OF PLANNING & ZONING
HOWARD COUNTY, MARYLAND

MILDENBERG, BOENDER & ASSOC., INC.
Engineers Planners Surveyors
5072 Dorsey Hall Drive, Suite 202, Ellicott City, Maryland 21042
(410) 997-0286 Ball. (301) 621-5521 Wash. (410) 997-0288 Fax.



engineering	HSP				
illustration	HSP				
approval	RJH				
project	01046				
date	JULY 2003	BY	NO.	REVISION	DATE

SEWER PROFILES

600' SCALE MAP NO. 25 BLOCK NO. 22

**AUTUMN VIEW, SECTION 5, PHASE 4, LOTS 336-379,
FOUR QUARTER ROAD AND ROLLING BROOK WAY AND
AUTUMN VIEW, SECTION 5 PHASE 5, FUTURE LOTS 380-397 (18 LOTS)
SONG SMITH LANE AND SEAWARD CIRCLE**
CONTRACT NO.: 14-4079-D
SECOND ELECTION DISTRICT
HOWARD COUNTY

scale
AS SHOWN