

GENERAL NOTES

- Approximate location of existing mains are shown. The contractor shall take all necessary precautions to protect existing mains and services and maintain uninterrupted supply. Any damage incurred shall be repaired immediately to the satisfaction of the Engineer at the Contractor's expense.
- All horizontal controls are based on Maryland State Coordinates.
- All vertical controls are based on U.S.G.S. data.
- All pipe elevations shown are invert elevations.
- Clear all utilities by a minimum of 6". Clear all poles by 2'-0" minimum or tunnel as required. The owner has contacted the utility companies and has made arrangements for bracing of poles as shown on the drawings. In the event the contractor's work requires the bracing of additional poles, any cost incurred by the owner for bracing of additional poles or damages shall be deducted from money owed the contractor. The contractor shall coordinate with the utility companies to schedule the bracing of the poles.
- For details not shown on the drawings, and for materials and construction methods use Howard County Design Manual, Volume IV, Standard Specifications and Detail for Construction (Latest Edition). The contractor shall have a copy of Volume IV on the job.
- Where test pits have been made on existing utilities, they are noted by the symbol  at the location of the test pit. A note or notes containing the results of the test pit or pits is included on the drawings. Existing utilities in the vicinity of the proposed work for which test pits have not been dug shall be located by the contractor two weeks in advance of construction operations at his own expense.
- Contractor shall notify the following utility companies or agencies at least five working days before starting work shown on these plans:

State Highway Administration	531-5533
Baltimore Gas & Electric Co. Contractor Services	850-4620
Baltimore Gas & Electric Co. Underground Damage Control	787-9068
Miss Utility	1-800-257-7777
Colonial Pipeline Co.	795-1390
Bureau of Utilities, Howard County Department of Public Works	313-4900
- Contractor shall remove trees, stumps and roots along line of excavation. Payment for such removal shall be included in the unit price bid for construction of the main.
- All fill areas within future roadway and under structures to be compacted to a minimum of 95% compaction as determined by AASHTO T-180.
- Valves adjacent to tees shall be strapped to tees.
- All water mains to be D.I.P. Class 52 unless otherwise noted.
- Tops of all water mains to have a minimum of 3'-1/2' cover unless otherwise noted.
- All fittings shall be buttressed or anchored with concrete in accordance with the Standard Details unless otherwise provided for on the drawings.
- Fire hydrants shall be set to the bury line elevations shown on the drawings. All fire hydrants shall be restrained and buttressed with concrete in accordance with Standard Details. Soil around the fire hydrant shall be compacted in accordance with Section 1000 and 1005 of the Standard Specifications.
- The contractor shall notify the Bureau of Highways, Howard County, at (410) 313-2450 at least five working days before any open cut of any County road or boring/jacking operation in County roads for laying water/sewer mains or house connections. The approval of these drawings will constitute compliance with DPW requirements per Section 18.114(a) of the Howard County Code.
- The contractor shall not operate any water main valves on the existing water system.
- All water house connections shall be for inside meter setting unless otherwise noted on plans or in specifications.
- All sewer mains shall be D.I.P. or P.V.C., unless otherwise noted.
- All manholes shall be 4'-0" inside diameter unless otherwise noted.
- Manholes to be precast concrete structure.
- Manholes shown with 12" and 16" area are for brick manholes only.
- All fire hydrants to be 3.0' behind back of curb.

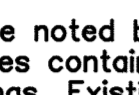
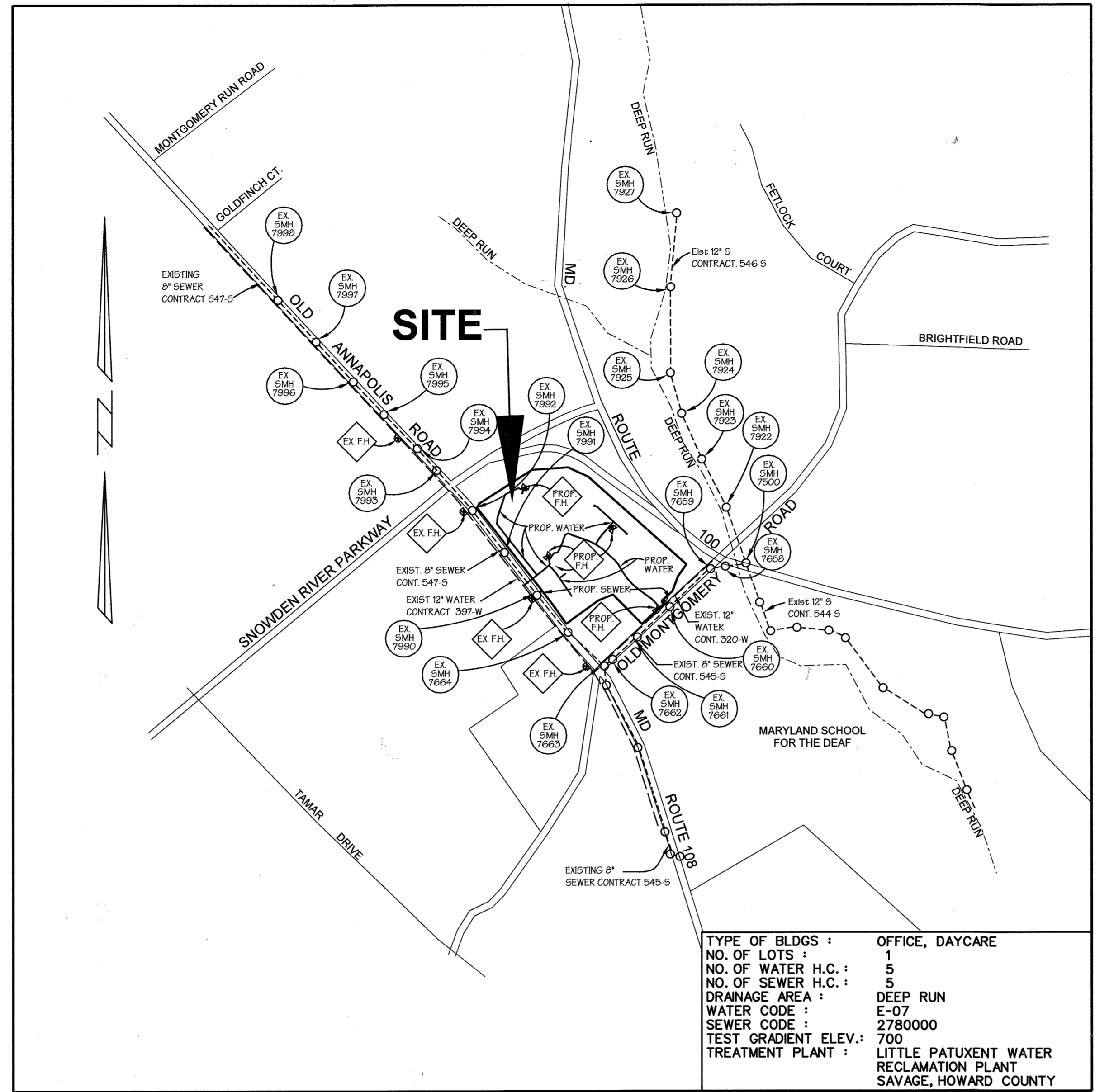

LOCATION MAP

SCALE: 1" = 600'

WATER & SEWER CONSTRUCTION PLANS COLUMBIA CORPORATE PARK 100 (THE HORSE FARM)

1st ELECTION DISTRICT HOWARD COUNTY, MARYLAND

CONTRACT NO. 14-3953-D

INDEX OF SHEETS

SHEET NO.	TITLES
1	COVER SHEET, GENERAL NOTES & LOCATION MAP
2	PLAN VIEW
3	PROFILES
4	PROFILES

Benchmarks

Pt. #37A2, Aka - 2643002 - Howard Co. Geodetic Control
 Northing : 562120.856
 Easting : 1369300.289
 NAD27 datum N 501371.9, E 856882.1
 Elevation : 403.675'

Pt. #37A3, Aka - 2643003 - Howard Co. Geodetic Control
 Northing : 561130.803
 Easting : 1369913.306
 NAD27 datum N 500581.9, E 857495.1
 Elevation : 385.627'

QUANTITIES

ITEMS	QUANTITIES ESTIMATED	AS-BUILT		
		QUANTITIES	TYPE	MANUFACTURER/ SUPPLIER
8" D.I.P. Water Main	2,607 L.F.	2,507	D.I.P. CLASS 52	U.S. PIPE
6" D.I.P. Water Main	91 L.F.	81	D.I.P. CLASS 52	U.S. PIPE
Fire Hydrants	5 Each	4		MUELLER
8"X8" TEE	5 Each	5		U.S. PIPE
8"X6" TEE	5 Each	4		" "
8" Valve and Roadway Box	12 Each	11		" "
6" Valve and Roadway Box	5 Each	4		" "
Sanitary Manholes (G 5.01)	2 Each	2		" "
8" P.V.C. Sanitary Sewer	145 L.F.	140		" "
12" X 8" Tapping Sleeve and Valve	2 Each	2		U.S. PIPE

NAME OF UTILITY CONTRACTOR : CTG

SURVEY AND DRAFTING DIVISION AS-BUILT DATE

8"x2" SADDLE CONNECTION	1 EACH	1 EACH	202 NS NYLON	PATAPSCO / BRS
2" METER AND VAULT	1 EACH	1 EACH	H-15428 N	MUELLER/HORNE CONCRETE/BRS
2" COPPER	14 LF	14 LF	TYPE K	CAMBRIDGE LEE / BRS

BY	NO.	REVISION	DATE
BLDG	3	ADDED 2" WATER SERVICE TO BLDG #6 DUNKIN CARRY-OUT.	02-19-20
		WORK WILL BE DONE UNDER ADD AGREEMENT	
GHS	4	REVISED QUANTITY BOX PER NEW FIRE HYD.	5-12-05
JMT	5	AS PER AS-BUILT	10-31-01

SEDIMENT CONTROL MEASURES FOR THIS CONTRACT WILL BE IMPLEMENTED IN ACCORDANCE WITH SECTION 219 OF THE STANDARD SPECIFICATIONS, SDP 01-068

THE DEVELOPMENT PLAN IS APPROVED FOR SOIL EROSION AND SEDIMENT CONTROL BY THE HOWARD SOIL CONSERVATION DISTRICT.

APPROVED:  5/12/01
 HOWARD SOIL CONSERVATION DISTRICT DATE

REVIEWED FOR HOWARD SOIL CONSERVATION DISTRICT AND MEETS TECHNICAL REQUIREMENTS.

 5/12/01
 U.S. SOIL CONSERVATION SERVICE DATE

OWNER / DEVELOPER
MERRITT PROPERTIES L.L.C.
 2066 LORD BALTIMORE DRIVE
 BALTIMORE, MARYLAND 21244
 410-298-2600

DEPARTMENT OF PUBLIC WORKS
 HOWARD COUNTY, MARYLAND

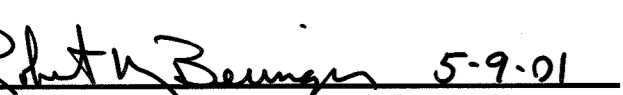
 5-9-01
 CHIEF, BUREAU OF UTILITIES DATE

DEPARTMENT OF PLANNING & ZONING
 HOWARD COUNTY, MARYLAND

 04/10
 CHIEF, DEVELOPMENT ENGINEERING DIVISION DATE

GWS
 GEORGE W. STEPHENS, JR.
 AND ASSOCIATES, INC.
 Civil Engineers and Land Surveyors
 1020 CROMWELL BRIDGE ROAD
 Towson, Maryland 21286
 (410) 825-8120



DESIGNED : PRC, KE
 DRAFTED : KE
 CHECKED : PRC

**COVER SHEET,
 GENERAL NOTES & LOCATION MAP**

CONTRACT NO. 14-3953-D
 600 SCALE MAP NO. 37 BLOCK NO. 8

**PUBLIC WATER & SEWER MAIN
 COLUMBIA CORPORATE PARK 100**
 CONTRACT NO. 14-3953-D

HOWARD COUNTY, MARYLAND
 ELECTION DISTRICT #01

JUNE 26, 2000
 SHEET 1 OF 4

MD. ROUTE 100
PLATS 54190, 54191 & 54193

OLD MONTGOMERY ROAD

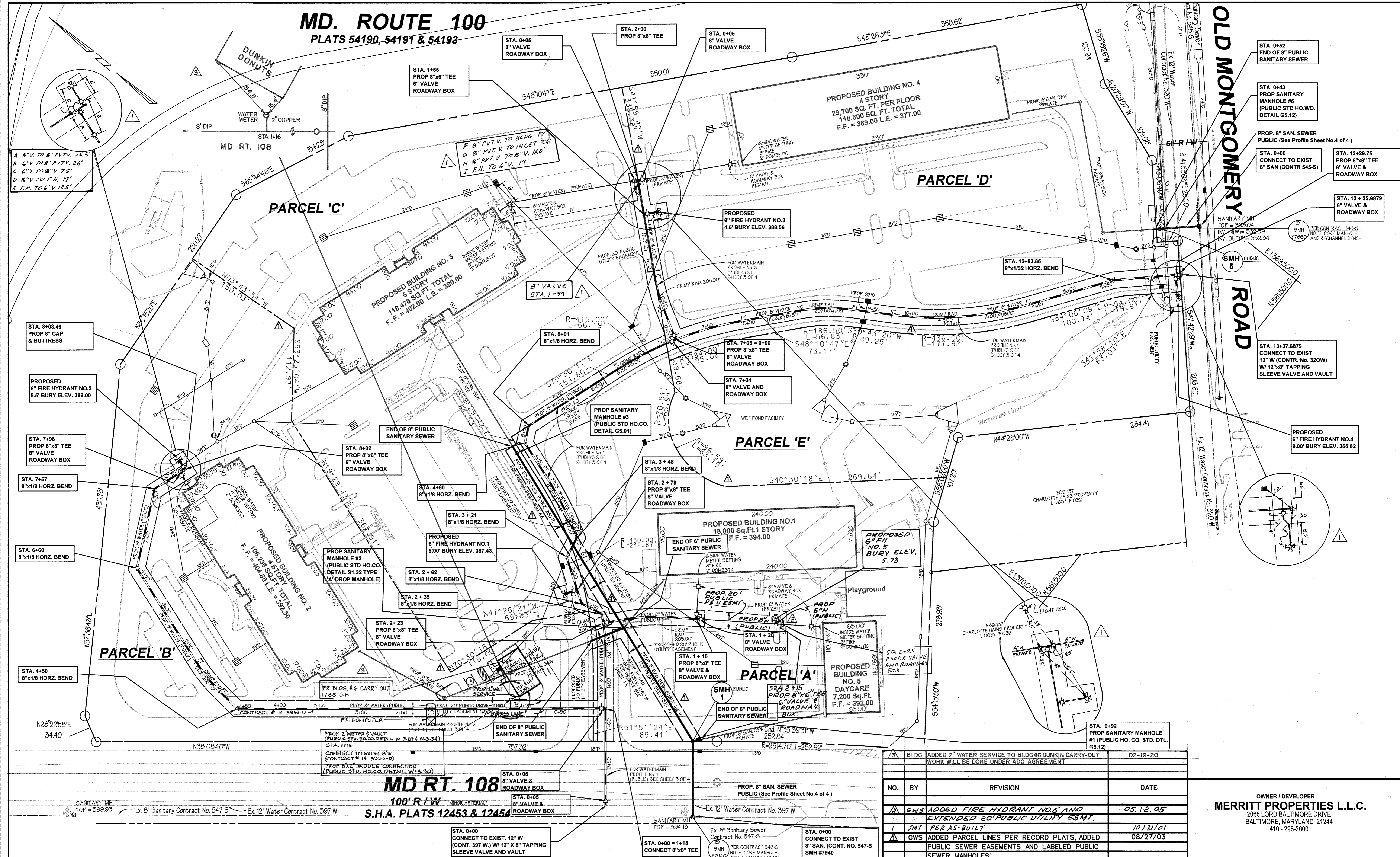

NO.	BY	REVISION	DATE
3		BLDG #6 CARRY-OUT	02-19-20
2	GWS	ADDED FIRE HYDRANT NOS AND EXTENDED 20' PUBLIC UTILITY ESM.	05-12-05
1	JMT	PER AS-BUILT	10/31/01
0	GWS	ADDED PARCEL LINES PER RECORD PLATS, ADDED PUBLIC SEWER EASEMENTS AND LABELED PUBLIC SEWER MANHOLES	08/27/03

OWNER / DEVELOPER
MERRITT PROPERTIES L.L.C.
2066 LORD BALTIMORE DRIVE
BALTIMORE, MARYLAND 21244
410-298-2600

DEPARTMENT OF PUBLIC WORKS
HOWARD COUNTY, MARYLAND
John K. Welch 9/16/03
CHIEF, BUREAU OF UTILITIES DATE

DEPARTMENT OF PLANNING & ZONING
HOWARD COUNTY, MARYLAND
John Dammann 9/16/03
CHIEF, DEVELOPMENT ENGINEERING DIVISION DATE

GWS
GEORGE W. STEPHENS, JR. AND ASSOCIATES, INC.
Civil Engineers and Land Surveyors
1020 CROMWELL BRIDGE ROAD
TOWSON, MARYLAND 21286
(410) 825-8120

DESIGNED : PRC, KE
DRAFTED : P.T., K.E.
CHECKED : PRC
Henry P. Miller 8/28/03

PLAN VIEW
CONTRACT NO. 14-3953-D
BLOCK NO. 8
600 SCALE MAP NO. 37

PUBLIC WATER & SEWER PLAN
COLUMBIA CORPORATE PARK 100
CONTRACT NO. 14-3953-D
ELECTION DISTRICT *1
HOWARD COUNTY, MARYLAND
AUGUST 27, 2003
SHEET 2 OF 4
P/N 8594 - revwatsewplan1.004

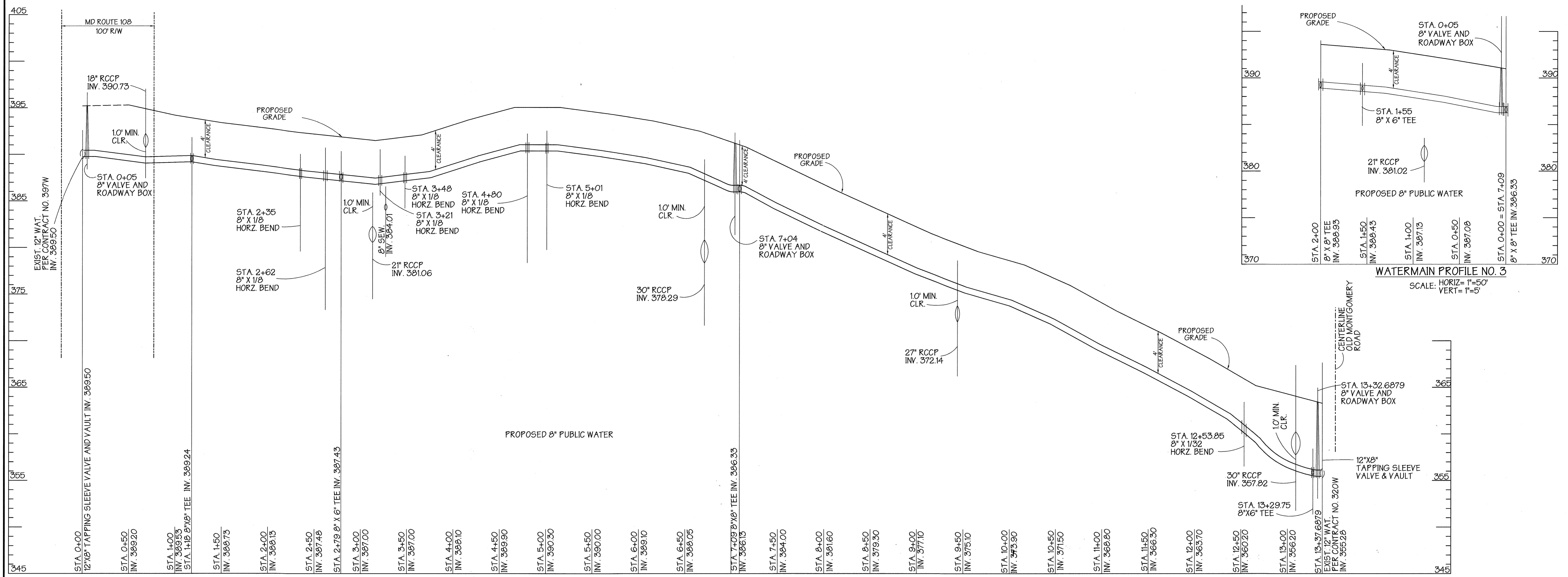

WATERMAIN PROFILE NO. 1
SCALE: HORIZ=1"=50'
VERT=1"=5'

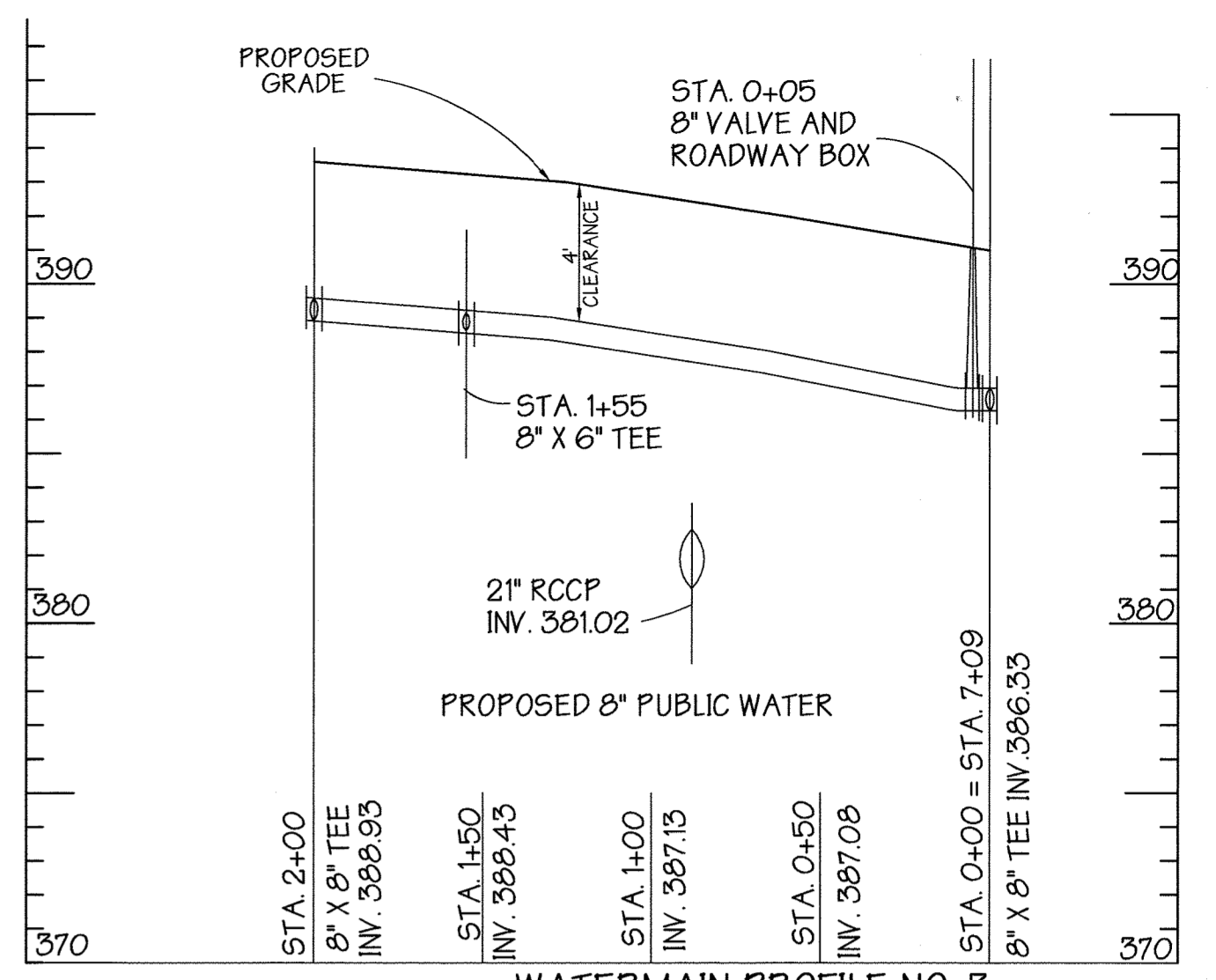

WATERMAIN PROFILE NO. 3
SCALE: HORIZ=1"=50'
VERT=1"=5'

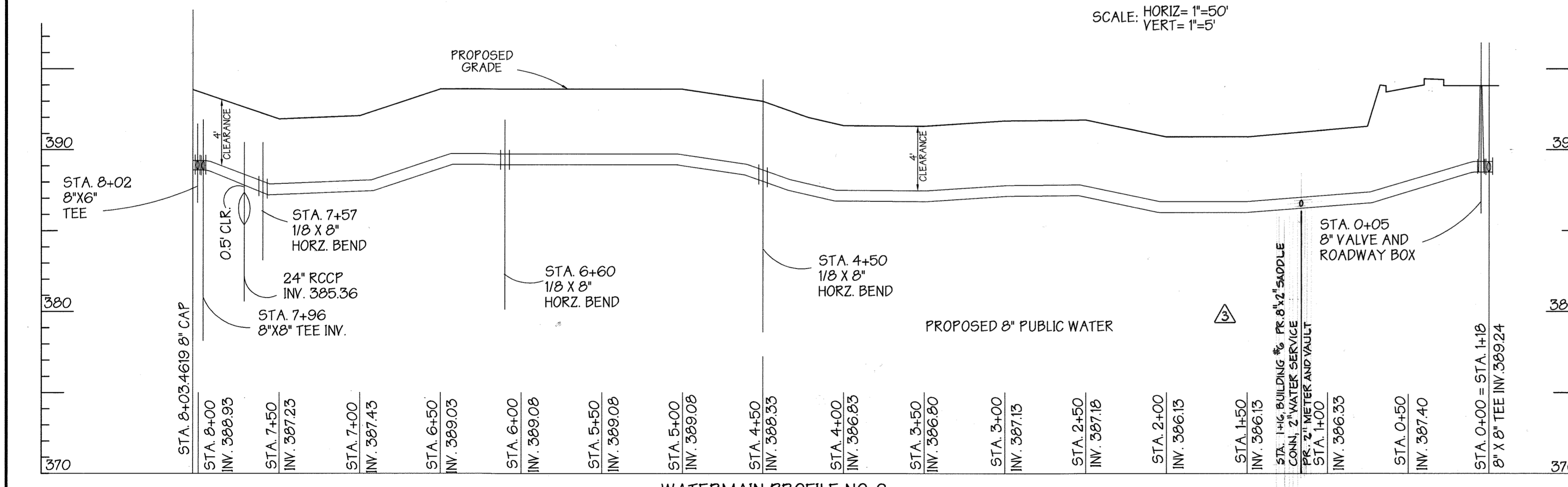

WATERMAIN PROFILE NO. 2
SCALE: HORIZ=1"=50'
VERT=1"=5'

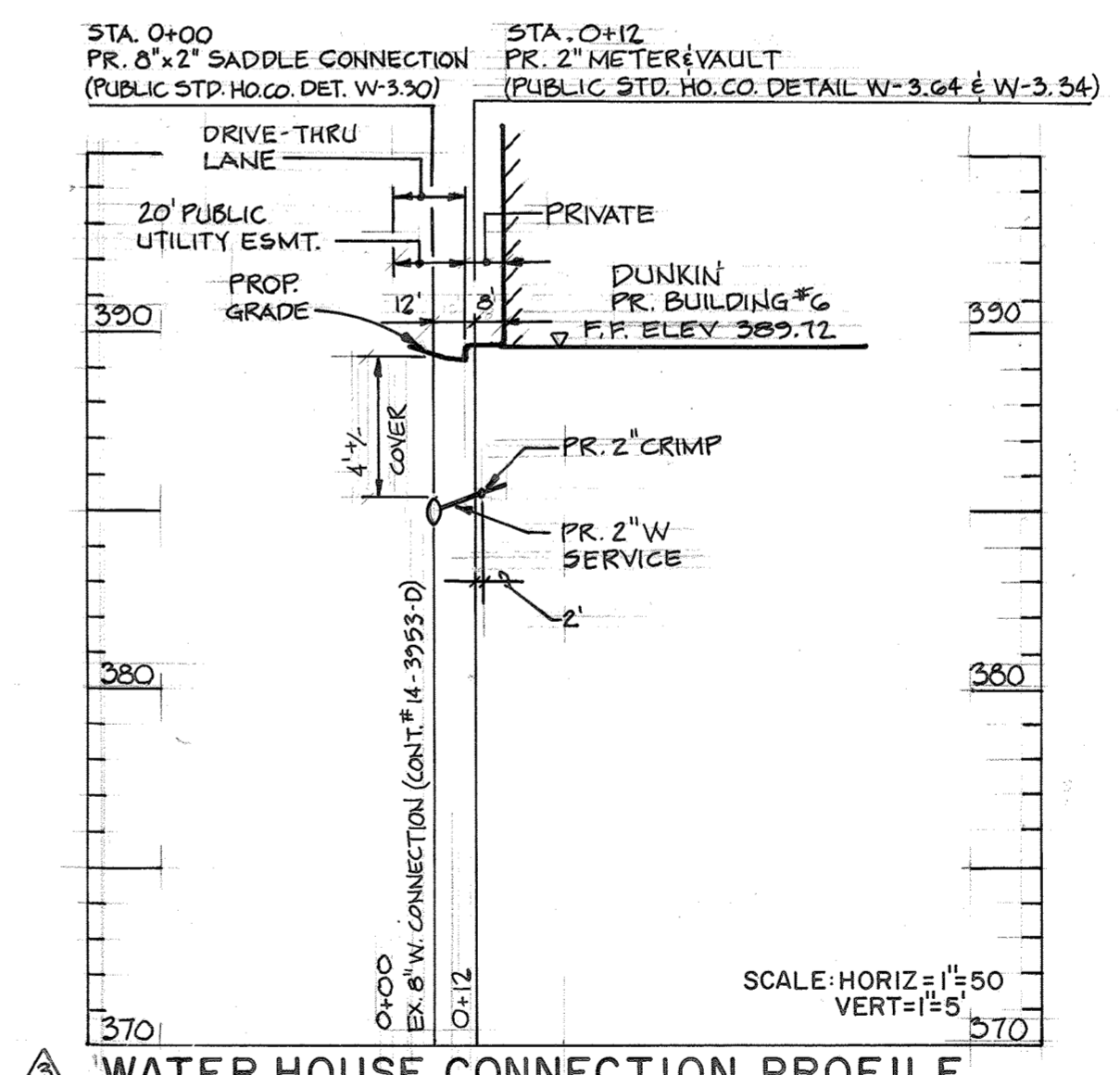

WATER HOUSE CONNECTION PROFILE
SCALE: HORIZ=1"=50'
VERT=1"=5'

NO.	BY	REVISION	DATE
1	BLDG	ADDED 2" WATER SERVICE TO BLDG#6 DUNKIN CARRY-OUT WORK WILL BE DONE UNDER ADO AGREEMENT	02-19-20

OWNER / DEVELOPER
MERRITT PROPERTIES L.L.C.
2066 LORD BALTIMORE DRIVE
BALTIMORE, MARYLAND 21244
410-298-2600

DEPARTMENT OF PUBLIC WORKS
HOWARD COUNTY, MARYLAND

5-9-01
CHIEF, BUREAU OF UTILITIES DATE

DEPARTMENT OF PLANNING & ZONING
HOWARD COUNTY, MARYLAND

6/4/01
CHIEF, DEVELOPMENT ENGINEERING DIVISION DATE

GEORGE W. STEPHENS, JR. AND ASSOCIATES, INC.
Civil Engineers and Land Surveyors
1020 CROMWELL BRIDGE ROAD
Towson, Maryland 21286
(410) 825-8120



DESIGNED : PRC, KE
DRAFTED : PT
CHECKED : PRC

PROFILES
CONTRACT NO. 14-3953-D
600 SCALE MAP NO. 37
BLOCK NO. 8

PUBLIC WATER & SEWER PROFILES
COLUMBIA CORPORATE PARK 100
CONTRACT NO. 14-3953-D
ELECTION DISTRICT #1
HOWARD COUNTY, MARYLAND
JUNE 26, 2000
SHEET 3 OF 4

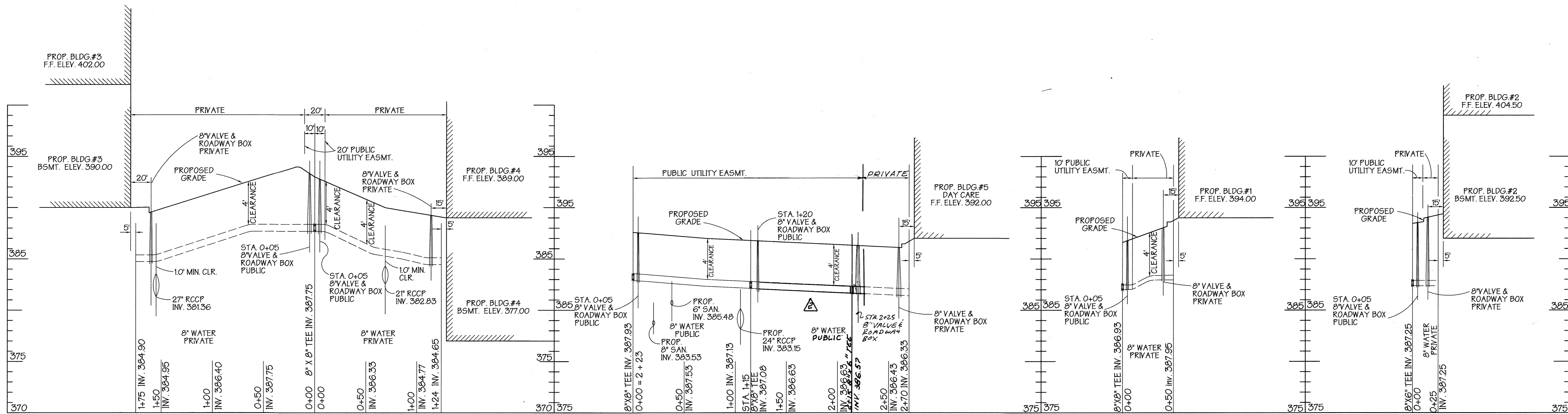

WATERHOUSE CONNECTION PROFILES
SCALE: HORIZ=1"=50'
VERT=1"=5'

WATERHOUSE CONNECTION PROFILES
SCALE: HORIZ=1"=50'
VERT=1"=5'

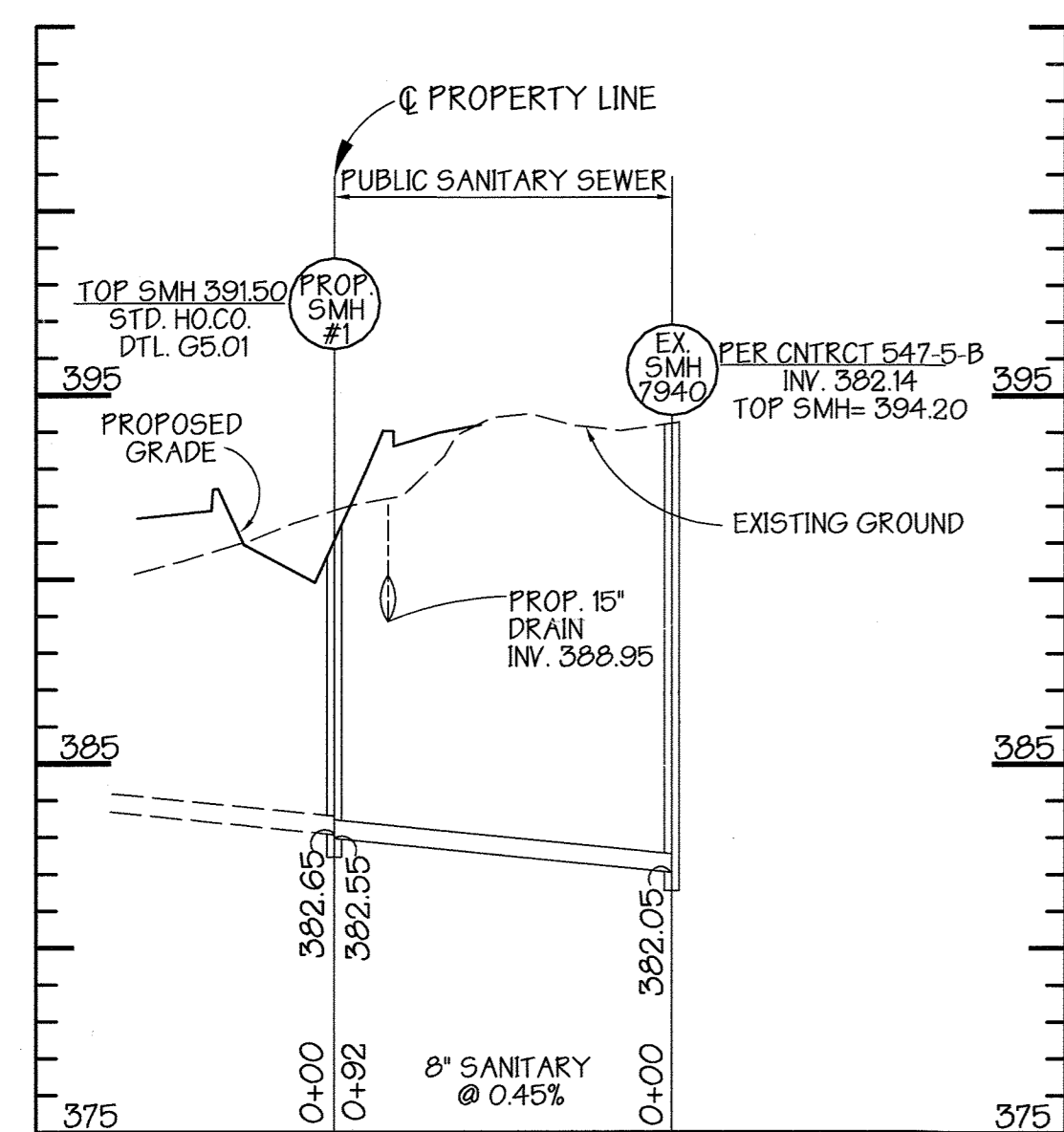

SANITARY SEWER PROFILE
SCALE: HORIZ=1"=50'
VERT=1"=5'

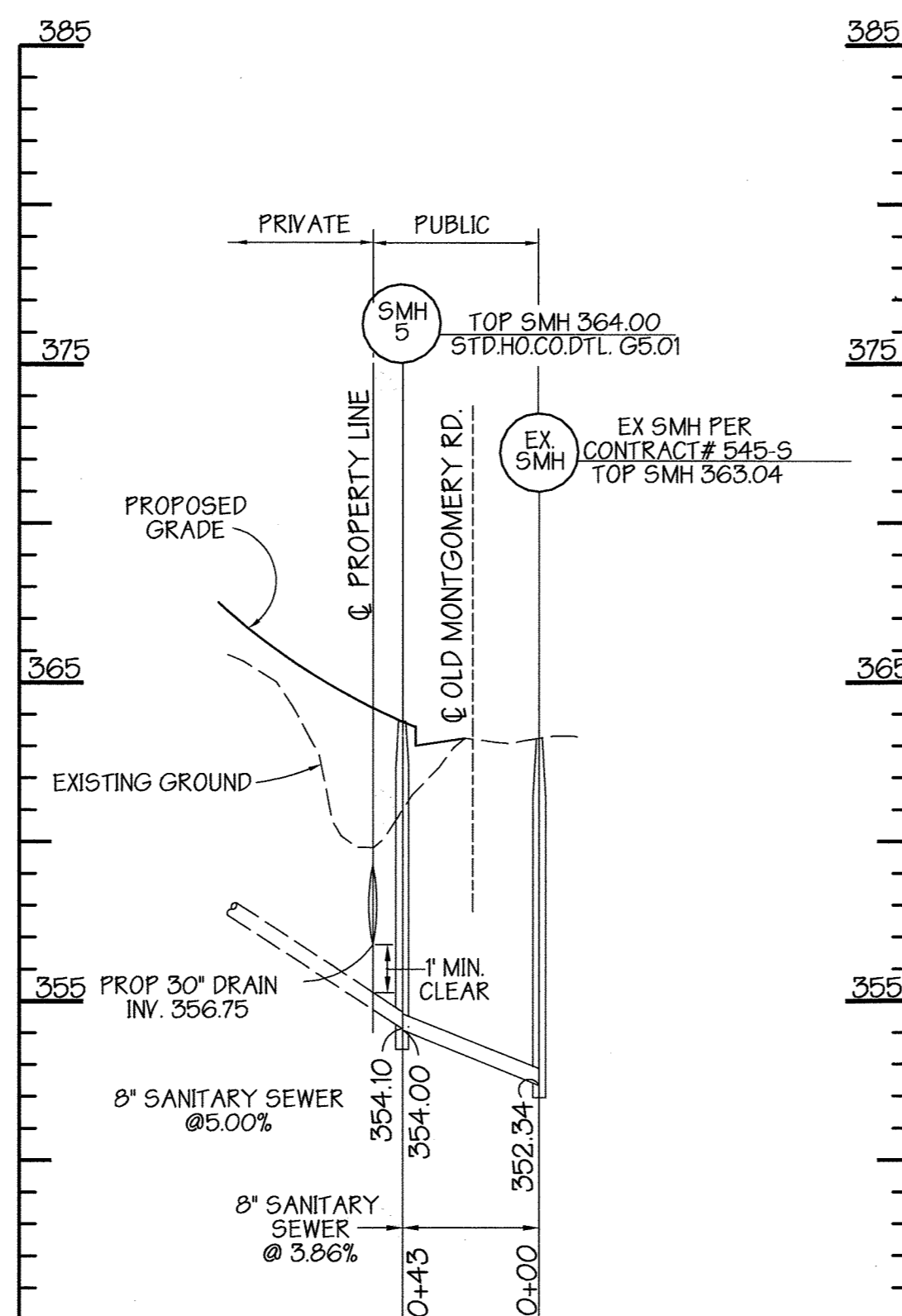

SANITARY SEWER PROFILE
SCALE: HORIZ=1"=50'
VERT=1"=5'

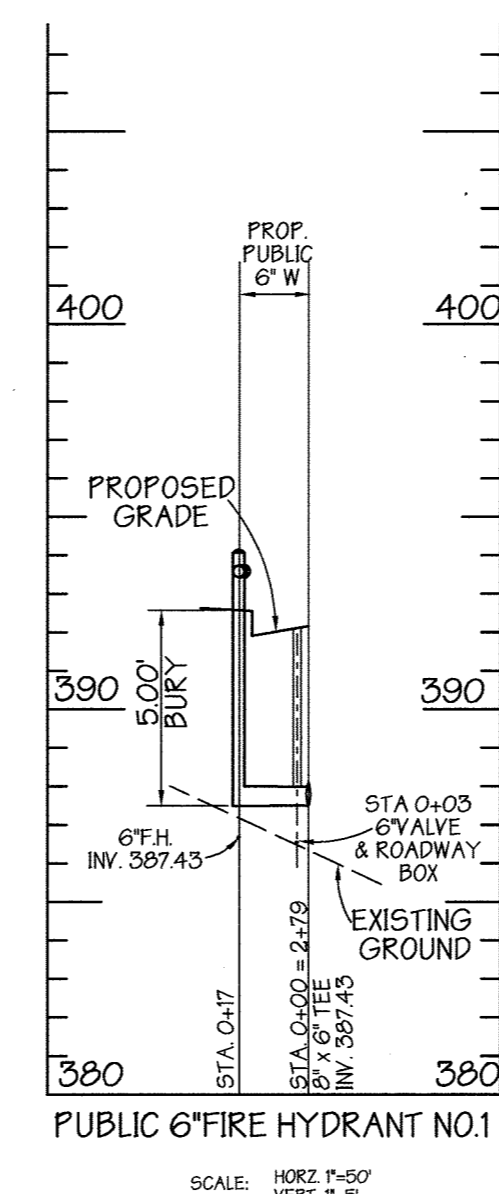

PUBLIC 6" FIRE HYDRANT NO.1
SCALE: HORIZ=1"=50'
VERT=1"=5'

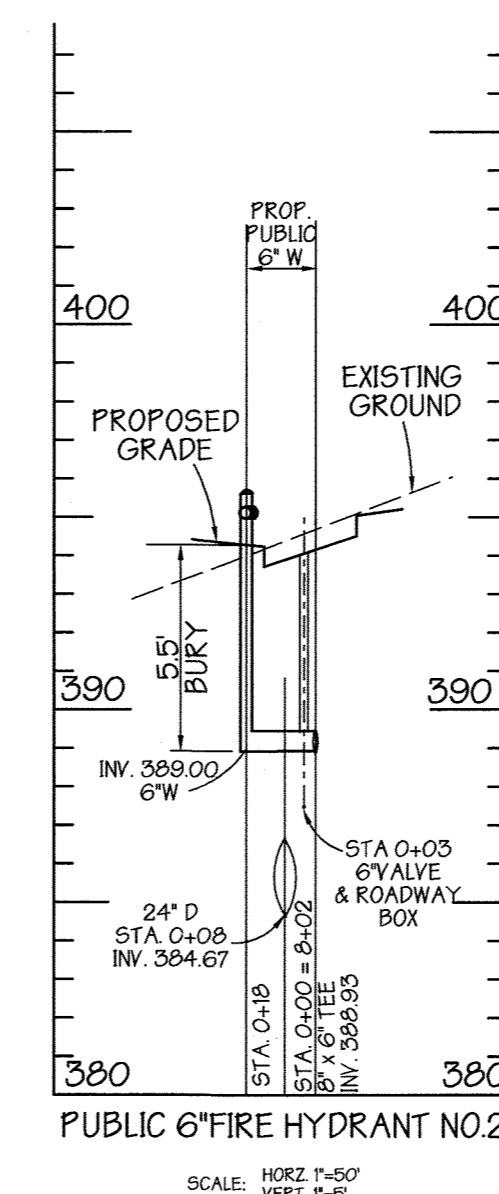

PUBLIC 6" FIRE HYDRANT NO.2
SCALE: HORIZ=1"=50'
VERT=1"=5'

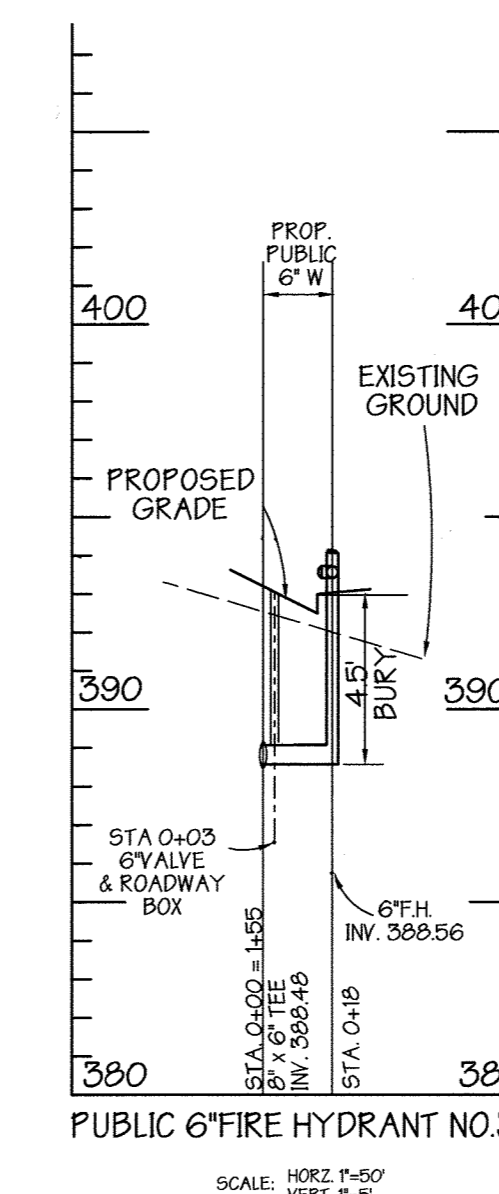

PUBLIC 6" FIRE HYDRANT NO.3
SCALE: HORIZ=1"=50'
VERT=1"=5'

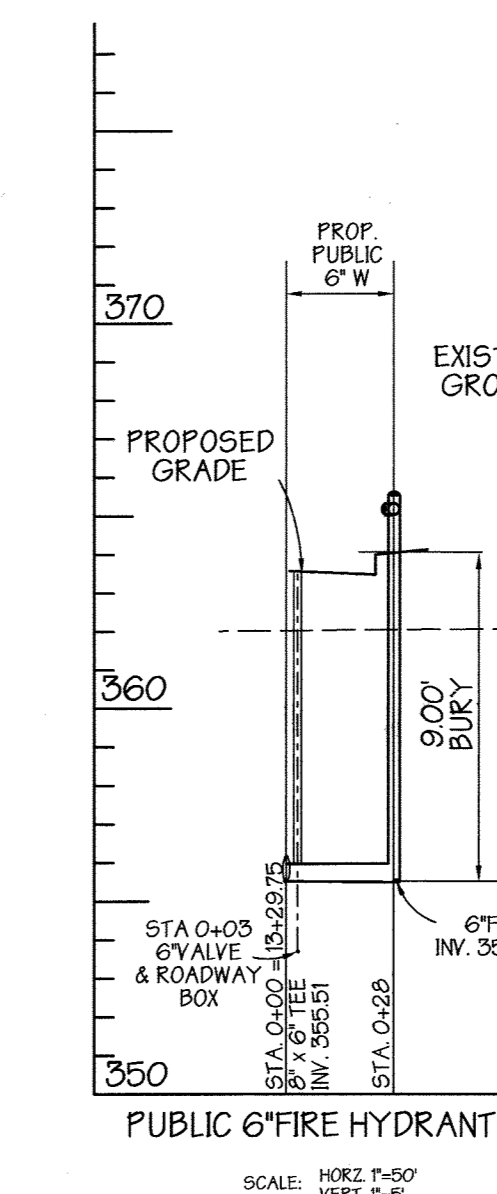

PUBLIC 6" FIRE HYDRANT NO.4
SCALE: HORIZ=1"=50'
VERT=1"=5'

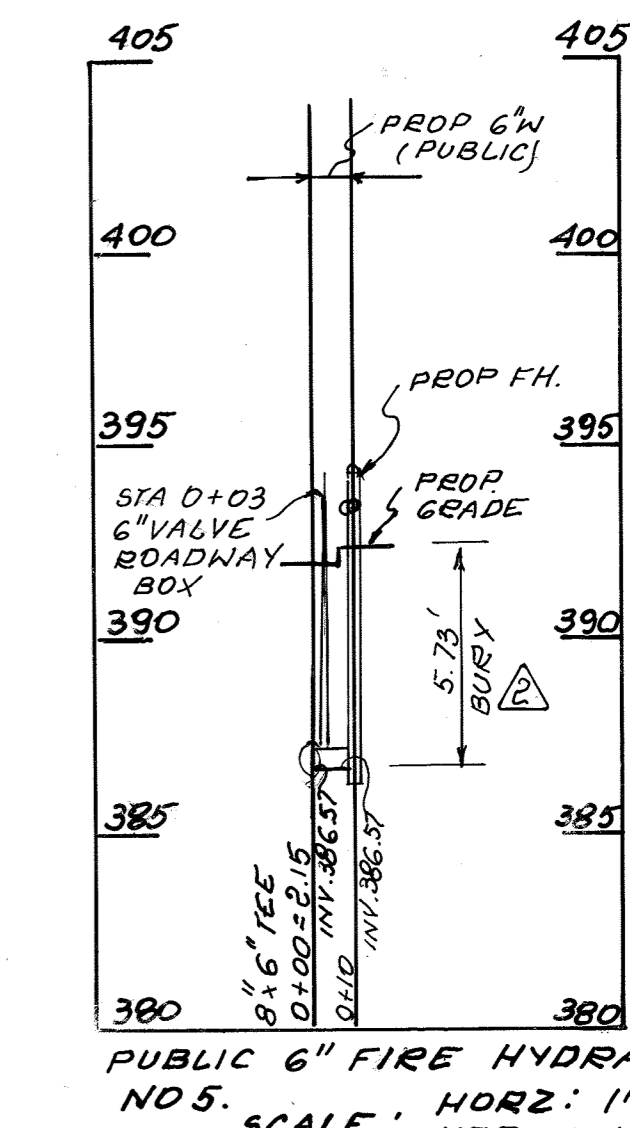

PUBLIC 6" FIRE HYDRANT NO.5
SCALE: HORIZ=1"=50'
VERT=1"=5'

NO.	BY	REVISION	DATE
1	GWS	ADDED FIRE HYDRANT NO.5, PROFILE	5-12-05
2		EXTENDED PUBLIC UTILITY EASMT.	

OWNER / DEVELOPER
MERRITT PROPERTIES L.L.C.
2066 LORD BALTIMORE DRIVE
BALTIMORE, MARYLAND 21244
410-298-2600

DEPARTMENT OF PUBLIC WORKS
HOWARD COUNTY, MARYLAND

DEPARTMENT OF PLANNING & ZONING
HOWARD COUNTY, MARYLAND



**GEORGE W. STEPHENS, JR.
AND ASSOCIATES, INC.**
Civil Engineers and Land Surveyors
1020 CROMWELL BRIDGE ROAD
Towson, Maryland 21286
(410) 825-8120



DESIGNED : PRC, KE
DRAFTED : PT
CHECKED : PRC

PROFILES

CONTRACT NO. 14-3953-D
600 SCALE MAP NO. 37

BLOCK NO. 8

**PUBLIC WATER & SEWER PROFILES
COLUMBIA CORPORATE PARK 100**
CONTRACT NO. 14-3953-D

ELECTION DISTRICT #1
HOWARD COUNTY, MARYLAND

JUNE 26, 2000
SHEET 4 OF 4

