

QUANTITIES				
ITEMS	QUANTITIES ESTIMATED	AS-BUILT		
		QUANTITIES	TYPE	MANUFACTURER / SUPPLIER
12" W	1763 LF	1763 LF	CLASS	GRIFFIN / M&C SALES
8" W	432 LF	432 LF	"	"
6" W	38 LF	40 LF	"	"
12" VALVE	4 EA	4 EA	GATE	KENNEDY / " "
8" VALVE	4 EA	3 EA	"	"
6" VALVE	2 EA	2 EA	"	"
FIRE HYD.	2 EA	2 EA	"	"
1 1/2" DRAIN & 1.5" DIA. VAULT	1 EA	1 EA	"	FORD / " "
1" AIR RELEASE AND MH	2 EA	2 EA	"	GAI-1 / " "
3" BLOW OFF	1 EA	1 EA	"	KUPFERLE / " "

NAME OF UTILITY CONTRACTOR: CHARLES J. MILLER, INC.
SURVEY AND DRAFTING DIVISION AS-BUILT DATE:

**CURVE #2
CURVE DATA**

$\Delta = 09^{\circ}09'11''$
 $R = 300'$
 $L = 47.92'$
 $T = 24.01'$
 $CHD. = S 00^{\circ}27'36'' E 47.87'$

BENCHMARKS

HORIZONTAL (NAD 83) AND VERTICAL (MVD 29)
 CONTROL BASED UPON HOWARD COUNTY TRAVERSE
 POINTS 47E4, 47E4A.
 STATION 47E4 (STAMPED CONCRETE MONUMENT)
 NS35846.639 E135724.012 (FOR HORIZONTAL CONTROL)
 ELEVATION 339.002 (FOR VERTICAL CONTROL)
 LOCATED 1" NORTH OF NORTH EDGE CONCRETE
 WALK 27' EAST OF NORTHEAST CORNER OF BRIDGE
 0.2' BELOW SURFACE

STATION 47E4 (STAMPED CONCRETE MONUMENT)
 NS35846.639 E135724.012 (FOR HORIZONTAL CONTROL ONLY)
 LOCATED ALONG GORMAN ROAD NORTHEAST OF JEANNE CT.

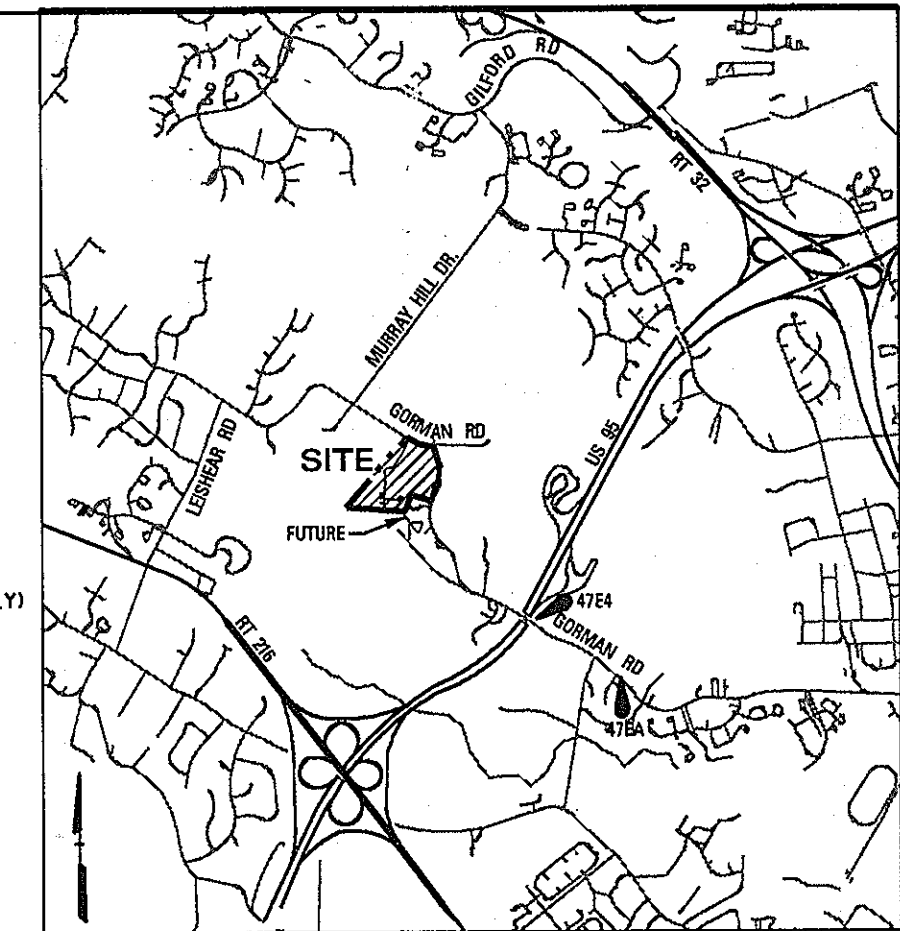

LOCATION MAP
SCALE: 1" = 4000'

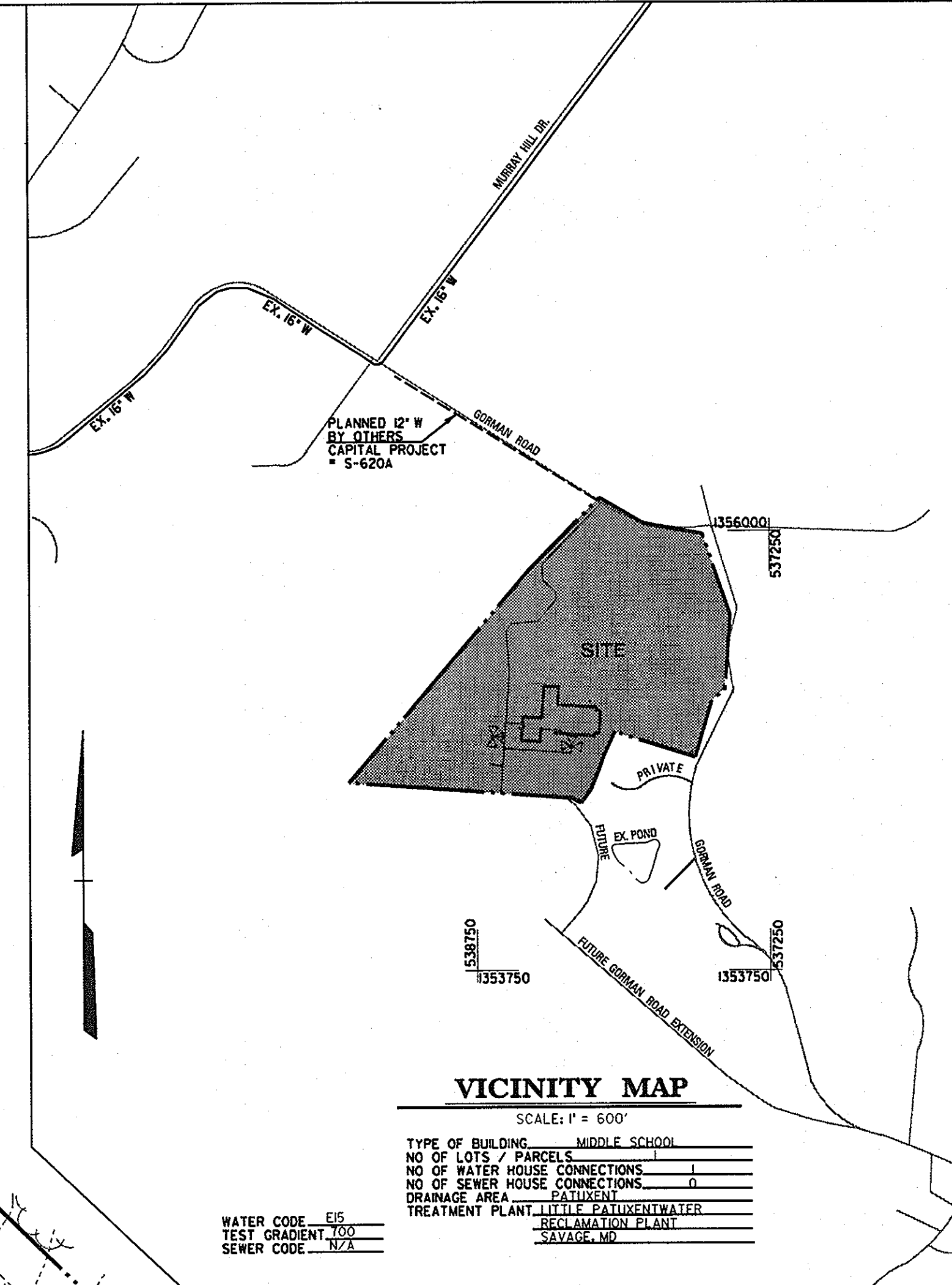

VICINITY MAP
SCALE: 1" = 600'

TYPE OF BUILDING	MIDDLE SCHOOL
NO OF LOTS / PARCELS	1
NO OF WATER HOUSE CONNECTIONS	0
NO OF SEWER HOUSE CONNECTIONS	0
DRAINAGE AREA (ACRES)	0
TREATMENT PLANT	SAVAGE, MD
RECLAMATION PLANT	SAVAGE, MD

WATER CODE: EIS
TEST GRADIENT: 100
SEWER CODE: N/A

**CURVE #1
CURVE DATA**

$\Delta = 03^{\circ}26'39''$
 $R = 350'$
 $L = 21.04'$
 $T = 10.52'$
 $CHD. = S 42^{\circ}42'40'' W 21.04'$

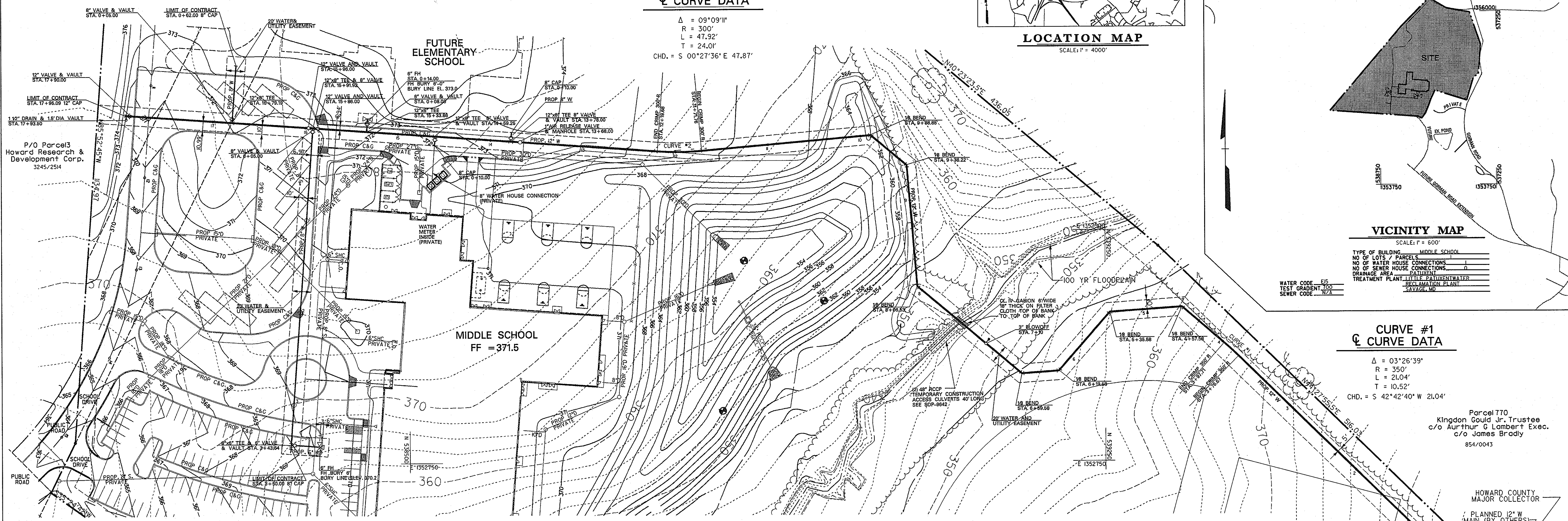

PART I - GENERAL NOTES

- APPROXIMATE LOCATION OF EXISTING MAINS ARE SHOWN. THE CONTRACTOR SHALL TAKE ALL NECESSARY PRECAUTIONS TO PROTECT EXISTING MAINS AND SERVICES AND MAINTAIN UNINTERRUPTED SUPPLY. ANY DAMAGE INCURRED SHALL BE REPAIRED IMMEDIATELY TO THE SATISFACTION OF THE ENGINEER AT THE CONTRACTOR'S EXPENSE.
- ALL HORIZONTAL CONTROLS ARE BASED ON MARYLAND STATE COORDINATES (NORTH AMERICAN DATUM OF 1983 (NAD 83)).
- ALL VERTICAL CONTROLS ARE BASED ON U.S.G.S. DATA.
- ALL PIPE ELEVATIONS SHOWN ARE INVERT ELEVATIONS.
- CLEAR ALL UTILITIES BY A MINIMUM OF 6 INCHES.
- FOR DETAILS NOT SHOWN ON THE DRAWINGS, AND FOR MATERIALS AND CONSTRUCTION METHODS, USE HOWARD COUNTY DESIGN MANUAL, VOLUME IV, STANDARD SPECIFICATIONS AND DETAILS FOR CONSTRUCTION LATEST EDITION. THE CONTRACTOR SHALL HAVE A COPY OF VOLUME IV ON THE JOB.
- WHERE TEST PITS HAVE BEEN MADE ON EXISTING UTILITIES, THEY ARE NOTED BY THE SYMBOL AT THE LOCATION OF THE TEST PIT. A NOTE OR NOTES CONTAINING THE RESULTS OF THE TEST PIT OR PITS IS INCLUDED ON THE DRAWINGS. EXISTING UTILITIES IN THE VICINITY OF THE PROPOSED WORK FOR WHICH TEST PITS HAVE NOT BEEN DUG SHALL BE VERIFIED BY THE CONTRACTOR TO HIS OWN SATISFACTION. ANY DAMAGE TO EXISTING FACILITIES DUE TO THE CONTRACTOR'S NEGLIGENCE SHALL BE REPAIRED AT THE CONTRACTOR'S EXPENSE.
- CONTRACTOR SHALL NOTIFY THE FOLLOWING UTILITIES OR AGENCIES AT LEAST FIVE WORKING DAYS BEFORE STARTING WORK SHOWN ON THESE PLANS:
 STATE HIGHWAY ADMINISTRATION - 531-5533
 BALTIMORE GAS & ELECTRIC CO. - CONTRACTOR SERVICES 850-4620
 BALTIMORE GAS & ELECTRIC CO. UNDERGROUND DAMAGE CONTROL - 787-9068
 BALTIMORE GAS & ELECTRIC CO. TROUBLE SHOOTING - 298-9013
 MISS. UTILITY - 1-800-257-7777
 COLONIAL PIPELINE CO. - 705-1390
 BUREAU OF UTILITIES, HOWARD COUNTY DEPARTMENT OF PUBLIC WORKS - 313-4900
- TREES AND SHRUBS ARE TO BE PROTECTED FROM DAMAGE TO MAXIMUM EXTENT. TREES AND SHRUBS LOCATED WITHIN THE CONSTRUCTION STRIP ARE NOT TO BE REMOVED OR DAMAGED BY THE CONTRACTOR.

- CONTRACTOR SHALL REMOVE TREES, STUMPS AND ROOTS ALONG LINE OF EXCAVATION. PAYMENT FOR SUCH REMOVAL SHALL BE INCLUDED IN THE UNIT PRICE BID FOR CONSTRUCTION OF THE MAIN.
- THE CONTRACTOR SHALL NOTIFY THE BUREAU OF HIGHWAYS, HOWARD COUNTY, AT (410) 313-2450 AT LEAST FIVE (5) WORKING DAYS BEFORE ANY OPEN CUT OF ANY COUNTY ROAD OR BORING/JACKING OPERATION IN COUNTY ROADS FOR LAYING WATER / SEWER MAINS OR HOUSE CONNECTIONS. THE APPROVAL OF THESE DRAWINGS WILL CONSTITUTE COMPLIANCE WITH DPW REQUIREMENTS PER SECTION 18J14 (g) OF THE HOWARD COUNTY CODE.

PART II - WATER

- ALL WATER MAINS TO BE D.I.P. CLASS 52 UNLESS OTHERWISE NOTED.
- TOPS OF ALL WATER MAINS TO HAVE A MINIMUM OF 3'-1/2" COVER UNLESS OTHERWISE NOTED.
- VALVES ADJACENT TO TEES SHALL BE STRAPPED TO TEES.
- ALL FITTINGS SHALL BE BUTTRESSED OR ANCHORED WITH CONCRETE IN ACCORDANCE WITH THE STANDARD DETAILS UNLESS OTHERWISE PROVIDED FOR ON THE DRAWINGS.
- FIRE HYDRANTS SHALL BE SET TO THE BURY LINE ELEVATIONS SHOWN ON THE DRAWINGS. ALL FIRE HYDRANTS SHALL BE RESTRAINED AND BUTTRESSED WITH CONCRETE IN ACCORDANCE WITH STANDARD DETAILS. SOIL AROUND THE FIRE HYDRANT SHALL BE COMPACTED IN ACCORDANCE WITH SECTION 1003 OF THE STANDARD SPECIFICATIONS.
- THE CONTRACTOR SHALL NOT OPERATE ANY WATER MAIN VALVES ON THE EXISTING WATER SYSTEM.
- ALL WATER HOUSE CONNECTIONS SHALL BE FOR INSIDE METER SETTING, UNLESS OTHERWISE NOTED ON THE PLANS OR IN THE SPECIFICATIONS.

NOTE: CONNECT TO THE EXISTING 12-INCH WATER MAIN IF EXISTING IN GORMAN ROAD. OTHERWISE PROVIDE PLUG AND BUTTRESS.

REVIEWED FOR HOWARD SOIL CONSERVATION DISTRICT AND MEETS TECHNICAL REQUIREMENT
John B. Robertson 4/12/96
 SIGNATURE DATE

THIS DEVELOPMENT PLAN IS APPROVED FOR SOIL EROSION AND SEDIMENT CONTROL BY THE HOWARD COUNTY CONSERVATION DISTRICT.
 APPROVED *J. H. Wanfield/PR* 4/12/96
 HOWARD COUNTY DATE

NOTE: SEDIMENT CONTROL MEASURES WILL BE IMPLEMENTED IN ACCORDANCE WITH SECTION 219 OF THE SPECIFICATIONS AND WITH SITE DEVELOPMENT PLANS SDP 96-42.

DEPARTMENT OF PLANNING & ZONING
 HOWARD COUNTY, MARYLAND
Robert J. ...
 CHIEF - DEVELOPMENT ENGINEERING DIVISION DATE

DEPARTMENT OF PUBLIC WORKS
 HOWARD COUNTY, MARYLAND
Robert J. ... 3-28-96
 CHIEF - BUREAU OF UTILITIES - DATE

DMW
 Daft · McCune · Walker, Inc.
 A Team of Land Planners, 200 East Pennsylvania Avenue
 Landscape Architects, Towson, Maryland 21286
 Engineers, Surveyors & Environmental Professionals 410 296 3333
 Fax 296 4705

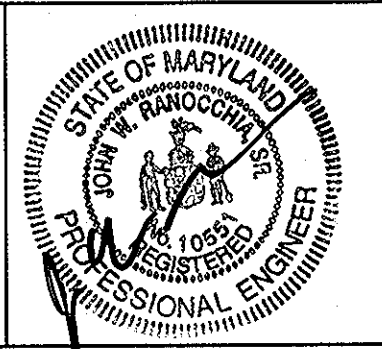

DESIGN BY:	RLH
DRAWN BY:	NB
CHECKED BY:	JWR/CVM
DATE:	2-8-96
BY NO.	REVISION
DATE	600 SCALE MAP NO. 47 BLOCK NO. 2

8" AND 12" WATER MAIN PLAN
 6th ELECTION DISTRICT
 CONTRACT NO. 44-3494-D

SOUTHEASTERN MIDDLE SCHOOL
 HOWARD COUNTY PUBLIC SCHOOL SYSTEM
 10910 ROUTE 108
 ELLICOTT CITY, MD 21043
 SHEET 1 OF 2

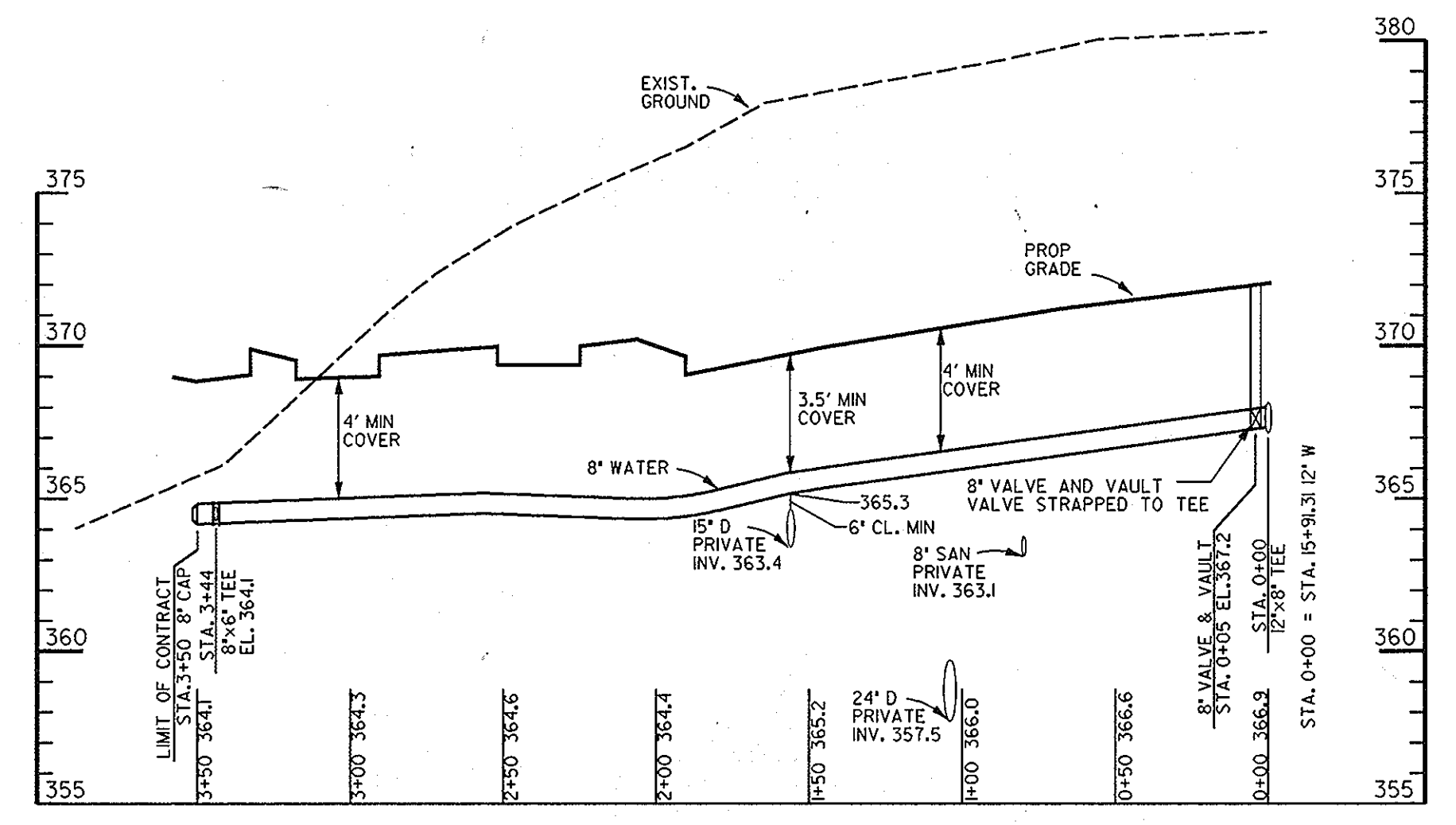

8\"/>

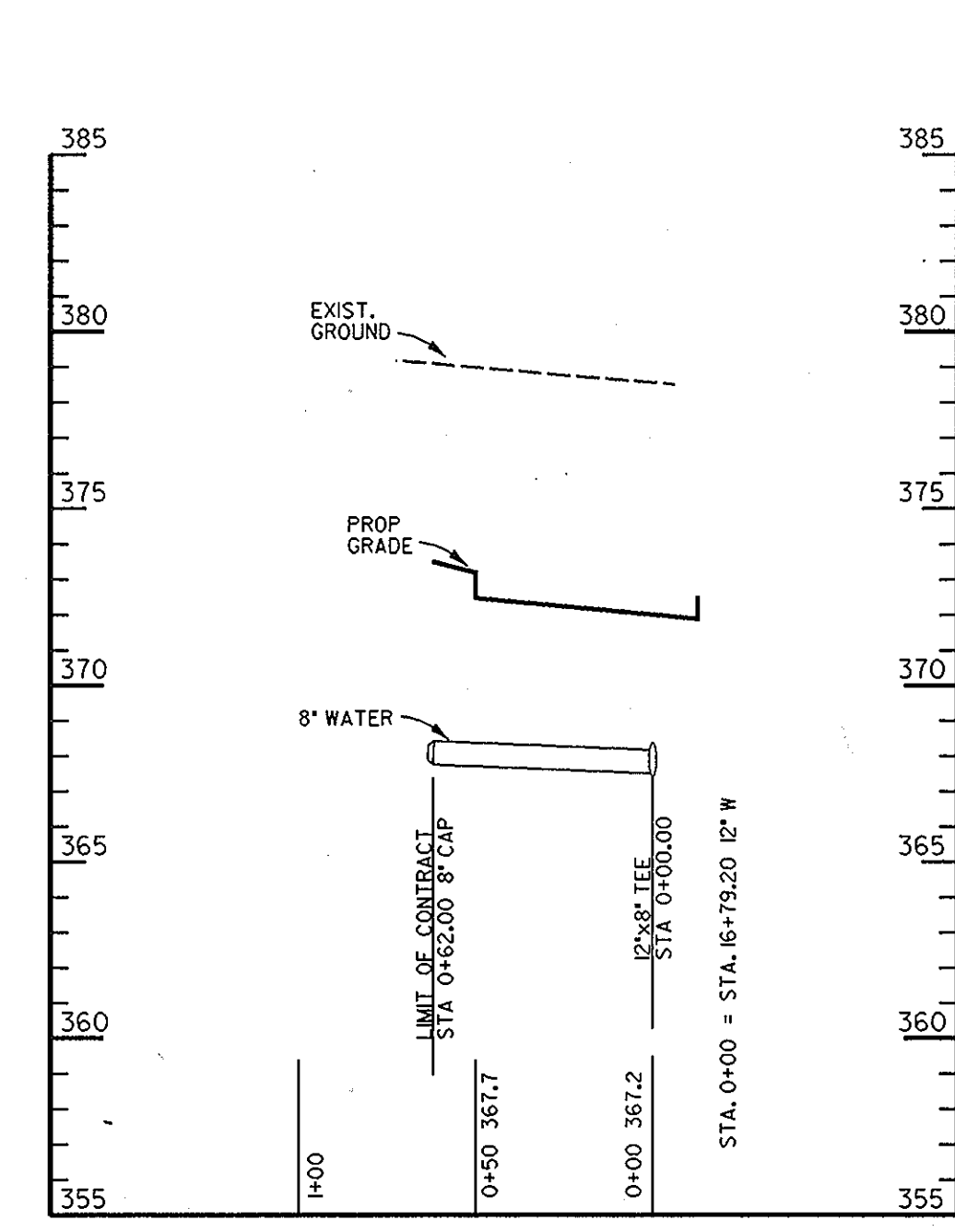

8\"/>

WATER AS-BUILTS

FROM	TO	DIST.
AIR RELEASE MH	EX. F.H.	22'
3\"/>	4\"/>	4'
AIR RELEASE MH @ STA. 19+20	14\"/>	11'
	CAP FOR PIPE @ STA. 19+70	17'
	VALVE @ STA. 14+99	91'
	12\"/>	167'
F.H. @ STA. 18+34	F.H. VALVE @ STA. 14+99	77'
	6\"/>	136'
	12\"/>	91'
	12\"/>	22'
	12\"/>	64'
	8\"/>	4'
F.H. @ STA. 19+34	6\"/>	33'
8\"/>	CAP FOR PIPE @ STA. 16+79	145'
12\"/>	CAP @ END OF PIPE @ STA. 17+34	61'
F.H. @ STA. 9+44	6\"/>	28'
EX. AIR RELEASE MH		

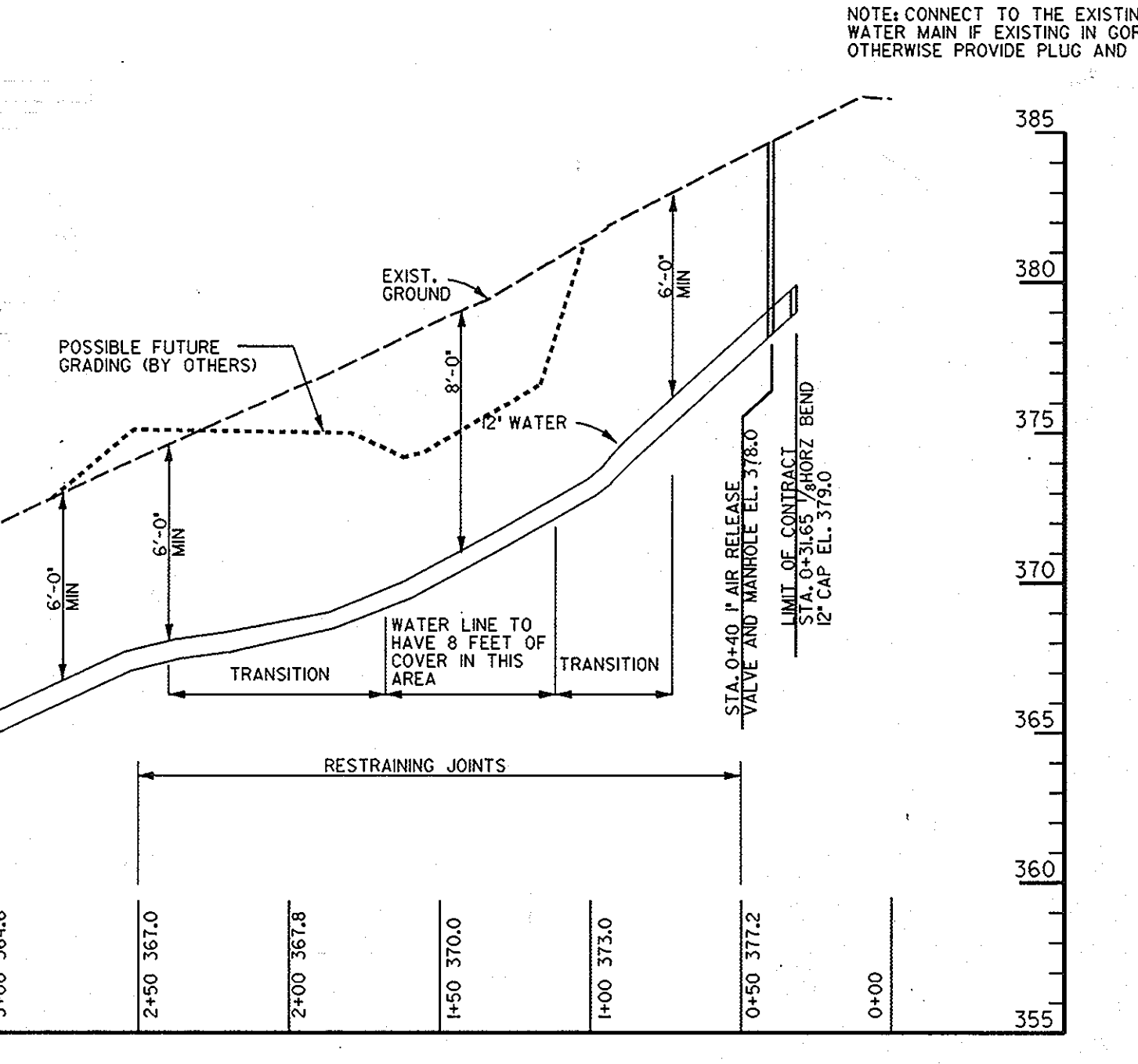

12\"/>

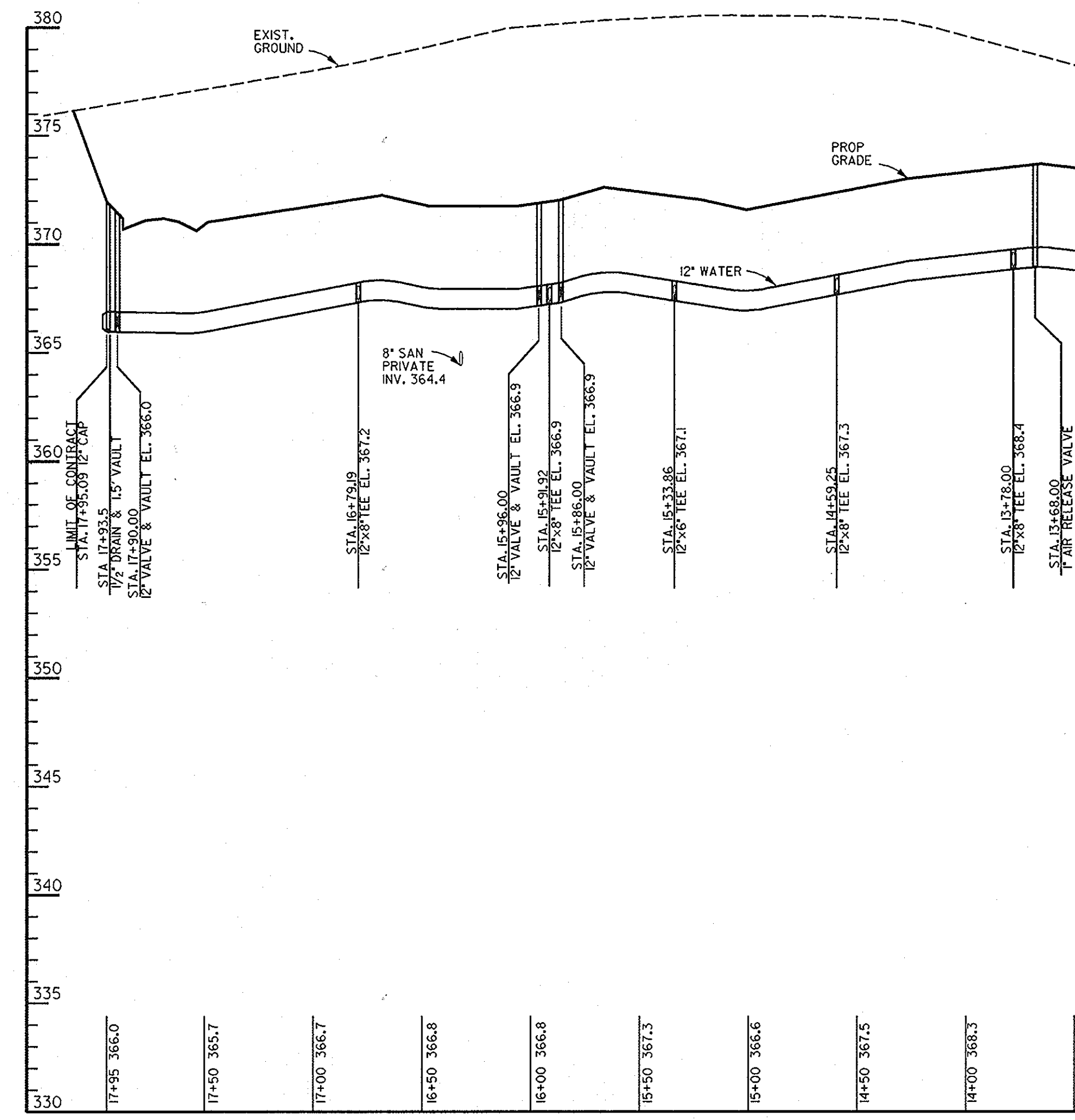

12\"/>

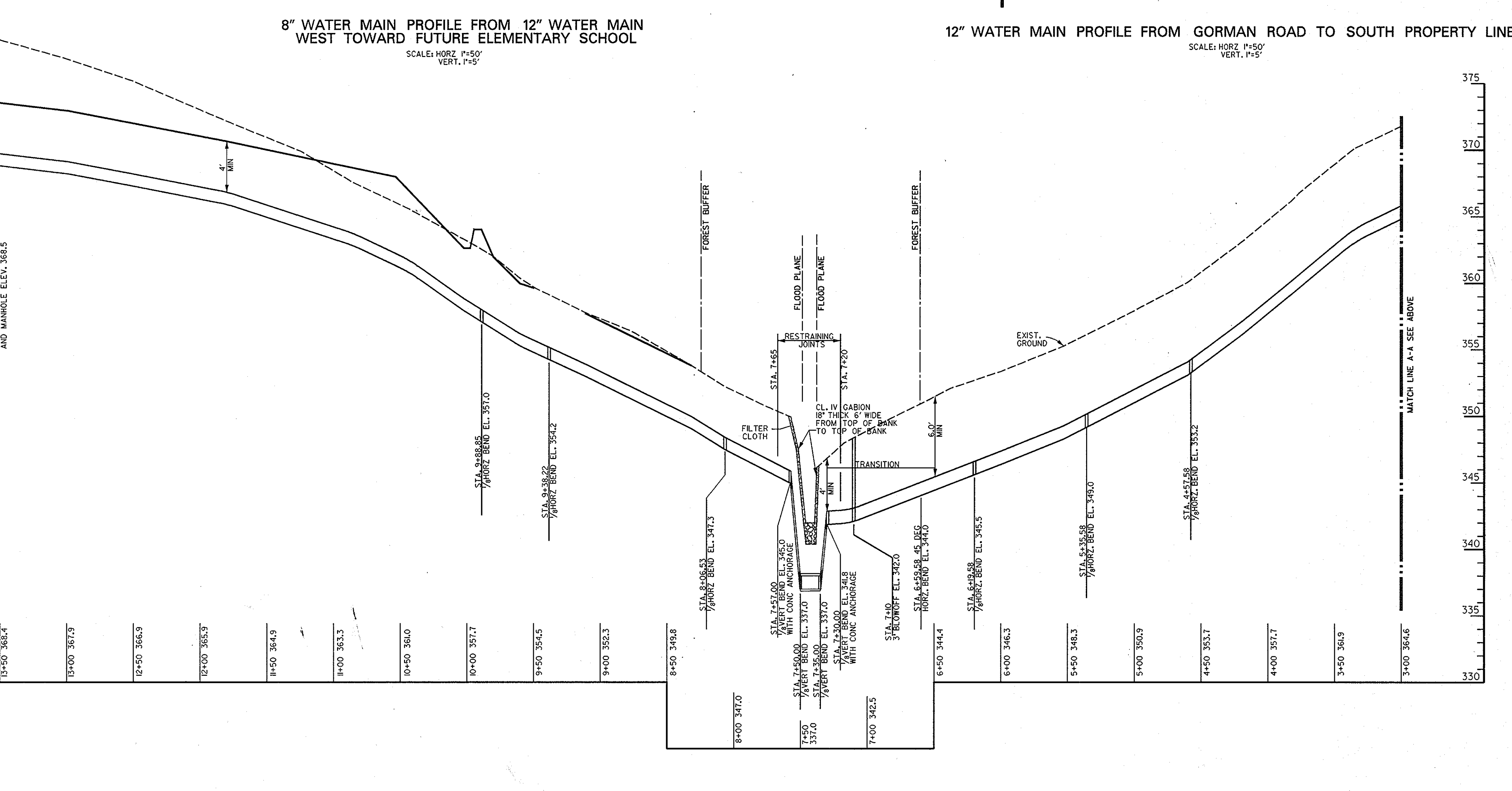

12\"/>

DEPARTMENT OF PLANNING & ZONING
HOWARD COUNTY, MARYLAND

 CHIEF - DEVELOPMENT ENGINEERING DIVISION - DATE 4/4/96

DEPARTMENT OF PUBLIC WORKS
HOWARD COUNTY, MARYLAND

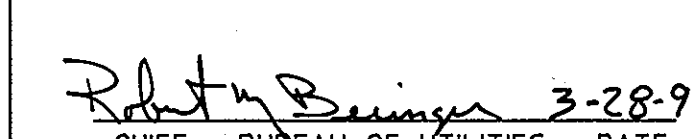
 CHIEF - BUREAU OF UTILITIES - DATE 3-28-96

DMW
 Daft • McCune • Walker, Inc.
 A Team of Land Planners, 200 East Pennsylvania Avenue
 Landscape Architects, Towson, Maryland 21286
 Engineers, Surveyors & 410 296 3333
 Environmental Professionals Fax 296 4705

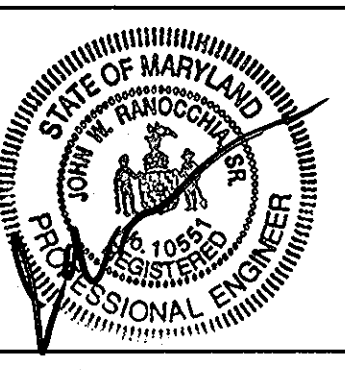

DESIGN BY:	RLH		
DRAWN BY:	NB		
CHECKED BY:	JWR/CVM		
DATE:	2-8-96		
BY	NO.	REVISION	DATE

8\"/>

6th ELECTION DISTRICT
 600 SCALE MAP NO. 47 BLOCK NO. 2

SOUTHEASTERN MIDDLE SCHOOL
 HOWARD COUNTY PUBLIC SCHOOL SYSTEM
 10910 ROUTE 108
 ELLICOTT CITY, MD 21043
 CONTRACT NO. 44-3494-D

SCALE AS SHOWN
 SHEET 2 OF 2