

SURVEY NOTES:

- HOWARD COUNTY STATION 38A9
CONC. MON. SW COR. RTE. No. 1 & MONTGOMERY RD.
NORTH (83) 561,056.3627
EAST (83) 1,389,634.097
ELEV. 222.67
- HOWARD COUNTY STATION 38BA
ALUM. DISC ON 3/4" REBAR ON WEST SIDE OF RTE. No. 1 & 100' N. OF SUMMER HOME TER.
NORTH (83) 561,056.3627
EAST (83) 1,389,634.097
ELEV. 222.67

BENCH MARKS

BM #1 (SSM#26) EL= 31.00
P.K. NAIL ON E. SIDE OF RACE ROAD 64.70' WEST OF SANITARY MANHOLE, 77.70' EAST OF BGE POLE #211446 & 33.33' SW OF A MAIL BOX IN #6114 RACE ROAD.

BM #2 (SSM#27) EL= 31.68
P.K. NAIL ON E. SIDE OF RACE ROAD 19.68' WEST OF FORSE FIELD FENCE POST AND 46.26' SE OF BGE POLE #202175.

PERMANENT SEEDING NOTES

APPLY TO GRADED OR CLEARED AREAS NOT SUBJECT TO IMMEDIATE FURTHER DISTURBANCE WHERE A PERMANENT LONG-LIVED VEGETATIVE COVER IS NEEDED.

SEEDBED PREPARATION: LOOSEN UPPER THREE INCHES OF SOIL BY RAKING, DISKING OR OTHER ACCEPTABLE MEANS BEFORE SEEDING, IF NOT PREVIOUSLY LOOSENED.

SOIL AMENDMENTS: IN LIEU OF SOIL TEST RECOMMENDATIONS, USE ONE OF THE FOLLOWING SCHEDULES:

- PREFERRED** - APPLY 2 TONS PER ACRE DOLOMITIC LIMESTONE (92 LBS/1000 SQ FT.) AND 800 LBS PER ACRE 10-10-10 FERTILIZER (14LBS/1000 SQ FT.) BEFORE SEEDING. HARROW OR DISK INTO UPPER THREE INCHES OF SOIL. AT TIME OF SEEDING, APPLY 400 LBS PER ACRE 30-0-0 UREAFORM FERTILIZER (9 LBS/1000 SQ FT.).
- ACCEPTABLE** - APPLY 2 TONS PER ACRE DOLOMITIC LIMESTONE (92 LBS/1000 SQ FT.) AND 1000 LBS PER ACRE 10-10-10 FERTILIZER (23 LBS/1000 SQ FT.) BEFORE SEEDING. HARROW OR DISK INTO UPPER THREE INCHES OF SOIL.

SEEDING - FOR THE PERIODS MARCH 1 THRU APRIL 30, AND AUGUST 1 THRU OCTOBER 15, SEED WITH 60 LBS PER ACRE (1.4 LBS/1000 SQ FT.) OF KENTUCKY 31 TALL FESCUE. FOR THE PERIOD MAY 1 THRU JULY 31, SEED WITH 60 LBS KENTUCKY 31 TALL FESCUE PER ACRE AND 2 LBS PER ACRE (.05 LBS/1000 SQ FT.) OF WEEPING LOVEGRASS. DURING THE PERIOD OF OCTOBER 16 THRU FEBRUARY 26, PROTECT SITE BY OPTION (1) 2 TONS PER ACRE OF WELL ANCHORED STRAW MULCH AND SEED AS SOON AS POSSIBLE IN THE SPRING. OPTION (2) USE SOD. OPTION (3) SEED WITH 60 LBS/ACRE KENTUCKY 31 TALL FESCUE AND MULCH WITH 2 TONS/ACRE WELL ANCHORED STRAW.

MULCHING - APPLY 1-1/2 TO 2 TONS PER ACRE (70 TO 90 LBS/1000 SQ FT.) OF UNROTTED SMALL GRASS STRAW IMMEDIATELY AFTER SEEDING. ANCHOR MULCH IMMEDIATELY AFTER APPLICATION USING MULCH ANCHORING TOOL OR 218 GALLONS PER ACRE (5 GAL/1000 SQ FT.) OF EMULSIFIED ASPHALT ON FLAT AREAS. ON SLOPES 8 FEET OR HIGHER, USE 348 GALLONS PER ACRE (8 GAL/1000 SQ FT.) FOR ANCHORING.

MAINTENANCE - INSPECT ALL SEEDED AREAS AND MAKE NEEDED REPAIRS, REPLACEMENTS AND RESEEDINGS.

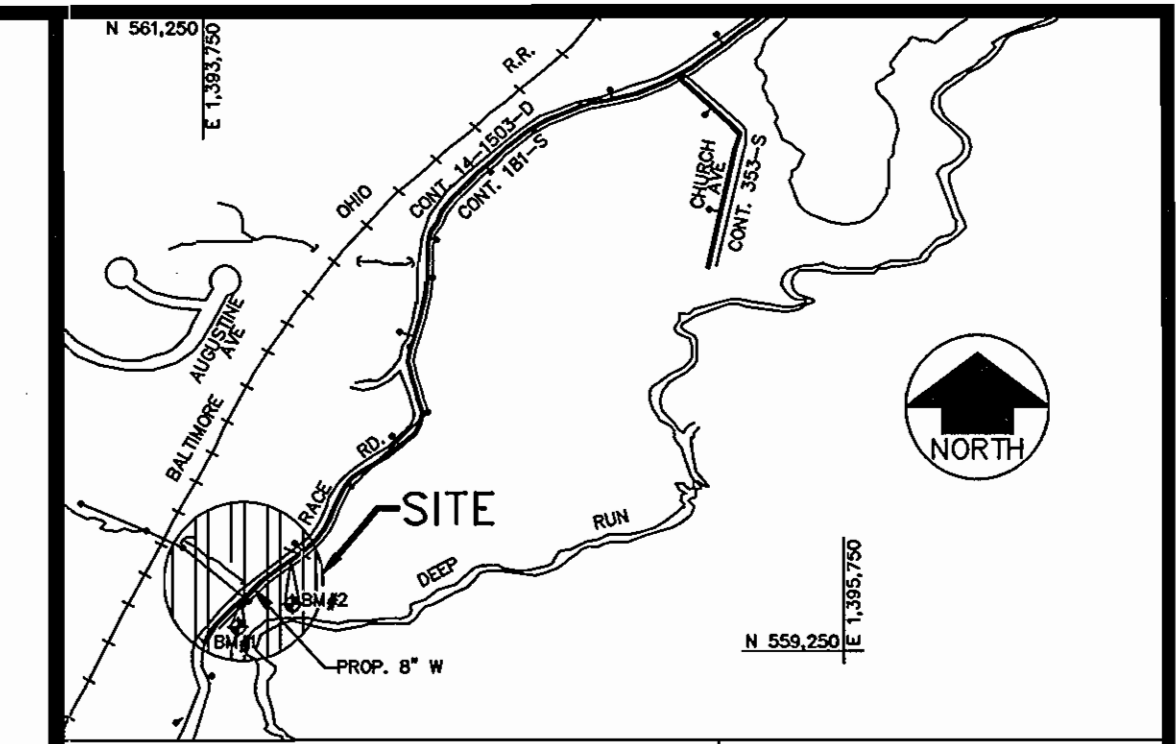

TYPE OF BUILDING: COMMERCIAL
NUMBER OF PARCELS: 1
WATER HOUSE CONNECTIONS: 1
DRAINAGE AREA: PATAPSCO

WATER CODE FOR COUNTY USE ONLY:
WATER No: A04

TEMPORARY SEEDING NOTES

APPLY TO GRADED OR CLEARED AREAS LIKELY TO BE REDISTURBED WHERE A SHORT-TERM VEGETATIVE COVER IS NEEDED.

SEEDBED PREPARATION: LOOSEN UPPER THREE INCHES OF SOIL BY RAKING, DISKING OR OTHER ACCEPTABLE MEANS BEFORE SEEDING, IF NOT PREVIOUSLY LOOSENED.

SOIL AMENDMENTS: - APPLY 60 LBS PER ACRE 10-10-10 FERTILIZER (14 LBS/1000 SQ FT.), SEED WITH 2-1/2 BUSHEL PER ACRE OF ANNUAL RYE (3.2 LBS/1000 SQ FT.). FOR THE PERIOD MAY 1 THRU AUGUST 14, SEED WITH 3 LBS PER ACRE OF WEEPING LOVEGRASS (.07 LBS/1000 SQ FT.). FOR THE PERIOD NOVEMBER 1 THRU FEBRUARY 28, PROTECT SITE BY APPLYING 2 TONS PER ACRE OF WELL ANCHORED STRAW MULCH AND SEED AS SOON AS POSSIBLE IN THE SPRING, OR USE SOD.

MULCHING: - APPLY 1-1/2 TO 2 TONS PER ACRE (70 TO 90 LBS/1000 SQ FT.) OF UNROTTED SMALL GRASS STRAW IMMEDIATELY AFTER SEEDING. ANCHOR MULCH IMMEDIATELY AFTER APPLICATION USING MULCH ANCHORING TOOL OR 218 GAL PER ACRE (5 GAL/1000 SQ FT.) OF EMULSIFIED ASPHALT ON FLAT AREAS. ON SLOPES 8 FT OR HIGHER, USE 348 GAL PER ACRE (8 GAL/1000 SQ FT.) FOR ANCHORING.

REFER TO THE 1994 MARYLAND STANDARDS AND SPECIFICATIONS FOR SOIL EROSION AND SEDIMENT CONTROL FOR RATE AND METHODS NOT COVERED.

GENERAL NOTES

- APPROXIMATE LOCATION OF EXISTING MAINS ARE SHOWN. THE CONTRACTOR SHALL TAKE ALL NECESSARY PRECAUTIONS TO PROTECT EXISTING MAINS AND SERVICES AND MAINTAIN UNINTERRUPTED SERVICE. ANY DAMAGE INCURRED SHALL BE REPAIRED IMMEDIATELY TO THE SATISFACTION OF THE ENGINEER AT THE CONTRACTOR EXPENSE.
- ALL HORIZONTAL CONTROLS ARE BASED ON MARYLAND STATE COORDINATES.
- ALL VERTICAL CONTROLS ARE BASED ON U.S.G.S. DATA.
- ALL PIPE ELEVATIONS SHOWN ARE INVERT ELEVATIONS UNLESS OTHERWISE NOTED ON THE PLANS.
- CLEAR ALL UTILITIES BY A MINIMUM OF 6". CLEAR ALL POLES BY 2'-0" MINIMUM OR TUNNEL AS REQUIRED. THE OWNER HAS CONTACTED THE UTILITY COMPANIES AND HAS MADE ARRANGEMENTS FOR BRACING OF POLES AS SHOWN ON THE DRAWINGS. IN THE EVENT THE CONTRACTOR'S WORK REQUIRES THE BRACING OF ADDITIONAL POLES, ANY COST INCURRED BY THE OWNER FOR THE BRACING OF ADDITIONAL POLES OR DAMAGES SHALL BE DEDUCTED FROM MONEY OWED THE CONTRACTOR. THE CONTRACTOR SHALL COORDINATE WITH THE UTILITY COMPANIES TO SCHEDULE THE BRACING OF THE POLES.
- FOR DETAILS NOT SHOWN ON THE DRAWINGS, AND FOR MATERIALS AND CONSTRUCTION METHODS, USE HOWARD COUNTY DESIGN MANUAL, VOLUME IV, STANDARD SPECIFICATIONS AND DETAILS FOR CONSTRUCTION (LATEST EDITION). THE CONTRACTOR SHALL HAVE A COPY OF VOLUME IV ON THE JOB.
- WHERE TEST PITS HAVE BEEN MADE ON EXISTING UTILITIES, THEY ARE NOTED BY THE SYMBOL [] AT THE LOCATION OF THE TEST PIT. A NOTE OR NOTES CONTAINING THE RESULTS OF THE TEST PIT OR PITS IS INCLUDED ON THE DRAWINGS. EXISTING UTILITIES IN THE VICINITY OF THE PROPOSED WORK FOR WHICH TEST PITS HAVE NOT BEEN DUG SHALL BE LOCATED BY THE CONTRACTOR TWO WEEKS IN ADVANCE OF CONSTRUCTION OPERATIONS AT HIS OWN EXPENSE.
- CONTRACTOR SHALL NOTIFY THE FOLLOWING UTILITY COMPANIES OR AGENCIES AT LEAST FIVE WORKING DAYS BEFORE STARTING WORK SHOWN ON THESE PLANS:

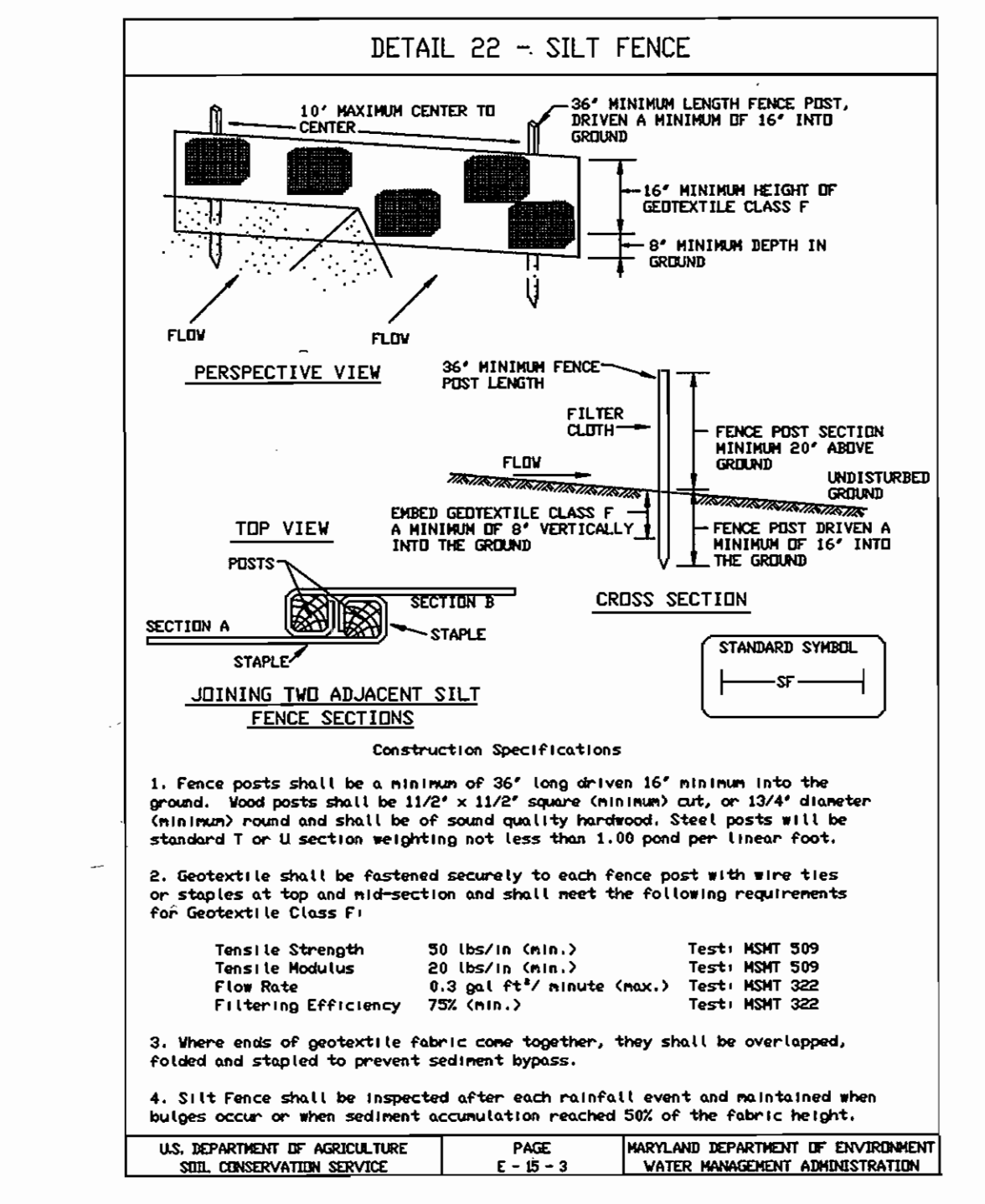
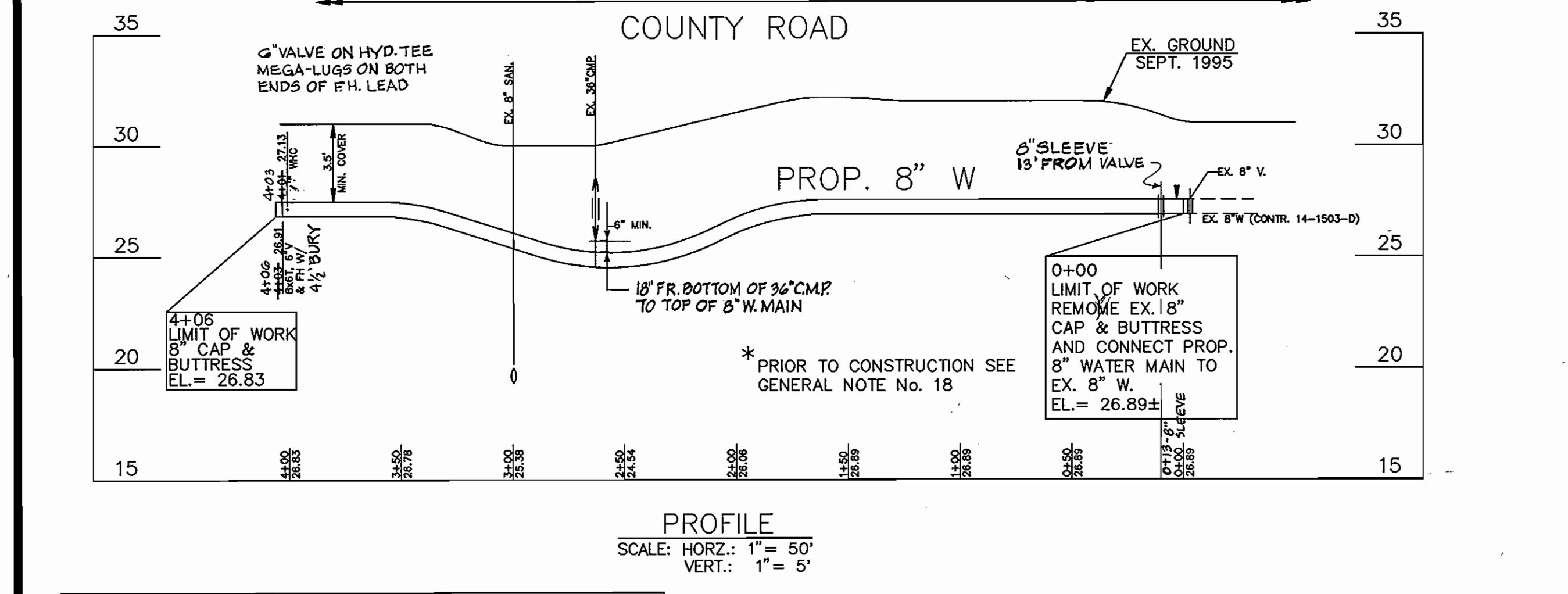

STANDARD SEDIMENT CONTROL NOTES

- A MINIMUM OF 24 HOURS MUST BE GIVEN TO THE HOWARD COUNTY OFFICE OF INSPECTIONS AND PERMITS, PRIOR TO THE START OF ANY CONSTRUCTION (410-313-1855).
- ALL VEGETATIVE AND STRUCTURAL PRACTICES ARE TO BE INSTALLED ACCORDING TO THE PROVISIONS OF THIS PLAN AND ARE TO BE IN CONFORMANCE WITH SECTION 219 OF THE HOWARD COUNTY STANDARDS AND SPECIFICATIONS.
- FOLLOWING INITIAL SOIL DISTURBANCE OR REDISTURBANCE, PERMANENT OR TEMPORARY STABILIZATION SHALL BE COMPLETED WITHIN:
 - 7 CALENDAR DAYS FOR ALL PERIMETER SEDIMENT CONTROL STRUCTURES, DIKES, PERIMETER SLOPES AND ALL SLOPES GREATER THAN 3:1.
 - 14 DAYS AS TO ALL OTHER DISTURBED OR GRADED AREAS ON THE PROJECT SITE.
- ALL SEDIMENT TRAPS/BASINS SHOWN MUST BE FENCED AND WARNING SIGNS POSTED AROUND THEIR PERIMETER IN ACCORDANCE WITH VOL. I, CHAPTER 12, OF THE HOWARD COUNTY DESIGN MANUAL, STORM DRAINAGE.
- ALL DISTURBED AREAS MUST BE STABILIZED WITHIN THE TIME PERIOD SPECIFIED ABOVE IN ACCORDANCE WITH THE 1991 MARYLAND STANDARDS AND SPECIFICATIONS FOR SOIL EROSION AND SEDIMENT CONTROL FOR PERMANENT SEEDINGS (Sec. 51), SOD (Sec. 52), TEMPORARY SEEDING (Sec. 50) AND MULCHING (Sec. 52). TEMPORARY STABILIZATION WITH MULCH ALONE CAN ONLY BE DONE WHEN RECOMMENDED SEEDING DATES DO NOT ALLOW FOR PROPER GERMINATION AND ESTABLISHMENT OF GRASSES.
- ALL SEDIMENT CONTROL STRUCTURES ARE TO REMAIN IN PLACE AND ARE TO BE MAINTAINED IN OPERATIVE CONDITION UNTIL PERMISSION FOR THEIR REMOVAL HAS BEEN OBTAINED FROM THE HOWARD COUNTY SEDIMENT CONTROL INSPECTOR.
- SITE ANALYSIS:**

TOTAL AREA OF SITE	NA	ACRES
AREA DISTURBED	0.19	ACRES
AREA TO BE ROOFED OR PAVED	0	ACRES
AREA TO BE GRAVELLED	0	ACRES
TOTAL CUT	180	CU. YDS.
TOTAL FILL	180	CU. YDS.
OFFSITE WASTE/BORROW AREA LOCATION	NA	
- ANY SEDIMENT CONTROL PRACTICE WHICH IS DISTURBED BY GRADING ACTIVITY FOR PLACEMENT OF UTILITIES MUST BE REPAIRED ON THE SAME DAY OF THE DISTURBANCE.
- ADDITIONAL SEDIMENT CONTROLS MUST BE PROVIDED, IF DEEMED NECESSARY BY THE HOWARD COUNTY SEDIMENT CONTROL INSPECTOR.
- ON ALL SITES WITH DISTURBED AREAS IN EXCESS OF 2 ACRES, APPROVAL OF THE INSPECTION AGENCY SHALL BE REQUESTED UPON COMPLETION OF PERIMETER EROSION AND SEDIMENT CONTROLS, BUT BEFORE PROCEEDING WITH ANY OTHER EARTH DISTURBANCE OR GRADING. OTHER BUILDING OR GRADING INSPECTION APPROVALS MAY NOT BE AUTHORIZED UNTIL THIS INITIAL APPROVAL BY THE INSPECTION AGENCY IS MADE.
- TRENCHES FOR THE CONSTRUCTION OF UTILITIES IS LIMITED TO THREE (3) PIPE LENGTHS OR THAT WHICH CAN BE BACK FILLED AND STABILIZED WITHIN ONE WORKING DAY, WHICHEVER IS SHORTER.
- CONTRACTOR SHALL PLACE EXCAVATED MATERIALS ON UPHILL SIDE OF TRENCH AND PLACE SILT FENCE ON DOWNHILL SIDE OF TRENCH.
- REFER TO CONTRACT SPECIFICATIONS (PROJECT MANUAL) FOR SEEDING NOTES.

QUANTITIES

ITEM	UNIT	ESTIMATE	AS-BUILT	MATERIAL SUPPLIER
8" W	L.F.	406	406	D.L.P. - WATER PRO
1" W	L.F.	22	24	COPPER - WATER PRO
4" VALVE	EA.	1	1	MUELLER - WATER PRO
6" SLEEVE	EA.	1	1	MUELLER - WATER PRO
8" G-TEE	EA.	19	18	D.L.P. - WATER PRO
8" CAP & BUTTRESS	EA.	1	1	D.L.P. - WATER PRO
6" VALVE	EA.	1	1	MUELLER - WATER PRO

NAME OF UTILITY CONTRACTOR: W.F. WILSON & SONS R.S.G.V.

CHECKBOX
AS-BUILT DATE: _____
SURVEY AND DRAFTING DIVISION

STAKEOUT SCHEDULE

STRUCTURE	DISTANCE (SSM #26 TO SSM #27)	OFFSET
PC 0+00	3+65.52	Lt. 2.35'
LIMIT OF WORK		
0+49.94	3+15.68	Lt. 0.25'
1+00	2+66.05	Lt. 6.36'
1+61.14		Lt. 13.83'
P.O.C	2+05.31	Lt. 13.83'
2+00	1+66.58	Lt. 16.93'
8" W		
2+62.08	1+04.58	Lt. 14.99'
P.O.T.		
3+00		
0+66.88	0+66.88	Lt. 11.24'
4+00		
8" W	-0+32.63	Lt. 1.32'
4+01		
WHC	-0+33.41	Lt. 1.24'
WHC @ PL.	-0+35.61	Lt. 23.14'
4+03		
8x6T	-0+35.61	Lt. 1.03'
4+04		
8x6T	-0+35.61	Lt. 1.03'
4+05		
8x6T	-0+37.47	Lt. 19.60'
4+06		
CAP & BUTTRESS		
LIMIT OF WORK	5+34.04	Lt. 12.90'

DEVELOPER'S CERTIFICATION

"I/WE CERTIFY THAT ALL DEVELOPEMENT AND CONSTRUCTION WILL BE DONE ACCORDING TO THIS PLAN, AND THAT ANY RESPONSIBLE PERSONNEL INVOLVED IN THE CONSTRUCTION PROJECT WILL HAVE A CERTIFICATE OF THE ENVIRONMENT APPROVED TRAINING PROGRAM FOR THE CONTROL OF SEDIMENT AND EROSION BEFORE BEGINNING THE PROJECT. I ALSO AUTHORIZE PERIODIC ON-SITE INSPECTION BY THE HOWARD SOIL CONSERVATION DISTRICT."

Robert E. Has 10/23/95
BUREAU OF ENGINEERING
DEPARTMENT OF PUBLIC WORKS

ENGINEER'S CERTIFICATION

"I/WE CERTIFY THAT ALL DEVELOPEMENT AND CONSTRUCTION WILL BE DONE ACCORDING TO THIS PLAN, AND THAT ANY RESPONSIBLE PERSONNEL INVOLVED IN THE CONSTRUCTION PROJECT WILL HAVE A CERTIFICATE OF THE ENVIRONMENT APPROVED TRAINING PROGRAM FOR THE CONTROL OF SEDIMENT AND EROSION BEFORE BEGINNING THE PROJECT. I ALSO AUTHORIZE PERIODIC ON-SITE INSPECTION BY THE HOWARD SOIL CONSERVATION DISTRICT."

Timothy W. Wolfe 10/23/95
TIMOTHY W. WOLFE
SPOTS, STEVENS & MCCOY, INC.
555 FARMOUNT AVENUE, SUITE 230
TOWSON, MARYLAND 21284

REVIEWED FOR HOWARD S.C.D. AND MEETS TECHNICAL REQUIREMENTS.
Robert E. Has 10/23/95
U.S. NATURAL RESOURCES CONSERVATION SERVICE

THIS DEVELOPEMENT PLAN IS APPROVED FOR THE SOIL EROSION & SEDIMENT CONTROL BY THE HOWARD COUNTY SOIL CONSERVATION DISTRICT.
Timothy W. Wolfe 10/23/95
APPROVEE DATE
HOWARD COUNTY S.C.D.

- SEQUENCE OF CONSTRUCTION**
- OBTAIN GRADING PERMIT.
 - LAYOUT ALIGNMENT AT SITE. (1 DAY)
 - INSTALL SEDIMENT CONTROL DEVICE (SILT FENCE) ALONG EDGE OF PAVEMENT ON EAST SIDE OF RACE ROAD WITHIN THE WORK LIMITS. (1 DAY)
 - EXCAVATE DITCH TO THE GRADE SPECIFIED ON THE PROFILE. (30 DAYS)
 - INSTALL WATER MAIN. (30 DAYS)
 - BACKFILL TRENCH SAME DAY AND RESURFACE WITH BITUMINOUS PAVING WHERE NEEDED (3 DAYS).
 - CLEAN UP CONSTRUCTION SITE. (1 DAY)
 - REMOVE SEDIMENT CONTROL DEVICES AFTER PERMISSION IS GRANTED BY THE SEDIMENT CONTROL INSPECTOR. (1 DAY)

RESTORATION SCHEDULE

LOCATION	DISTANCE	TYPE
0+0 TO 4+06	406 L.F.	PAVING
WHC & 6" W	15.66 L.F.	PAVING
WHC, 6" W & FH	6.34 L.F.	SEEDING

NOTE: SEDIMENT CONTROL TO BE IMPLEMENTED IN ACCORDANCE WITH SECTION 219 OF THE STANDARDS AND SPECIFICATIONS (VOL.IV) OF THE HOWARD COUNTY DESIGN MANUAL AND THIS PLAN.

DEPARTMENT OF PUBLIC WORKS
HOWARD COUNTY, MARYLAND

James J. Williams 10/23/95
DIRECTOR OF PUBLIC WORKS
DATE

Robert E. Has 10-26-95
10-26-95
CHIEF, BUREAU OF UTILITIES
DATE

Robert E. Has 10/23/95
10-23-95
CHIEF, WATER AND SEWER DESIGN DIVISION
DATE

SSM
SPOTS, STEVENS & MCCOY, INC.
ENGINEERS & SURVEYORS & SCIENTISTS
555 FARMOUNT AVENUE, STE. 230
TOWSON, MARYLAND 21286-3497
(410)484-0500 FAX (410)296-3560

STATE OF MARYLAND
DEPARTMENT OF PUBLIC WORKS
REGISTERED PROFESSIONAL ENGINEER
TIMOTHY W. WOLFE
1023

DES:	DRN:	CHK:	DATE:	BY:	NO.:	REVISION	DATE:
FCL	FCL	TWW	OCT. '95				

8-INCH WATER MAIN
PLAN, PROFILE & NOTES
RACE ROAD

600' SCALE MAP NO. 37 BLOCK NO. 10

RACE ROAD WATER EXTENSION
CAPITAL PROJECT No. W-8695
CONTRACT No. 44-3477
ELECTION DISTRICT No. 1
HOWARD COUNTY, MARYLAND

SCALE AS SHOWN
SHEET 1 OF 1
FILE NAME: B013

AS-BUILT 7/24/96