

ROWANBERRY DR.
 1- TO 8" V. @ STA. 0+94-04'
 1- TO 8" V. @ STA. 0+03-05'
 8" V. @ STA. 0+14 TO 8" V. @ STA. 0+03-04'

ELKRIDGE ELDERLY PARKING LOT
 6" F.H.V. @ STA. 1+24 TO F.H.-0'
 6" F.H.V. @ STA. 1+24 TO 8" V. (WHQ)-16'
 6" F.H.V. @ STA. 1+24 TO 8" V. (WHQ)-19'

NOTE: THE CONTRACTOR SHALL EXCAVATE A TEST PIT TO DETERMINE THE "AS-BUILT" LOCATION & ELEVATION OF THE END OF THE EX. 8" WATER MAIN WITHIN ROWANBERRY DRIVE PRIOR TO INSTALLATION OF ANY WATER MAIN. THE CONTRACTOR SHALL FORWARD THE RESULTS OF THE TEST PIT DETERMINATION TO THE ENGINEER FOR REVIEW.

8" PLUG 1 OUTLETS; LIMIT OF XIM CONSTRUCTION THIS CONTRACT

LIMIT OF PAVING (F 95-120)

CHIMNEY MASTS - 60 FT

REMOVE 8" PLUG AND BUTTRESS CONNECT TO EX. 8" WATER MAIN SEE NOTE THIS SHEET

ELKRIDGE LIBRARY SITE

ELKRIDGE PUBLIC LIBRARY

THIS DEVELOPMENT IS APPROVED FOR EROSION AND SEDIMENT CONTROL BY HOWARD COUNTY DEPARTMENT OF PUBLIC WORKS.

APPROVED: *Patricia Eng* 5/5/15
 HOWARD SOIL CONSERVATION DISTRICT DATE

SEDIMENT CONTROL MEASURES FOR THIS CONTRACT WILL BE IMPLEMENTED IN ACCORDANCE WITH SECTION 219 OF THE HOWARD COUNTY DESIGN MANUAL & STANDARDS AND SPECIFICATIONS FOR SOIL EROSION AND SEDIMENT CONTROL IN DEVELOPING AREAS AND ALSO AS SHOWN ON THE GRADING AND SEDIMENT CONTROL PLAN SDP 95-66 (F 95-120)

REVIEWED FOR HOWARD COUNTY SOIL CONSERVATION DISTRICT 2000 METERS TECHNICAL REQUIREMENTS
John R. Blanton
 SOIL NATURAL RESOURCES CONSERVATION SERVICE DATE

APPROVED: *Paul W. Rain* 05/04/95
 SIGNATURE OF DEVELOPER DATE
 for Surface Development Construction

DEPARTMENT OF PUBLIC WORKS
 HOWARD COUNTY, MARYLAND

Paul W. Rain 5/8/95
 DIRECTOR OF PUBLIC WORKS DATE
Michael A. ... 5-2-95
 CHIEF, BUREAU OF UTILITIES DATE

John R. Blanton 5/8/95
 CHIEF, LAND DEVELOPMENT DIVISION DATE

FISHER, COLLINS & CARTER, INC.
 CIVIL ENGINEERING CONSULTANTS & LAND SURVEYORS
 SUITE 100, 9171 BALTIMORE NATIONAL PIKE
 ELLICOTT CITY, MARYLAND 21042
 (410) 461-2855

#9757
 DES: M.J.M.
 DRWN: L.A./J.M.M.
 CHK: P.W.K.
 DATE: _____
 BY NO. _____ REVISION _____ DATE _____

600' SCALE MAP NO. 38 BLOCK NO. 7

ELKRIDGE ELDERLY
 PARCEL "A"
 CONTRACT NO. 14-3304-D
 FIRST ELECTION DISTRICT
 HOWARD COUNTY, MARYLAND

SCALE AS SHOWN
 SHEET 1 OF 2
 ELKTS.DWG

QUANTITIES			
ITEM	ESTIMATED QUANTITIES	AS-BUILT TYPE	OUTLIER
B" SENICIS (BID)	120 L.F.	116	GRIFFIN PERGUSON ENT.
B" SENICIS	125 L.F.	117	PRE-CAST ATLANTIC PRECAST
MANHOLES	3 EACH	3	GRIFFIN PERGUSON ENT.
B" WATER	402 L.F.	360	KENNEDY PERGUSON ENT.
G" WATER	12 L.F.	11	I.M. PAELING PERGUSON ENT.
FIRE HYDRANTS	1 EACH	1	
B" VALVES	3 EACH	3	
G" VALVES	1 EACH	1	

NAME OF UTILITY CONTRACTOR:
 SURVEYING & DRAFTING DIVISION AS-BUILT DATE:

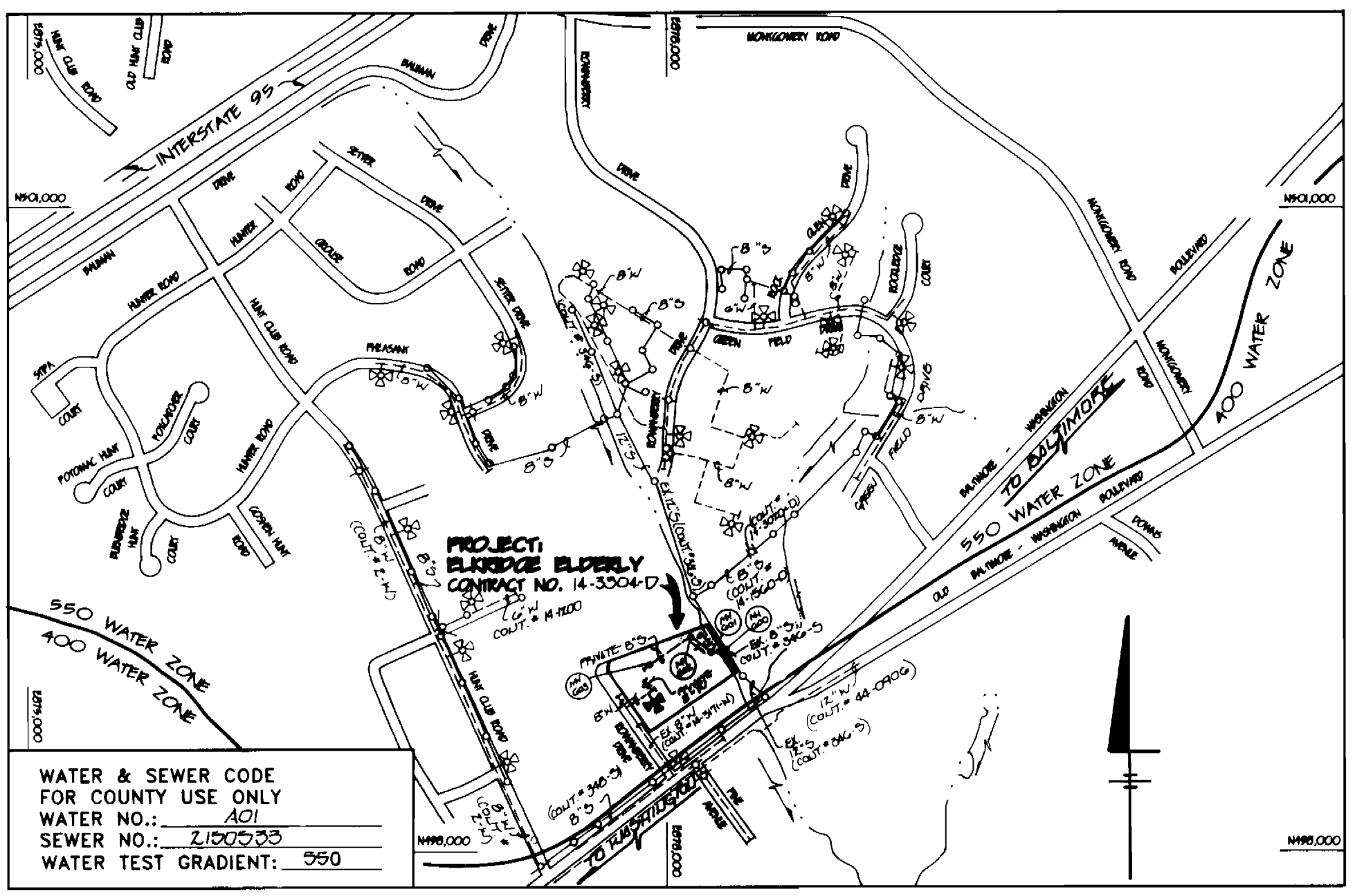

WATER & SEWER CODE FOR COUNTY USE ONLY
 WATER NO.: ACI
 SEWER NO.: 11007005
 WATER TEST GRADIENT: .950

TYPE OF BUILDING: 100 APARTMENT UNITS
 NUMBER OF PARCELS: 1
 NO. OF WATER HOUSE CONNECTIONS: 1
 NO. OF SEWER HOUSE CONNECTIONS: 1
 DRAINAGE AREA: PATAPSCO
 TREATMENT PLANT: PATAPSCO WASTEWATER TREATMENT PLANT; CITY OF BALTIMORE

VICINITY MAP

SCALE: 1"=600'

GENERAL NOTES

- APPROXIMATE LOCATION OF EXISTING MAINS ARE SHOWN. THE CONTRACTOR SHALL TAKE ALL NECESSARY PRECAUTIONS TO PROTECT EXISTING MAINS AND SERVICES AND MAINTAIN UNINTERRUPTED SUPPLY. ANY DAMAGE INCURRED SHALL BE REPAIRED IMMEDIATELY TO THE SATISFACTION OF THE ENGINEER AT THE CONTRACTOR'S EXPENSE.
- ALL HORIZONTAL CONTROLS ARE BASED ON MARYLAND STATE COORDINATES.
- ALL VERTICAL CONTROLS ARE BASED ON U.S.G.S. DATUM.
- ALL PIPE ELEVATIONS ARE INVERT ELEVATIONS.
- CLEAR ALL UTILITIES BY A MINIMUM OF 6". CLEAR ALL POLES BY 2'-0" MINIMUM OR TUNNEL AS REQUIRED.
- FOR DETAILS NOT SHOWN ON THE DRAWINGS, AND FOR MATERIALS AND CONSTRUCTION METHODS, USE HOWARD COUNTY DESIGN MANUAL, VOLUME IV, STANDARD SPECIFICATIONS AND DETAILS FOR CONSTRUCTION (1991 AMENDMENTS) THE CONTRACTOR SHALL HAVE A COPY OF VOLUME IV ON THE JOB SITE.
- WHERE TEST PITS HAVE BEEN MADE ON EXISTING UTILITIES, THEY ARE NOTED BY THE SYMBOL AT THE LOCATION OF THE TEST PIT. A NOTE OR NOTES CONTAINING THE RESULTS OF THE TEST PIT OR PITS IS INCLUDED ON THE DRAWINGS. EXISTING UTILITIES IN THE VICINITY OF THE PROPOSED WORK FOR WHICH TEST PITS HAVE NOT BEEN DUG SHALL BE VERIFIED BY THE CONTRACTOR TO HIS OWN SATISFACTION. ANY DAMAGE TO EXISTING FACILITIES DUE TO THE CONTRACTOR'S NEGLIGENCE SHALL BE REPAIRED AT THE CONTRACTOR'S EXPENSE.
- CONTRACTOR SHALL NOTIFY THE FOLLOWING UTILITIES OR AGENCIES AT LEAST FIVE WORKING DAYS BEFORE STARTING WORK SHOWN ON THESE PLANS:
 STATE HIGHWAY ADMINISTRATION - 531-5533
 BALTIMORE GAS & ELECTRIC CO. - CONTRACTOR SERVICES - 850-4620
 BALTIMORE GAS & ELECTRIC CO. - UNDER GROUND DAMAGE CONTROL - 787-9068
 MISS UTILITY - 1-800-257-7777
 COLONIAL PIPELINE CO. - 795-1390
 BUREAU OF UTILITIES, HOWARD COUNTY DEPARTMENT OF PUBLIC WORKS - 313-4900
- TREES AND SHRUBS ARE TO BE PROTECTED FROM DAMAGE TO MAXIMUM EXTENT. TREES AND SHRUBS LOCATED WITHIN THE CONSTRUCTION STRIP ARE NOT TO BE REMOVED OR DAMAGED BY THE CONTRACTOR.
- CONTRACTOR SHALL REMOVE TREES, STUMPS AND ROOTS ALONG THE LINE OF EXCAVATION. PAYMENT FOR SUCH REMOVAL SHALL BE INCLUDED IN THE UNIT PRICE BID FOR CONSTRUCTION OF THE MAIN.
- ALL SEWER MAINS SHALL BE D.I.P. OR P.V.C. UNLESS OTHERWISE NOTED.
- ALL MANHOLES SHALL BE 4'-0" INSIDE DIAMETER UNLESS OTHERWISE NOTED.
- T.B. DENOTES TEST BORING.
- MANHOLES SHOWN WITH 12" AND 16" WALLS ARE FOR BRICK MANHOLES ONLY.
- MANHOLES DESIGNATED W.T. IN PLAN AND PROFILE SHALL HAVE WATERTIGHT FRAME AND COVERS, STANDARD DETAIL G 5.52.
- WHERE WATERTIGHT MANHOLE FRAME AND COVER IS USED, SET TOP OF FRAME 1'-6" ABOVE FINISHED GRADE UNLESS OTHERWISE NOTED ON THE PLANS OR IN THE SPECIFICATIONS.
- HOUSE(S) WITH THE SYMBOL "C.N.S." INDICATES THAT THE CELLAR CANNOT BE SERVED.
- ALL WATER HOUSE CONNECTIONS SHALL BE FOR INSIDE METER SETTING, UNLESS OTHERWISE NOTED ON THE PLANS OR IN THE SPECIFICATIONS.
- MANHOLES LOCATED WITHIN THE PROPOSED ROADWAY SHALL HAVE STANDARD HEAVY TRAFFIC MANHOLE FRAMES AND COVERS, STANDARD DETAIL G5.51.
- WATER MAINS AND WATER HOUSE CONNECTION LINES MUST BE PLACED AS TO HAVE ONE (1) FOOT SEPARATION FROM THE SEWER MAIN OR SEWER HOUSE CONNECTION AS THEY PASS ABOUT IT.
- ALL WATER MAINS SHALL BE D.I.P., CLASS 52 UNLESS OTHERWISE NOTED.
- TOPS OF ALL WATER MAINS TO HAVE A MINIMUM OF 3'-1/2' COVER UNLESS OTHERWISE NOTED.
- VALVES ADJACENT TO TEES SHALL BE STRAPPED TO TEES.
- ALL FITTINGS SHALL BE BUTTRESSED OR ANCHORED WITH CONCRETE IN ACCORDANCE WITH THE STANDARD DETAILS UNLESS OTHERWISE PROVIDED FOR ON THE DRAWINGS.
- FIRE HYDRANTS SHALL BE SET TO THE BURY LINE ELEVATION SHOWN ON THE DRAWINGS. ALL FIRE HYDRANTS SHALL BE RESTRAINED AND BUTTRESSED WITH CONCRETE IN ACCORDANCE WITH THE STANDARD DETAILS (W1.11 AND W2.13). SOIL AROUND THE FIRE HYDRANT SHALL BE COMPACTED IN ACCORDANCE WITH SECTION 1000 AND 1005 OF THE STANDARD SPECIFICATIONS.
- THE CONTRACTOR SHALL NOT OPERATE ANY WATER MAIN VALVES ON THE EXISTING WATER SYSTEM.
- ALL D.I.P. FITTINGS SHALL BE IN ACCORDANCE WITH AWWA SPECIFICATIONS C-153; DUCTILE IRON COMPACT FITTINGS, 3-INCH THROUGH 12-INCH FOR WATER AND OTHER LIQUIDS.
- THE CONTRACTOR SHALL NOTIFY THE BUREAU OF HIGHWAYS, HOWARD COUNTY, (410) 313-2450 AT LEAST FIVE WORKING DAYS BEFORE ANY OPEN CUT OF ANY COUNTY ROAD OR BORING/JACKING OPERATION IN COUNTY ROADS FOR LAYING WATER/SEWER MAINS OR HOUSE CONNECTIONS. THE APPROVAL OF THESE DRAWINGS WILL CONSTITUTE COMPLIANCE WITH DPW REQUIREMENTS PER SECTION 18.114(a) OF THE HOWARD COUNTY CODE.

SEE SHEET 2 FOR PROFILES OF WATER & SEWER MAINS

PLAN
 SCALE 1"=60'

PLAN REFERENCE NUMBERS:
 30P 95-66
 F 95-120

DEPARTMENT OF PUBLIC WORKS
 HOWARD COUNTY, MARYLAND
Paul W. Rain 5/8/95
 DIRECTOR OF PUBLIC WORKS DATE
Michael A. ... 5-2-95
 CHIEF, BUREAU OF UTILITIES DATE

FISHER, COLLINS & CARTER, INC.
 CIVIL ENGINEERING CONSULTANTS & LAND SURVEYORS
 SUITE 100, 9171 BALTIMORE NATIONAL PIKE
 ELLICOTT CITY, MARYLAND 21042
 (410) 461-2855

#9757
 DES: M.J.M.
 DRWN: L.A./J.M.M.
 CHK: P.W.K.
 DATE: _____
 BY NO. _____ REVISION _____ DATE _____

600' SCALE MAP NO. 38 BLOCK NO. 7

PLAN VIEW
 WATER & SEWER MAINS

ELKRIDGE ELDERLY
 PARCEL "A"
 CONTRACT NO. 14-3404-D
 FIRST ELECTION DISTRICT
 HOWARD COUNTY, MARYLAND

ws/1 ELKRIDGE ELDERLY 3404

3404 ws/2 ELKRIDGE ELDERLY

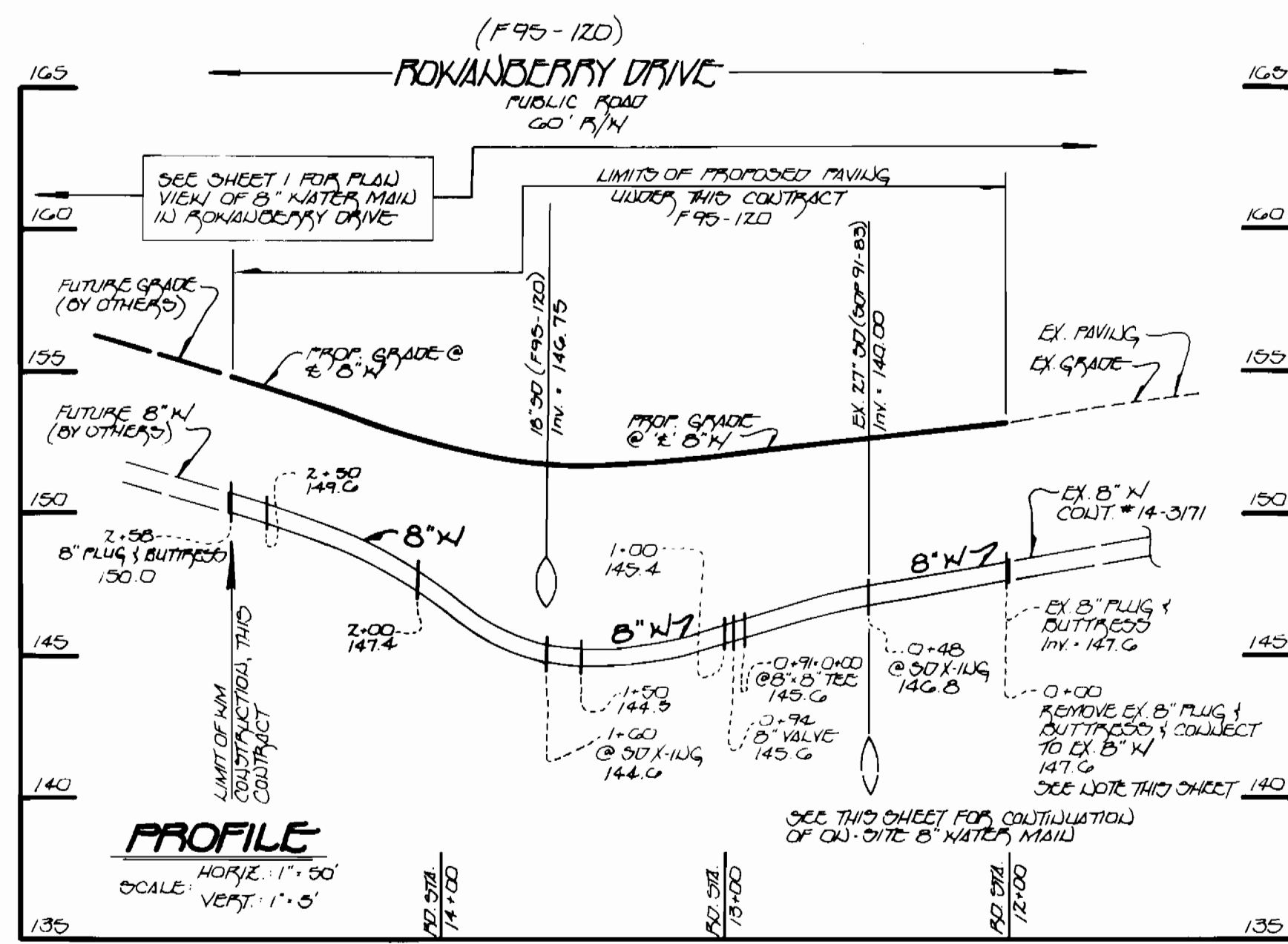

NOTE: THE CONTRACTOR SHALL EXCAVATE A TEST PIT TO DETERMINE THE LOCATION & ELEVATION OF THE EXISTING 8" WATER MAIN UNDER ROWANBERRY DRIVE. PRIOR TO INSTALLATION OF ANY WATER MAIN, THE CONTRACTOR SHALL FORWARD THE RESULTS OF THE TEST PIT INFORMATION TO THE ENGINEER FOR REVIEW.

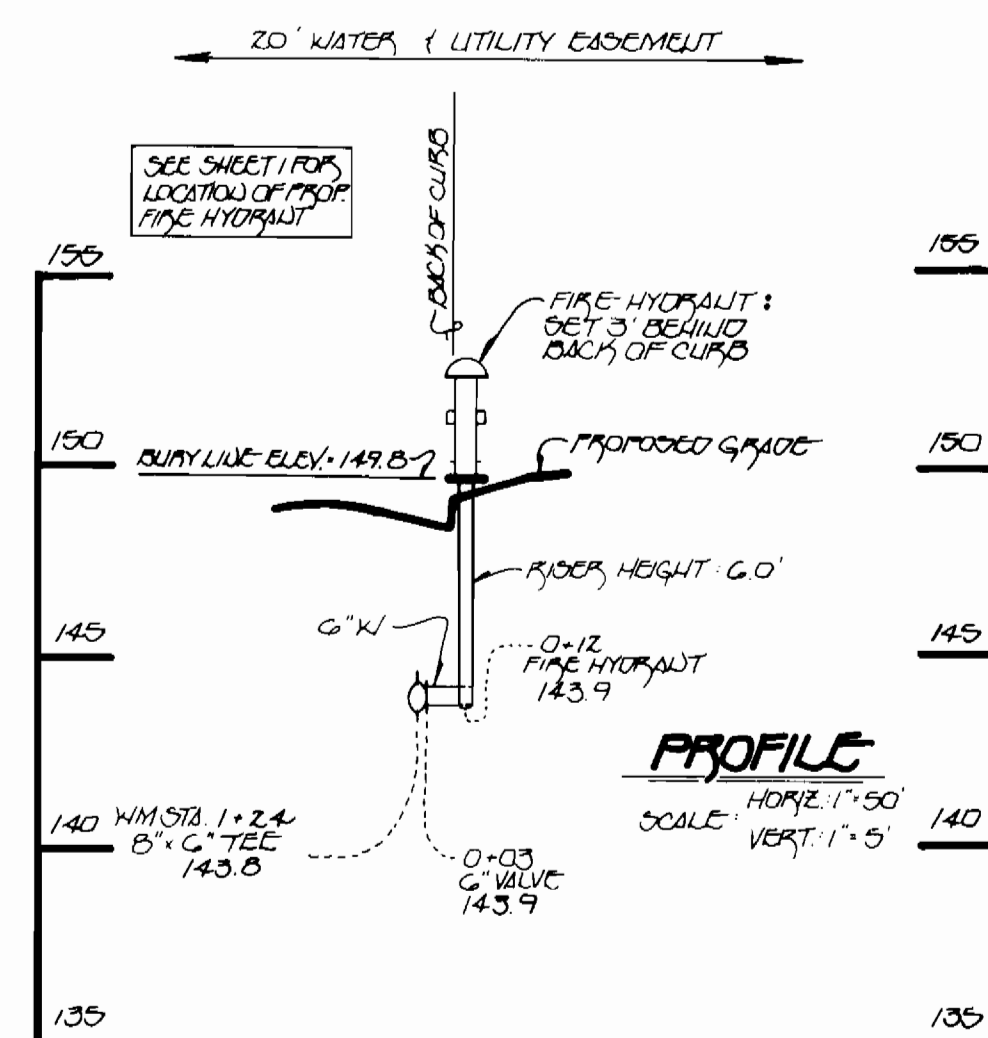

8" WATER : ROWANBERRY DRIVE

6" FIRE HYDRANT

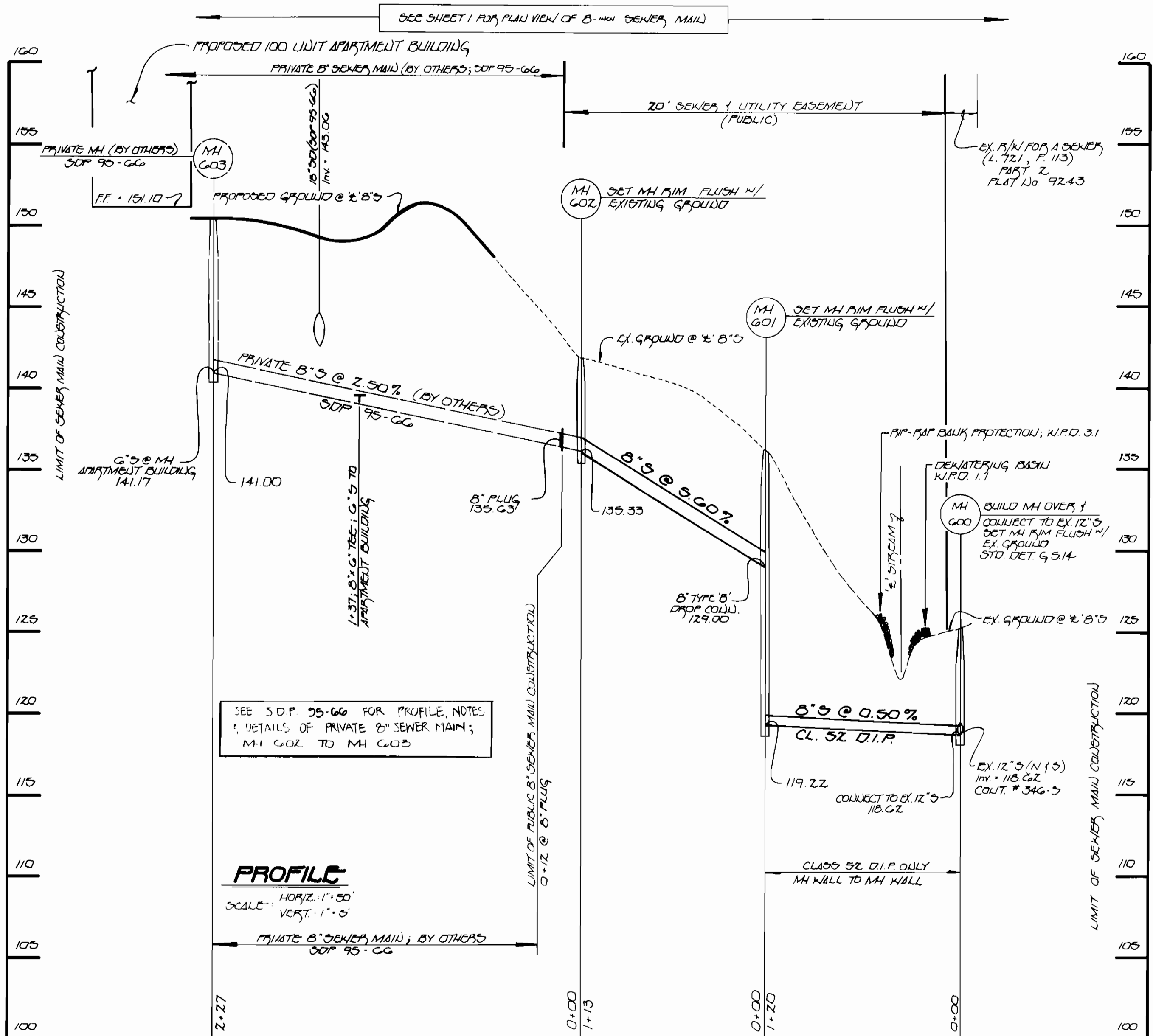

8" SEWER TO SERVICE PROPOSED BUILDING

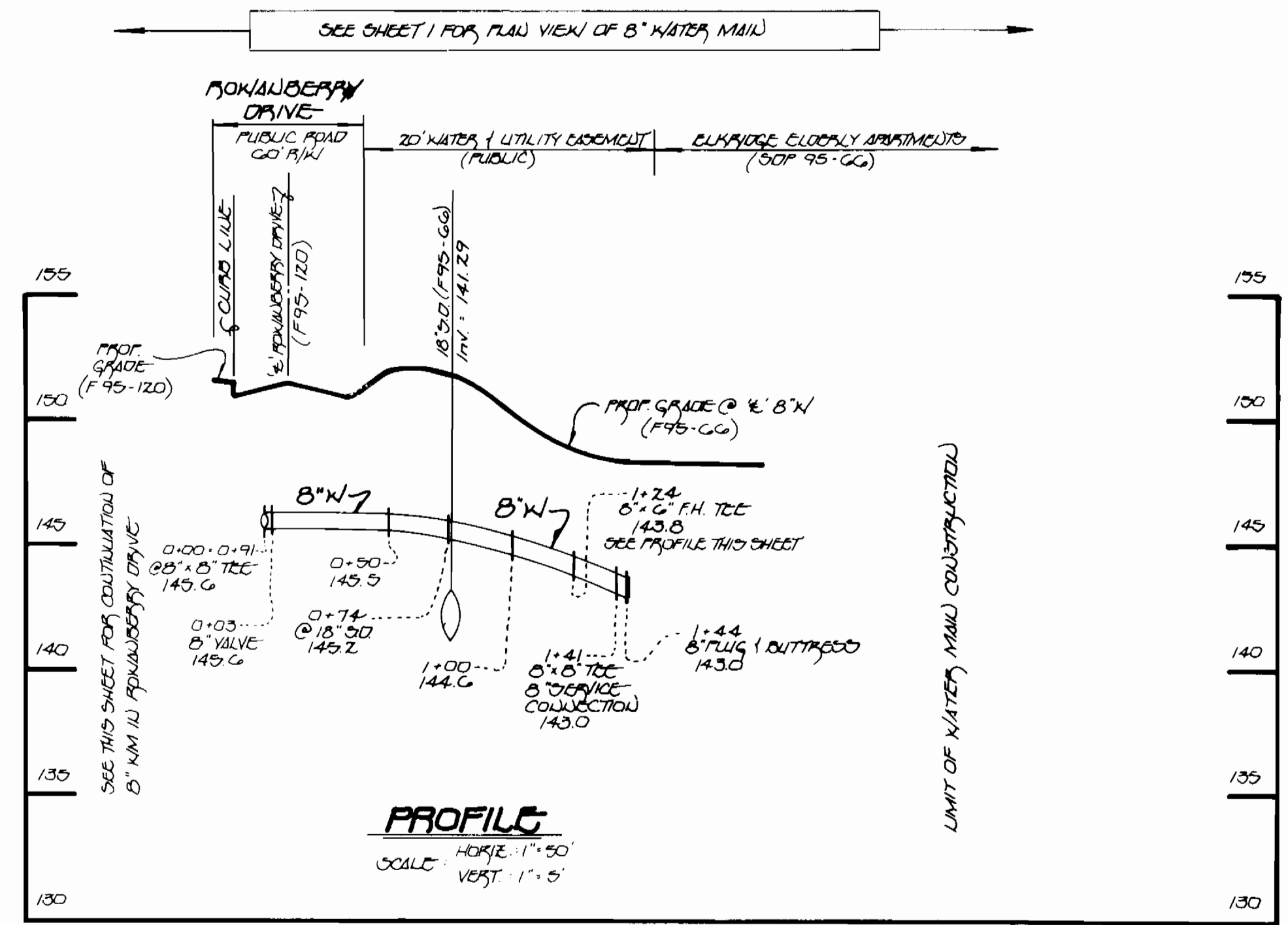

8" WATER : ENTRANCE ROADWAY/20' PUBLIC WATER & UTILITY EASEMENT

CONTRACT NO. - 14-3304-D
ELKRIDGE ELDERLY
PARCEL "A"
WATER AND SEWER EXTENSIONS
HOWARD COUNTY, MARYLAND

DEPARTMENT OF PUBLIC WORKS
HOWARD COUNTY, MARYLAND
5/8/95
5-2-95

FISHER, COLLINS & CARTER, INC.
CIVIL ENGINEERING CONSULTANTS & LAND SURVEYORS
SUITE 100, 9171 BALTIMORE NATIONAL PIKE
ELLCOTT CITY, MARYLAND 21042
(410) 461-2855

#9757
TERRELL A. FISHER

DES:	M.J.M.
DRWN:	J.M.M.
CHK:	P.W.K.
DATE:	
BY:	NO.
REVISION:	
DATE:	

PROFILES
WATER & SEWER MAINS
600' SCALE MAP NO. 38 BLOCK NO. 7

ELKRIDGE ELDERLY
PARCEL "A"
CONTRACT NO. 14-3404 D
FIRST ELECTION DISTRICT
HOWARD COUNTY, MARYLAND

SCALE AS SHOWN
SHEET 2 OF 2
UTSHEET.DWG