

PROFILE
HOR. 1"=50'
VERT. 1"=5'

QUANTITIES				
ITEM	UNIT	ESTIMATE	AS-BUILT	SUPPLIER
8" SEWER	L.F.	186		
STD MANHOLE	EA.	1		
4" S.H.C.	L.F.	80		

RESTORATION SCHEDULE		
LOCATION	DISTANCE	TYPE
EX. MH 2 TO S-3	190'	PAVING
STA. 0+55 (S.H.C.)	20'	10' PAVING, 10' SEED
S.H.C. (#9108)	40'	28' PAVING, 12' SEED
S.H.C. (#9109)	20'	10' PAVING, 10' SEED

STAKEOUT SCHEDULE		
MANHOLE	DISTANCE	OFFSET
S-3	H.E.C. F-105 TO H.E.C. F-1043, STA. 1+00	LT. 11

SURVEY CONTROL

- HOWARD COUNTY STATION 17F1
CONC. MON. @ SURF 22' N. NORTH OF
C.L. RD. 66' E. OF CHAPEL AVE.
NORTH (89): 101,609,265 (M)
EAST (89): 415,470,180 (M)
ELEV.: 470.186
- HOWARD COUNTY STATION 17-FA
CONC. MON. 24.1' NORTH OF & RTE. 99,
3.5' N. OF N. EDGE OF ROAD
NORTH (89): 101,340,693 (M)
EAST (89): 415,939,08 (M)
ELEV.: N/A
- H.E.C. TRAVERSE PT. F-104
1/2" I.P. & CAP
NORTH: 596,275.76
EAST: 1,360,604.51, ELEV.: 480.95
- H.E.C. TRAVERSE PT. F-105
P.K. # SHINER
NORTH: 596,948.56
EAST: 1,360,971.13, ELEV.: 483.23
- H.E.C. TRAVERSE PT. F-106
1/2" I.P. & CAP
NORTH: 596,159.75
EAST: 1,361,130.78, ELEV.: N/A

SEQUENCE OF CONSTRUCTION

- Contact Howard County Bureau of Construction Inspection (792-7272) prior to starting date.
- Install erosion and sediment control devices as per Section 219 of the Howard County Design Manual Vol. III
- Excavate and install proposed 8" Sewer Main and 4" S.H.C.
- Restore paving and earth trenches to their original condition as per Howard County Standards.
- Upon permission from Howard County Sediment Control Inspector, remove Sediment Control Devices.
- Final grade all disturbed areas and stabilize with permanent seeding.
- Trees and shrubs are to be protected from damage to the maximum extent. Trees and shrubs located within the construction strip are not to be removed or damaged by the Contractor.
- Contractor shall remove trees, stumps and roots along line of excavation. Payment for such removal shall be included in the unit price for construction of the main and service connections.
- All sewer mains shall be C.S.P.X., R.C.S.P., V.C.P.X., or P.V.C. unless otherwise noted.
- The contractor shall provide a joint in all sewer mains within 2'-0" of exterior manhole wall.
- All manholes shall be 4'-0" inside diameter unless otherwise noted.
- Trench repair to be in accordance with Howard County Standard Details.
- All work will be in accordance with Howard County Standards and Specifications for Soil Erosion and Sediment Control Section 219.
- Length of open trench will be limited to that which can be filled and stabilized within one working day.

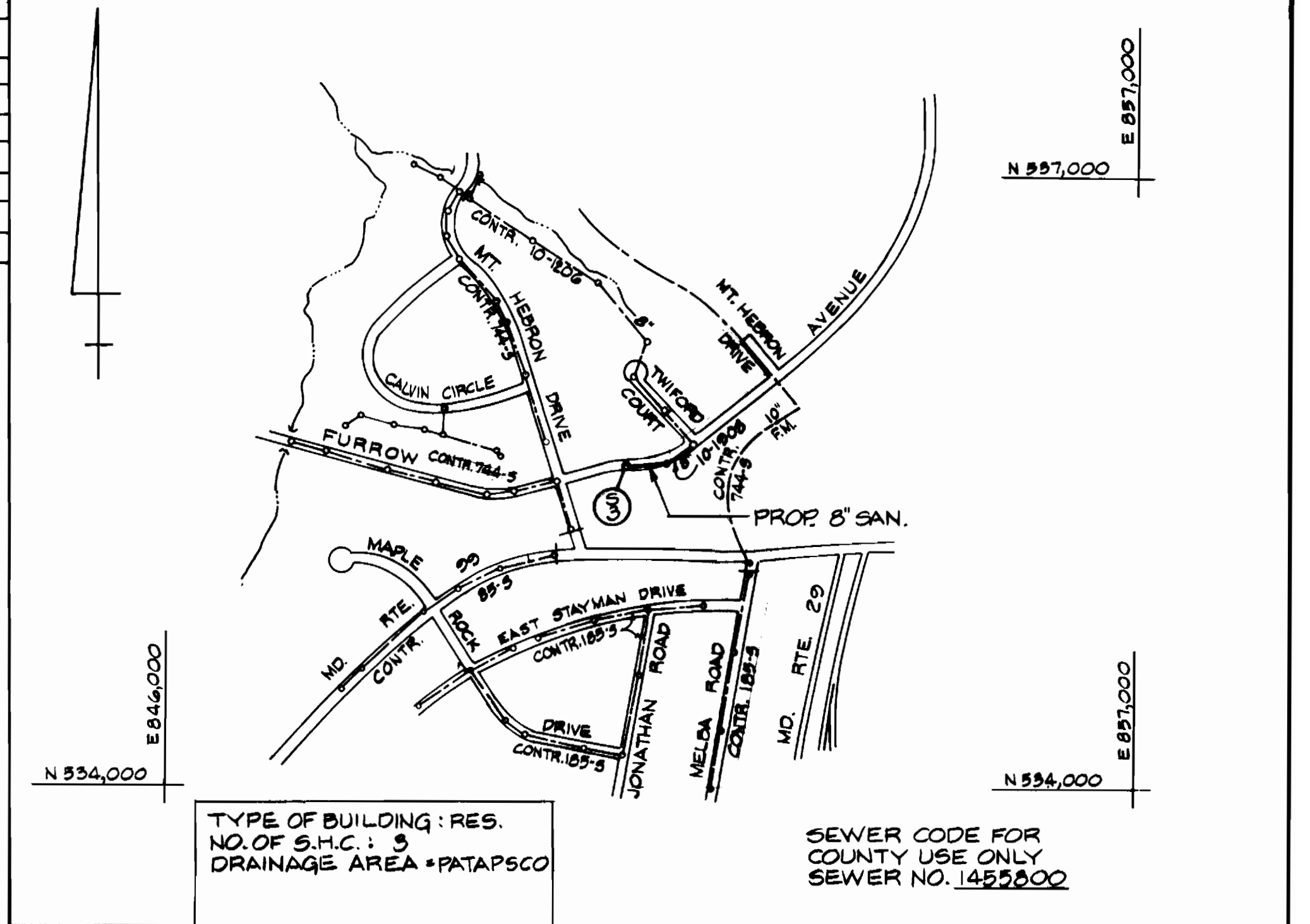

VICINITY MAP
SCALE: 1"=600'

GENERAL NOTES

- Approximate location of existing mains are shown. The Contractor shall take all necessary precautions to protect existing mains and services and maintain uninterrupted supply. Any damage incurred shall be repaired immediately to the satisfaction of the Engineer at the Contractor's expense.
- All Horizontal Controls shown are based on Maryland State Coordinates.
- All Vertical Controls are based on U.S.G.S. Datum.
- All pipe elevations shown are invert elevations.
- Clear all utilities by a minimum of 6'. Clear all poles by 2'-0" minimum or tunnel as required.
- For details not shown on the Drawings, and for materials and construction methods, use Howard County Design Manual, Volume II, Standard Specification and Details for Construction. The Contractor shall have a copy of Volume II on the job.
- Where test pits have been made on existing utilities, they are noted by the symbol [X] at location of test pit. A note or notes containing the results of the test pit or pits is included on the drawings. Existing utilities in the vicinity of the proposed work for which tests have not been dug shall be located by the Contractor two weeks in advance of Construction Operations at the Contractor's expense.
- The Contractor shall notify the following utility companies or agencies at least five working days prior to starting work on this plan:

C&P Telephone Company	597-8565
State Highway Administration	531-5533
Baltimore Gas & Electric Co. Contractor Service	850-4620
Baltimore Gas & Electric Co. Underground Damage Control	859-9004
Baltimore Gas & Electric Co. Trouble Shooting	258-9004
MIS UTILITY	1-800-257-7777
Colonial Pipeline	755-1330
Bureau of Utilities, Howard County Dept. of Public Works	315-4800

REVIEWED FOR HOWARD SOIL CONSERVATION DISTRICT AND MEETS TECHNICAL REQUIREMENTS
 APPROVED: *[Signature]* DATE: 4/19/92
 CHIEF, BUREAU OF ENGINEERING

DEPARTMENT OF PUBLIC WORKS
 HOWARD COUNTY, MARYLAND
 DIRECTOR OF PUBLIC WORKS: *[Signature]* DATE: 10/14/92
 CHIEF, BUREAU OF ENGINEERING: *[Signature]* DATE: 10-14-92
 CHIEF, WATER & SEWER DESIGN DIVISION: *[Signature]* DATE: 10-7-92

HICKS ENGINEERING CO., INC.
 ENGINEERS · SURVEYORS · PLANNERS
 200 E. JOPPA ROAD · SUITE #02
 TOWSON MARYLAND 21204

DES: E.A.S.			
DRN: F.W.			
CHK: E.A.S.			
DATE: 9-10-92	BY: NO.	REVISION	DATE

CONTRACT NO. 10-3234
 600' SCALE MAP NO. 17 BLOCK NO. 11

FURROW AVENUE SEWER MAIN
 ELECTION DISTRICT NO. 2
 HOWARD COUNTY, MARYLAND
 CAPITAL PROJECT S-6177
 SCALE AS SHOWN
 SHEET 1 OF 1