

INDEX OF SHEETS	
SHEET NO.	TITLE
1	TITLE SHEET
2	PLAN VIEW
3	PROFILE
4	PROFILE

WATER AND SEWER EXTENSIONS PLEASANT CHASE

SECTION ONE 6TH ELECTION DISTRICT HOWARD COUNTY, MARYLAND PHASE ONE (CONTRACT NO. 24-3201-D)

QUANTITIES				
ITEMS	QUANTITIES ESTIMATED	AS-BUILT		
		QUANTITIES	TYPE	MANUFACTURER/SUPP.
8" WATER	2090 L.F.	2090 L.F.	L.F.	GRIFFIN PIPE
6" WATER	92 L.F.	40 L.F.	L.F.	GRIFFIN PIPE
1" WHC.	630 L.F.	630 L.F.	"K" PIPER	HO-WELL METALS
6" SEWER	1527 L.F.	1523 L.F.	PVC	JM MANUFACTURING
4" SHC.	1800 L.F.	1800 L.F.	PVC	JM MANUFACTURING
FIRE HYDRANT	3	3 EA.		MILLER
6" VALVES	10	10 EA.		MILLER
6" VALVES	3	3 EA.		MILLER
MANHOLES	7 @ 20" V.F.	7EA.	FREIGHT	WATSON
AIR RELEASE MANHOLE	1 EA. 45" V.F.	1EA.	FREIGHT	WATSON
1 1/2" WHC.	980 L.F.	980 L.F.	"K" PIPER	HO-WELL METALS
NAME OF UTILITY CONTRACTOR: _____				
SURVEY & DRAFTING DIV. AS-BUILT DATA				

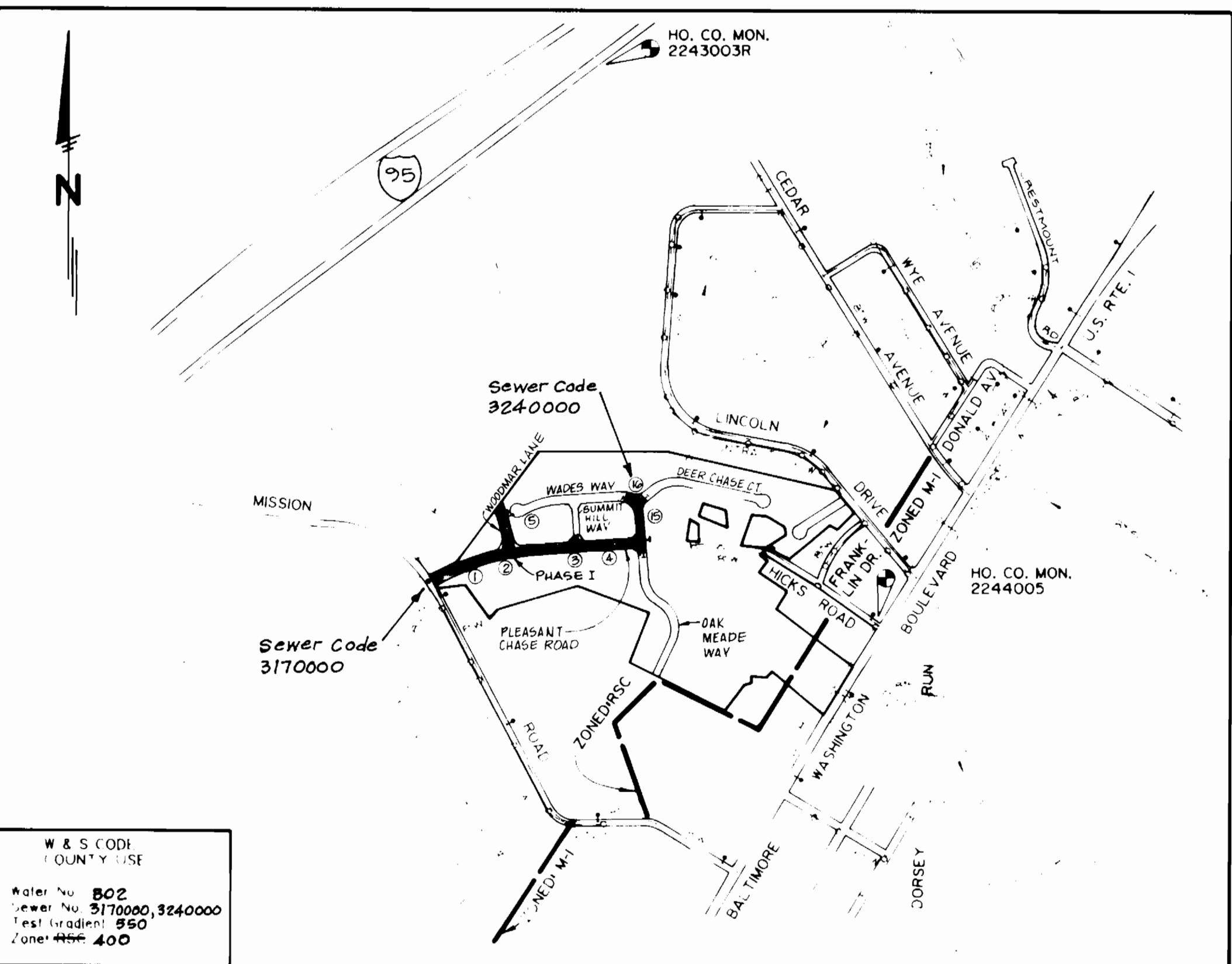

VICINITY MAP
SCALE: 1" = 600'

- GENERAL NOTES**
- APPROXIMATE LOCATION OF EXISTING MAINS ARE SHOWN. THE CONTRACTOR SHALL TAKE ALL NECESSARY PRECAUTIONS TO PROTECT EXISTING MAINS AND SERVICES AND MAINTAIN UNINTERRUPTED SUPPLY. ANY DAMAGES INCURRED SHALL BE REPAIRED IMMEDIATELY TO THE SATISFACTION OF THE ENGINEER AT THE CONTRACTOR'S EXPENSE.
 - ALL HORIZONTAL CONTROLS ARE BASED ON MARYLAND STATE COORDINATES.
 - ALL VERTICAL CONTROLS ARE BASED ON U.S.C.G.S. DATA.
 - ALL PIPE ELEVATIONS SHOWN ARE INVERT ELEVATIONS.
 - CLEAR ALL UTILITIES BY A MINIMUM OF 6" CLEAR. ALL POLES BY 2' MINIMUM OR TUNNEL AS REQUIRED. THE OWNER HAS CONTACTED THE UTILITY COMPANIES AND HAS MADE ARRANGEMENTS FOR THE LOG OF POLES AS SHOWN ON THE DRAWINGS. IN THE EVENT THE CONTRACTOR'S WORK REQUIRES THE BRACING OF ADDITIONAL POLES, ANY COST INCURRED BY THE OWNER FOR BRACING OF ADDITIONAL POLES OR DAMAGES SHALL BE DEDUCTED FROM MONEY OWED TO THE CONTRACTOR. THE CONTRACTOR SHALL COORDINATE WITH THE UTILITY COMPANIES TO SCHEDULE THE BRACING OF THE POLES.
 - FOR DETAILS NOT SHOWN ON THE DRAWINGS, AND FOR MATERIALS AND CONSTRUCTION METHODS USE HOWARD COUNTY DESIGN MANUAL, VOLUME IV, STANDARD SPECIFICATIONS AND DETAIL FOR CONSTRUCTION, (LATEST EDITION). THE CONTRACTOR SHALL HAVE A COPY OF VOLUME IV ON THE JOB.
 - WHERE TEST PITS HAVE BEEN MADE ON EXISTING UTILITIES, THEY ARE NOTED BY THE SYMBOL AT THE LOCATION OF THE TEST PIT. A NOTE OR NOTES CONTAINING THE RESULTS OF THE TEST PIT OR PITS IS INCLUDED ON THE DRAWINGS. EXISTING UTILITIES IN THE VICINITY OF THE PROPOSED WORK FOR WHICH TEST PITS HAVE NOT BEEN DUG SHALL BE LOCATED BY THE CONTRACTOR TWO WEEKS IN ADVANCE OF CONSTRUCTION OPERATIONS AT HIS OWN EXPENSE. CONTRACTOR SHALL NOTIFY THE FOLLOWING UTILITY COMPANIES OR AGENCIES AT LEAST FIVE WORKING DAYS BEFORE STARTING WORK SHOWN ON THESE PLANS:
STATE HIGHWAY ADMINISTRATOR 531-5133
BALTIMORE GAS & ELECTRIC CONTRACTOR SERVICES 856-4626
BALTIMORE GAS & ELECTRIC UNDERGROUND DAMAGE 717-9068
CONTROL
MINS UTILITY 1-800-257-7777
COLORADO PIPELINE CO. 795-1390
BUREAU OF UTILITIES, HOWARD COUNTY
DEPARTMENT OF PUBLIC WORKS 313-4900
 - TREES AND SHRUBS ARE TO BE PROTECTED FROM DAMAGE TO MAXIMUM EXTENT. TREES AND SHRUBS LOCATED WITHIN THE CONSTRUCTION STRIP ARE NOT TO BE REMOVED OR DAMAGED BY THE CONTRACTOR. CONTRACTOR SHALL REMOVE TREES, STUMPS AND ROOTS ALONG LINE OF EXCAVATION. PAYMENT FOR SUCH REMOVAL SHALL BE INCLUDED IN THE UNIT PRICE BID FOR CONSTRUCTION OF THE MAIN.
 - ALL WATER MAINS TO BE D.I.P. CLASS 50 UNLESS OTHERWISE NOTED.
 - TOP OF ALL WATER MAINS TO HAVE A MINIMUM OF 3' 11" COVER UNLESS OTHERWISE NOTED.
 - VALVES ADJACENT TO TREES SHALL BE STAPLED TO TREES.
 - ALL FITTINGS SHALL BE BUTTRESSED OR A CHAMFER WITH CONCRETE IN ACCORDANCE WITH THE STANDARD DETAILS UNLESS OTHERWISE PROVIDED FOR ON THE DRAWINGS.
 - FIRE HYDRANTS SHALL BE SET TO THE GROUND ELEVATIONS SHOWN ON THE DRAWINGS. ALL FIRE HYDRANTS SHALL BE PROPERLY REINFORCED WITH CONCRETE IN ACCORDANCE WITH STANDARD DETAILS. SOIL AROUND THE FIRE HYDRANT SHALL BE COMPACTED IN ACCORDANCE WITH SECTION 1302 AND 1305 OF THE STANDARD SPECIFICATIONS.
 - THE CONTRACTOR SHALL NOT OPERATE ANY WATER MAIN VALVES ON THE EXISTING WATER SYSTEM.
 - ALL WATER HOUSE CONNECTIONS SHALL BE FOR INSIDE METER SETTING UNLESS OTHERWISE NOTED ON PLANS OR IN SPECIFICATION.
 - ALL SEWER MAINS SHALL BE 24", 30", 36", 42", 48" AND 60" UNLESS OTHERWISE NOTED.
 - THE CONTRACTOR SHALL PROVIDE A 12" X 12" X 12" BRICK MANHOLE WITH A 12" X 12" X 12" BRICK MANHOLE AT THE EXTERIOR MANHOLE JUNCTION.
 - ALL MANHOLES SHALL BE 4'-0" INSIDE DIAMETER UNLESS OTHERWISE NOTED.
 - FORCE MAINS SHALL BE D.I.P. ONLY.
 - MANHOLES SHOWN WITH 12" AND 18" X 18" X 18" ARE FOR BRICK MANHOLES UNLESS OTHERWISE NOTED.
 - MANHOLES DESIGNATED W.T. IN PLAN AND PROFILE SHALL HAVE WATER-TIGHT FRAME AND COVER, STANDARD DETAIL 05.52. WHERE WATER-TIGHT FRAME AND COVER IS USED, SET TOP OF FRAME 1" ABOVE FINISHED GRADE UNLESS OTHERWISE NOTED ON DRAWINGS.
 - HOUSE(S) WITH THE SYMBOL "C.W.S." INDICATES THAT CELLAR CANNOT BE SERVED.
 - THE CONTRACTOR SHALL NOTIFY THE BUREAU OF HIGHWAYS, HOWARD COUNTY, AT (410) 318-2450 AT LEAST FIVE WORKING DAYS BEFORE ANY OPEN CUT OF ANY COUNTY ROAD OR BORING/JACKING OPERATION IN COUNTY ROADS FOR LAYING WATER/SEWER MAINS OR HOUSE CONNECTIONS. THE APPROVAL OF THESE DRAWINGS WILL CONSTITUTE COMPLIANCE WITH OPW REQUIREMENTS PER SECTION 10.114(a) OF THE HOWARD COUNTY CODE.

Sediment control measures for the contract will be implemented in accordance with Section 219 of the Specifications and as shown on **P-92-14c**.

HOWARD SOIL CONSERVATION DISTRICT

Review for Howard Soil Conservation District and meets technical requirements.

Patricia Engle / *JM* 5/6/94
U.S. SOIL CONSERVATION SERVICE DATE

This plan is approved for soil erosion and sediment control by the Howard Soil Conservation District.

John R. Roberts 5/6/94
HOWARD SOIL CONSERVATION DISTRICT DATE

THESE REVISED WATER AND SEWER CONSTRUCTION PLANS (SHEETS 1 THRU 4) CONTRACT 24-3201-D PLEASANT CHASE SECTION I PHASE I, WILL SUPERSEDE THE WATER AND SEWER CONSTRUCTION PLANS APPROVED AND SIGNED BY THE DIRECTOR OF PUBLIC WORKS ON 11/17/92.

HOWARD COUNTY MONUMENT NO. 2244003R ELEV. 217.572
FLUSH 2.5' EAST OF EAST EDGE MACADAM OF NORTH BOUND LANE
N 487448.365 E 856755.255

HOWARD COUNTY MONUMENT NO. 2244005 ELEV. 217.572
2' BELOW SURFACE, 10.8' WEST OF NAIL & CAP ON EDGE
MACADAM SOUTH BOUND LANE
N 485175.968 E 859142.539

TYPE OF BUILDING: SINGLE FAMILY
NO OF LOTS/PARCELS: 30
NO OF WATER USE CONNECTIONS: 31
NO OF SEWER USE CONNECTIONS: 31
DRAINAGE AREA: DORSEY, LITTLE PATUXENT VIA DORSEY PUMPING STATION
NAME OF TREATMENT PLANT: LITTLE PATUXENT WATER QUALITY MANAGEMENT CENTER SAVAGE, HOWARD COUNTY

DEPARTMENT OF PUBLIC WORKS HOWARD COUNTY, MARYLAND <i>James R. Lewis</i> 5/10/93 DIRECTOR OF PUBLIC WORKS DATE <i>John R. Roberts</i> 5-3-94 CHIEF, BUREAU OF UTILITIES DATE		LAND SERVICES GROUP, INC. ENGINEERS • PLANNERS • SURVEYORS 7601 BROADLAND PARKWAY, SUITE 100 COLUMBIA, MARYLAND 21046 <i>John R. Roberts</i> 5/26/94 DATE		DATE: 3-92 BY: NO. REVISION: 1 DATE: 600' SCALE MAP NO. 43 BLOCK NO.		TITLE SHEET	PHASE ONE PLEASANT CHASE SECTION ONE 6TH ELECTION DISTRICT HOWARD COUNTY, MARYLAND CONT. 24-3201-D AS-BUILT 5/28/94	SCALE AS SHOWN SHEET 1 OF 4
--	--	---	--	---	--	--------------------	--	--------------------------------

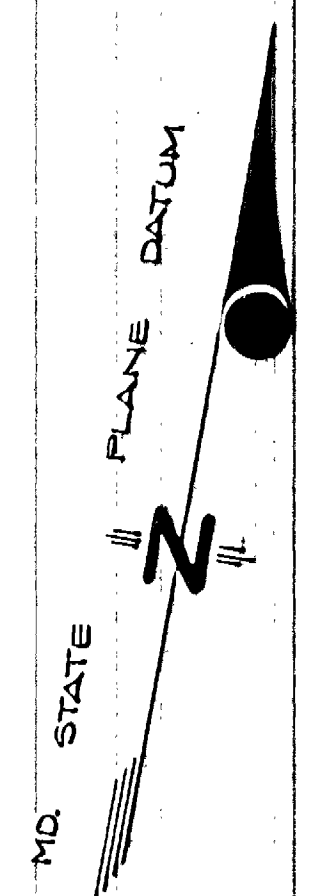
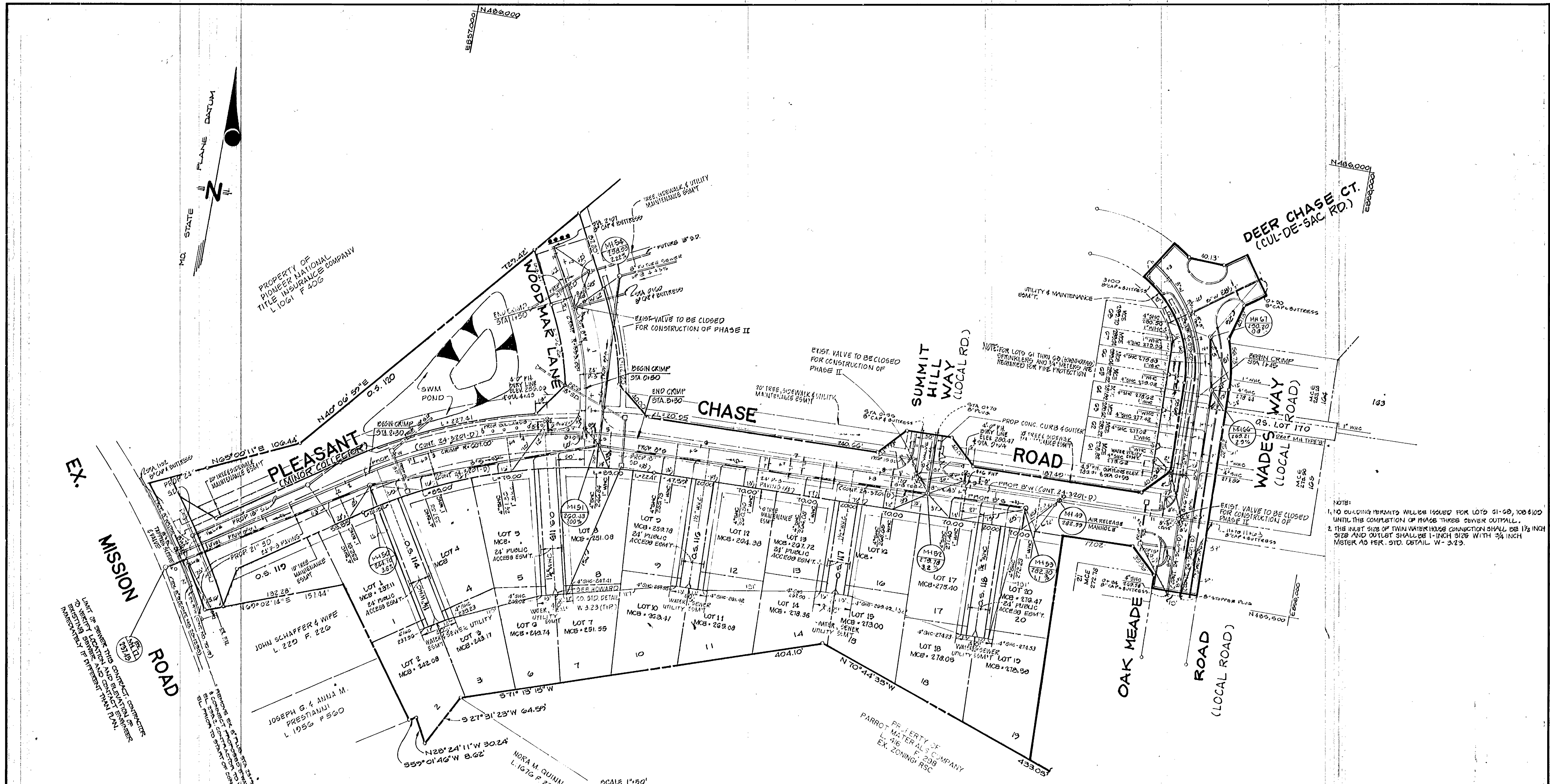

PROPERTY OF
PIONEER NATIONAL
TITLE INSURANCE COMPANY
L 1061 F 406

PLEASANT CHASE
MINOR COLLECTOR

CHASE

ROAD

DEER CHASE CT.
(CUL-DE-SAC RD.)

SUMMIT HILL WAY
(LOCAL RD.)

WAES WAY
(LOCAL ROAD)

OAK MEADE ROAD
(LOCAL ROAD)

EX. MISSION ROAD

- NOTES:
- NO BUILDING PERMITS WILL BE ISSUED FOR LOTS 21-60, 108-100 UNTIL THE COMPLETION OF PHASE THREE SEWER CUTFALL.
 - THE INLET SIZE OF TWIN WATERHOUSE CONNECTION SHALL BE 1 1/2 INCH SIZE AND OUTLET SHALL BE 1-INCH SIZE WITH 3/4 INCH METER AS PER STD. DETAIL W-323.

SCALE 1"=50'

MANHOLE TABLE	
NO.	LOCATION
50	T' RIGHT OF C STA 2131 PLEASANT CHASE RD.
51	T' RIGHT OF C STA 4+00 " " "
52	T' RIGHT OF C STA 8+00 " " "
53	T' RIGHT OF C STA 9+16 " " "
54	SS RIGHT OF C STA 1+67 WOODMAR LN.
55	T' RIGHT OF C STA 1+54 WAES WAY
56	T' RIGHT OF C STA 2+11 " " "

DEPARTMENT OF PUBLIC WORKS
HOWARD COUNTY, MARYLAND

James M. Chew 5/10/94
DIRECTOR OF PUBLIC WORKS DATE

Robert J. Brown 5/10/94
CHIEF, BUREAU OF ENGINEERING DATE

Robert J. Brown 5/3/94
CHIEF, BUREAU OF UTILITIES DATE

John M. Quinn 5/10/94
CHIEF, LAND DEVELOPMENT DATE

LAND SERVICES GROUP, INC.

ENGINEERS & PLANNERS & SURVEYORS
200 BROADLAND PARKWAY SUITE 200
COLLEGE PARK, MARYLAND 21048

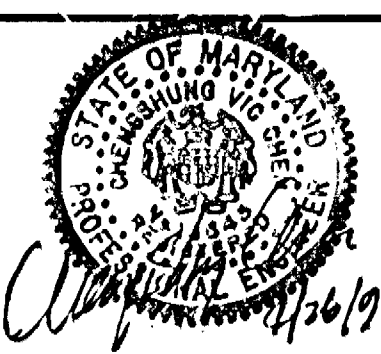

DES: J.P.H.					
DRW: M.E.S.					
CHK: B.B.S.					
DATE: 3-92	BY NO.	REVISION	DATE		

PLAN OF
WATER AND SEWER MAINS

600' SCALE MAP NO. 43 BLOCK NO.

PHASE ONE

PLEASANT CHASE
SECTION ONE
6TH ELECTION DISTRICT
HOWARD COUNTY, MARYLAND

CONT. 24-3201-D

SCALE AS SHOWN

SHEET 2 OF 4

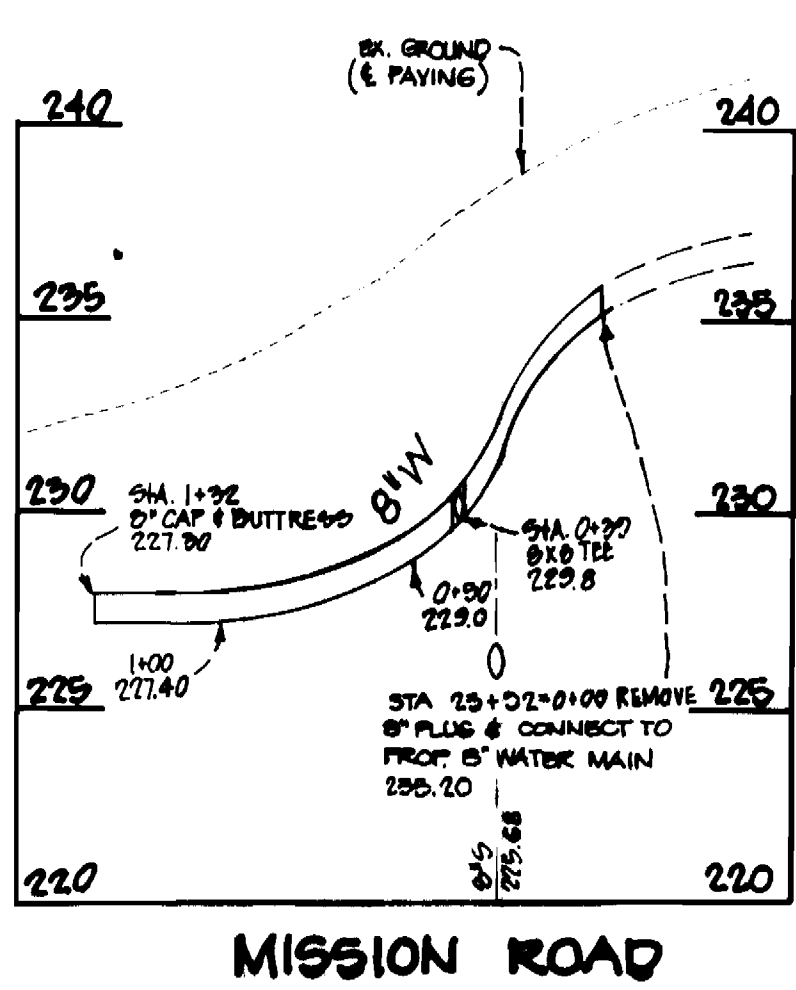
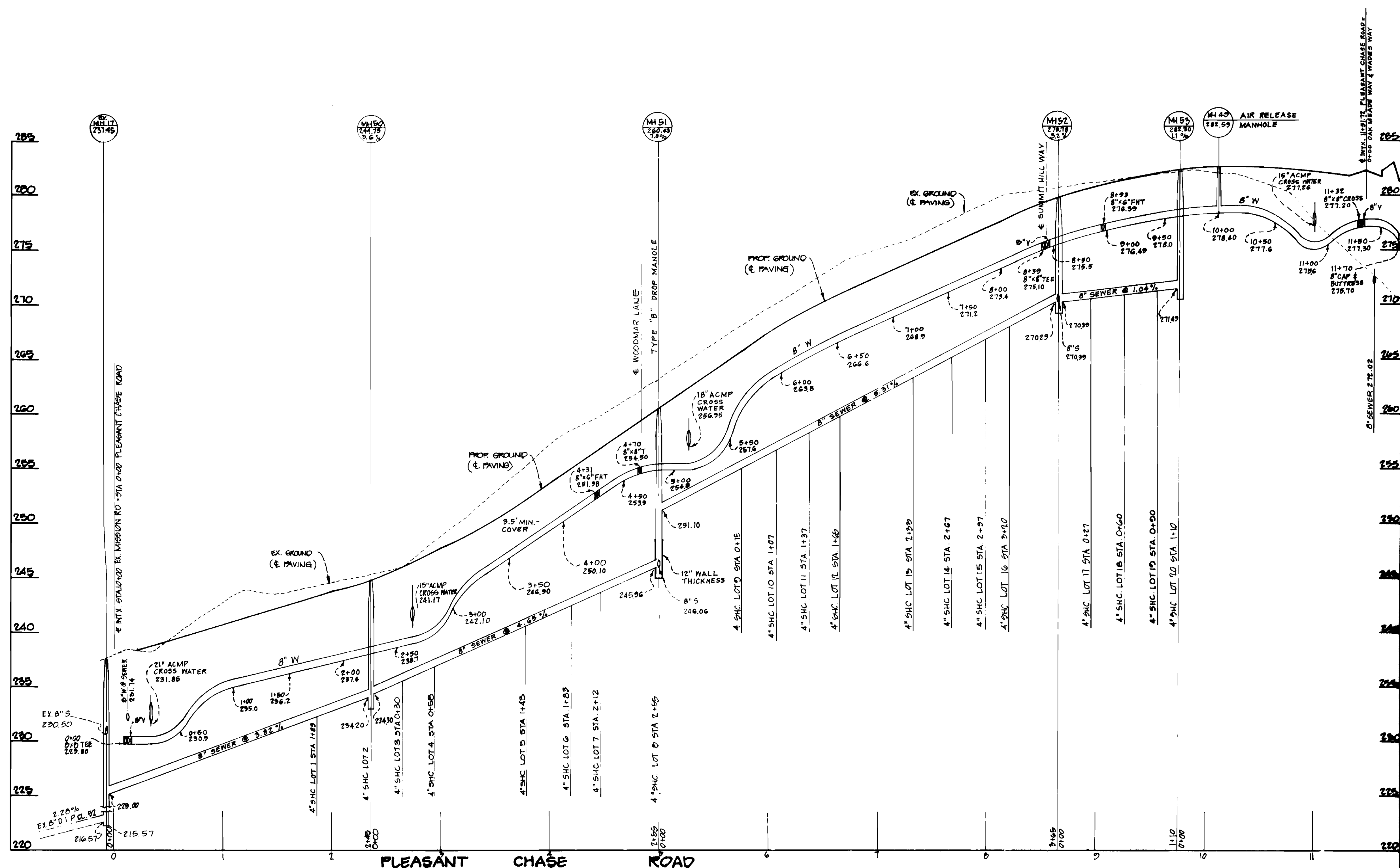

PROFILE
SCALE: HOR. 1" = 50'
VERT. 1" = 5'

PHASE ONE

DEPARTMENT OF PUBLIC WORKS
HOWARD COUNTY, MARYLAND
 Director of Public Works: *[Signature]* 5/10/94
 Chief, Bureau of Engineering: *[Signature]* 5/10/94
 Chief, Bureau of Utilities: *[Signature]* 5-3-94
 Chief, Land Development: *[Signature]*

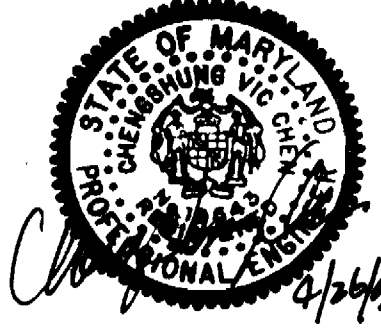
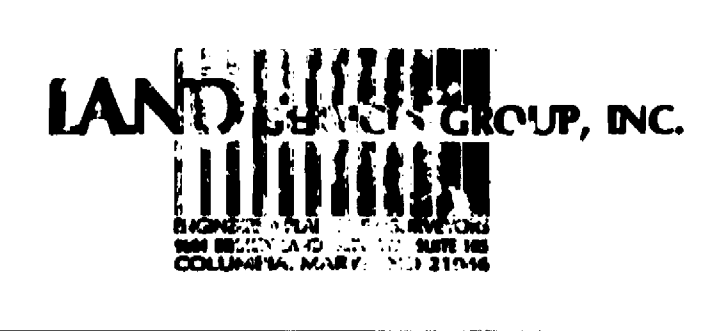

DES: J.P.H.	
DRN: M.E.S.	
CHK: B.B.S.	
DATE: 3-92	
BY: NO.	REVISION
	DATE

PROFILES OF
WATER AND SEWER MAINS

PLEASANT CHASE
SECTION ONE
6TH ELECTION DISTRICT
HOWARD COUNTY, MARYLAND
CONT. 24-3201-D

SCALE AS SHOWN
SHEET 3 OF 4

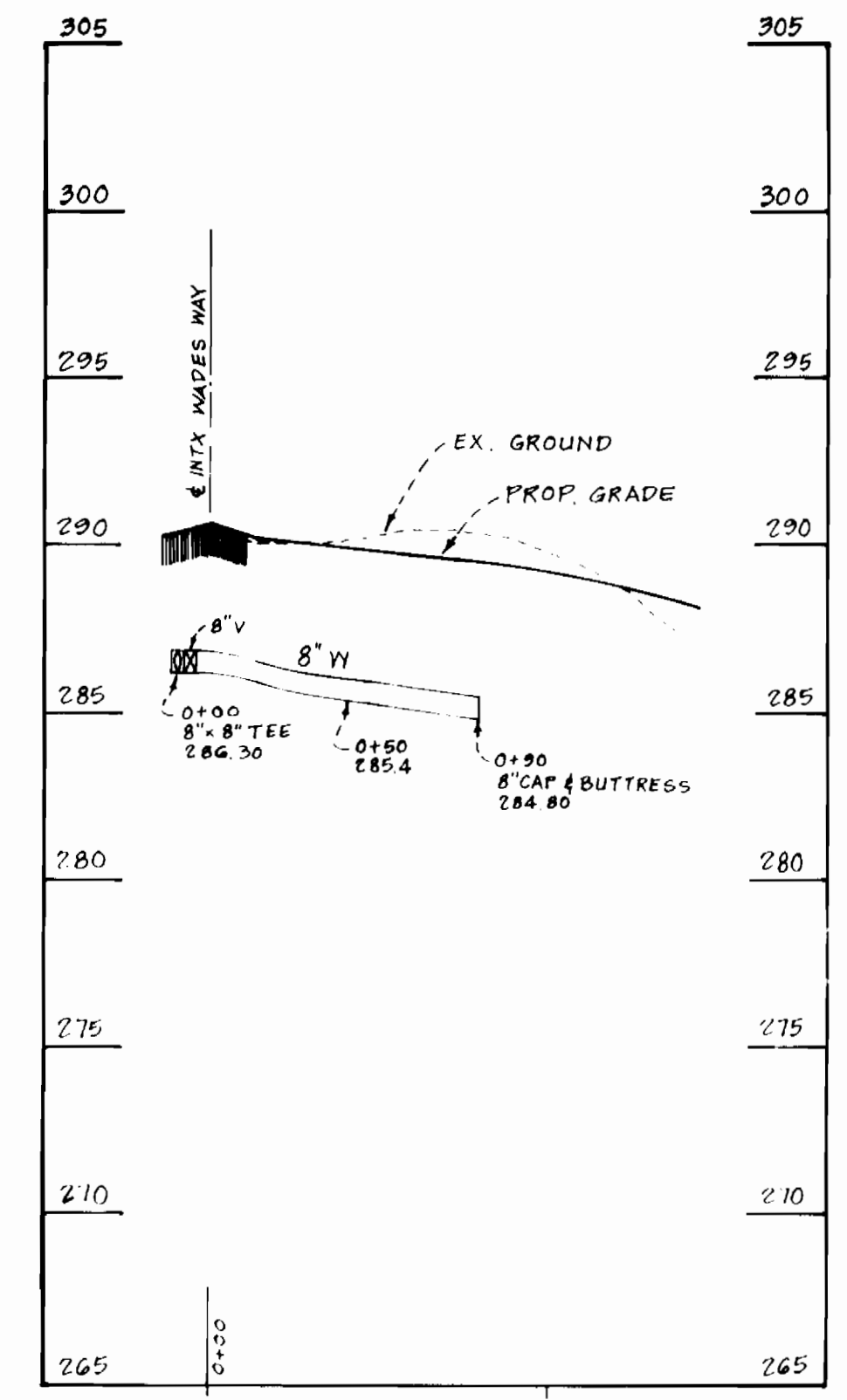
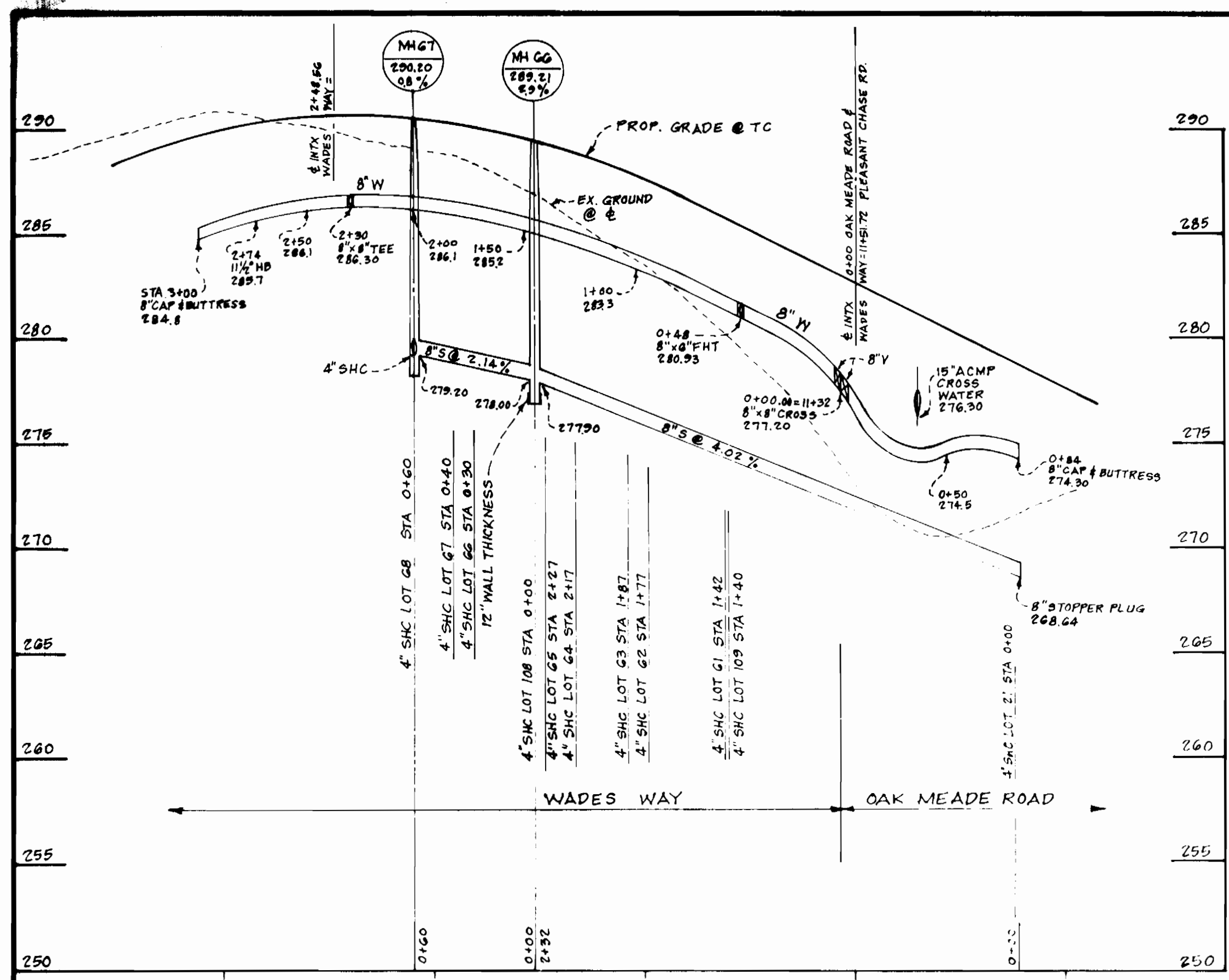

DEER CHASE COURT

PROFILES
SCALE: HOR. = 1" = 50'
VERT. = 1" = 5'

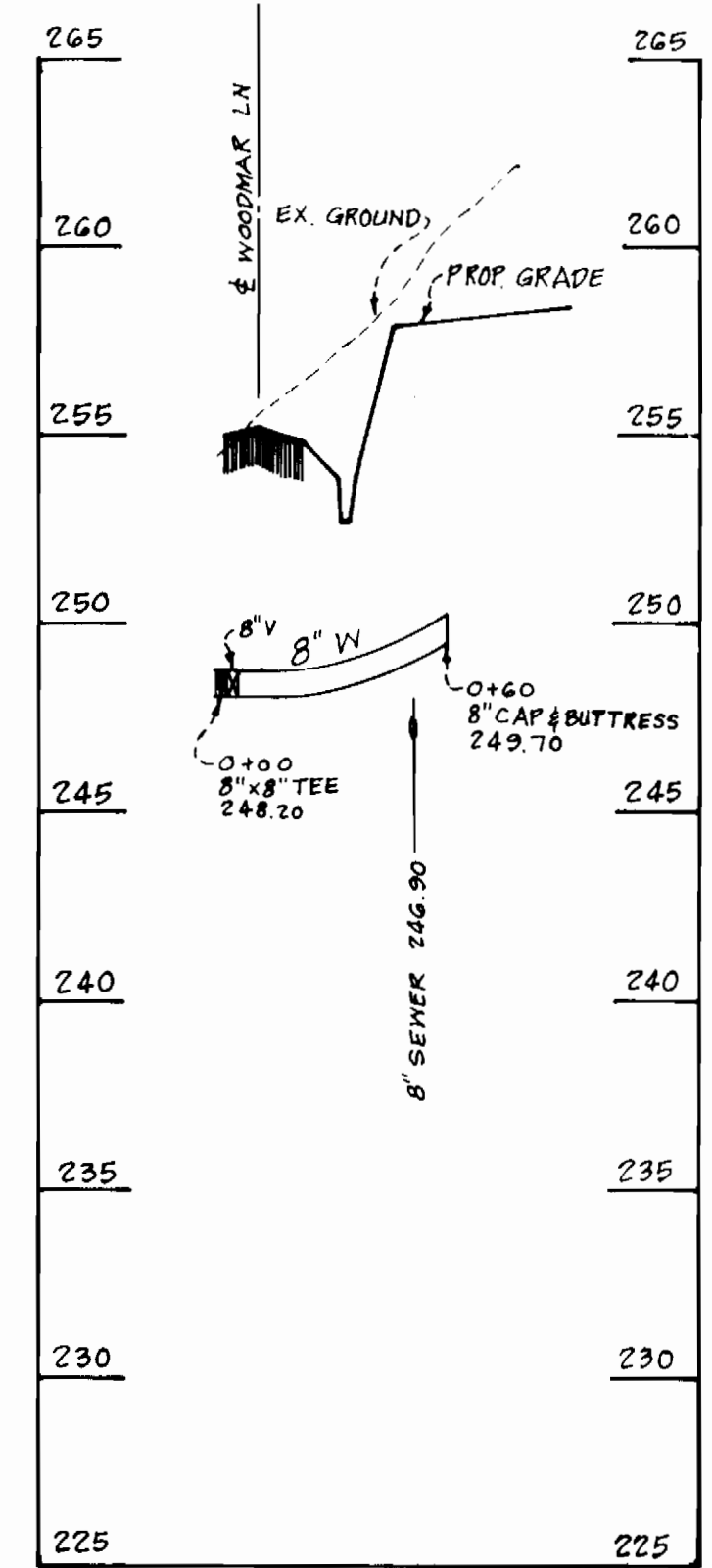

WADES WAY

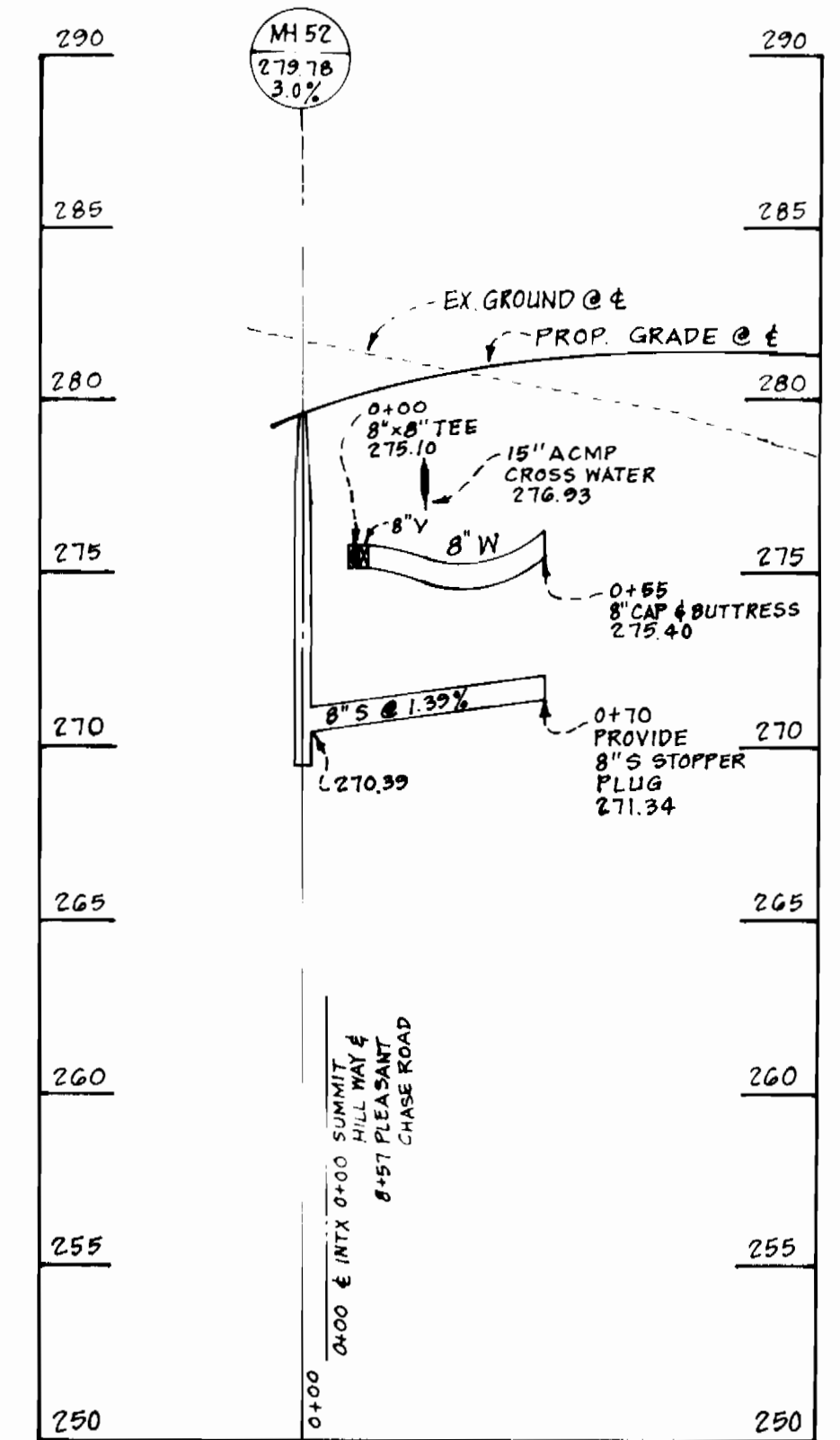

SUMMIT HILL WAY

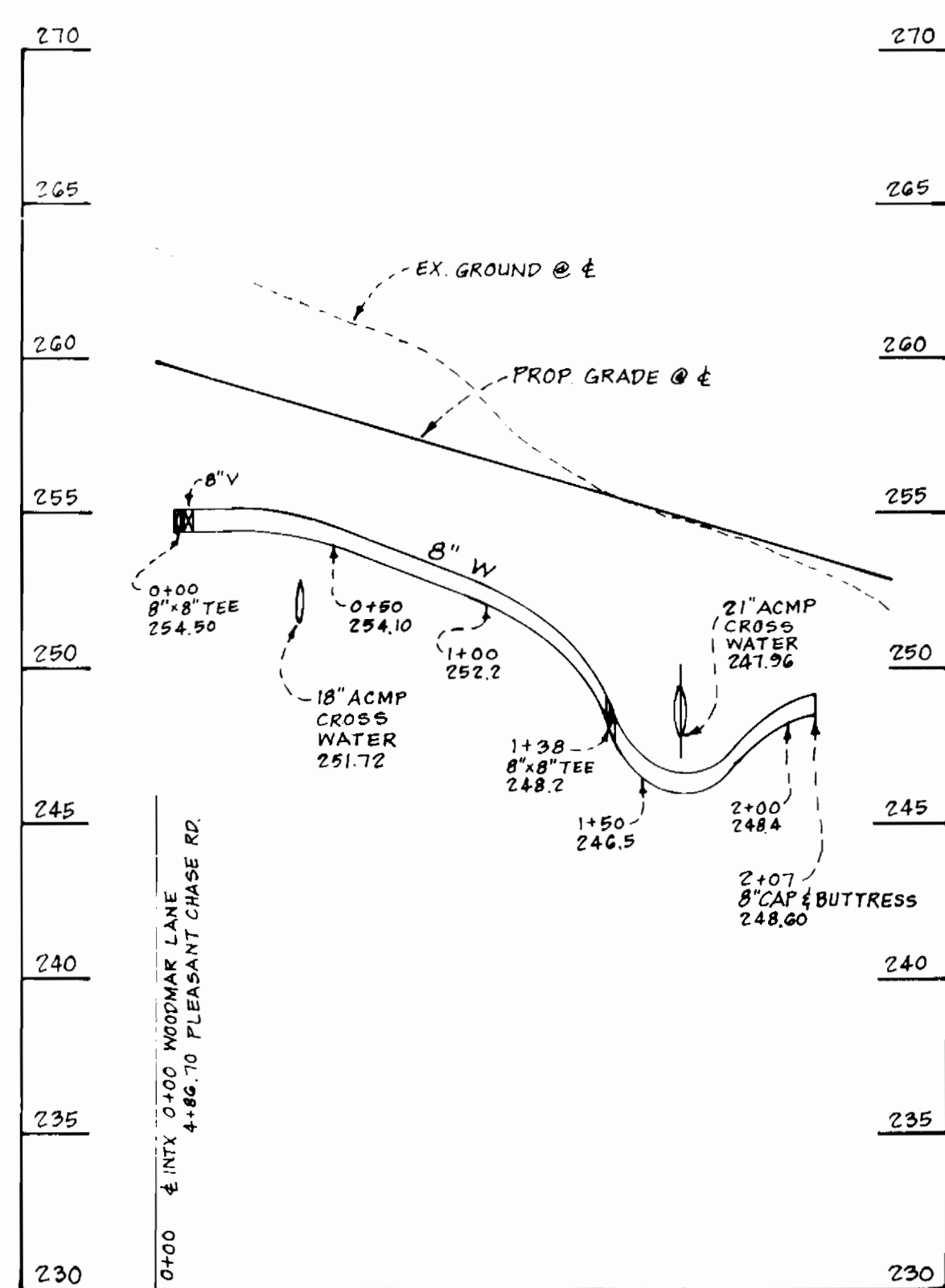

WOODMAR LANE

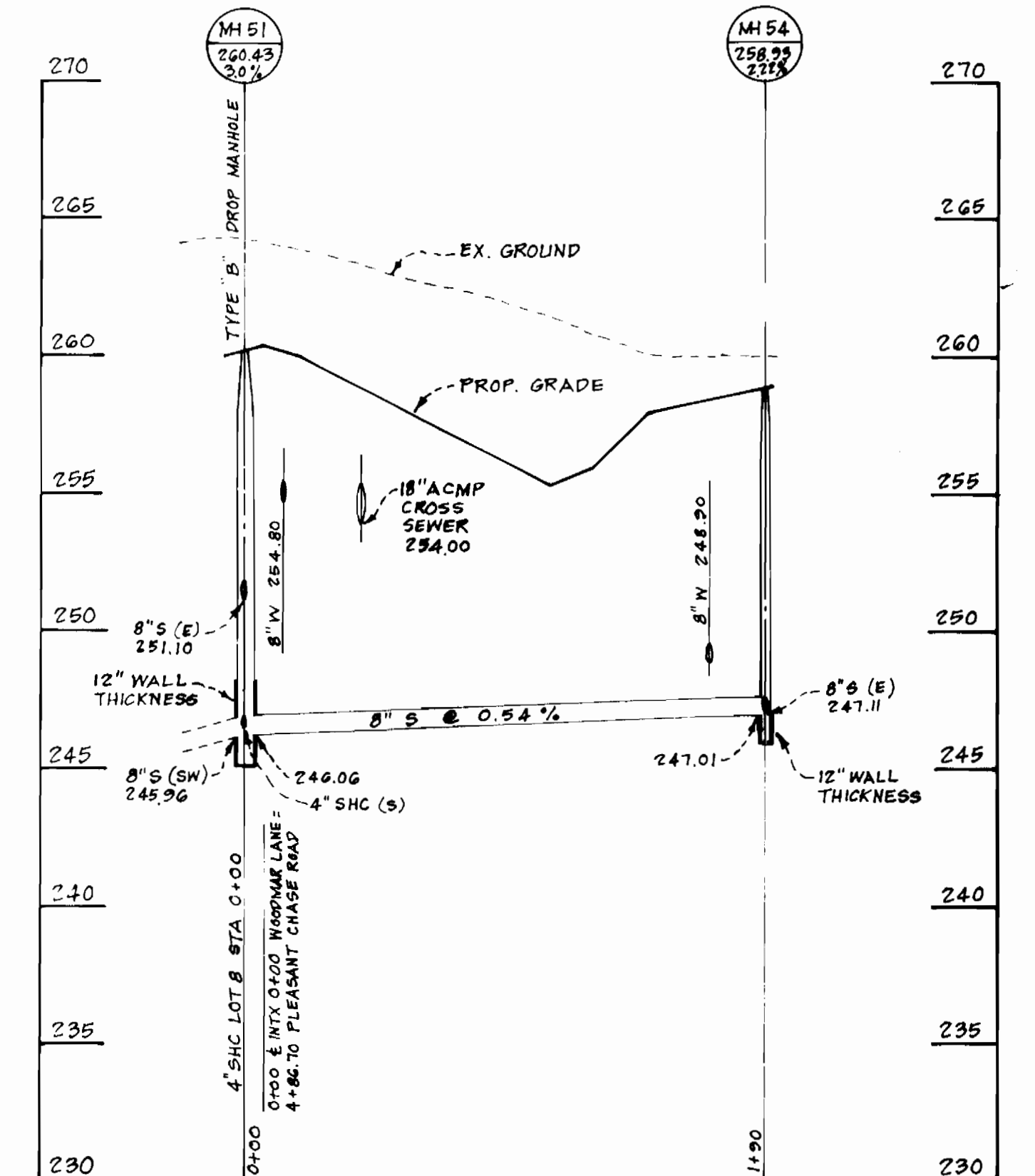

WOODMAR LANE

PHASE ONE

DEPARTMENT OF PUBLIC WORKS

HOWARD COUNTY, MARYLAND
 Director of Public Works: [Signature] 5/10/94
 Chief, Bureau of Engineering: [Signature] 5/10/94
 Chief, Bureau of Utilities: [Signature] 5-3-94
 Chief, Land Development: [Signature] 5/10/94



DES: J.P.H.
 DRN: M.E.S.
 CHK: B.B.S.
 DATE: 3-92
 BY: NO.
 REVISION

PROFILES OF WATER AND SEWER MAINS

PLEASANT CHASE SECTION ONE
 6TH ELECTION DISTRICT
 HOWARD COUNTY, MARYLAND
 CONT. 24-3201-D

SCALE AS SHOWN
 SHEET 4 OF 4