

STAKEOUT TABLE		
FITTING	DISTANCE	OFFSET
8" x 8" TEE	BASELINE STR. 3+03	20' LEFT
8" CAP	BASELINE STR. 3+05	20' LEFT

QUANTITIES				
ITEM	UNIT	ESTIMATE	AS-BUILT	SUPPLIER
8" WATER MAIN	L.F.	234'		
3/4" W.H.G.	L.F.	73'		
8" CAP	EA.	1		
FIRE HYDRANT	EA.	1		
8" x 8" TEE	EA.	1		
6" VALVE	EA.	1		

RESTORATION SCHEDULE		
LOCATION	DISTANCE	TYPE
STR. 0+48 TO STR. 2+82	234'	PAVING
STR. 2+70 (W.H.G.)	72'	SEED & PAVING
STR. 2+80 (F.H.)	10'	SEED & PAVING

SURVEY CONTROL

1. HOWARD COUNTY CONTROL 2447003
CONG. MON. 0.2' BELOW SURFACE
ELEV. 49.20
N 49° 31' 04" W
E 870.030.173
2. TRAVERSE 0-104 (STR. 0+00)
1/4" REBAR
N 49° 31' 04" W
E 870.044.293
3. TRAVERSE 0-105 (STR. 4+50.10)
1/4" REBAR
N 49° 31' 04" W
E 870.547.841

SEDIMENT CONTROL NOTES

- 1) A MINIMUM OF 24 HOURS NOTICE MUST BE GIVEN TO THE HOWARD COUNTY OFFICE OF INSPECTION AND PERMITS PRIOR TO THE START OF ANY CONSTRUCTION. (800-3450)
- 2) ALL VEGETATIVE AND STRUCTURAL PRACTICES ARE TO BE INSTALLED ACCORDING TO THE PROVISIONS OF THIS PLAN AND ARE TO BE IN CONFORMANCE WITH THE 1983 MARYLAND STANDARDS AND SPECIFICATIONS FOR SOIL EROSION AND SEDIMENT CONTROL.
- 3) FOLLOWING INITIAL SOIL DISTURBANCE OR REDISTURBANCE, PERMANENT OR TEMPORARY STABILIZATION SHALL BE COMPLETED WITHIN: (A) 7 CALENDAR DAYS FOR ALL PERIMETER SEDIMENT CONTROL STRUCTURES, DIKES, PERIMETER SLOPES AND ALL SLOPES GREATER THAN 3:1, (B) 14 DAYS AS TO ALL OTHER DISTURBED OR GRADED AREAS ON THE PROJECT SITE.
- 4) ALL SEDIMENT TRAPS/BASINS SHOWN MUST BE FENCED AND WARNING SIGNS POSTED AROUND THEIR PERIMETER IN ACCORDANCE WITH VOL. 1, CHAPTER 12, OF THE HOWARD COUNTY DESIGN MANUAL, STORM DRAINAGE.
- 5) ALL DISTURBED AREAS MUST BE STABILIZED WITHIN THE TIME PERIOD SPECIFIED ABOVE IN ACCORDANCE WITH THE 1983 MARYLAND STANDARDS AND SPECIFICATIONS FOR SOIL EROSION AND SEDIMENT CONTROL FOR PERMANENT SEEDINGS (SEC. 51) SOO (SEC. 54), TEMPORARY SEEDING (SEC. 50) AND MULCHING (SEC. 52). TEMPORARY STABILIZATION WITH MULCH ALONE CAN ONLY BE DONE WHEN RECOMMENDED SEEDING DATES DO NOT ALLOW FOR PROPER GERMINATION AND ESTABLISHMENT OF GRASSES.
- 6) ALL SEDIMENT CONTROL STRUCTURES ARE TO REMAIN IN PLACE AND ARE TO BE MAINTAINED IN OPERATIVE CONDITION UNTIL PERMITS FOR THEIR REMOVAL HAS BEEN OBTAINED FROM THE HOWARD COUNTY SEDIMENT CONTROL INSPECTOR.
- 7) SITE ANALYSIS:
TOTAL AREA OF SITE --- ACRES
AREA DISTURBED 0.008 ACRES
AREA TO BE ROOFED OR PAVED 0.022 ACRES
AREA TO BE VEGETATIVELY STABILIZED 0.022 ACRES
TOTAL CUT 100 CU. YDS.
TOTAL FILL 100 CU. YDS.
OFFSITE WASTE/BORROW AREA LOCATION ---
- 8) ANY SEDIMENT CONTROL PRACTICE WHICH IS DISTURBED BY GRADING ACTIVITY FOR PLACEMENT OF UTILITIES MUST BE REPAIRED ON THE SAME DAY OF DISTURBANCE.
- 9) ADDITIONAL SEDIMENT CONTROLS MUST BE PROVIDED, IF DEEMED NECESSARY BY THE HOWARD COUNTY DEPT. OF SEDIMENT CONTROL INSPECTOR.
- 10) ON ALL SITES WITH DISTURBED AREAS IN EXCESS OF 2 ACRES, APPROVAL OF THE INSPECTION AGENCY SHALL BE REQUESTED UPON COMPLETION OF INSTALLATION OF PERIMETER EROSION AND SEDIMENT CONTROLS, BUT BEFORE PROCEEDING WITH ANY OTHER EARTH DISTURBANCE OR GRADING. OTHER BUILDING OR GRADING INSPECTION APPROVALS MAY NOT BE AUTHORIZED UNTIL THIS INITIAL APPROVAL BY THE INSPECTION AGENCY IS MADE.

PERMANENT SEEDING NOTES

- APPLY TO GRADED OR CLEARED AREAS NOT SUBJECT TO IMMEDIATE FURTHER DISTURBANCE WHERE A PERMANENT LONG-LIVED VEGETATIVE COVER IS NEEDED.
- SEEDBED PREPARATION: LOOSEN UPPER THREE INCHES OF SOIL BY RAKING, DISCING OR OTHER ACCEPTABLE MEANS BEFORE SEEDING.
- SOIL AMENDMENTS: IN LIEU OF SOIL TEST RECOMMENDATIONS, USE ONE OF THE FOLLOWING SCHEDULES:
- 1) PREFERRED - APPLY 2 TONS PER ACRE DOLOMITIC LIMESTONE (92 LBS/1000 SQUARE FT.) AND 600 LBS PER ACRE 10-10-10 FERTILIZER (14 LBS/1000 SQ. FT.) BEFORE SEEDING. HARROW OR DISC INTO UPPER THREE INCHES OF SOIL. AT TIME OF SEEDING, APPLY 400 LBS PER ACRE 30-0-0 UREAFORM FERTILIZER (9 LBS/1000 SQ FT.).
 - 2) ACCEPTABLE - APPLY 2 TONS PER ACRE DOLOMITIC LIMESTONE (92 LBS/1000 SQ FT.) AND 1000 LBS PER ACRE 10-10-10 FERTILIZER (23 LBS/1000 SQ FT.) BEFORE SEEDING. HARROW OR DISC INTO UPPER THREE INCHES OF SOIL.
- SEEDING - FOR THE PERIODS MARCH 1 THRU APRIL 30, AND AUGUST 1 THRU OCTOBER 15, SEED WITH 60 LBS PER ACRE (1.4 LBS/1000 SQ FT.) OF KENTUCKY 31 TALL FESCUE. FOR THE PERIOD MAY 1 THRU JULY 31, SEED WITH 60 LBS PER ACRE (1.4 LBS/1000 SQ FT.) OF WEeping LOVEGRASS. DURING THE PERIOD OF OCTOBER 16 THRU FEBRUARY 28, PROTECT SITE BY: OPTION (1) 2 TONS PER ACRE OF WELL ANCHORED STRAW MULCH AND SEED AS SOON AS POSSIBLE IN THE SPRING. OPTION (2) USE SOO. OPTION (3) SEED WITH 60 LBS/ACRE KENTUCKY 31 TALL FESCUE AND MULCH WITH 2 TONS/ACRE WELL ANCHORED STRAW.
- MULCHING - APPLY 1 1/2 TO 2 TONS PER ACRE (70 TO 90 LBS/1000 SQ FT.) OF UNROTTED SMALL-DRAIN STRAW IMMEDIATELY AFTER SEEDING. ANCHOR MULCH IMMEDIATELY AFTER APPLICATION USING MULCH ANCHORING TOOL OR 2 1/2 GALLONS PER ACRE (5 GALLONS/1000 SQ FT.) OF EMULSIFIED ASPHALT ON FLAT AREAS. ON SLOPES 8 FEET OR HIGHER, USE 348 GALLONS PER ACRE (8 GALL/1000 SQ FT.) FOR ANCHORING.
- MAINTENANCE - INSPECT ALL SEEDING AREAS AND MAKE NEEDED REPAIRS, REPLACEMENTS AND RESEEDINGS.

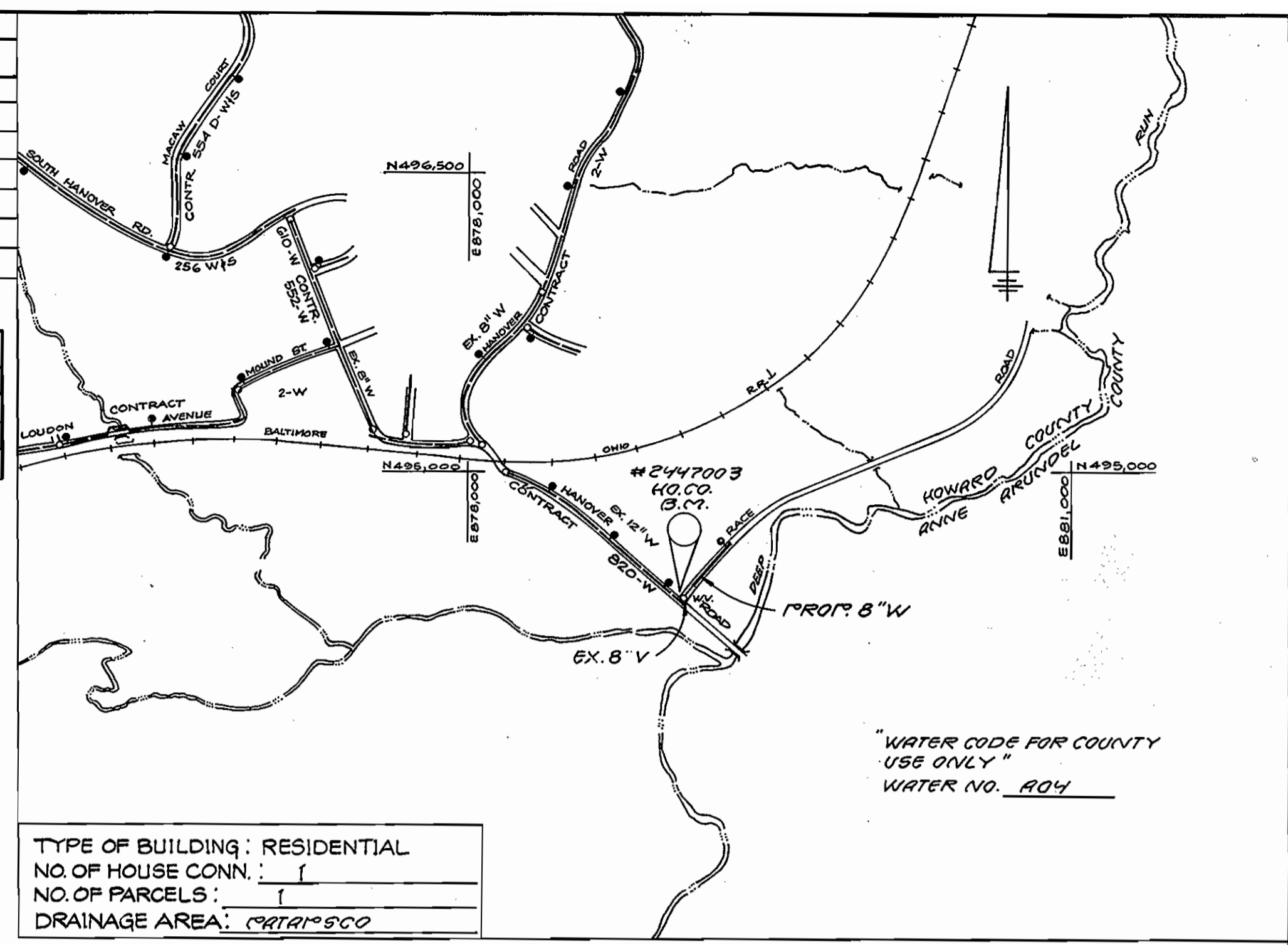

GENERAL NOTES

1. Approximate location of existing mains are shown. The Contractor shall take all necessary precautions to protect existing mains and services and maintain uninterrupted supply. Any damage incurred shall be repaired immediately to the satisfaction of the Engineer at the Contractor's expense.
2. All Horizontal Controls shown are based on Maryland State Coordinates.
3. All Vertical Controls are based on U.S.G.S. Datum.
4. All pipe elevations shown are invert elevations.
5. Clear all utilities by a minimum of 6". Clear all poles by 2'-0" minimum or tunnel as required.
6. For details not shown on the Drawings, and for materials and construction methods, use Howard County Design Manual, Volume IV, Standard Specification And Details For Construction. The Contractor shall have a copy of Volume IV on the job.
7. Where test pits have been made on existing utilities, they are noted by the symbol \boxtimes at location of test pit. A note or notes containing the results of the test pit or pits is included on the drawings. Existing utilities in the vicinity of the proposed work for which tests have not been dug shall be located by the Contractor two weeks in advance of Construction Operations at the Contractor's expense.
8. The Contractor shall notify the following utility companies or agencies at least five working days prior to starting work shown on this plan:
 - C&P Telephone Company 597-8585
 - State Highway Administration 531-5533
 - Baltimore Gas & Electric Co. Contractor Service 850-4620
 - Baltimore Gas & Electric Co. Underground Damage Control 850-3004
 - Baltimore Gas & Electric Co. Trouble Shooting 298-3001
 - MISS UTILITY 1-800-257-7777
 - Colonial Pipeline 795-1330
 - Bureau of Utilities, Howard County Dept. of Public Works 313-4900
9. Trees and shrubs are to be protected from damage to the maximum extent. Trees and shrubs located within the construction strip are not to be removed or damaged by the Contractor.
10. Contractor shall remove trees, stumps and roots along line of excavation. Payment for such removal shall be included in the unit price for construction of the main and service connections.
11. All water mains shall be D.I.P. Cl. 52 unless otherwise noted.
12. Top of all water main pipe to have a minimum of 3 1/2' cover unless otherwise noted.
13. Valves adjacent to tees shall be strapped to tees.
14. All fittings shall be buttressed or anchored with concrete in accordance with the Standard Details unless otherwise provided for on the drawings.
15. Fire Hydrants shall be set to the bury line elevations shown on the drawings. All Fire Hydrants shall be strapped and buttressed with concrete in accordance with the Standard Details. Soil around the fire hydrants shall be compacted in accordance with Section 1003 of the Standard Spec's.
16. The Contractor shall not operate any water main valves on the Existing Water System. Call Howard Co. Bureau Of Utilities at 313-4900. Coordinate the tie-in to the existing 8" water at least five working days prior to scheduling.
17. All Water House Connections shall be for Inside Meter Setting, unless otherwise noted on Plans or in the Specifications.
18. Trench repair to be in accordance with Howard Co. Std. Details.

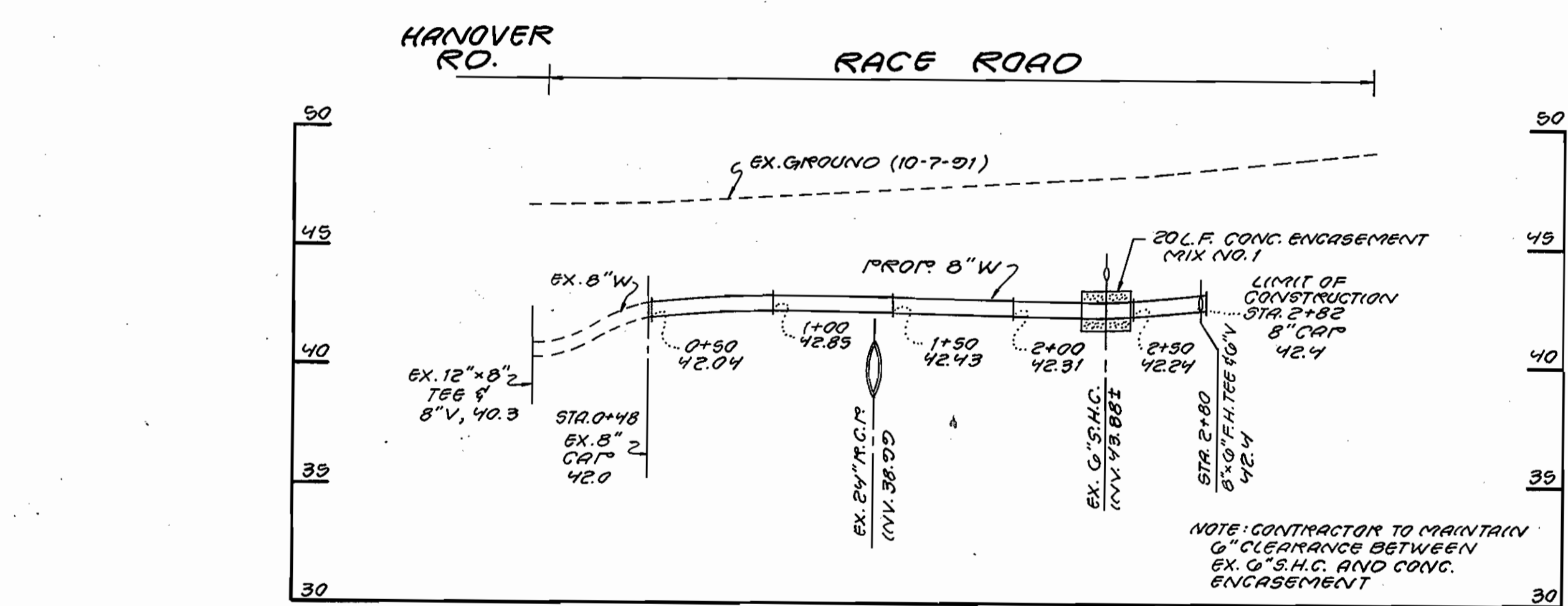

PROFILE
SCALE: HOR. 1" = 30'
VERT. 1" = 5'

By the Developer:
"I/We certify that all development and construction will be done according to this plan, and that any responsible personnel involved in the construction project will have a Certificate of Attendance at a Department of the Environment Approved Training Program for the Control of Sediment and Erosion before beginning the project. I also authorize periodic on-site inspection by the Howard Soil Conservation District."

Signature of Developer: *James M. Hicks* Date: *1-7-92*

By the Engineer:
"I certify that this plan for erosion and sediment control represents a practical and workable plan based on my personal knowledge of the site conditions and that it was prepared in accordance with the requirements of the Howard Soil Conservation District."

Signature of Engineer: *James M. Hicks* Date: *1/13/91*

REVIEWED FOR HOWARD SOIL CONSERVATION DISTRICT AND MEETS TECHNICAL REQUIREMENTS
U.S. SOIL CONSERVATION SERVICE
DATE: *1/16/92*

This Construction Plan is approved for Soil Erosion and Sediment Control by the Howard Soil Conservation District.
APPROVED:
DATE: *1/16/92*

DEPARTMENT OF PUBLIC WORKS
HOWARD COUNTY, MARYLAND
DATE: *1/10/92*
DATE: *1-8-92*

HICKS ENGINEERING CO., INC.
ENGINEERS · SURVEYORS · PLANNERS
200 E. JOPPA ROAD · SUITE 402
TOWSON MARYLAND 21204

DES: E.A.S.
DRN: E.R.S.
CHK: D.E.H.
DATE: *12-3-91*

8" WATER MAIN
CONTRACT NO. 44-3166

RACE ROAD WATER MAIN
FIRST ELECTION DISTRICT
HOWARD COUNTY, MARYLAND
CAPITAL PROJECT W-8181
SCALE AS SHOWN
SHEET 1 OF 1