

**GENERAL NOTES**

- APPROXIMATE LOCATION OF EXISTING MAINS ARE SHOWN. THE CONTRACTOR SHALL TAKE ALL NECESSARY PRECAUTIONS TO PROTECT EXISTING MAINS AND SERVICES AND MAINTAIN UNINTERRUPTED SUPPLY. ANY DAMAGE INCURRED SHALL BE REPAIRED IMMEDIATELY TO THE SATISFACTION OF THE ENGINEER AT THE CONTRACTOR'S EXPENSE.
- ALL HORIZONTAL CONTROLS ARE BASED ON MARYLAND STATE COORDINATES.
- ALL VERTICAL CONTROLS ARE BASED ON U.S.G.S. DATA.
- ALL PIPE ELEVATIONS SHOWN ARE INVERT ELEVATIONS.
- CLEAR ALL UTILITIES BY A MINIMUM OF 6" CLEAR ALL POLES BY 2'-0" MINIMUM OR TUNNEL AS REQUIRED. THE OWNER HAS CONTACTED THE UTILITY COMPANIES AND HAS MADE ARRANGEMENTS FOR BRACING OF POLES AS SHOWN ON THE DRAWINGS. IN THE EVENT THE CONTRACTOR'S WORK REQUIRES THE BRACING OF ADDITIONAL POLES, ANY COST INCURRED BY THE OWNER FOR BRACING OF ADDITIONAL POLES OR DAMAGES SHALL BE DEDUCTED FROM MONEY OWED THE CONTRACTOR. THE CONTRACTOR SHALL COORDINATE WITH THE UTILITY COMPANIES TO SCHEDULE THE BRACING OF POLES.
- FOR DETAILS NOT SHOWN ON THE DRAWINGS, AND FOR MATERIALS AND CONSTRUCTION METHODS, USE HOWARD COUNTY DESIGN MANUAL, VOLUME II, STANDARD SPECIFICATIONS AND DETAILS FOR CONSTRUCTION (LATEST EDITION). THE CONTRACTOR SHALL HAVE A COPY OF VOLUME II ON THE JOB.
- WHERE TEST PITS HAVE BEEN MADE ON EXISTING UTILITIES, THEY ARE NOTED BY THE SYMBOL AT THE LOCATION OF THE TEST PIT. A NOTE OR NOTES CONTAINING THE RESULTS OF THE TEST PIT OR PITS IS INCLUDED ON THE DRAWINGS. EXISTING UTILITIES IN THE VICINITY OF THE PROPOSED WORK FOR WHICH TEST PITS HAVE NOT BEEN DUG SHALL BE LOCATED BY THE CONTRACTOR TWO WEEKS IN ADVANCE OF CONSTRUCTION OPERATIONS AT HIS OWN EXPENSE.
- CONTRACTOR SHALL NOTIFY THE FOLLOWING UTILITY COMPANIES OR AGENCIES AT LEAST FIVE WORKING DAYS BEFORE STARTING WORK SHOWN ON THESE DRAWINGS.
 

a) STATE HIGHWAY ADMINISTRATION	531-5533
b) BALTIMORE GAS & ELECTRIC COMPANY (CONTRACTOR SERVICES)	850-4620
c) BALTIMORE GAS & ELECTRIC COMPANY (UNDER GROUND DAMAGE CONTROL)	787-9068
d) MIBS UTILITY	1-800-257-7777
e) COLONIAL PIPELINE COMPANY	798-1390
f) BUREAU OF UTILITIES	313-4900
HOWARD COUNTY DEPT. OF PUBLIC WORKS	
- TREES AND SHRUBS ARE TO BE PROTECTED FROM DAMAGE TO MAXIMUM EXTENT. TREES AND SHRUBS LOCATED WITHIN THE CONSTRUCTION STRIP ARE NOT TO BE REMOVED OR DAMAGED BY THE CONTRACTOR.
- CONTRACTOR SHALL REMOVE TREES, STUMPS AND ROOTS ALONG LINE OF EXCAVATION. PAYMENT FOR SUCH REMOVAL SHALL BE INCLUDED IN THE UNIT PRICE BID FOR CONSTRUCTION OF THE MAIN.
- ALL SEWER MAINS SHALL BE D.I.P., RCP, VCPX, CSPX, RCP AND PYC UNLESS OTHERWISE NOTED.
- THE CONTRACTOR SHALL PROVIDE A JOINT IN ALL SEWER MAINS WITHIN 2'-0" OF EXTERIOR MANHOLE WALL.
- ALL MANHOLES SHALL BE 4'-0" INSIDE DIAMETER UNLESS OTHERWISE NOTED.
- FORCE MAINS SHALL BE D.I.P. ONLY.
- MANHOLES SHOWN WITH 12" AND 16" WALLS ARE FOR BRICK MANHOLES ONLY.
- MANHOLES DESIGNATED WT. IN PLAN AND PROFILE SHALL HAVE WATER-TIGHT FRAME AND COVERS. STANDARD DETAIL G 5.52 WHERE WATER-TIGHT MANHOLE FRAME AND COVER IS USED. SET TOP OF FRAME 1'-6" ABOVE FINISHED GRADE UNLESS OTHERWISE NOTED ON THE DRAWINGS.
- HOUSE(S) WITH THE SYMBOL "C.N.S." INDICATES THE CELLAR CANNOT BE SERVED.

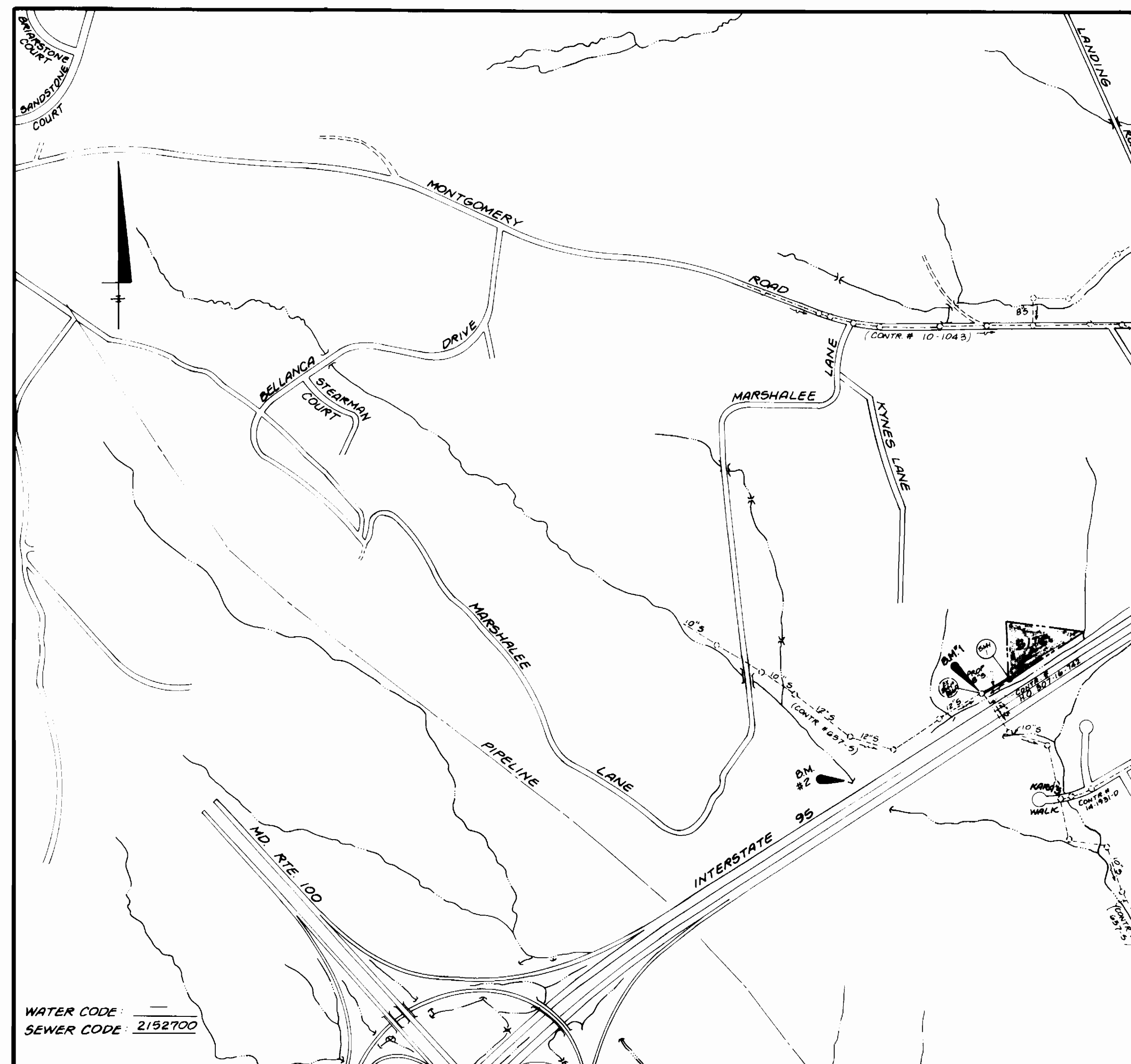

WATER CODE: \_\_\_\_\_  
SEWER CODE: 2192700

**TYPE OF BUILDING:** SINGLE FAMILY DETACHED

NO. OF LOTS:	1
NO. OF WHC'S:	0
NO. OF SHC'S:	1
DRAINAGE AREA:	PATAPSCO
WASTEWATER TREATMENT PLANT:	PATAPSCO

**VICINITY MAP**  
SCALE: 1"=600'

**BENCH MARKS:**

- B.M. #1:**  
EXISTING SANITARY SEWER MANHOLE # B560  
TOP OF RIM ELEVATION @ 209.75
- B.M. #2:**  
WR # A D CUT IN CORNER OF CONCRETE HEADWALL  
I-95 NEAR PI # 2-37  
ELEVATION @ 204.98

**QUANTITIES**

ITEM	EST'D	AS BUILT	MATERIAL / SUPPLIER
8" S	200 L.F.	196 L.F.	ATLANTIC STATES / ASP SEWER & WATER SUPPLIES
4" SHC	15 L.F.	15 L.F.	CERTAINTEED CORP. / ATLANTIC PRECAST PRODUCTS
STD MANHOLE	(1) 5' DIA	1 EA.	ATLANTIC CONCRETE PRODUCTS

**DEVELOPER'S CERTIFICATE**

"I/We certify that all development and construction will be done according to this plan, and that any responsible personnel involved in the construction project will have a Certificate of Attendance at a Department of the Environment Approved Training Program for the Control of Sediment and Erosion before beginning the project. I also authorize periodic on-site inspection by the Howard Soil Conservation District."

Signature of Developer: \_\_\_\_\_ Date: \_\_\_\_\_

**ENGINEER'S CERTIFICATE**

"I certify that this plan for erosion and sediment control represents a practical and workable plan based on my personal knowledge of the site conditions and that it was prepared in accordance with the requirements of the Howard Soil Conservation District."

Signature of Engineer: \_\_\_\_\_ Date: 10-28-91

REVIEWED FOR HOWARD SOIL CONSERVATION DISTRICT AND MEETS TECHNICAL REQUIREMENTS

Signature: *James M. Williams* Date: 11/14/91  
U.S. SOIL CONSERVATION SERVICE

THIS DEVELOPMENT PLAN IS APPROVED FOR SOIL EROSION AND SEDIMENT CONTROL BY THE HOWARD COUNTY SOIL CONSERVATION DISTRICT

Signature: *Jeffrey H. Adley* Date: 11/14/91  
HOWARD SCD

SEDIMENT CONTROL MEASURES FOR THIS CONTRACT WILL BE IMPLEMENTED IN ACCORDANCE WITH SECTION 219 OF THE STANDARD SPECIFICATIONS

DEPARTMENT OF PUBLIC WORKS  
HOWARD COUNTY, MARYLAND

Signature: *James M. Williams* Date: 11/14/91  
DIRECTOR OF PUBLIC WORKS

Signature: *Robert J. Boney* Date: 11-12-91  
CHIEF BUREAU OF UTILITIES

Signature: *James M. Williams* Date: 11/14/91  
CHIEF LAND DEVELOPMENT DIVISION

LAND DESIGN ENGINEERING, INC.  
10620 GUILFORD ROAD  
SUITE 210  
JESSUP, MARYLAND 20794  
(301) 604-6264  
(301) 880-0034

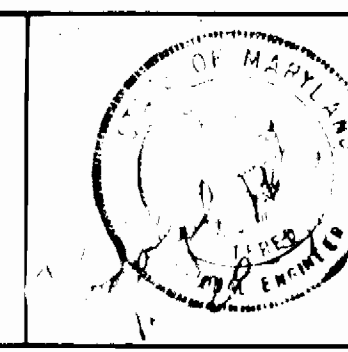

DES	DATE	BY	NO.	REVISION	DATE
LM					
KB					
BB					
	Sept 1991				

**TITLE SHEET**

600 SCALE MAP NO. 37 BLOCK NO. 12

SEWER MAIN EXTENSION  
-FOR-  
**LOUIS G. JR. & CORA LEE SCHMITT PROPERTY**  
CONTRACT NO. 10-3158-D  
1ST ELECTION DISTRICT

SCALE AS SHOWN  
SHEET 1 OF 2

