

GENERAL NOTES

- APPROXIMATE LOCATION OF EXISTING MAINS ARE SHOWN. THE CONTRACTOR SHALL TAKE ALL NECESSARY PRECAUTIONS TO PROTECT EXISTING MAINS AND SERVICES AND MAINTAIN UNINTERRUPTED SUPPLY. ANY DAMAGE INCURRED SHALL BE REPAIRED IMMEDIATELY TO THE SATISFACTION OF THE ENGINEER. AT THE CONTRACTOR'S EXPENSE.
- ALL HORIZONTAL CONTROLS ARE BASED ON MARYLAND STATE COORDINATES.
- ALL VERTICAL CONTROLS ARE BASED ON U.S.G.S. DATUM.
- ALL PIPE ELEVATIONS SHOWN ARE INVERT ELEVATIONS.
- CLEAR ALL UTILITIES BY A MINIMUM OF 6". CLEAR ALL POLES BY 2'-0" MINIMUM OR TUNNEL AS REQUIRED.
- FOR DETAILS NOT SHOWN ON THE DRAWINGS, AND FOR MATERIALS AND CONSTRUCTION METHODS USE HOWARD COUNTY DESIGN MANUAL, VOLUME IV, STANDARD SPECIFICATIONS AND DETAILS FOR CONSTRUCTION. THE CONTRACTOR SHALL HAVE A COPY OF VOLUME IV ON THE JOB.
- WHERE TEST PITS HAVE BEEN MADE ON EXISTING UTILITIES, THEY ARE NOTED BY THE SYMBOL AT THE LOCATION OF THE TEST PIT. A NOTE OR NOTES CONTAINING THE RESULTS OF THE TEST PIT OR PITS IS INCLUDED ON THE DRAWINGS. EXISTING UTILITIES IN THE VICINITY OF THE PROPOSED WORK FOR WHICH TEST PITS HAVE NOT BEEN DUG SHALL BE VERIFIED BY THE CONTRACTOR TO HIS OWN SATISFACTION. ANY DAMAGE TO EXISTING FACILITIES DUE TO THE CONTRACTOR'S NEGLIGENCE SHALL BE REPAIRED AT THE CONTRACTOR'S EXPENSE.
- CONTRACTOR SHALL NOTIFY THE FOLLOWING UTILITIES OR AGENCIES AT LEAST FIVE WORKING DAYS BEFORE STARTING WORK SHOWN ON THESE PLANS:
 - STATE HIGHWAY ADMINISTRATION - 531-5533
 - BALTIMORE GAS AND ELECTRIC CO. - CONTRACTOR SERVICES 850-4620
 - BALTIMORE GAS AND ELECTRIC CO. - UNDER GROUND DAMAGE CONTROL - 859-9004
 - BALTIMORE GAS AND ELECTRIC CO. - TROUBLE SHOOTING - 298-9001
 - MISS UTILITY - 1 - 559-0100
 - COLONIAL PIPELINE CO. - 795-1390/C&P TELEPHONE CO. 1-800-257-7777
 - BUREAU OF UTILITIES, HOWARD COUNTY DEPARTMENT OF PUBLIC WORKS - 992-2366
- TREES AND SHRUBS ARE TO BE PROTECTED FROM DAMAGE TO MAXIMUM EXTENT. TREES AND SHRUBS LOCATED WITHIN THE CONSTRUCTION STRIP ARE NOT TO BE REMOVED OR DAMAGED BY THE CONTRACTOR.
- CONTRACTOR SHALL REMOVE TREES, STUMPS AND ROOTS ALONG LINE OF EXCAVATION.
- ALL WATER MAINS TO BE D.I.P. CLASS 52 UNLESS OTHERWISE NOTED.
- TOPS OF ALL WATER MAINS TO HAVE A MINIMUM OF 3-1/2' COVER UNLESS OTHERWISE NOTED.
- VALVES ADJACENT TO TEES SHALL BE STRAPPED TO TEES.
- ALL FITTINGS SHALL BE BUTTRESSED OR ANCHORED WITH CONCRETE IN ACCORDANCE WITH THE STANDARD DETAILS UNLESS OTHERWISE PROVIDED FOR ON THE DRAWINGS.
- FIRE HYDRANTS SHALL BE SET TO THE BURY LINE ELEVATIONS SHOWN ON THE DRAWINGS. ALL FIRE HYDRANTS SHALL BE STRAPPED AND BUTTRESSED WITH CONCRETE IN ACCORDANCE WITH STANDARD DETAILS. SOIL AROUND THE FIRE HYDRANT SHALL BE COMPACTED IN ACCORDANCE WITH SECTION 1003 THE STANDARD SPECIFICATIONS.
- THE CONTRACTOR SHALL NOT OPERATE ANY WATER MAIN VALVES ON THE EXISTING WATER SYSTEM.
- ALL WATER HOUSE CONNECTIONS SHALL BE FOR INSIDE METER SETTINGS, UNLESS OTHERWISE NOTED ON THE PLANS OR IN THE SPECIFICATIONS.
- ALL W.H.C.'S. SHALL BE 3/4" UNLESS OTHERWISE NOTED.
- ALL SEWER MAINS SHALL BE C.S.P.X., D.I.P., V.C.P.X., A.C.P. CLASS 2400 OR P.V.C. UNLESS OTHERWISE NOTED.
- THE CONTRACTOR SHALL PROVIDE A JOINT IN ALL SEWER MAINS WITHIN 2'-0" OF EXTERIOR MANHOLE WALL.
- ALL MANHOLES SHALL BE 4'-0" INSIDE DIAMETER UNLESS OTHERWISE NOTED.
- MANHOLES SHOWN WITH 12" AND 16" WALLS ARE FOR BRICK MANHOLES ONLY.
- MANHOLES DESIGNATED W.T. IN PLAN AND PROFILE SHALL HAVE WATERTIGHT FRAME AND COVERS. STANDARD DETAILS 65.52. WHERE WATERTIGHT MANHOLE FRAME AND COVER IS USED, SET TOP OF FRAME 1.5' ABOVE FINISHED GRADE UNLESS OTHERWISE NOTED ON THE DRAWINGS.
- STRAW BALE DIKE AND SILT FENCE ARE INTERCHANGEABLE.
- FOR MANHOLES IN OPEN SPACE OR OUTFALL. SET TOP OF FRAME 1.5' ABOVE FINISHED GRADE UNLESS OTHERWISE NOTED ON THE DRAWINGS.
- All D.I.P. fittings shall be in accordance with AWWA Spec. C-153 Ductile Iron Compact Fittings, 3 inch thru 12 inch for water + other liquids.

QUANTITIES			
ITEM	BID	AS BUILT	MATERIAL/SUPPLIER
8" Water L.F.	840	840	AIP WATER SEWER SUPPLIES - ATLANTIC STATES CAST IRON PIPE
6" Water L.F.	124	264 & 219	AIP WATER SEWER SUPPLIES - ATLANTIC STATES CAST IRON PIPE
4" Water L.F.	10	10 & 146	ATLANTIC STATES CAST IRON PIPE
1" W.H.C. L.F.	116	116	VINCENT BRASS & HALSTEAD INC.
8" Valve Ea.	6	6	MUELLER
6" Valve (Excluding FH)	3	4	MUELLER
Relocated F.H.	1	1	ON SITE
Fire Hydrants Ea.	3	3	KENNEDY
8" Sewer L.F.	1400	1474 & 243	CHARLOTTE PIPE
Manholes Ea.	6	6 & 2	CAMBELL FOUNDRY
6" S.H.C. L.F.	60	118 & 102	CHARLOTTE PIPE
6" D.H.C. V.F.	10	6	CHARLOTTE PIPE
8" D.C. V.F.	9	9	CHARLOTTE PIPE
4" Valve Ea.	1	1 & 1	MUELLER

PUBLIC & PRIVATE

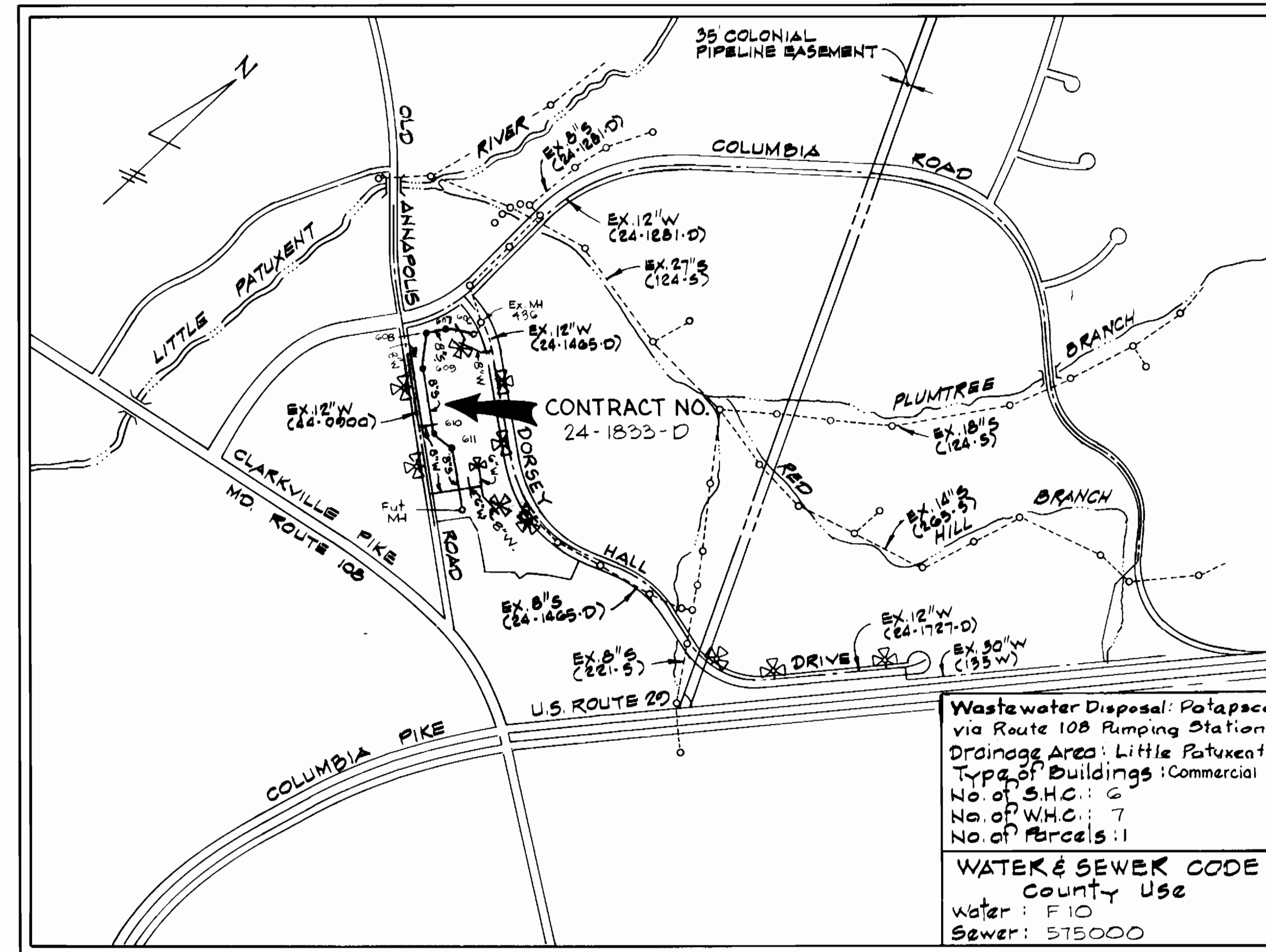

VICINITY MAP
SCALE: 1" = 600'

CONTRACT NO. 24-1833-D SECTION 2 AREA 4 VILLAGE CENTER WATER AND SEWER MAIN EXTENSIONS HOWARD COUNTY, MARYLAND DEPARTMENT OF PUBLIC WORKS

WATER & SEWER
PRIVATE & PUBLIC
AS BUILT

REVIEWED FOR HOWARD SOIL CONSERVATION DISTRICT AND MEETS TECHNICAL REQUIREMENTS
Amos Mitchell 9-2-88
SIGNATURE DATE
U.S. SOIL CONSERVATION SERVICE

This Development Plan is approved for Soil Erosion and Sediment Control by the Howard County Conservation District.
APPROVED:
Robert W. Zick 9/2/88
HOWARD S.C.D. DATE
Sediment Control Measures for this Contract will be implemented in accordance with Section 219 of the Standard Specifications, and Road Construction Drawings F-88-241 and SDP-88-192

DORSEY HALL
SECTION 2 AREA 4
PARCEL "L"
Contract No. 24-1833-D

DEPARTMENT OF PUBLIC WORKS
HOWARD COUNTY, MARYLAND
James 9/6/88
DIRECTOR OF PUBLIC WORKS - DATE
Robert 8-31-88
CHIEF - BUREAU OF UTILITIES - DATE
James 9-2-88
CHIEF - BUREAU OF ENGINEERING - DATE
James 9-2-88
CHIEF - LAND DEVELOPMENT DIVISION - DATE

WHITMAN, REQUARDT
AND ASSOCIATES
ENGINEERS
2315 ST PAUL ST
BALTIMORE, MARYLAND

DES. T.P.					
DRN. B.G.					
CHK. S.J.					
DATE	BY	NO.	REVISION	DATE	

VICINITY MAP
AND
GENERAL NOTES
600' SCALE MAP NO. 30 BLOCK NO.

DORSEY HALL
SECTION 2 AREA 4
ELECTION DISTRICT NO. 2
CONTRACT NO. 24-1833-D
SCALE 1" = 600'
SHEET 1 OF 3

CURVE DATA TABLE						
NO	RADIUS	DELTA	ARC TAN	CHORD	CHD BEARING	
H	105.00	30-00-00	164.75	105.00	148.49	N82-52-05 E
I	200.00	76-25-16	22.70	11.76	22.65	N34-16-57 E
J	200.00	15-51-41	55.57	27.46	55.19	N23-05-59 E
S	30.00	45-00-00	23.56	14.43	22.96	S60-02-05 W
T	25.00	45-00-00	19.64	10.36	19.13	S15-02-05 W
U	25.00	45-00-00	19.64	10.36	19.13	S29-57-55 E

— BENCH MARKS —
 WR1A BM #2 El. 382.61'
 Boat Spike in Gas and Electric Pole # 390112 SW of Intersection of Columbia Road and Old Annapolis Road
 WR1A BM #23 El. 337.19'
 RR Spike in Base of 12" Triple Aspen 90' Left of E Road Sta 23+00 Dorsey Hall Drive

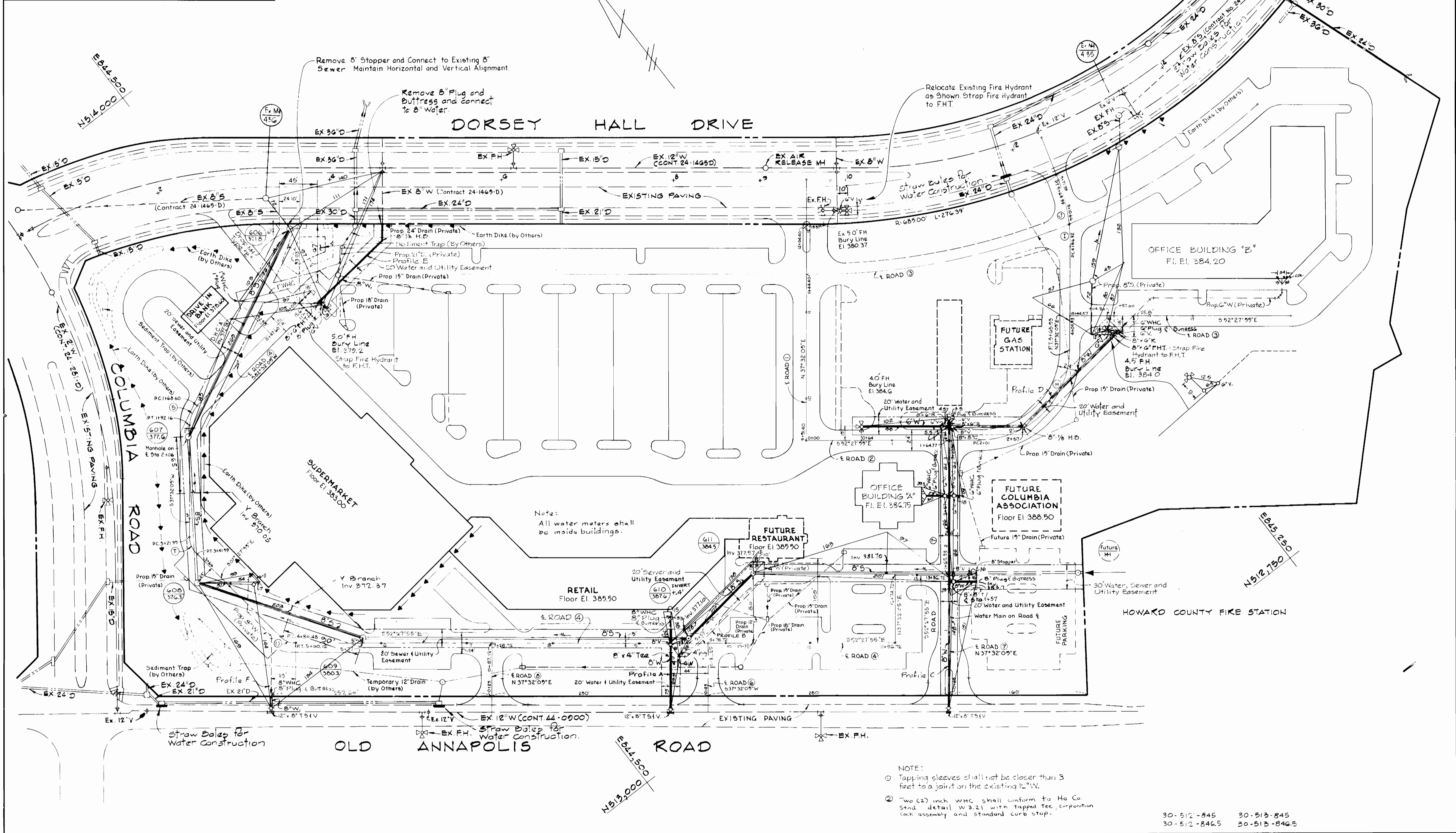

Note:
All water meters shall be inside buildings.

NOTE:
 1) Tapping sleeves shall not be closer than 3 feet to a joint on the existing 12" W.
 2) Two (2) inch W.H.C. shall conform to Ho Co. Std. detail W.3.21 with tapped tee, corporation cock assembly and standard curb stop.

30-512-845 30-513-845
 30-512-846.5 30-513-846.5

DEPARTMENT OF PUBLIC WORKS
 HOWARD COUNTY, MARYLAND
 Director of Public Works: *James J. ...*
 Chief - Bureau of Engineering - Date: *9-2-88*
 Chief - Bureau of Utilities - Date: *8-31-88*
 Chief - Land Development Division - Date: *1/18*

WHITMAN, REQUARDT
 AND ASSOCIATES
 ENGINEERS
 2315 ST PAUL ST
 BALTIMORE, MARYLAND

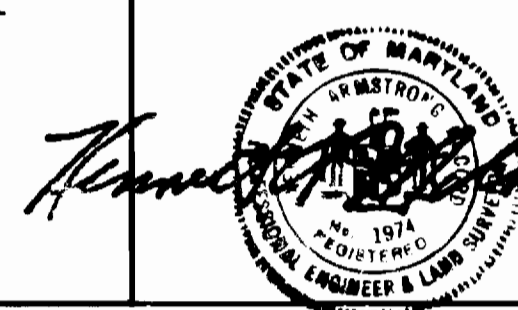

DES. T.P.
 DRN. B.G.
 CHK. S.U.
 DATE: TP 1
 BY NO. REV. SION. DATE: 11/16/88

PLAN OF
 WATER AND SEWER MAINS

DORSEY HALL
 SECTION 2 AREA 4
 ELECTION DISTRICT NO. 2
 CONTRACT NO. 24-1833-D

SCALE
 1" = 50'
 SHEET
 2 OF 3

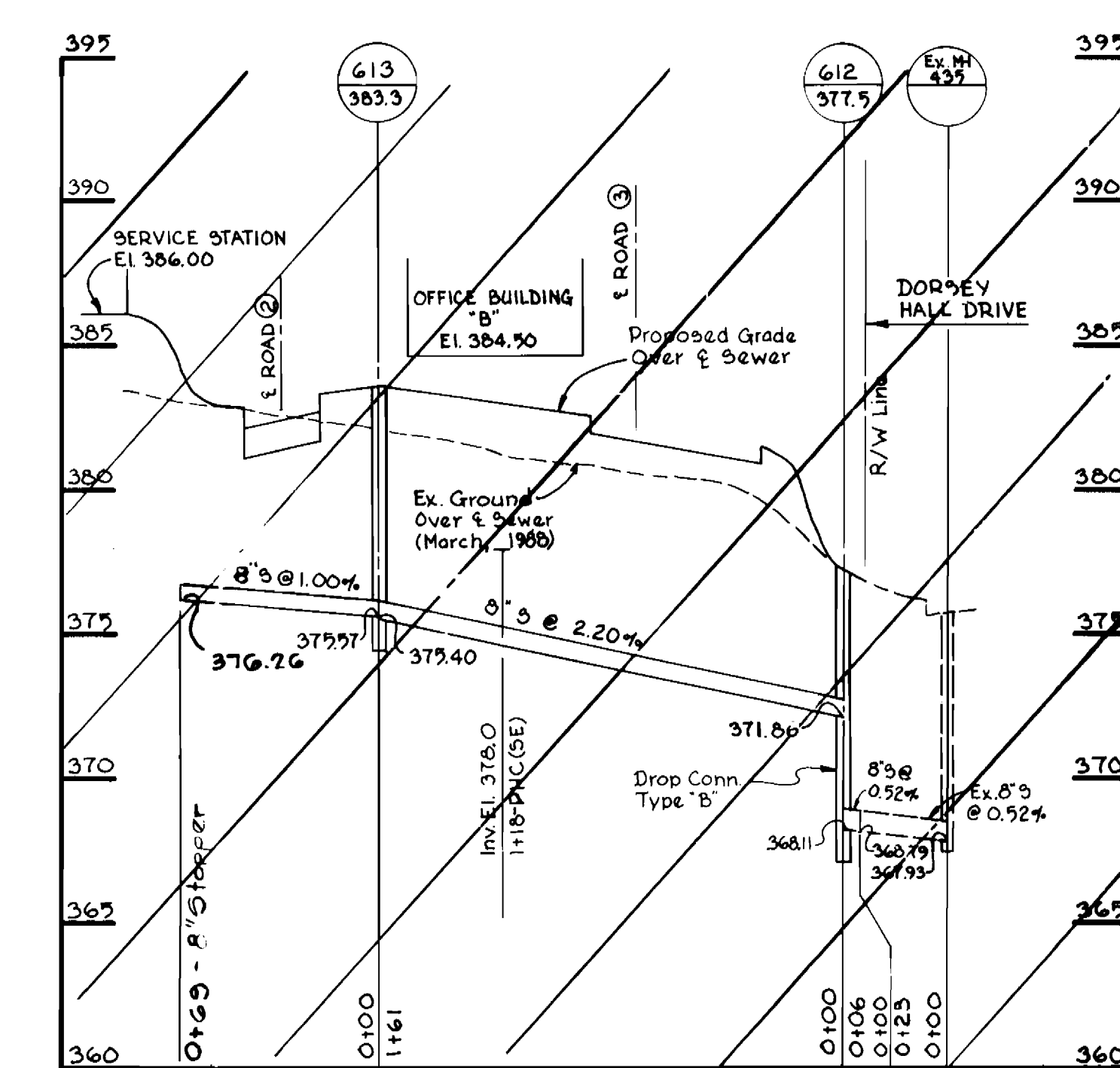
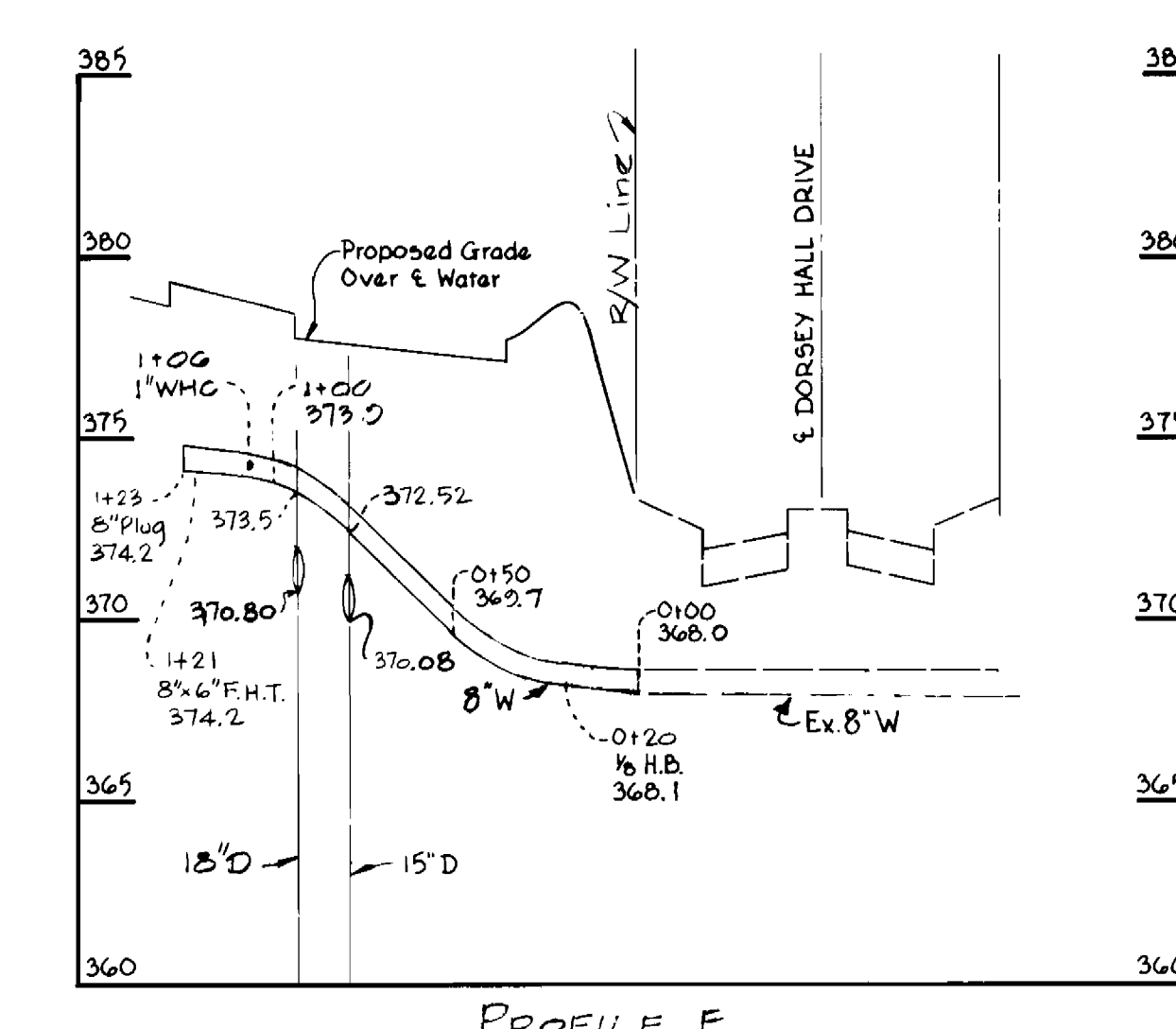
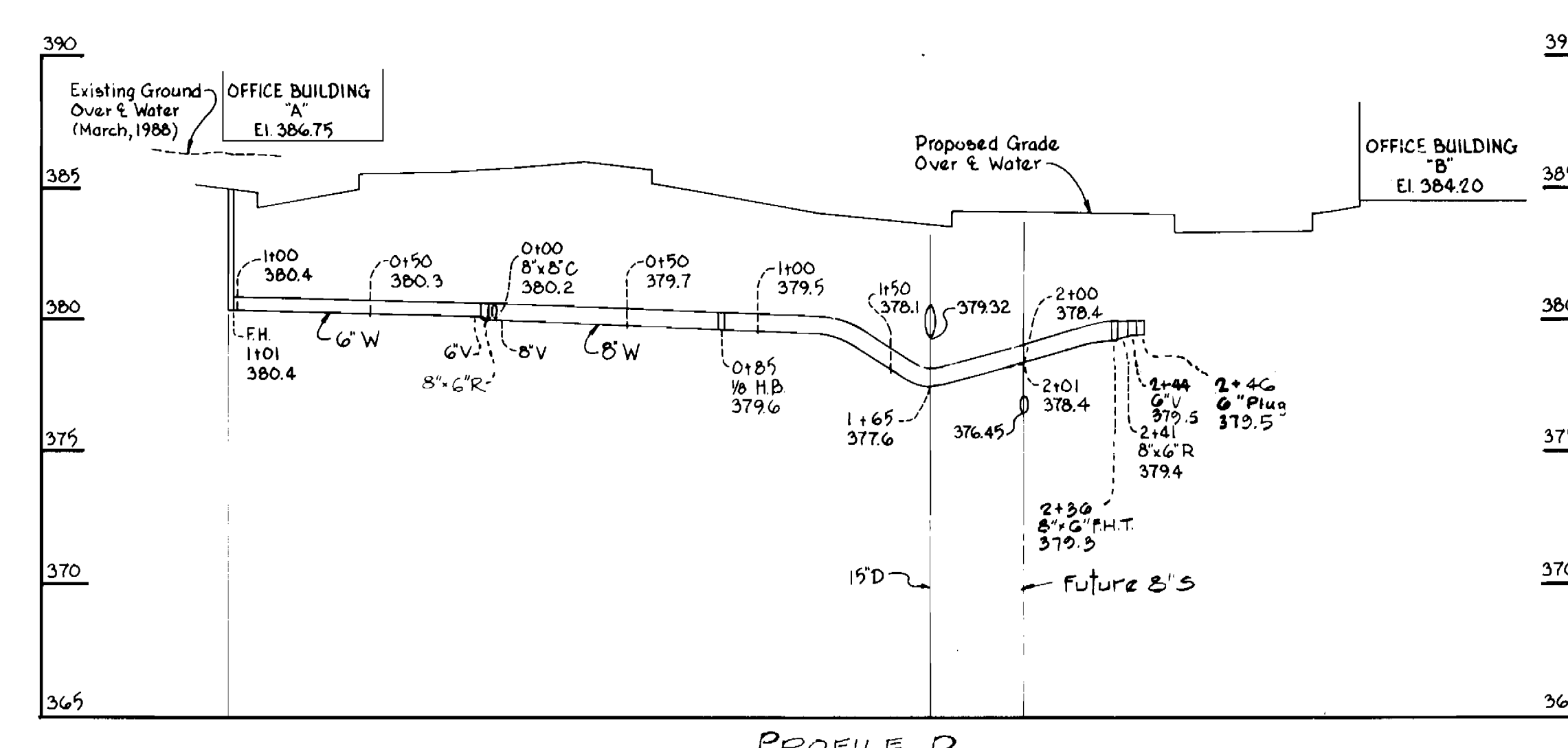
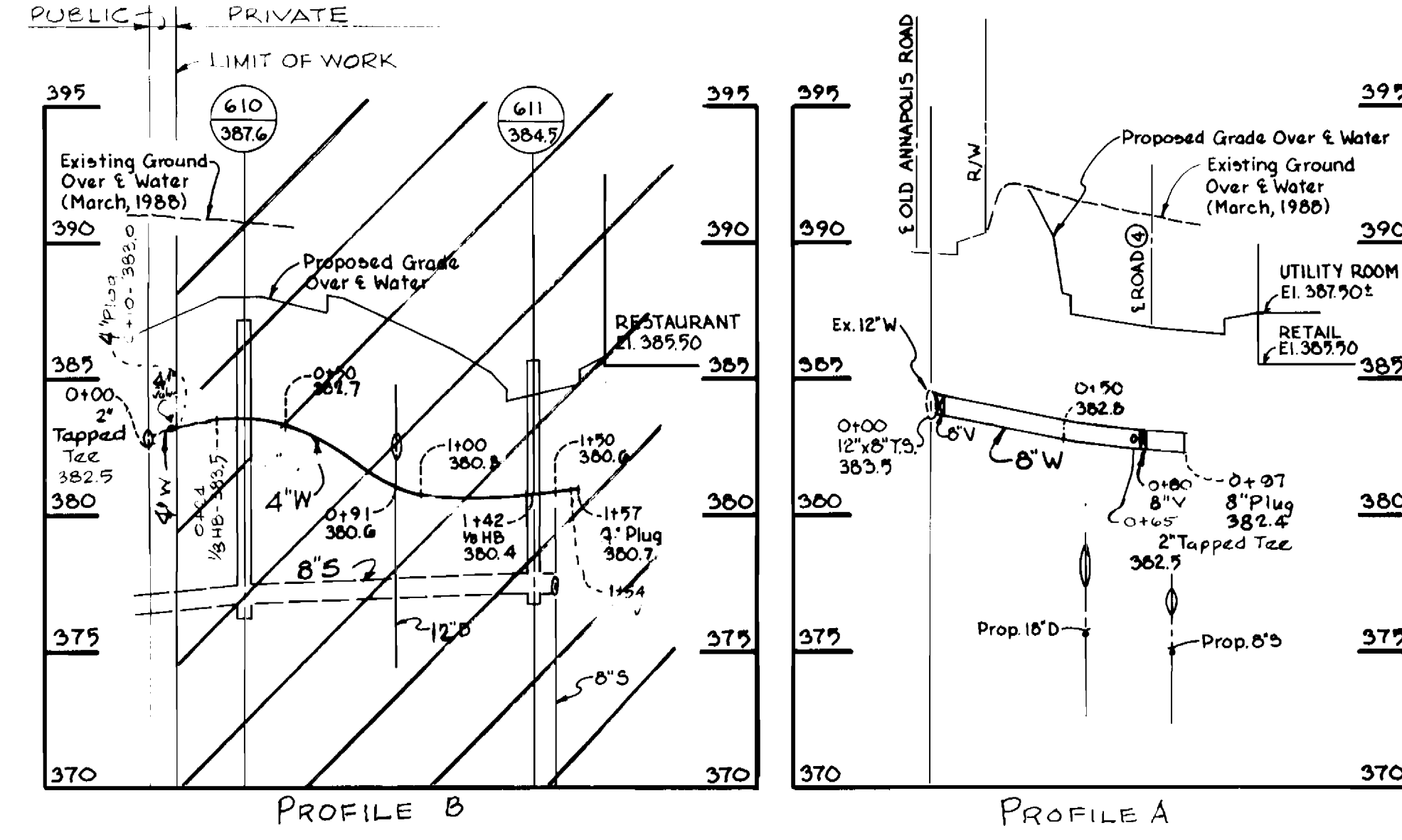
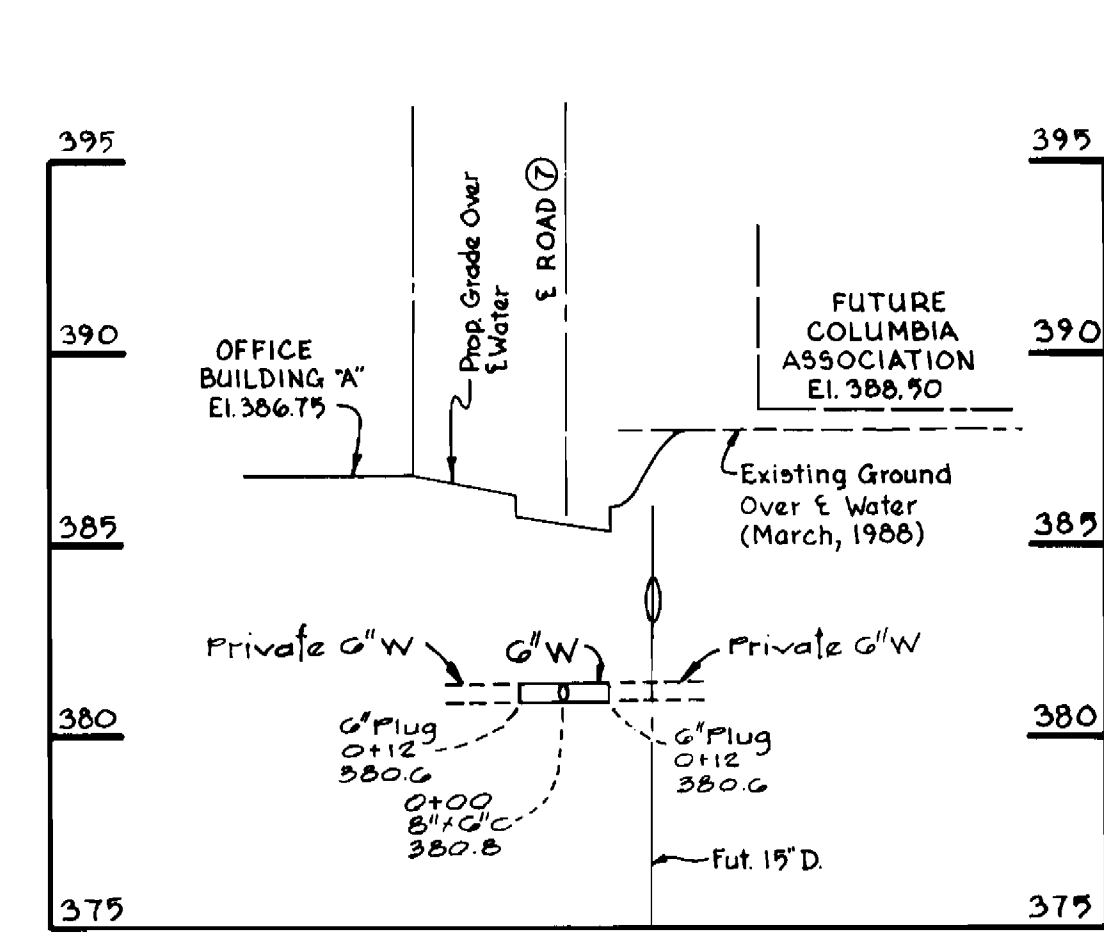
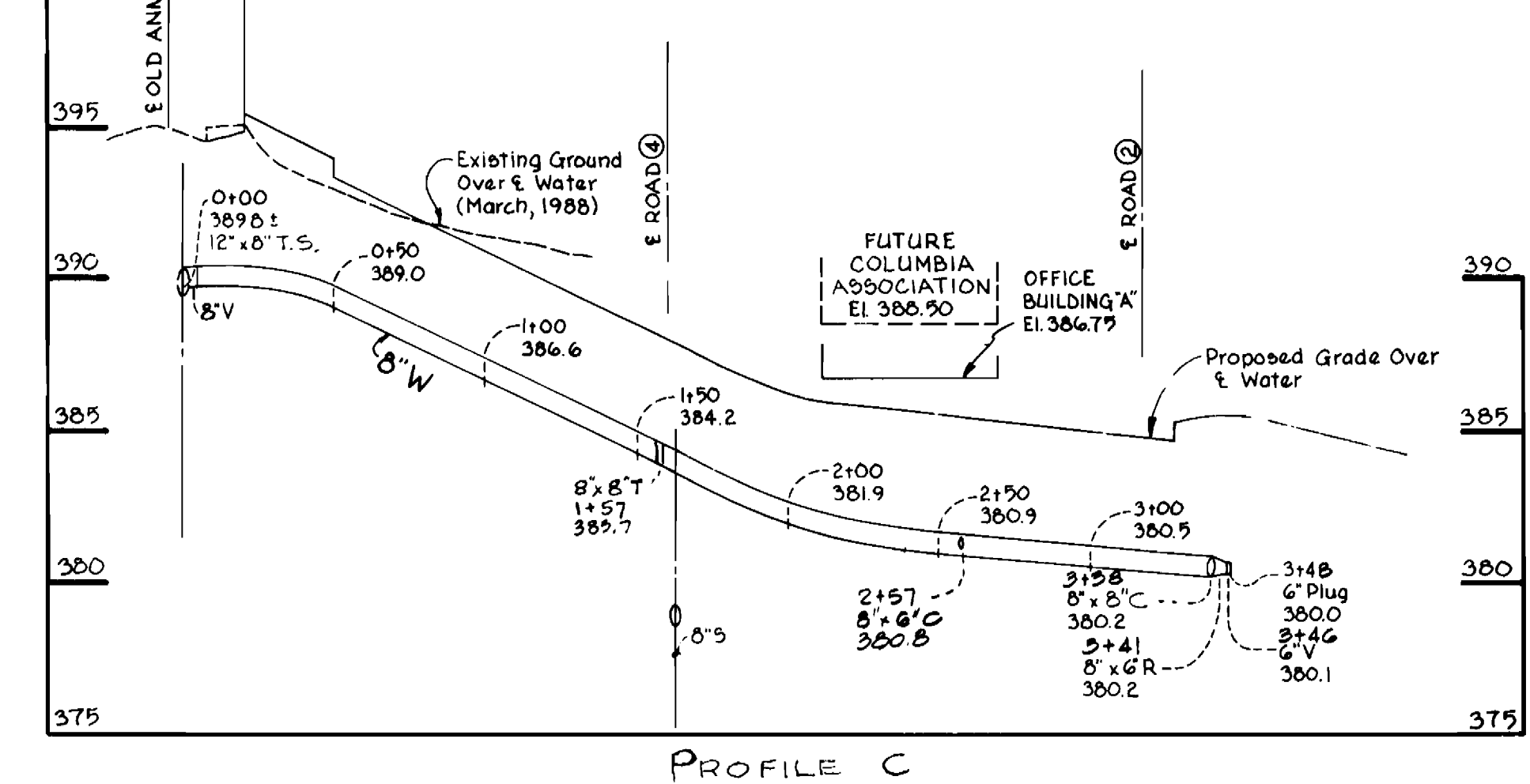
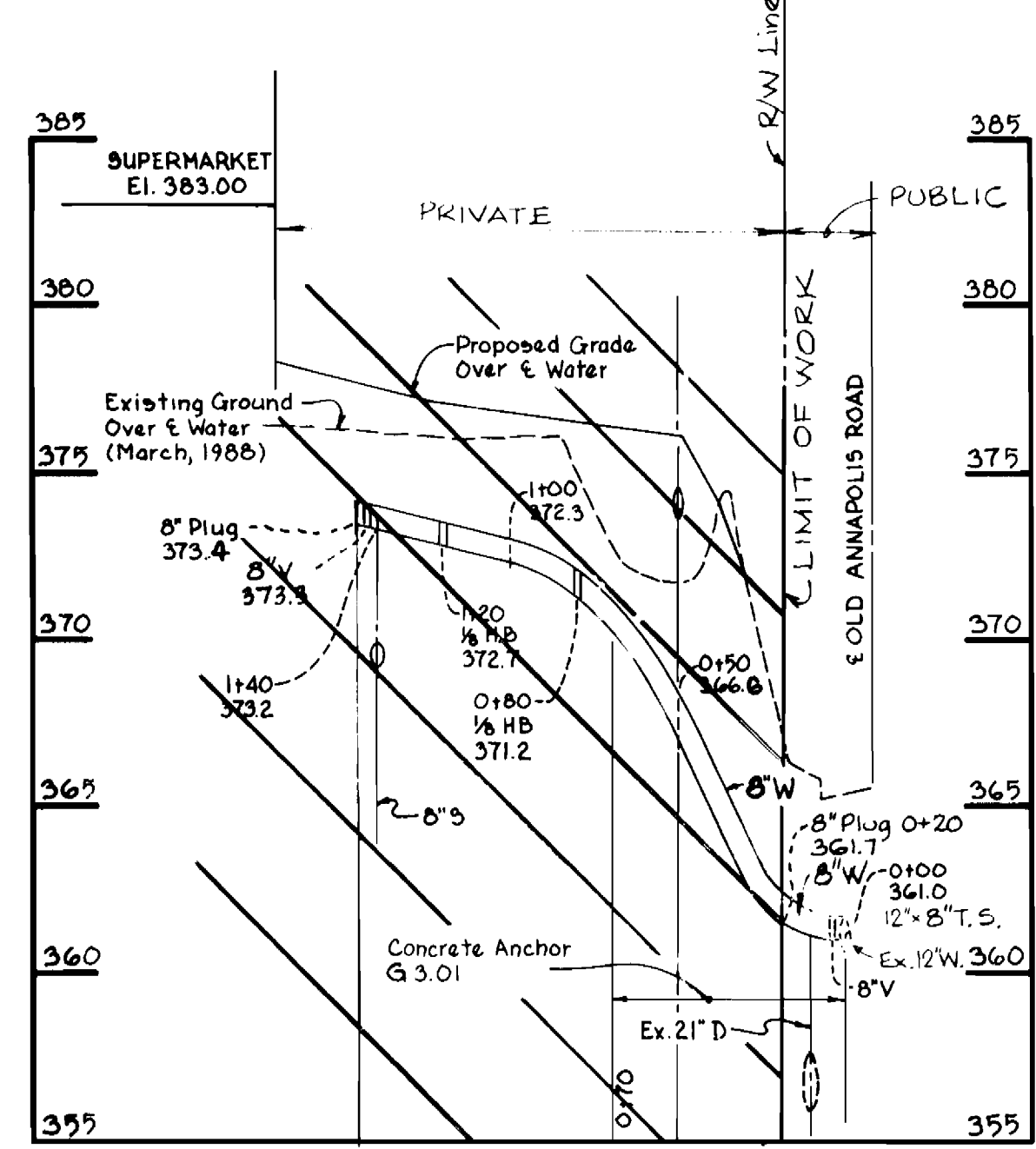
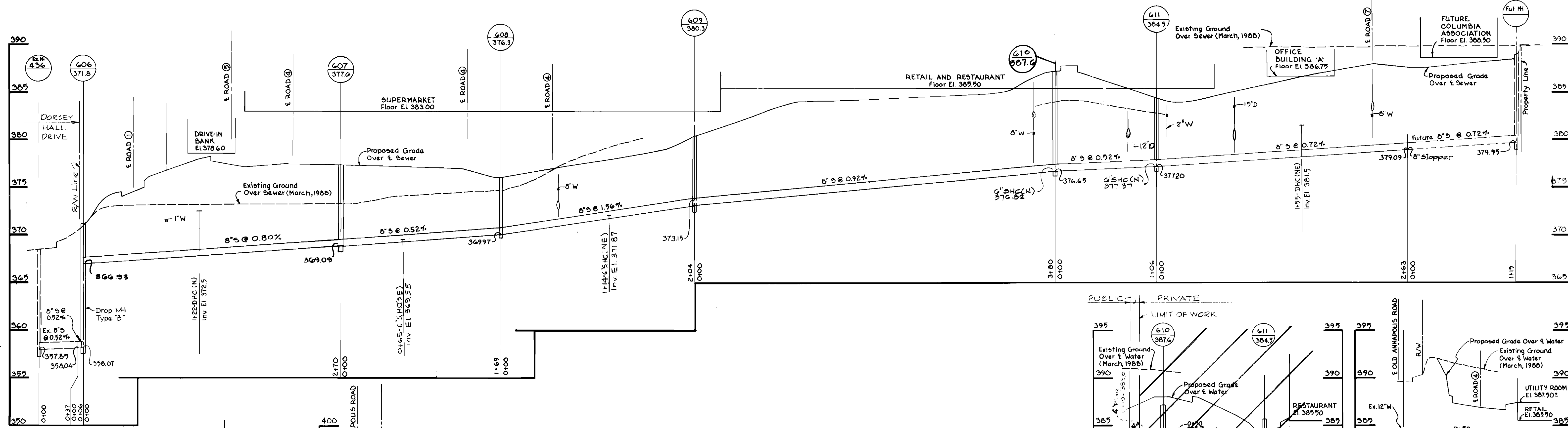

DEPARTMENT OF PUBLIC WORKS
HOWARD COUNTY, MARYLAND

Ramon J. Lee 9/1/88
DIRECTOR OF PUBLIC WORKS - DATE

John J. ... 9-2-88
CHIEF - BUREAU OF ENGINEERS - DATE

Robert ... 8-31-88
CHIEF - BUREAU OF UTILITIES - DATE

Joseph ... 4-1-88
CHIEF - LAND DEVELOPMENT DIVISION - DATE

WHITMAN, REQUARDT
AND ASSOCIATES
ENGINEERS

2315 ST PAUL ST
BALTIMORE, MARYLAND

DES. TP				
DRN. B.G.				
CHK. S.J.				
DATE	TP	REVISION	DATE	
	1	Revised Sewer HC to Supermarket	11/1/88	

PROFILES OF
WATER AND SEWER MAINS

600' SCALE MAP NO. 20 BLOCK NO.

DORSEY HALL
SECTION 2 AREA 4
ELECTION DISTRICT NO. 2
CONTRACT NO. 24-1833-D

SCALE
H: 1" = 50'
V: 1" = 5'

SHEET
3 OF 3