

SEWER HOUSE CONNECTION TABLE					
LOTS	Inv. @ R.	Min. C.	LOTS	Inv. @ R.	Min. C.
105	98.2	101.8	178/179	132.7	139.1/140.7
172	93.3	96.5	180	130.4	133.8
107	99.1	102.3	181	113.4	115.8
108	107.6	111.2	182/183	115.0	119.0
109	112.8	116.4	184/126	119.9	124.3
110	104.8	108.0	127/128	119.1	123.6
111	113.0	116.2	129	103.1	107.1
112	123.8	127.6	130	104.3	107.5
113	130.9	134.6	131	109.1	113.3
173	117.4	120.6	132	114.7	119.1
174	139.0	142.8	133	114.0	117.6
175	140.2	144.0	134	102.4	106.4
176	139.7	143.3	135	96.2	99.8
177	135.4	139.0			

TYPE OF BUILDING	Single Family
NO OF LOTS	32
NO OF WHC'S	31
NO OF SHC'S	31
DRAINAGE AREA	Patapsco W.W.T.P.

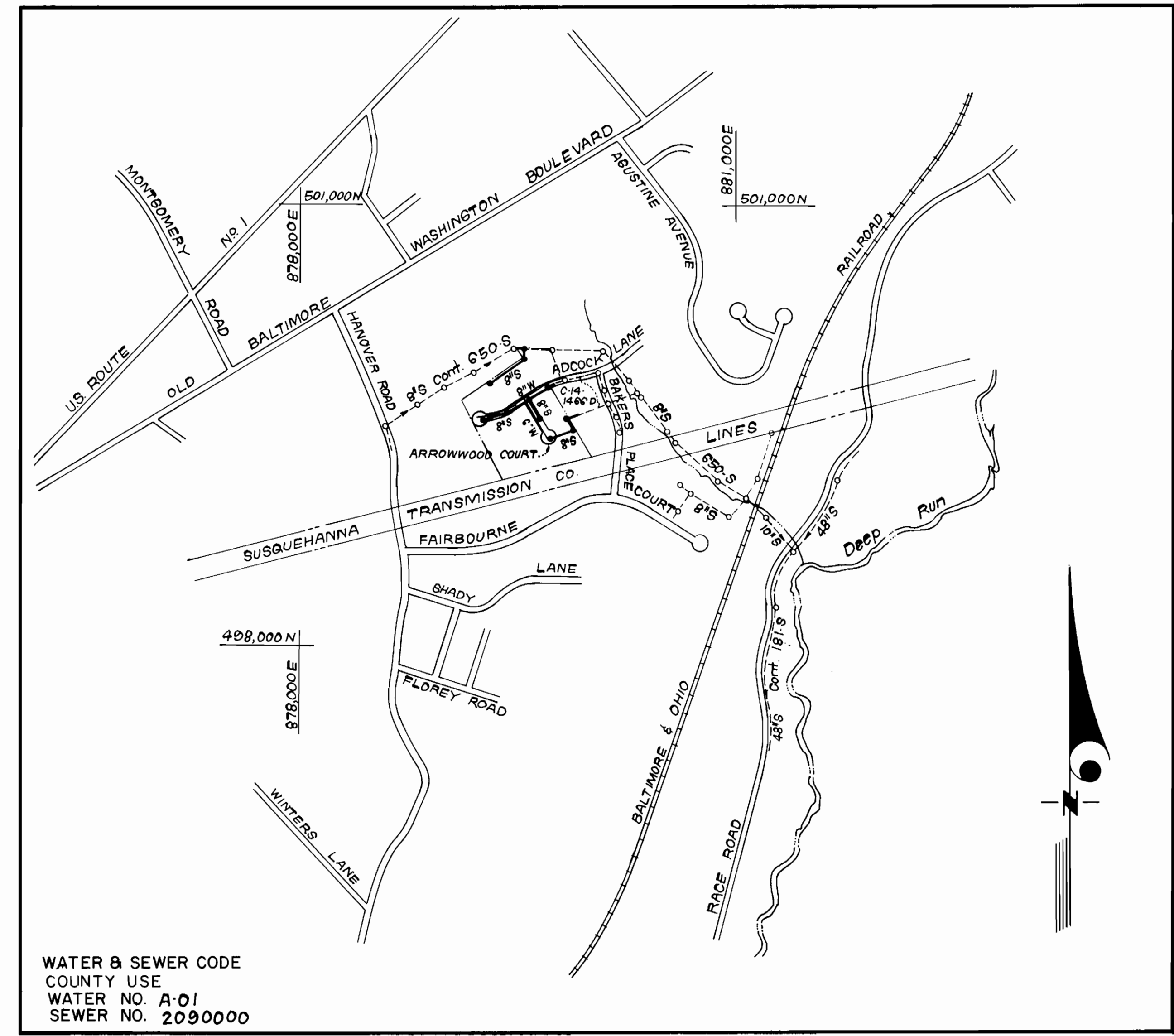

WATER & SEWER CODE  
 COUNTY USE  
 WATER NO. A-01  
 SEWER NO. 2090000

VICINITY MAP  
 SCALE: 1" = 600'

GENERAL NOTES

- Approximate location of existing mains are shown. The contractor shall take all necessary precautions to protect existing mains and services and maintain uninterrupted supply. Any damage incurred shall be repaired immediately to the satisfaction of the Inspector, at the contractor's expense.
- All horizontal controls are based on Maryland State Coordinates.
- All vertical controls are based on U.S.G.S. Datum.
- All pipe elevations shown are invert elevations.
- Clear all utilities by a minimum of 6" clear all poles by 2'-0" minimum or tunnel as required. Any cost incurred to the contractor for tunneling or bracing at poles shall be included in unit prices bid for excavation and backfill.
- For details not shown on the drawings use Howard County Standard Details.
- For materials and construction methods use Howard County Standard Specifications and H.C. Design Manual, Volume II: The Contractor shall have Volume II of the Job.
- Contractor shall locate existing utilities a minimum of two (2) weeks in advance of construction operations in the vicinity of proposed utilities at his own expense.
- Contractor shall notify the following utilities or agencies at least five (5) working days before starting work shown on these plans.  
 State Highway Administration - 531-5533  
 Baltimore Gas & Electric Company - Contractor Services - 850-4820  
 Baltimore Gas & Electric Company - Underground Damage Control - 859-9004  
 Baltimore Gas & Electric Company - Trouble Shooting - 298-9001  
 "Miss Utility" - 1-559-0100  
 Chesapeake & Potomac (C & P) Telephone Company - 1-800-257-7777  
 Colonial Pipeline Company - 795-1390  
 Bureau of Utilities Howard County - 992-2366
- Trees are to be protected from damage to maximum extent. Trees located within the construction strip are not to be removed or damaged by the contractor.
- Contractor shall remove trees, stumps, and roots along line of excavation as directed by the Inspector. Payment for such removal shall be included in the unit price bid for excavation and backfill.
- Place regulation "Men Working" and warning signs as required to comply with Maryland State Highway Administration Manual of Traffic Control for Highway Construction and Maintenance Operations.
- All water mains to be CLASS #2 D.I.P. unless otherwise noted.
- Top of all water mains to have a minimum of 3-1/2' cover unless otherwise noted.
- Valves adjacent to tees shall be strapped to tees.
- Block all fittings with concrete.
- Bury line elevations on fire hydrants shall be set to the elevations shown on the drawings. All fire hydrants shall be strapped and buttressed with concrete in accordance with standard details. Soil around the fire hydrant to be compacted in accordance with Section 1003 & 1008 of the Standard Specifications.
- All water house connections shall be for an inside meter setting.
- The contractor shall not operate any water main valves on the existing system.
- All sewer mains shall be C.S.P.X., V.C.P.X., P.V.C., or A.C.P. Class 2400 unless otherwise noted.
- The contractor shall provide a joint in all sewer mains within 2'-0" of exterior manhole wall.
- All manholes shall be 4'-0" inside diameter, unless otherwise noted.
- Water main and water house connection lines must have a minimum of one foot separation from the sanitary sewer and sewer house connections as they cross. Except at crossings, water and sewer lines shall have a minimum horizontal separation of 10'.

CONTRACT NO. 14-1749-D  
**CANBURY WOODS**  
 SECTION 2 AREA 1 LOTS 104 THRU 136  
 HOWARD COUNTY, MARYLAND  
 DEPARTMENT OF PUBLIC WORKS

QUANTITIES			
ITEM	EST'D MD	AS BUILT	MATERIAL / SUPPLIER
8" W	447 LF	445'	ATLANTIC STATES / AEP
8" W	454 LF	452'	ATLANTIC STATES / AEP
8" S	1297 LF	1227'	CHARLOTTE PIPE PUE / AEP
6" SHC	785 LF	895'	CHARLOTTE PIPE PUE / AEP
1" WHC	235 LF	215'	MUELLER CO. / AEP
3/4" WHC	485 LF	430'	MUELLER CO. / AEP
F.H.	2 EA	2	MUELLER CO. / AEP
4'-0" DIA MH	11 EA	11	ATLANTIC PEECAST
8" V	1 EA	1	MUELLER CO. / AEP
6" V (excl. FH)	1 EA	1	MUELLER CO. / AEP
BLOWOFF	1 EA		

Sediment Control Measures will be implemented in accordance with Section 219 of the Specifications & with Road Construction Plan F 88-87; Drawing, Sediment & Erosion Control.

REVIEWED FOR HOWARD SOIL CONSERVATION DISTRICT AND MEETS TECHNICAL REQUIREMENT  
 Signature: *[Signature]* DATE: 1-21-98

U.S. SOIL CONSERVATION SERVICE  
 This Development Plan is approved for Soil Erosion and Sediment Control by the Howard Soil Conservation District.

APPROVED:  
 Signature: *[Signature]* DATE: 1/21/98  
 Howard S.C.D.

DEPARTMENT OF PUBLIC WORKS  
 HOWARD COUNTY, MARYLAND

*[Signature]* 1/25/98  
 DIRECTOR OF PUBLIC WORKS DATE

*[Signature]* 1-18-98  
 CHIEF, BUREAU OF UTILITIES DATE

*[Signature]* 1/21/98  
 CHIEF, BUREAU OF ENGINEERING DATE

*[Signature]* 1/21/98  
 CHIEF, LAND DEVELOPMENT DIV. DATE

**CF&S** CLARK - FINEFROCK & SACKETT  
 ENGINEERS - PLANNERS - SURVEYORS  
 7135 MINSTREL WAY - COLUMBIA, MD. 21045  
 (301) 381-7500 - BALTO. (301) 621-8100 - WASH.



DES: JTR	1	Revised Quantities Box - deleted 8" D.C. Type B	5-5-88
DRN: JTR	2	Revised Quantities Box & Sewer House Connection Table	11-30-89
CHK: C.C.M.			
DATE: 10-22-87	BY	NO.	REVISION

TITLE SHEET

600' SCALE MAP NO. 38 BLOCK NO.

CANBURY WOODS  
 SECTION 2, AREA 1 LOTS 104 THRU 136  
 1<sup>ST</sup> ELECTION DISTRICT  
 CONTRACT NO. 14-1749-D

SCALE AS SHOWN

SHEET 1 OF 3

AS-BUILT 1/18/90





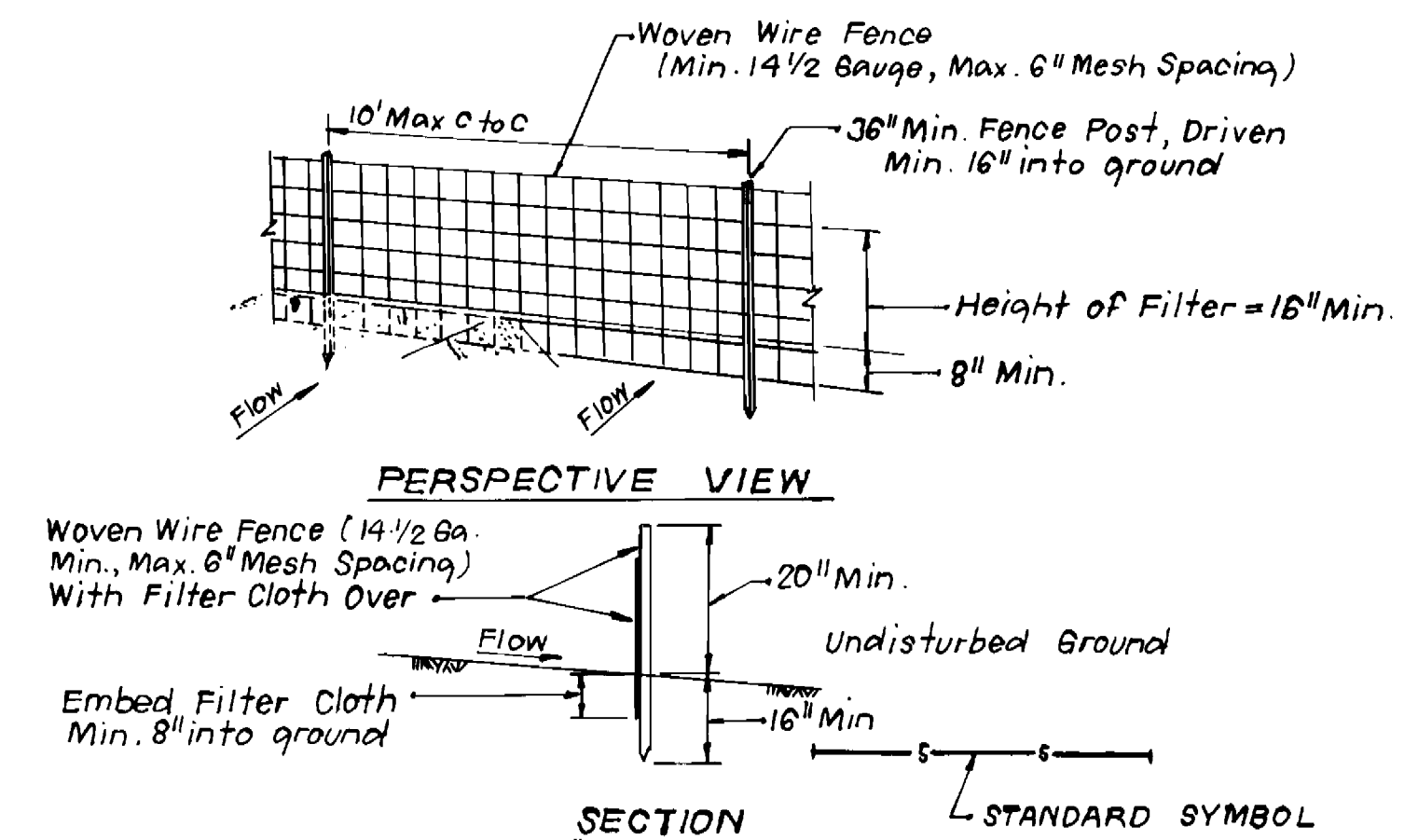
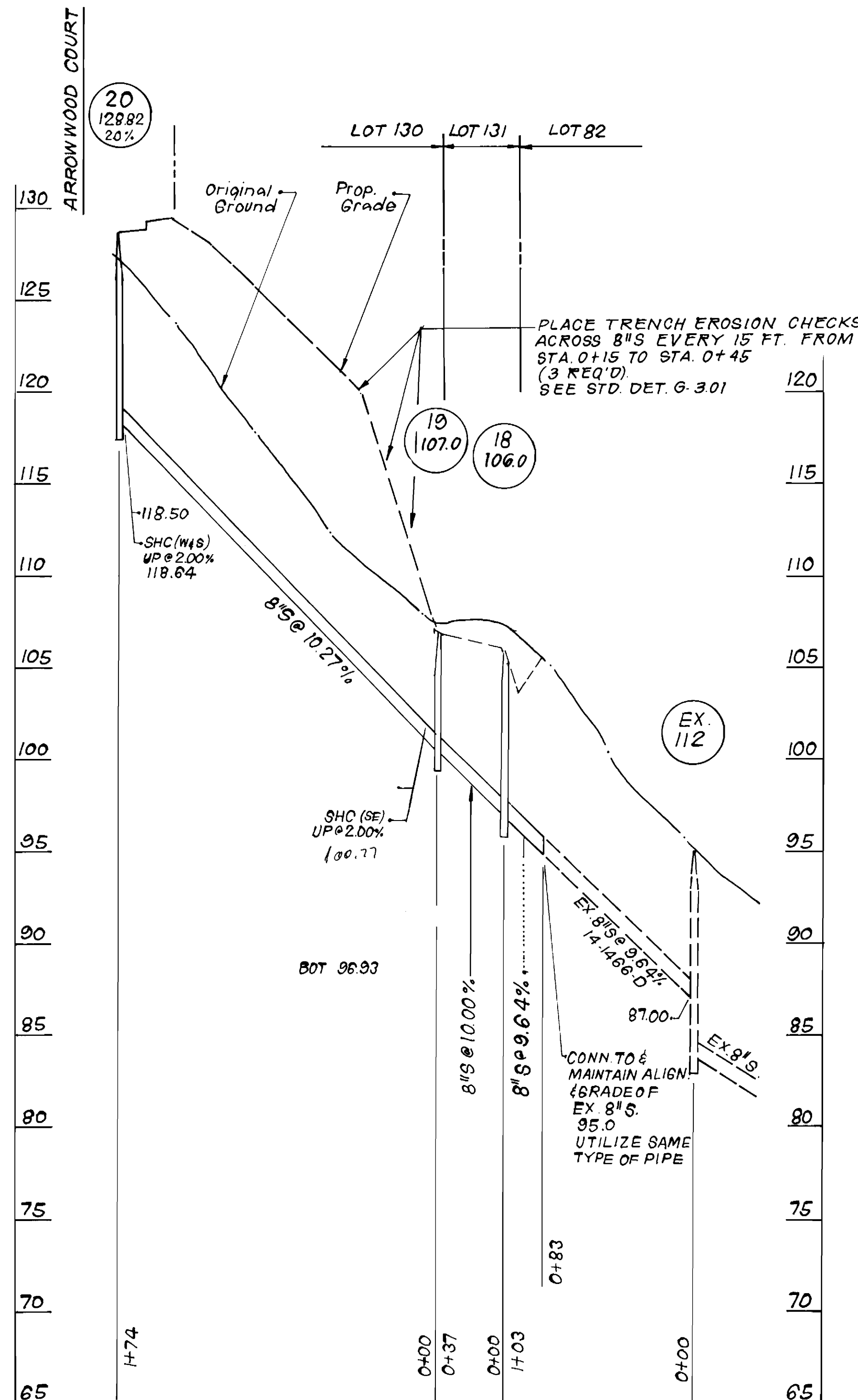
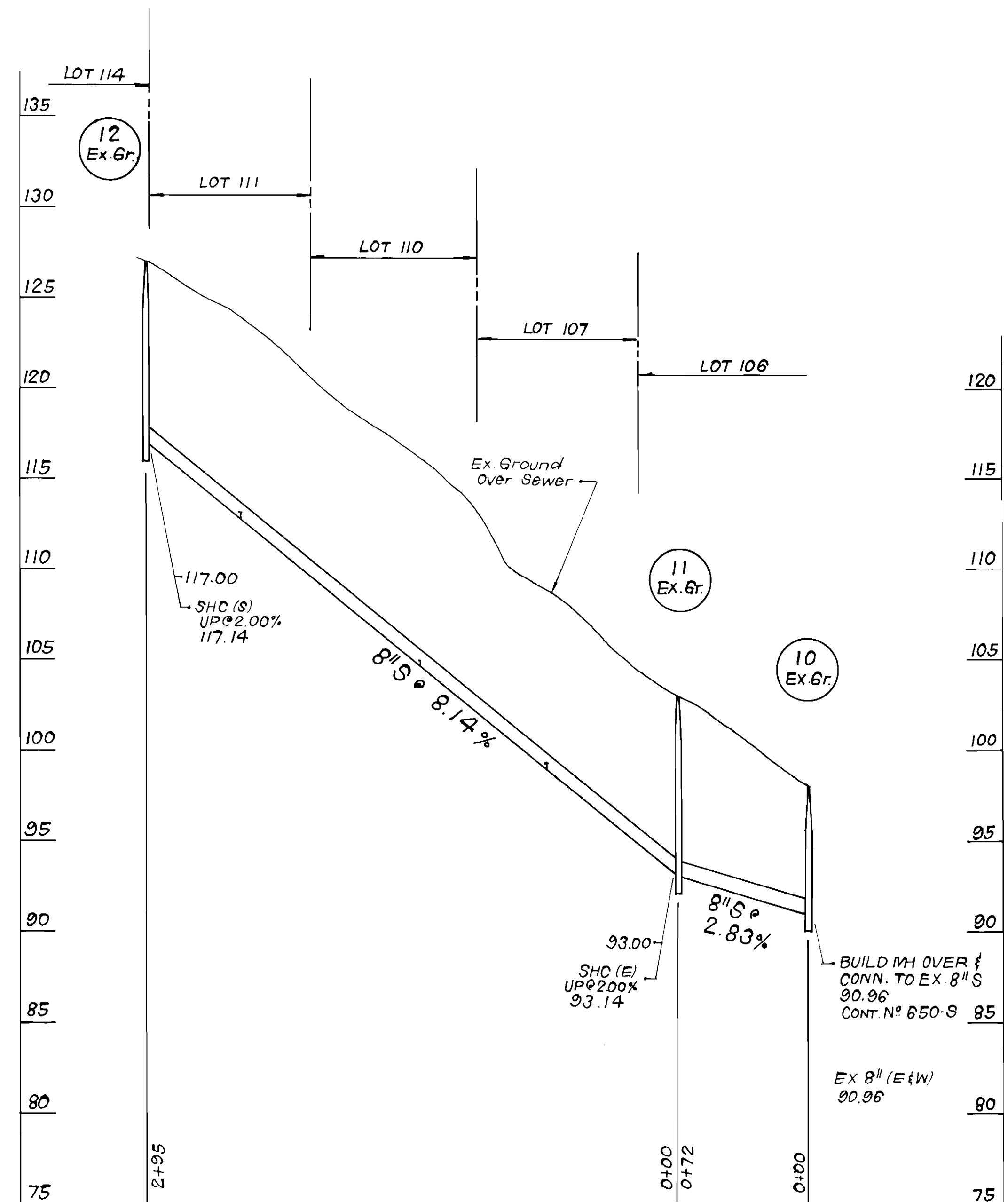

**CONSTRUCTION NOTES FOR FABRICATED SILT FENCE**

1. Woven Wire Fence to be fastened securely to fence post with wire ties or staples.
2. Filter Cloth to be fastened securely to woven wire fence with ties spaced every 24" at top and mid section.
3. When two sections of filter cloth adjoin each other they shall be overlapped by six inches and folded.
4. Maintenance shall be performed as needed and material removed when "Bulges" develop in the silt fence.

POSTS: Steel either T or U type or 2" Hardwood.  
 FENCE: Woven Wire, 1 1/2 Ga. min., 6" max., Mesh Opening.  
 FILTER CLOTH: Filter X, MiraFi 100X, Stablinka T140N or approved equal  
 PREFABRICATED UNIT: GeoFab, Envirofence, or approved equal.

**SILT FENCE DETAIL**  
NO SCALE

DEPARTMENT OF PUBLIC WORKS  
 HOWARD COUNTY, MARYLAND

*[Signature]* 1/23/88  
 DIRECTOR OF PUBLIC WORKS DATE

*[Signature]* 1-18-88  
 CHIEF, BUREAU OF UTILITIES DATE

*[Signature]* 1-22-88  
 CHIEF, BUREAU OF ENGINEERING DATE

*[Signature]* 1-22-88  
 CHIEF, LAND DEVELOPMENT DIV. DATE

**CLARK-FINEPROCK & SACKETT**  
 ENGINEERS-PLANNERS-SURVEYORS

7135 MINSTREL WAY · COLUMBIA, MD. 21045  
 (301) 381-7500 BALTO. · (301) 821-8100 WASH.

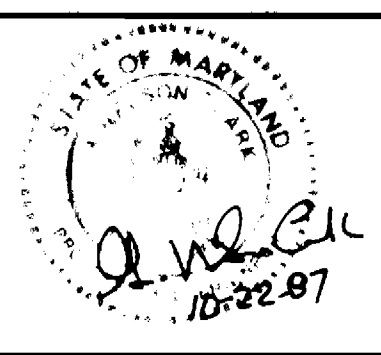

DES: JTR	1	Rev'd Sewer Profile MH 18, 19 & 20	55 88
DRN: JTR			
CHK: CCM			
DATE: 10/22/87			

PROFILES OF  
 WATER & SEWER MAINS

DATE: 10/22/87

BY: NO. REVISION DATE: 60' SCALE MAP NO. 38 BLOCK NO.

CANBURY WOODS  
 SECTION 2, AREA 1 LOTS 104 THRU 136  
 1<sup>ST</sup> ELECTION DISTRICT  
 CONTRACT NO. 14-1749-D

SCALE  
 HORZ: 1"=50'  
 VERT: 1"=5'

SHEET  
 3 OF 3

AS-BUILT 1/18/90