

QUANTITIES			
ITEM	BID	AS-BUILT	MATERIAL / SUPPLIER
8" SEWER L.F.	140	140	NATIONAL PIPE CO.
MANHOLES EA.	1	1	ATLANTIC CONC. PROD.
1" W.H.C. L.F.	30	30	M-D-K
6" S.H.G. L.F.	180	180	NATIONAL PIPE CO.
1" METER VAULT	2	2	MAYNE BROTHERS

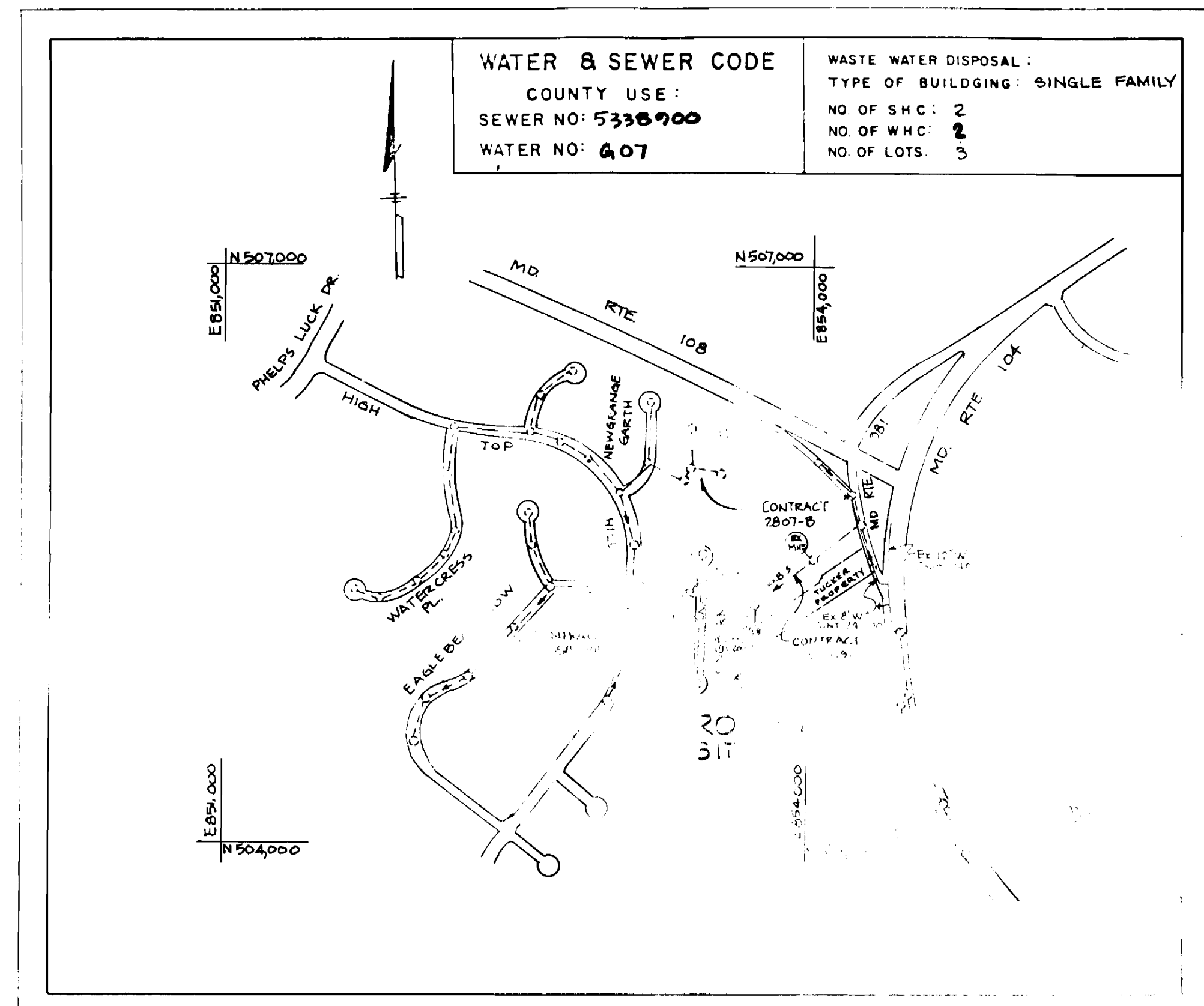

VICINITY MAP  
SCALE 1" = 400'

GENERAL NOTES

- APPROXIMATE LOCATION OF EXISTING MAINS AND UTILITIES SHOWN FOR INFORMATION. CONTRACTOR SHALL VERIFY LOCATION AND DEPTH OF EXISTING MAINS AND UTILITIES AND MAINTAIN RECORD OF ALL UTILITIES ENCOUNTERED.
- ALL EXISTING UTILITIES SHALL BE PROTECTED AND MAINTAINED THROUGHOUT THE CONSTRUCTION PERIOD.
- ALL EXISTING UTILITIES SHALL BE REPAIRED TO ORIGINAL CONDITION OR BETTER.
- ALL ELEVATIONS SHOWN ARE INVERT ELEVATIONS UNLESS NOTED OTHERWISE.
- CLEAR ALL UTILITIES BY A MINIMUM OF 6" BELOW ALL GOES BY 18" MINIMUM.
- FOR DETAILS NOT SHOWN ON THE DRAWINGS, AND FOR MATERIALS AND CONSTRUCTION METHODS, REFER TO THE STANDARD SPECIFICATIONS AND DETAILS FOR HIGHWAY CONSTRUCTION, VOLUME IV, STANDARD SPECIFICATIONS AND DETAILS FOR HIGHWAY CONSTRUCTION, PART 1000, HAVE A COPY OF VOLUME IV ON THE JOB.
- WHERE TEST PITS HAVE BEEN MADE ON EXISTING UTILITIES, THEY ARE NOTED BY THE CONTRACTOR AT THE LOCATION OF THE TEST PIT. A NOTE OR NOTES CONTAINING THE RESULTS OF THE TEST PIT OR PITS IS INCLUDED ON THE DRAWINGS. EXISTING UTILITIES IN THE VICINITY OF THE PROPOSED WORK FOR WHICH TEST PITS HAVE NOT BEEN DUG SHALL BE LOCATED BY THE CONTRACTOR TWO WEEKS IN ADVANCE OF CONSTRUCTION OPERATIONS AT HIS OWN EXPENSE.
- CONTRACTOR SHALL NOTIFY THE FOLLOWING UTILITIES OR AGENCIES AT LEAST FIVE WORKING DAYS BEFORE STARTING WORK SHOWN ON THESE PLANS:
  - STATE HIGHWAY ADMINISTRATION - 531-5533
  - BALTIMORE GAS & ELECTRIC CO. - CONTRACTOR SERVICES 561-2585
  - BALTIMORE GAS & ELECTRIC CO. - UNDER GROUND DAMAGE CONTROL - 234-5621
  - BALTIMORE GAS & ELECTRIC CO. TROUBLE SHOOTING - 298-9013
  - MISS UTILITY - 1-559-0100
  - COLONIAL PIPELINE CO. - 795-1390
  - BUREAU OF UTILITIES, HOWARD COUNTY DEPARTMENT OF PUBLIC WORKS - 992-2366
- TREES AND SHRUBS ARE TO BE PROTECTED FROM DAMAGE TO MAXIMUM EXTENT. TREES AND SHRUBS LOCATED WITHIN THE CONSTRUCTION STRIP ARE NOT TO BE REMOVED OR DAMAGED BY THE CONTRACTOR.
- CONTRACTOR SHALL REMOVE TREES, STUMPS AND ROOTS ALONG LINE OF EXCAVATION.
- ALL SEWER MAINS SHALL BE C.S.P.X., R.C.S.P., V.C.P.X., A.C.P. CLASS 2400 OR P.V.C. UNLESS OTHERWISE NOTED.
- THE CONTRACTOR SHALL PROVIDE A JOINT IN ALL SEWER MAINS WITHIN 2'-0" OF EXTERIOR MANHOLE WALL.
- ALL MANHOLES SHALL BE 4'-0" INSIDE DIAMETER UNLESS OTHERWISE NOTED.
- MANHOLES SHOWN WITH 12" AND 16" WALLS ARE BRICK MANHOLES ONLY.

PLAN  
SCALE 1" = 50'

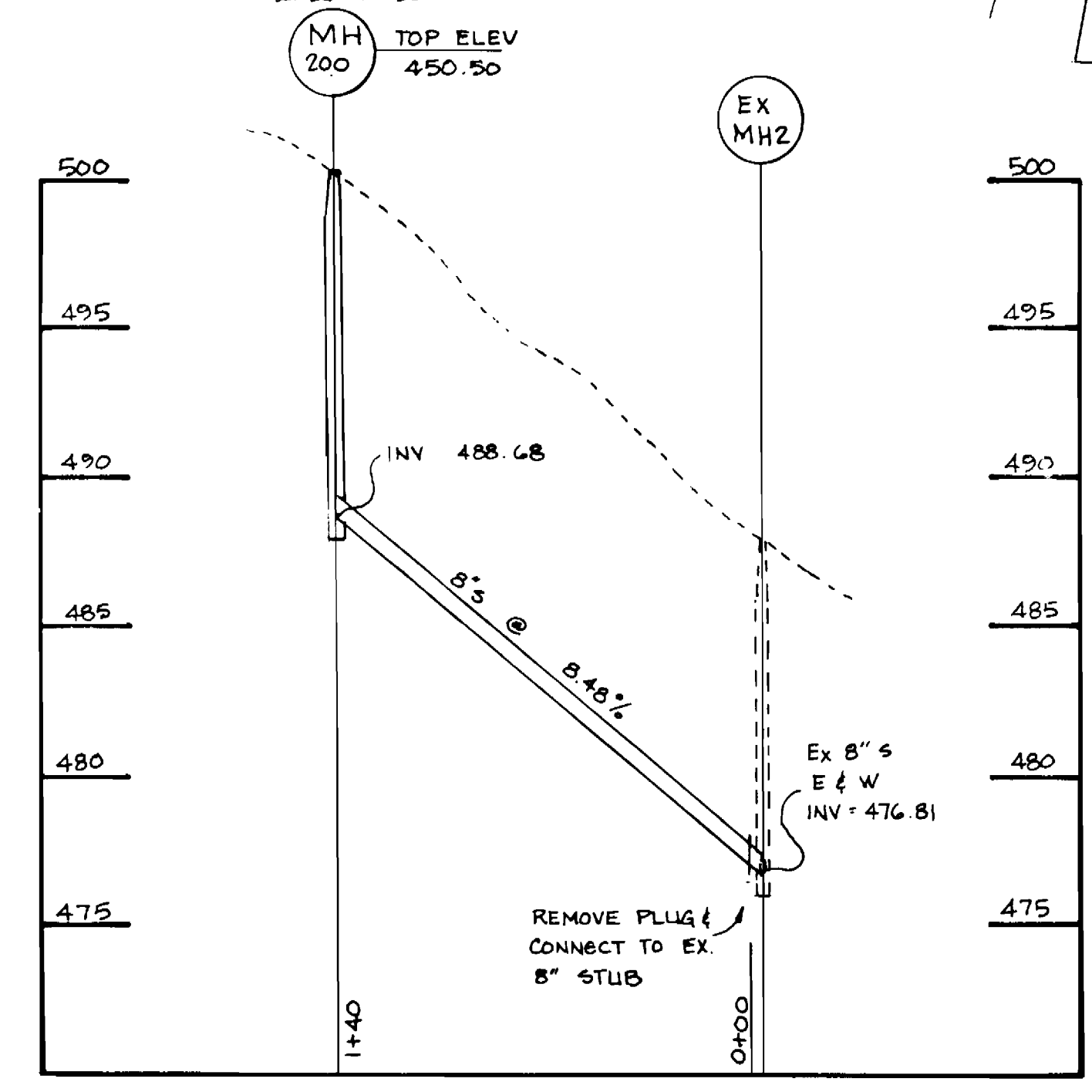

PROFILE  
SCALE VERT 1" = 5'  
HOR 1" = 50'

SEDIMENT CONTROL MEASURES WILL BE IMPLEMENTED IN ACCORDANCE WITH SECTION 219 OF THE SPECIFICATIONS.

REVIEWED FOR HOWARD SOIL CONSERVATION DISTRICT AND MEETS TECHNICAL REQUIREMENTS  
*James M. Hehn* 12-31-86  
 U.S. SOIL CONSERVATION SERVICE DATE  
 Conditionally Approved as F-86-228

THIS DEVELOPMENT PLAN IS APPROVED FOR SOIL EROSION AND SEDIMENT CONTROL BY THE HOWARD SOIL CONSERVATION DISTRICT.

*Robert W. Ziehm* 12-31-86  
 HOWARD S.C.D. DATE

DEPARTMENT OF PUBLIC WORKS  
 HOWARD COUNTY, MARYLAND

*James M. Hehn* 1-2-87  
 DIRECTOR OF PUBLIC WORKS - DATE  
*Robert W. Ziehm* 1-2-87  
 CHIEF - BUREAU OF UTILITIES - DATE  
*John R. Heinrichs* 2-2-87  
 CHIEF - BUREAU OF ENGINEERING - DATE  
*William H. ...* 1-6-87  
 CHIEF - LAND DEVELOPMENT DIVISION - DATE

JOHN R. HEINRICHS  
 5124 S ROLLING ROAD  
 RELAY, MARYLAND 21227

CONTRACT NO. 24-1596-D

PLAN & PROFILE  
 8" SEWER

TUCKER PROPERTY SUBDIVISION  
 Lots 1, 2, & 3  
 TAX MAP 30 PARCEL 181

DRAWING NO. 1 OF 1 SCALE AS SHOWN



AS-BUILT