

VICINITY MAP
SCALE: 1" = 600'

GENERAL NOTES

- APPROXIMATE LOCATION OF EXISTING MAINS ARE SHOWN. THE CONTRACTOR SHALL TAKE ALL NECESSARY PRECAUTIONS TO PROTECT EXISTING MAINS AND SERVICES AND MAINTAIN UNINTERRUPTED SUPPLY. ANY DAMAGE INCURRED SHALL BE REPAIRED IMMEDIATELY TO THE SATISFACTION OF THE ENGINEER AT THE CONTRACTOR'S EXPENSE.
- ALL HORIZONTAL CONTROLS ARE BASED ON MARYLAND STATE COORDINATES.
- ALL VERTICAL CONTROLS ARE BASED ON U.S.G.S. DATA.
- ALL PIPE ELEVATIONS ARE INVERT ELEVATIONS.
- CLEAR ALL UTILITIES BY A MINIMUM OF 6".
- FOR DETAILS NOT SHOWN ON THE DRAWINGS, AND FOR MATERIALS AND CONSTRUCTION METHODS, USE HOWARD COUNTY DESIGN MANUAL, VOLUME IV, STANDARD SPECIFICATIONS AND DETAILS FOR CONSTRUCTION. THE CONTRACTOR SHALL HAVE A COPY OF VOLUME IV ON THE JOB.
- WHERE TEST PITS HAVE BEEN MADE ON EXISTING UTILITIES, THEY ARE NOTED BY THE SYMBOL AT THE LOCATION OF THE TEST PIT. A NOTE OR NOTES CONTAINING THE RESULTS OF THE TEST PIT IS INCLUDED ON THE DRAWINGS. EXISTING UTILITIES IN THE VICINITY OF PROPOSED WORK FOR WHICH TEST PITS HAVE NOT BEEN DUG SHALL BE VERIFIED BY THE CONTRACTOR TO HIS OWN SATISFACTION. ANY DAMAGE TO EXISTING FACILITIES DUE TO THE CONTRACTOR'S NEGLIGENCE SHALL BE REPAIRED AT THE CONTRACTOR'S EXPENSE.
- CONTRACTOR SHALL NOTIFY THE FOLLOWING UTILITIES OR AGENCIES AT LEAST FIVE WORKING DAYS BEFORE STARTING WORK SHOWN ON THESE PLANS:
STATE HIGHWAY ADMINISTRATION 531-5533 C&P TELEPHONE CO. 1-800-257-7777
BALTIMORE GAS AND ELECTRIC CO. 880-4620
CONTRACTOR SERVICES
BALTIMORE GAS AND ELECTRIC CO., UNDERGROUND DAMAGE CONTROL 869-9004
BALTIMORE GAS AND ELECTRIC CO., TROUBLE SHOOTING 298-9001
MISS UTILITY 1-800-257-7777
COLONIAL PIPELINE CO. 795-1390
BUREAU OF UTILITIES, HOWARD COUNTY DEPARTMENT OF PUBLIC WORKS 992-2388
- TREES AND SHRUBS ARE TO BE PROTECTED FROM DAMAGE TO MAXIMUM EXTENT. TREES AND SHRUBS LOCATED WITHIN THE CONSTRUCTION STRIP ARE NOT TO BE REMOVED OR DAMAGED BY THE CONTRACTOR.
- CONTRACTOR SHALL REMOVE TREES, STUMPS AND ROOTS ALONG LINE OF EXCAVATION. PAYMENT OF SUCH REMOVAL SHALL BE INCLUDED IN THE UNIT PRICE BID FOR CONSTRUCTION OF THE MAIN.
- ALL WATER MAINS TO BE D.I.P. CLASS 52 UNLESS OTHERWISE NOTED.
- TOP OF ALL MAINS TO HAVE A MINIMUM OF 3 1/2' COVER UNLESS OTHERWISE NOTED.
- VALVES ADJACENT TO TEES SHALL BE STRAPPED TO TEES.
- ALL FITTINGS SHALL BE BUTTRESSED OR ANCHORED WITH CONCRETE IN ACCORDANCE WITH THE STANDARD DETAILS UNLESS OTHERWISE PROVIDED FOR ON THE DRAWINGS.
- FIRE HYDRANTS SHALL BE SET TO THE BURY LINE ELEVATIONS SHOWN ON THE DRAWINGS. ALL FIRE HYDRANTS SHALL BE STRAPPED AND BUTTRESSED WITH CONCRETE IN ACCORDANCE WITH STANDARD DETAILS. SOIL AROUND THE FIRE HYDRANT TO BE COMPACTED IN ACCORDANCE WITH SECTION 1003 OF THE STANDARD SPECIFICATIONS.
- THE CONTRACTOR SHALL NOT OPERATE ANY WATER MAIN VALVES ON THE EXISTING SYSTEM.
- ALL WATER HOUSE CONNECTIONS SHALL BE FOR INSIDE METER SETTING, UNLESS OTHERWISE NOTED ON PLANS OR IN SPECIFICATIONS.
- ALL SEWER MAINS SHALL BE C.S.P.X., R.C.S.P., V.C.P.X., A.C.P. CLASS 2400 OR P.V.C. UNLESS OTHERWISE NOTED.
- THE CONTRACTOR SHALL PROVIDE A JOINT IN ALL SEWER MAINS WITH 2'-0" OF EXTERIOR MANHOLE WALL.
- ALL MANHOLES SHALL BE 4'-0" INSIDE DIAMETER UNLESS OTHERWISE NOTED.
- FORCE MAINS SHALL BE D.I.P. ONLY.
- MANHOLES SHOWN WITH 12" AND 16" WALLS ARE FOR BRICK MANHOLES ONLY.
- MANHOLES DESIGNATED W.T. IN PLAN AND PROFILE SHALL HAVE WATERTIGHT FRAMES AND COVERS, STANDARD DETAIL G5.52. WHERE WATERTIGHT MANHOLE FRAMES AND COVERS ARE USED, SET TOP OF FRAME 1'-6" ABOVE FINISHED GRADE UNLESS OTHERWISE NOTED ON THE DRAWINGS.
- HOUSE(S) WITH THE SYMBOL "C.N.S." INDICATES THE CELLAR CAN NOT BE SERVED.

PLAN
SCALE: 1" = 50'

SEDIMENT CONTROL MEASURES FOR THIS CONTRACT WILL BE IMPLEMENTED IN ACCORDANCE WITH ARTICLE 219 OF THE SPECIFICATIONS AND SOP-87-13

HOWARD SOIL CONSERVATION DISTRICT:
REVIEWED FOR HOWARD SOIL CONSERVATION DISTRICT AND MEETS TECHNICAL REQUIREMENTS.

James M. Nelson 12-2-86
US SOIL CONSERVATION SERVICE DATE
THIS PLAN IS APPROVED FOR SOIL EROSION AND SEDIMENT CONTROL BY THE HOWARD SOIL CONSERVATION DISTRICT

Stephen L. Shuler 12-2-86
HOWARD SOIL CONSERVATION DISTRICT DATE

Item	Quantities		Material Supplier
	Estimated	As Built	
8" Water	1200 LF	1290 87	ASCI PIPE CO./CL 52
6" Water	45 LF	"	"
Fire Hydrants	4 EA.	4 EA	NJRS MUELLER CO.
8" Valves	2 EA.	2 EA	NJRS GATE VALVES
8" x 6" Reducer	3 EA.	2 EA	BENSHAM & TAYLOR
6" Valves	3 EA.	6 EA	NJRS
8" 1/2" HOR. BEND	4 EA.	4 EA	MT-45"
8" Cross Delete	1 EA.	"	"
8" Tee	3 EA.	4 EA	MT FH TEE
CAP-6"	2 EA.	3 EA	MT

DEPARTMENT OF PUBLIC WORKS
HOWARD COUNTY, MARYLAND

John F. Nemy 12-15-86
DIRECTOR OF PUBLIC WORKS DATE

Robert Benjamin 12-12-86
CHIEF, BUREAU OF UTILITIES DATE

William S. Rea 12-12-86
CHIEF, BUREAU OF ENGINEERING DATE

Michael L. F. 12-12-86
CHIEF, LAND DEVELOPMENT DATE

THE RIEMER GROUP, INC.
3105 NORTH RIDGE ROAD
ELLICOTT CITY, MARYLAND

Arthur E. Muegge 8707

DES: JDP					
DRN: F.D.M.					
CHK:					
DATE: 11-12-86	BY NO.	REVISION	DATE	600' SCALE MAP NO. 42	BLOCK NO.

PLAN OF WATER MAIN

FOX RUN
COLUMBIA GATEWAY
6TH ELECTION DISTRICT
HOWARD COUNTY, MARYLAND
CONTRACT NO. 24-1567-D

SCALE AS SHOWN

SHEET 1 OF 2

NOVEMBER 12, 1986

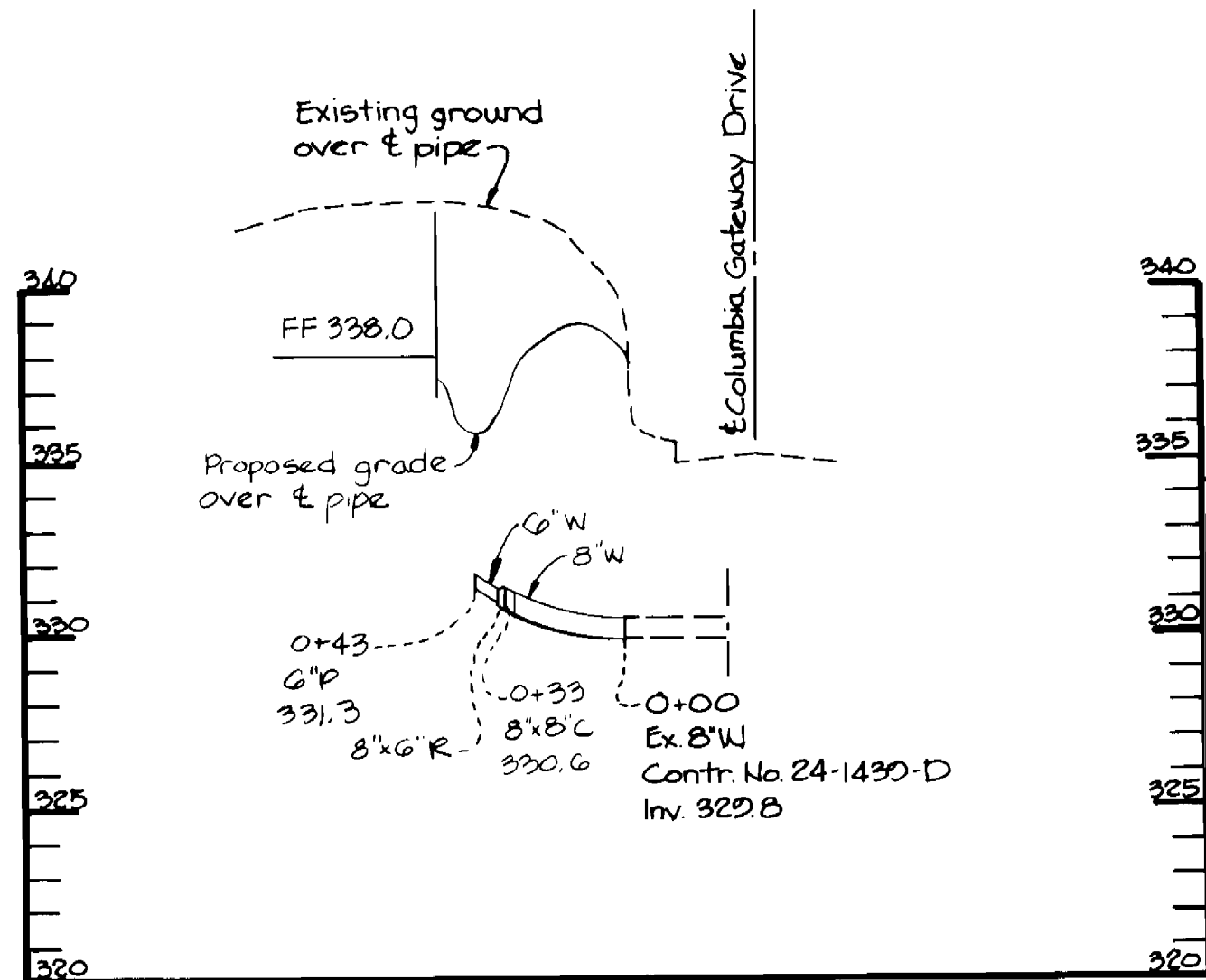

WATER PROFILE
 SCALE: HOR. 1"=50'
 VERT. 1"=5'

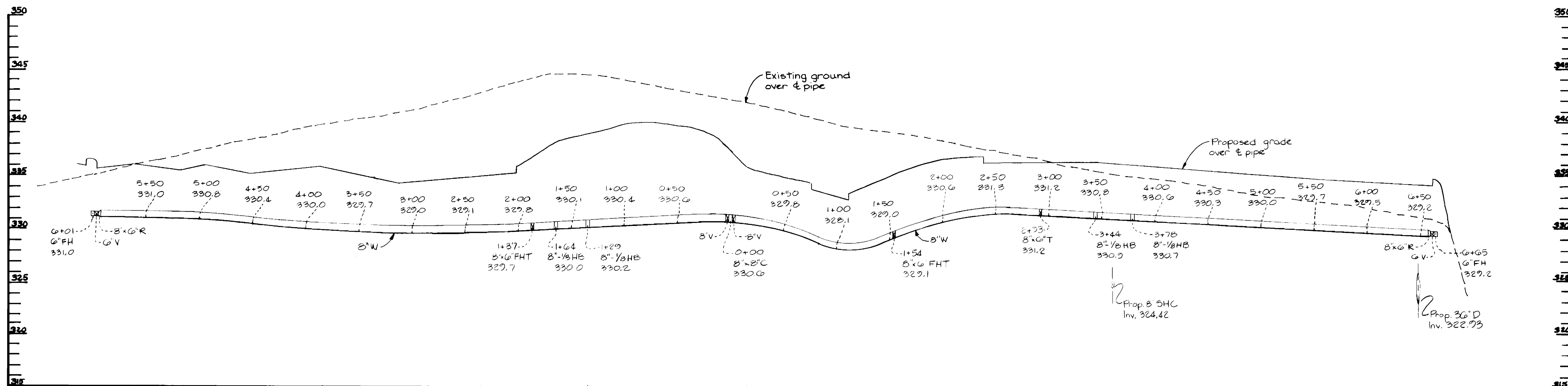

WATER PROFILE
 SCALE: HOR. 1"=50'
 VERT. 1"=5'

DEPARTMENT OF PUBLIC WORKS HOWARD COUNTY, MARYLAND <i>Henry F. Nemy</i> DIRECTOR OF PUBLIC WORKS DATE: 12-15-86 <i>Robert B. ...</i> CHIEF, BUREAU OF UTILITIES DATE: 12-12-86	THE RIEMER GROUP, INC. 3105 NORTH RIDGE ROAD ELLICOTT CITY, MARYLAND <i>Arthur E. Muegge</i> ARTHUR E. MUEGGE # 8707	DES: JDP			PROFILE OF WATER MAIN	FOX RUN COLUMBIA GATEWAY 6TH ELECTION DISTRICT HOWARD COUNTY, MARYLAND CONTRACT NO.-24-1567-D	SCALE AS SHOWN
		DRN: SVW CHK:					600' SCALE MAP NO. 42 BLOCK NO.
		DATE: 11-12-86	BY NO.	REVISION	DATE		AS-CUILT NOVEMBER 12, 1986