

| QUANTITIES | | | |
|----------------|-----------|----------|-------------------------------------------------------|
| ITEM | ESTIMATED | AS BUILT | MATERIAL/SUPPLIER |
| 8" SEWER | 99 L.F. | 66 L.F. | PVC NATIONAL PIPE CO. |
| MANHOLES | 1 | 1 | ATLANTIC PRECAST |
| 6" WATER | 287 L.F. | 216 L.F. | UTYTON PIPE DBL. ATLANTIC STATES PIPE CO. |
| 6" VALVE | 1 | 1 | ATLANTIC STATES PIPE CO. |
| FIRE HYDRANT | 1 | 1 | MODEL 4425 4" FIRE HYDRANT SUP. PRECAST SMITH-MIDLAND |
| 4" METER VAULT | 1 | 1 | PRECAST SMITH-MIDLAND |
| 1" METER VAULT | 1 | 1 | PRECAST SMITH-MIDLAND |

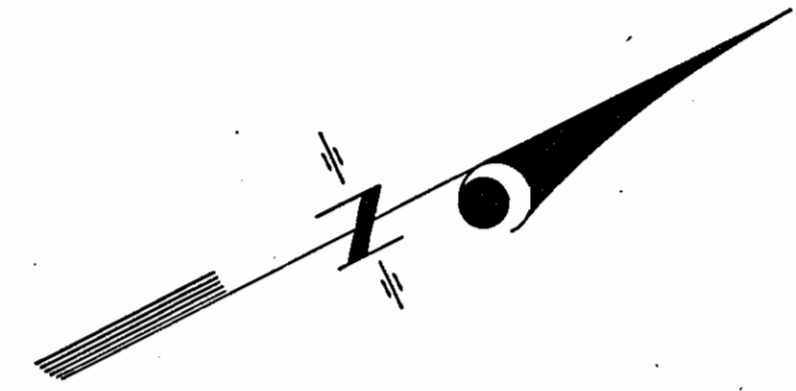

E 851.750
N 324.000

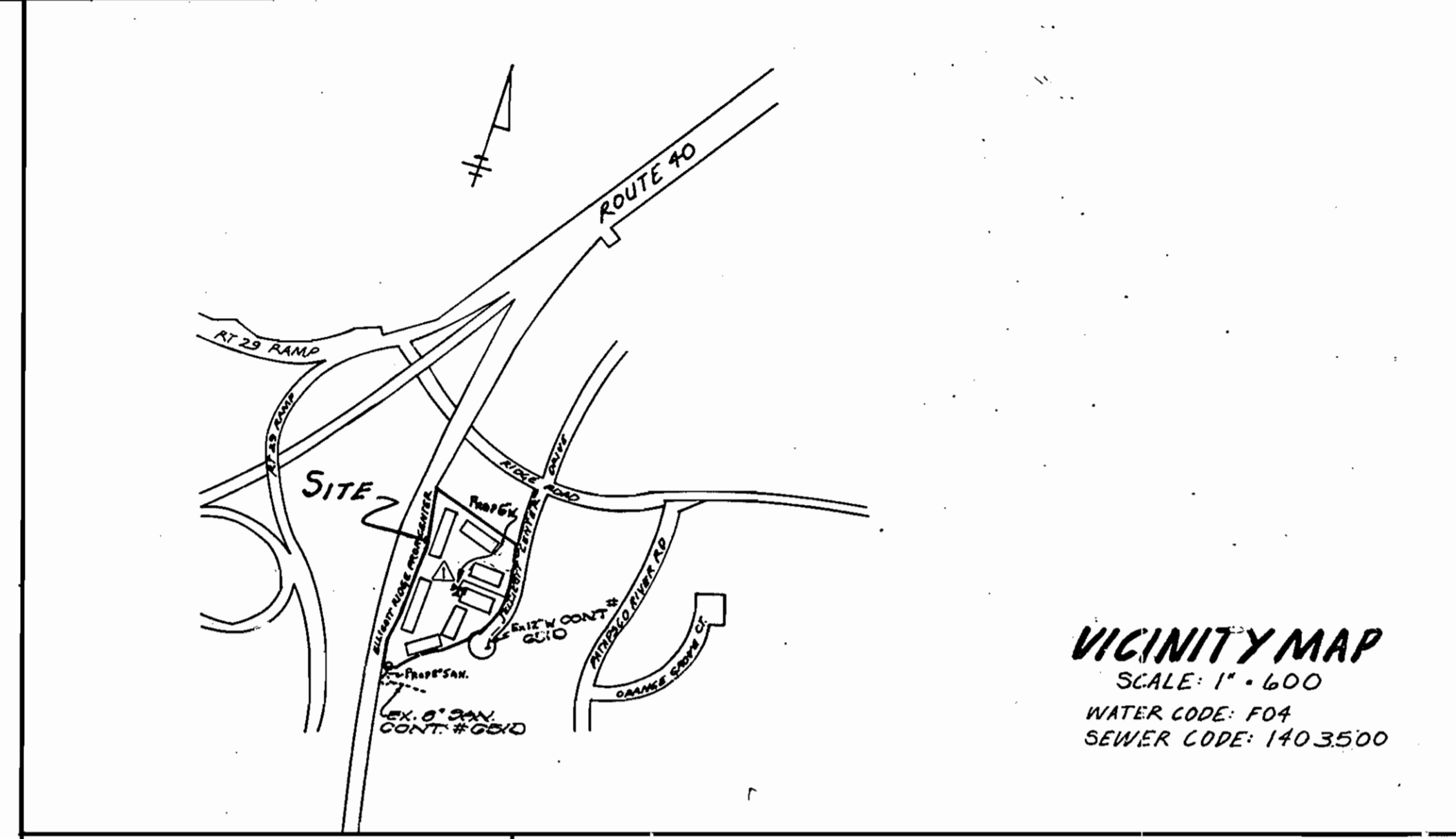

VICINITY MAP
SCALE: 1" = 600
WATER CODE: F04
SEWER CODE: 140.3500

TYPE OF BUILDINGS - OFFICE CONDOMINIUMS
NUMBER OF LOTS - ONE
NUMBER OF WATER HOUSE CONNECTIONS - 41
NUMBER OF SEWER HOUSE CONNECTIONS - 41
DRAINAGE AREA - PATARSCO

BM1 - TOP OF INLET ELLICOTT CENTER DR.
At End of Culch. S. & EL. 387.90'
BM2 - TOP OF RIM EX. M.H. #956
END OF CUL. DE SAC EL. 388.92'

NOTE:
1. REF. HOWARD COUNTY DESIGN MANUAL VOL. II, FOR (M-1) SEE DETAIL 9-B-1?

GENERAL NOTES

- Approximate location of existing mains are shown. The contractor shall take all necessary precautions to protect existing mains and services and maintain uninterrupted supply. Any damage incurred shall be repaired immediately to the satisfaction of the Engineer, at the Contractor's expense.
- All horizontal controls are based on Maryland State Coordinates.
- All vertical controls are based on U.S.G.S. Datum.
- All pipe elevations shown are invert elevations.
- Clear all utilities by a minimum of 6". Clear all poles by 2'-0" minimum of tunnel as required. Any cost incurred to the contractor for tunneling or bracing at poles shall be included in unit prices bid for construction of the main.
- For details not shown on the drawings use Howard County Standard Specifications.
- For materials and construction methods use Howard County Standard Specifications.
- Contractor shall locate existing utilities a minimum of two (2) weeks in advance of construction operations in the vicinity of proposed utilities at his own expense.
- Contractor shall notify the following utilities or agencies at least five (5) working days before starting work shown on these plans:
 - State Highway Administration - 531-5533
 - Baltimore Gas & Electric Company - Underground Electric Distribution Customer Service - 649-0123
 - Baltimore Gas & Electric Company - Underground Gas Distribution Customer Service - 649-0123
 - Engineering - "Damage Control" - 234-5421
 - "Miss Utility" - 1-800-257-7777
 - Chesapeake & Potomac (CAP) Telephone Company - 725-9976
 - American Telephone and Telegraph - Cable Location Division - 393-3353
 - Colonial Pipeline Company - 795-1390
 - Bureau of Utilities Howard County - 992-2354
- Trees are to be protected from damage to maximum extent. Trees located within the construction strip are not to be removed or damaged by the contractor.
- Contractor shall remove trees, stumps, and roots along line of excavation as directed by the Engineer. Payment shall be included in the unit price bid for construction of the main.
- Place regulation "Men Working" and warning signs as required to comply with Maryland State Highway Administration Manual of Traffic Control for Highway Construction and Maintenance Operation.
- All water mains to be C.I.P. or D.I.P. unless otherwise noted.
- Top of all water mains to have a minimum of 3'-1/2" cover unless otherwise noted.
- Valves adjacent to tees shall be strapped to tees.
- Block all fittings with concrete.
- Bury line elevations on fire hydrants shall be set to the elevations shown on the drawings. All fire hydrants shall be strapped and buttressed with concrete in accordance with standard details. Soil around the fire hydrant to be compacted in accordance with Sections 10.03 and 10.08 of the Standard Specifications.
- All water house connections shall be for inside meter setting. The contractor shall not operate any water main valves on the existing system. For all copper water house connections, utilize flared type settings only.
- All sewer mains shall be C.S.P., R.C.S.P., V.C.S.P., A.C.P. Class 2400 or PVC unless otherwise noted.
- The contractor shall provide a joint in all sewer mains within 2'-0" of exterior manhole wall.
- All manholes shall be 4'-0" inside diameter, unless otherwise noted.

NOTE:
3" METER VAULT LOWERED 2' BELOW ORIGINAL PROF. ELEV. SEE REVISED CUT SHEET (DANBERRY AND PAVIS) FOR NEW ELEV.

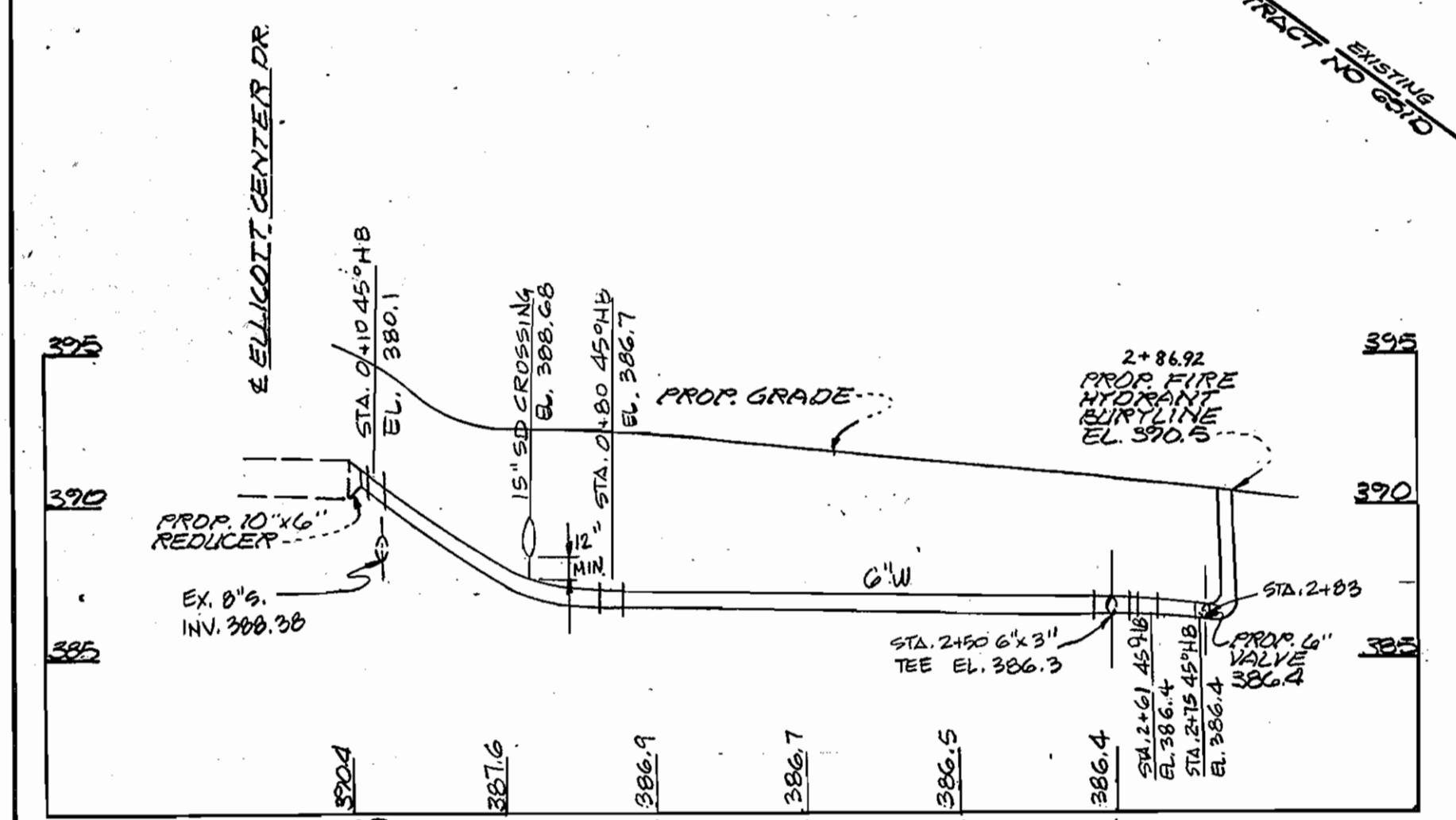
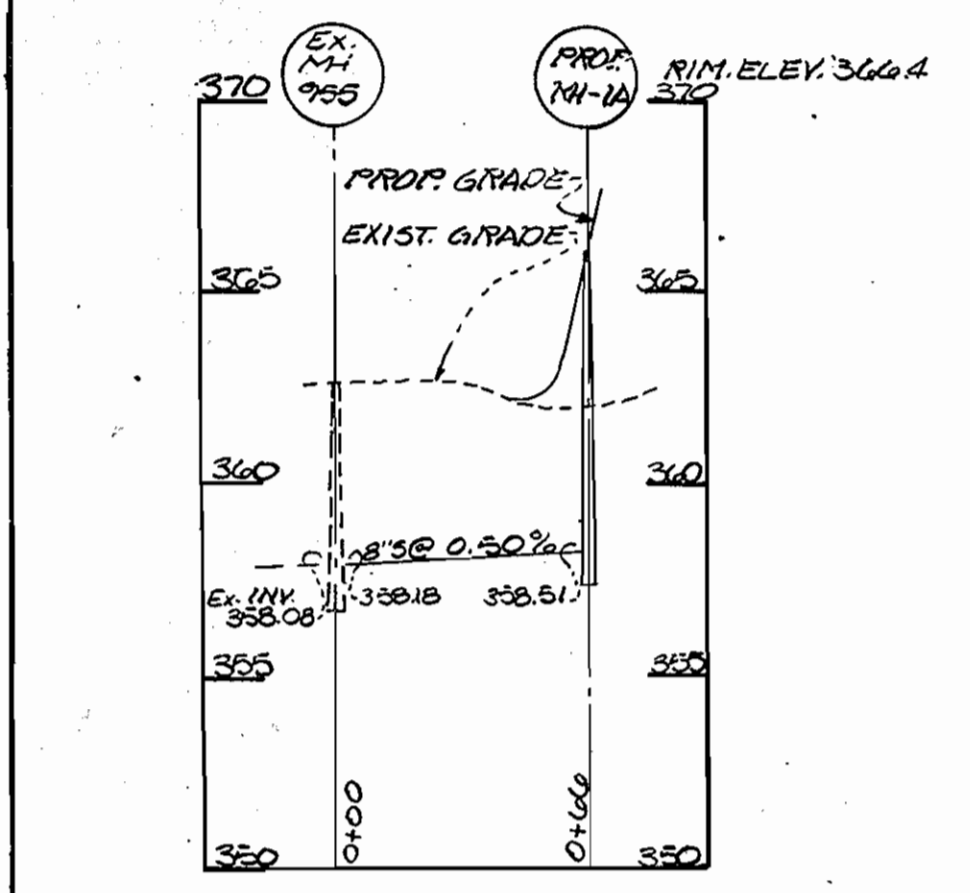

PUBLIC WATER LINE PROFILE

NOTE: SEDIMENT CONTROL WILL BE PROVIDED IN ACCORDANCE WITH THE APPROVED PLAN SDP-86-263 THIS PLAN AND ARTICLE 15 OF THE HOWARD COUNTY DESIGN MANUAL.

() THIS DEVELOPMENT PLAN IS APPROVED FOR SOIL EROSION AND SEDIMENT CONTROL BY THE HOWARD SOIL CONSERVATION DISTRICT.
Stephen K. Finley 9/24/86
HOWARD S.C.D. DATE

() REVIEWED FOR HOWARD S.C.D. AND MEETS TECHNICAL REQUIREMENTS.
Jack Helm 9/24/86
U.S. SOIL CONSERVATION SERVICE DATE

DEPARTMENT OF PUBLIC WORKS
HOWARD COUNTY, MARYLAND

Robert M. ... 10-1-86
DIRECTOR OF PUBLIC WORKS DATE

Robert M. ... 9-30-86
CHIEF, BUREAU OF UTILITIES DATE

William T. ... 10-1-86
CHIEF, LAND DEVELOPMENT DIVISION DATE

Dewberry & Davis
Engineers Architects Planners Surveyors
3300 N. Ridge Road Suite 100 Ellicott City, Md. 21043
(301) 441-7475

William T. ...

| | |
|---------------|--------------------------------------------------|
| DES: DEP | 11-4 86 REVISION TO WATER LINES |
| DRN: JRG | 11-25 86 REVISION TO WATER LINE PROFILE (PUBLIC) |
| CHK: YPB | |
| DATE: 9-19-86 | |
| BY: NO. | REVISION |
| DATE | 600' SCALE MAP NO. 24 BLOCK NO. |

OWNER / DEVELOPER
THE ELLICOTT RIDGE CORPORATION
3525 ELLICOTT MILLS DR.
SUITE 'B' ELLICOTT CITY, MD. 21043

WATER & SEWER
ELLICOTT CENTER
2nd ELECTION DISTRICT
HOWARD COUNTY, MARYLAND

SCALE AS SHOWN
SHEET 1 OF 1

BRUNING 44-132 69150