

PLAN VIEW
1"=50'

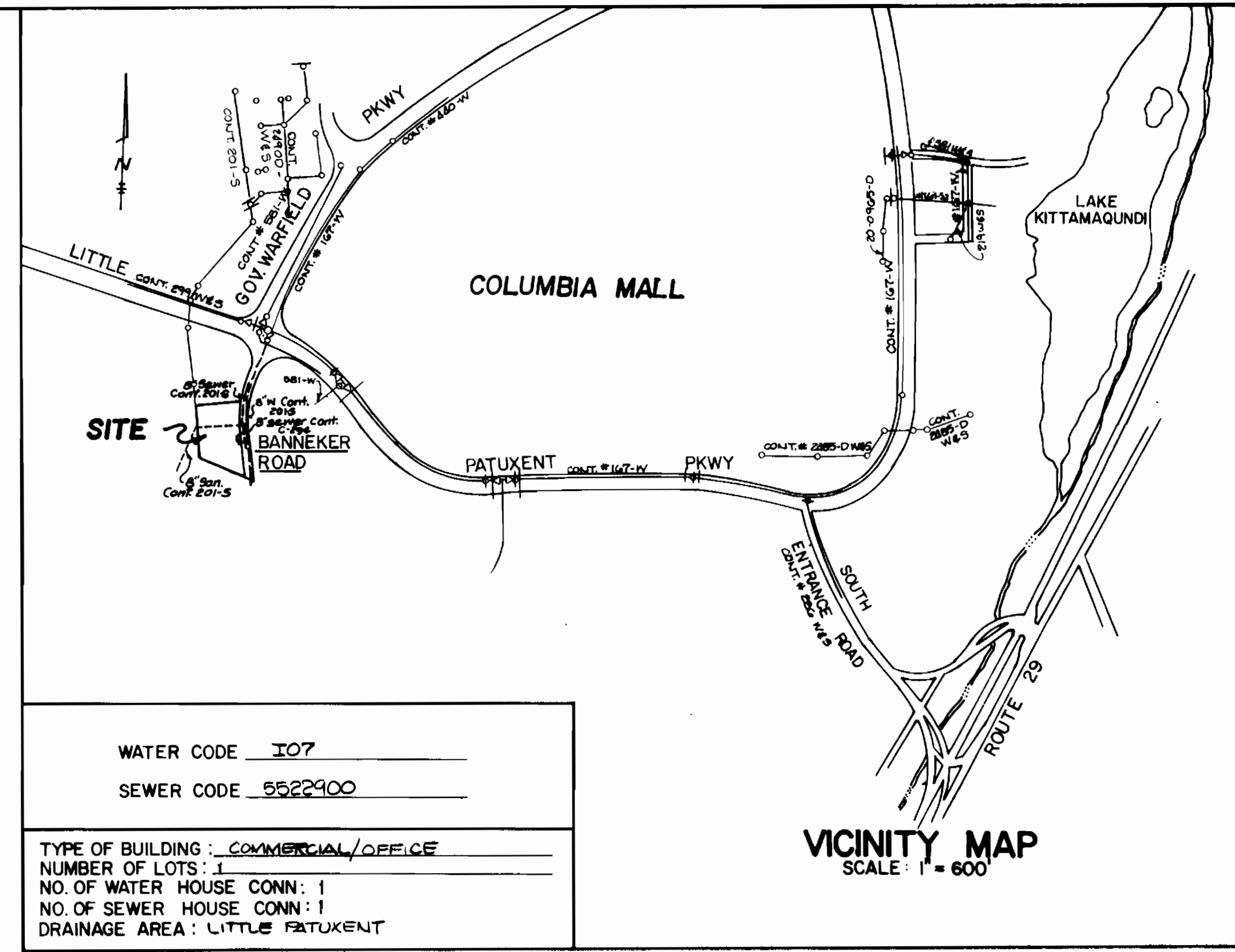

WATER CODE 107
SEWER CODE 5522900

TYPE OF BUILDING: COMMERCIAL/OFFICE
NUMBER OF LOTS: 1
NO. OF WATER HOUSE CONN: 1
NO. OF SEWER HOUSE CONN: 1
DRAINAGE AREA: LITTLE PATUXENT

- SEWER RELOCATION CONSTRUCTION SCHEDULE**
- BEGIN EXCAVATION AT MH 3006, BREAK PROPOSED PIPE INLET HOLE INTO MH AT EL. 361.20. CONNECT 2' LENGTH OF PIPE, AND RESEAL EXTERIOR OF MH WHERE PIPE ENTERS.
 - CONTINUE LINE TO PROPOSED MH 1 AND INSTALL PROPOSED MH 1.
 - INSTALL TYPE "B" DROP CONNECTION AT MH 1 AS PER HO. CO. STD. S-1.32.
 - CONTINUE LINE TO PROPOSED MH 2. INSTALL 8" SHC AT STA. 0+75. INSTALL PROPOSED MH 2.
 - DIG TEST PIT BY HAND AND LOCATE 4" H.P. GAS LINE.
 - TEMP. BLOCK INCOMING 8" SAN. LINES ENTERING MH 3014-A.
 - BREAK PROPOSED PIPE INLET HOLE AT EL. 375.06. CONNECT 2' LENGTH OF PIPE, TEMP. PLUG NEW PIPE, AND UNBLOCK INCOMING 8" SAN. LINES.
 - INSTALL REMAINDER OF PROPOSED 8" LINE FROM 2' STUB TO PROPOSED MH 2. NOTIFY INSPECTOR OF COMPLETION.
 - AFTER INSPECTION AND APPROVAL, TEMP. BLOCK INCOMING 8" SAN. LINES ENTERING MH 3014-A. FILL ENDS OF ABANDONED LINES WITH GROUT AND BRICK SHUT.
 - REMOVE PLUG FROM NEW LINE, AND UNBLOCK INCOMING 8" LINES.

QUANTITIES			
ITEM	EST'D	AS BUILT	SUPPLIER
6" SHC	10'	9 LF	TYC TYPE BELL & HOWELL SUPPLY 11111 MANIAC RD.
6" WATER	39'	13 LF	BELL & HOWELL SUPPLY 11111 MANIAC RD.
8" SEWER	245'	239 LF	TYC TYPE BELL & HOWELL SUPPLY 11111 MANIAC RD.
MANHOLES	2	2 EA	PRECAST CONCRETE ATLANTIC CONCRETE CONG. CO. 104112 FIVE CREEK RD. WETS SMITH-MIDLAND CORP.
6" METER VAULT	1	1 EA	SMITH-MIDLAND CORP.

GENERAL NOTES

- APPROXIMATE LOCATION OF EXISTING MAINS ARE SHOWN. THE CONTRACTOR SHALL TAKE ALL NECESSARY PRECAUTIONS TO PROTECT EXISTING MAINS AND SERVICES AND MAINTAIN UNINTERRUPTED SUPPLY. ANY DAMAGE INCURRED SHALL BE REPAIRED IMMEDIATELY.
- ALL HORIZONTAL CONTROLS ARE BASED ON MARYLAND STATE COORDINATES.
- ALL VERTICAL CONTROLS ARE BASED ON U.S.G.S. DATUM.
- ALL PIPE ELEVATIONS SHOWN ARE INVERT ELEVATIONS.
- CLEAR ALL UTILITIES BY A MINIMUM OF 6". CLEAR ALL POLES 2'-0" MINIMUM OR TUNNEL AS REQUIRED. ANY COST INCURRED TO THE CONTRACTOR FOR TUNNELING OR BRACING AT POLES SHALL BE INCLUDED IN UNIT PRICES BID FOR CONSTRUCTION OF THE MAIN.
- FOR ALL STANDARD DETAILS SEE STANDARDS BOUND IN SPECIFICATIONS.
- CONTRACTOR SHALL LOCATE EXISTING UTILITIES IN ADVANCE OF CONSTRUCTION OPERATIONS IN THE VICINITY OF PROPOSED UTILITIES AT HIS OWN EXPENSE.
- CONTRACTOR SHALL NOTIFY THE FOLLOWING UTILITIES OR AGENCIES AT LEAST FIVE (5) DAYS BEFORE STARTING WORK SHOWN ON THESE PLANS:
STATE HIGHWAY ADMINISTRATION - 531-5533
BALTIMORE GAS AND ELECTRIC COMPANY - UNDERGROUND ELECTRIC DISTRIBUTION
ENGINEERING - "DAMAGE CONTROL" - 234-5691
BALTIMORE GAS AND ELECTRIC COMPANY - UNDERGROUND GAS DISTRIBUTION
ENGINEERING - 559-0100
CHESAPEAKE AND POTOMAC TELEPHONE COMPANY - 725-9976
AMERICAN TELEPHONE AND TELEGRAPH - CABLE LOCATION DIVISION - 301-393-3553
COLONIAL PIPELINE COMPANY - 781-4641
- TREES ARE TO BE PROTECTED FROM DAMAGE TO MAXIMUM EXTENT. TREES LOCATED WITHIN THE CONSTRUCTION STRIP ARE NOT TO BE REMOVED OR DAMAGED BY THE CONTRACTOR.
- CONTRACTOR SHALL REMOVE TREES, STUMPS AND ROOTS ALONG LINE OF EXCAVATION AS DIRECTED BY THE ENGINEER. PAYMENT FOR SUCH REMOVAL SHALL BE INCLUDED IN THE UNIT PRICE BID FOR EXCAVATION AND BACK FILL FOR WATER AND SEWER MAINS.
- PLACE REGULATION "MEN WORKING" AND WARNING SIGNS AS REQUIRED TO COMPLY WITH MARYLAND STATE HIGHWAY ADMINISTRATION MANUAL OF TRAFFIC CONTROL FOR HIGHWAY CONSTRUCTION AND MAINTENANCE OPERATIONS.
- ALL WATER MAINS TO BE D.I.P. UNLESS OTHERWISE NOTED.
- TOP OF ALL WATER MAINS TO HAVE A MINIMUM OF 3'-6" COVER UNLESS OTHERWISE NOTED.
- ALL VALVES SHALL BE STRAPPED TO TEES IN ACCORDANCE WITH STANDARD DETAILS.
- BLOCK ALL FITTINGS WITH CONCRETE, SEE STANDARD BOUND IN SPECIFICATIONS.
- BURY LINE ELEVATIONS ON FIRE HYDRANTS SHALL BE SET TO THE ELEVATION ON THE DRAWINGS. ALL FIRE HYDRANTS SHALL BE STRAPPED AND BUTTRESSED WITH CONCRETE IN ACCORDANCE WITH STANDARD DETAILS, SOIL AROUND THE FIRE HYDRANT TO BE COMPACTED IN ACCORDANCE WITH SECTIONS 1003 AND 1008 OF STANDARD SPECIFICATIONS.
- ALL WATER HOUSE CONNECTIONS SHALL BE FOR AN INSIDE METER SETTING UNLESS OTHERWISE NOTED.
- ALL SEWER MAINS SHALL BE C.S.P.X., V.C.P.X. OR A.C.P. CLASS PVC 2400 UNLESS OTHERWISE NOTED.
- THE CONTRACTOR SHALL PROVIDE A JOINT IN ALL SEWER MAINS WITHIN 2'-0" OF EXTERIOR MANHOLE WALL.
- ALL MANHOLES SHALL BE 4'-0" INSIDE DIAMETER UNLESS OTHERWISE NOTED.
- FOR MATERIAL AND CONSTRUCTION METHODS USE HOWARD COUNTY STANDARD SPECIFICATIONS.
- VALVES ADJACENT TO TEES SHALL BE STRAPPED TO TEES.
- THE CONTRACTOR SHALL NOT OPERATE ANY WATER MAIN VALVES ON THE EXISTING SYSTEM.
- WATER MAINS AND WATER HOUSE CONNECTION LINES MUST BE PLACED SO AS TO HAVE AT LEAST ONE (1) FOOT SEPARATION FROM THE SEWER MAIN OR SEWER HOUSE CONNECTION AS THEY PASS ABOVE IT.
- MANHOLES LOCATED WITHIN PROPOSED ROADWAY SHALL HAVE STANDARD HEAVY TRAFFIC MANHOLE FRAME AND COVER, STANDARD DETAIL G.5.1.

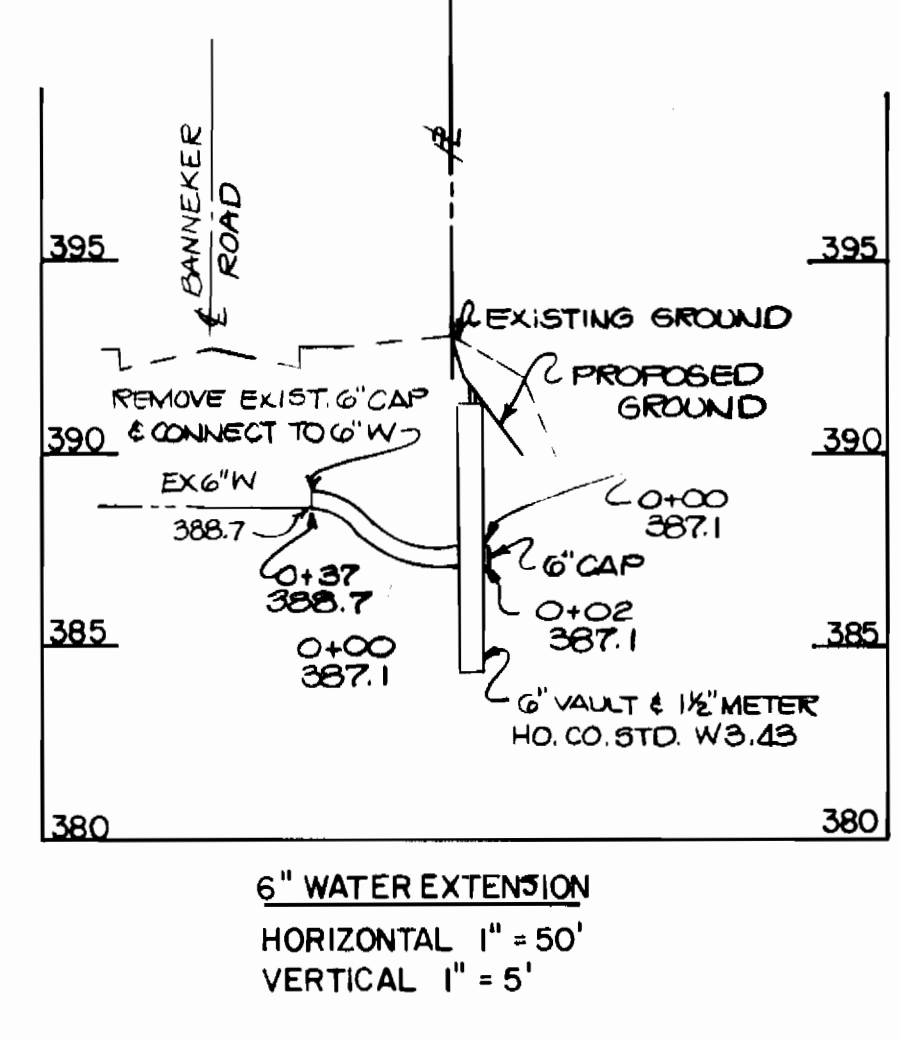
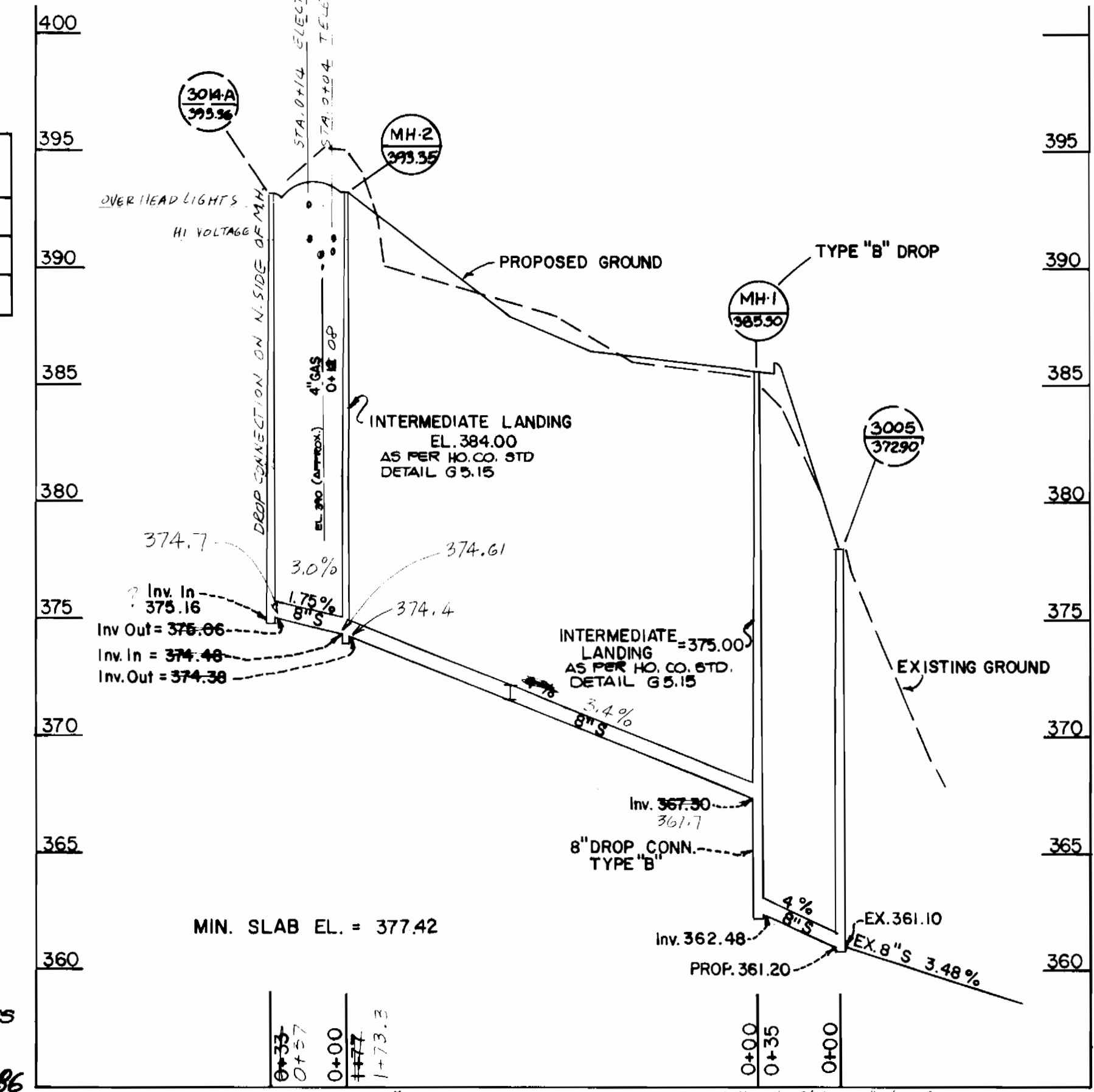

REVIEWED FOR HOWARD S.C.D. AND MEETS TECHNICAL REQUIREMENTS.
John M. John 2/13/86
DATE

THIS DEVELOPMENT PLAN IS APPROVED FOR SOIL EROSION AND SEDIMENT CONTROL BY THE HOWARD SOIL CONSERVATION DISTRICT.
Stephen L. Haker 2/13/86
DATE

SEDIMENT CONTROL MEASURES FOR THIS CONTRACT WILL BE IMPLEMENTED IN ACCORDANCE WITH SECTION 15 OF THE HOWARD COUNTY DESIGN MANUAL + STANDARDS + SPECIFICATIONS FOR SOIL EROSION AND SEDIMENT CONTROL IN DEVELOPING AREAS - SDP. 86-110

DEPARTMENT OF PUBLIC WORKS
HOWARD COUNTY, MARYLAND

Henry F. Nunnery 2-18-86
DIRECTOR OF PUBLIC WORKS DATE

Robert B. Boring 2-18-86
CHIEF, BUREAU OF UTILITIES DATE

John C. ... 2-18-86
CHIEF, BUREAU OF ENGINEERING DATE

William ... 2-18-86
CHIEF, LAND DEVELOPMENT DIV. DATE

KIDDE CONSULTANTS INC.
ENGINEERS, PLANNERS & SURVEYORS
8101 SANDY SPRING ROAD/SUITE 101
LAUREL, MD. 20707
(301) 792-8086



DES: MVD	
DRN: JJK/MVD	
CHK: MVD	
DATE: 12-13-85	
BY	NO.
REVISION	DATE

**PLAN & PROFILES
WATER & SEWER MAINS**

600' SCALE MAP NO. 36 BLOCK NO.

TOWN CENTER
SECTION 3 AREA 2 PARCEL 9
CONTRACT No. 24-1434-D
5th ELECTION DISTRICT
HOWARD COUNTY, MARYLAND

SCALE AS SHOWN
SHEET 1 OF 1