

GENERAL NOTES

TYPE OF BUILDINGS Residential
 TOTAL NUMBER OF LOTS 4
 NO. OF SEWER HOUSE CONNECTIONS 4
 NO. OF WATER HOUSE CONNECTIONS 4
 DRAINAGE AREA Potapoco

VICINITY MAP
 SCALE: 1"= 600

SEWER CODE FOR COUNTY USE ONLY:
 SEWER NO. 2280000

WATER CODE FOR COUNTY USE ONLY:
 WATER NO. 201

- APPROXIMATE LOCATION OF EXISTING MAINS ARE SHOWN. THE CONTRACTOR SHALL TAKE ALL NECESSARY PRECAUTIONS TO PROTECT EXISTING MAINS AND SERVICES AND MAINTAIN UNINTERRUPTED SUPPLY. ANY DAMAGE INCURRED SHALL BE REPAIRED IMMEDIATELY TO THE SATISFACTION OF THE ENGINEER AT THE CONTRACTOR'S EXPENSE.
- ALL HORIZONTAL CONTROLS ARE BASED ON MARYLAND STATE COORDINATES.
- ALL VERTICAL CONTROLS ARE BASED ON U.S.G.S. DATUM.
- ALL PIPE ELEVATIONS SHOWN ARE INVERT ELEVATIONS.
- CLEAR ALL UTILITIES BY A MINIMUM OF 6'. CLEAR ALL POLES BY 2'-0" MINIMUM OR TUNNEL AS REQUIRED. THE OWNER HAS CONTACTED THE UTILITY COMPANIES AND HAS MADE ARRANGEMENTS FOR BRACING OF POLES AS SHOWN ON THE DRAWINGS. IN THE EVENT THE CONTRACTOR'S WORK REQUIRES THE BRACING OF ADDITIONAL POLES, ANY COST INCURRED BY THE OWNER FOR THE BRACING OF ADDITIONAL POLES OR DAMAGES SHALL BE DEDUCTED FROM MONEY OWED THE CONTRACTOR. THE CONTRACTOR SHALL COORDINATE WITH THE UTILITY COMPANIES TO SCHEDULE THE BRACING OF THE POLES.
- THE CONTRACTOR SHALL NOT OPERATE ANY WATER MAIN VALVES ON THE EXISTING WATER SYSTEM.
- CONTRACTOR SHALL NOTIFY THE FOLLOWING UTILITIES OR AGENCIES AT LEAST FIVE (5) WORKING DAYS BEFORE STARTING WORK SHOWN ON THESE PLANS:
 STATE HIGHWAY ADMINISTRATION: 531-5533
 BALTIMORE GAS & ELECTRIC CO. - CONTRACTOR SERVICE: 561-2585
 BALTIMORE GAS & ELECTRIC CO. - UNDERGROUND DAMAGE CONTROL: 234-5621
 BALTIMORE GAS & ELECTRIC CO. TROUBLE SHOOTING: 298-9013
 MISS UTILITY: 1-559-0100
 COLONIAL PIPELINE CO.: 795-1390
 BUREAU OF UTILITIES, HOWARD CO. DEPT. OF PUBLIC WORKS: 992-2366

TEST PIT INFORMATION TABLE

Existing Utility	Elevation-Top of Pipe
10" W.P. Gas	129.36
2" Gas	123.40
8" Water	123.02

*Test Pit @ Prop. 8' between MH#1 & MH#2

CONSTRUCTION STAKEOUT TABLE

MH#1	35' from C-1 along C-2/C-1 extended @ 3' left
MH#2	30' from C-1 towards C-2 @ 20' Left
MH#3	157' from C-2 towards C-1 @ 225' Right

STABILIZATION NOTES:

- Seadbed should be prepared to a minimum depth of 3 inches. When the area to be seadbed has been recently loosened to the extent that an adequate seadbed exists, no additional treatment is required.
- Lime to a pH of 9.0 but in the absence of a soil test, apply a minimum of one ton/acre of ground limestone.
- Fertilize at the minimum rate of 500 pounds of 10-10-10 per acre.
- Mulch the seadbed area with small grain straw at a rate of 15 tons/acre.
- Seed the areas with Kentucky 31 Tall Fescue at a rate of 50 lbs./ac. The seeding dates are spring - 3/15 to 5/15.

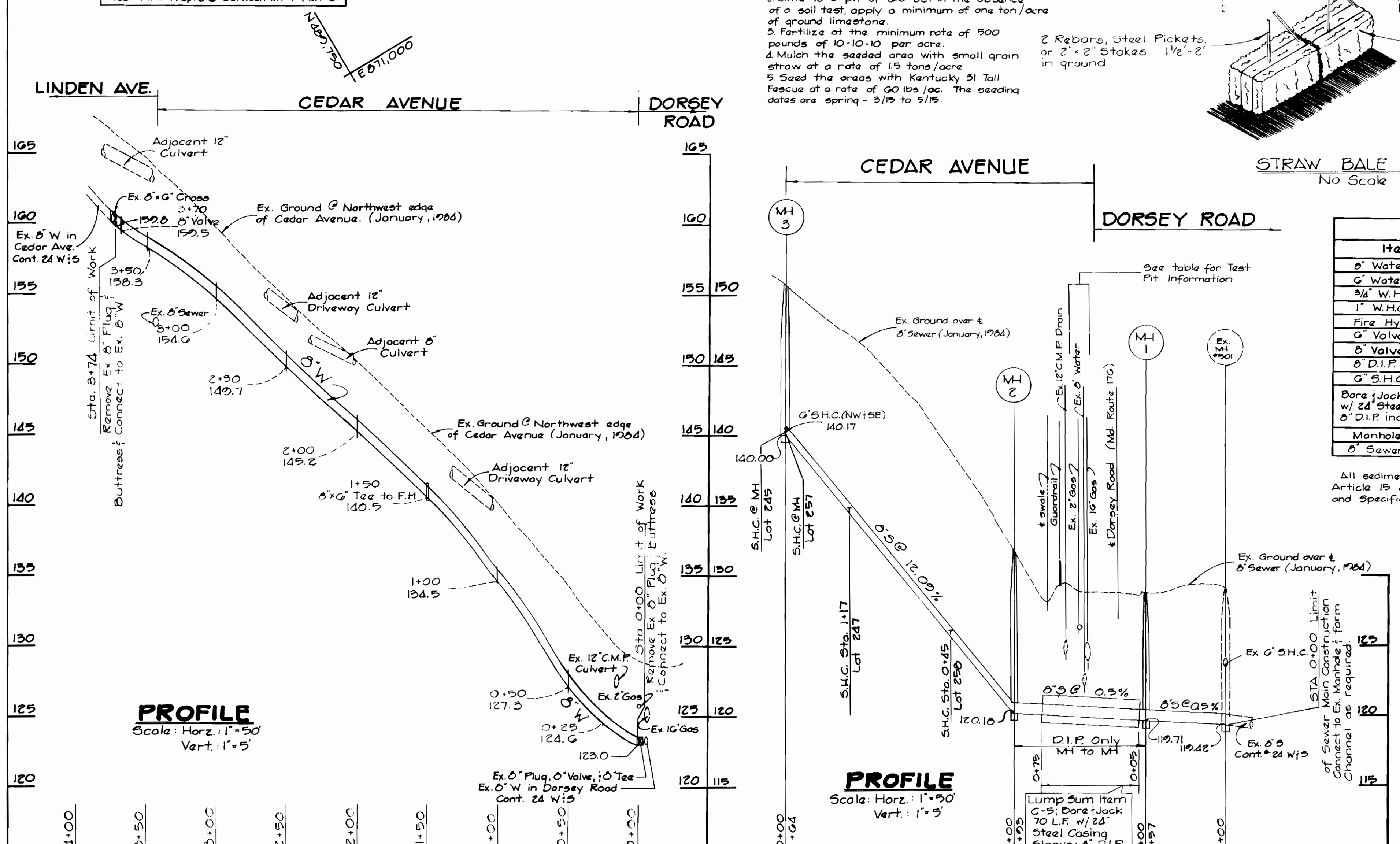
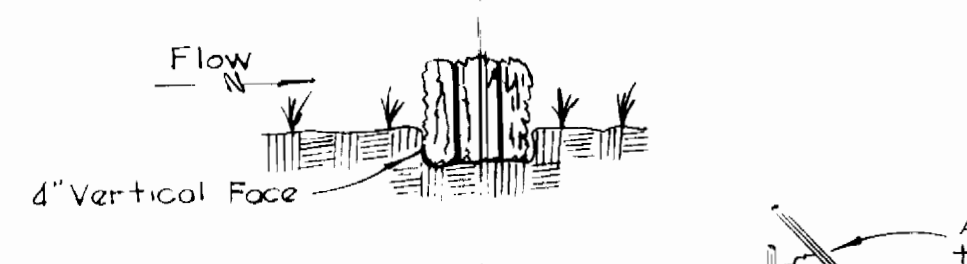

QUANTITIES

Item	Estimated	As-Built	Supplier
6" Water	374 LF.	375 LF D.I.P.	A&P Supply
6" Water	5 LF. (to F.H.)	5 LF.	"
3/4" W.H.C.	20 LF.	20 LF.	"
1" W.H.C.	7 LF.	7 LF.	"
Fire Hydrant	1 Each	1 - Mueller	"
6" Valves	1 Each	1 - Mueller	"
6" Valves	1 Each	1 - Mueller	"
6" D.I.P. Sewer	23 LF.	23 LF D.I.P.	"
6" S.H.C.	22 LF.	22 LF.	"
Bore Jack w/ 24" Steel Casing; 6" D.I.P. included.	Lump Sum; 70 LF.	70'	C.C.T. Construction
Manholes	3 Each	3	Atlantic Precast
6" Sewer	21 LF.	22 LF.	A&P Supply

All sediment control operations are to be done in accordance with Article 15 of the Howard County Design Manual and the Standards and Specifications for Sediment Control in Developing Areas.

Sediment Control Measures for this contract will be implemented in accordance with Article 15 of these Specifications.

Review for Howard County Soil Conservation District and m&e's Technical Requirements.

James M. Hahn 4/30/84
 U.S. Soil Conservation Service Date

This Development Plan is approved for Erosion and Sediment Control by Howard Soil Conservation District.

Approved: *Stephen A. Hughes* 4/24/84
 Howard Soil Conservation District Date

Immediately following backfill of pipe trenches, all disturbed areas are to be stabilized with seed mulch in accordance with referenced Standards, Specifications and in accordance with the "Stabilization Notes" included on this plan.

DEPARTMENT OF PUBLIC WORKS
 HOWARD COUNTY, MARYLAND

Shirley F. Nemes 7-5-84
 DIRECTOR OF PUBLIC WORKS DATE

Robert M. Beisinger 7-3-84
 CHIEF, BUREAU OF UTILITIES DATE

FISHER, COLLINS & CARTER, INC.
 CONSULTING ENGINEERS & LAND SURVEYORS
 8388 COURT AVENUE
 ELLICOTT CITY, MARYLAND 21043

Allen L. Brown 7/2/84
 CHIEF, UTILITY DIVISION DATE

Terrell A. Fisher
 Terrell A. Fisher

DES: P.W.K.	DATE: 5/6/84	BY: NO.	REVISION
DRN: DEV.			
CHK: T.A.F.			
M.W. 1			
As-Built			

PLAN, PROFILES AND DETAILS
 WATER AND SEWER MAINS

600 SCALE MAP NO. 45 BLOCK NO.

CEDAR AVENUE
 CAPITAL PROJECTS NO. W-8684 AND S-6684
 CONTRACT NO. 14-1207
 FIRST ELECTION DISTRICT
 HOWARD COUNTY, MARYLAND

SCALE AS SHOWN
 SHEET 1 OF 1

Revised 5/31/84 & 6/26/84 AS BUILT 4/3/85