

VICINITY MAP  
SCALE: 1" = 600'

STA. 10+24 CEDAR LANE @ CONSTR. (11' LT.)  
INSTALL 16" x 8" TAPPING SLEEVE AND BUTTRESS,  
8" TAPPING VALVE AND ROADWAY VALVE BOX  
INV. EL. 473.01 (8" W) INSTALL 710' L.F. WATER MAIN

STA. 1+19 @ CONSTR. 2-D (40' LT.)  
INSTALL 1/8" HORIZ. BEND AND  
BUTTRESS INV. EL. 477.2

STA. 19+17 @ CONSTR. PARKING LOT 'A'  
INSTALL 8" x 6" TEE AND BUTTRESS, 6" VALVE  
AND ROADWAY VALVE BOX, AND FIRE  
HYDRANT (14 LT STA. 18+77.5). STRAP FIRE  
HYDRANT TO MAIN IN ACCORDANCE W/  
HOWARD CO. STD. W 2.13 INV. EL. @  
8" x 6" TEE = 475.2 INSTALL 41' L.F. 6" WATER  
MAIN.

PLAN  
SCALE: 1" = 50'

NOTE: NO EASEMENT OR R/W REQUIRED  
FOR 6" WATER MAIN INTO STORAGE  
BUILDING.

QUANTITIES			
ITEM	BID	AS BUILT	MATERIAL SUPPLIER
8" WATER	710 L.F.		
6" WATER	46 L.F.		
F. HYDRANT	1		

GENERAL NOTES  
FOR WATER MAIN CONSTRUCTION

- APPROXIMATE LOCATIONS OF EXISTING UTILITIES ARE SHOWN. THE CONTRACTOR SHALL TAKE ALL NECESSARY PRECAUTIONS TO PROTECT THE EXISTING UTILITIES AND MAINTAIN UNINTERRUPTED SERVICES. ANY DAMAGE TO EXISTING UTILITIES SHALL BE IMMEDIATELY REPAIRED TO THE SATISFACTION OF THE ENGINEER, AT THE CONTRACTOR'S EXPENSE.
- ALL PIPE ELEVATIONS ARE SHOWN AS INVERT (I) ELEVATIONS.
- CLEAR ALL UTILITIES TO A MINIMUM OF 1'-0" CLEAR, ALL POLES BY 2'-0" MINIMUM OR TUNNEL AS REQUIRED. ANY COST INCURRED TO THE CONTRACTOR FOR TUNNELING OR BRACING AT POLES SHALL BE INCLUDED IN UNIT PRICES BID FOR CONSTRUCTION OF THE MAIN.
- FOR DETAILS NOT SHOWN ON THE DRAWINGS USE HOWARD COUNTY STANDARD DETAILS.
- FOR MATERIALS AND CONSTRUCTION METHODS USE HOWARD COUNTY STANDARD SPECIFICATIONS.
- CONTRACTOR SHALL LOCATE EXISTING UTILITIES A MINIMUM OF TWO (2) WEEKS IN ADVANCE OF CONSTRUCTION OPERATIONS IN THE VICINITY OF PROPOSED UTILITIES AT HIS OWN EXPENSE.
- CONTRACTOR SHALL NOTIFY THE FOLLOWING UTILITIES OR AGENCIES AT LEAST FIVE (5) WORKING DAYS BEFORE STARTING WORK SHOWN ON THESE PLANS.
  - STATE HIGHWAY ADMINISTRATION - 531-5533
  - BALTIMORE GAS & ELECTRIC CO. - UNDERGROUND ELECTRIC DISTRIBUTION CUSTOMER SERVICE - 685-0123
  - BALTIMORE GAS & ELECTRIC CO. - UNDERGROUND GAS DISTRIBUTION CUSTOMER SERVICE - 685-0123
  - ENGINEERING 'DAMAGE CONTROL' - 234-5621
  - MISS UTILITY - 1-559-0100
  - CHESAPEAKE & POTOMAC (C&P) TELEPHONE COMPANY - 725-9976
  - AMERICAN TELEPHONE AND TELEGRAPH - CABLE LOCATION DIVISION - 393-3553
  - COLONIAL PIPELINE COMPANY - 761-4641
  - BUREAU OF UTILITIES - HOWARD COUNTY - 992-2366
- ALL WATER MAINS TO BE C.I.P. OR D.I.P. UNLESS OTHERWISE NOTED.
- TOP OF ALL WATER MAINS SHALL HAVE A MINIMUM OF 3 1/2' COVER UNLESS OTHERWISE NOTED.
- VALVES ADJACENT TO TEES SHALL BE STRAPPED TO TEES.
- BLOCK ALL FITTINGS WITH CONCRETE.
- BURY LINE ELEVATIONS ON FIRE HYDRANTS SHALL BE SET TO THE ELEVATIONS SHOWN ON THE DRAWINGS. ALL FIRE HYDRANTS SHALL BE STRAPPED AND BUTTRESSED WITH CONCRETE IN ACCORDANCE WITH STANDARD DETAILS. SOIL AROUND FIRE HYDRANTS TO BE COMPACTED IN ACCORDANCE WITH SECTION 37.01 AND 37.05 OF THE STANDARD SPECIFICATIONS.
- ALL WATER HOUSE CONNECTIONS SHALL BE FOR AN INSIDE METER SETTING.
- THE CONTRACTOR SHALL NOT OPERATE ANY METER MAIN VALVES ON THE EXISTING SYSTEM.
- ALL HORIZONTAL CONTROLS ARE BASED ON MARYLAND STATE COORDINATES.
- ALL VERTICAL CONTROLS ARE BASED ON U.S.G.S. DATUM.

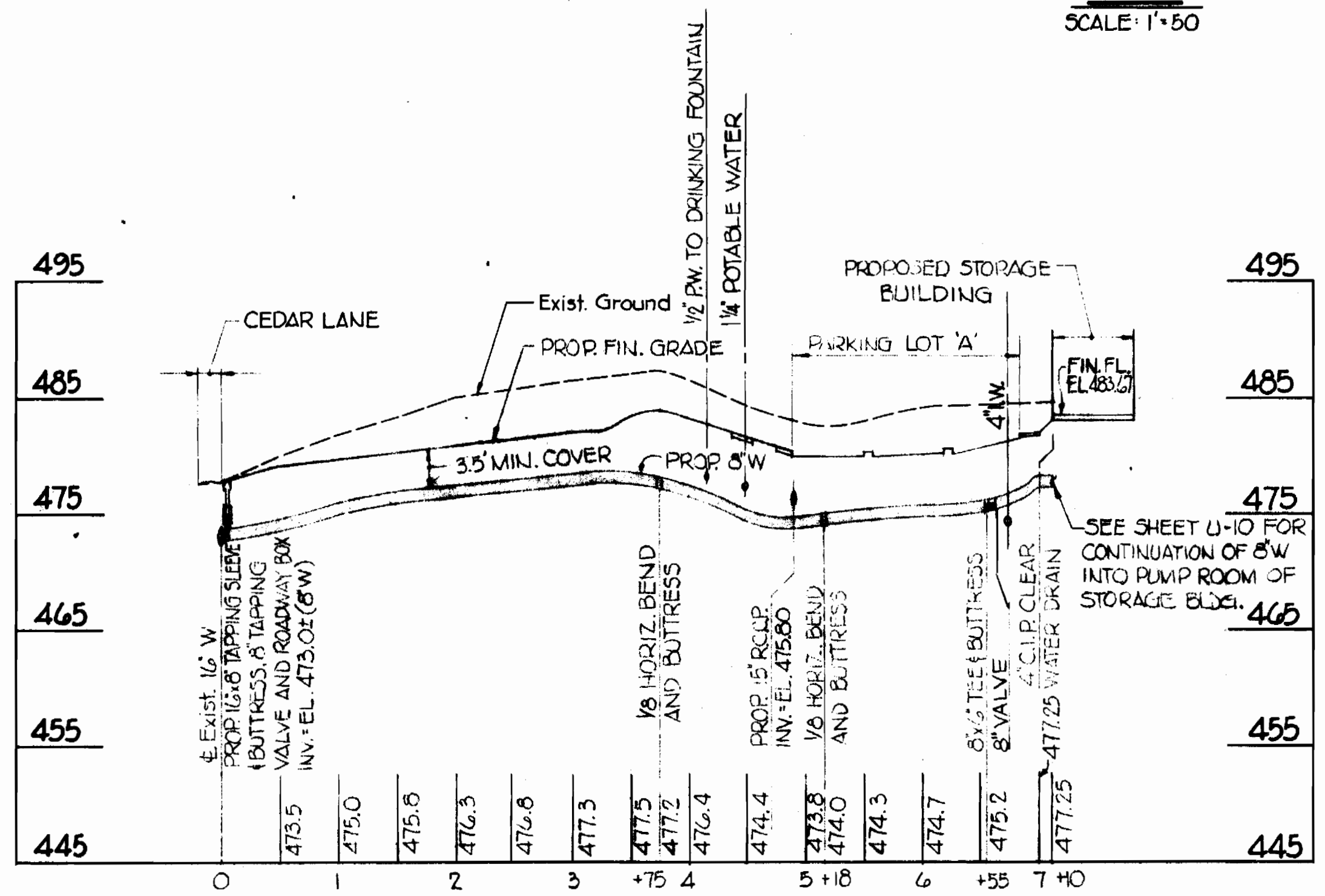

PROFILE - 8" W. TO STORAGE BUILDING  
SCALE: HORIZ. 1" = 100'  
VERT. 1" = 10'

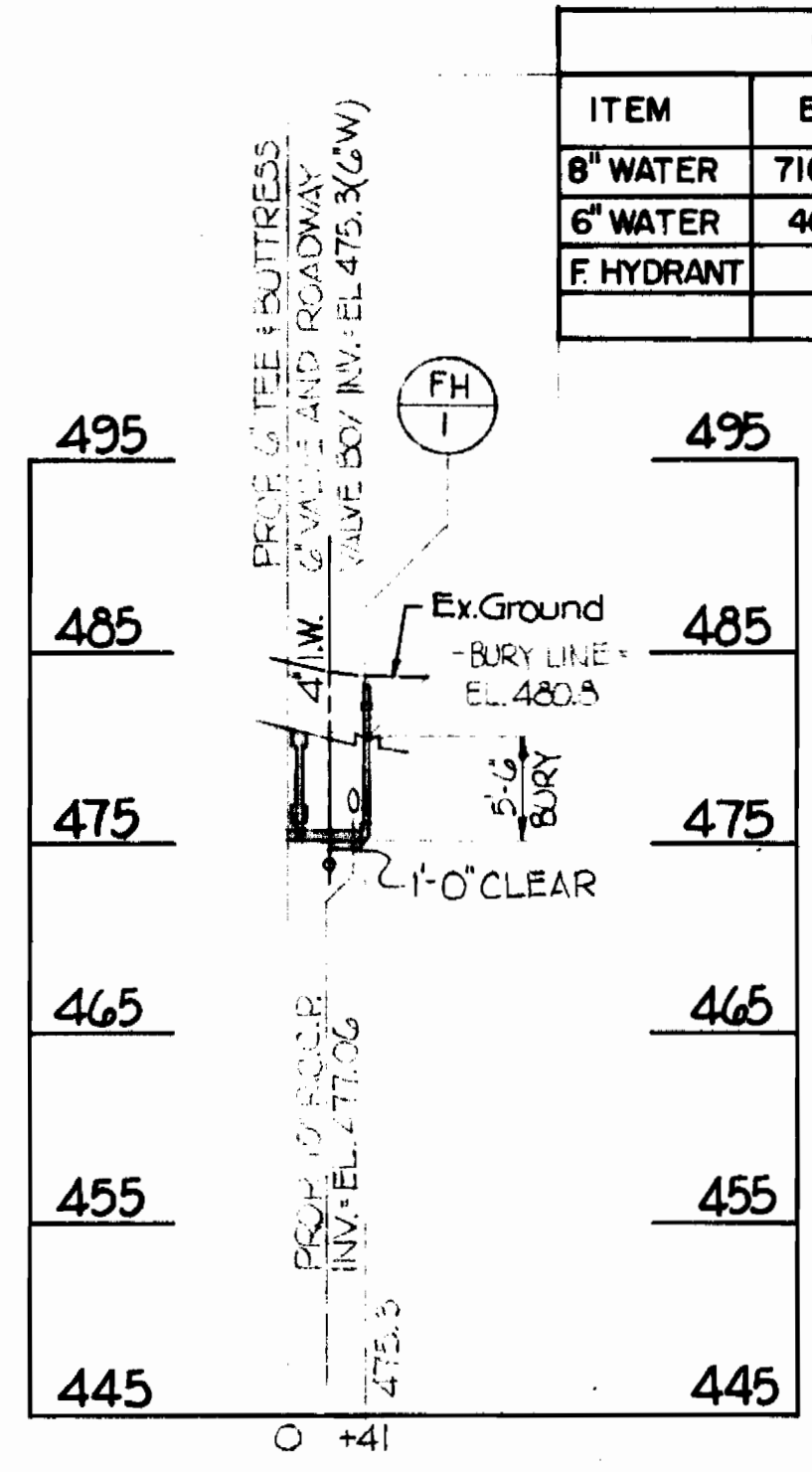

PROFILE - 6" W. TO FH-1  
SCALE: HORIZ. 1" = 100'  
VERT. 1" = 10'

DEPARTMENT OF PUBLIC WORKS  
HOWARD COUNTY, MARYLAND  
*John F. Neuman* 2-10-83 *Robert R. Reinger* 2-17-83  
DIRECTOR OF PUBLIC WORKS DATE CHIEF - BUREAU OF UTILITIES DATE

JOHNSON, MIRMIRAN & THOMPSON P.A.  
ENGINEERS PLANNERS SURVEYORS LANDSCAPE ARCHITECTS  
1526 YORK ROAD BALTIMORE, MARYLAND 21093

DEPARTMENT OF PUBLIC WORKS  
HOWARD COUNTY, MARYLAND  
*Allen J. Brown* 2/10/83 *Robert R. Reinger* 2/11/83  
CHIEF, UTILITY DIVISION DATE CHIEF - BUREAU OF ENGINEERING DATE

CONTRACT NO. 44-109B

WATER MAIN  
PLAN AND PROFILE

CEDAR LANE PARK  
CAPITAL PROJECT N-4-3028

DRAWING NO. W-1 OF W-1 SCALE AS SHOWN OCT. 1982