

TYPE OF BLDG. - OFFICE & WAREHOUSE
 NO. OF LOTS -
 NO. W.H.C. -
 NO. SAN. H.C. -
 DRAINAGE AREA - LITTLE FRUITCANT

BENCHMARK: BM-3 ELEV. 216.30
 DESCRIPTION: CROSSCUT ON BONNET BOLT
 FIRE HYDRANT 290'N OF INTERSECTION OF
 LARKIN ROAD AND GREENWOOD PLACE
 NOTE: B.M. OBTAINED FROM TOPO SURVEY (FISHER, COLLINS & CARTER, INC.)

- GENERAL NOTES**
- APPROXIMATE LOCATION OF EXISTING MAINS ARE SHOWN. THE CONTRACTOR SHALL TAKE ALL NECESSARY PRECAUTIONS TO PROTECT EXISTING MAINS AND DEVICES AND MAINTAIN UNINTERRUPTED SUPPLY. ANY DAMAGE INCURRED SHALL BE REPAIRED IMMEDIATELY.
 - ALL HORIZONTAL CONTROLS ARE BASED ON "MARYLAND STATE COORDINATES."
 - ALL VERTICAL CONTROLS ARE BASED ON MARYLAND STATE DATUM.
 - CLEAR ALL UTILITIES BY A MINIMUM OF 6". CLEAR ALL POLES 2'-0" MIN. OR TUNNEL AS REQUIRED.
 - CONTRACTOR SHALL LOCATE EXISTING UTILITIES IN ADVANCE OF CONSTRUCTION OPERATIONS IN THE VICINITY OF PROPOSED UTILITIES.
 - CONTRACTOR SHALL NOTIFY THE FOLLOWING UTILITIES OR AGENCIES AT LEAST FIVE (5) DAYS BEFORE STARTING WORK.
 - "MIDG UTILITY" (COLLECT) 1-880-0100
 - BALTIMORE GAS & ELECTRIC CO. - UNDERGROUND ELECTRIC DISTRIBUTION ENGINEERING "DAMAGE CONTROL", MR. G.U. ZELER-MANAGER 284-9091
 - BALTIMORE GAS & ELECTRIC CO. - UNDERGROUND GAS DISTRIBUTION ENGINEERING, MR. BELL 284-5088
 - CHEAPAKE & POTOMAC TELEPHONE CO. 728-0076
 - BUREAU OF UTILITIES (HOWARD CO.) 898-2366
 - CONTRACTOR SHALL REMOVE TREES, STUMPS AND ROOTS ALONG LINE OF EXCAVATION AS DIRECTED BY ENGINEER. PAYMENT FOR SUCH REMOVAL SHALL BE INCLUDED IN THE UNIT PRICE BID FOR "EXCAVATION AND BACKFILL FOR WATER AND SEWER MAINS."
 - PLACE REGULATION "MEN WORKING" AND WARNING SIGNS AS REQUIRED TO COMPLY WITH MARYLAND STATE HIGHWAY ADMINISTRATION "MANUAL FOR HIGHWAY CONSTRUCTION AND MAINTENANCE OPERATIONS."
 - ALL WATER MAINS TO BE C.I.P. OR D.I.P. UNLESS OTHERWISE NOTED.
 - TOP OF WATER MAINS TO HAVE A MINIMUM OF 8" COVER UNLESS OTHERWISE NOTED.
 - ALL VALVES SHALL BE STRAPPED TO TEES IN ACCORDANCE WITH STANDARD DETAILS.
 - BLOCK ALL FITTINGS WITH CONCRETE. SEE STANDARD BOUND IN SPECIFICATIONS.
 - BURY LINE ELEVATIONS ON FIRE HYDRANTS SHALL BE SET TO THE ELEVATIONS SHOWN ON THE DRAWINGS. ALL FIRE HYDRANTS SHALL BE STRAPPED AND BUTTERBRED WITH CONCRETE IN ACCORDANCE WITH STANDARD DETAILS. SOIL AROUND THE FIRE HYDRANT TO BE COMPACTED IN ACCORDANCE WITH SECTION 5-18 OF THE STANDARD SPECIFICATIONS.
 - ALL WATER MAIN ELEVATIONS SHOWN ARE INVERT ELEVATION.
 - SEDIMENT CONTROL MEASURES FOR THIS CONTRACT WILL BE IMPLEMENTED IN ACCORDANCE WITH GRADING AND EROSION PLAN SDP#81-182.
 - WATER MAIN AND WATER HOUSE CONNECTIONS MUST BE PLACED SO AS TO HAVE AT LEAST ONE (1) FOOT SEPARATION FROM THE SANITARY SEWER AND SEWER HOUSE CONNECTION AS THEY PASS ABOVE IT.

PLAN
 SCALE: 1" = 50'

* CONTRACTOR TO TEST PIT EXISTING UTILITIES PRIOR TO LAYING PIPE TO DETERMINE EXACT LOCATIONS AND ELEVATIONS

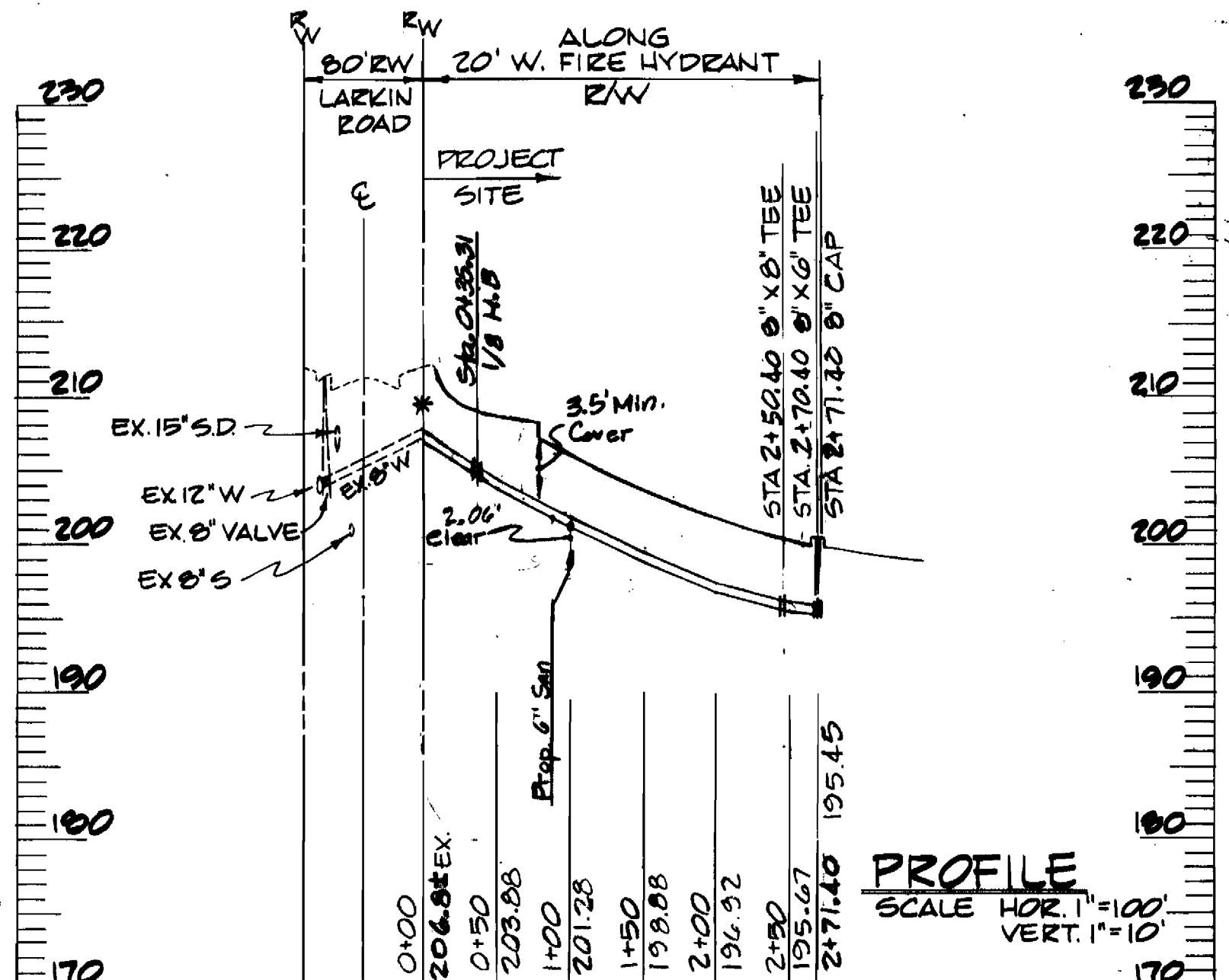

QUANTITIES

ITEM	ESTIMATED	AS-BUILT	MATERIAL/SUPPLIER
6" SAN. HOUSE CONN	4@6.E.	4@5 LF	VCP/A&P LOGAN
6" WATER	277 LF.	CLASS 52/273 LF.	DIP/A&P ATLANTIC TRINITY / A&P
6" X 6" TEE	1 EA.	1 EA.	TRINITY / A&P
1/2 BEND	1 EA.	1 EA.	TRINITY / A&P
6" X 6" TEE	1 EA.	1 EA.	TRINITY / A&P
6" WATER	5 LF.	4.5 LF.	DARLING / A&P
6" F.H. & VALVE	1 EA.	1 EA.	A&P
6" VALVE	1 EA.	1 EA.	A&P
6" CAP	1 EA.	1 EA.	A&P

SEDIMENT CONTROL MEASURES FOR THIS CONTRACT WILL BE IMPLEMENTED IN ACCORDANCE WITH ARTICLE #15 OF THE STANDARD SPECIFICATIONS AND SDP#81-182.

DEPARTMENT OF PUBLIC WORKS
 HOWARD COUNTY, MARYLAND
 Chief - Bureau of Utilities - DATE
 Chief - Bureau of Engineering - DATE
GEORGE W. STEPHENS, JR. & ASSOC. INC.
 CONSULTING ENGINEERS
 305 ALLEGHENY AVENUE
 TOWSON, MARYLAND 21284

DEPARTMENT OF PUBLIC WORKS
 HOWARD COUNTY, MARYLAND
 Director - Public Works - DATE
 Chief - Land Development Div. - DATE
CONTRACT NO. 44-0997-D

REVIEWED FOR THE HOWARD SOIL CONSERVATION DISTRICT AND MEETS TECHNICAL REQUIREMENTS.
 SIGN DATE
 U.S. SOIL CONSERVATION SERVICE

THIS CONSTRUCTION PLAN IS APPROVED FOR SOIL EROSION AND SEDIMENT CONTROL BY THE HOWARD SOIL CONSERVATION DISTRICT.
 APPROVED DATE
 HOWARD SOIL CONSERVATION DISTRICT

PLAN AND PROFILE FOR PROPOSED 6" WATER

14-ALL WATER MAIN ELEVATIONS SHOWN ARE INVERT ELEVATION.
 15-SEDIMENT CONTROL MEASURES FOR THIS CONTRACT WILL BE IMPLEMENTED IN ACCORDANCE WITH GRADING AND EROSION PLAN SDP#81-182.
 16-WATER MAIN AND WATER HOUSE CONNECTIONS MUST BE PLACED SO AS TO HAVE AT LEAST ONE (1) FOOT SEPARATION FROM THE SANITARY SEWER AND SEWER HOUSE CONNECTION AS THEY PASS ABOVE IT.

CORRIDOR INDUSTRIAL PARK PROPOSED OFFICE & WAREHOUSE
 SECTION-1 PARCEL P-1
 HOWARD CO., MD. ~ 6TH ELECT. DIST. ~ JUNE 1981

DRAWING NO. 1 OF 1
 SCALE AS SHOWN
 DESIGN E.W.R.
 DRAWN B.F.
 CHECKED B.F.
 P.L. 4502

DRAWING NUMBER
CE-5